

Bath & Body Works

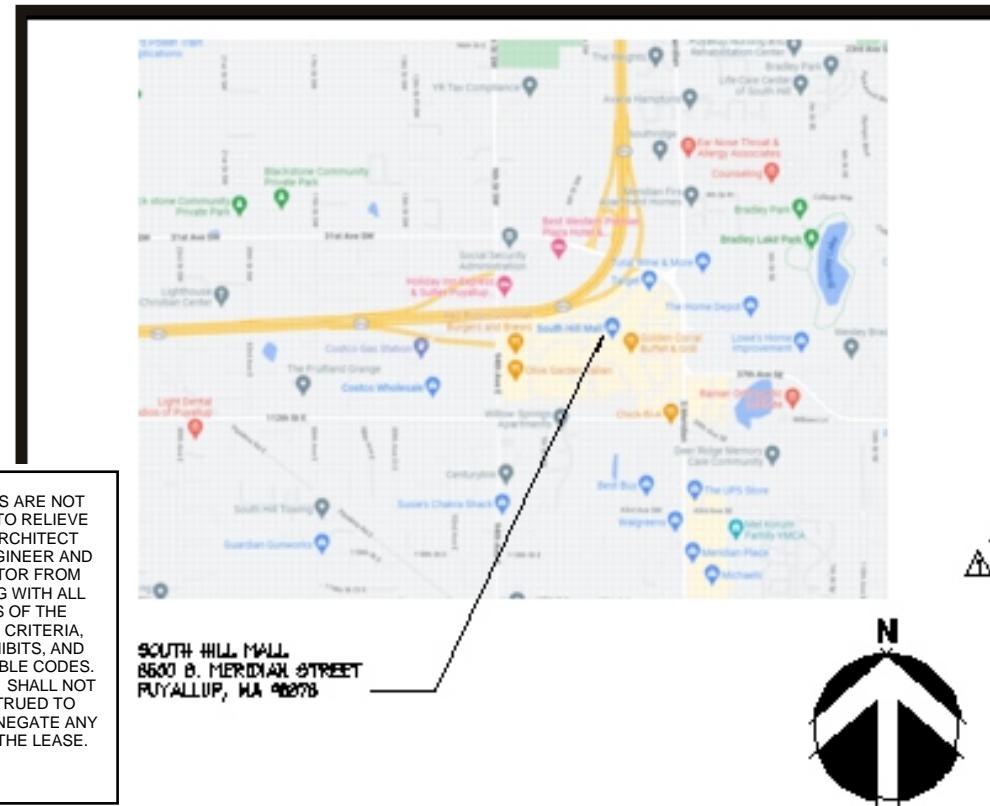

<input checked="" type="checkbox"/> APPROVED	APPROVALS ARE NOT INTENDED TO RELIEVE TENANT ARCHITECT AND/OR ENGINEER AND CONTRACTOR FROM COMPLYING WITH ALL ASPECTS OF THE LANDLORD CRITERIA, LEASE EXHIBITS, AND ALL APPLICABLE CODES. APPROVALS SHALL NOT BE CONSTRUED TO MODIFY OR NEGATE ANY TERMS OF THE LEASE.
<input type="checkbox"/> APPROVED AS NOTED	
<input type="checkbox"/> REVISE AND RESUBMIT	
<input type="checkbox"/> NOT APPROVED	
TOM EFT, TENANT COORDINATOR	
BY: Tom Eft	
DATE: 01/18/2023	

**STORE 737
SPACE 235
SOUTH HILL MALL
3500 SOUTH MERIDIAN STREET
PUYALLUP, WA 98373**

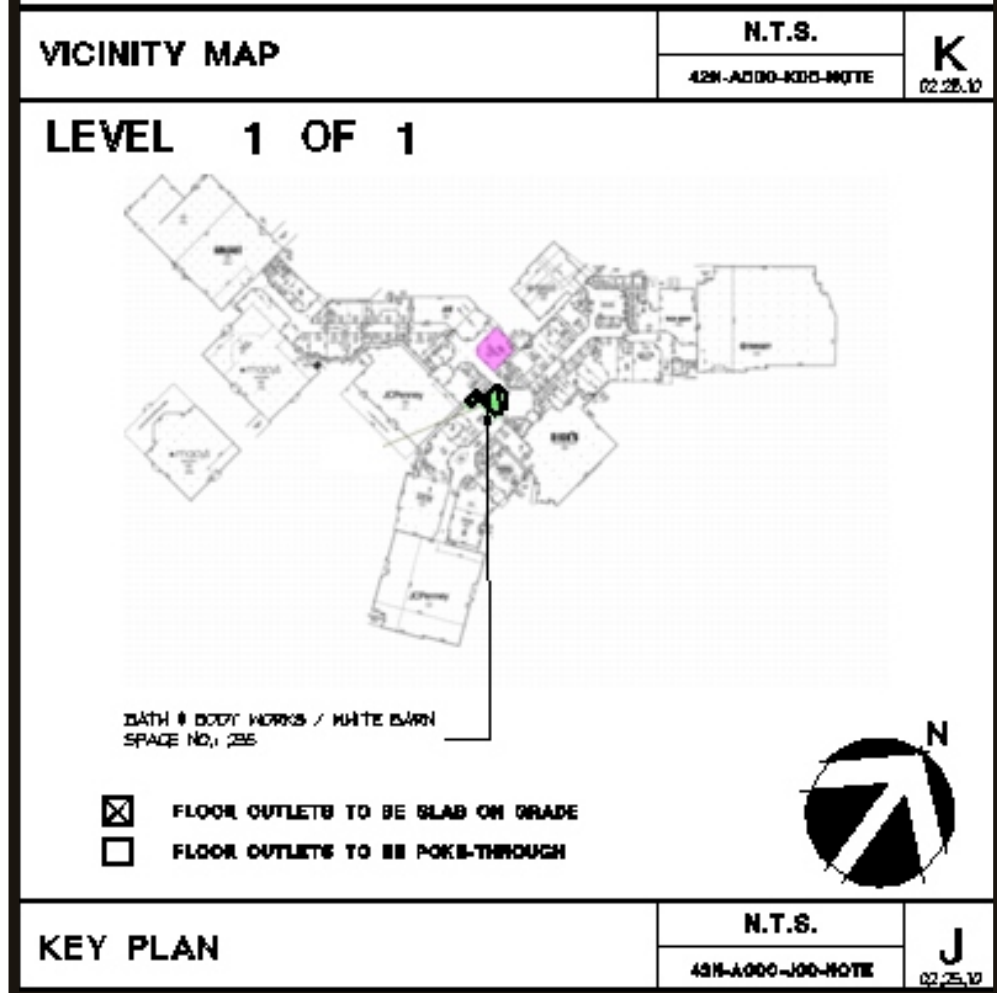

93 Industry Drive
PO Box 349
Versailles, KY 40383
859.879.1199



Bath & Body Works

STORE 737
SPACE 235

SOUTH HILL MALL
3500 SOUTH MERIDIAN STREET
PUYALLUP, WA 98373

This sign is intended to be installed in accordance with the requirements of Article 600 of the National Electrical Code and/or other applicable local codes. This includes proper grounding and bonding of the sign.

RUGGLES SIGN DOES NOT PROVIDE PRIMARY ELECTRICAL TO SIGN LOCATION!



Submittal Date: 01/10/23
Plan Issue/Rev Date: _____
Acct Rep: Ashley Abney
Designer: Jaye Williams

REVISIONS

R1: _____	R6: _____
R2: _____	R7: _____
R3: _____	R8: _____
R4: _____	R9: _____
R5: _____	R10: _____

STOREFRONT - ELEVATION

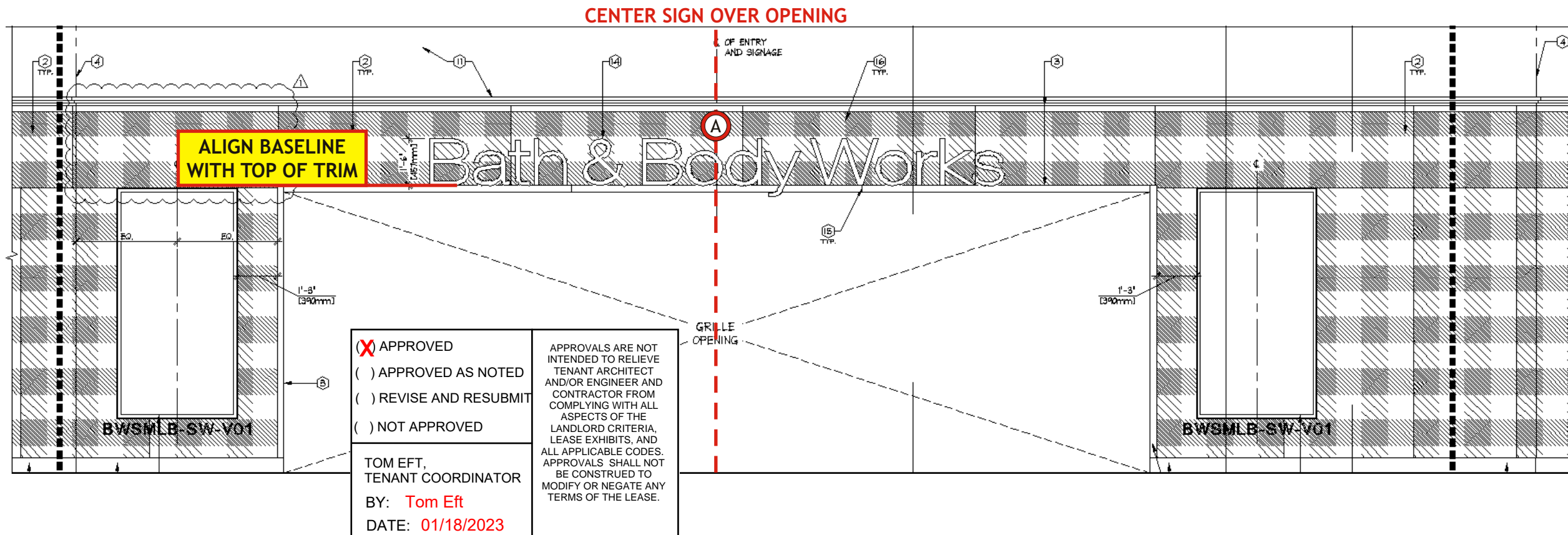
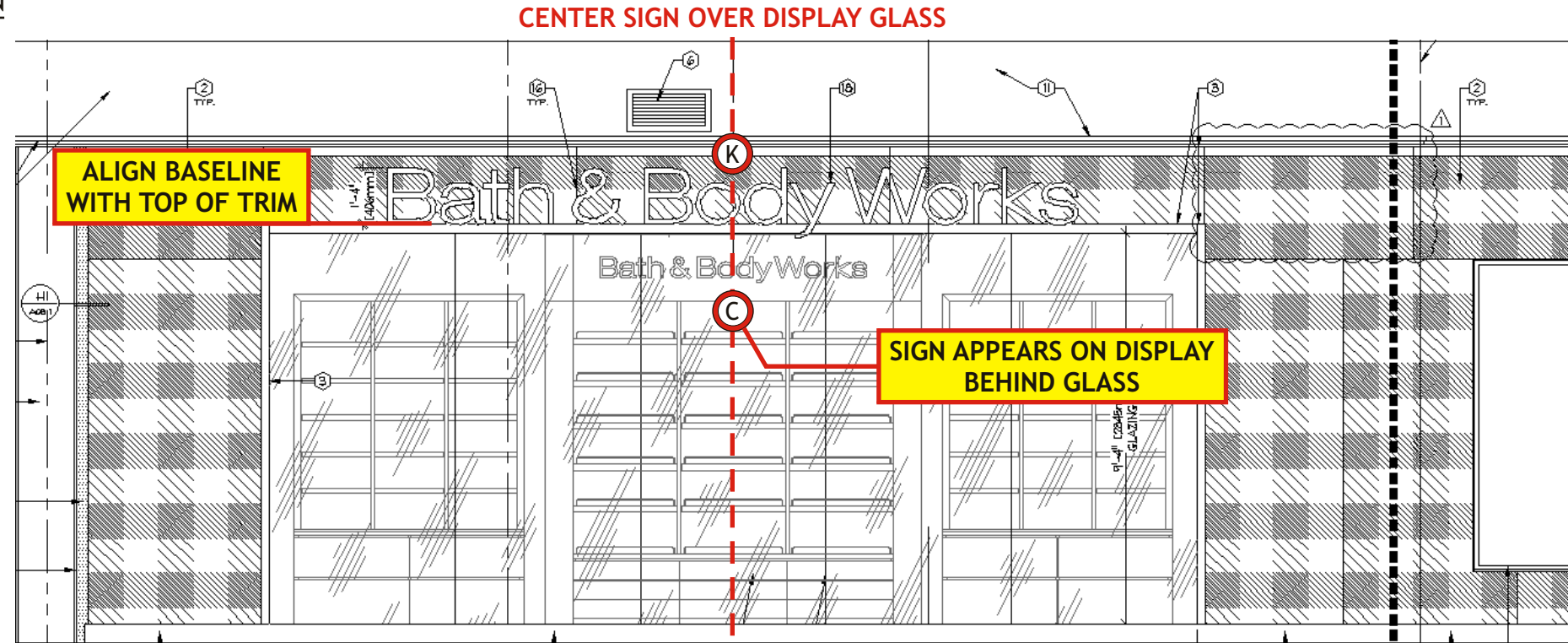

- (A) BBW18FL RPT Qty - 1
- (B) WB14.5EL RPT acrylic aged brass Qty - 1
- (C) BBW6FL acrylic gen3 Qty - 2
- (D) WB11EL RPT gold 50% Qty - 4
- (E) BBW5FL acrylic gen3 Qty - 2
- (F) BBW NS V Qty - 1
- (G) BBW WB PL18 Qty - 1
- (H) BBW SYS2.25V Qty - 1
- (I) BBW YSG7V Qty - 1
- (J) ADA AG RR PL BBW blue Qty - 1
- (K) BBW16FL RPT Qty - 2



93 Industry Drive
PO Box 349
Versailles, KY 40383
859.879.1199



Bath & Body Works

STORE 737
SPACE 235

SOUTH HILL MALL
3500 SOUTH MERIDIAN STREET
PUYALLUP, WA 98373

This sign is intended to be installed in accordance with the requirements of Article 600 of the National Electrical Code and/or other applicable local codes. This includes proper grounding and bonding of the sign.

RUGGLES SIGN DOES NOT PROVIDE PRIMARY ELECTRICAL TO SIGN LOCATION!



Submittal Date: 01/10/23
Plan Issue/Rev Date: _____
Acct Rep: Ashley Abney
Designer: Jaye Williams

REVISIONS

R1: _____ R6: _____
R2: _____ R7: _____
R3: _____ R8: _____
R4: _____ R9: _____
R5: _____ R10: _____

Bath & Body Works

STORE 737
SPACE 235

SOUTH HILL MALL
3500 SOUTH MERIDIAN STREET
PUYALLUP, WA 98373

This sign is intended to be installed in accordance with the requirements of Article 600 of the National Electrical Code and/or other applicable local codes. This includes proper grounding and bonding of the sign.

RUGGLES SIGN DOES NOT PROVIDE PRIMARY ELECTRICAL TO SIGN LOCATION!



Submittal Date: 01/10/23
Plan Issue/Rev Date: _____
Acct Rep: Ashley Abney
Designer: Jaye Williams

REVISIONS

R1: _____ R6: _____
R2: _____ R7: _____
R3: _____ R8: _____
R4: _____ R9: _____
R5: _____ R10: _____

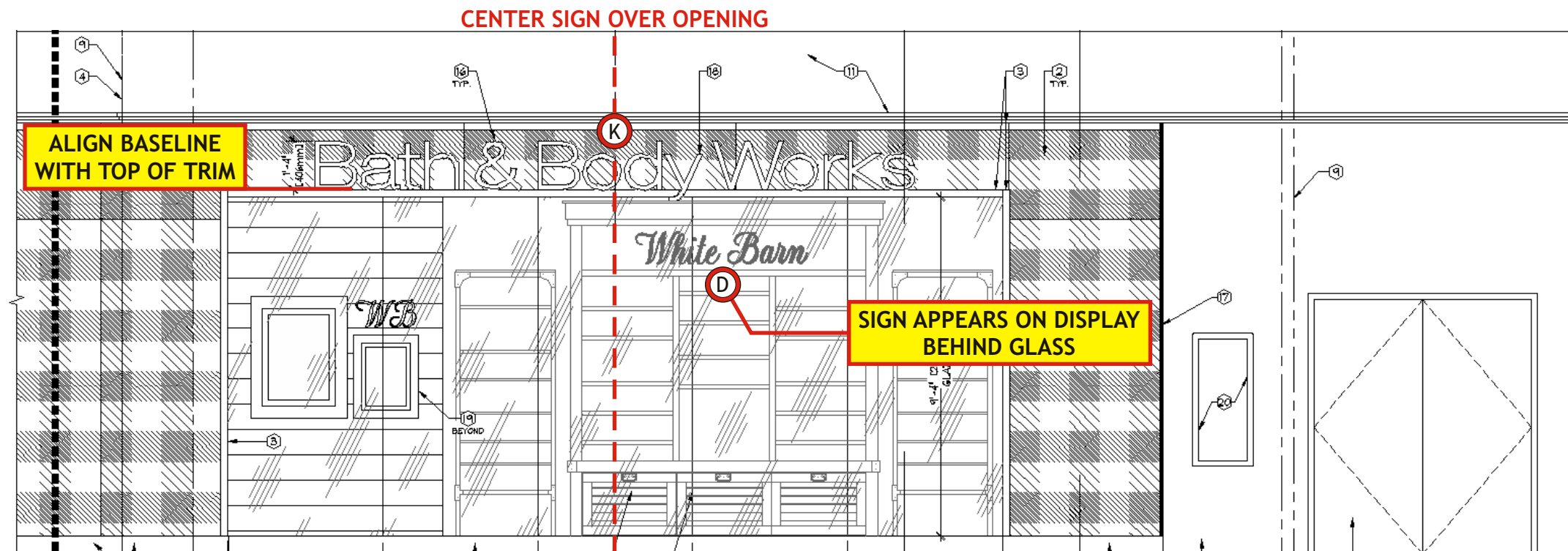

<input checked="" type="checkbox"/> APPROVED	APPROVALS ARE NOT INTENDED TO RELIEVE TENANT ARCHITECT AND/OR ENGINEER AND CONTRACTOR FROM COMPLYING WITH ALL ASPECTS OF THE LANDLORD CRITERIA, LEASE EXHIBITS, AND ALL APPLICABLE CODES. APPROVALS SHALL NOT BE CONSTRUED TO MODIFY OR NEGATE ANY TERMS OF THE LEASE.
<input type="checkbox"/> APPROVED AS NOTED	
<input type="checkbox"/> REVISE AND RESUBMIT	
<input type="checkbox"/> NOT APPROVED	
TOM EFT, TENANT COORDINATOR	
BY: Tom Eft	
DATE: 01/18/2023	

- (A) BBW18FL RPT Qty - 1
- (B) WB14.5EL RPT acrylic aged brass Qty - 1
- (C) BBW6FL acrylic gen3 Qty - 2
- (D) WB11EL RPT gold 50% Qty - 4
- (E) BBW5FL acrylic gen3 Qty - 2
- (F) BBW NS V Qty - 1
- (G) BBW WB PL18 Qty - 1
- (H) BBW SYS2.25V Qty - 1
- (I) BBW YSG7V Qty - 1
- (J) ADA AG RR PL BBW blue Qty - 1
- (K) BBW16FL RPT Qty - 2

STORE PLAN VIEW

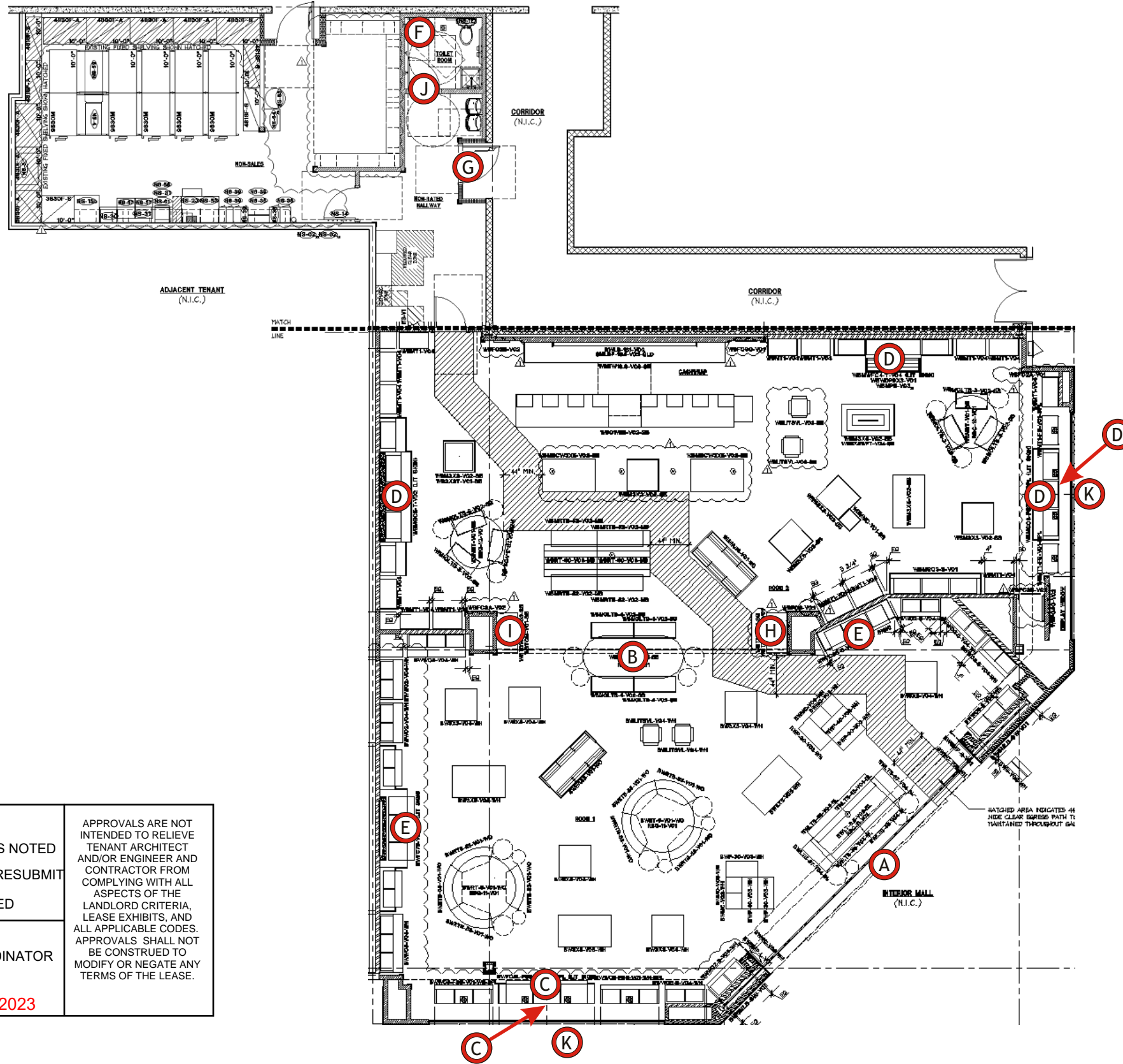

<p><input checked="" type="checkbox"/> APPROVED</p> <p><input type="checkbox"/> APPROVED AS NOTED</p> <p><input type="checkbox"/> REVISE AND RESUBMIT</p> <p><input type="checkbox"/> NOT APPROVED</p>	<p>APPROVALS ARE NOT INTENDED TO RELIEVE TENANT ARCHITECT AND/OR ENGINEER AND CONTRACTOR FROM COMPLYING WITH ALL ASPECTS OF THE LANDLORD CRITERIA, LEASE EXHIBITS, AND ALL APPLICABLE CODES. APPROVALS SHALL NOT BE CONSTRUED TO MODIFY OR NEGATE ANY TERMS OF THE LEASE.</p>
<p>TOM EFT, TENANT COORDINATOR</p> <p>BY: Tom Eft</p> <p>DATE: 01/18/2023</p>	

- (A) BBW18FL RPT Qty - 1
- (B) WB14.5EL RPT acrylic aged brass Qty - 1
- (C) BBW6FL acrylic gen3 Qty - 2
- (D) WB11EL RPT gold 50% Qty - 4
- (E) BBW5FL acrylic gen3 Qty - 2
- (F) BBW NS V Qty - 1
- (G) BBW WB PL18 Qty - 1
- (H) BBW SYS2.25V Qty - 1
- (I) BBW YSG7V Qty - 1
- (J) ADA AG RR PL BBW blue Qty - 1
- (K) BBW16FL RPT Qty - 2



93 Industry Drive
PO Box 349
Versailles, KY 40383
859.879.1199



Bath & Body Works

STORE 737
SPACE 235

SOUTH HILL MALL
3500 SOUTH MERIDIAN STREET
PUYALLUP, WA 98373

This sign is intended to be installed in accordance with the requirements of Article 600 of the National Electrical Code and/or other applicable local codes. This includes proper grounding and bonding of the sign.

RUGGLES SIGN DOES NOT PROVIDE PRIMARY ELECTRICAL TO SIGN LOCATION!



Submittal Date: 01/10/23
Plan Issue/Rev Date: _____
Acct Rep: Ashley Abney
Designer: Jaye Williams

REVISIONS

R1: _____ R6: _____
R2: _____ R7: _____
R3: _____ R8: _____
R4: _____ R9: _____
R5: _____ R10: _____

A FACE LIT CHANNEL LETTERS - ELEVATION
Scale: 1/2" = 1' - 0"

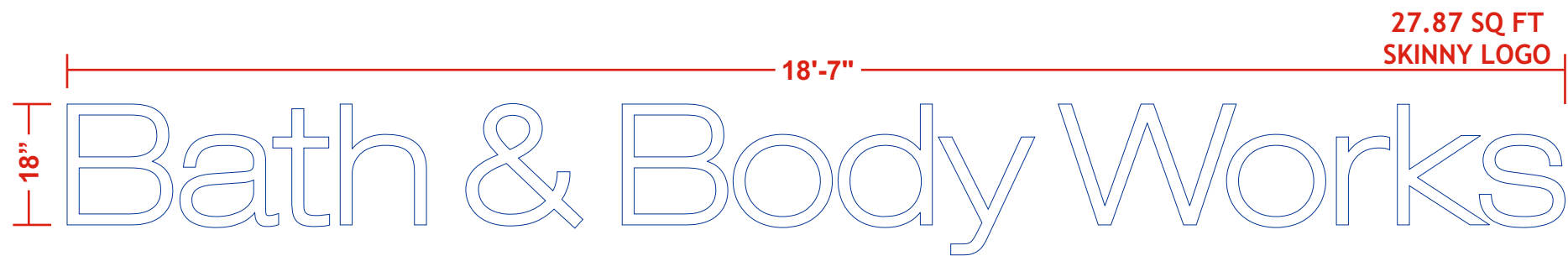

SIGN - DETAILS

- 1 1 1/2" DEEP ALUMINUM LETTERS WITH ROUTED ALUMINUM BACKS PAINTED TO MATCH SW PT-19 IT'S ALL ABOUT THE BLUE (UFN 1554796), INTERIOR SURFACES PAINTED HIGH GLOSS WHITE
- 2 LETTER RETURNS & BACKS ARE CAULKED TO ELIMINATE LIGHT LEAKS
- 3 3/8" THICK ROUTED LIGHT DIFFUSING ACRYLIC (SATIN ICE) REVERSE PUSH THRU FACE SECURED TO RETURNS WITH SET SCREW AT TOP RETURN
- 4 BITRO LITE 6500K WHITE LED UNITS TO ILLUMINATE LETTERS
- 5 BITRO ASU-60-12U LED DRIVER (120-277 VOLT) CONTAINED IN PAIGE 980054C SNAP 2 ENCLOSURE
- 6 10-24 RIVET NUT, WITH 3/16" ALL THREAD ROD, SILICONE APPLIED TO STUDS AND LETTER BACK WITH DOUBLE SIDE TAPE TO SECURE LETTER TO STOREFRONT. LETTERS TO HAVE 3/4" SPACERS PAINTED TO MATCH LETTER RETURNS

<input checked="" type="checkbox"/> APPROVED <input type="checkbox"/> APPROVED AS NOTED <input type="checkbox"/> REVISE AND RESUBMIT <input type="checkbox"/> NOT APPROVED	APPROVALS ARE NOT INTENDED TO RELIEVE TENANT ARCHITECT AND/OR ENGINEER AND CONTRACTOR FROM COMPLYING WITH ALL ASPECTS OF THE LANDLORD CRITERIA, LEASE EXHIBITS, AND ALL APPLICABLE CODES. APPROVALS SHALL NOT BE CONSTRUED TO MODIFY OR NEGATE ANY TERMS OF THE LEASE.
TOM EFT, TENANT COORDINATOR BY: Tom Eft DATE: 01/18/2023	

FACE LIT CHANNEL LETTERS - SECTION
Scale: N.T.S.

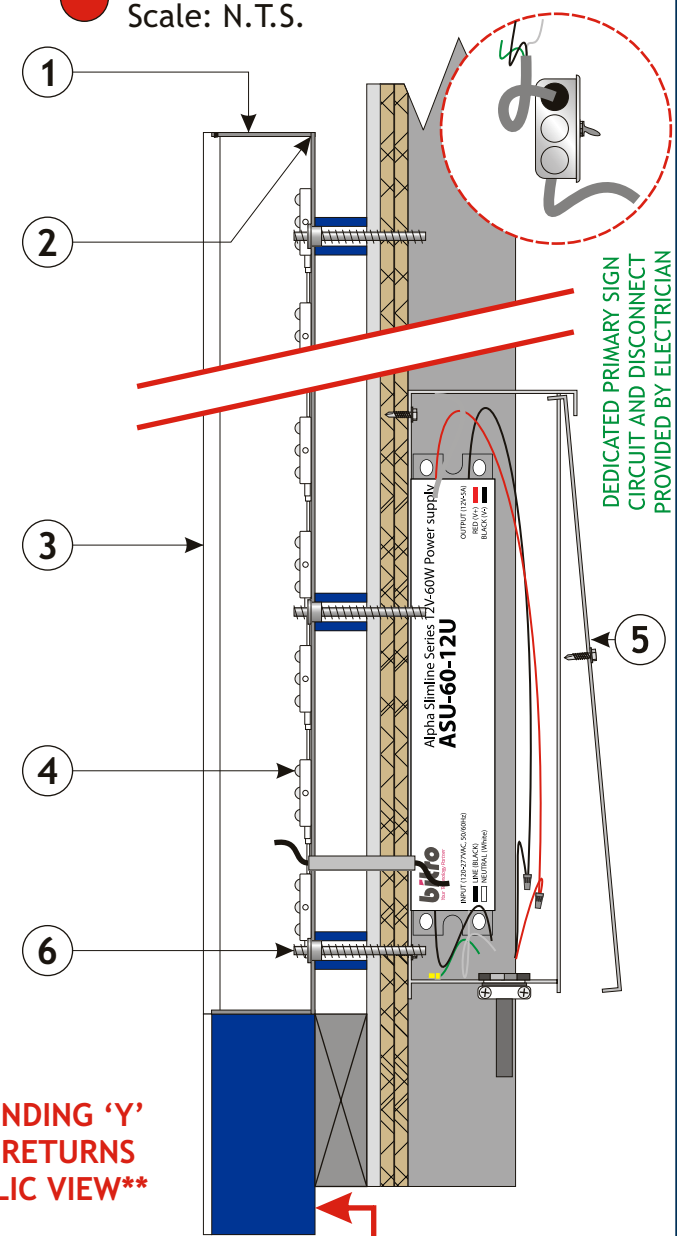

93 Industry Drive
PO Box 349
Versailles, KY 40383
859.879.1199



Bath & Body Works

STORE 737
SPACE 235

SOUTH HILL MALL
3500 SOUTH MERIDIAN STREET
PUYALLUP, WA 98373

This sign is intended to be installed in accordance with the requirements of Article 600 of the National Electrical Code and/or other applicable local codes. This includes proper grounding and bonding of the sign.

RUGGLES SIGN DOES NOT PROVIDE PRIMARY ELECTRICAL TO SIGN LOCATION!



Submittal Date: 01/10/23
Plan Issue/Rev Date: _____
Acct Rep: Ashley Abney
Designer: Jaye Williams

REVISIONS

R1: _____	R6: _____
R2: _____	R7: _____
R3: _____	R8: _____
R4: _____	R9: _____
R5: _____	R10: _____

STOREFRONT - SECTION

<input checked="" type="checkbox"/> APPROVED	APPROVALS ARE NOT INTENDED TO RELIEVE TENANT ARCHITECT AND/OR ENGINEER AND CONTRACTOR FROM COMPLYING WITH ALL ASPECTS OF THE LANDLORD CRITERIA, LEASE EXHIBITS, AND ALL APPLICABLE CODES. APPROVALS SHALL NOT BE CONSTRUED TO MODIFY OR NEGATE ANY TERMS OF THE LEASE.
<input type="checkbox"/> APPROVED AS NOTED	
<input type="checkbox"/> REVISE AND RESUBMIT	
<input type="checkbox"/> NOT APPROVED	
TOM EFT, TENANT COORDINATOR	
BY: Tom Eft	
DATE: 01/18/2023	

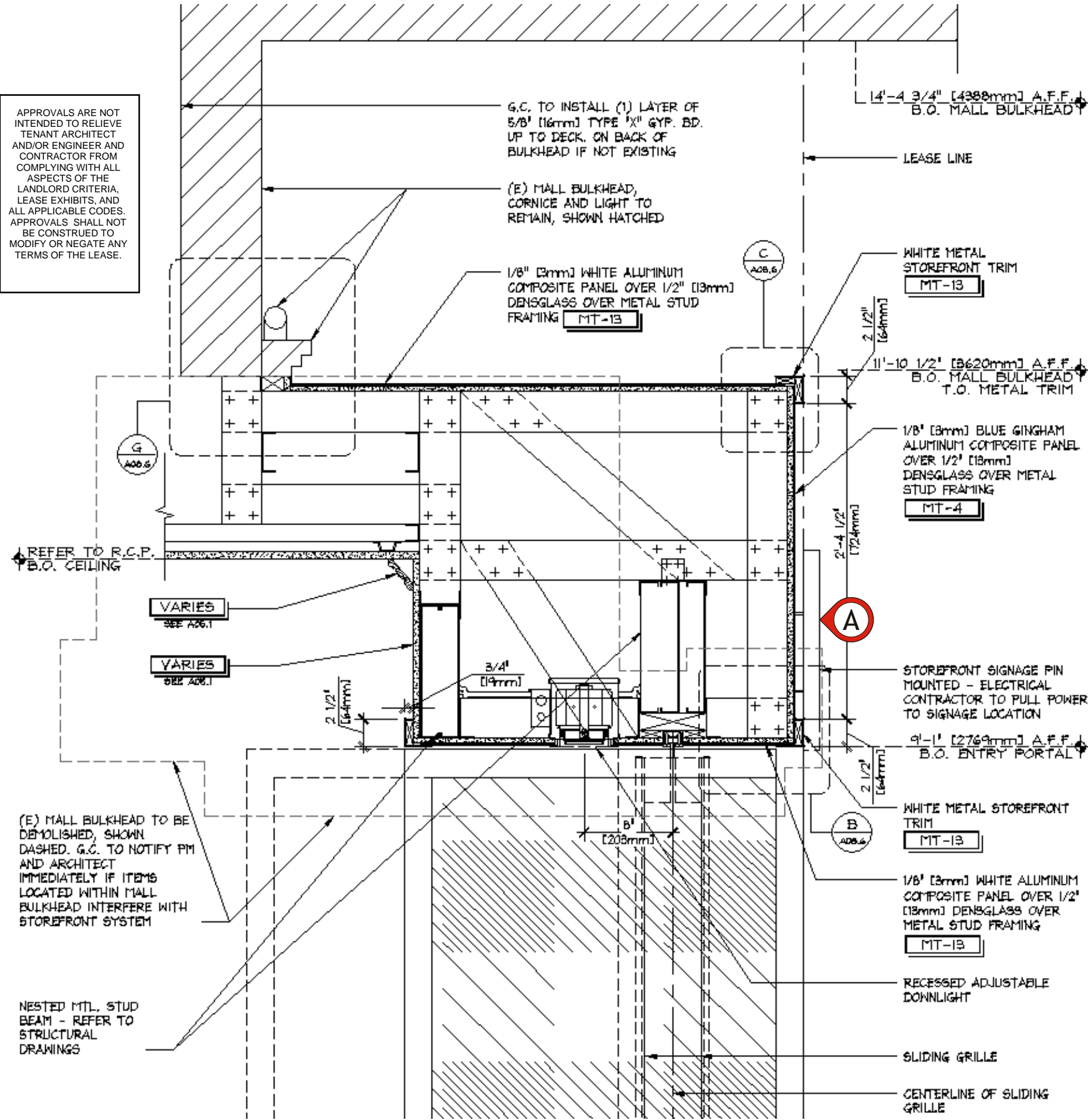

93 Industry Drive
PO Box 349
Versailles, KY 40383
859.879.1199



Bath & Body Works

STORE 737
SPACE 235

SOUTH HILL MALL
3500 SOUTH MERIDIAN STREET
PUYALLUP, WA 98373

This sign is intended to be installed in accordance with the requirements of Article 600 of the National Electrical Code and/or other applicable local codes. This includes proper grounding and bonding of the sign.

RUGGLES SIGN DOES NOT PROVIDE PRIMARY ELECTRICAL TO SIGN LOCATION!



Submittal Date: 01/10/23
Plan Issue/Rev Date: _____
Acct Rep: Ashley Abney
Designer: Jaye Williams

REVISIONS

R1: _____	R6: _____
R2: _____	R7: _____
R3: _____	R8: _____
R4: _____	R9: _____
R5: _____	R10: _____

B EDGE LIT - ILLUM CHANNEL LETTERS - ELEVATION
Scale: 1" = 1' - 0"



SIGN - DETAILS

- 1 1" DEEP BLACK ACRYLIC LETTERS PAINTED TO MATCH AGED BRASS FINISH ON EXTERIOR SURFACES, INTERIOR SURFACES PAINTED HIGH GLOSS WHITE
- 2 3/4" THICK ROUTED ACRYLIC REVERSE PUSH THRU BACKS WITH 3/8" EXPOSED (FROSTED EDGES), MATTE WHITE VINYL APPLIED TO BACK OF ACRYLIC, BACKS SECURED WITH 2-56 SCREW
- 3 BITRO TITO 4100K WHITE LED UNITS TO ILLUMINATE LETTERS.
- 4 HEYCO GROMMET PASS-THRU TO BITRO ASU-60-12U LED DRIVER (120-277 VOLT) CONTAINED IN PAIGE 980054C SNAP 2 ENCLOSURE
- 5 LETTERS SECURED WITH LAG BOLTS THROUGH LETTER BACKS INTO BLOCKING

<input checked="" type="checkbox"/> APPROVED	APPROVALS ARE NOT INTENDED TO RELIEVE TENANT ARCHITECT AND/OR ENGINEER AND CONTRACTOR FROM COMPLYING WITH ALL ASPECTS OF THE LANDLORD CRITERIA, LEASE EXHIBITS, AND ALL APPLICABLE CODES. APPROVALS SHALL NOT BE CONSTRUED TO MODIFY OR NEGATE ANY TERMS OF THE LEASE.
<input type="checkbox"/> APPROVED AS NOTED	
<input type="checkbox"/> REVISE AND RESUBMIT	
<input type="checkbox"/> NOT APPROVED	
TOM EFT, TENANT COORDINATOR	
BY: Tom Eft	
DATE: 01/18/2023	

INSTALL - DETAILS

SIGN CENTERED HORIZONTALLY OVER OPENING

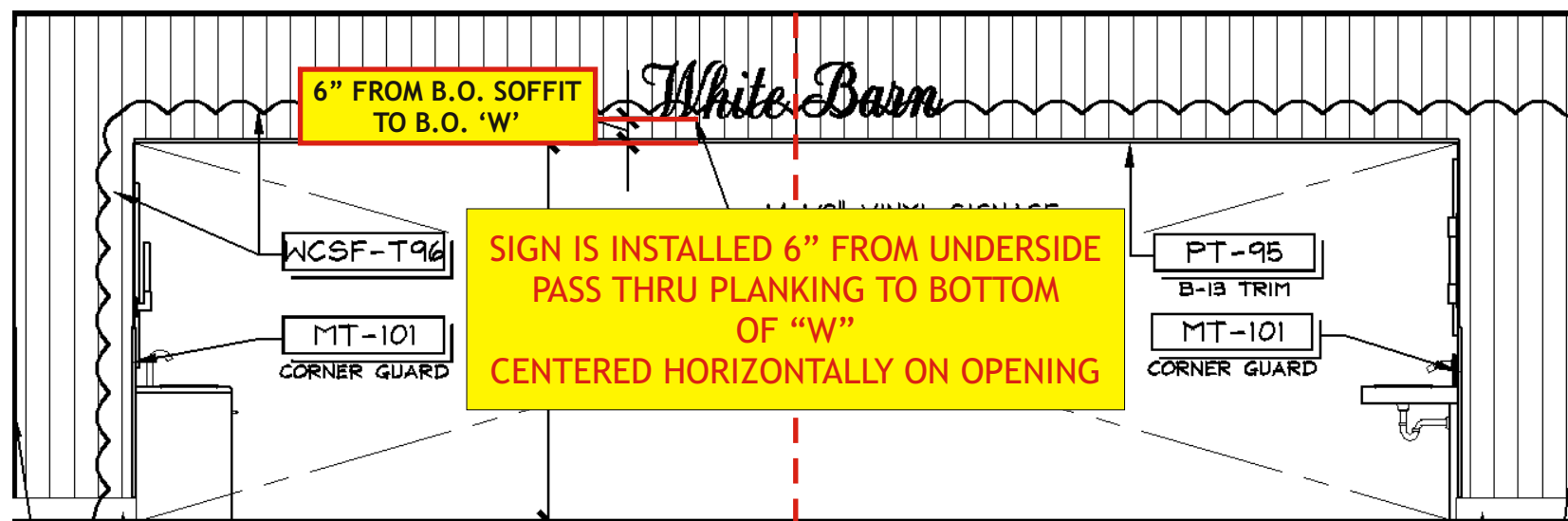

EDGE-LIT - ILLUM CHANNEL LETTERS - SECTION
Scale: N.T.S.

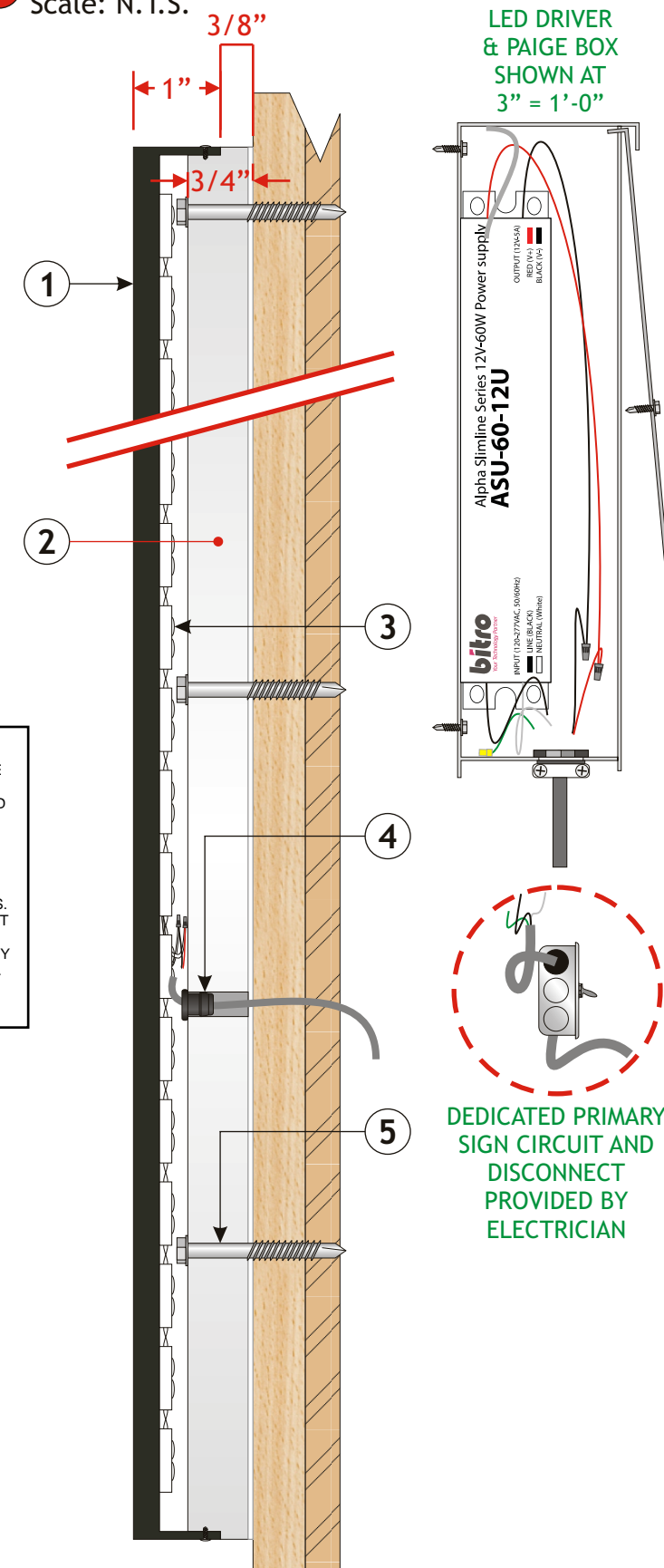

93 Industry Drive
PO Box 349
Versailles, KY 40383
859.879.1199



Bath & Body Works

STORE 737
SPACE 235

SOUTH HILL MALL
3500 SOUTH MERIDIAN STREET
PUYALLUP, WA 98373

This sign is intended to be installed in accordance with the requirements of Article 600 of the National Electrical Code and/or other applicable local codes. This includes proper grounding and bonding of the sign.

RUGGLES SIGN DOES NOT PROVIDE PRIMARY ELECTRICAL TO SIGN LOCATION!



Submittal Date: 01/10/23
Plan Issue/Rev Date: _____
Acct Rep: Ashley Abney
Designer: Jaye Williams

REVISIONS

R1: _____	R6: _____
R2: _____	R7: _____
R3: _____	R8: _____
R4: _____	R9: _____
R5: _____	R10: _____

C FACE LIT CHANNEL LETTERS - ELEVATION
Scale: 1 1/2" = 1' - 0"

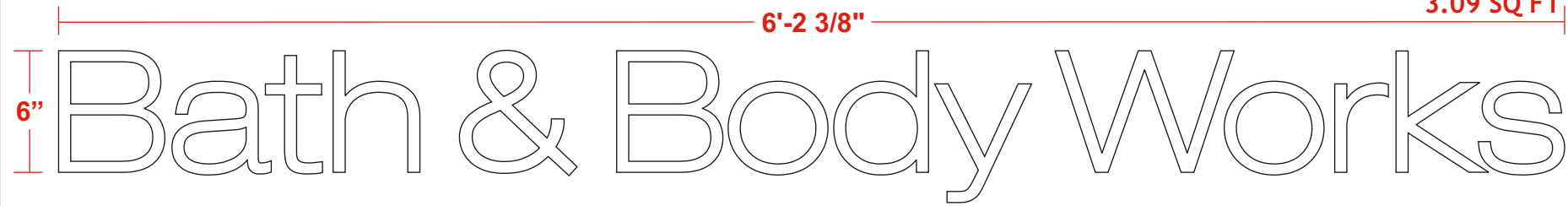

- APPROVED
- APPROVED AS NOTED
- REVISE AND RESUBMIT
- NOT APPROVED

TOM EFT,
TENANT COORDINATOR
BY: Tom Eft
DATE: 01/18/2023

APPROVALS ARE NOT INTENDED TO RELIEVE TENANT ARCHITECT AND/OR ENGINEER AND CONTRACTOR FROM COMPLYING WITH ALL ASPECTS OF THE LANDLORD CRITERIA, LEASE EXHIBITS, AND ALL APPLICABLE CODES. APPROVALS SHALL NOT BE CONSTRUED TO MODIFY OR NEGATE ANY TERMS OF THE LEASE.



93 Industry Drive
PO Box 349
Versailles, KY 40383
859.879.1199



SIGN - DETAILS

- 1 1 1/8" DEEP ACRYLIC LETTERS WITH ROUTED ALUMINUM BACKS PAINTED TO MATCH SW 7006 EXTRA WHITE ON RETURNS
- 2 TRANSLUCENT FACE
- 3 REMOVABLE ALUMINUM BACK
- 4 BITRO 8100K WHITE LED BOARD GLUED TO LETTER BACK
- 5 BITRO ASU-60-12U LED DRIVER (120-277 VOLT) CONTAINED IN PAIGE 980054C SNAP 2 ENCLOSURE
- 6 LETTERS MOUNT FLUSH TO WALL WITH 10-24 RIVET NUT WITH 3/16 ALL THREAD ROD AND SILICONE
- 7 PLUG-IN CORD FOR CHANEL LETTERS

INSTALL - DETAILS

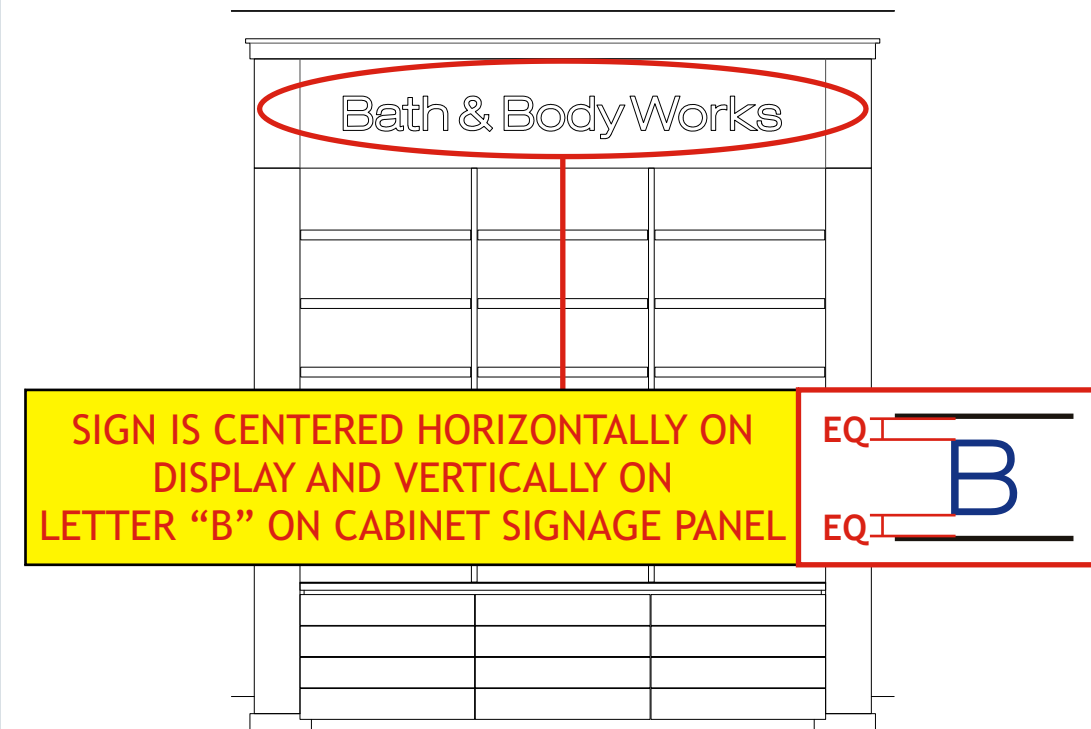

FACE LIT CHANNEL LETTERS - SECTION
Scale: N.T.S.

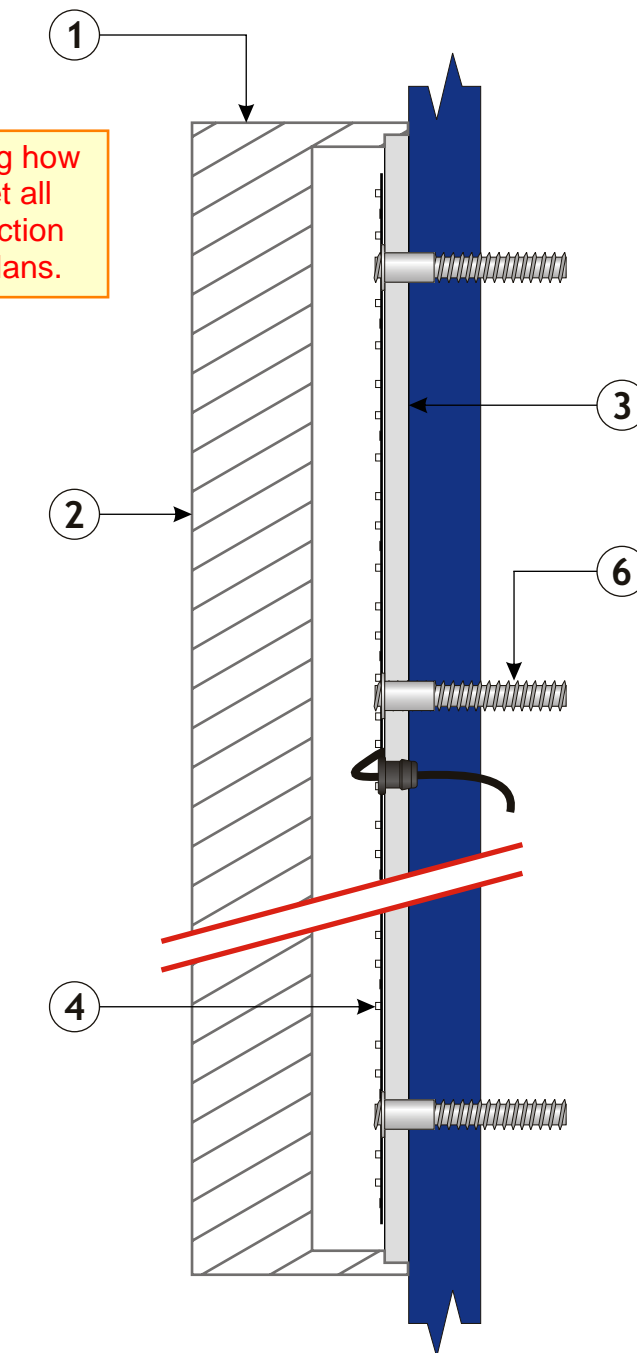

Must provide information showing how the signs located in the mall meet all the requirements of 2018 IBC section 402.6.4. Note on page 8 of the plans.

PAIGE BOX - SECTION
Scale: 3" = 1' - 0"

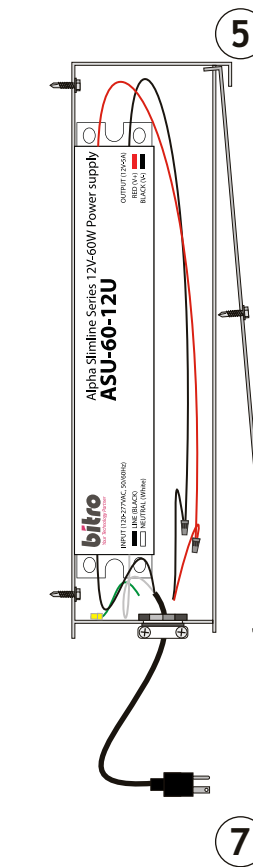

DEDICATED PRIMARY SIGN CIRCUIT AND DISCONNECT PROVIDED BY ELECTRICIAN

Bath & Body Works

STORE 737
SPACE 235

SOUTH HILL MALL
3500 SOUTH MERIDIAN STREET
PUYALLUP, WA 98373

This sign is intended to be installed in accordance with the requirements of Article 600 of the National Electrical Code and/or other applicable local codes. This includes proper grounding and bonding of the sign.

RUGGLES SIGN DOES NOT PROVIDE PRIMARY ELECTRICAL TO SIGN LOCATION!



Submittal Date: 01/10/23
Plan Issue/Rev Date: _____
Acct Rep: Ashley Abney
Designer: Jaye Williams

REVISIONS

R1: _____	R6: _____
R2: _____	R7: _____
R3: _____	R8: _____
R4: _____	R9: _____
R5: _____	R10: _____

BBW6FL acrylic gen3



93 Industry Drive
 PO Box 349
 Versailles, KY 40383
 859.879.1199



Bath & Body Works

STORE 737
 SPACE 235

SOUTH HILL MALL
 3500 SOUTH MERIDIAN STREET
 PUYALLUP, WA 98373

This sign is intended to be installed in accordance with the requirements of Article 600 of the National Electrical Code and/or other applicable local codes. This includes proper grounding and bonding of the sign.

RUGGLES SIGN DOES NOT PROVIDE PRIMARY ELECTRICAL TO SIGN LOCATION!



Submittal Date: 01/10/23
 Plan Issue/Rev Date: _____
 Acct Rep: Ashley Abney
 Designer: Jaye Williams

REVISIONS

R1: _____ R6: _____
 R2: _____ R7: _____
 R3: _____ R8: _____
 R4: _____ R9: _____
 R5: _____ R10: _____

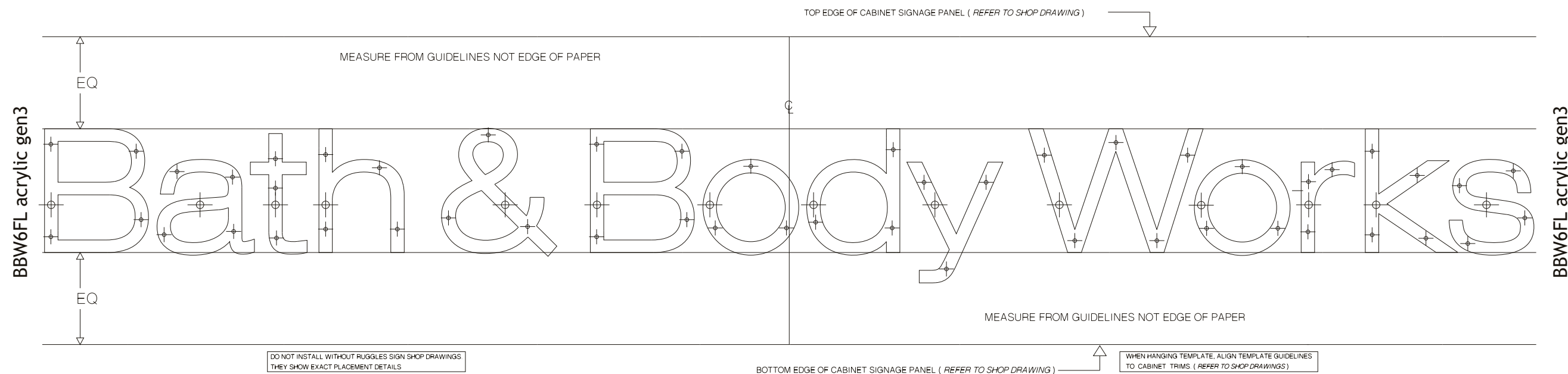

Need to more clearly depict the spacing and actual location of all mounting anchors so the inspectors know exactly what they are looking at on site and for review. Note on page 9 of the plans.

<input checked="" type="checkbox"/> APPROVED	APPROVALS ARE NOT INTENDED TO RELIEVE TENANT ARCHITECT AND/OR ENGINEER AND CONTRACTOR FROM COMPLYING WITH ALL ASPECTS OF THE LANDLORD CRITERIA, LEASE EXHIBITS, AND ALL APPLICABLE CODES. APPROVALS SHALL NOT BE CONSTRUED TO MODIFY OR NEGATE ANY TERMS OF THE LEASE.
<input type="checkbox"/> APPROVED AS NOTED	
<input type="checkbox"/> REVISE AND RESUBMIT	
<input type="checkbox"/> NOT APPROVED	
TOM EFT, TENANT COORDINATOR	
BY: Tom Eft	
DATE: 01/18/2023	

D EDGE LIT - ILLUM CHANNEL LETTERS - ELEVATION
Scale: 1 1/2" = 1' - 0"



4.49 SQ FT
14.5lb

SIGN - DETAILS

- 1 1" DEEP METAL LETTERS RETURNS AND FACES PAINTED HIGHLIGHTED MP TUCSON/DE BEERS GOLD WITH BLACK ADDED AND BLACK DISTRESSED EDGES ON EXTERIOR SURFACES, INTERIOR SURFACES PAINTED HIGH GLOSS WHITE
- 2 3/4" THICK ROUTED ACRYLIC REVERSE PUSH THRU BACKS WITH 3/8" EXPOSED (FROSTED EDGES), MATTE WHITE VINYL APPLIED TO FRONT AND BACK SIDE OF ACRYLIC, BACKS SECURED WITH 2-56 SCREW
- 3 BITRO TITO 4100K WHITE LED UNITS TO ILLUMINATE LETTERS
- 4 HEYCO GROMMET PASS-THRU TO BITRO ASU-60-12U LED DRIVER (120-277 VOLT) CONTAINED IN PAIGE 980054C SNAP 2 ENCLOSURE WITH WALL PLUG-IN CORD FOR LETTERS
- 5 LETTERS SECURED WITH LAG BOLTS THROUGH LETTER BACKS INTO BLOCKING

<input checked="" type="checkbox"/> APPROVED	APPROVALS ARE NOT INTENDED TO RELIEVE TENANT ARCHITECT AND/OR ENGINEER AND CONTRACTOR FROM COMPLYING WITH ALL ASPECTS OF THE LANDLORD CRITERIA, LEASE EXHIBITS, AND ALL APPLICABLE CODES. APPROVALS SHALL NOT BE CONSTRUED TO MODIFY OR NEGATE ANY TERMS OF THE LEASE.
<input type="checkbox"/> APPROVED AS NOTED	
<input type="checkbox"/> REVISE AND RESUBMIT	
<input type="checkbox"/> NOT APPROVED	
TOM EFT, TENANT COORDINATOR BY: Tom Eft DATE: 01/18/2023	

INSTALL - DETAILS

SIGN APPEARS ON
MULTIPLE ELEVATIONS
QTY 2



EDGE-LIT - ILLUM CHANNEL LETTERS - SECTION
Scale: N.T.S.

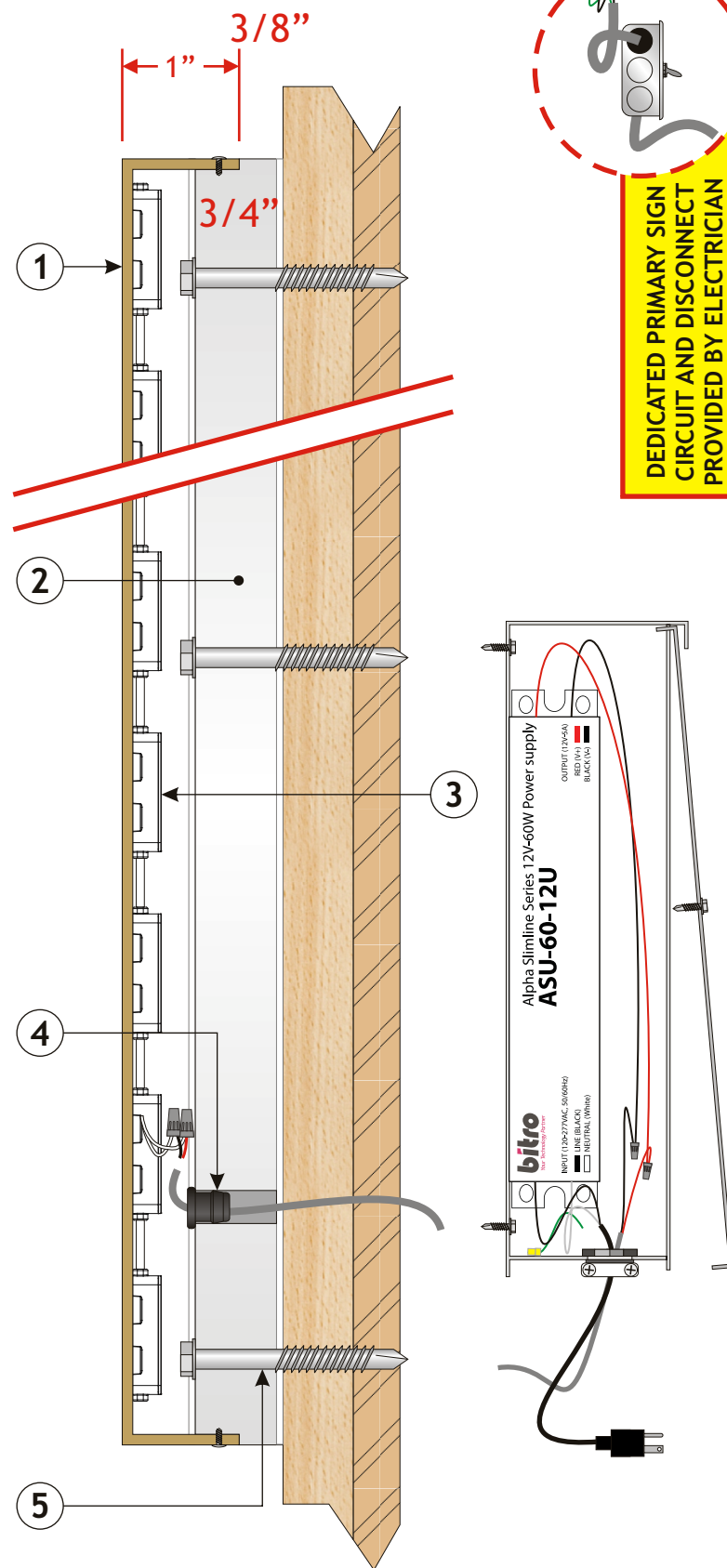

93 Industry Drive
PO Box 349
Versailles, KY 40383
859.879.1199



Bath & Body Works

STORE 737
SPACE 235

SOUTH HILL MALL
3500 SOUTH MERIDIAN STREET
PUYALLUP, WA 98373

This sign is intended to be installed in accordance with the requirements of Article 600 of the National Electrical Code and/or other applicable local codes. This includes proper grounding and bonding of the sign.

RUGGLES SIGN DOES NOT PROVIDE PRIMARY ELECTRICAL TO SIGN LOCATION!



Submittal Date: 01/10/23
Plan Issue/Rev Date: _____
Acct Rep: Ashley Abney
Designer: Jaye Williams

REVISIONS

R1: _____	R6: _____
R2: _____	R7: _____
R3: _____	R8: _____
R4: _____	R9: _____
R5: _____	R10: _____



93 Industry Drive
 PO Box 349
 Versailles, KY 40383
 859.879.1199



Bath & Body Works

STORE 737
 SPACE 235

SOUTH HILL MALL
 3500 SOUTH MERIDIAN STREET
 PUYALLUP, WA 98373

This sign is intended to be installed in accordance with the requirements of Article 600 of the National Electrical Code and/or other applicable local codes. This includes proper grounding and bonding of the sign.

RUGGLES SIGN DOES NOT PROVIDE PRIMARY ELECTRICAL TO SIGN LOCATION!



Submittal Date: 01/10/23
 Plan Issue/Rev Date: _____
 Acct Rep: Ashley Abney
 Designer: Jaye Williams

REVISIONS

R1: _____ R6: _____
 R2: _____ R7: _____
 R3: _____ R8: _____
 R4: _____ R9: _____
 R5: _____ R10: _____

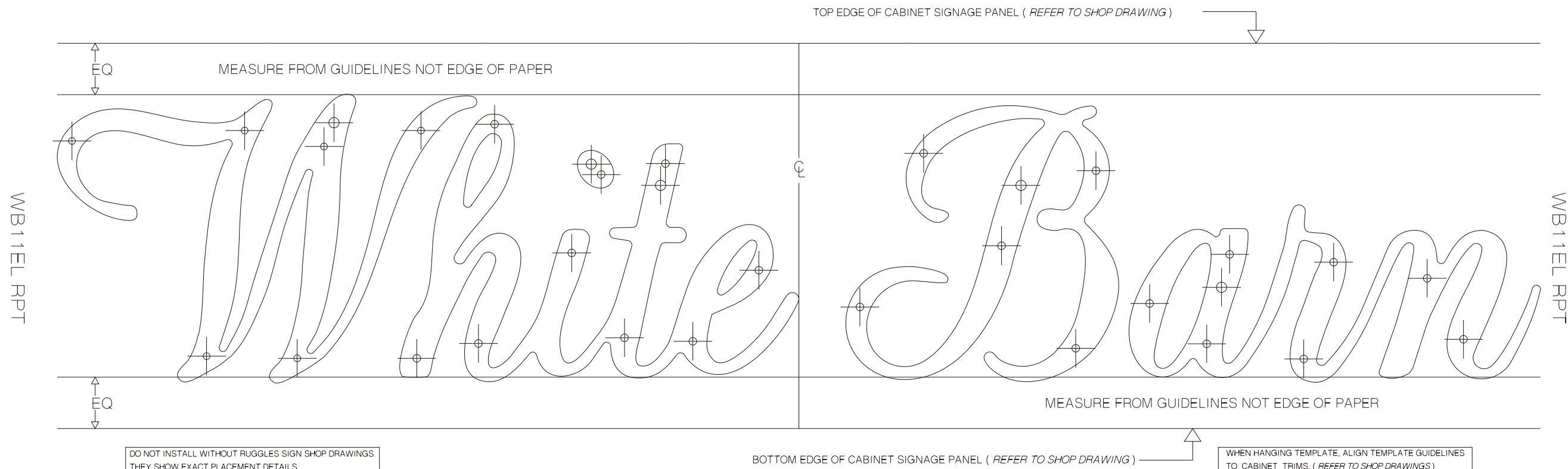

DO NOT INSTALL WITHOUT RUGGLES SIGN SHOP DRAWINGS. THEY SHOW EXACT PLACEMENT DETAILS.

BOTTOM EDGE OF CABINET SIGNAGE PANEL (REFER TO SHOP DRAWING)

WHEN HANGING TEMPLATE, ALIGN TEMPLATE GUIDELINES TO CABINET TRIMS (REFER TO SHOP DRAWINGS)

<input checked="" type="checkbox"/> APPROVED	APPROVALS ARE NOT INTENDED TO RELIEVE TENANT ARCHITECT AND/OR ENGINEER AND CONTRACTOR FROM COMPLYING WITH ALL ASPECTS OF THE LANDLORD CRITERIA, LEASE EXHIBITS, AND ALL APPLICABLE CODES. APPROVALS SHALL NOT BE CONSTRUED TO MODIFY OR NEGATE ANY TERMS OF THE LEASE.
<input type="checkbox"/> APPROVED AS NOTED	
<input type="checkbox"/> REVISE AND RESUBMIT	
<input type="checkbox"/> NOT APPROVED	
TOM EFT, TENANT COORDINATOR	
BY: Tom Eft	
DATE: 01/18/2023	

E FACE LIT CHANNEL LETTERS - ELEVATION
Scale: 1 1/2" = 1' - 0"

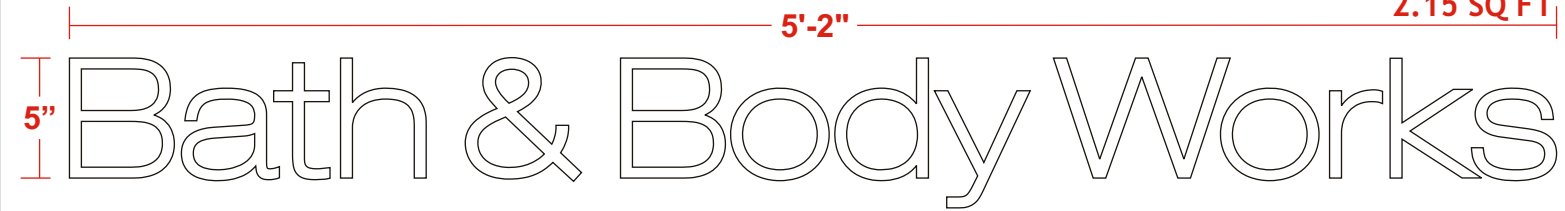

SIGN - DETAILS

- 1 1 1/8" DEEP ACRYLIC LETTERS WITH ROUTED ALUMINUM BACKS PAINTED TO MATCH SW 7006 EXTRA WHITE ON RETURNS
- 2 TRANSLUCENT FACE
- 3 REMOVABLE ALUMINUM BACK SECURED TO RETURNS WITH ADHESIVE
- 4 BITRO 8100K WHITE LED BOARD GLUED TO LETTER BACK
- 5 BITRO ASU-60-12U LED DRIVER (120-277 VOLT) CONTAINED IN PAIGE 980054C SNAP 2 ENCLOSURE
- 6 LETTERS MOUNT FLUSH TO WALL WITH 10-24 RIVET NUT WITH 3/16 ALL THREAD ROD AND SILICONE
- 7 PLUG-IN CORD FOR CHANEL LETTERS

INSTALL - DETAILS

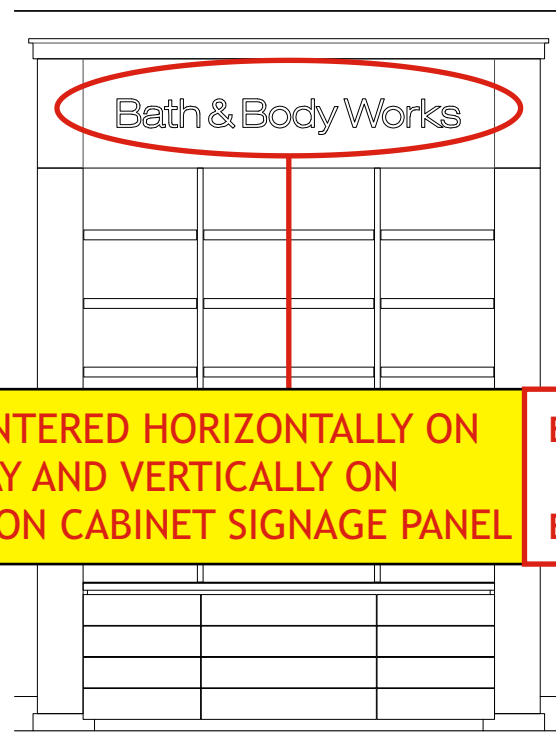

SIGN IS CENTERED HORIZONTALLY ON DISPLAY AND VERTICALLY ON LETTER "B" ON CABINET SIGNAGE PANEL

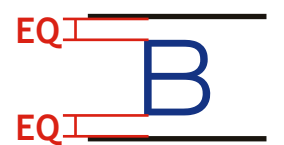

**SKINNY LOGO
2.15 SQ FT**

FACE LIT CHANNEL LETTERS - SECTION
Scale: N.T.S.

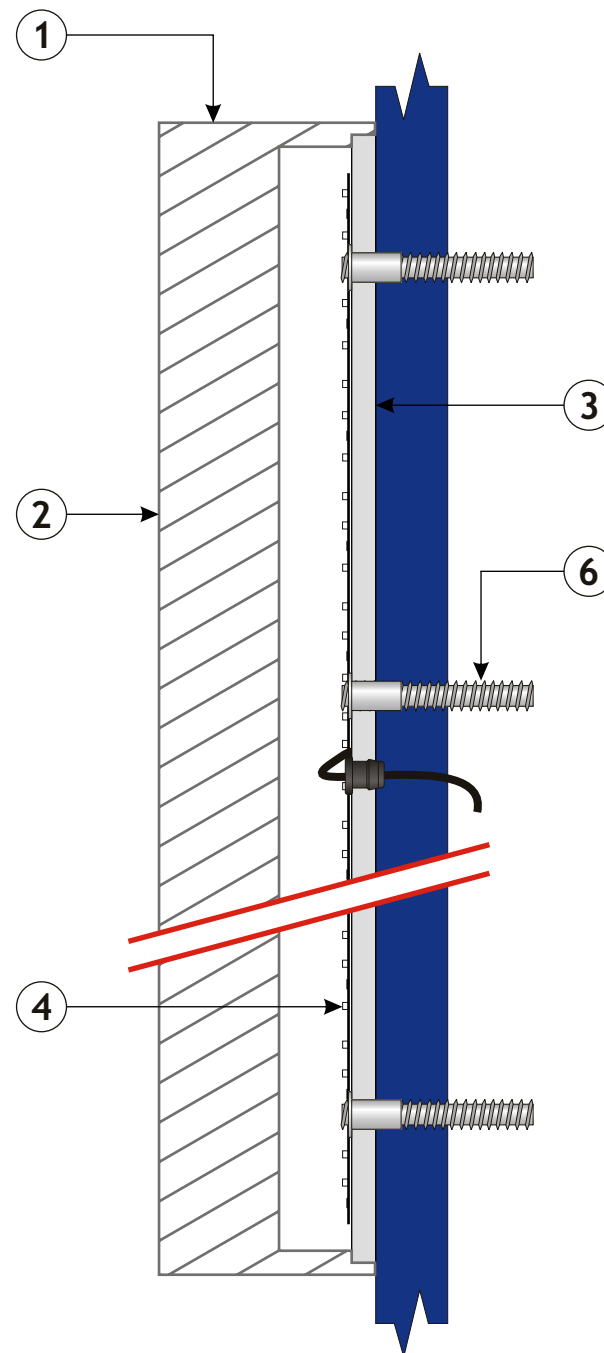

PAIGE BOX - SECTION
Scale: 3" = 1' - 0"

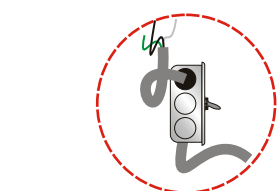
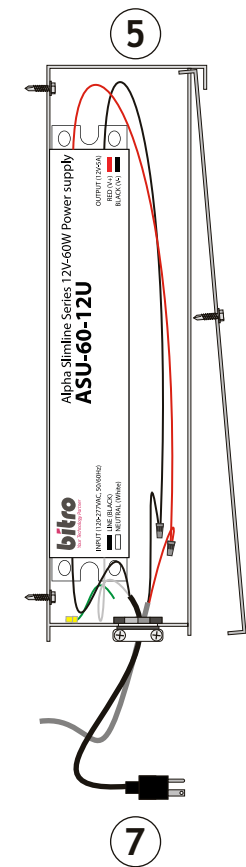

DEDICATED PRIMARY SIGN CIRCUIT AND DISCONNECT PROVIDED BY ELECTRICIAN

<input checked="" type="checkbox"/> APPROVED
<input type="checkbox"/> APPROVED AS NOTED
<input type="checkbox"/> REVISE AND RESUBMIT
<input type="checkbox"/> NOT APPROVED
TOM EFT, TENANT COORDINATOR
BY: Tom Eft
DATE: 01/18/2023

APPROVALS ARE NOT INTENDED TO RELIEVE TENANT ARCHITECT AND/OR ENGINEER AND CONTRACTOR FROM COMPLYING WITH ALL ASPECTS OF THE LANDLORD CRITERIA, LEASE EXHIBITS, AND ALL APPLICABLE CODES. APPROVALS SHALL NOT BE CONSTRUED TO MODIFY OR NEGATE ANY TERMS OF THE LEASE.



93 Industry Drive
PO Box 349
Versailles, KY 40383
859.879.1199



Bath & Body Works

**STORE 737
SPACE 235**

SOUTH HILL MALL
3500 SOUTH MERIDIAN STREET
PUYALLUP, WA 98373

This sign is intended to be installed in accordance with the requirements of Article 600 of the National Electrical Code and/or other applicable local codes. This includes proper grounding and bonding of the sign.

RUGGLES SIGN DOES NOT PROVIDE PRIMARY ELECTRICAL TO SIGN LOCATION!



Submittal Date: 01/10/23
Plan Issue/Rev Date: _____
Acct Rep: Ashley Abney
Designer: Jaye Williams

REVISIONS

R1: _____	R6: _____
R2: _____	R7: _____
R3: _____	R8: _____
R4: _____	R9: _____
R5: _____	R10: _____

BBW5FL acrylic gen3



93 Industry Drive
 PO Box 349
 Versailles, KY 40383
 859.879.1199



Bath & Body Works

STORE 737
 SPACE 235

SOUTH HILL MALL
 3500 SOUTH MERIDIAN STREET
 PUYALLUP, WA 98373

This sign is intended to be installed in accordance with the requirements of Article 600 of the National Electrical Code and/or other applicable local codes. This includes proper grounding and bonding of the sign.

RUGGLES SIGN DOES NOT PROVIDE PRIMARY ELECTRICAL TO SIGN LOCATION!



Submittal Date: 01/10/23
 Plan Issue/Rev Date: _____
 Acct Rep: Ashley Abney
 Designer: Jaye Williams

REVISIONS

R1: _____ R6: _____
 R2: _____ R7: _____
 R3: _____ R8: _____
 R4: _____ R9: _____
 R5: _____ R10: _____

TOP EDGE OF CABINET SIGNAGE PANEL (REFER TO SHOP DRAWING)

MEASURE FROM GUIDELINES NOT EDGE OF PAPER

EQ

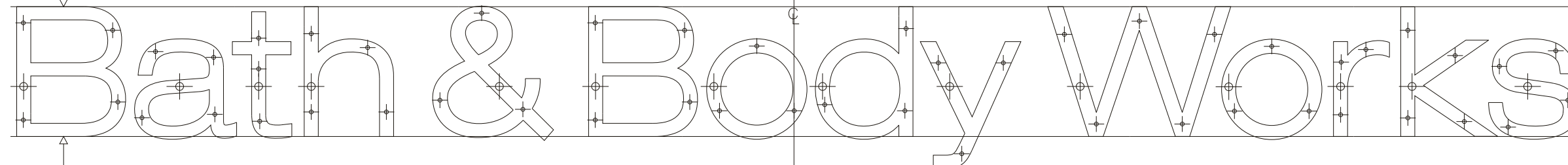

EQ

MEASURE FROM GUIDELINES NOT EDGE OF PAPER

BOTTOM EDGE OF CABINET SIGNAGE PANEL (REFER TO SHOP DRAWING)

WHEN HANGING TEMPLATE, ALIGN TEMPLATE GUIDELINES TO CABINET TRIMS (REFER TO SHOP DRAWINGS)

DO NOT INSTALL WITHOUT RUGGLES SIGN SHOP DRAWINGS THEY SHOW EXACT PLACEMENT DETAILS

BBW5FL acrylic gen3

BBW5FL acrylic gen3

APPROVED
 APPROVED AS NOTED
 REVISE AND RESUBMIT
 NOT APPROVED

TOM EFT,
 TENANT COORDINATOR
 BY: **Tom Eft**
 DATE: **01/18/2023**

APPROVALS ARE NOT INTENDED TO RELIEVE TENANT ARCHITECT AND/OR ENGINEER AND CONTRACTOR FROM COMPLYING WITH ALL ASPECTS OF THE LANDLORD CRITERIA, LEASE EXHIBITS, AND ALL APPLICABLE CODES. APPROVALS SHALL NOT BE CONSTRUED TO MODIFY OR NEGATE ANY TERMS OF THE LEASE.

F VINYL - ELEVATION
Scale: 2" = 1' - 0"

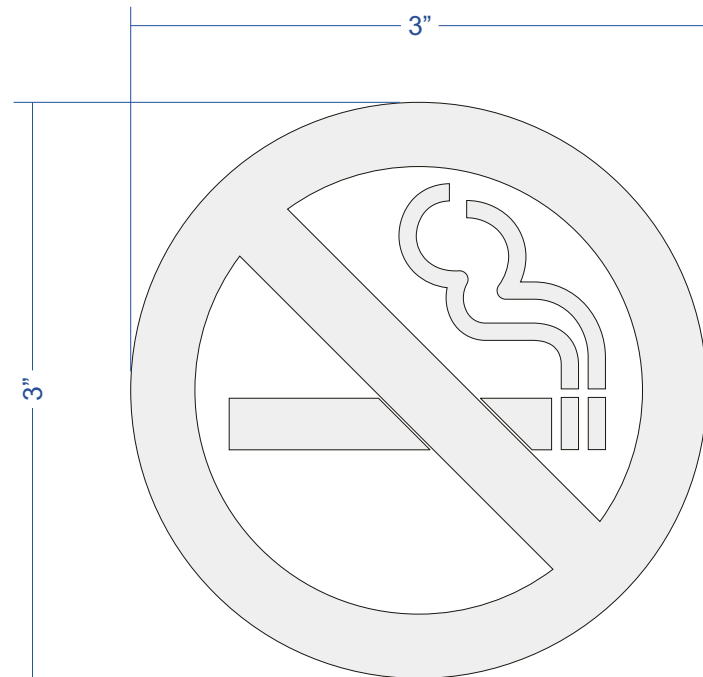

INSTALL - DETAILS

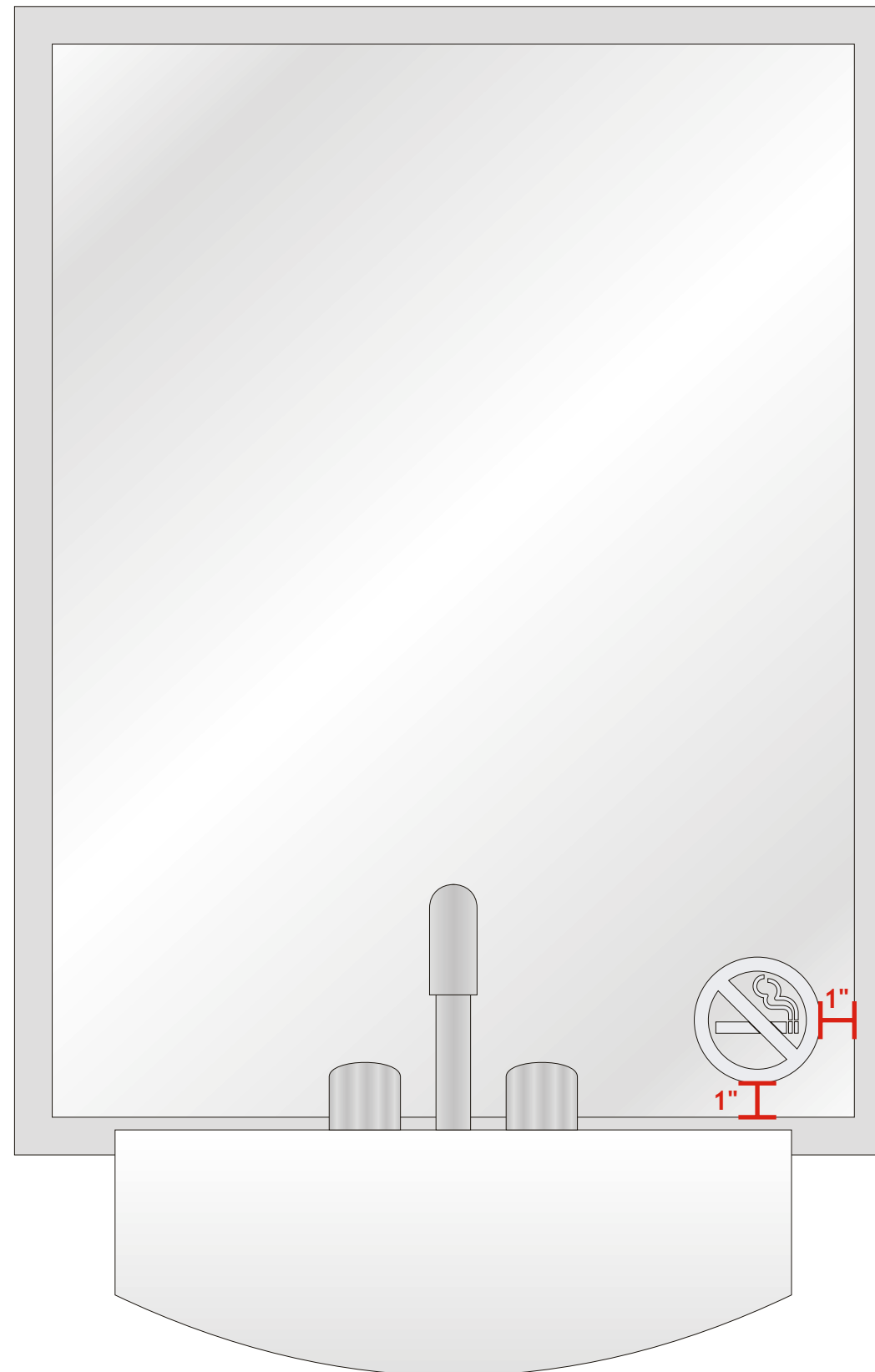

SIGN - DETAILS

- 1 FORWARD CUT FROSTED VINYL APPLIED FIRST SURFACE OF MIRROR
- 2 VINYL APPLIED DIRECTLY TO FACE OF MIRROR AT BOTTOM RIGHT CORNER, 1" FROM BOTTOM AND RIGHT EDGES OF FRAME

<input checked="" type="checkbox"/> APPROVED	APPROVALS ARE NOT INTENDED TO RELIEVE TENANT ARCHITECT AND/OR ENGINEER AND CONTRACTOR FROM COMPLYING WITH ALL ASPECTS OF THE LANDLORD CRITERIA, LEASE EXHIBITS, AND ALL APPLICABLE CODES. APPROVALS SHALL NOT BE CONSTRUED TO MODIFY OR NEGATE ANY TERMS OF THE LEASE.
<input type="checkbox"/> APPROVED AS NOTED	
<input type="checkbox"/> REVISE AND RESUBMIT	
<input type="checkbox"/> NOT APPROVED	
TOM EFT, TENANT COORDINATOR	
BY: Tom Eft	
DATE: 01/18/2023	



93 Industry Drive
PO Box 349
Versailles, KY 40383
859.879.1199



Bath & Body Works

STORE 737
SPACE 235

SOUTH HILL MALL
3500 SOUTH MERIDIAN STREET
PUYALLUP, WA 98373

This sign is intended to be installed in accordance with the requirements of Article 600 of the National Electrical Code and/or other applicable local codes. This includes proper grounding and bonding of the sign.

RUGGLES SIGN DOES NOT PROVIDE PRIMARY ELECTRICAL TO SIGN LOCATION!



Submittal Date: 01/10/23
Plan Issue/Rev Date: _____
Acct Rep: Ashley Abney
Designer: Jaye Williams

REVISIONS

R1: _____	R6: _____
R2: _____	R7: _____
R3: _____	R8: _____
R4: _____	R9: _____
R5: _____	R10: _____

G PANEL - ELEVATION
Scale: 3" = 1' - 0"



● PANEL - INSTALL DETAIL
Scale: N.T.S.

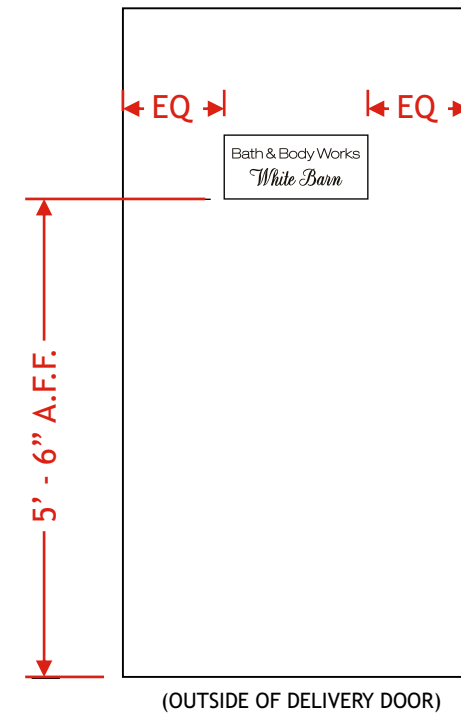

● PANEL - BACK SIDE
Scale: 3" = 1' - 0"

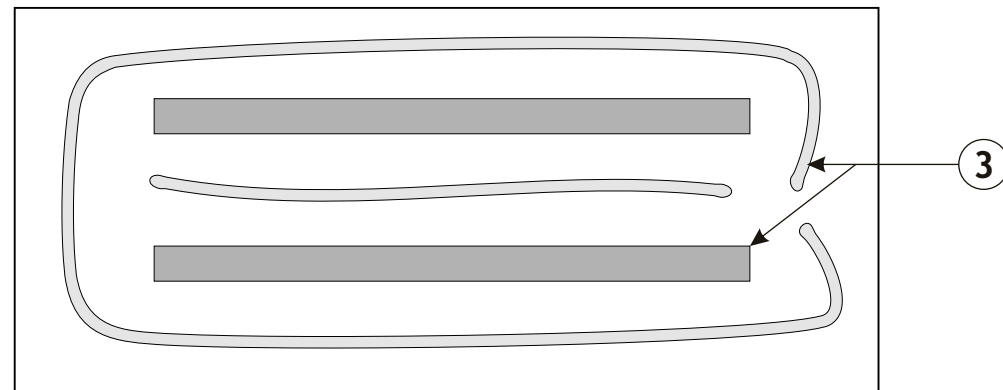

● SIGN - DETAILS

- 1 .040 PRE-FINISHED WHITE ALUMINUM PANEL
- 2 FORWARD CUT, GLOSS BLACK VINYL LOGO, APPLIED TO FACE OF WHITE PANEL
- 3 PANEL IS MOUNTED FLUSH TO DOOR WITH SILICONE AND VHB DOUBLE SIDED TAPE

<input checked="" type="checkbox"/> APPROVED	APPROVALS ARE NOT INTENDED TO RELIEVE TENANT ARCHITECT AND/OR ENGINEER AND CONTRACTOR FROM COMPLYING WITH ALL ASPECTS OF THE LANDLORD CRITERIA, LEASE EXHIBITS, AND ALL APPLICABLE CODES. APPROVALS SHALL NOT BE CONSTRUED TO MODIFY OR NEGATE ANY TERMS OF THE LEASE.
<input type="checkbox"/> APPROVED AS NOTED	
<input type="checkbox"/> REVISE AND RESUBMIT	
<input type="checkbox"/> NOT APPROVED	
TOM EFT, TENANT COORDINATOR	
BY: Tom Eft	
DATE: 01/18/2023	



93 Industry Drive
PO Box 349
Versailles, KY 40383
859.879.1199



Bath & Body Works

STORE 737
SPACE 235

SOUTH HILL MALL
3500 SOUTH MERIDIAN STREET
PUYALLUP, WA 98373

This sign is intended to be installed in accordance with the requirements of Article 600 of the National Electrical Code and/or other applicable local codes. This includes proper grounding and bonding of the sign.

RUGGLES SIGN DOES NOT PROVIDE PRIMARY ELECTRICAL TO SIGN LOCATION!



Submittal Date: 01/10/23
Plan Issue/Rev Date: _____
Acct Rep: Ashley Abney
Designer: Jaye Williams

REVISIONS

R1: _____ R6: _____
R2: _____ R7: _____
R3: _____ R8: _____
R4: _____ R9: _____
R5: _____ R10: _____

H VINYL - DETAIL
Scale: HALF

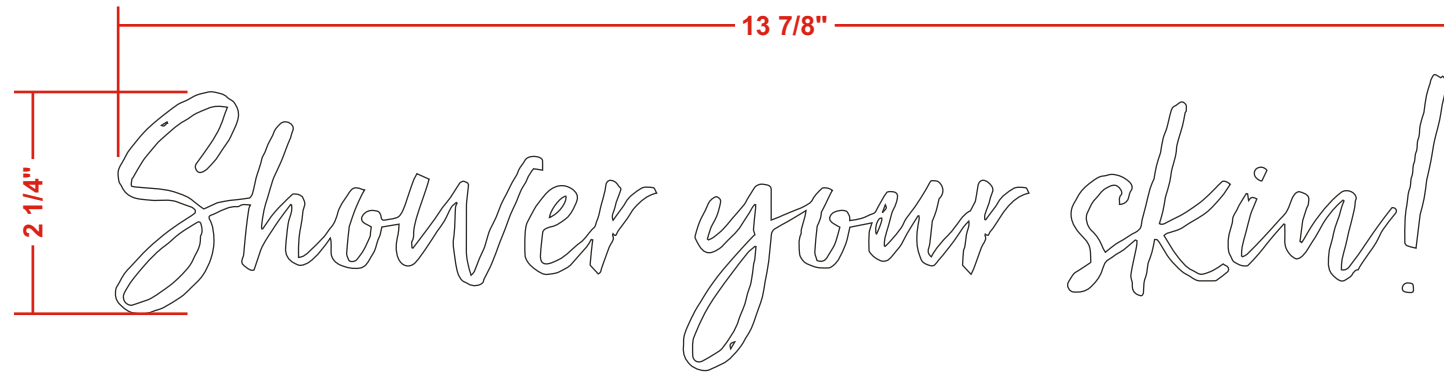

● PLACEMENT - DETAILS

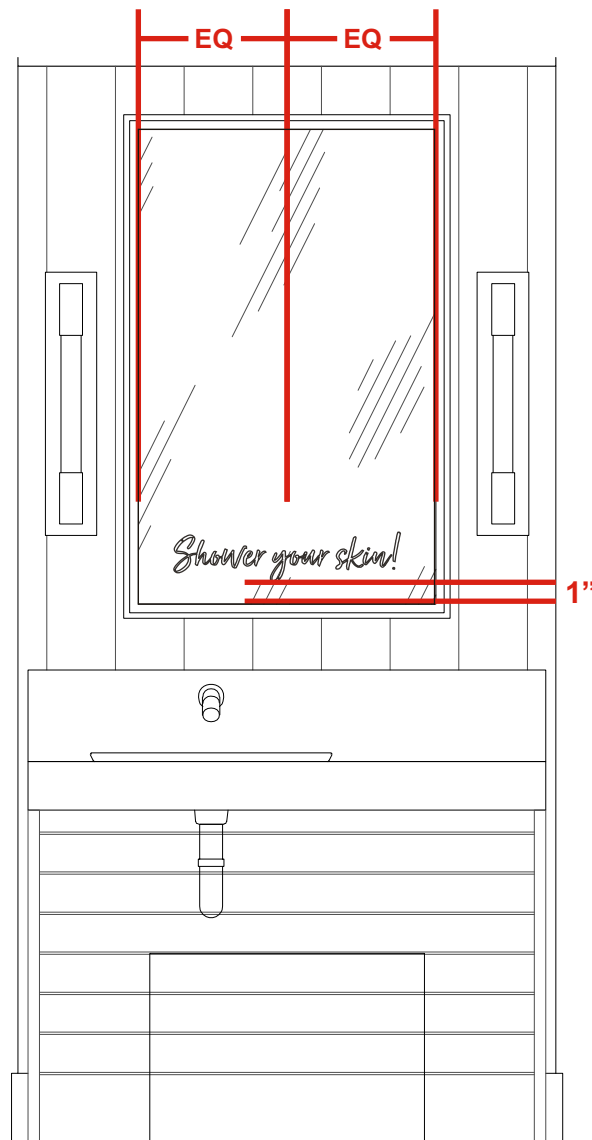

● SIGN - DETAILS

- ① FORWARD CUT WHITE VINYL TO MATCH SW 6007 EXTRA WHITE APPLIED FIRST SURFACE

<input checked="" type="checkbox"/> APPROVED	APPROVALS ARE NOT INTENDED TO RELIEVE TENANT ARCHITECT AND/OR ENGINEER AND CONTRACTOR FROM COMPLYING WITH ALL ASPECTS OF THE LANDLORD CRITERIA, LEASE EXHIBITS, AND ALL APPLICABLE CODES. APPROVALS SHALL NOT BE CONSTRUED TO MODIFY OR NEGATE ANY TERMS OF THE LEASE.
<input type="checkbox"/> APPROVED AS NOTED	
<input type="checkbox"/> REVISE AND RESUBMIT	
<input type="checkbox"/> NOT APPROVED	
TOM EFT, TENANT COORDINATOR	
BY: Tom Eft	
DATE: 01/18/2023	



93 Industry Drive
PO Box 349
Versailles, KY 40383
859.879.1199



Bath & Body Works

STORE 737
SPACE 235

SOUTH HILL MALL
3500 SOUTH MERIDIAN STREET
PUYALLUP, WA 98373

This sign is intended to be installed in accordance with the requirements of Article 600 of the National Electrical Code and/or other applicable local codes. This includes proper grounding and bonding of the sign.

RUGGLES SIGN DOES NOT PROVIDE PRIMARY ELECTRICAL TO SIGN LOCATION!



Submittal Date: 01/10/23
Plan Issue/Rev Date: _____
Acct Rep: Ashley Abney
Designer: Jaye Williams

REVISIONS

R1: _____ R6: _____
R2: _____ R7: _____
R3: _____ R8: _____
R4: _____ R9: _____
R5: _____ R10: _____

1 VINYL - DETAIL
Scale: HALF



SIGN - DETAILS

- 1** FORWARD CUT WHITE VINYL TO MATCH SW 6007 EXTRA WHITE APPLIED FIRST SURFACE

PLACEMENT - DETAILS

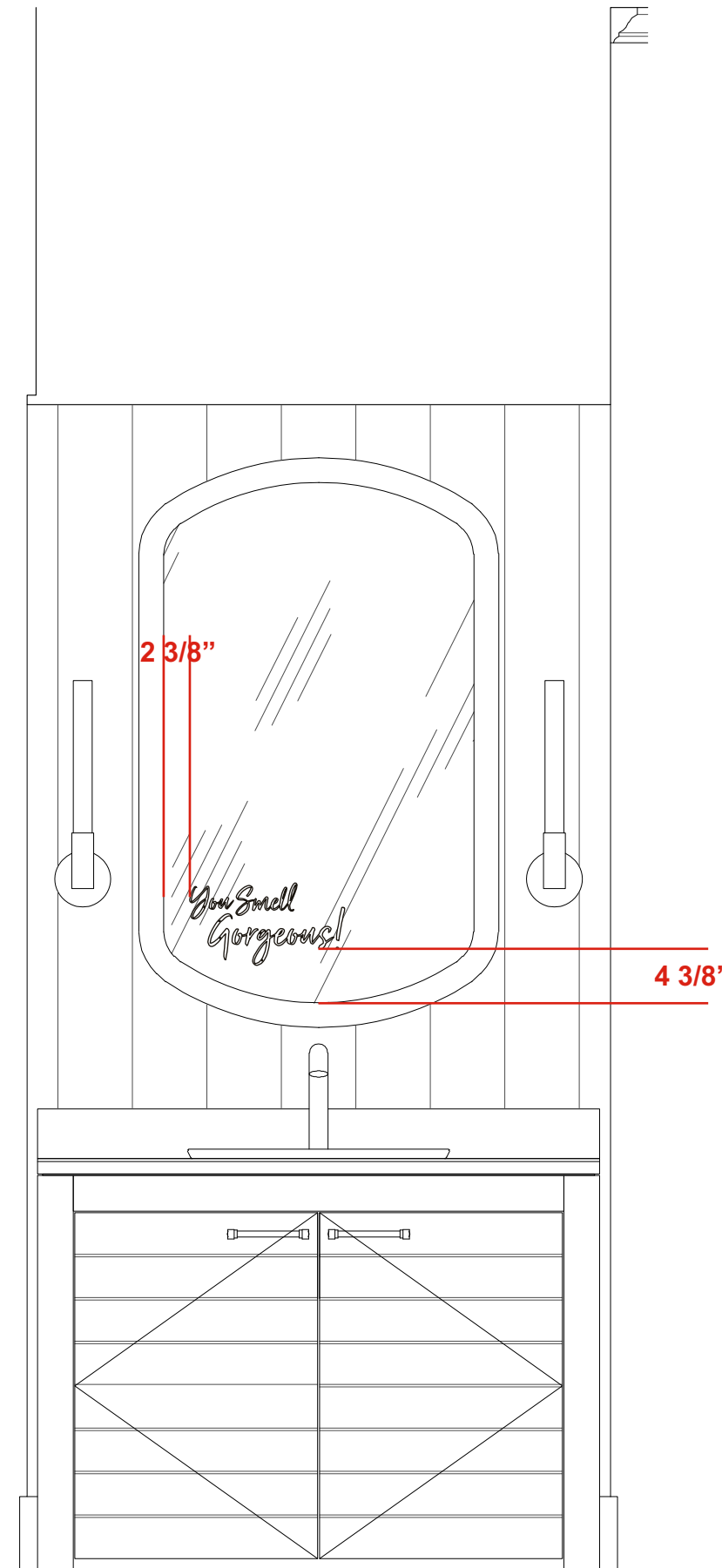

<input checked="" type="checkbox"/> APPROVED	APPROVALS ARE NOT INTENDED TO RELIEVE TENANT ARCHITECT AND/OR ENGINEER AND CONTRACTOR FROM COMPLYING WITH ALL ASPECTS OF THE LANDLORD CRITERIA, LEASE EXHIBITS, AND ALL APPLICABLE CODES. APPROVALS SHALL NOT BE CONSTRUED TO MODIFY OR NEGATE ANY TERMS OF THE LEASE.
<input type="checkbox"/> APPROVED AS NOTED	
<input type="checkbox"/> REVISE AND RESUBMIT	
<input type="checkbox"/> NOT APPROVED	
TOM EFT, TENANT COORDINATOR	
BY: Tom Eft	
DATE: 01/18/2023	



93 Industry Drive
PO Box 349
Versailles, KY 40383
859.879.1199



Bath & Body Works

STORE 737
SPACE 235

SOUTH HILL MALL
3500 SOUTH MERIDIAN STREET
PUYALLUP, WA 98373

This sign is intended to be installed in accordance with the requirements of Article 600 of the National Electrical Code and/or other applicable local codes. This includes proper grounding and bonding of the sign.

RUGGLES SIGN DOES NOT PROVIDE PRIMARY ELECTRICAL TO SIGN LOCATION!



Submittal Date: 01/10/23
Plan Issue/Rev Date: _____
Acct Rep: Ashley Abney
Designer: Jaye Williams

REVISIONS

R1: _____ R6: _____
R2: _____ R7: _____
R3: _____ R8: _____
R4: _____ R9: _____
R5: _____ R10: _____

J ACCESSIBLE RESTROOM SIGNAGE - ELEVATION / SECTION
Scale: HALF SIZE

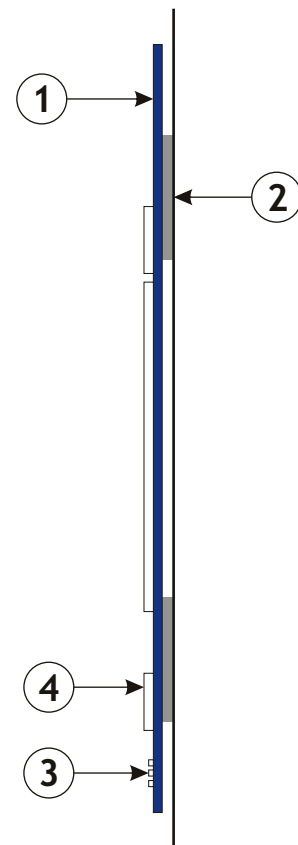

ACCESSIBLE RESTROOM SIGNAGE - INSTALLATION DETAIL
Scale: N.T.S.

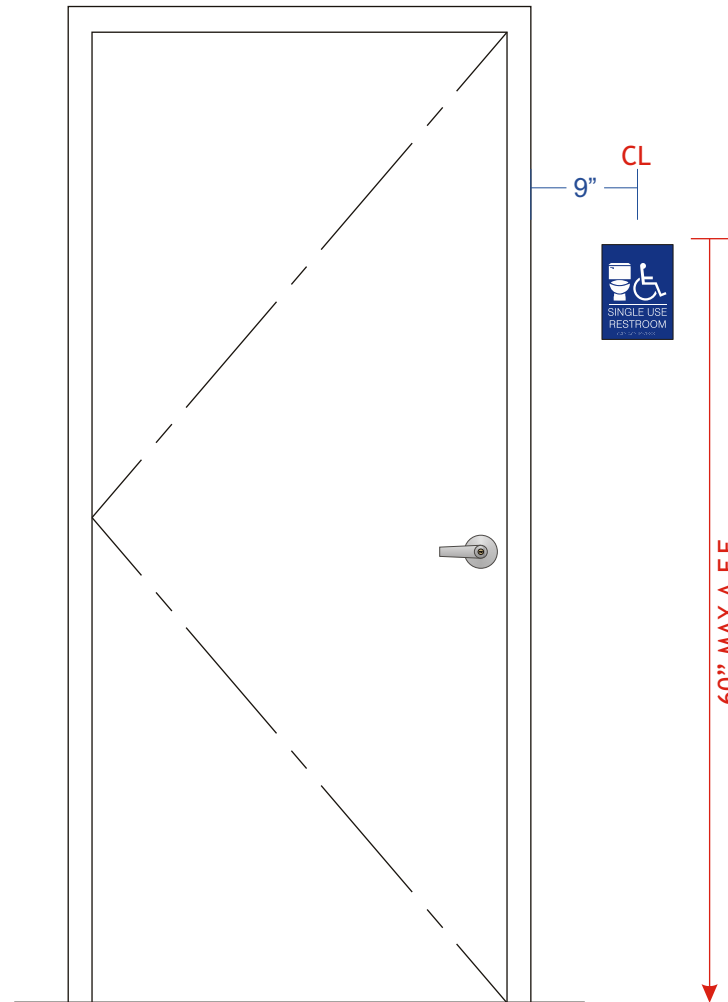

SIGN - DETAILS

- ① 1/4" THICK MOLDED PLASTIC, TO MATCH SW PT-19 "IT'S ALL ABOUT THE BLUE"
- ② 1/4" THICK ROUTED ACRYLIC SYMBOL AND COPY, MATTE WHITE MOUNTED FLUSH TO WALL WITH DOUBLE SIDED TAPE (TAPE IS PRE-APPLIED TO PANEL, JUST PEEL AND STICK)
- ③ TYPE 2 BRAILLE LOCATED AT BOTTOM OF SIGN
- ④ CHARACTERS TO BE RAISED 1/32" MINIMUM

<input checked="" type="checkbox"/> APPROVED	APPROVALS ARE NOT INTENDED TO RELIEVE TENANT ARCHITECT AND/OR ENGINEER AND CONTRACTOR FROM COMPLYING WITH ALL ASPECTS OF THE LANDLORD CRITERIA, LEASE EXHIBITS, AND ALL APPLICABLE CODES. APPROVALS SHALL NOT BE CONSTRUED TO MODIFY OR NEGATE ANY TERMS OF THE LEASE.
<input type="checkbox"/> APPROVED AS NOTED	
<input type="checkbox"/> REVISE AND RESUBMIT	
<input type="checkbox"/> NOT APPROVED	
TOM EFT, TENANT COORDINATOR	
BY: Tom Eft	
DATE: 01/18/2023	



93 Industry Drive
PO Box 349
Versailles, KY 40383
859.879.1199



Bath & Body Works

STORE 737
SPACE 235

SOUTH HILL MALL
3500 SOUTH MERIDIAN STREET
PUYALLUP, WA 98373

This sign is intended to be installed in accordance with the requirements of Article 600 of the National Electrical Code and/or other applicable local codes. This includes proper grounding and bonding of the sign.

RUGGLES SIGN DOES NOT PROVIDE PRIMARY ELECTRICAL TO SIGN LOCATION!



Submittal Date: 01/10/23
Plan Issue/Rev Date: _____
Acct Rep: Ashley Abney
Designer: Jaye Williams

REVISIONS

R1: _____ R6: _____
R2: _____ R7: _____
R3: _____ R8: _____
R4: _____ R9: _____
R5: _____ R10: _____

K FACE LIT CHANNEL LETTERS - ELEVATION
Scale: 1/2" = 1' - 0"

22.02 SQ FT
SKINNY LOGO

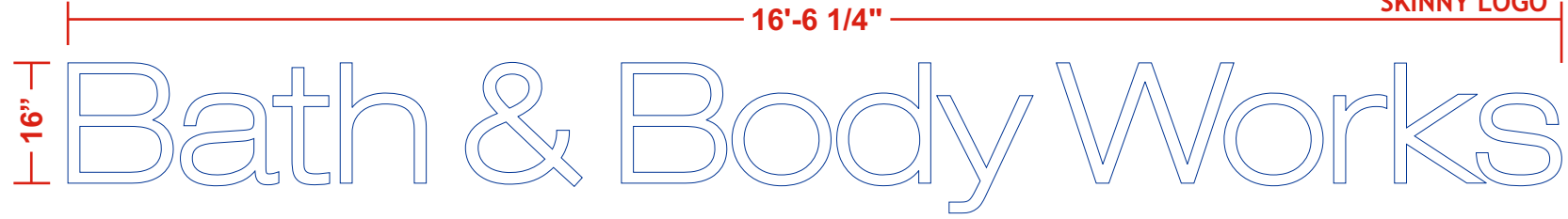

SIGN - DETAILS

- 1 1 1/2" DEEP ALUMINUM LETTERS WITH ROUTED ALUMINUM BACKS PAINTED TO MATCH SW PT-19 IT'S ALL ABOUT THE BLUE (UFN 1554796), INTERIOR SURFACES PAINTED HIGH GLOSS WHITE
- 2 LETTER RETURNS & BACKS ARE CAULKED TO ELIMINATE LIGHT LEAKS
- 3 3/8" THICK ROUTED LIGHT DIFFUSING ACRYLIC (SATIN ICE) REVERSE PUSH THRU FACE SECURED TO RETURNS WITH SET SCREW AT TOP RETURN
- 4 BITRO LITE 6500K WHITE LED UNITS TO ILLUMINATE LETTERS
- 5 BITRO ASU-60-12U LED DRIVER (120-277 VOLT) CONTAINED IN PAIGE 980054C SNAP 2 ENCLOSURE
- 6 10-24 RIVET NUT, WITH 3/16" ALL THREAD ROD, SILICONE APPLIED TO STUDS AND LETTER BACK WITH DOUBLE SIDE TAPE TO SECURE LETTER TO STOREFRONT. LETTERS TO HAVE 3/4" SPACERS PAINTED TO MATCH LETTER RETURNS

FACE LIT CHANNEL LETTERS - SECTION
Scale: N.T.S.

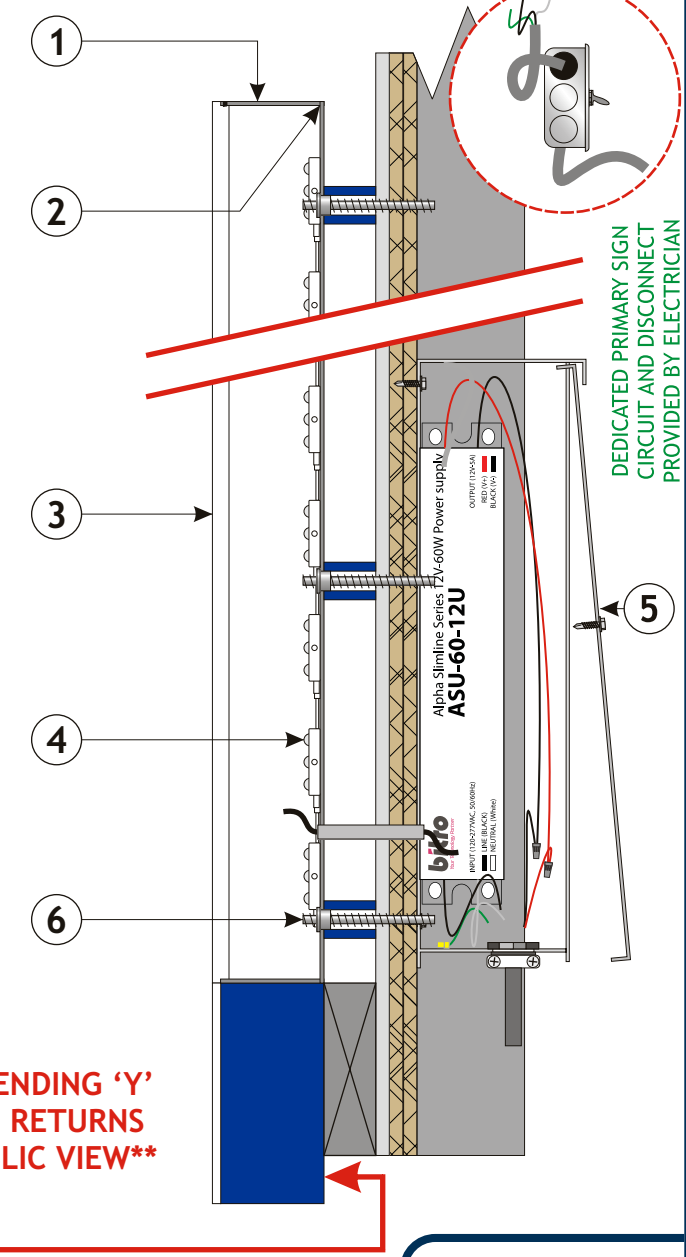

<input checked="" type="checkbox"/> APPROVED	APPROVALS ARE NOT INTENDED TO RELIEVE TENANT ARCHITECT AND/OR ENGINEER AND CONTRACTOR FROM COMPLYING WITH ALL ASPECTS OF THE LANDLORD CRITERIA, LEASE EXHIBITS, AND ALL APPLICABLE CODES. APPROVALS SHALL NOT BE CONSTRUED TO MODIFY OR NEGATE ANY TERMS OF THE LEASE.
<input type="checkbox"/> APPROVED AS NOTED	
<input type="checkbox"/> REVISE AND RESUBMIT	
<input type="checkbox"/> NOT APPROVED	
TOM EFT, TENANT COORDINATOR	
BY: Tom Eft	
DATE: 01/18/2023	

**BACK SIDE OF DESCENDING 'Y'
PAINTED TO MATCH RETURNS
VISIBLE FROM PUBLIC VIEW**



93 Industry Drive
PO Box 349
Versailles, KY 40383
859.879.1199



Bath & Body Works

STORE 737
SPACE 235

SOUTH HILL MALL
3500 SOUTH MERIDIAN STREET
PUYALLUP, WA 98373

This sign is intended to be installed in accordance with the requirements of Article 600 of the National Electrical Code and/or other applicable local codes. This includes proper grounding and bonding of the sign.

RUGGLES SIGN DOES NOT PROVIDE PRIMARY ELECTRICAL TO SIGN LOCATION!



Submittal Date: 01/10/23
Plan Issue/Rev Date: _____
Acct Rep: Ashley Abney
Designer: Jaye Williams

REVISIONS

R1: _____	R6: _____
R2: _____	R7: _____
R3: _____	R8: _____
R4: _____	R9: _____
R5: _____	R10: _____