

PRCT120230388

THE APPROVED CONSTRUCTION PLANS AND ALL ENGINEERING MUST BE POSTED ON THE JOB AT ALL INSPECTIONS IN A VISIBLE AND READILY ACCESSIBLE LOCATION.

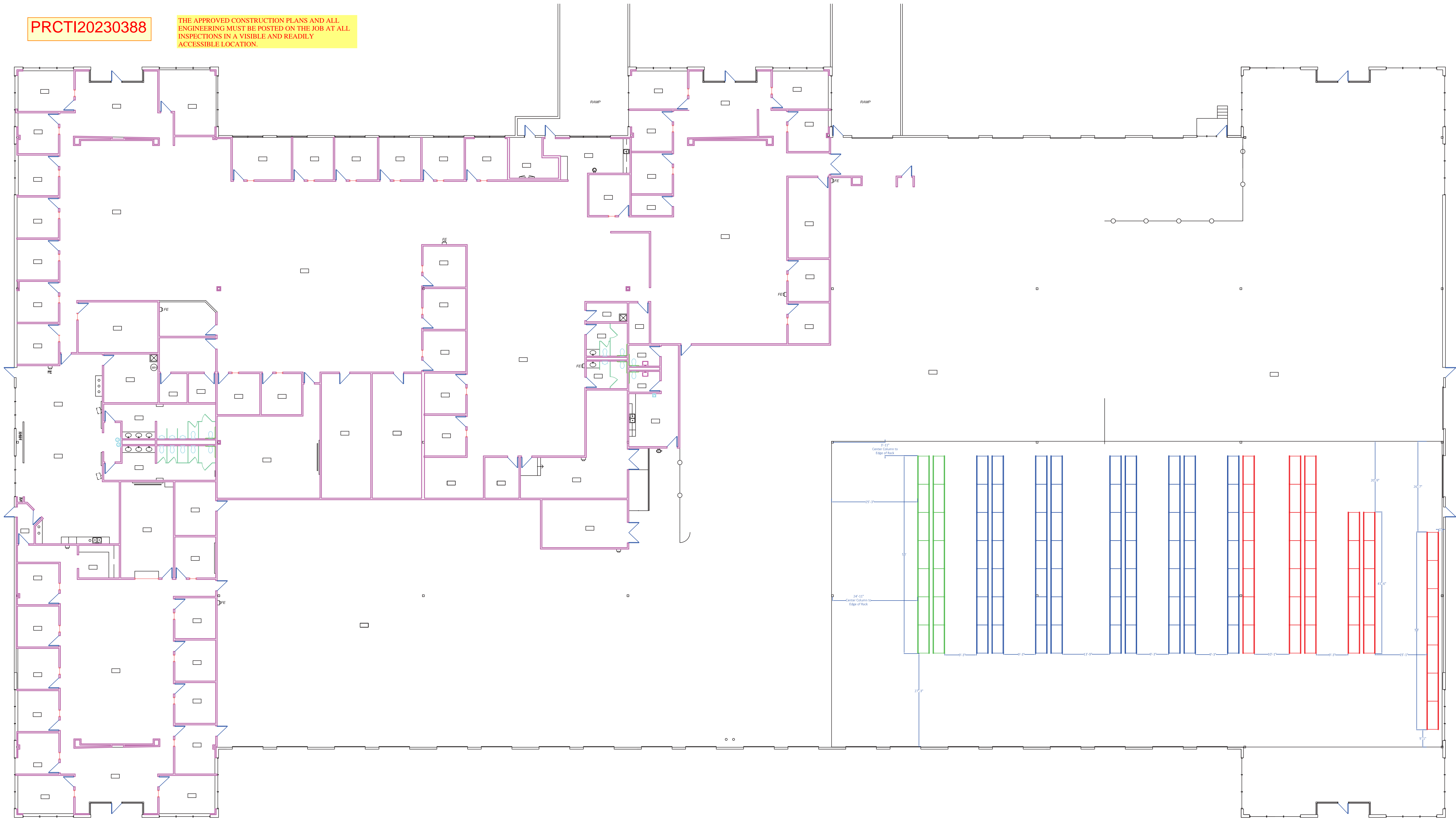

City of Puyallup
Development & Permitting Services
ISSUED PERMIT

Building	Planning
Engineering	Public Works
Fire	Traffic

Digitally signed
by Sal Fateen
Date: 2023.01.12 14:08:00

EXPIRES
04-12-2024

REVISIONS		DRAWN	CHECKED	DATE	REV
PROJECT:		ABATIX 410 VALLEY AVE, SUITE 102, PUYALLUP, WA, 98371			
TITLE	PLAN VIEW				
DATE	01/09/2023	QUOTATION	1661772		
DRAWN BY	EB	DRAWING	1 OF 2		
CHECKED BY	EM	PERMITTED	VARIES		
SCALE	NTS	LOAD	VARIES		
<small>This document is the property of MECALUX, S.A. and it is therefore prohibited to reproduce it fully or partially, or deliver it to third parties, under the penalties prescribed by law.</small>					

CUSTOMER'S APPROVAL TO SYSTEM AND MEASURES IN THE DRAWING