

# ZONING SITE MAP

PRCTI20221788

SCALE 1"=50'

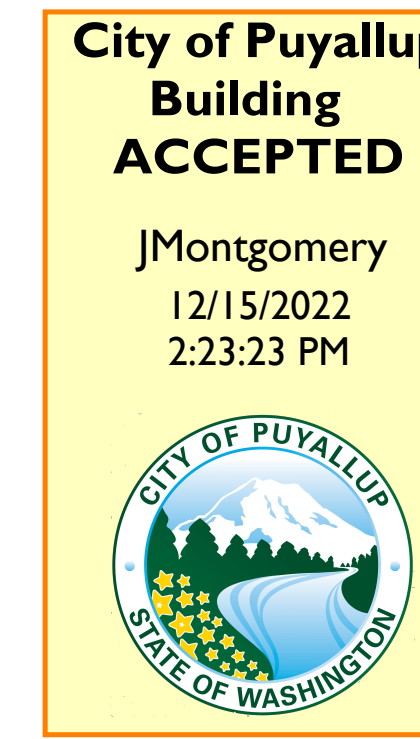
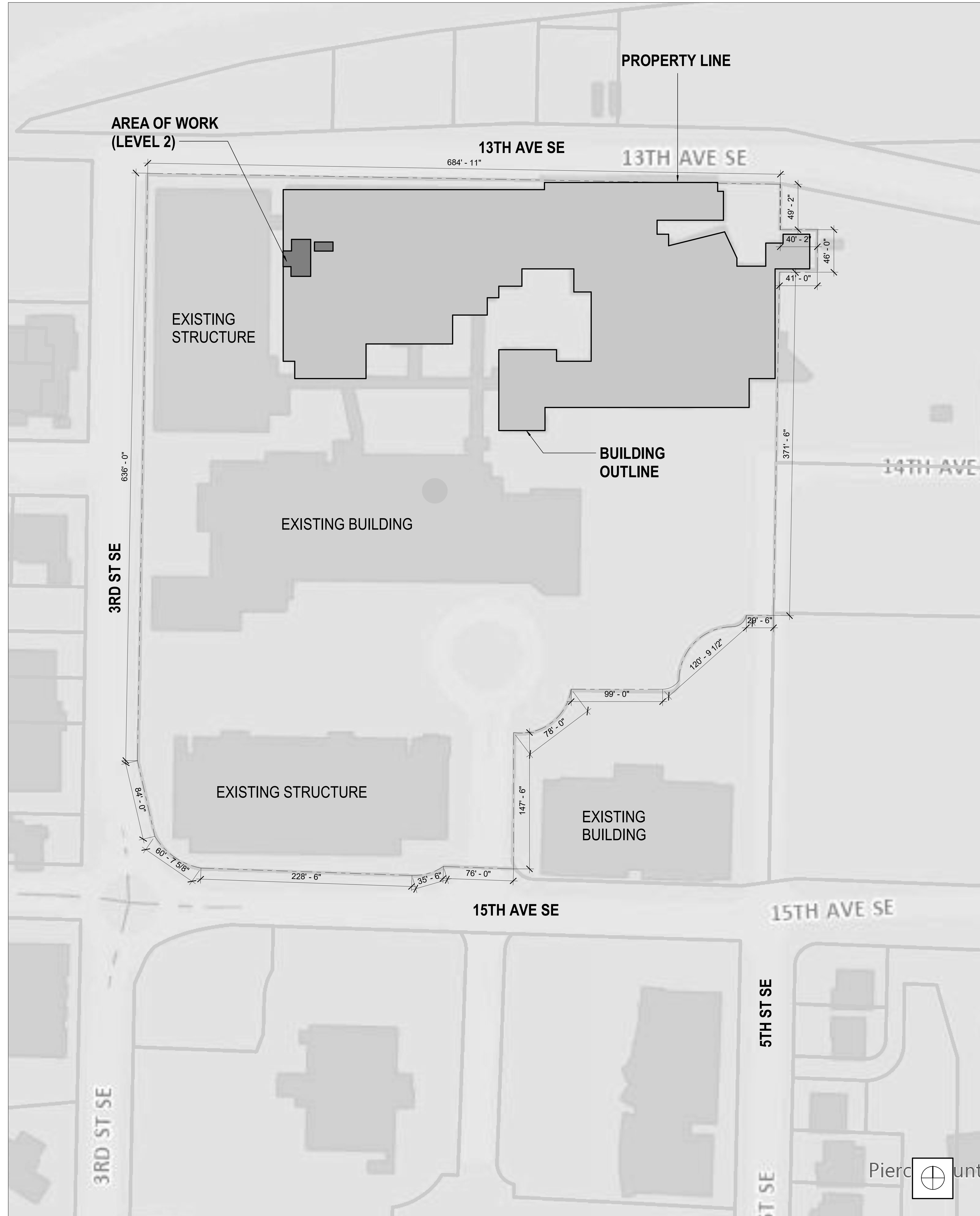

# PROJECT INFORMATION

PERMIT #:

DOH CRS #: 61364387

PROJECT NAME: MULTICARE GOOD SAMARITAN HOSPITAL HYBRID OR #1

SITE ADDRESS: 401 15TH AVE SE, PUYALLUP, WA 98372

PARCEL NUMBER: 9810000016

**LEGAL DESCRIPTION:** SECTION 34 TOWNSHIP 20 RANGE 04 QUARTER 23 WOODS 1ST CANNOT BE SOLD OR SUBD WITHOUT 001-4 & 001-5 LOT 1 OF BLA 2010-06-15-5001 DESC AS BEG AT A PT 30 FT E & 151.05 FT N OF INTER OF 15TH AV SE & 3RD ST SE TH N 322.08 FT TH N 305.27 FT TH E 692.45 FT TH S 78 DEG 58 MIN 52 SEC E 0.44 FT TH S 49.97 FT TH E 40.98 FT TH S 43.29 FT TH N 41.04 FT TH S 181.78 FT TH W 30 FT TH S 196.6 FT TO BEG CURVE CONCAVE TO NW HAVING A RAD OF 19.5 FT & C/A OF 59 DEG 50 MIN 20 SEC & BEING SUBTENDED BY A CHORD WHICH BEARS S 56 DEG 53 MIN 06 SEC W 19.45 FT TH SWLY & WLY ALG SD CURVE 20.37 FT TO PT OF REVERSE CURV TH WLY & SWLY & SLY 90.9 FT CONCAVE TO SE HAVING A RAD OF 60.5 FT & C/A OF 86 DEG 05 MIN 15 SEC TH S 3.26 FT TH SLY, SWLY & WLY 14.92 FT ALG CURVE CONCAVE TO NW HAVING A RAD OF 9.5 FT & C/A OF 89 DEG 59 MIN 59 SEC TH W 107.24 FT TO BEG OF CURVE CONCAVE TO NW HAVING A RAD OF 55.98 FT & C/A OF 81 DEG 57 MIN 04 SEC & BEING SUBTENDED BY CHORD WHICH BEARS S 49 DEG 34 MIN 17 SEC W 73.42 FT TH SLY, SWLY & WLY ALG SD CURVE 80.07 FT TH W 6.43 FT TH S 131.8 FT TH SLY & SELY 14.27 FT ALG SD CURVE CONCAVE TO E HAVING A RAD OF 25 FT & C/A OF 32 DEG 42 MIN 11 SEC TH N 88 DEG 06 MIN 01 SEC W 77.46 FT TO BEG OF CURVE CONCAVE TO N HAVING A RAD OF 40 FT & A C/A OF 43 DEG 31 MIN 52 SEC & BEING SUBTENDED BY CHORD WHICH BEARS S 70 DEG 08 MIN 03 SEC W 29.66 FT TH SWLY & WLY ALG SD CURVE 30.39 FT TH N 88 DEG 06 MIN 01 SEC W 238.87 FT TO BEG OF A CURVE CONCAVE TO NE HAVING A RAD OF 63 FT & A C/A OF 65 DEG 47 MIN 29 SEC & BEING SUBTENDED BY CHORD WHICH BEARS N 48 DEG 11 MIN 19 SEC W 68.43 FT TH WLY, NWLY & NLY ALG SD CURVE 72.34 FT TH N 12 DEG 28 MIN 32 SEC W 81.31 FT TO POB EXC POR DETER TAXABLE & EXC POR DETER EXEMPT PER DOR REG # 01777-001 TOG/W VAC ORD 2958 EASE OF RECORD OUT OF 981000-065-0 SEG 2011-0091 BB 10/11/10 BB DC00354165 5/2/2014 KG

ZONING: 6510-HOSPITAL, COMMERCIAL

PROPERTY OWNER: MULTICARE HEALTH SYSTEM

TENANT: MULTICARE GOOD SAMARITAN HOSPITAL

**PROJECT OVERVIEW:** CONVERSION OF EXISTING OR#1 SUITE AND AUXILIARY SPACES INTO A HYBRID OR SUITE. RECONFIGURATION OF EXISTING CONTROL ROOM, STORAGE, AND SUB-STERILE ROOM TO ACCOMMODATE NEW HYBRID OR SUITE.