

**City of Puyallup  
Building  
ACCEPTED**

JMontgomery  
05/03/2023  
2:36:27 PM



**CITY OF PUYALLUP**  
Planning Division Approved Site Plan  
(253) 864-4165  
MINIMUM SETBACK REQUIREMENTS

Front Yard: 12'-0" <sup>SB/L</sup> Rear Yard: 10'  
Interior Side Yard: Left: 6' Right: 6'  
Street Side Yard: N/A  
Zoning District: LMX  
Permit #: PRMU20221555

**Additional Conditions/Comments**  
An approved lot combination is required prior to issuance of either building permit for this project.  
Project approved per P-21-0096 design review determination dated 03/25/2022

Staff: NComstock  
Date: 01/10/2023  
Front, rear, and side yard property lines shall be marked with string from surveying pins prior to footing inspection.

The applicant shall request a sediment control and erosion inspection with a City Engineering Inspector through the CityView portal least 48 hours in advance of job start.

Refer to approved civil plan: PRCCP20221569 for sedimentation and erosion control methods

Refer to approved civil plan: PRCCP20221569 for roof downspout control methods

**City of Puyallup  
Development  
Engineering  
APPROVED**

See permit for additional requirements.

Linda Lian  
11/29/2022  
7:58:43 AM



City of Puyallup Development & Permitting Services ISSUED PERMIT	
Building	Planning
Engineering	Public Works
Fire	Traffic

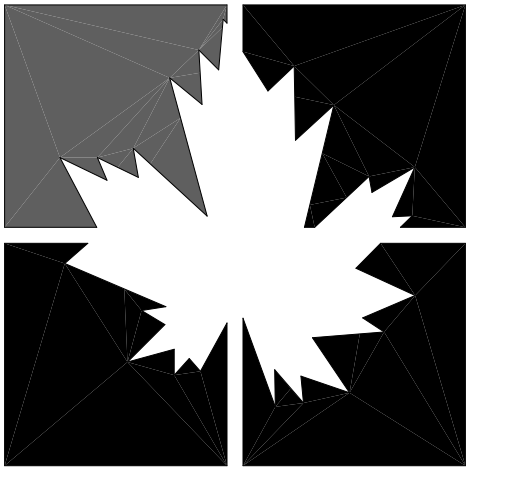

**PACIFIC  
HOME  
SOURCE**  
LLC

www.pacifichomesource.com  
info@pacifichomesource.com

4001 72nd Street East  
Tacoma, WA 98443  
PH: 253-312-5523

**BRC Family**  
4002 10th St SE  
Puyallup, WA 98374  
253-686-0654  
Parcels  
4389000180, 0170 & 0160

6805 **REGISTERED  
ARCHITECT**  
*Robert W. Hendershott*  
ROBERT W. HENDERSHOTT  
STATE OF WASHINGTON

Disclaimers:  
---These plans are exclusive property of Pacific Home Source LLC (PHS) and may not be sold to any person or business without expressed written consent of PHS. These plans are for one (1) time use only for PHS's customer - BRC Family and to be built on the customer's site at 4002 10th St SE in Puyallup, WA 98374.  
---NOTICE: DO NOT SCALE - The written dimensions on this plan supersede any scaled measurements.  
---Copyright notice: these plans are copyrighted and are subject to copyright protection as an "architectural work" under sec. 102 of the copyright act, 17 USC as amended December 1990. The protection includes but is not limited to the overall form as well as the arrangement and composition of spaces and elements of design. Under such protection, any unauthorized use of these plans, the design in whole or part, can legally result in monetary compensation to PHS. Written permission must be obtained and granted prior to any use and/or design changes to these plans.

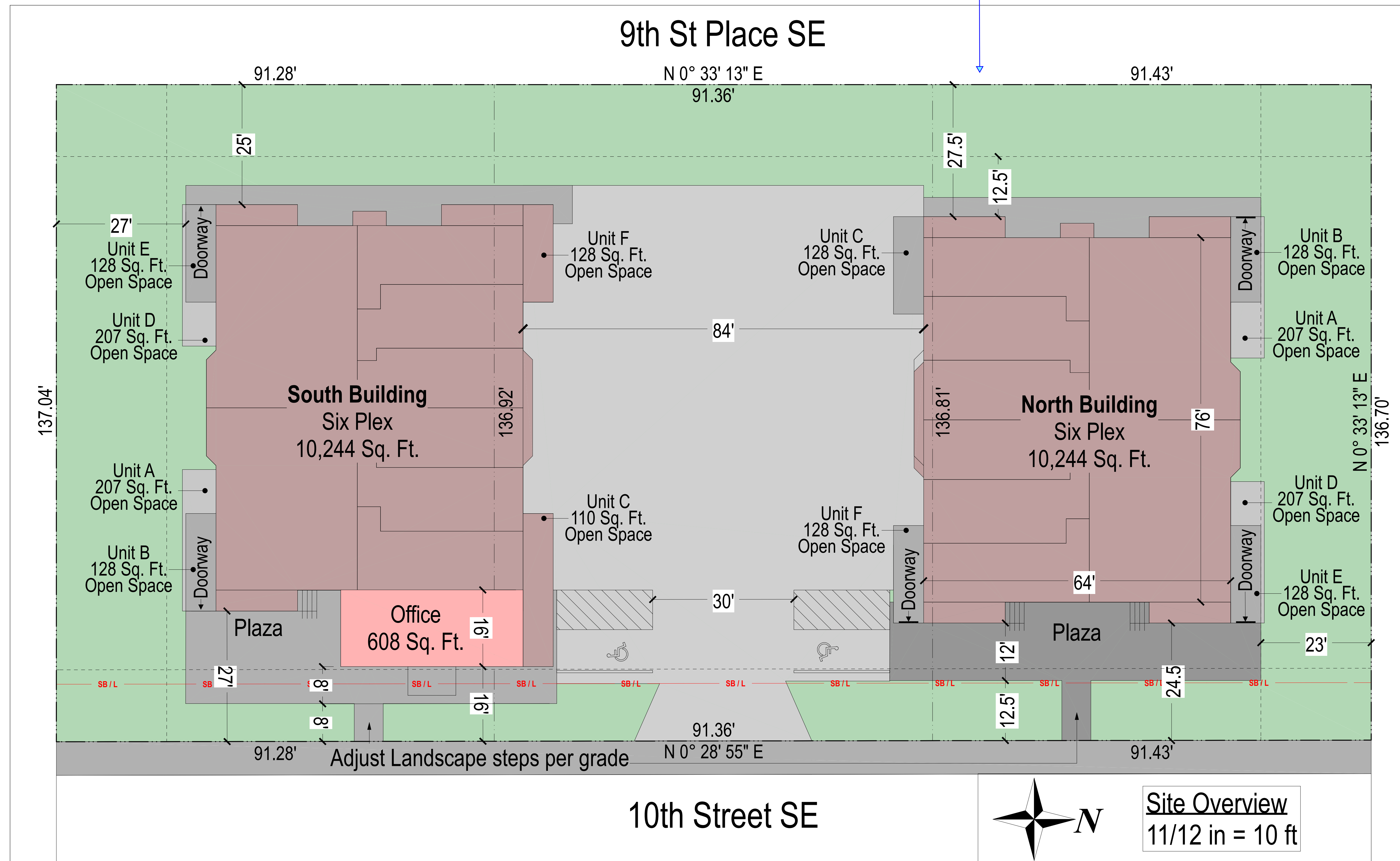

**PRMU20221555**

**North Building  
Page Template**

PHS Job #:  
21.136

Printed On:  
3/29/2023 00:20:55

Layout Sheet #  
0 of 18

Sheet:

**TEMP**