

## CASE INSTALLATION

\*\*\*NOTE\*\*\*  
THIS DOCUMENT IS INTENDED TO DESCRIBE IMPORTANT ELEMENTS OF THIS PROJECT AND TO DEFINE THE RESPONSIBLE PARTIES FOR THIS WORK STREAM. IT IS NOT MEANT TO BE AN EXHAUSTIVE SOURCE OF INFORMATION OR A COMPLETE SCOPE OF WORK. IT SHOULD BE READ AND USED IN CONJUNCTION WITH ADDITIONAL, DETAILED INFORMATION IN THE WALMART REALTY ONE BEST WAY STANDARDS LIBRARY, AND IN PUBLICATIONS AVAILABLE FROM THE MANUFACTURER.

#	SCOPE OF WORK	RESPONSIBLE PARTY			
		REPLACEMENTS		NEW EQUIPMENT	
		REMODEL	CAPEX	REMODEL	CAPEX
1	FURNISH THE NEW / REPLACEMENT CASES.	OEM/WMT	OEM/WMT	OEM/WMT	OEM/WMT
2	FURNISH AND INSTALL ALL (REFRIGERANT AND DRAIN) PIPING.	RC	RC	RC	RC
3	FURNISH ALL FIELD-INSTALLED REFRIGERATION VALVES.	OEM/WMT	OEM/WMT	OEM/WMT	OEM/WMT
4	FURNISH AND INSTALL ALL ISOLATION BALL VALVES	RC	RC	RC	RC
5	INSTALL ALL FIELD INSTALLED REFRIGERATION VALVES.	RC	RC	RC	RC
6	FURNISH AND INSTALL ALL FACTORY INSTALLED REFRIGERATION VALVES.	OEM/WMT	OEM/WMT	OEM/WMT	OEM/WMT
7	FURNISH ALL CONTROLS CABLING AS NECESSARY TO COMPLETE THE WORK. (24 VOLTS OR LESS)	EMS	EMS	EMS	EMS
8	PROVIDE TYPEWRITTEN SCHEDULES FOR ALL AFFECTED ELECTRICAL PANELBOARDS.	GC	RC	GC	RC
9	INSTALL AND TERMINATE FURNISHED CONTROLS WIRING (24 VOLTS OR LESS) AS DETAILED ON THE PRINTS.	RC	RC	RC	RC
10	PROVIDE ELECTRICAL POWER CABLING FROM POWER SOURCE TO THE FIRST CASE IN THE CIRCUIT.	GC	RC	GC	RC
11	PROVIDE ALL "SLAVE" WIRING FROM FIRST CASE TO REMAINING CASES ON THE CIRCUIT.	RC	RC	RC	RC
12	PREFABRICATE AS MUCH OF THE NEW PIPE WORK AND ELECTRICAL CONDUIT AS POSSIBLE AND MOUNT ANY NEW DEVICES IN ORDER TO REDUCE THE AMOUNT OF "DOWN TIME"...	RC	RC	RC	RC
13	COORDINATE THE INSTALLATION TIME WITH STORE...	GC	RC	GC	RC
14	OBTAIN HOT WORK PERMITS AS REQUIRED.	GC	RC	GC	RC
15	NOTIFY THE EMS VENDOR 24 HRS. IN ADVANCE OF THE WORK - TELL THEM WHAT CASES ARE BEING INSTALLED AND WHAT SYSTEMS WILL BE IMPACTED.	RC	RC	RC	RC
16	NOTIFY THE WMT BUILDING CONTROLS TEAM AND ADVISE THEM WHICH SYSTEMS AND WHICH CASES WILL BE IMPACTED BY THE WORK.	RC	RC	N/A	N/A
17	REMOVE ALL OF REFRIGERATED PRODUCTS FROM THE CASES THAT ARE BEING REPLACED.	WMT	WMT	N/A	N/A
18	REMOVE ALL OF THE ASSET PROTECTION (BUMP GUARDS) FROM AROUND THE CASES.	GC	RC	N/A	N/A
19	DECOMMISSION AND REMOVE THE OLD CASES. IN TEXAS, ALL DECOMMISSIONED CASES WILL BE REMOVED FROM THE STORE BY QUICK REFRIGERATION. COORDINATE REMOVAL AND DISPOSAL WITH WMT CONSTRUCTION MANGER. WHEN REPLACING PRODUCE CASES, REMOVE WATER SUPPLY FROM MISTING SYSTEM. WHEN REPLACING DELI SERVE OVER CASES, COORDINATE THE REMOVAL OF THE DATA CABLING FOR THE DELI SCALES.	RC	RC	N/A	N/A
20	CLEAN THE FLOOR UNDER THE CASES AND JET THE DRAINS.	RC	RC	N/A	N/A
21	WHEN REPLACING MULTI-DECK AND / OR GLASS DOOR CASES, AND REUSING EXISTING PIPEWORK, RE-INSULATE THE REFRIGERATION PIPING BEHIND THE CASES. THIS APPLIES TO ALL PIPING THAT IS ACCESSIBLE WITHOUT DISTURBING EXISTING CASES, INSIDE PITS / TUNNELS OR IN A CHASE THAT IS NOT BEING OTHERWISE DISTURBED.	RC	RC	N/A	N/A
22	SET THE NEW CASES IN THE POSITION DICTATED BY THE CONSTRUCTION PRINTS. ENSURE CASES ARE STRAIGHT AND LEVEL, AND SHIMMED PER THE MANUFACTURER'S GUIDANCE. SEAL ALL CASES WITH BUTYL SEALANT. ALIGN GLASS DOORS PLUMS AND LEVEL TO PREVENT "SAW-TOOTHING" OF THE DOORS.	RC	RC	RC	RC
23	CONNECT THE NEW CASES (MECHANICAL, ELECTRICAL, PLUMBING AND CONTROLS) AS DETAILED ON THE PRINTS.	RC	RC	RC	RC
24	EVACUATE AND PRESSURE TEST THE NEW CASES AND ANY PIPING MODIFIED OR DISTURBED DURING THE WORK.	RC	RC	RC	RC
25	SWITCH ON AND COMMISSION THE NEW CASES, VALVES AND CONTROLS AS REQUIRED. CHECK AND ADJUST MECHANICAL TXV SUPERHEATS TO OEM RECOMMENDATIONS AND EPR SETTINGS PER NEW LEGEND.	RC	RC	RC	RC
26	INSTALL FURNISHED LIDS TO REFRIGERATED BUNKERS.	RC	RC	RC	RC
27	FURNISH CONTROLS SUPPORT TO THE INSTALLING CONTRACTOR.	OEM	OEM	OEM	OEM
28	WHEN REPLACING PRODUCE CASES, INSTALL NEW MISTING SYSTEM TO CASES AND CONNECT TO DEDICATED WATER SUPPLY.	RC	RC	RC	RC
29	WHEN REPLACING DELI SERVE OVER CASES, COORDINATE THE INSTALLATION OF THE DATA CABLING FOR THE DELI SCALES.	WMT	RC/WMT	WMT	RC/WMT
30	NOTIFY WMT BUILDING CONTROLS THAT THE NEW CASES ARE RUNNING AND ONLINE.	RC	RC	RC	RC
31	CARRY OUT A THOROUGH LEAK TEST ON ALL WELDED AND MECHANICAL JOINTS INSTALLED OR DISTURBED DURING THE PROJECT.	RC	RC	RC	RC
32	HANDOVER THE NEW CASES TO THE STORE. (CASES MUST BE CLEAN, AT OPERATIONAL TEMPERATURE AND FULLY FUNCTIONAL WITH ALL PANS AND SHELVING IN PLACE.)	RC	RC	RC	RC
33	FILL THE NEW CASE WITH PRODUCT.	WMT	WMT	WMT	WMT
34	REPLACE MISSING OR DAMAGED FLOOR TILES OR REPAIR VISIBLE, DAMAGED CONCRETE FLOOR AROUND THE NEW CASES. (AS NEEDED)	GC (OR WMT PREFERRED FLOORING INSTALLER)	RC	N/A	N/A
35	INSTALL NEW CIRCUIT LABELS TO THE NEW CASES AS...	RC	RC	RC	RC
36	COMPLETE ASSET TAGGING PROCESS	RC	RC	RC	RC
37	REPLACE THE SHOP FLOOR DRAWINGS AND INSTALL REPLACEMENT LEGENDS.	RC	RC	RC	RC
38	REINSTALL ANY PREVIOUSLY REMOVED (UNDAMAGED) ASSET PROTECTION (BUMP GUARDS). INSTALL NEW OWNER FURNISHED PROTECTION EQUIPMENT AS NEEDED.	RC	RC	RC	RC
39	AFTER ALL CHANGES HAVE BEEN MADE TO A RACK, REMOVE ANY COMPRESSOR SUCTION FILTERS / SOCKS AND REPLACE THE RACK LIQUID LINE FILTERS. LEAVE THE OLD FILTERS / ...	RC	RC	RC	RC
40	SUBMIT REQUIRED VERSAIRE AND OTHER REGULATORY FORMS AS REQUIRED BY THE END OF COMMISSIONING WEEK. COMPLETED VERSAIRE FORMS ARE TO BE EMAILED TO MCEQUIP@WAL-MART.COM.	RC	RC	RC	RC
41	REMOVE ALL OF THE OLD CASES AND CLEAR SITE OF ALL TOOLS, UNUSED INSTALLATION MATERIALS AND TRASH.	GC	RC	GC	RC

## ABBREVIATION LEGEND

ABBREVIATION	DESCRIPTION
RC	REFRIGERATION CONTRACTOR AND SUB-CONTRACTORS
GC	GENERAL CONTRACTOR AND SUB-CONTRACTORS
EMS	EMS VENDOR
OEM	ORIGINAL RACK EQUIPMENT MANUFACTURER, ORIGINAL CASE EQUIPMENT MANUFACTURER, AHU MANUFACTURER, RTU MANUFACTURER
PS	WALK-IN BOX PANEL SUPPLIER
WMT	WALMART
AES	SUPPLIER OF AHU ADAPTER CURBS, RTU ADAPTER CURBS AND WALMART'S EQUIPMENT SALVAGE PARTNER
WTC	WATER TREATMENT CONTRACTOR
MC	MECHANICAL CONTRACTOR AND SUB-CONTRACTORS

THIS DRAWING WAS PREPARED FOR USE

THIS DRAWING WAS PREPARED FOR USE ON A SPECIFIC SITE AT: PUVALLUP, WA  
CONTEMPORANEOUSLY WITH ITS ISSUE DATE ON 04/15/22, AND IT IS NOT SUITABLE FOR USE ON A DIFFERENT PROJECT SITE OR AT A LATER TIME. USE OF THIS DRAWING FOR REFERENCE OR EXAMPLE ON ANOTHER PROJECT REQUIRES THE SERVICES OF PROPERLY LICENSED ARCHITECTS AND ENGINEERS. REPRODUCTION OF THIS DRAWING FOR REUSE ON ANOTHER PROJECT IS NOT AUTHORIZED AND MAY BE CONTRARY TO THE LAW.

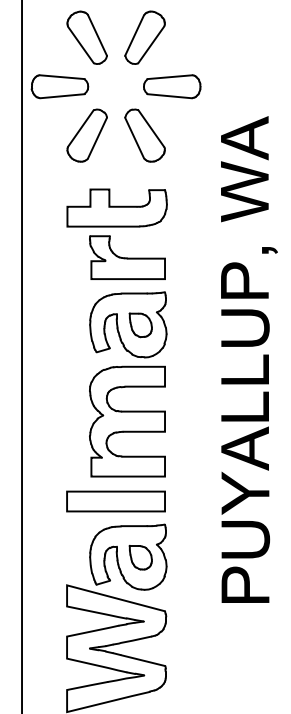

## ISSUE BLOCK

[illegible]

CHECKED BY:	DL
DRAWN BY:	LP
PROTO CYCLE:	12/17/21
DOCUMENT DATE:	04/15/22



DOCUMENTS THAT DO NOT  
HAVE THE ARCHITECT OR  
ENGINEER OF RECORD  
SEAL AND SIGNATURE  
SHALL BE CONSIDERED  
NOT FOR CONSTRUCTION

## RESPONSIBILITY MATRICES

**SHEET:**

N1

EXISTING CONDITIONS WERE TAKEN FROM ORIGINAL DRAWINGS AND MAY NOT REFLECT EXACT "AS-BUILT" CONDITIONS. CONTRACTOR SHALL FIELD VERIFY ALL EXISTING CONDITIONS PRIOR TO SUBMITTING FINAL BIDS. CONTRACTOR SHALL CAREFULLY COORDINATE NEW WORK AND DEMOLITION WITH ALL OTHER DISCIPLINES AND EXISTING CONDITIONS.

EACH SUBCONTRACTOR IS RESPONSIBLE FOR HAVING A THOROUGH KNOWLEDGE OF ALL DRAWINGS AND SPECIFICATIONS IN THEIR RELATED FIELD. THE FAILURE TO ACQUAINT THEMSELVES WITH THIS KNOWLEDGE DOES NOT RELIEVE THE RESPONSIBILITY OF PERFORMING THE WORK PROPERLY. NO ADDITIONAL COMPENSATION SHALL BE ALLOWED BECAUSE OF CONDITIONS THAT OCCUR DUE TO FAILURE TO FAMILIARIZE WORKERS WITH THIS KNOWLEDGE.

PRCTI20230548



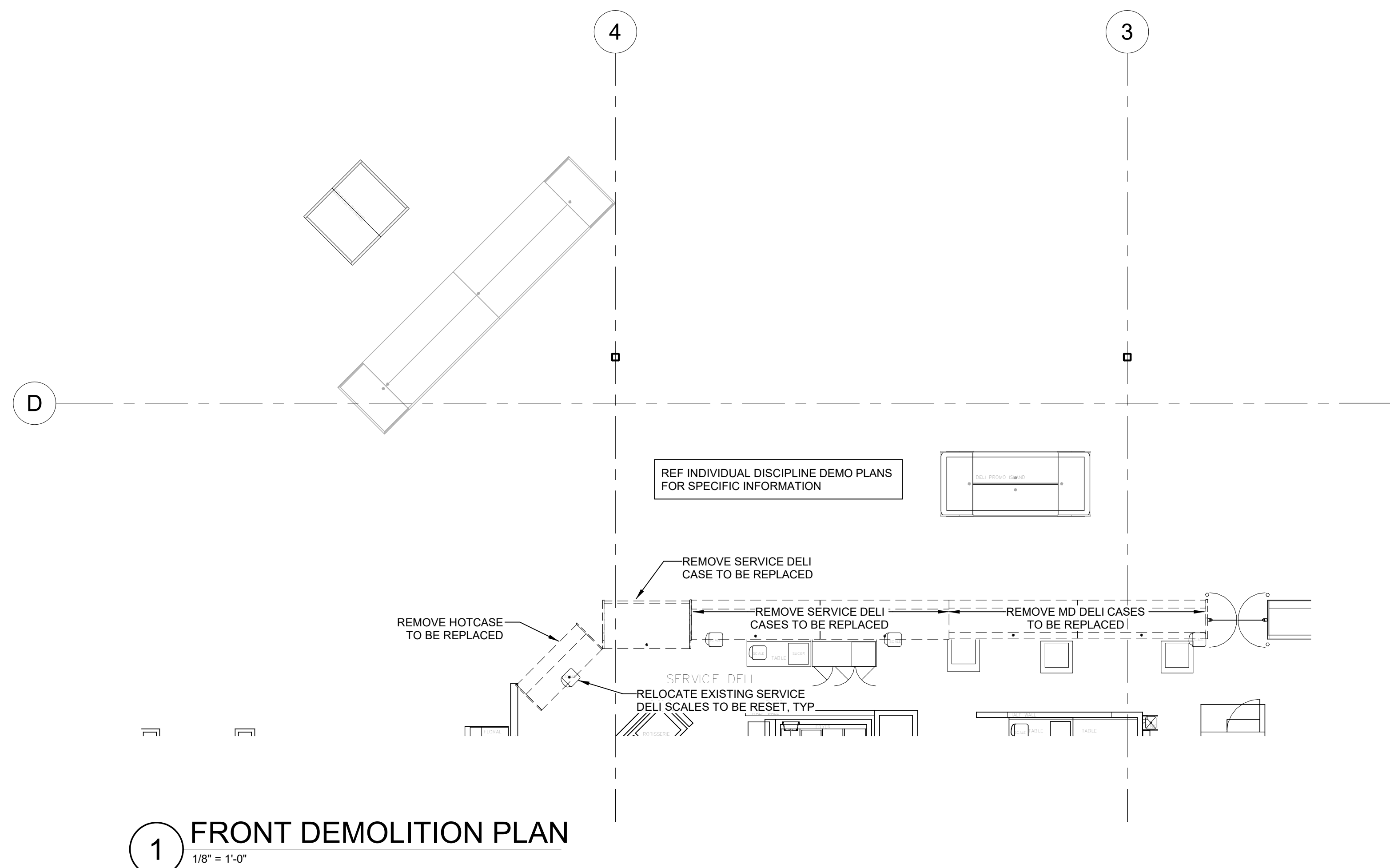
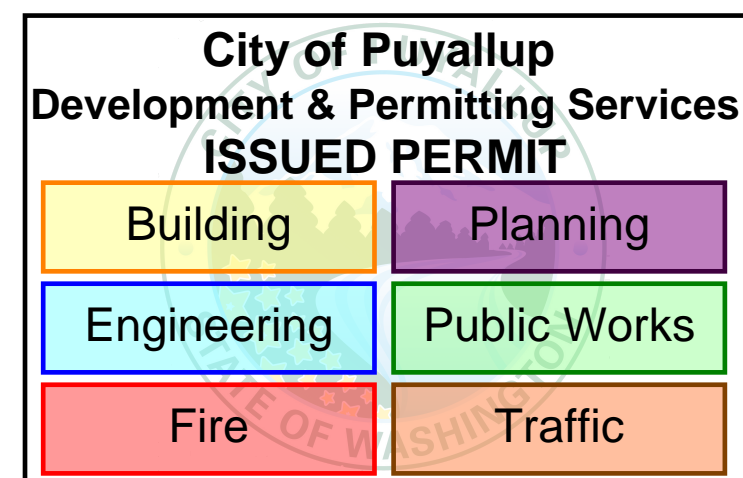

## DEMOLITION REQUIREMENTS

- 1 ALL DEMOLITION SHALL BE CARRIED OUT IN A SAFE MANNER AND IN STRICT ACCORDANCE WITH OSHA REGULATIONS.
- 2 THE CONTRACTOR SHALL FIELD VERIFY THE EXTENT OF DEMOLITION. THE WORK INCLUDES, BUT IS NOT LIMITED TO, REMOVAL AND DISPOSITION OF ALL ABOVE FINISHED FLOORS AND ELECTRICAL ITEMS INCLUDING CONDUITS AS SHOWN ON DRAWING OR AS REQUIRED FOR THE INSTALLATION OF NEW WORK FOR A COMPLETE JOB.
- 3 WHEN UTILITIES ARE REMOVED, CAP AND SEAL A MINIMUM OF 8 INCHES TO A MINIMUM OF 18 INCHES ABOVE FINISHED CEILING. SHOW ALL ABANDONED AND CAPPED UTILITIES ON AS-BUILT, DRAWINGS, AND RECORDED DOCUMENTS.
- 4 IT IS THE CONTRACTOR'S RESPONSIBILITY TO PROVIDE ADEQUATE SHORING, BRACING, AND SUPPORT SYSTEMS TO MAINTAIN THE EXISTING STRUCTURE INTACT AND IN A SAFE CONDITION DURING THE REMOVAL OF STRUCTURAL ITEMS AND NEW CONSTRUCTION.
- 5 THE CONTRACTOR SHALL RETAIN A DESIGNATED PROFESSIONAL ENGINEER TO REGISTER THE SHORING AND SPECIALTY DEMOLITION REQUIREMENTS.
- 6 IT IS THE CONTRACTOR'S RESPONSIBILITY FOR MEANS AND METHODS OF DEMOLITION AND NEW CONSTRUCTION PRIOR TO THE EXCAVATION OF FOUNDATIONS ADJACENT TO THE EXISTING STRUCTURE. PROVIDE ADEQUATE SUPPORT FOR THE EXISTING STRUCTURE TO PREVENT COLLAPSE.
- 7 DURING DEMOLITION AND RECONSTRUCTION, THE CONTRACTOR SHALL COORDINATE WITH THE WALMART MECHANICAL CONSTRUCTION MANAGER ANY REQUIRED SAFETY BARRIERS OR BARRICADES AND DUST WALLS. THE CONTRACTOR SHALL COORDINATE WITH THE WALMART MECHANICAL CONSTRUCTION MANAGER FOR PHASING AND SCHEDULING DEMOLITION AND NEW CONSTRUCTION.
- 8 DISPOSAL OF ALL DECOMMISSIONED EQUIPMENT NOT APPORTIONED TO WALMART'S DESIGNATED SALVAGE VENDOR SHALL BE IN ACCORDANCE WITH LOCAL CODES AND ANY GOVERNMENTAL REGULATIONS; REFER TO WALMART CONTRACT SPECIFICATIONS AND SPECIFICATIONS. THE CONTRACTOR SHALL CONDUCT THE PICK-UP DATE WITH THE DESIGNATED SALVAGE VENDOR, PREPARE AND LOAD THE DESIGNATED SALVAGE ITEMS, KEEPING THEM INTACT AND IN ACCORDANCE WITH LOCAL CODES AND ANY GOVERNMENTAL REGULATIONS; REFER TO WALMART CONTRACT SPECIFICATIONS AND SPECIFICATIONS. ITEMS TO BE SALVAGED BY WALMART'S DESIGNATED SALVAGE VENDOR SHALL BE LIMITED TO: VARIABLE FREQUENCY DRIVES, CONDENSING UNITS, COMPRESSORS, EVAPORATORS, COPPER PIPING, ROOF TOP UNITS, AIR HANDLING UNITS, AND COMPRESSOR HOUSES.
- 8-TX DISPOSAL OF ALL DECOMMISSIONED EQUIPMENT NOT APPORTIONED TO WALMART'S DESIGNATED SALVAGE VENDOR SHALL BE IN ACCORDANCE WITH LOCAL CODES AND ANY GOVERNMENTAL REGULATIONS; REFER TO WALMART CONTRACT SPECIFICATIONS AND SPECIFICATIONS. THE CONTRACTOR SHALL COORDINATE THE PICK-UP DATE WITH THE DESIGNATED SALVAGE VENDOR, PREPARE AND LOAD THE DESIGNATED SALVAGE ITEMS, AND DISPOSE OF THEM IN ACCORDANCE WITH LOCAL CODES AND ANY GOVERNMENTAL REGULATIONS; REFER TO WALMART DIRECTIVES AND SPECIFICATIONS. ITEMS NOT SALVAGED BY WALMART'S DESIGNATED SALVAGE VENDOR SHALL BE LIMITED TO: REFRIGERATED CASES AS DESIGNATED BY THE WALMART CONSTRUCTION MANAGER, COMPRESSORS, CONDENSING UNITS, COMPRESSORS, EVAPORATORS, CONDENSING UNITS, CONDENSERS, EVAPORATORS, COPPER PIPING, ROOF TOP UNITS, AIR HANDLING UNITS, AND COMPRESSOR HOUSES.
- 9 REFER TO SPECIFICATIONS SECTION 1500 FOR ADDITIONAL INFORMATION REGARDING STORMWATER RUNOFF CONTROL.
- 10 CONDUCT ALL DEMOLITION AND REMOVAL OF DEBRIS AS SHOWN ON THE ENERGY EFFICIENCY IMPROVEMENTS WITH BUILDING-SITE FACILITIES AND OPERATIONS.
- 11 NOTES INDICATING DEMOLITION WORK ARE NOT CONFINED SOLY TO THE DEMOLITION PLANS. THE CONTRACTOR SHALL REVIEW ALL CONSTRUCTION DOCUMENTS AND SPECIFICATIONS TO DETERMINE FULL EXTENT OF DEMOLITION WORK.

## DEMOLITION NOTES

1. REMOVAL OF ANY SALVAGE EQUIPMENT OR DEBRIS IS PROHIBITED. THIS INCLUDES THE SALE OF COPPER, ALUMINUM, OR ANY RELATED MATERIALS.
2. WHERE APPLICABLE COOLER PANEL MANUFACTURER SHALL DEMOLISH AND PROMPTLY HAUL OFF WALK-IN PANELS AND DOORS TO BE REPLACED.
3. DURING DEMOLITION AND RECONSTRUCTION PHASES, COORDINATE LOCATION OF ALL DUST WALLS AND SEALS WITH ENCLOSURES WITH MATERIALS STORE MANAGER. REFER TO DUST WALL SITE PLAN.
4. ALL NEW EQUIPMENT MUST BE ON DATE PRIOR TO STARTING ANY DEMOLITION OR CONSTRUCTION.
5. PATCH/REPAIR FLOOR COVERING AS REQUIRED AFTER INSTALLATION OF NEW CASES. MATCH EXISTING FLOORING TYPE, COLOR, PATTERN, AND FINISH.

## CONSTRUCTION LEGEND

== EXISTING TO REMAIN  
 == DEMOLISHED  
 ■ AREA TO BE DEMOLISHED

**STIPULATION FOR REUSE**

THIS DRAWING WAS PREPARED FOR USE ON A SPECIFIC SITE AT:  
PAYALLON, WA. PREVIOUSLY WITH ITS ISSUE DATE ON 04/15/22, AND IT IS NOT SUITABLE FOR USE ON A DIFFERENT PROJECT SITE OR AT A LATER TIME. USE OF THIS DRAWING FOR REFERENCE OR EXAMPLE ON ANOTHER PROJECT WITHOUT THE WRITTEN CONSENT OF THE LICENSED ARCHITECTS AND ENGINEERS, REPRODUCTION OF THIS DRAWING FOR USE ON ANOTHER PROJECT IS NOT AUTHORIZED AND MAY BE CONTRARY TO

Walmart  
PUYALLUP, WA  
STORE NO. 2403-605  
1023871 | CAPA REF-3

## ISSUE BLOCK

[illegible]

CHECKED BY:	DL
DRAWN BY:	LP
PROTO CYCLE:	12/17/21
DOCUMENT DATE:	04/15/22

 EXISTING TO REMAIN  
 DEMOLISHED  
 AREA TO BE DEMOLISHED

EXISTING CONDITIONS WERE TAKEN FROM ORIGINAL DRAWINGS AND MAY NOT REFLECT EXACT "AS-BUILT" CONDITIONS. CONTRACTOR SHALL FIELD VERIFY ALL EXISTING CONDITIONS PRIOR TO SUBMITTING FINAL BIDS. CONTRACTOR SHALL CAREFULLY COORDINATE NEW WORK AND DEMOLITION WITH ALL OTHER DISCIPLINES AND EXISTING CONDITIONS.

EACH SUBCONTRACTOR IS RESPONSIBLE FOR HAVING A THOROUGH KNOWLEDGE OF ALL DRAWINGS AND SPECIFICATIONS IN THEIR RELATED FIELD. THE FAILURE TO ACQUAINT THEMSELVES WITH THIS KNOWLEDGE DOES NOT RELIEVE THE RESPONSIBILITY OF PERFORMING THE WORK PROPERLY. NO ADDITIONAL COMPENSATION SHALL BE ALLOWED BECAUSE OF CONDITIONS THAT OCCUR DUE TO FAILURE TO FAMILIARIZE WORKERS WITH THIS KNOWLEDGE.

DEMOLITION  
PLAN

SHEET: **D1**

D1

PRCTI20230548







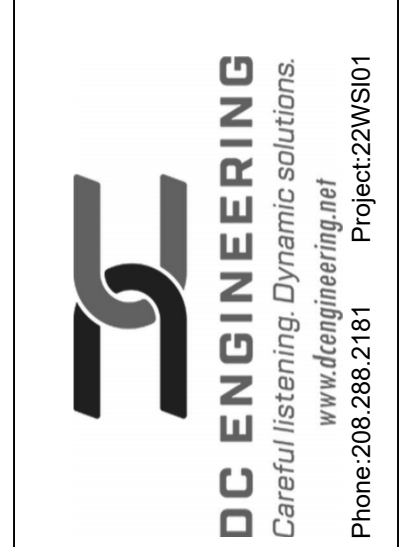

**Walmart\***  
**PUYALLUP, WA**  
STORE NO. 2403-605  
JOB NUMBER: 1023871    CAPPX REF-3

CHECKED BY:	DL
DRAWN BY:	LP
PROTO CYCLE:	12/17/21
DOCUMENT DATE:	04/15/22

## FIXTURE DETAILS

SHEET:  
F2



<p>EXISTING CONDITIONS WERE TAKEN FROM ORIGINAL DRAWINGS AND MAY NOT REFLECT EXACT "AS-BUILT" CONDITIONS. CONTRACTOR SHALL FIELD VERIFY ALL EXISTING CONDITIONS PRIOR TO SUBMITTING FINAL BIDS. CONTRACTOR SHALL CAREFULLY COORDINATE NEW WORK AND DEMOLITION WITH ALL OTHER DISCIPLINES AND EXISTING CONDITIONS.</p>	<p>EACH SUBCONTRACTOR IS RESPONSIBLE FOR HAVING A THOROUGH KNOWLEDGE OF ALL DRAWINGS AND SPECIFICATIONS IN THEIR RELATED FIELD. THE FAILURE TO ACQUAINT THEMSELVES WITH THIS KNOWLEDGE DOES NOT RELIEVE THE RESPONSIBILITY OF PERFORMING WORK IN ACCORDANCE WITH THE PROPERLY ISSUED CONTRACT. NO COMPENSATION SHALL BE ALLOWED BECAUSE OF CONDITIONS THAT OCCUR DUE TO FAILURE TO FAMILIARIZE WORKERS WITH THIS KNOWLEDGE.</p>
---	---



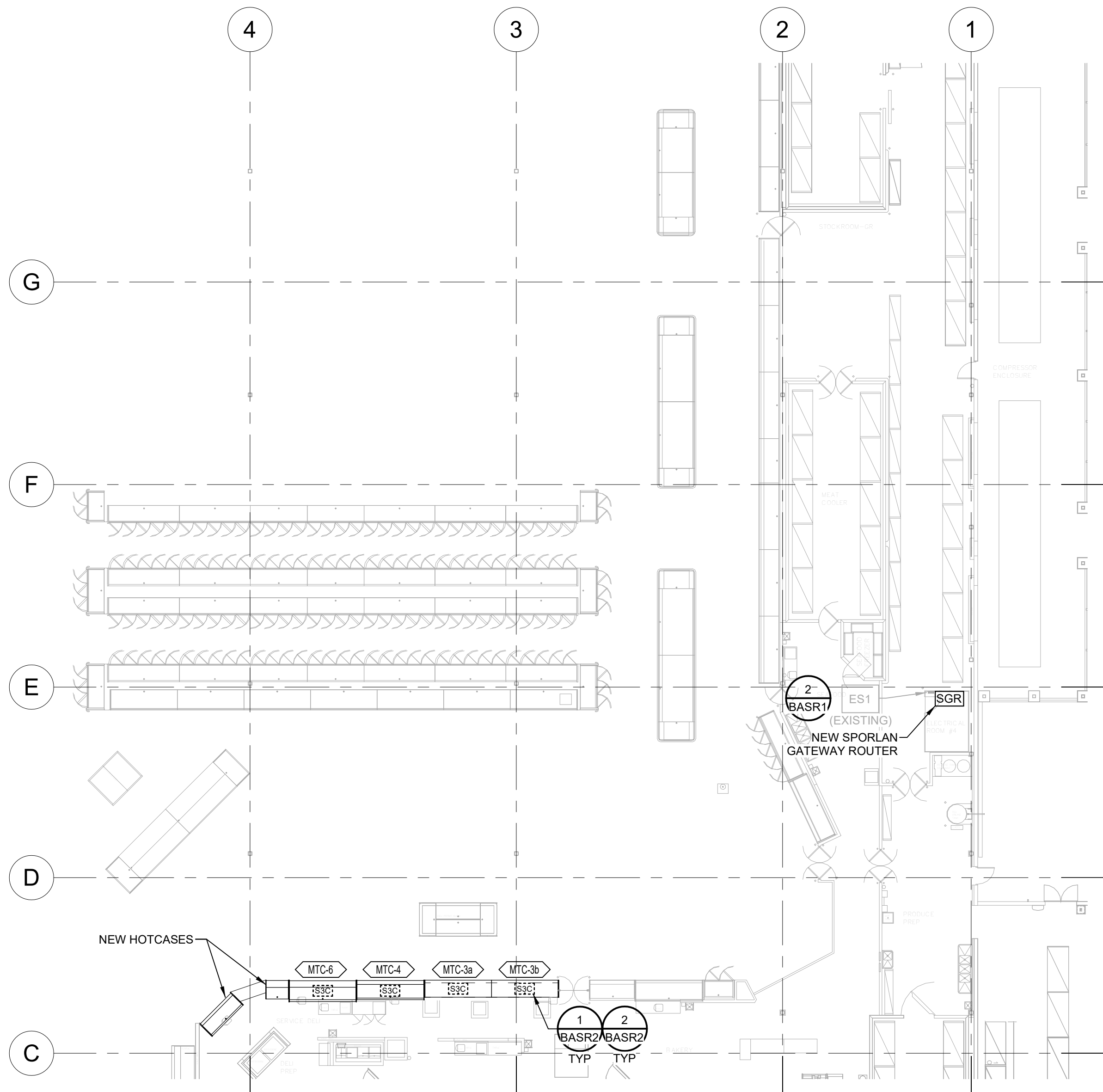

## 2 REFRIGERATION BAS ONE-LINE DIAGRAM

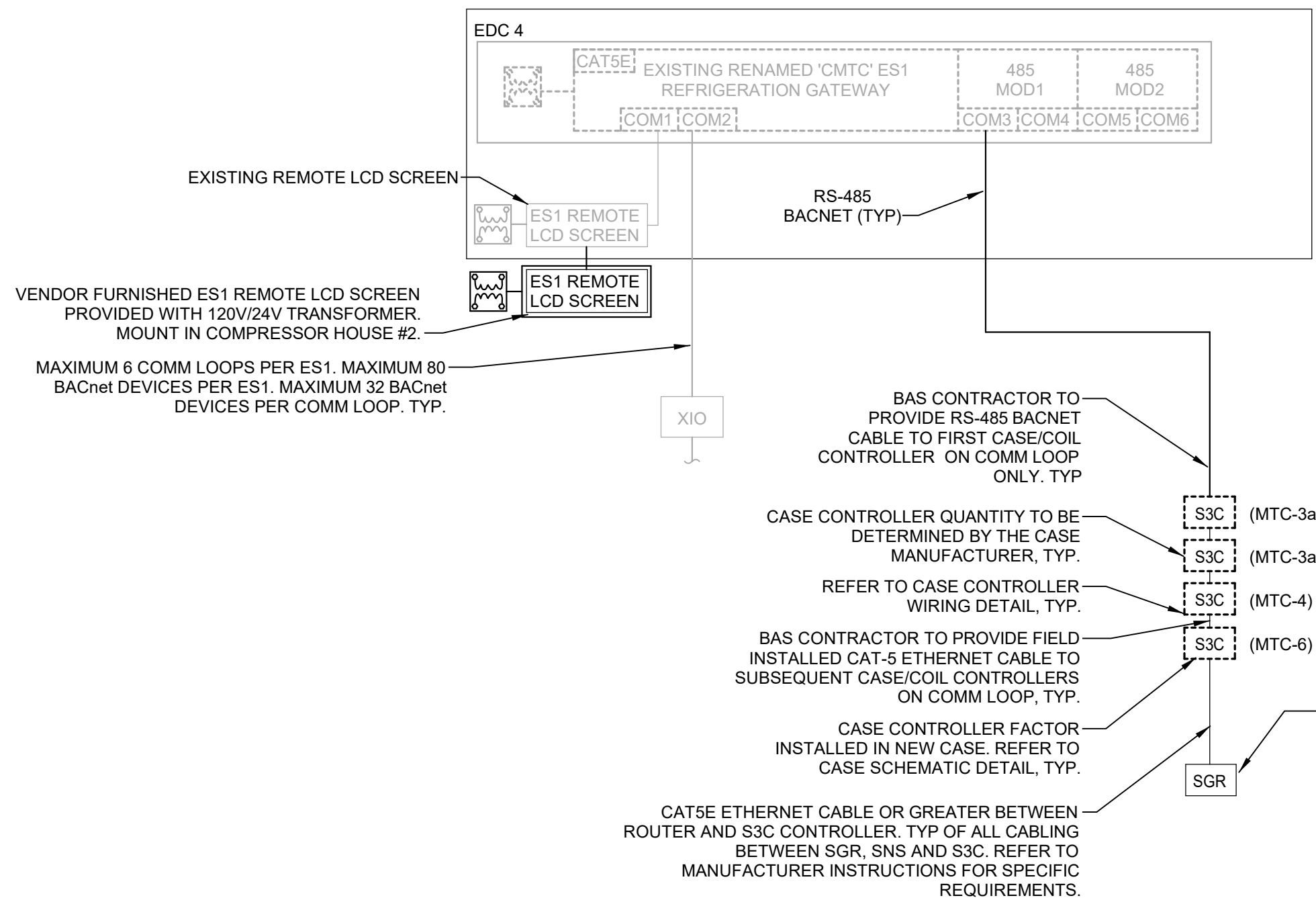
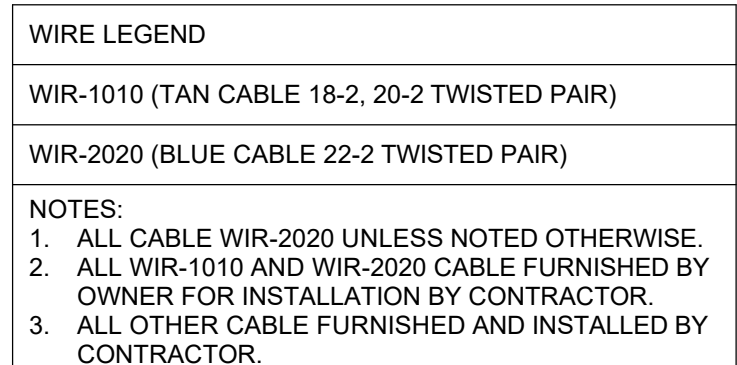

CIM-C2 SCHEDULE (E)		
1	SPARE	(N)
2	SPARE	(N)
3	SPARE	(N)
4	SPARE	(N)
5	SPARE	(E)
6	MT-C-5	(SENSOR)(E)
7	SPARE	(N)
8	SPARE	(N)
AUX	SPARE	(E)

UNLESS NOTED OTHERWISE, DEVICES AND CABLEING SHOWN IN THIS ONE-LINE DIAGRAM ARE VENDOR FURNISHED; REFRIGERATION BUILDING AUTOMATION CONTRACTOR TO INSTALL CABLEING AND DEVICES AND MAKE FINAL TERMINATIONS. REFER TO PLANS FOR DEVICE LOCATIONS.

-SPORLAN GATEWAY ROUTER (REF BASR1 FLOORPLAN FOR LOCATION). SPORLAN GATEWAY TO BE FURNISHED BY OWNER, TYP. REFERENCE ELECTRICAL DRAWINGS FOR 120V POWER SOURCE.

EACH SUBCONTRACTOR IS RESPONSIBLE FOR HAVING A THOROUGH KNOWLEDGE OF ALL DRAWINGS AND SPECIFICATIONS IN THEIR RELATED FIELD. THE FAILURE TO ACQUAINT THEMSELVES WITH THIS KNOWLEDGE DOES NOT RELIEVE THE RESPONSIBILITY OF PERFORMING THE WORK PROPERLY. NO ADDITIONAL COMPENSATION SHALL BE ALLOWED BECAUSE OF CONDITIONS THAT OCCUR DUE TO FAILURE TO FAMILIARIZE WORKERS WITH THIS KNOWLEDGE.

## 03.12.18

1. BAS CONTRACTOR SHALL CONTACT THE BAS SUPPLIERS) TO OBTAIN A CURRENT MODULE CONFIGURATION FROM THE SUPPLIER. TERMINATING SENSOR LEADS AT INPUT MODULES. THE REQUEST FOR THE CONFIGURATION FROM THE SUPPLIER IS TO BE MADE PRIOR TO THE INSTALLATION OF BAS CABLES. WIRING TERMINATIONS SHALL BE LANDED ACCORDING TO THE SUPPLIER CONFIGURATION SHEETS.
2. BAS CONTRACTOR SHALL PROVIDE COMPLETED REFRIGERATION SENSOR INPUT VERIFICATION FORMS TO THE BAS SUPPLIERS) AT THE BEGINNING OF THE REFRIGERATION EQUIPMENT STARTUP. BAS INSTALLER SHALL PROVIDE ASSISTANCE TO THE BAS SUPPLIERS) FOR SPOT CHECKING OF SENSORS AND ACCURACY.
3. ALL BAS CABLE ON THE SALES FLOOR SHALL BE ROUTED IN CONDUIT AND CONCEALED FROM VIEW AND ROUTED ALONGSIDE OTHER PIPING OR CONDUIT AS MUCH AS POSSIBLE.
4. BAS CONTRACTOR SHALL PRESENT AND BE AVAILABLE TO RESOLVE ISSUES AND PROVIDE REFRIGERATION STARTUP ASSISTANCE UNTIL RELEASED BY THE BAS SUPPLIER AND WALMART MECHANICAL CONSTRUCTION MANAGER.
5. DURING THE REFRIGERATION STARTUP, BAS CONTRACTOR SHALL COMPLETE ALL UNRESOLVED REFRIGERATION WORK PRIOR TO WORKING ON OTHER BAS INSTALLATION ITEMS.
6. WHEN THE BAS SUPPLIER IS NOT SCHEDULED TO PERFORM THE ON SITE REFRIGERATION STARTUP, THE BAS CONTRACTOR IS RESPONSIBLE FOR PERFORMING ALL CHECKS AND TESTS TO ENSURE THE REFRIGERATION REFRIGERATION CONTROL SYSTEM. CONTACT THE BAS SUPPLIER FOR THE BLANK TEST VERIFICATION FORMS AND INSTRUCTIONS FOR COMPLETING. ALL COMPLETED TEST VERIFICATION FORMS SHALL BE RETURNED TO THE WALMART MECHANICAL CONSTRUCTION MANAGER.
7. REFER TO ARCHITECTURAL DRAWINGS FOR PIPING INSTALLATION AND SEALING REQUIREMENTS FOR ALL REFRIGERATION ON COOLER/FREEZER PANELS. DO NOT REQUIRE PIPING WITHIN COOLER/FREEZER LINES.
8. ROUTE ALL UTILITY SERVICE LINES (PIPES AND CONDUIT) WITHIN STUD WALLS WHEREVER POSSIBLE. ON COOLER/FREEZER PANELS IN FOOD PREP AREAS WHERE UTILITIES MUST BE EXPOSED, CONTRACTOR TO HAVE THE OPTION OF THE FOLLOWING:
  - A. SURFACE MOUNT UTILITIES WITH NON-CORROSIVE ANCHORS, SEAL BOTH SIDES OF PIPE/CONDUIT TO PANEL CONTINUOUSLY WITH SEALANT.
  - B. INSTALL UTILITIES 1/2" OFF FACE OF PANEL TO ALLOW FOR CLEAN ANCHORS AND ONLY NON-CORROSIVE MATERIALS FOR SPACERS AND ANCHORS.
  - C. COVER UTILITIES WITH 20 GAUGE STAINLESS STEEL BENT PLATES MOUNTED TO WALL WITH NON-CORROSIVE ANCHORS. APPLY CONTINUOUS SEALANT ALONG EDGES AND JOINTS.
9. REFERENCE ARCHITECTURAL DEMOLITION PLANS FOR THE EXTENT OF DEMOLITION WORK REQUIRED.

## 11.02.15

ALL DEMOLISHED NOVAR BAS EQUIPMENT SHALL BE RETURNED TO WALMART MECHANICAL SERVICES CONSTRUCTION MANAGER. EQUIPMENT TO BE RETURNED INCLUDES: EXECUTIVE CONTROLLER(S), IOM(S), CIM(S), CCM(S), ETC. PROVIDE DOCUMENTATION FOR ALL EQUIPMENT REMOVED IN ACCORDANCE WITH SPECIFICATIONS AND REQUIRED CLOSE-OUT DOCUMENTS.

**STIPULATION FOR REUSE**

THIS DRAWING WAS PREPARED FOR USE ON A SPECIFIC SITE AT: PUYALLUP, WA

CONTEMPORANEOUSLY WITH ITS ISSUE DATE ON 10-01-18, AND IT IS NOT SUITABLE FOR USE ON A DIFFERENT PROJECT SITE OR AT A LATER TIME. USE OF THIS DRAWING FOR ANY OTHER PROJECT, OR REUSE OF THE SERVICES OF THE PROJECTED ARCHITECTS AND ENGINEERS, REPRODUCTION OF THIS DRAWING FOR ANY OTHER PROJECT IS NOT AUTHORIZED AND MAY BE CONTRARY TO

[illegible]

CHECKED BY:	DL
DRAWN BY:	LP
PROTO CYCLE:	12/17/21
DOCUMENT DATE:	04/15/22

DOCUMENTS THAT DO NOT  
HAVE THE ARCHITECT OR  
ENGINEER OF RECORD  
SEAL AND SIGNATURE  
SHALL BE CONSIDERED  
NOT FOR CONSTRUCTION

BUILDING  
AUTOMATION  
SYSTEM

SHFFT·  
**BASR1**



REFER TO SHEET BASR4 FOR ALL NOTES PERTAINING TO THIS SHEET.

REFER TO MANUFACTURER'S INSTALLATION INSTRUCTIONS FOR FACTORY WIRING DIAGRAMS, FIELD WIRING TERMINATIONS, AND RS485 BACNET WIRING DETAILS.

NOTE: FOR CASES SERVICED BY A REMOTE CONDENSING UNIT OMIT EEPR

ONE CASE CONTROLLER PER CASE. CASE CONTROLLER FURNISHED AND INSTALLED BY THE CASE MANUFACTURER.

SPORLAN S3C CASE CONTROLLER

RS-485 COMM WIRING FROM REFRIGERATION EXECUTIVE GATEWAY TO FIRST CASE/COIL CONTROLLER ON COMM LOOP. REFER TO ONE-LINE DIAGRAM.

CAT5E ETHERNET CABLE TO NEXT CONTROLLER ON COMM LOOP. REFER TO ONE-LINE DIAGRAM.

CAT5E ETHERNET CABLE FROM PREVIOUS CONTROLLER ON COMM LOOP. REFER TO ONE-LINE DIAGRAM.

CAT5E ETHERNET CABLE BETWEEN S3C AND SPORLAN GATEWAY ROUTER OR SPORLAN NETWORK SWITCH SHALL UTILIZE THE "NEW" OR "PREVIOUS" CONNECTION DEPENDING UPON DEVICE LOCATION WITHIN COMMUNICATION LOOP. REFER TO MANUFACTURER INFORMATION.

FACTORY INSTALLED TERMINAL BLOCK AT EVERY CASE, TYPE

FOR ADDITIONAL INFORMATION REFER TO CASE CONNECTION SCHEMATIC. REFER TO REFRIGERATION

EEP. OWNER TO FURNISH #18 AWG 4 (OR #14 AWG 4 FOR RUNS OVER 250 FT) CONDUCTOR CABLE FOR EEPR VALVE BUILDING AUTOMATION SYSTEM CONTRACTOR TO INSTALL / TERMINATE WIRING AT EEPR AND AT THE "A" CASE TERMINAL BLOCK ONLY. REFER TO REF SCHEDULES FOR QUANTITY AND CIRCUIT NAME.

1/8" = 1'-0" 06/21/18

120V POWER SUPPLY FEED. IN CASE REPLACEMENT APPLICATION WIRING COULD BE EXISTING TO REMAIN, VERIFY RE-USE OF EXISTING WIRING WITH ELECTRICAL. OTHERWISE ELECTRICAL CONTRACTOR TO PROVIDE NEW POWER FEED. REFRIGERATION CONTRACTOR TO TERMINATE WIRING. REF ELECTRICAL.

FACTORY INSTALLED WIRING BETWEEN FAN/LIGHT/ANTI-SWEAT HEATER TERMINALS AT EVERY CASE. IN CASE REPLACEMENT APPLICATION WHERE WIRING IS EXISTING TO REMAIN, REMOVE FACTORY JUMPERS. REF ELECTRICAL.

ELECTRIC DEFOST CASES: IN CASE REPLACEMENT APPLICATION WIRING COULD BE EXISTING TO REMAIN. VERIFY RE-USE OF EXISTING WIRING WITH ELECTRICAL. OTHERWISE ELECTRICAL CONTRACTOR TO PROVIDE 208V POWER FEED. REFRIGERATION CONTRACTOR TO TERMINATE WIRING. REF ELECTRICAL.

LLSV: REFRIGERATION CONTRACTOR TO PROVIDE AND TERMINATE 120VAC # 12 AWG LIQUID LINE SOLENOID VALVE WIRING AT 'A' CASE TERMINAL BLOCK ONLY. REF ELECTRICAL.

EEPR: OWNER TO FURNISH #18 AWG 4 (OR #14 AWG 4 FOR RUNS OVER 250 FT) CONDUCTOR CABLE FOR EEPR VALVE. REFRIGERATION BUILDING AUTOMATION SYSTEMS CONTRACTOR TO TERMINATE WIRING AT EEPR AND AT 'A' CASE TERMINAL BLOCK ONLY. REFER TO REFRIGERATION SCHEDULES AND SUBMITTALS FOR QUANTITY AND CIRCUIT NAME.

COMM. WIRING TO PREVIOUS CONTROLLER ON COMM. LOOP. REFER TO REFRIGERATION BUILDING AUTOMATION SYSTEM PLANS FOR ONE-LINE DIAGRAM. (TYP)

COMM. WIRING TO NEXT CONTROLLER ON COMM. LOOP. REFER TO REFRIGERATION BUILDING AUTOMATION SYSTEM PLANS FOR ONE-LINE DIAGRAM. (TYP)

EEPR: (1) PER REFRIGERATION CIRCUIT.

LLSV: (1) PER REFRIGERATION CIRCUIT.

REFRIGERATED CASE, TYP.

'A' LEAD CASE CONTROLLER. REFER TO REFRIGERATION BUILDING AUTOMATION SYSTEM PLANS FOR LOCATION OF 'A' CASE.

REFRIGERATION BUILDING AUTOMATION SYSTEMS CONTRACTOR TO TERMINATE COMM. WIRING AT CASE CONTROLLER MASTER/SLAVE I/O

CASE CONTROLLER(S) FURNISHED AND INSTALLED BY CASE MANUFACTURER AT EVERY CASE.

DETAIL IS A SCHEMATIC REPRESENTATION AND MAY NOT REFLECT ALL CASE CONFIGURATIONS. SOME FACTORY-INSTALLED COMPONENTS AND WIRING ARE NOT SHOWN FOR CLARITY. CONTACT REFRIGERATED CASE MANUFACTURER FOR FACTORY INSTALLED COMPONENT INFORMATION. THIS DIAGRAM SHOULD NOT BE USED FOR INTERNAL CASE COMPONENT WIRING.

REFER TO MANUFACTURER'S INSTALLATION INSTRUCTIONS FOR COMPLETE FACTORY WIRING DIAGRAMS.

FACTORY WIRING TO LLSV CONTACT STRIP

BUILDING AUTOMATION SYSTEM CONTRACTOR TO PROVIDE CAT-5 ETHERNET CABLE FROM PREVIOUS CONTROLLER ON THE COMM. LOOP. REFER TO ONE-LINE DIAGRAM

BUILDING AUTOMATION SYSTEM CONTRACTOR TO PROVIDE CAT-5 ETHERNET CABLE TO NEXT CONTROLLER ON THE COMM. LOOP. REFER TO ONE-LINE DIAGRAM

S3C CASE CONTROL

E2 POWER

A1 ALARM

C1 COOLING

F1 FANS

E2 DEFOST

L1 LIGHTS

R1 REFRIGERATOR

V1 VALVE

B1 BASI RUTH

RDM VM RUTH

P1 PUMP

S1 SENSORS

T1 THERMISTORS

P1 PRESSURE

D1 DRAIN

O1 OILPRESSURE

H1 HUMIDITY

W1 WIND

PWM

FANS

LIGHTS

ANTI-SWEAT HEATERS

208V ELECTRIC DEFOST

LIQUID LINE SOLENOID VALVE

ELECTRONIC EVAPORATOR PRESSURE REGULATOR

EEPR

LLSV

REFRIGERATED CASE, TYP.

A

B

C

D

1/8" = 1'-0" 01/25/18

EACH SUBCONTRACTOR IS RESPONSIBLE FOR HAVING A THOROUGH KNOWLEDGE OF ALL DRAWINGS AND SPECIFICATIONS IN THEIR RELATED FIELD. THE FAILURE TO ACQUAINT THEMSELVES WITH THIS KNOWLEDGE DOES NOT RELIEVE THE RESPONSIBILITY OF PERFORMING THE WORK PROPERLY. NO ADDITIONAL COMPENSATION SHALL BE ALLOWED BECAUSE OF CONDITIONS THAT OCCUR DUE TO FAILURE TO FAMILIARIZE WORKERS WITH THIS KNOWLEDGE.



City of Puyallup  
Development & Permitting Services  
ISSUED PERMIT

Building

Planning

Engineering

Public Works

Fire

Traffic

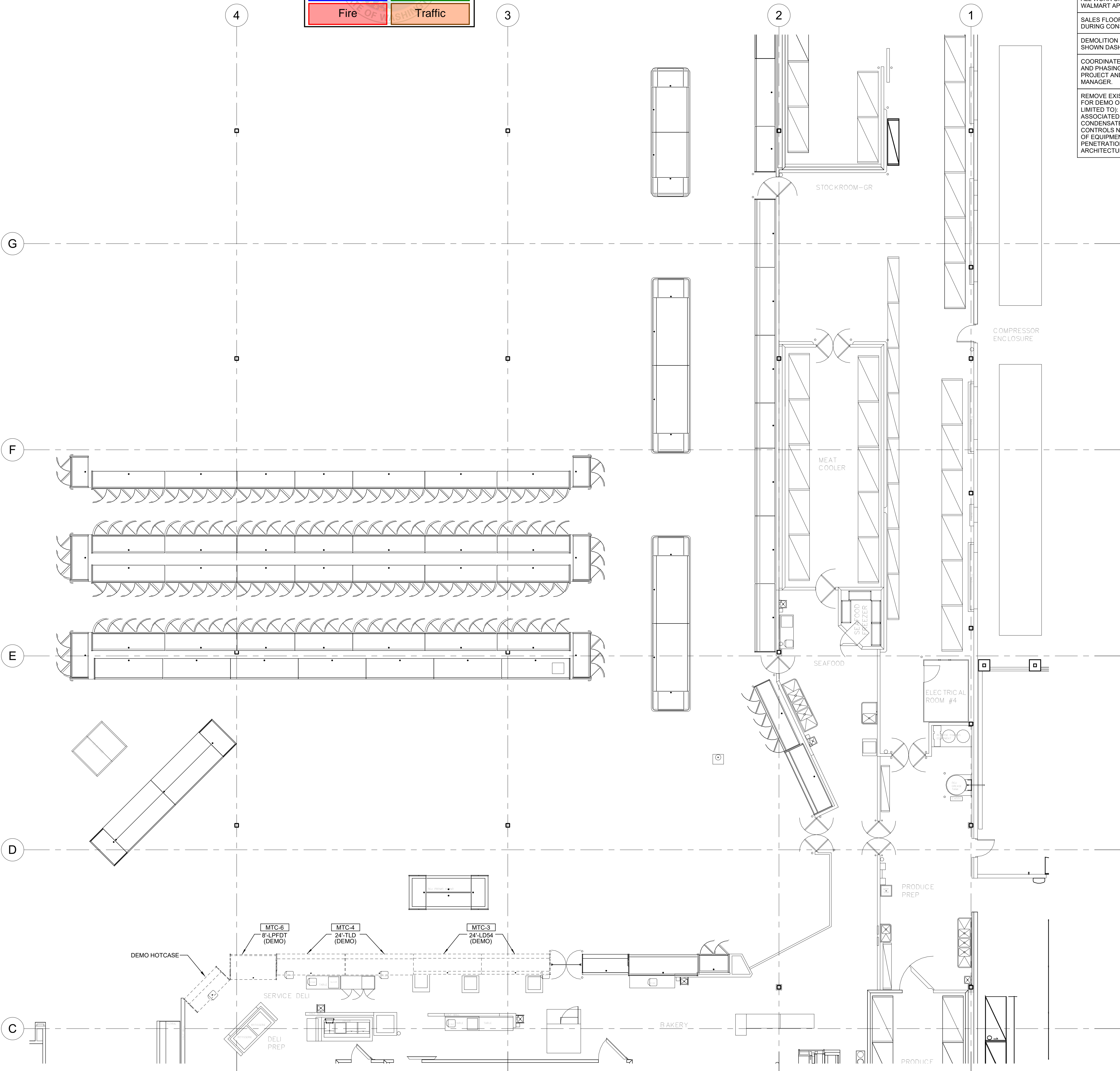

SHEET NOTES

REFER TO SHEET R1 FOR ALL NOTES PERTAINING TO THIS SHEET.

EPA CLEAN AIR ACT

COMPLY WITH CLEAN AIR ACT, TITLE VI, SECTION 608 AND CODE OF FEDERAL REGULATION TITLE 40, PART 82 WHEN ADDING OR REMOVING REFRIGERATED EQUIPMENT. RECORD ALL EQUIPMENT IDENTIFICATION NUMBERS, MODEL AND SERIAL NUMBERS, THE AMOUNT OF REFRIGERANT RECOVERED FROM EACH UNIT, THE DATE OF DECOMMISSIONING, COMPANY NAME AND SIGNATURE OF ON-SITE SUPERVISOR.

ALL WORK ON THIS SHEET IS TO BE COMPLETED BY A WALMART APPROVED CONTRACTOR.

SALES FLOOR TO BE ACCESSIBLE TO CUSTOMERS DURING CONSTRUCTION.

DEMOLITION INCLUDES BUT NOT LIMITED TO ITEMS SHOWN DASHED.

COORDINATE PROJECT SCOPE OF WORK, SCHEDULE AND PHASING WITH CONCURRENT WALMART REMODEL PROJECT AND WALMART MECHANICAL CONSTRUCTION MANAGER.

REMOVE EXISTING REFRIGERATION EQUIPMENT NOTED FOR DEMO OR REPLACEMENT, INCLUDING (BUT NOT LIMITED TO): REFRIGERATED CASES, WALK-IN COILS, ASSOCIATED VALVES, REFRIGERATION AND CONDENSATE PIPING, HANGERS AND SUPPORTS, AND CONTROLS NOT BEING REUSED. COORDINATE DISPOSAL OF EQUIPMENT WITH CONSTRUCTION MANAGER. PATCH PENETRATIONS TO MATCH EXISTING. REFER TO ARCHITECTURAL DRAWINGS.

SHEET NOTES

1. SALES FLOOR TO BE ACCESSIBLE TO CUSTOMERS DURING NON-CONSTRUCTION HOURS. PROVIDE TEMPORARY COVERS CAPABLE OF WITHSTANDING SHOPPING CART TRAFFIC AND OCCUPANTS FOR PITTS AND TUNNELS. REMOVE CONSTRUCTION FENCING AND DUST WALLS INTERFERING WITH CUSTOMER CIRCULATION OR ACCESS.

2. REMOVE WALL STANDARDS ABOVE 96" AFF.

3. DEMOLITION INCLUDES BUT IS NOT LIMITED TO ITEMS SHOWN DASHED. REF DEMOLITION REQUIREMENT NOTE ON N1 SHEET.

4. REMOVE ALL DOORS SHOWN DASHED. REFER TO ENLARGED PLANS AND DOOR SCHEDULE FOR DOOR AND FRAME REPLACEMENT.

5. REMOVE CARPET AND GLUE FROM COLUMNS. PATCH AND REPAIR COLUMNS TO SMOOTH SURFACE PRIOR TO PAINTING.

6. COORDINATE REMOVAL AND DISPOSAL OF EXISTING REFRIGERATED CASES AND FIXTURES WITH MECHANICAL SERVICES CONSTRUCTION MANAGER.

DEMOLITION LEGEND

EXISTING TO REMAIN

DEMOLISH/REMOVE

AREA TO BE DEMOLISHED

RELOCATE

DEMOLITION REQUIREMENTS

1. ALL DEMOLITION SHALL BE CARRIED OUT IN A SAFE MANNER AND IN STRICT ACCORDANCE WITH OSHA REGULATIONS.

2. THE CONTRACTOR SHALL FIELD VERIFY THE EXTENT OF DEMOLITION. THE WORK INCLUDES, BUT IS NOT LIMITED TO, THE DEMOLITION AND REMOVAL OF REFRIGERATION EQUIPMENT, REFRIGERATION LINES, AND ELECTRICAL ITEMS INCLUDING CONDUITS AS SHOWN ON DRAWING OR AS REQUIRED FOR THE INSTALLATION OF NEW WORK FOR A COMPLETE JOB.

3. WHEN UTILITIES ARE REMOVED, CAP AND SEAL A MINIMUM OF 8" BELOW FINISH FLOOR OR A MINIMUM OF 6" ABOVE FINISHED CEILING. SHOW ALL ABANDONED AND CAPPED UTILITIES ON AS-BUILT, DRAWINGS, AND RECORDED DOCUMENTS.

4. IT IS THE CONTRACTOR'S RESPONSIBILITY TO PROVIDE ADEQUATE SHORING, BRACING, AND SUPPORT SYSTEMS TO KEEP THE EXISTING STRUCTURE INTACT AND IN A SAFE CONDITION DURING THE REMOVAL OF STRUCTURAL ITEMS AND NEW CONSTRUCTION.

5. THE CONTRACTOR SHALL RETAIN A REGISTERED PROFESSIONAL ENGINEER TO DESIGN THE SHORING AND SPECIFY DEMOLITION PROCEDURES.

6. IT IS THE CONTRACTOR'S RESPONSIBILITY FOR MEANS AND METHODS OF DEMOLITION AND NEW CONSTRUCTION. PRIOR TO THE EXCAVATION OF FOUNDATIONS ADJACENT TO THE EXISTING STRUCTURE, PROVIDE ADEQUATE SUPPORT FOR THE SUB-BASE TO PREVENT UNDERMINING.

7. DURING DEMOLITION AND RECONSTRUCTION, THE CONTRACTOR SHALL COORDINATE WITH THE WALMART CONSTRUCTION MANAGER ANY REQUIRED SAFETY BARRIERS OR BARRICADES. REFER TO THE WALMART CONSTRUCTION MANAGER FOR PHASING AND SCHEDULING DEMOLITION AND NEW CONSTRUCTION.

8. CONDUCT ALL DEMOLITION AND REMOVAL OF DEBRIS AS REQUIRED TO INSURE MINIMUM INTERFERENCE WITH BUILDING SITE FACILITIES AND OPERATIONS. REFERENCE SALVAGE REQUIREMENTS.

9. NOTES INDICATING DEMOLITION WORK ARE NOT CONFINED SOLELY TO THE DEMOLITION PLANS. THE GENERAL CONTRACTOR SHALL REVIEW ALL CONSTRUCTION DOCUMENTS, INCLUSIVE OF SCHEDULES AND SPECIFICATIONS, TO DETERMINE FULL EXTENT OF DEMOLITION WORK.

SALVAGE REQUIREMENTS

IMMEDIATE SALVAGE/LEGAL DISPOSAL OF ALL DECOMMISSIONED EQUIPMENT AND CONSTRUCTION DEBRIS SHALL BE THE RESPONSIBILITY OF THE CONTRACTOR. THE GENERAL CONTRACTOR WILL COORDINATE DISPOSAL OF OTHER MATERIALS WITH RES AND/OR WASTE MANAGEMENT.

RECLAIMED REFRIGERANT WILL REMAIN IN THE POSSESSION OF WALMART STORES, INC. ON APPLICABLE PROJECTS INVOLVING GAS CONVERSION. THE CONTRACTOR SHALL ASSIST WALMART IN THE SCHEDULING OF APPROPRIATE CYLINDERS FOR THE COLLECTION OF REFRIGERANTS, WHICH WALMART WILL PROCESS THROUGH THEIR VENDOR RECLAMATION PROGRAM, OR USE IN OTHER WALMART EQUIPMENT, AT THE DISCRETION OF THE WALMART CONSTRUCTION MANAGER. THE CONTRACTOR AND WALMART CONSTRUCTION MANAGER MUST RECORD THE USAGE OR DECOMMISSIONING OF THE REFRIGERANT LOGS AT THE COMPRESSOR RACKS.

INSTALLING CONTRACTOR WILL REMOVE AXP DEVICES MOUNTED ON WALK-IN BOXES PRIOR TO THE BOX DEMO AND HANDOVER TO STORE MANAGEMENT FOR SAFE STORAGE OF EQUIPMENT. GENERAL CONTRACTOR WILL PROVIDE NEW CONDUIT IN THE SAME LOCATION ON THE NEW WALK-IN BOXES. INSTALLING CONTRACTOR WILL NOTIFY CTS OF EQUIPMENT/CABLE RE-INSTALL DATE. CTS WILL ARRANGE FOR CABLING CONTRACTOR TO RUN WIRE AND RE-INSTALL AXP DEVICES.

SALVAGE OF WALK-IN PANELS AND WALK-IN DOORS WILL BE THE RESPONSIBILITY OF THE PANEL MANUFACTURER.

NOTICE: THESE SALVAGE REQUIREMENTS DO NOT INCLUDE HVAC EQUIPMENT, RACKHOUSES CONDENSERS, REMOTE CONDENSING UNITS, COOLING TOWERS AND FLUID COOLER REPLACEMENTS.

ROLE OF WASTE MANAGEMENT:

DELIVER CONTAINERS BASED ON DELIVERY DATES PROVIDED BY THE GENERAL CONTRACTOR.

SERVICE FOR THE CONTAINERS AS REQUESTED.

SUPPORT PERSONAL AT ALL TIMES DURING THE PROJECT DURATION.

REPORTING FOR SERVICES THAT OCCUR AT THE END OF THE PROJECT.

ROLE OF GENERAL CONTRACTOR (GC):

CONTACT WASTE MANAGEMENT 72 HOURS PRIOR TO PROJECT LAUNCH TO HAVE ESTABLISHED SERVICES DELIVERED.

WASTE MANAGEMENT C&D TEAM

1-866-338-2342 OR OAKLEAFCDTEAM@WM.COM

BERNICE MURPHY 1-866-255-6317 OR BMURPHY22@WM.COM

MICHAEL LASSONDE 1-866-268-6317 OR MLASSONDE@WM.COM

ESTABLISHED SERVICES WILL BE DETERMINED FROM THE PROJECT ESTIMATION FORM FILLED OUT BY THE GC.

REQUEST ALL NEEDS FOR CONTAINERS FOR SERVICE VIA PHONE OR EMAIL TO WM'S NATIONAL ACCOUNTS OFFICE.

DC ENGINEERING  
Careful listening. Dynamic solutions.  
www.dceengineering.net  
Phone: 206.268.2161  
Project: 221601

STIPULATION FOR REUSE  
THIS DRAWING MAY BE REPRODUCED FOR USE IN A DIFFERENT PROJECT, BUT THE USER SHALL BE RESPONSIBLE FOR OBTAINING ALL NECESSARY PERMITS AND FOR THE USER'S OWN LIABILITY FOR THE USE OF THIS DRAWING FOR ANY PURPOSE OTHER THAN THAT FOR WHICH IT WAS ORIGINALLY PREPARED. THE USER SHALL BE RESPONSIBLE FOR THE PROTECTION OF THE DRAWING FROM UNAUTHORIZED REPRODUCTION AND FOR THE PROTECTION OF THE DRAWING FROM UNAUTHORIZED REUSE.

Walmart  
PUYALLUP, WA  
STORE NO. 2403-605  
102371 | CAPX REF-3  
JOB NUMBER:

ISSUE BLOCK

CHECKED BY: DL  
DRAWN BY: LP  
PROTO CYCLE: 12/17/21  
DOCUMENT DATE: 04/15/22

SEAL AND SIGNATURE  
NOT FOR CONSTRUCTION

04/25/23

DOCUMENTS THAT DO NOT HAVE THE ARCHITECT OR ENGINEER OF RECORD SEAL AND SIGNATURE SHALL BE CONSIDERED NOT FOR CONSTRUCTION

REFRIGERATION DEMO PLAN

SHEET: RD1

1 FRONT REFRIGERATION DEMO PLAN  
1/8" = 1'-0"

EXISTING CONDITIONS WERE TAKEN FROM ORIGINAL DRAWINGS AND MAY NOT REFLECT EXACT "AS-BUILT" CONDITIONS. CONTRACTOR SHALL FIELD VERIFY ALL EXISTING CONDITIONS PRIOR TO SUBMITTING FINAL BIDS. CONTRACTOR SHALL CAREFULLY COORDINATE NEW WORK AND DEMOLITION WITH ALL OTHER DISCIPLINES AND EXISTING CONDITIONS.

EACH SUBCONTRACTOR IS RESPONSIBLE FOR HAVING A THOROUGH KNOWLEDGE OF ALL DRAWINGS AND SPECIFICATIONS IN THEIR RELATED FIELD. THE FAILURE TO ACQUAINT THEMSELVES WITH THIS KNOWLEDGE DOES NOT RELIEVE THE RESPONSIBILITY OF PERFORMING THE WORK PROPERLY. NO ADDITIONAL COMPENSATION SHALL BE ALLOWED BECAUSE OF CONDITIONS THAT OCCUR DUE TO FAILURE TO FAMILIARIZE WORKERS WITH THIS KNOWLEDGE.



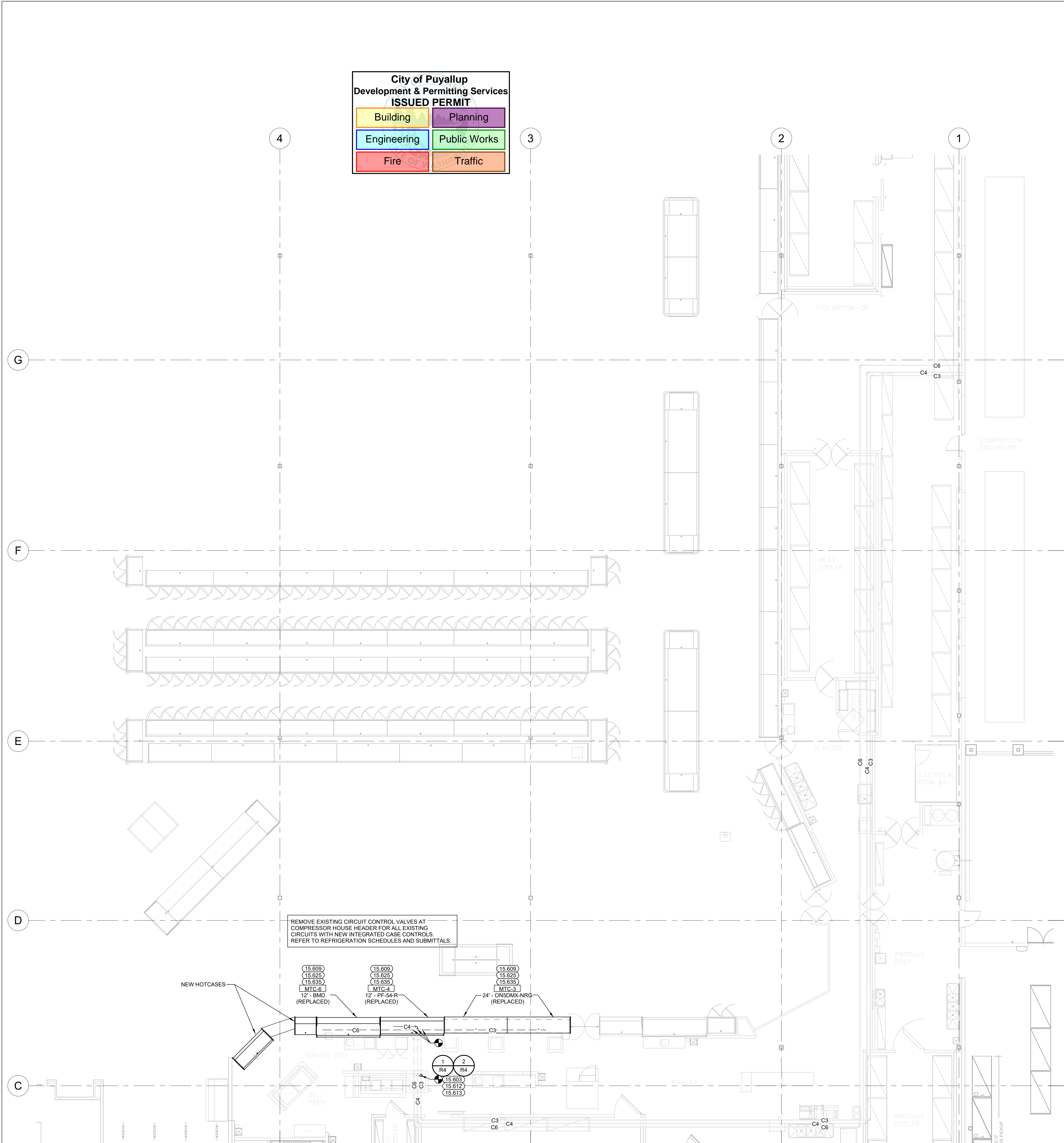

City of Puyallup  
Development & Permitting Services  
ISSUED PERMIT

Building

Planning

Engineering

Public Works

Fire

Traffic

REFRIGERATION KEYNOTES

15.603 AT ALL POINTS WHERE SUCTION LINES RISE, PROVIDE A SUCTION LINE TRAP AT THE BASE OF THE RISER.

15.609 PROVIDE PVC DRAIN LINE FROM EACH CASE DRAIN CONNECTION SAME SIZE AS CASE OUTLET, AND END OVER FLOOR RECEPTOR. CONTRACTOR SHALL ENSURE RECEPTOR(S) AND DRAIN LINE(S) SERVING CASE LINE-UP ARE FREE OF OBSTRUCTIONS AND FUNCTION PROPERLY. WHERE EXTENSIVE DAMAGE EXISTS AND/OR PROPER DRAINAGE CANNOT BE OBTAINED COORDINATE WITH WALMART MECHANICAL CONSTRUCTION MANAGER.

15.612 PROVIDE INTERMEDIATE SUCTION LINE TRAP IN WALL OR VOID SPACE. INTERMEDIATE TRAP SHOULD BE PLACED AT THE MIDPOINT OF ANY SUCTION LINE RISE WHICH EXCEEDS 16 FEET.

15.613 REPLACE EXISTING SUCTION RISER. REFER TO PIPING SCHEDULE FOR SIZE.

15.625 ROUTE REFRIGERATION LINES IN BASE OF CASE FOR ALL BOTTOM FED CONNECTED CASES. SLOPE BACK TO COMPRESSOR AT 1" PER 20'-0" OF RUN.

15.635 REFRIGERATION CONTRACTOR SHALL INSTALL REFRIGERATION MANUFACTURER-FURNISHED LIQUID LINE SOLENOID VALVE AND EVAPORATOR PRESSURE REGULATOR IN A SERVICE ACCESSIBLE LOCATION INSIDE CASE DRAIN PAN. CONTRACTOR SHALL FURNISH AND INSTALL FULL PORT ISOLATION BALL VALVE IN A SERVICE ACCESSIBLE LOCATION INSIDE CASE DRAIN PAN. INSTALL CONTROL WIRING FROM VALVES BACK TO CASE OR RACK CONTROLLER. REFER TO REFRIGERATION SUBMITTALS/SCHEDULES AND BAS PLANS FOR EXACT REQUIREMENTS. REFER TO SPECIFICATIONS FOR ASSET TAGGING REQUIREMENTS.

REFRIGERATION SYMBOLS

X##

XXX

CO II-

---

####

-----

ETR

(TYP)

CIRCUIT NUMBER

MODEL NUMBER

CLEANOUTS (CO)

CONDENSATE DRAIN LINE (CD)

CONNECT TO EXISTING

CONTINUATION

DETAIL NUMBER

SHEET NUMBER

EVAPORATOR COIL

ISOLATION VALVE

ELBOW - TURNED DOWN

ELBOW TURNED UP

REFRIGERATION KEYNOTE REFERENCE

REFRIGERATION FITTING (ABOVE)

REFRIGERATION PIPING (BELOW)

EXISTING TO REMAIN

TYPICAL

24 HOURS PRIOR TO SHUTTING DOWN ANY REFRIGERATION SYSTEMS, HVAC SYSTEMS OR BUILDING AUTOMATION CONTROLS SYSTEMS, SEND EMAIL TO NSRM@WALMART.COM. THE E-MAIL SHALL STATE WHAT, WHY, AND WHEN IT IS BEING SHUT DOWN AND HOW LONG IT IS ANTICIPATED TO BE SHUT DOWN. THEN SEND A FOLLOW UP EMAIL TO NSRM@WALMART.COM AFTER THE WORK IS COMPLETE AND THE SYSTEM IS BACK UP AND RUNNING.

REFERENCE ARCHITECTURAL DRAWINGS FOR ALL NEW CASES BEING INSTALLED FOR CONNECTION LOCATION OF UTILITIES. (TOP FED VS BOTTOM FED)

SEPARATE CONTRACTOR IS RESPONSIBLE FOR RE-SKIN OF EXISTING REFRIGERATED CASES TO REMAIN.

ALL WORK ON THIS SHEET IS TO BE COMPLETED BY A WALMART APPROVED CONTRACTOR.

REFRIGERATION CONTRACTOR IS RESPONSIBLE FOR ALL FINAL REFRIGERATION ELECTRICAL TERMINATIONS TO REFRIGERATION EQUIPMENT.

VERIFY EXACT LOCATION OF ALL REFRIGERATED CASES WITH FINAL MERCHANDISE PLAN.

COORDINATE LOCATION OF REFRIGERATED CASES WITH PLUMBING CONTRACTOR PRIOR TO CUTTING OF FLOOR AND SETTING DRAINS.

ALL EXISTING REFRIGERATED CASES ARE TO REMAIN UNLESS NOTED OTHERWISE.

IF REPLACED REFRIGERANT LINE SIZES ARE LARGER THAN SUCTION OR LIQUID HEADER STUB SIZES, REPLACE STUB WITH SAME SIZE AS NEW REFRIGERANT LINE. COORDINATE WITH CONSTRUCTION MANAGER AND RACK OEM.

CONTRACTOR TO RE-USE EXISTING CASE DRAINS. REPLACE DRAIN IF MORE THAN 1/2 OF DRAIN IS EXPOSED TO SALES FLOOR. FIELD VERIFY EXACT LOCATIONS.

PROJECT COORDINATED WITH REFRIGERATION VENDOR (OEM) AS INDICATED ON REFRIGERATION SCHEDULE(S).

PRIOR TO INSTALLING ANY EQUIPMENT OR ADJUSTING RACK PARAMETERS, REFRIGERATION CONTRACTOR SHALL REQUEST A SUCTION GROUP REPORT FOR ALL RACKS AND SUCTION GROUPS WHERE WORK IS PERFORMED. REQUEST VIA EMAIL AT B.PTEAM1@WAL-MART.COM

EPA CLEAN AIR ACT

COMPLY WITH CLEAN AIR ACT, TITLE VI, SECTION 608 AND CODE OF FEDERAL REGULATION TITLE 40, PART 82 WHEN ADDING OR REMOVING REFRIGERATED EQUIPMENT. RECORD ALL EQUIPMENT IDENTIFICATION NUMBERS, MODEL AND SERIAL NUMBERS, THE AMOUNT OF REFRIGERANT RECOVERED FROM EACH UNIT, THE DATE OF DECOMMISSIONING, COMPANY NAME AND SIGNATURE OF ON-SITE SUPERVISOR.

GENERAL NOTES

1. PLANS INDICATE GENERAL ROUTING OF REFRIGERANT LINES, WITH A SINGLE LINE SHOWN INDICATING BOTH SUCTION AND LIQUID LINE ROUTING FOR EACH SYSTEM.

2. REFRIGERATION SYSTEM INSTALLATION SHALL BE IN COMPLETE CONFORMANCE WITH SPECIFICATIONS, AND WITH ALL REQUIREMENTS OF REFRIGERATION EQUIPMENT MANUFACTURER.

3. REFRIGERATION DRAWINGS ARE PROVIDED AS AN AID TO BIDDERS AND TO INDICATE DESIRED ROUTING OF REFRIGERATION LINES; CONTRACTOR SHALL ASSUME FULL RESPONSIBILITY FOR CORRECT INSTALLATION OF PIPING AND ACCESSORIES TO PROVIDE A COMPLETE AND FULLY OPERATING SYSTEM.

4. REFER TO SPECIFICATION 15600 FOR INSULATION THICKNESS. INSIDE DIAMETER OF INSULATION SHALL MATCH PIPE DIAMETER TO MINIMIZE AIR GAPS BETWEEN PIPING AND INSULATION. PROVIDE FACTORY PNE-MANUFACTURED FITTINGS AT ALL TRAPS AND ELBOWS. WHERE PRE-MANUFACTURED FITTINGS ARE UNAVAILABLE MITER CUT ALL FITTINGS TO ENSURE PROPER SEAL BETWEEN INSULATION SEGMENTS.

5. PIPE INSULATION SHALL BE BLACK.

6. COORDINATE REFRIGERATION DEMOLITION ISSUES WITH THE ARCHITECTURAL DRAWINGS. REFER TO ARCHITECTURAL PLANS FOR REFRIGERATION EQUIPMENT DEMOLITION AND COOLER REPAIR AND REMODELING.

7. REFRIGERATION SYSTEM SHALL REMAIN OPERATIONAL DURING REMODELING. DURING THE PHASING OF OLD TO NEW SYSTEMS, BOTH NEW AND OLD REFRIGERATION SYSTEMS MAY BE REQUIRED TO OPERATE AT THE SAME TIME FOR A SHORT PERIOD.

8. WHERE NEW REFRIGERATED EQUIPMENT IS INDICATED ON THE DRAWINGS, PROVIDE DEMOLITION, REMOVAL, AND TEMPORARY STORAGE OF OLD EQUIPMENT PER WALMART MECHANICAL SERVICES CONSTRUCTION MANAGER'S INSTRUCTIONS, AND REFRIGERATION DEMO NOTES.

9. COORDINATE REMOVAL AND DISPOSAL OF EXISTING EVAPORATORS, REFRIGERATED CASES, AND CONDENSING UNITS, WITH WALMART MECHANICAL SERVICES CONSTRUCTION MANAGER.

10. REMOVE COPPER LINES, EVAPORATORS, AND CONDENSATE LINES FROM COOLERS/ FREEZERS BEING REMOVED FROM SITE. COORDINATE WITH WALK-IN PANEL VENDOR FOR TIME LINE OF REPLACEMENT. REFERENCE SPECIFICATION FOR CONTACT INFORMATION.

11. WALK-IN PANEL VENDOR SHALL PROPERLY PREPARE ALL COOLER/FREEZER PANELS, GLASS DOORS, SLIDER OR SWING DOORS TO PALLETIZE, AND PREPARE THE EQUIPMENT TO SHIP OFF SITE.

12. COORDINATE WITH FIRE PROTECTION CONTRACTOR FOR THE REMOVAL OF SPRINKLERS FOR ALL REMOVED COOLER/FREEZER BOXES.

13. COORDINATE WITH ELECTRICAL CONTRACTOR FOR THE REMOVAL OF ALL REMOVED COOLER/FREEZER BOXES ELECTRICAL WIRING DEVICES.

14. COORDINATE WITH BAS CONTRACTOR FOR THE REMOVAL OF ALL REMOVED COOLER/FREEZER BOXES BAS WIRING AND DEVICES.

15. EXISTING REFRIGERATION PIPING MAY BE RE-USED UNLESS OTHERWISE NOTED ON PLANS. REFER TO SCHEDULES FOR PIPE SIZE REQUIREMENTS.

16. BUILDING COMPONENTS ABANDONED BY THE SCOPE OF WORK SHALL BE SECURED TO PREVENT FALLING, LOOSENING, OR CREATING DAMAGE OF ANY KIND IN THE FUTURE.

17. IF ANY RACK SYSTEMS WILL BE OPENED TO ADD OR REPLACE CASES, EVAPORATORS, ETC. THEN 24 TO 48 HOURS AFTER THE WORK IS COMPLETED AND ALL FINAL ADJUSTMENTS HAVE BEEN MADE, PROVIDE AND CHANGE LIQUID LINE FILTER CORES, OIL SYSTEM FILTER USING SPORLAN OF STYLE FILTER, AND REPLACE SUCTION FILTERS. FILTERS ARE TO BE RATED FOR WAX REMOVAL. CONTRACTOR TO PROPERLY DISPOSE OF OIL AND COMPONENTS REPLACED. REFER TO SPECIFICATION 15600.

18. REFER TO GROCERY ARCHITECTURAL DRAWINGS FOR ADDITIONAL WORK BY REFRIGERATION CONTRACTOR.

19. INSTALL ASSET TAGS ON ALL NEW REFRIGERATED CASES AND COMPLETE THE DATA COLLECTION INFORMATION. DELETE DEMOED ASSETS FROM ASSET TAGGING APPLICATION. REFER TO SPECIFICATIONS.

20. UPON START-UP OF ALL NEW REFRIGERATED EQUIPMENT, CONSTRUCTION MANAGER SHALL REQUEST THE BUILDING PERFORMANCE REPORT FOR ALL RACKS AND SUCTION GROUPS WHERE WORK IS PERFORMED. ANY DEVIATIONS NOTED ON THE REPORT MUST BE CORRECTED PRIOR TO PROJECT CLOSE OUT. REQUEST VIA EMAIL AT B.PTEAM1@WAL-MART.COM

FOOD PREP AREA NOTES

1. ROUTE ALL PIPING CONCEALED WITHIN STUD WALLS WHEREVER POSSIBLE.

2. ALL EXPOSED PIPE INSULATION SHALL BE CLAD PER SPECIFICATIONS. EXPOSED PIPING SHALL COMPLY WITH ONE OF THE FOLLOWING INSTALLATION OPTIONS:  
A. SURFACE MOUNTING PIPING WITH NON-CORROSIVE ANCHORS; SEAL BOTH SIDES OF PIPE TO SURFACE CONTINUOUSLY WITH SEALANT.  
B. INSTALL PIPING 1/2" OFF FACE OF SURFACE TO ALLOW FOR CLEANING. USE ONLY NON-CORROSIVE MATERIALS FOR ANCHORS AND SPACERS.  
C. COVER PIPING WITH 20 GAUGE STAINLESS STEEL BENT PLATES MOUNTED TO SURFACE WITH NON-CORROSIVE ANCHORS; APPLY CONTINUOUS SEALANT ALONG EDGES AND JOINTS.

3. PROPER INSTALLATION OF SEALANTS IS CRITICAL TO MEETING WALMART QUALITY STANDARDS. PROVIDE SEALANTS IN ACCORDANCE WITH DRAWINGS AND SPECIFICATIONS. REFERENCE SECTION 07900 FOR SEALANT SCHEDULE.

4. INTERIOR SEALANTS USED IN FOOD PREP AREAS SHALL MEET THE REQUIREMENTS FOR USE IN USDA REGULATED FACILITIES. PROVIDE CONTINUOUS USDA APPROVED SEALANT AT ALL JOINTS BETWEEN MATERIALS ON WALLS IN FOOD PREPARATION COOLER AND FREEZER AREAS.

5. ALL JOINTS BETWEEN DISSIMILAR MATERIALS SHALL BE SEALED AS REQUIRED FOR A COMPLETE AND PROPER INSTALLATION, REGARDLESS OF WHETHER SHOWN ON DRAWINGS OR NOT.

EXISTING CONDITIONS WERE TAKEN FROM ORIGINAL DRAWINGS AND MAY NOT REFLECT EXACT "AS-BUILT" CONDITIONS. CONTRACTOR SHALL FIELD VERIFY ALL EXISTING CONDITIONS PRIOR TO SUBMITTING FINAL BIDS. CONTRACTOR SHALL CAREFULLY COORDINATE NEW WORK AND DEMOLITION WITH ALL OTHER DISCIPLINES AND EXISTING CONDITIONS.

EACH SUBCONTRACTOR IS RESPONSIBLE FOR HAVING A THOROUGH KNOWLEDGE OF ALL DRAWINGS AND SPECIFICATIONS IN THEIR RELATED FIELD. THE FAILURE TO ACQUAINT THEMSELVES WITH THIS KNOWLEDGE DOES NOT RELIEVE THE RESPONSIBILITY OF PERFORMING THE WORK PROPERLY. NO ADDITIONAL COMPENSATION SHALL BE ALLOWED BECAUSE OF CONDITIONS THAT OCCUR DUE TO FAILURE TO FAMILIARIZE WORKERS WITH THIS KNOWLEDGE.

DC ENGINEERING  
Careful listening. Dynamic solutions.  
www.dceengineering.net  
Phone 206.286.2461  
Project 2219601

STIPULATION FOR REUSE  
THIS DRAWING MAY BE REUSED FOR USE IN ANY PROJECT, BUT NOT FOR THE SAME PROJECT, WITHOUT THE WRITTEN CONSENT OF DC ENGINEERING. ANY REUSE OF THIS DRAWING FOR A DIFFERENT PROJECT WITHOUT THE WRITTEN CONSENT OF DC ENGINEERING SHALL BE AT THE USER'S SOLE RISK. DC ENGINEERING SHALL NOT BE RESPONSIBLE FOR ANY DAMAGE OR INJURY RESULTING FROM THE REUSE OF THIS DRAWING. THE USER SHALL BE RESPONSIBLE FOR OBTAINING ALL NECESSARY PERMITS AND APPROVALS FOR THE REUSE OF THIS DRAWING.

Walmart  
PUYALLUP, WA  
STORE NO. 2403-605  
1023271 / CAPX REF-3  
JOB NUMBER

ISSUE BLOCK

CHECKED BY: DL  
DRAWN BY: LP  
PROTO CYCLE: 12/17/21  
DOCUMENT DATE: 04/15/22

SEAL OF THE STATE OF WASHINGTON  
JULIA A. BROWN  
REGISTERED PROFESSIONAL ENGINEER  
NO. 41741  
04/25/23  
DOCUMENTS THAT DO NOT HAVE THE ARCHITECT OR ENGINEER OF RECORD SEAL AND SIGNATURE SHALL BE CONSIDERED NOT FOR CONSTRUCTION

REFRIGERATION PLAN

SHEET: R1





Walmart  
PUYALLUP, WA

[illegible]

04/25/2022

DOCUMENTS THAT DO NOT HAVE THE ARCHITECT OR ENGINEER OF RECORD SEAL AND SIGNATURE SHALL BE CONSIDERED NOT FOR CONSTRUCTION

EXISTING CONDITIONS WERE TAKEN FROM ORIGINAL DRAWINGS AND MAY NOT REFLECT EXACT "AS-BUILT" CONDITIONS. CONTRACTOR SHALL FIELD VERIFY ALL EXISTING CONDITIONS PRIOR TO SUBMITTING FINAL BIDS. CONTRACTOR SHALL CAREFULLY COORDINATE NEW WORK AND DEMOLITION WITH ALL OTHER DISCIPLINES AND EXISTING CONDITIONS.	EACH SUBCONTRACTOR IS RESPONSIBLE FOR HAVING A THOROUGH KNOWLEDGE OF ALL DRAWINGS AND SPECIFICATIONS IN THEIR RELATED FIELD. THE FAILURE TO ACQUAINT THEMSELVES WITH THIS KNOWLEDGE DOES NOT RELIEVE THE RESPONSIBILITY OF PERFORMING THE WORK PROPERLY. NO ADDITIONAL COMPENSATION SHALL BE ALLOWED BECAUSE OF CONDITIONS THAT OCCUR DUE TO FAILURE TO FAMILIARIZE WORKERS WITH THIS KNOWLEDGE.
--	--

EXISTING CONDITIONS WERE TAKEN FROM ORIGINAL DRAWINGS AND MAY NOT REFLECT EXACT "AS-BUILT" CONDITIONS. CONTRACTOR SHALL FIELD VERIFY ALL EXISTING CONDITIONS PRIOR TO SUBMITTING FINAL BIDS. CONTRACTOR SHALL CAREFULLY COORDINATE NEW WORK AND DEMOLITION WITH ALL OTHER DISCIPLINES AND EXISTING CONDITIONS.



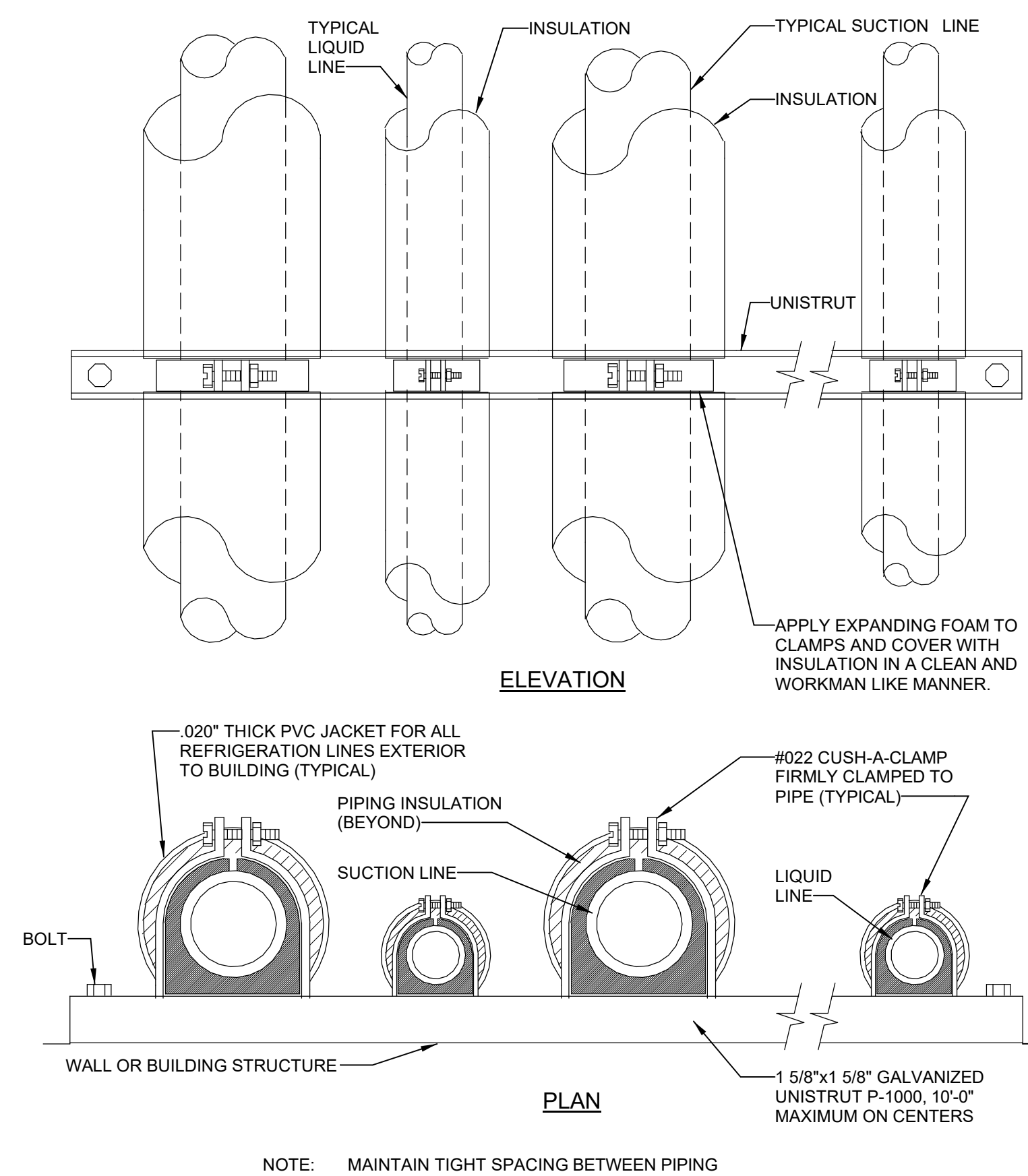
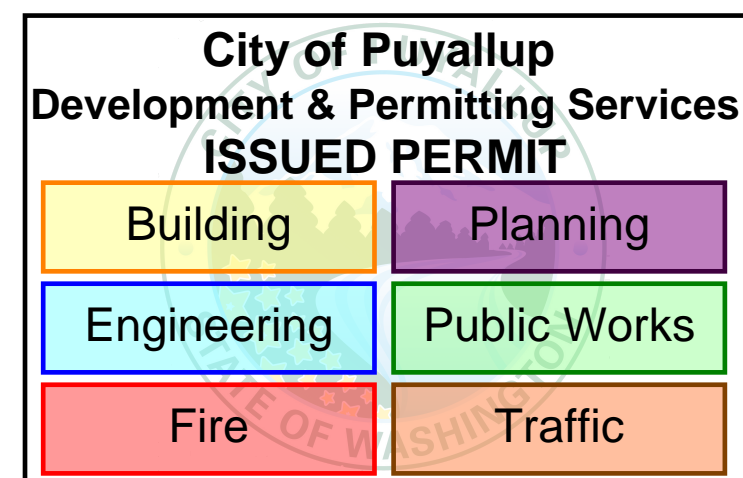

## 2 VERTICAL REFRIGERANT LINE SUPPORT

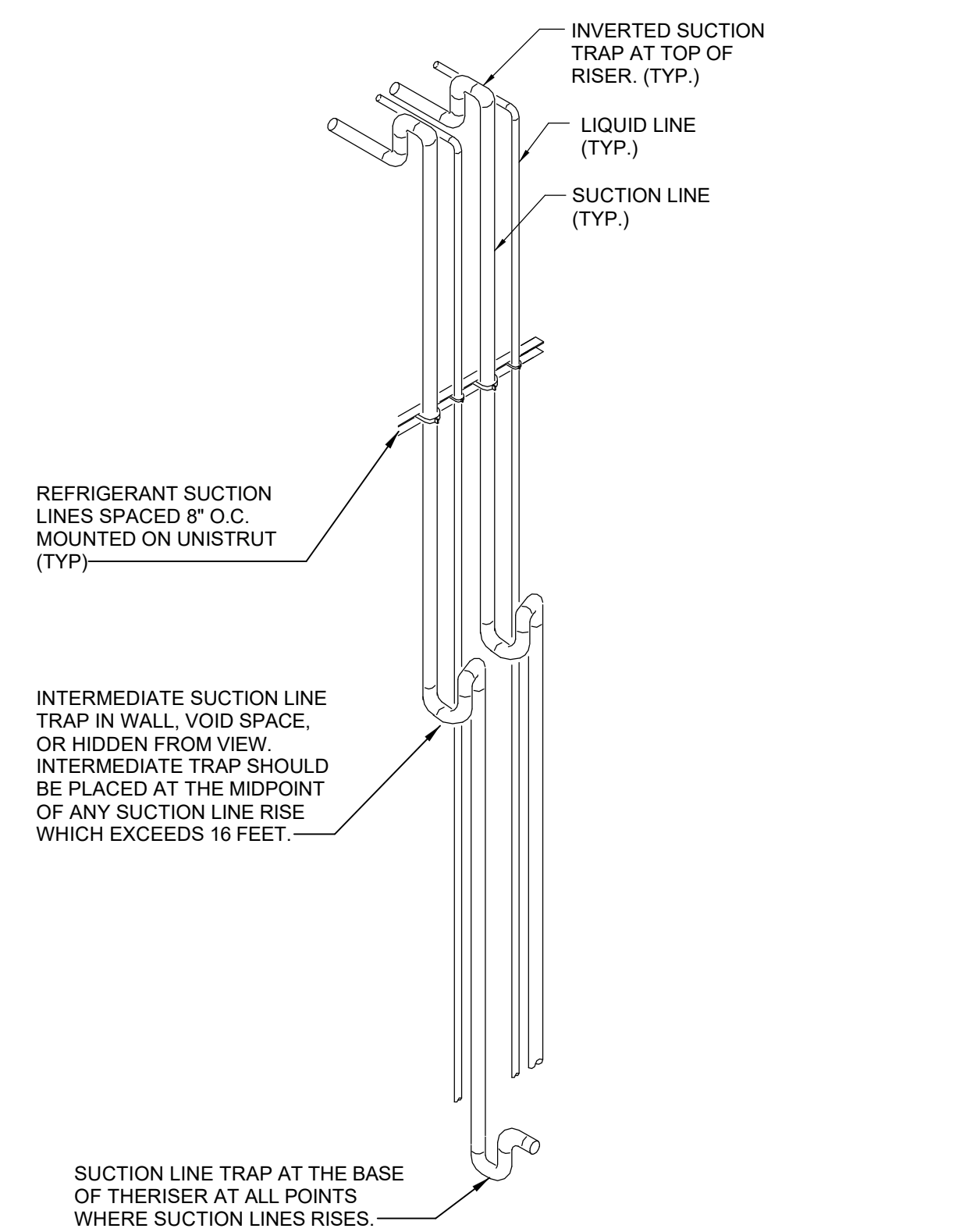

## 1 INTERMEDIATE SUCTION LINE TRAP

EXISTING CONDITIONS WERE TAKEN FROM ORIGINAL DRAWINGS AND MAY NOT REFLECT EXACT "AS-BUILT" CONDITIONS. CONTRACTOR SHALL FIELD VERIFY ALL EXISTING CONDITIONS PRIOR TO SUBMITTING FINAL BIDS. CONTRACTOR SHALL CAREFULLY COORDINATE NEW WORK AND DEMOLITION WITH ALL OTHER DISCIPLINES AND EXISTING CONDITIONS.

EACH SUBCONTRACTOR IS RESPONSIBLE FOR HAVING A THOROUGH KNOWLEDGE OF ALL DRAWINGS AND SPECIFICATIONS IN THEIR RELATED FIELD. THE FAILURE TO ACQUAINT THEMSELVES WITH THIS KNOWLEDGE DOES NOT RELIEVE THE RESPONSIBILITY OF PERFORMING THE WORK PROPERLY. NO ADDITIONAL COMPENSATION SHALL BE ALLOWED BECAUSE OF CONDITIONS THAT OCCUR DUE TO FAILURE TO FAMILIARIZE WORKERS WITH THIS KNOWLEDGE.



DOCUMENTS THAT DO NOT  
HAVE THE ARCHITECT OR  
ENGINEER OF RECORD  
SEAL AND SIGNATURE  
SHALL BE CONSIDERED  
NOT FOR CONSTRUCTION

## REFRIGERATION DETAILS

SHEET: **R4**

**STIPULATION FOR REUSE**

THIS DRAWING WAS PREPARED FOR USE ON A SPECIFIC SITE AT:  
FOYALL, WA. FREQUENTLY WITH ITS ISSUE DATE ON 10-01-18, AND IT IS NOT SUITABLE FOR USE ON A DIFFERENT PROJECT SITE OR AT A LATER TIME. USE OF THIS DRAWING FOR REFERENCE OR EXAMPLE ON ANOTHER PROJECT WITHOUT THE WRITTEN CONSENT OF THE LICENSED ARCHITECTS AND ENGINEERS, REPRODUCTION OF THIS DRAWING FOR USE ON ANOTHER PROJECT IS NOT AUTHORIZED AND MAY BE CONTRARY TO

Walmart\*

PUYALLUP, WA

STORE NO: 2403-605

1023871 CAPX REF-3

JOB NUMBER:

[illegible]

CHECKED BY:	DL
DRAWN BY:	LP
PROTO CYCLE:	12/17/21
DOCUMENT DATE:	04/15/22





Walmart  
PUYALLUP, WA  
STORE NO. 2403-605  
1023871 | CAPX REF-3  
JOB NUMBER:

CHECKED BY:	DL
DRAWN BY:	LP
PROTO CYCLE:	12/17/21
DOCUMENT DATE:	04/15/22

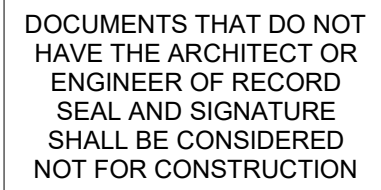

SHEET: **R5**

EXISTING CONDITIONS WERE TAKEN FROM ORIGINAL DRAWINGS AND MAY NOT REFLECT EXACT "AS-BUILT" CONDITIONS. CONTRACTOR SHALL FIELD VERIFY ALL EXISTING CONDITIONS PRIOR TO SUBMITTING FINAL BIDS. CONTRACTOR SHALL CAREFULLY COORDINATE NEW WORK AND DEMOLITION WITH ALL OTHER DISCIPLINES AND EXISTING CONDITIONS.

EACH SUBCONTRACTOR IS RESPONSIBLE FOR HAVING A THOROUGH KNOWLEDGE OF ALL DRAWINGS AND SPECIFICATIONS IN THEIR RELATED FIELD. THE FAILURE TO ACQUAINT THEMSELVES WITH THIS KNOWLEDGE DOES NOT RELIEVE THE RESPONSIBILITY OF PERFORMING THE WORK PROPERLY. NO COMPENSATION SHALL BE ALLOWED BECAUSE OF CONDITIONS THAT OCCUR DUE TO FAILURE TO FAMILIARIZE WORKERS WITH THIS KNOWLEDGE.







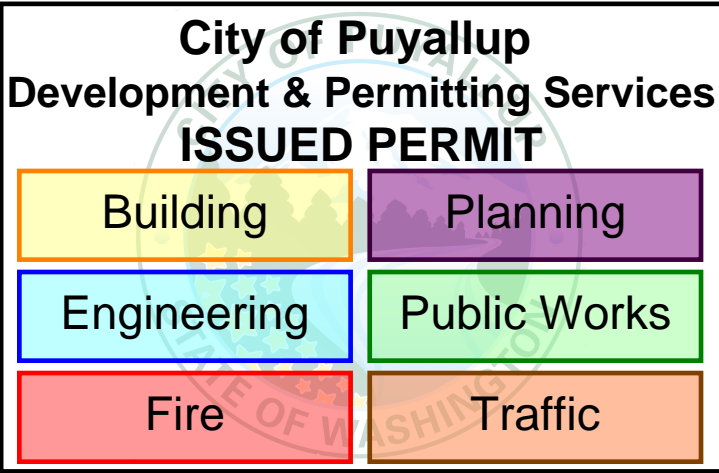

L4D3-1 (EXISTING)				PANELBOARD				SECTION #1: BREAKER 1-30				SECTION #2: BREAKERS 31-60				208Y/120V, 3PH, 4W 225A, MCB 10,000AIC EQUIPMENT GROUND BUS ISOLATED GROUND BUS			
SERVES: BAKERY AND DELI																			
LOCATION: BAKERY PREP																			
MOUNTING: FLUSH																			
DESCRIPTION				WIRE	BRKR	PL	KVA A	KVA B	KVA C	PL	BRKR	WIRE	DESCRIPTION						
1	SPACE			20	1					1	20		EXISTING (13)			2			
3	EXISTING (13)			20	1					2	20		FLOWER CASE (13)			4			
5	B49 DONUT MACHINE (13)			60	2					-	-		---			6			
7	---			--	--											8			
9	B49A DONUT (13)			30	2					2	50		SPARE (13)			10			
11	---			--	--					1	20		BAKERY RECEPTACLE (13)			12			
13	B26 ICING WARMER (13)			15	2					1	20		BAKERY FREEZER LG (13)			14			
15	---			--	--					1	20		BAKERY FREEZER HEATERS (13)			16			
17	BERRY COOLER (13)			20	2					1	20		POULTRY COOLER HTRS (13)			18			
19	---			--	--					3	30		ROTISSERIE (13)			20			
21	BERRY COOLER (13)			20	2					-	--		---			22			
23	---			--	--						--					24			
25	OVEN (13)			20	3								SHUNT TRIP BREAKER			26			
27	---			--	--					1	20		OVEN CONTROL (13)			28			
29	---			--	--					1	20		EXISTING (13)			30			
TOTAL							0	0	0	KVA									
PER NEC ARTICLE 220							0.00	0.00	0.00	AMPS									
TOTAL LOAD							0.00		0.00	AMPS									
FEEDER LOAD							0.00		0.00	AMPS									

L5D1-2 (EXISTING)				PANELBOARD				SECTION #1: BREAKER 1-30				SECTION #2: BREAKERS 31-60				208Y/120V, 3PH, 4W			
SERVES: GROCERY MISC POWER												225A, MCB							
LOCATION: EDCS												10,000AIC							
MOUNTING: SURFACE												EQUIPMENT GROUND BUS							
												ISOLATED GROUND BUS							
DESCRIPTION				WIRE	BRKR	PL	KVA A	KVA B	KVA C	PL	BRKR	WIRE	DESCRIPTION						
31	WATER COOLERS (13)			20	1					1	20		PORTRAIT STUDIO RECEPTACLES (13)		32				
33	ICE MAKER (13)			20	2					1	20		SURVEILLANCE SYSTEM (13)		34				
35	---			--	--					1	20		PORTRAIT STUDIO RECEPTACLES (13)		36				
37	ICE MAKER (13)			20	2					1	20		EXISTING COLUMNNM REC (13)		38				
39	---			--	--					1	20		EXISTING COLUMNNM REC (13)		40				
41	SIDEWALK CASH WRAP (13)			20	1					1	20		EXISTING COLUMNNM REC (13)		42				
43	EXTERIOR RECEPTACLES (13)			20	1					1	20		EXISTING COLUMNNM REC (13)		44				
45	RTU RECEPTACLE (13)			20	1					1	20		EXISTING COLUMNNM REC (13)		46				
47	RTU RECEPTACLES (13)			20	1					1	20		EXISTING COLUMNNM REC (13)		48				
49	FRONT TOILET SENSOR (13)			20	1		1.20			3	20	12	RM122 HOT CASE (22)		50				
51	HAND DRYER (13)			20	1			1.20			--	12	---		52				
53	HAND DRYER (13)			20	1				1.20		--	12	---		54				
55	ICE BAGGER/RECEPT (13)			20	1					1	20		EXISTING RTU RECEPTACLES (13)		56				
57	SPARE			20	1			0.54		1	20		MOTORIZED CARTS/INSECT		58				
59	SPARE			20	1					1	20		EXISTING RTU RECEPTACLES (13)		60				
TOTAL							1.2	1.74	1.2	KVA									
TOTAL LOAD							10.00	14.50	10.00	AMPS									
FEEDER LOAD							4.14		11.50	AMPS									
FEEDER LOAD							4.14		6.64	AMPS									
PER NEC ARTICLE 220																			

CH2F		(EXISTING)		PANELBOARD				208Y/120V, 3PH, 4W					
SERVES:		REFRIGERATED CASE FANS, RECEPTACLES & A/S HTRS (NON-CYCLED)						225A, MLO					
LOCATION:		COMPRESSOR HOUSE #2						10000AIC					
MOUNTING:		SURFACE						EQUIPMENT GROUND BUS					
	DESCRIPTION	WIRE	BRKR	PL	KVA A	KVA B	KVA C	PL	BRKR	WIRE	DESCRIPTION		
1	MTC-1 FANS & A/S HTRS (13)		20	1	1.11	0.43		1	20	#10	MTD-1 CASE FANS (13)	2	
3	SPARE (13)		20	1		0.65		1	20	#10	MTD-2 CASE FANS (13)	4	
5	MTC-3 CASE FANS (19)	E	20	1			0.17	1.01	1	20	#8	MTD-3 COIL FANS (13)	6
7	MTC-4 CASE FANS (19)	E	20	1	0.14	0.50			1	20	#10	MTD-4 COIL FANS (13)	8
9	MTC-5 CASE FANS (13)		20	1		0.67	0.64		1	20	#10	MTD-6 CASE FANS (13)	10
11	MTC-6 CASE FANS (19)	E	20	1			0.22	0.60	1	20	#10	MTD-7 CASE FANS (13)	12
13	MTC-7 CASE FANS (13)		20	1	1.00	0.60			1	20	#8	MTD-8 CASE FANS (13)	14
15	MTC-8 CASE FANS (13)		20	1		0.88	1.26		1	20	#6	MTD-9 COIL FANS (13)	16
17	MTC-9 CASE FANS (13)		20	1			1.50	1.26	1	20	#6	MTD-10 COIL FANS (13)	18
19	MTC-10 CASE FANS (13)		20	1	0.42	1.26			1	20	#6	MTD-9 COIL FANS (13)	20
21	MTC-11 FANS & A/S HTRS (13)		20	1		1.40	0.50		1	20	#10	MTD-10 COIL FANS (13)	22
23	MTC-12 FANS & A/S HTRS (13)		20	1			1.70		1	20	#10	SPARE (13)	24
25	MTC-13 CASE FANS (13)		20	1	0.48	0.43			1	20		MTD-11 CASE FANS (13)	26
27	MTC-14 FANS & A/S HTRS (13)		20	1		1.70	0.14		1	20		MTD-12 CASE FANS (13)	28
29	MTC-15 CASE FANS (13)		20	1			0.72	0.73	1	20	#10	DAIRY CLR DR HTS (13)	30
31	MTC-16 CASE FANS (13)		20	1	0.60				1	20		SPARE (13)	32
33	MTC-17 FANS & A/S HTRS (13)		20	1		1.70	0.54		1	20		MTD-4 CASE RECEPTACLE (13)	34
35	MTC-18 CASE FANS (13)		20	1			0.12	0.18	1	20		MTD-12 CASE RECEPTACLE (13)	36
37	SPARE (13)		20	1		0.18			1	20		MTD-12 CASE RECEPTACLE (13)	38
39	SPARE (13)		20	1			0.18		1	20		MTD-14 CASE RECEPTACLE (13)	40
41	SPARE (13)		20	1			0.18		1	20		MTD-14 CASE RECEPTACLE (13)	42
TOTAL					7.154	10.26	8.384	KVA					
TOTAL LOAD					59.62	85.50	69.87	AMPS					
FEEDER LOAD					25.80		71.66	AMPS					
PER NEC ARTICLE 220							41.37	AMPS					

L4D3-2		(EXISTING)		PANELBOARD				SECTION #1: BREAKER 1-30				208Y/120V, 3PH, 4W			
SERVES:		GROCERY MISC POWER		SECTION #2: BREAKERS 31-60				225A, MCB							
LOCATION:		EDC4						10,000AIC							
MOUNTING:		SURFACE						EQUIPMENT GROUND BUS							
								ISOLATED GROUND BUS							
DESCRIPTION				WIRE	BRKR	PL	KVA A	KVA B	KVA C	PL	BRKR	WIRE	DESCRIPTION		
31	EF LIGHTS (13)	20	1				3.12			3	30	E	HOT FOOD CASE(22)	32	
33	EH CONTROLS (13)	20	1					3.12		-	--	E	--	34	
35	EF (FRYER) (13)	20	1						3.12	-	--	E	--	36	
37	EF (ROTISSERIE) (13)	20	1							3	30		OVEN (13)	38	
39	D07 DELI SLICER (13)	20	1							-	--		--	40	
41	D07 DELI SLICER (13)	20	1							-	--		--	42	
43	D07 DELI SLICER (13)	20	1											44	
45	D05 WRAPPER (13)	20	1							3	30		D59 SHUNT-TRIP BREAKER	46	
47	D13 WORKTOP REFRIG (13)	20	1							-	---		DOUBLE ROTISSERIE (13)	48	
49	D07 DELI SLICER (13)	20	1							-	---		---	50	
51	D04/D04 SCALE/LABELERS (13)	20	1										D59 SHUNT - TRIP BREAKER	52	
53	PIZZA WARMER (13)	20	1							1	20		D56A FREYER FILTER PUMP (13)	54	
55	DELI RECEPTACLES (13)	20	1										D56A SHUNT - TRIP BREAKER	56	
57	D13 WORKTOP REFRIG (13)	20	1							1	20		D076 DELI SLICER (13)	58	
59	SPACE									1	20		D05 WRAPPER/D04A SCALE (13)	60	
TOTAL							3.12	3.12	3.12	KVA					
TOTAL LOAD							26.00	26.00	26.00	AMPS					
FEEDER LOAD							9.36		26.00	AMPS					
							9.36		15.01	AMPS					
PER NEC ARTICLE 220															

CH2L (EXISTING)		PANELBOARD							208Y/120V, 3PH, 4W				
SERVES: REFRIGERATED CASE LIGHTS									225A, MLO				
LOCATION: COMPRESSOR HOUSE #2									10000AIC				
MOUNTING: SURFACE									EQUIPMENT GROUND BUS				
	DESCRIPTION	WIRE	BRKR	PL	KVA A	KVA B	KVA C	PL	BRKR	WIRE	DESCRIPTION		
1	MTC-1 CASE LTS (13)		20	1	0.77	0.62		1	20		MTD-1 CASE LTS (13)	2	
3	MTC-3 CASE LTS (19)	E	20	1		0.04	0.94	1	20		MTD-2 CASE LTS (13)	4	
5	MTC-4 CASE LTS (19)	E	20	1			0.08	1.77	1	20		MTD-6 CASE LTS (13)	6
7	MTC-5 CASE LTS (13)		20	1	0.65	0.55		1	20		MTD-7 CASE LTS (13)	8	
9	MTC-6 CASE LTS (13)	E	20	1		0.12	0.76		1	20		MTD-8 CASE LTS (13)	10
11	MTC-7 CASE LTS (13)		20	1			0.92	0.92	1	20		DAIRY CLR LTS (13)	12
13	MTC-8 CASE LTS (13)		20	1	0.80	0.21			1	20		MTD-10 CASE LTS (13)	14
15	MTC-9 CASE LTS (13)		20	1		1.39	0.62		1	20		MTD-11 CASE LTS (13)	16
17	MTC-10 CASE LTS (13)		20	1			0.48	0.22	1	20		MTD-12 CASE LTS (13)	18
19	MTC-13 CASE LTS (13)		20	1	0.55				1	20		SPARE (13)	20
21	MTC-15 CASE LTS (13)		20	1		0.83			1	20		SPARE (13)	22
23	MTC-16 CASE LTS (13)		20	1			0.83		1	20		SPARE (13)	24
25	SPACE (13)	--	1						--	--		SPACE	26
27	SPACE (13)	--	1						--	--		SPACE	28
29	TEMP PLUGS (13)	--	--						--	--		SPACE	30
31	SPACE	--	--						--	--		SPACE	32
33	SPACE	--	--						--	--		SPACE	34
35	SPACE	--	--						--	--		SPACE	36
37	SPACE	--	--						--	--		SPACE	38
39	SPACE	--	--						--	--		SPACE	40
41	SPACE	--	--						--	--		SPACE	42
TOTAL					4.15	4.696	5.224	KVA					
PER NEC ARTICLE 220					34.58	39.13	43.53	AMPS					
TOTAL LOAD					14.07		39.08	AMPS					
FEEDER LOAD					14.07		22.56	AMPS					