

GOOD SAMARITAN HOSPITAL

D.R. #7 & #8 BUILDOUT

Fire Alarm and Detection System

Equipment Supplied By



Project Team Contact Information			
Sales Representative	Project Coordinator	Technician Scheduler	Project Designer
Tim Duggan timothy.duggan@jci.com Phone: 253-509-8816	Bryan Reimer bryan.reimer@jci.com Phone: 206-777-4933	Yvonne Thompson yvonne.thompson@jci.com Phone: 206-777-4860	Eric Beck eric.beck@jci.com Phone: 206-777-4821 NICET Fire Alarm System Level III, #148077

DRAWING LIST			
SHEET NAME	DRAWING NAME	ELECTRONIC DRAWING NAME	INCLUDED IN THIS PROJECT
FA-COV-01	TITLE SHEET	FA-COVER	X
FA-COV-02	COVER SHEET	FA-COVER	X
FA-COV-02.1	COVER SHEET	FA-COVER	X
FA-COV-03	COVER SHEET	FA-COVER	X
FA-COV-04	COVER SHEET	FA-COVER	X
FA-COV-05	COVER SHEET	FA-COVER	
FA-COV-06	PANEL LAYOUT	FA-COVER	
FA-COV-07	PANEL LAYOUT	FA-COVER	
FA-COV-08	PANEL LAYOUT	FA-COVER	
FA-COV-09	SUP. PANEL LAYOUT	FA-COVER	
FA-RIS-01	RISER SHEET	FA-RISER	
FA-RIS-02	RISER SHEET	FA-RISER	
FA-DET-01	DETAIL SHEET	FA-COVER	
FA-DET-02	DETAIL SHEET(T.L.)	FA-COVER	X
FA-SCP-01	SMOKE CONTROL PANEL	FA-SCP-01	
FA-LEVA-W	LEVEL A WEST FLOOR PLAN	FA-LEVEL A	
FA-LEVA-E	LEVEL A EAST FLOOR PLAN	FA-LEVEL A	
FA-LEV1-W	LEVEL 1 WEST FLOOR PLAN	FA-LEVEL 1	
FA-LEV1-E	LEVEL 1 EAST FLOOR PLAN	FA-LEVEL 1	
FA-LEV2-WD	LEVEL 2 WEST DEMO FLOOR PLAN	FA-LEVEL 2-D	X
FA-LEV2-W	LEVEL 2 WEST FLOOR PLAN	FA-LEVEL 2	X
FA-LEV2-E	LEVEL 2 EAST FLOOR PLAN	FA-LEVEL 2	
FA-LEV3-W	LEVEL 3 WEST FLOOR PLAN	FA-LEVEL 3	
FA-LEV3-E	LEVEL 3 EAST FLOOR PLAN	FA-LEVEL 3	
FA-LEV4-W	LEVEL 4 WEST FLOOR PLAN	FA-LEVEL 4	
FA-LEV4-E	LEVEL 4 EAST FLOOR PLAN	FA-LEVEL 4	
FA-LEV5-W	LEVEL 5 WEST FLOOR PLAN	FA-LEVEL 5	
FA-LEV5-E	LEVEL 5 EAST FLOOR PLAN	FA-LEVEL 5	
FA-LEV6-W	LEVEL 6 WEST FLOOR PLAN	FA-LEVEL 6	
FA-LEV6-E	LEVEL 6 EAST FLOOR PLAN	FA-LEVEL 6	
FA-LEV7-W	LEVEL 7 WEST FLOOR PLAN	FA-LEVEL 7	
FA-LEV7-E	LEVEL 7 EAST FLOOR PLAN	FA-LEVEL 7	
FA-LEV8-W	LEVEL 8 WEST FLOOR PLAN	FA-LEVEL 8	
FA-LEV8-E	LEVEL 8 EAST FLOOR PLAN	FA-LEVEL 8	
FA-ROOF-W	ROOF WEST FLOOR PLAN	FA-ROOF	
FA-ROOF-E	ROOF EAST FLOOR PLAN	FA-ROOF	

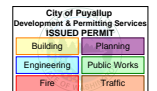

Johnson Controls
SOLUTIONS
SERVICES

401 10TH AVENUE SE
FOUNDRY, WA 98071

NO.	DATE	REVISION DESCRIPTION	ISSUED BY		PROJECT #
			DESIGNER	DATE	
46	1/25/19	DAILY PHARMACY RECORD DRAWINGS	REC	1/25	46018584
47	9/12/18	PROGRESS DOORS	DUP	9/12	46018584
48	4/12/18	ASB FIRE-ACTOR PANEL UPGRADE	ASB	4/12	46018584
49	8/12/18	D.R. #7 & 8 BUILDOUT	AMM	8/12	46018584

APPROVED BY:
C. McCAMMON

DATE:
8/12/18

ISSUED PERMIT NUMBER:
458413141/943123501

PROJECT NUMBER:
FA-COV-01

PROJECT: FIRE ALARM SYSTEM
TITLE SHEET
GOOD SAMARITAN - PATIENT CARE TOWER

City of Puyallup
Development & Permitting Services
ISSUED PERMIT

Sequence of Operation	Sequence of Operation																									
	Manual Station	Smoke Detection	Supervisory Smoke Detection*	Beam Smoke Detection	Corridor Smoke Detection	Anesthetizing Area Smoke Detection	IDF Room Smoke Detection	Primary Recall/Elevator Lobbies Smoke Detection	Elev Lobbies Except Primary Recall Smoke Detection	Elevator Mach Rm/Shaft Smoke Detection	Elevator Power Monitor	Duct Smoke Detection Supply Air Handler	Duct Smoke Detection Exhaust Air Handler	Duct Smoke Detection Supply Smoke/Fire Damper	Duct Smoke Detection Exhaust Smoke/Fire Damper	Heat Detection	Clean Agent System Control Panel	Flow Switch	Pressure Switch	High/Low Air Switch	Tamper Switch	Fire Pump	System Trouble	Pre-Action Alarm	Pre-Action Supervisory	Pre-Action Trouble
Activation of Local Alarm at FACP (LCD Display & Audible Indication)	X	X		X	X		X	X	X	X						X	X	X	X					X		
Activation of Local Alarm at Annunciator	X	X		X	X		X	X	X	X						X	X	X	X					X		
Activate Visible Devices Alarm Floor	X	X		X	X		X	X	X	X						X	X	X	X					X		
Activate Audible Devices Alarm Floor/Floor Above/Floor Below	X	X		X	X		X	X	X	X						X	X	X	X					X		
Release Door Holders Within Smoke Zone	X	X		X	X		X	X	X	X						X	X	X	X					X		
Release Door Holders Floor of Alarm	X																							X		
Release Elevator Door Smoke Curtains Local Detection Only		X		X	X		X										X							X		
Release Stair Door Locks Floor of Alarm	X	X		X	X		X	X	X	X						X	X	X	X					X		
Close Corridor Smoke/Fire Dampers Within Smoke Zone					X									X	X											
Close Smoke/Fire Dampers at Duct Det.														X	X											
Maintain Smoke/Fire Dampers in Anesthetizing Area Ducts in Open Position														X	X											
Shutdown AHU and SAHU Supply Fan												X														
Shutdown EAHU Exhaust Fan												X														
Send Signal to DDC for Shutdown of Associated AHU, SAHU and EAHU Fans												X	X	X	X											
Send Signal to DDC System					X		X					X	X	X	X		X									
Send Signal to DDC System For Smoke Removal Mode																										
Activate Stair Pressurization Fans	X	X		X	X			X	X	X						X	X	X						X		
Open Elevator Hoistway Vent Dampers								X	X	X																
Initiate Primary Elevator Recall								X	X	X																
Initiate Alternate Elevator Recall								X																		
Activate Elevator Hat Light									X																	
Transmit Alarm Signal To Central Station Monitor	X	X		X	X		X	X	X	X						X	X	X	X					X		
Trouble Indication at FACP																										
Trouble Indication at Annunciator																								X		X
Transmit Trouble Signal To Central Station Monitor																								X		X
Supv Indication at Annunciator			X			X					X	X	X	X	X						X	X	X		X	
Transmit Supv Signal To Central Station Monitor			X			X					X	X	X	X	X						X	X	X		X	

*NOTE: OPERATING ROOM FANS WILL OPERATE INDEPENDENTLY OF OTHERS IN SMOKE CONTROL ZONE, ONLY SHUTTING DOWN AFTER SMOKE IS DETECTED IN OPERATING ROOM.



10000 North 130th Street, Seattle, WA 98148
 206-291-1400
 SERVICE: 206-291-1400

PROJECT #	SUBAREA	SUBSYSTEM	EQUIPMENT	DRAWING NO.	DATE

REVISIONS

NO.	DATE	REVISION DESCRIPTION
1	1/25/19	ISSUE FOR PERMIT
2	9/26/19	ISSUE FOR PERMIT
3	9/27/19	ISSUE FOR PERMIT
4	4/12/20	ISSUE FOR PERMIT
5	5/17/20	ISSUE FOR PERMIT

DRAWINGS REVIEWED BY:

DATE	BY
10/1/19	10/1/19
10/1/19	10/1/19
10/1/19	10/1/19

APPROVED BY:

C. McCAMMON

DATE: 8/12/09

SITE/PROJECT NUMBER: 458413141/943123501

SHEET NUMBER: FA-COV-02.1

FIRE ALARM SYSTEM COVER SHEET

GOOD SAMARITAN - PATIENT CARE TOWER

400 10TH AVENUE SE
 PUYALLUP, WA 98471

BATTERY CALCULATIONS - TPR2 - (Level 2)

Does the system have an Emergency Generator that meets NEC 708.2(1)?

Yes X No

How many hours of battery standby are required?

X 4 24 48 96 (4 hours minimum w/ Emergency Generators)

City	Part #	Description	Standby Current (A)	Total Standby (A)	Alarm Current (A)	Total Alarm (A)
1	4100601	Transponder Panel	1,320	1,320	11,900	11,900
1	4096756	Autobahn/Vehicle Detector	0,000	0,000	2,700	2,700
1	4096756	TransAlarm Dust Smoke Sensor	0,004	0,004	0,150	0,150
1	4096756	Dust Detector Relay	0,000	0,000	0,150	0,150
3	2084908	Remote Relay	0,000	0,000	0,450	0,450
2	4096901	Master ZONE	0,160	0,160	0,150	0,150
2	4096901	Transceiver Smoke Detector	0,000	0,000	0,000	0,000
Total Standby:			1,320	1,320	12,650	12,650
Total Standby Current Required:			1,380	X	2,800	5,780
Total Alarm Current Required:			16,800	X	0,200	4,715
Total:						10,255
50% Deflection Factor:						5,128
Total Amper-Hour Required:						15,363
Total Amper-Hour Batteries Provided:					(1) sec	33,000

Transponder Panel - TPR2 (Level 2)

Auxiliary Circuits

NF-AUX17	Spire
NF-AUX18	Auxiliary Power
NF-AUX19	Not Available
NF-AUX20	Auxiliary Power
NF-AUX21	Not Available
NF-AUX22	Auxiliary Power
NF-AUX23	Level 2 Door Heaters
NF-AUX24	Level 2 East Link Door Heaters
NF-AUX25	Level 2 East Link Door Heaters
NF-AUX28-29	Spire

Speaker Circuits

Watts	11.5
NF-SB01	Level 2 West
NF-SB02	Level 2 West Link
NF-SB03	Spire
NF-SB04-05	Not Available
Total Watts	11.5
Watts Provided	50.0

Signal Circuits - TPR2 (Level 2)

Current	Dist. (ft)	Voltage Drop
0.712	415	1.61
0.645	475	1.47
0.665	460	1.48
0.624	415	2.35
0.638	410	2.22
0.612	390	1.48
0.638	410	2.42
0.300	480	0.86
0.120	215	0.18
5.120		

DNET Channel RMS

Level 3 - NF-M1-1 to NF-M1-22
Level 3 - NF-M1-23 to NF-M1-32
Level 3 - NF-M1-33 to NF-M1-42
Level 3 - NF-M1-43 to NF-M1-52
Level 3 - NF-M1-53 to NF-M1-62
Level 3 - NF-M1-63 to NF-M1-72
Level 3 - NF-M1-73 to NF-M1-82
Level 3 - NF-M1-83 to NF-M1-92
Level 3 - NF-M1-93 to NF-M1-102
Level 3 - NF-M1-103 to NF-M1-112
Level 3 - NF-M1-113 to NF-M1-122
Level 3 - NF-M1-123 to NF-M1-132
Level 3 - NF-M1-133 to NF-M1-142
Level 3 - NF-M1-143 to NF-M1-152
Level 3 - NF-M1-153 to NF-M1-162
Level 3 - NF-M1-163 to NF-M1-172
Level 3 - NF-M1-173 to NF-M1-182
Level 3 - NF-M1-183 to NF-M1-192
Level 3 - NF-M1-193 to NF-M1-202
Level 3 - NF-M1-203 to NF-M1-212
Level 3 - NF-M1-213 to NF-M1-222
Level 3 - NF-M1-223 to NF-M1-232
Level 3 - NF-M1-233 to NF-M1-242
Level 3 - NF-M1-243 to NF-M1-252
Level 3 - NF-M1-253 to NF-M1-262
Level 3 - NF-M1-263 to NF-M1-272
Level 3 - NF-M1-273 to NF-M1-282
Level 3 - NF-M1-283 to NF-M1-292
Level 3 - NF-M1-293 to NF-M1-302
Level 3 - NF-M1-303 to NF-M1-312
Level 3 - NF-M1-313 to NF-M1-322
Level 3 - NF-M1-323 to NF-M1-332
Level 3 - NF-M1-333 to NF-M1-342
Level 3 - NF-M1-343 to NF-M1-352
Level 3 - NF-M1-353 to NF-M1-362
Level 3 - NF-M1-363 to NF-M1-372
Level 3 - NF-M1-373 to NF-M1-382
Level 3 - NF-M1-383 to NF-M1-392
Level 3 - NF-M1-393 to NF-M1-402
Level 3 - NF-M1-403 to NF-M1-412
Level 3 - NF-M1-413 to NF-M1-422
Level 3 - NF-M1-423 to NF-M1-432
Level 3 - NF-M1-433 to NF-M1-442
Level 3 - NF-M1-443 to NF-M1-452
Level 3 - NF-M1-453 to NF-M1-462
Level 3 - NF-M1-463 to NF-M1-472
Level 3 - NF-M1-473 to NF-M1-482
Level 3 - NF-M1-483 to NF-M1-492
Level 3 - NF-M1-493 to NF-M1-502
Level 3 - NF-M1-503 to NF-M1-512
Level 3 - NF-M1-513 to NF-M1-522
Level 3 - NF-M1-523 to NF-M1-532
Level 3 - NF-M1-533 to NF-M1-542
Level 3 - NF-M1-543 to NF-M1-552
Level 3 - NF-M1-553 to NF-M1-562
Level 3 - NF-M1-563 to NF-M1-572
Level 3 - NF-M1-573 to NF-M1-582
Level 3 - NF-M1-583 to NF-M1-592
Level 3 - NF-M1-593 to NF-M1-602
Level 3 - NF-M1-603 to NF-M1-612
Level 3 - NF-M1-613 to NF-M1-622
Level 3 - NF-M1-623 to NF-M1-632
Level 3 - NF-M1-633 to NF-M1-642
Level 3 - NF-M1-643 to NF-M1-652
Level 3 - NF-M1-653 to NF-M1-662
Level 3 - NF-M1-663 to NF-M1-672
Level 3 - NF-M1-673 to NF-M1-682
Level 3 - NF-M1-683 to NF-M1-692
Level 3 - NF-M1-693 to NF-M1-702
Level 3 - NF-M1-703 to NF-M1-712
Level 3 - NF-M1-713 to NF-M1-722
Level 3 - NF-M1-723 to NF-M1-732
Level 3 - NF-M1-733 to NF-M1-742
Level 3 - NF-M1-743 to NF-M1-752
Level 3 - NF-M1-753 to NF-M1-762
Level 3 - NF-M1-763 to NF-M1-772
Level 3 - NF-M1-773 to NF-M1-782
Level 3 - NF-M1-783 to NF-M1-792
Level 3 - NF-M1-793 to NF-M1-802
Level 3 - NF-M1-803 to NF-M1-812
Level 3 - NF-M1-813 to NF-M1-822
Level 3 - NF-M1-823 to NF-M1-832
Level 3 - NF-M1-833 to NF-M1-842
Level 3 - NF-M1-843 to NF-M1-852
Level 3 - NF-M1-853 to NF-M1-862
Level 3 - NF-M1-863 to NF-M1-872
Level 3 - NF-M1-873 to NF-M1-882
Level 3 - NF-M1-883 to NF-M1-892
Level 3 - NF-M1-893 to NF-M1-902
Level 3 - NF-M1-903 to NF-M1-912
Level 3 - NF-M1-913 to NF-M1-922
Level 3 - NF-M1-923 to NF-M1-932
Level 3 - NF-M1-933 to NF-M1-942
Level 3 - NF-M1-943 to NF-M1-952
Level 3 - NF-M1-953 to NF-M1-962
Level 3 - NF-M1-963 to NF-M1-972
Level 3 - NF-M1-973 to NF-M1-982
Level 3 - NF-M1-983 to NF-M1-992
Level 3 - NF-M1-993 to NF-M1-1002

BATTERY CALCULATIONS - TPR3 - (Level 3)

Does the system have an Emergency Generator that meets NEC 708.2(1)?

Yes X No

How many hours of battery standby are required?

X 4 24 48 96 (4 hours minimum w/ Emergency Generators)

City	Part #	Description	Standby Current (A)	Total Standby (A)	Alarm Current (A)	Total Alarm (A)
1	4100601	Transponder Panel	1,320	1,320	11,900	11,900
1	4096756	Autobahn/Vehicle Detector	0,000	0,000	2,700	2,700
1	4096756	TransAlarm Dust Smoke Sensor	0,004	0,004	0,150	0,150
1	4096756	Dust Detector Relay	0,000	0,000	0,150	0,150
3	2084908	Remote Relay	0,000	0,000	0,450	0,450
2	4096901	Master ZONE	0,160	0,160	0,150	0,150
2	4096901	Transceiver Smoke Detector	0,000	0,000	0,000	0,000
Total Standby:			1,320	1,320	12,650	12,650
Total Standby Current Required:			1,380	X	2,800	5,968
Total Alarm Current Required:			20,840	X	0,250	5,710
Total:						10,708
50% Deflection Factor:						5,354
Total Amper-Hour Required:						16,162
Total Amper-Hour Batteries Provided:					(1) sec	33,000

Transponder Panel - TPR3 (Level 3)

Auxiliary Circuits

NF-AUX17	Spire
NF-AUX18	Auxiliary Power
NF-AUX19	Not Available
NF-AUX20	Auxiliary Power
NF-AUX21	Not Available
NF-AUX22	Auxiliary Power
NF-AUX23	Level 3 Door Heaters
NF-AUX24	Level 3 Door Heaters
NF-AUX28-29	Spire

Speaker Circuits

Watts	11.5
NF-SB01	Level 3 Northwest
NF-SB02	Level 3 Southwest
NF-SB03	Spire
NF-SB04-05	Not Available
Total Watts	11.5
Watts Provided	50.0

Signal Circuits - TPR3 (Level 3)

Current	Dist. (ft)	Voltage Drop
0.814	545	2.71
0.834	555	1.97
0.660	500	2.03
0.872	370	3.40
0.876	365	3.28
0.972	420	3.70
0.906	425	2.83
0.876	365	1.64
0.822	340	3.27
7.816		

DNET Channel RMS

Level 3 - NF-M1-1 to NF-M1-22
Level 3 - NF-M1-23 to NF-M1-32
Level 3 - NF-M1-33 to NF-M1-42
Level 3 - NF-M1-43 to NF-M1-52
Level 3 - NF-M1-53 to NF-M1-62
Level 3 - NF-M1-63 to NF-M1-72
Level 3 - NF-M1-73 to NF-M1-82
Level 3 - NF-M1-83 to NF-M1-92
Level 3 - NF-M1-93 to NF-M1-102
Level 3 - NF-M1-103 to NF-M1-112
Level 3 - NF-M1-113 to NF-M1-122
Level 3 - NF-M1-123 to NF-M1-132
Level 3 - NF-M1-133 to NF-M1-142
Level 3 - NF-M1-143 to NF-M1-152
Level 3 - NF-M1-153 to NF-M1-162
Level 3 - NF-M1-163 to NF-M1-172
Level 3 - NF-M1-173 to NF-M1-182
Level 3 - NF-M1-183 to NF-M1-192
Level 3 - NF-M1-193 to NF-M1-202
Level 3 - NF-M1-203 to NF-M1-212
Level 3 - NF-M1-213 to NF-M1-222
Level 3 - NF-M1-223 to NF-M1-232
Level 3 - NF-M1-233 to NF-M1-242
Level 3 - NF-M1-243 to NF-M1-252
Level 3 - NF-M1-253 to NF-M1-262
Level 3 - NF-M1-263 to NF-M1-272
Level 3 - NF-M1-273 to NF-M1-282
Level 3 - NF-M1-283 to NF-M1-292
Level 3 - NF-M1-293 to NF-M1-302
Level 3 - NF-M1-303 to NF-M1-312
Level 3 - NF-M1-313 to NF-M1-322
Level 3 - NF-M1-323 to NF-M1-332
Level 3 - NF-M1-333 to NF-M1-342
Level 3 - NF-M1-343 to NF-M1-352
Level 3 - NF-M1-353 to NF-M1-362
Level 3 - NF-M1-363 to NF-M1-372
Level 3 - NF-M1-373 to NF-M1-382
Level 3 - NF-M1-383 to NF-M1-392
Level 3 - NF-M1-393 to NF-M1-402
Level 3 - NF-M1-403 to NF-M1-412
Level 3 - NF-M1-413 to NF-M1-422
Level 3 - NF-M1-423 to NF-M1-432
Level 3 - NF-M1-433 to NF-M1-442
Level 3 - NF-M1-443 to NF-M1-452
Level 3 - NF-M1-453 to NF-M1-462
Level 3 - NF-M1-463 to NF-M1-472
Level 3 - NF-M1-473 to NF-M1-482
Level 3 - NF-M1-483 to NF-M1-492
Level 3 - NF-M1-493 to NF-M1-502
Level 3 - NF-M1-503 to NF-M1-512
Level 3 - NF-M1-513 to NF-M1-522
Level 3 - NF-M1-523 to NF-M1-532
Level 3 - NF-M1-533 to NF-M1-542
Level 3 - NF-M1-543 to NF-M1-552
Level 3 - NF-M1-553 to NF-M1-562
Level 3 - NF-M1-563 to NF-M1-572
Level 3 - NF-M1-573 to NF-M1-582
Level 3 - NF-M1-583 to NF-M1-592
Level 3 - NF-M1-593 to NF-M1-602
Level 3 - NF-M1-603 to NF-M1-612
Level 3 - NF-M1-613 to NF-M1-622
Level 3 - NF-M1-623 to NF-M1-632
Level 3 - NF-M1-633 to NF-M1-642
Level 3 - NF-M1-643 to NF-M1-652
Level 3 - NF-M1-653 to NF-M1-662
Level 3 - NF-M1-663 to NF-M1-672
Level 3 - NF-M1-673 to NF-M1-682
Level 3 - NF-M1-683 to NF-M1-692
Level 3 - NF-M1-693 to NF-M1-702
Level 3 - NF-M1-703 to NF-M1-712
Level 3 - NF-M1-713 to NF-M1-722
Level 3 - NF-M1-723 to NF-M1-732
Level 3 - NF-M1-733 to NF-M1-742
Level 3 - NF-M1-743 to NF-M1-752
Level 3 - NF-M1-753 to NF-M1-762
Level 3 - NF-M1-763 to NF-M1-772
Level 3 - NF-M1-773 to NF-M1-782
Level 3 - NF-M1-783 to NF-M1-792
Level 3 - NF-M1-793 to NF-M1-802
Level 3 - NF-M1-803 to NF-M1-812
Level 3 - NF-M1-813 to NF-M1-822
Level 3 - NF-M1-823 to NF-M1-832
Level 3 - NF-M1-833 to NF-M1-842
Level 3 - NF-M1-843 to NF-M1-852
Level 3 - NF-M1-853 to NF-M1-862
Level 3 - NF-M1-863 to NF-M1-872
Level 3 - NF-M1-873 to NF-M1-882
Level 3 - NF-M1-883 to NF-M1-892
Level 3 - NF-M1-893 to NF-M1-902
Level 3 - NF-M1-903 to NF-M1-912
Level 3 - NF-M1-913 to NF-M1-922
Level 3 - NF-M1-923 to NF-M1-932
Level 3 - NF-M1-933 to NF-M1-942
Level 3 - NF-M1-943 to NF-M1-952
Level 3 - NF-M1-953 to NF-M1-962
Level 3 - NF-M1-963 to NF-M1-972
Level 3 - NF-M1-973 to NF-M1-982
Level 3 - NF-M1-983 to NF-M1-992
Level 3 - NF-M1-993 to NF-M1-1002

TPR2 - LEVEL 2

4100-0025 AUX 23-30	4100-0111 DNET M2 SIG 43-44 AUX 17-18
------------------------	--

4100-1326 SIG 60-62	4100-5010 SIG 34-39 AUX 22	4100-1328 SIG 56-68
------------------------	----------------------------------	------------------------

4100-5010 SIG 48-53 AUX 20

Signal Circuits - TPR2 (Level 2)

Current	Dist. (ft)	Voltage Drop
0.712	415	1.61
0.645	475	1.47
0.665	460	1.48
0.624	415	2.35
0.638	410	2.22
0.612	390	1.48
0.638	410	2.42
0.300	480	0.86
0.120	215	0.18
5.120		

TPR3 - LEVEL 3

4100-0025 AUX 27-44	4100-3306 AUX 37-44	4100-5111 DNET M3 SIG 74-74 AUX 31-32
------------------------	------------------------	--

4100-1326 SIG 60-62	4100-5010 SIG 64-86	4100-1328 SIG 56-68
------------------------	------------------------	------------------------

4100-5010 SIG 78-83 AUX 34

Signal Circuits - TPR3 (Level 3)

Current	Dist. (ft)	Voltage Drop
0.814	545	2.71
0.834	555	1.97
0.660	500	2.03
0.872	370	3.40
0.876	365	3.28
0.972	420	3.70
0.906	425	2.83
0.876	365	1.64
0.822	340	3.27
7.816		

DNET Channel RMS

Level 3 - NF-M1-1 to NF-M1-22
Level 3 - NF-M1-23 to NF-M1-32
Level 3 - NF-M1-33 to NF-M1-42
Level 3 - NF-M1-43 to NF-M1-52
Level 3 - NF-M1-53 to NF-M1-62
Level 3 - NF-M1-63 to NF-M1-72
Level 3 - NF-M1-73 to NF-M1-82
Level 3 - NF-M1-83 to NF-M1-92
Level 3 - NF-M1-93 to NF-M1-102
Level 3 - NF-M1-103 to NF-M1-112
Level 3 - NF-M1-113 to NF-M1-122
Level 3 - NF-M1-123 to NF-M1-132
Level 3 - NF-M1-133 to NF-M1-142
Level 3 - NF-M1-143 to NF-M1-152
Level 3 - NF-M1-153 to NF-M1-162
Level 3 - NF-M1-163 to NF-M1-172
Level 3 - NF-M1-173 to NF-M1-182
Level 3 - NF-M1-183 to NF-M1-192

LEVEL 2 WEST LINK FLOOR PLAN
SCALE 1/8"=1'-0"

STROBE AND SPEAKER IDENTIFICATION

25/25 SPEAKER CIRCUIT
STROBE CIRCUIT
TAP SPEAKER AT 25% 1/2 WATT UNLESS OTHERWISE NOTED.

ADDRESSABLE DETECTOR IDENTIFICATION

NODE #
DEVICE #
IDNET CHANNEL #

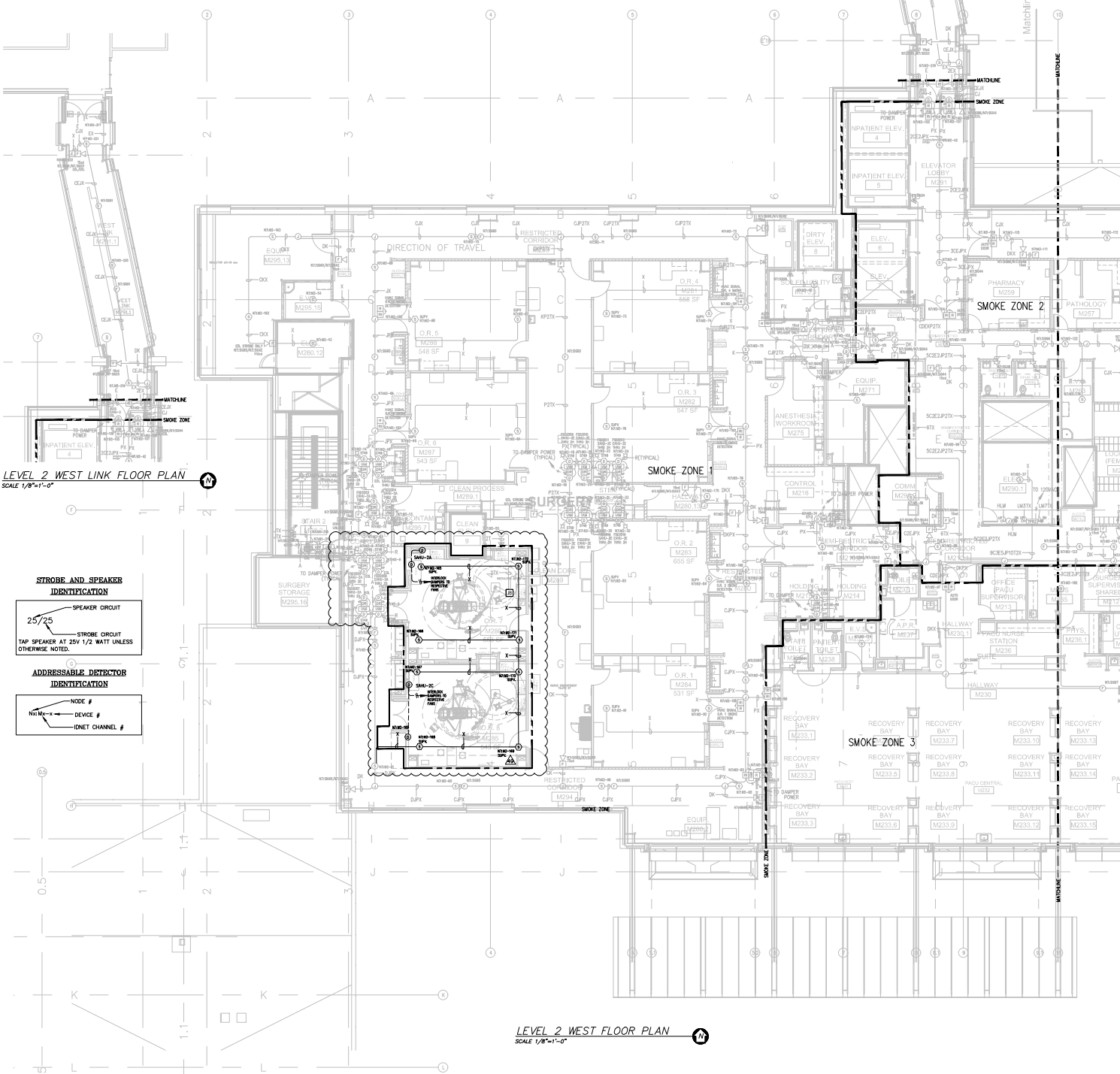

LEVEL 2 WEST FLOOR PLAN
SCALE 1/8"=1'-0"

Symbol	Description	Part #	Backbox
[Symbol]	Multicore Wall Speaker/Strobe - White	4908-9153	5" sq 2.875" deep w/ ending 1/2" adaptor by EC
[Symbol]	Multicore Ceiling Speaker/Strobe - White	4908-9154	5" sq 2.875" deep w/ ending 1/2" adaptor by EC
[Symbol]	Multicore Wall Speaker - White	4908-9103	4" sq by EC
[Symbol]	Multicore Ceiling Speaker - White	4908-9102	4" sq by EC
[Symbol]	Wall Speaker - White	4908-8717	5" sq 2.875" deep w/ ending 1/2" adaptor by EC
[Symbol]	Ceiling Speaker - White	4908-8721	5" sq 2.875" deep w/ ending 1/2" adaptor by EC
[Symbol]	Addressable Manual Station	4999-9005 w/ 811 100 Cover	2" sq 2 1/8" deep w/ sq by EC
[Symbol]	Addressable Manual Station Suppression	4999-9010 w/ 811 100 Cover	2" sq 2 1/8" deep w/ sq by EC
[Symbol]	TriAlarm Smoke Sensor	4908-9714 w/ 20% minimum activation delay	4" sq by EC
[Symbol]	TriAlarm Heat Sensor	4908-9712 Base	4" sq by EC
[Symbol]	Heat Detector - 130°F	4908-9702 Base	4" sq by EC
[Symbol]	TriAlarm Duct Sensor	4908-9736	self-contained
[Symbol]	Remote LED w/1st	2098-8806	sq by EC
[Symbol]	Dust Detector Relay	4988-8813	4" sq sq by EC
[Symbol]	Beam Smoke Detector - Transmitter	BEAM1224	Surface Box w/BEAMBAR
[Symbol]	Beam Smoke Detector - Receiver	4989-9191	Surface
[Symbol]	Suppression BSM	4908-9001	4" sq 2 1/8" deep w/ 2-gang cover by EC
[Symbol]	Pressure Switch	By Others	By Others
[Symbol]	Low Air Switch	By Others	By Others
[Symbol]	Tamper Switch	By Others	By Others
[Symbol]	Post Indicator Valve	By Others	By Others
[Symbol]	Coil/Suppression Module	209-1046	By Others
[Symbol]	Pre-Action Solenoid	By Others	By Others
[Symbol]	Door Holders	By Others	
[Symbol]	Suppression Mech./Disconnect	2098-8600	Indicated
[Symbol]	Relay BSM	4908-9002	4" sq 2 1/8" deep w/ 2-gang cover by EC
[Symbol]	Relay Relay	2098-8008	self-contained
[Symbol]	FFI Cabinet	2098-8001	sq by EC
[Symbol]	FFI Cabinet	2098-8002 w/ 23.75" x 23.75" x 4.0"D	
[Symbol]	Smoke Control Panel	CEP 4.0/4.0/2.0 4174 x 2974 x 4.75"D	
[Symbol]	Suppression Relieving Purgifier	4908-9006	5.125" x 1.525" w/ 4"D Surface Mount
[Symbol]	Printer	4198-9013	Table Top
[Symbol]	LCD Annunciator	4908-9101	Bejing 3.5" deep by EC
[Symbol]	Terminal Cabinet	SSU0061	174 x 23.75" x 5.5"D
[Symbol]	Transponder Panel	4100-9001	5674 x 2474 x 4.375"D
[Symbol]	Fire Alarm Control Panel	4100-2114	5674 x 2474 x 4.375"D
[Symbol]	Network Display Unit	4100-4151	2975-5428
[Symbol]	40765 Pre-Action Panel	4007-4101	16.25" x 15.5" x 5.75"D

Letter	Qty	Color/Type	Size	Function
A	2	Black/Orange TKN	14	Zone
C	2	Red/Black TKN	14	Periscope
D	4	(2) Red/2) Blue TKN	14	Periscope Loop
E	2	Blow/Yellow TKN	14	Door Holders
F	2	Orange TKN	14	Fire Staircase
H	1	WestPerm D975	18	Serial Communication
K	2	Red/Black TKN	14	Speaker
J	1	WestPerm 991	16	Speaker
L	1	WestPerm 991	16	Speaker Loop
M	1	WestPerm 922PZ	16	Local Network Connection**
N	1	WestPerm 922PZ	16	Mirrored Transponder**
L	1	WestPerm 922PZ	16	
N	2	WestPerm D975	18	Network Connection
P	2	Red/Black TKN	14	2000D Power
R	2	Blue/Yellow TKN	16	Remote LED w/1st
T	1	WestPerm 991	16	Fire Fighter Telephone
V	1	WestPerm D975	18	Printer
X	1	WestPerm D975	18	Addressable Data Line

REVISIONS:

1. EXISTING INFORMATION IS SHOWN LIGHT AND BASED ON INFORMATION PROVIDED BY OTHERS. FIELD VERIFY ALL EXISTING EQUIPMENT AND CONNECTIONS TO THE RED LINE ANY AND ALL CHANGES AND MARK ON RECORD DRAWING.

2. TAP ALL SPEAKERS AT 25% 1/2W. FIELD VERIFY

REV 49 FLAG NOTES:

[Symbol] DURING CONSTRUCTION PHASE DEVICES ARE TO BE REPROGRAMMED AS AND SAMPLED FOR GREAT DETECTORS. DETECTORS CAN BE REPROGRAMMED DURING WORK ON CEILING. UPON COMPLETION CONSTRUCTION PHASE REMOVE AND RETURN TO OWNER TO BE RE-TESTED OR DISPOSED OF AT THEIR DISCRETION. REMOVE OR DISPOSE OF UNNECESSARY WIRE MAINTAIN OVERALL CIRCUIT INTEGRITY.

[Symbol] FIELD VERIFY LOCATION AND PRE-TEST DUCT DETECTORS TO ENSURE FULL FUNCTIONALITY. REPLACE IF NEEDED.

City of Puyallup
Development & Permitting Services
ISSUED PERMIT

Building Planning
Engineering Public Works
Fire Traffic

Johnson Controls
3000 N. 19th St., Suite 100
Seattle, WA 98108
206-271-1400
206-271-1400

NO.	DATE	REVISION DESCRIPTION	DESIGNED BY	CHECKED BY	PROJECT #	CLIENT #	LOCATION
1	8/12/09	DATE PHARMACY RECORD DRAWING	REC	REC	259	00000045	GOOD SAMARITAN
2	8/12/09	DATE PHARMACY RECORD DRAWING	REC	REC	259	00000045	GOOD SAMARITAN
3	8/12/09	DATE PHARMACY RECORD DRAWING	REC	REC	259	00000045	GOOD SAMARITAN
4	8/12/09	DATE PHARMACY RECORD DRAWING	REC	REC	259	00000045	GOOD SAMARITAN

DRAWINGS REVIEWED BY:

REV 153886
REV 153886
REV 153886

FIRE ALARM SYSTEM
LEVEL 2 WEST FLOOR PLAN
GOOD SAMARITAN - PATIENT CARE TOWER

APPROVED BY:
C. McCAMMON

DRAWN BY:
C. McCAMMON

DATE:
8/12/09

SFR/PROJECT NUMBER:
458413141/943123501

SHEET NUMBER:
FA-LEV2-W