



City of Puyallup Application for Building Permit

**333 S. Meridian
Puyallup, WA 98371
Tel: (253) 864-4165
permitcenter@ci.puyallup.wa.us**

Parcel No: 0420222056, 0420222055, 0420226014, 0420226015 0420226016 & 0420222051, 0420226013		Site Address: 407 Valley Ave NE Puyallup, WA 98372	
Owner Name: Meridian Pointe Apartments, LLC		Tel: 206-241-4800	
Owner Address: 17786 Des Moines Memorial Dr.		City: Burien, WA	Zip: 98148
Contractor Name: Farrell-McKenna Construction, LLC		Tel: 206-241-2600	
Contractor Address: 17786 Des Moines Memorial Dr.		City: Burien, WA	Zip: 98148
WA State License: FARREC*005L6	Exp Date: 6/24/24	City Business License: Yes - Exp 11/30/23	
Contact Name: Sean McKenna		Email: Sean@farrellpi.com	
Contact Tel: 206-241-2600		Fax: 206-241-2600	
Lender Name: PNC Real Estate / Midland Loan Services		Address: 10851 Mastin Ste 700 Overland Park, KS 66210	Tel: 913-253-9438

Project Description: Interior Unit Building Renovation - BUILDING 'S' 101/201/301 Unit Stack. If the project disturbs one acre or more, the applicant must apply for a NPDES Construction stormwater general permit from the Department of Ecology. For additional information visit DOE website www.ecy.wa.gov/programs/wq/stormwater/construction

Building Permit Information

COMMERCIAL OR RESIDENTIAL	Commercial	TYPE OF CONSTRUCTION	Type V - 1 Hr
OCCUPANCY TYPE	R-2	FIRST FLOOR SQ. FT.	2,550 gross SF
OCCUPANCY LOAD	4	SECOND FLOOR SQ. FT.	including Decks, Storage and Breezeways
# OF DWELLING UNITS	3	BASEMENT SQ. FT.	
# OF BEDROOMS	6	GARAGE SQ. FT.	
# OF BATHROOMS	6	COVERED PORCH SQ. FT.	
BUILDING HEIGHT		PATIO SQ. FT.	
ZONING	1305 - Multi Family	DECK SQ. FT.	
LOT SIZE SQ. FT.		HEAT TYPE	Electric
LOT COVERAGE: (%)		CHANGE OF USE?	No
IMPERVIOUS SURFACE SQ. FT.		AIR CONDITIONED?	No
PROJECT DISTURBED AREA SQ. FT.		FIRE SPRINKLERS?	Yes
SEWER OR SEPTIC	Sewer	LOCATED IN FLOOD PLAIN?	
WATER PURVEYOR		VALUATION	\$ 29,876.68

I HEREBY CERTIFY THAT I HAVE READ AND EXAMINED THIS APPLICATION AND KNOW THE SAME TO BE TRUE AND CORRECT. ALL PROVISIONS OF LAWS AND ORDINANCES GOVERNING THIS TYPE OF WORK WILL BE COMPLIED WITH WHETHER SPECIFIED HEREIN OR NOT.

BY LEAVING THE CONTRACTOR INFORMATION SECTION BLANK, I HEREBY CERTIFY FURTHER THAT CONTRACTORS (GENERAL OR SUBCONTRACTORS) WILL NOT BE HIRED TO PERFORM ANY WORK IN ASSOCIATION WITH THIS PERMIT. I ALSO CERTIFY THAT IF I DO CHOOSE TO HIRE A CONTRACTOR (GENERAL OR SUBCONTRACTOR) I WILL ONLY HIRE THOSE CONTRACTORS THAT ARE LICENSED BY THE STATE OF WASHINGTON.

SIGNATURE OWNER / AUTHORIZED AGENT

Sean McKenna, Manager

PRINT NAME

6/21/23

DATE

MECHANICAL

Quantity Scheduled	Description	Permit Rate Per Unit	Total Price
3	Permit Issuance	40.00	120.00
	Supplemental Permit	9.60	
	AC Unit – Stand Alone	19.55	
	Install Furnace / Burner up to 100,000 BTU	19.55	
	Install Furnace / Burner over 100,000 BTU	24.00	
	Install / Relocate Floor Furnace & Vent	19.55	
	Install / Relocate Recessed Wall Space Heater	19.55	
	Appliance Vent – Separate	9.60	
	Repair Heating / Cooling Unit	18.11	
	Heat Pump/Boiler / Compress. 3 HP; up to 6 Tons; 100,000	19.55	
	Heat Pump/Boiler / Compress. 3-15 HP or 500,000 BTU	35.95	
	Heat Pump/Boiler / Compress 15-30 HP or 1,000,000 BTU	49.28	
	Heat Pump/Boiler / Compress 30-50 HP or 1,750,000 BTU	73.30	
	Heat Pump/Boiler / Compress over 50 HP or over 1,750,000	122.48	
	Separate Air Handling Unit to 10,000 CFM	14.10	
	Separate Air Handling Unit over 10,000 CFM	23.92	
	Stationary Evaporative Cooler	14.10	
6	Exhaust Vent Fan with Single Duct (Bath Fan)	14.10	84.60
	Vent System Apart from Heating or AC	14.10	
	Mechanical Exhaust Hood / Duct (Range Hood) - Residential	14.10	
	Mechanical Exhaust Hood w/Make-up Air - Commercial	35.95	
	Commercial / Industrial Incinerator	24.00	
	Gas Piping: (1 - 4 outlets)	6.30	
	(5 or more outlets / per outlet)	1.30	
	Unclassified Appliance or Equipment (Fireplace, etc.)	14.10	
	Mechanical Duct Work: (1 – 5 Diffusers)	14.10	
	(6 – 10 Diffusers)	19.55	
	(11 or more Diffusers)	24.00	
TOTAL:			204.60

PLUMBING

Quantity Scheduled	Description	Rate Per Unit	Total	Quantity Scheduled	Description	Rate Per Unit	Total
3	Permit Issuance	40.00	120.00		GREASE TRAP/INTERCEPTOR		
	RESIDENTIAL (1 & 2 DWELLINGS)				Grease Trap	13.00	
	1 Bathroom	160.00			Grease Interceptor	13.00	
	2 Bathroom	200.00			BACK FLOW DEVICE		
	3 Bathroom	240.00			Per Unit	26.00	
	Alterations each fixture	13.00			MEDICAL GAS SYSTEM		
	Water Heater	13.00			Medical Gas Piping System	80.00	
	COMMERCIAL				Surgical Vacuum System	80.00	
	New Const. each fixture	13.00			Gas Piping: (1 - 4 outlets)	8.50	
					(5 or more outlets/per outlet)	2.00	
15	Alterations each fixture	13.00	195.00		Dental Chair or Unit	40.25	
	Drinking Fountain, Water Cooler, Ice Machine	40.25			OTHER (NOT LISTED)		
	Sump, Sewage Ejector Pump	13.00					
3	Garbage Disposal	13.00	39.00				
3	Water Heater	13.00	39.00				
SUB-TOTAL:			393.00	SUB-TOTAL:			
TOTAL:							393.00

*****COMMERCIAL PROJECTS: Please complete "System Development Calculation Sheet"*****

A water availability/approval letter shall be submitted with this application for any property located outside the city's water service area.

Fruitland Mutual Water Co. – (253) 848-5519 / Valley Water Co. – (253) 841-9698 / Tacoma Water Co. – (253) 502-8600

Plan Submittal Checklist for Single Family Residence

- 2 (two) copies of a site plan, drawn to scale on 8½" x 11". Details to include setbacks, easements, other structures & features, adjacent right-of-way, drive access, septic and/or utility lines, and contours of slopes over 15% grade at 2-foot intervals.
- 2 (two) sets of plans (**Engineer or Architect Stamped** on all sheets)
 - Foundation Plan: footing size, wall height, section & reinforcing. Provide design calculations for basement walls that are not supported by concrete cross walls spaced per table 404.1b.
 - Floor plan with room use identified Floor framing plan for each floor (post & beam or joist w/ size & spacing) Ceiling/roof framing plan or truss layout w/ reactions from truss manufacturer Truss layout with hanger and reactions for girder/carrier trusses Truss drawings for TJI's or BCI's Truss specifications packet **Engineer Stamped**
 - Window & door sizes, header sizes, U-values
 - Complete building sections - special sections (show floor, wall & ceiling height, insulation R-value of floors, walls & ceilings. Show sections through stairs - headroom)
 - Construction details (i.e. structural members, insulation, sheathing, siding, roofing, bracing, dimensions, etc.)
 - Exterior porches & decks (resistance to decay including support footings)
 - Special equipment (fireplace, woodstove, hydro-massage tub, etc.)
 - Location of all smoke detectors
 - Handrail/guardrail details for stairs, landings, decks
- Energy Worksheets: <http://www.energy.wsu.edu/BuildingEfficiency/EnergyCode.aspx>
- 2 (two) sets Engineering plans/calculations for special conditions – **Engineer stamped**
 - Basement & retaining walls 4 feet and higher Beams supporting combined roof & floor loads Beams supporting other beams or girder trusses Shear walls when bracing not provided as required.
- If less than 2,000 square feet of new + replaced hard surface: submit a temporary sediment and erosion control plan per the 2014 update to the 2012 Stormwater Management Manual for Western Washington
- If greater than 2,000 square feet of new + replaced hard surface: submit a Stormwater site plan, report and temporary sediment and erosion control plan and report that satisfy the 2014 update to the 2012 Stormwater Management Manual for Western Washington and City standards
- Plan Review Fee

Plan Submittal Checklist for Commercial Projects

- 2 (two) copies of a site plan, drawn to scale on 8½" x 11". Details to include setbacks, easements, soil reports, other structures & features, adjacent right-of-way, drive access, septic and/or utility lines, and contours of slopes over 15% grade at 2-foot intervals, Fire Department access and hydrants, and names of adjacent streets.
- 2 (two) complete sets of plans. (**Engineer or Architect Stamped** on all sheets)
- 2 (two) sets of structural calculations – **Engineer Stamped**
- 1 (one) set of specifications
- Driveways, sidewalks, parking, and accessible routes
- Exterior elevations Complete building sections - special sections
- Building code summary Proposed use Construction Type Occupancy Group Classification Allowable Area Actual Area Dimension yard width on site plan where used for allowable area increase.
- Occupant load calculations and exiting, including exit width calculations
- Energy worksheets including envelope calculations, HVAC, and lighting budget
- Foundation plan including footing sizes, wall heights, cross-sections and reinforcing Floor plan with room use identified for each floor Floor framing plan each floor (slab, post & beam or joist) Ceiling/roof framing plan or truss layout with girder truss reactions
- Window & door sizes, header sizes, and U-Values
- Construction details (i.e. structural members, insulation, sheathing, roofing, diaphragms, shear walls)
- Handrail / guardrail / stair details (with headroom) for stairs and landings
- Smoke detectors, fire alarm, sprinkler system details (if required)
- Engineering for special conditions (truss, basement, retaining walls, shear walls, lateral bracing, load transfer etc.)
- Plumbing plans including layout and fixture count - **Plumbing Fixture Worksheet is required with plumbing plans**
- Special equipment (kitchen, HVAC, Boiler, fireplace, woodstove, etc.)
- Mechanical plans including layout, location and make/model of equipment
- Traffic Scoping Worksheet
- Plan Review Fee

CFP LEGEND	
	WALL FINISH 210
	FINISH 100
	FINISH 101
	FINISH 102
	FINISH 103
	FINISH 104
	FINISH 105
	FINISH 106
	FINISH 107
	FINISH 108
	FINISH 109
	FINISH 110
	FINISH 111
	FINISH 112
	FINISH 113
	FINISH 114
	FINISH 115
	FINISH 116
	FINISH 117
	FINISH 118
	FINISH 119
	FINISH 120
	FINISH 121
	FINISH 122
	FINISH 123
	FINISH 124
	FINISH 125
	FINISH 126
	FINISH 127
	FINISH 128
	FINISH 129
	FINISH 130
	FINISH 131
	FINISH 132
	FINISH 133
	FINISH 134
	FINISH 135
	FINISH 136
	FINISH 137
	FINISH 138
	FINISH 139
	FINISH 140
	FINISH 141
	FINISH 142
	FINISH 143
	FINISH 144
	FINISH 145
	FINISH 146
	FINISH 147
	FINISH 148
	FINISH 149
	FINISH 150
	FINISH 151
	FINISH 152
	FINISH 153
	FINISH 154
	FINISH 155
	FINISH 156
	FINISH 157
	FINISH 158
	FINISH 159
	FINISH 160
	FINISH 161
	FINISH 162
	FINISH 163
	FINISH 164
	FINISH 165
	FINISH 166
	FINISH 167
	FINISH 168
	FINISH 169
	FINISH 170
	FINISH 171
	FINISH 172
	FINISH 173
	FINISH 174
	FINISH 175
	FINISH 176
	FINISH 177
	FINISH 178
	FINISH 179
	FINISH 180
	FINISH 181
	FINISH 182
	FINISH 183
	FINISH 184
	FINISH 185
	FINISH 186
	FINISH 187
	FINISH 188
	FINISH 189
	FINISH 190
	FINISH 191
	FINISH 192
	FINISH 193
	FINISH 194
	FINISH 195
	FINISH 196
	FINISH 197
	FINISH 198
	FINISH 199
	FINISH 200

- GENERAL FINISH NOTES**
1. SEE FINISH SCHEDULE FOR FINISHES.
 2. PATCHING, REPAIRS AS NECESSARY FOR SCHEDULED FINISHES.
 3. SCAFFOLDING SHALL BE SET UP AND REMOVED WITHOUT DAMAGE TO FINISHES.
 4. CONTRACTOR IS RESPONSIBLE TO OBTAIN ALL NECESSARY PERMITS AND APPROVALS FOR THE PROJECT. ALL PERMITS AND APPROVALS SHALL BE OBTAINED PRIOR TO COMMENCEMENT OF WORK.
 5. ALL PERMITS AND APPROVALS SHALL BE OBTAINED PRIOR TO COMMENCEMENT OF WORK.
 6. ALL PERMITS AND APPROVALS SHALL BE OBTAINED PRIOR TO COMMENCEMENT OF WORK.
 7. ALL PERMITS AND APPROVALS SHALL BE OBTAINED PRIOR TO COMMENCEMENT OF WORK.
 8. ALL PERMITS AND APPROVALS SHALL BE OBTAINED PRIOR TO COMMENCEMENT OF WORK.
 9. ALL PERMITS AND APPROVALS SHALL BE OBTAINED PRIOR TO COMMENCEMENT OF WORK.
 10. ALL PERMITS AND APPROVALS SHALL BE OBTAINED PRIOR TO COMMENCEMENT OF WORK.

PROJECT:
**MERIDIAN
POINTE**
407 VALLEY AVENUE
ROYALUP, WA 98572

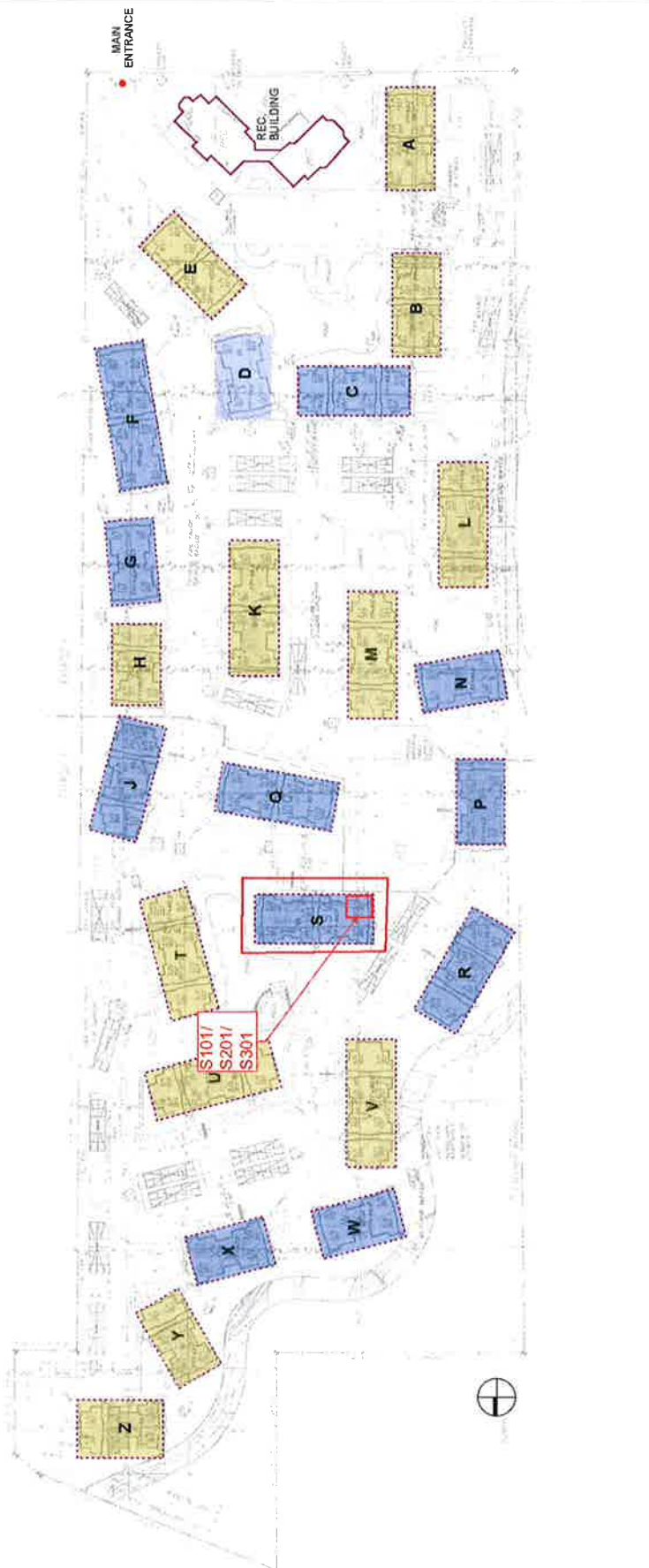

1 SITE PLAN - BUILDING SCHEME PLAN SCALE NONE

ID0.1

SITE PLAN:
COLOR:
SCHEME PLAN

PROJECT:	MERIDIAN POINTE
DATE:	3.25.20
SCALE:	SCALE NONE