

CODE LEGEND

	TYPE Ic PERIMETER LANDSCAPE		TYPE IV INTERNAL PARKING LOT LANDSCAPE
	TYPE Ib RESIDENTIAL BUFFER		SD-2 BLACK WALL LANDSCAPING
	TYPE Ib ENHANCED BUFFER WITH BERM		LOADING AREA BUFFER
	TYPE IIb PERIMETER LANDSCAPE		RIGHT OF WAY
	TYPE IIIa PERIMETER LANDSCAPE		

PLANT SCHEDULE

SYMBOL	BOTANICAL / COMMON NAME	SIZE	SPACING	QTY
	ACER CIRCINATUM VINE MAPLE CLASS I TREE (15' H X 10' W)	2" CAL. B&B		9
	CALOCEDRUS DECURRENS INCENSE CEDAR CLASS II TREE (50' H X 15' W)	8' HT. MIN. B&B		58
	GLEDITSIA TRIACANTHOS INERMIS 'DRAVES' STREET KEEPER HONEY LOCUST CLASS II TREE (45' H X 20' W)	2" CAL., B&B		26
	PICEA OMORIKA SERBIAN SPRUCE CLASS III TREE (50' H X 20' W)	8' HT. MIN. B&B		21
	PSEUDOTSUGA MENZIESII 'FASTIGIATA' FASTIGIATA DOUGLAS FIR CLASS II TREE (45' H X 15' W)	6' HT. MIN. B&B		1
	QUERCUS PALUSTRIS 'PRINGREEN' GREEN PILLAR PIN OAK CLASS II TREE (45' H X 15' W)	2" CAL., B&B		7
	QUERCUS X 'CRIMSCHMIDT' CRIMSON SPIRE OAK CLASS II TREE (45' H X 15' W)	2" CAL. B&B		13
	ULMUS AMERICANA 'VALLEY FORGE' VALLEY FORGE AMERICAN ELM CLASS IV TREE (80' H X 60' W)	2" CAL. B&B		6
	ZELKOVA SERRATA 'VILLAGE GREEN' SAWLEAF ZELKOVA CLASS III TREE (40' H X 40' W)	2" CAL., B&B		21
	EXISTING BOTANICAL / COMMON NAME	SIZE		QTY
	EXISTING CONIFER TREE TO REMAIN	---		6
	EXISTING DECIDUOUS TREE TO REMOVE	---		2
	BOTANICAL / COMMON NAME	SIZE	SPACING	QTY
	ARBUTUS UNEDO 'COMPACTA' COMPACT STRAWBERRY TREE	5 GAL.	60" o.c.	105
	CORNUS STOLONIFERA 'KELSEY' KELSEY DOGWOOD	3 GAL.	24" o.c.	370
	ILEX CRENATA CONVEXA CONVEX JAPANESE HOLLY	5 GAL. 48" HT. MIN.	48" o.c.	78
	JUNIPERUS SCOPULORUM 'SKYROCKET' SKYROCKET JUNIPER	8' HT. MIN.	48" o.c.	31
	MAHONIA AQUIFOLIUM OREGON GRAPE	5 GAL. 48" HT. MIN.	48" o.c.	204
	MAHONIA AQUIFOLIUM 'COMPACTA' COMPACT OREGON GRAPE	3 GAL.	36" o.c.	20
	NANDINA DOMESTICA 'GULF STREAM' GULF STREAM HEAVENLY BAMBOO	3 GAL.	36" o.c.	79
	PIERIS JAPONICA MOUNTAIN FIRE MOUNTAIN FIRE JAPANESE PIERIS	3 GAL.	60" o.c.	84
	PRUNUS LAUROCERASUS 'OTTO LUYKEN' OTTO LUYKEN LAUREL	3 GAL.	42" o.c.	104
	RIBES SANGUINEUM RED FLOWERING CURRANT	5 GAL.	48" o.c.	80
	SPIRAEA BETULIFOLIA 'TOR' BIRCHLEAF SPIRAEA	3 GAL.	30" o.c.	324
	THUJA OCCIDENTALIS 'SMARAGD' EMERALD GREEN ARBORVITAE	8' HT. MIN.	48" o.c.	67
	BOTANICAL / COMMON NAME	SIZE	SPACING	QTY
	PENNISETUM ALOPECUROIDES 'HAMELN' HAMELN FOUNTAIN GRASS	1 GAL.	24" o.c.	88
	BOTANICAL / COMMON NAME	SIZE	SPACING	QTY
	LONICERA JAPONICA 'HALLIANA' HALLS HONEYSUCKLE FLOWERING VINE	1 GAL.	24" o.c.	19
	LONICERA X 'MANDARIN' MANDARIN HONEYSUCKLE	1 GAL.	24" o.c.	19
	BOTANICAL / COMMON NAME	SIZE	SPACING	QTY
	ARCTOSTAPHYLOS UVA-URSI KINKINNICK	1 GAL.	18" o.c.	1,019 SF
	CALAMAGROSTIS X ACUTIFLORA 'KARL FOERSTER' KARL FOERSTER FEATHER REED GRASS	1 GAL.	24" o.c.	1,500 SF
	CAREX OBNUPTA SLOUGH SEDGE	1 GAL.	18" o.c.	856 SF
	POLYSTICHUM MUNITUM WESTERN SWORD FERN	3 GAL.	24" o.c.	8,368 SF
	ROCK MULCH MAINTENANCE BAND 1"-2" ROUND ROCK	---		1,146 SF
	RUBUS CALYCINOIDES 'EMERALD CARPET' EMERALD CARPET CREEPING BRAMBLE	1 GAL.	18" o.c.	14,018 SF
	TURF SEED	---		4,108 SF

LANDSCAPE NOTES

- GENERAL**
- CONTRACTOR SHALL CONFIRM ALL EXISTING CONDITIONS PRIOR TO COMMENCING WORK.
 - CALL BEFORE YOU DIG. CONTRACTOR SHALL VERIFY INVERT ELEVATIONS OF ALL UNDERGROUND UTILITIES AND NOTIFY LANDSCAPE ARCHITECT IF THERE ARE ANY DISCREPANCIES WITH PLANTING ROOT ZONES. TO REQUEST LOCATES FOR PROPOSED EXCAVATION CALL 1-800-424-5555 (OR 811) IN WASHINGTON.
 - NOTIFY THE OWNER OR OWNER'S REPRESENTATIVE OF ANY DISCREPANCIES OR CONFLICTS WITH EXISTING CONDITIONS PRIOR TO COMMENCEMENT OF ANY WORK.
 - LOCATION OF EXISTING TREES SHALL BE VERIFIED IN THE FIELD BY THE CONTRACTOR PRIOR TO COMMENCEMENT OF WORK.
 - DAMAGE TO EXISTING CONCRETE CURB, ASPHALT PAVING, OR OTHER STRUCTURE SHALL BE REPAIRED OR REPLACED TO PRE CONSTRUCTION CONDITIONS.
 - CONTRACTOR SHALL COORDINATE WITH THE OWNER ANY DISRUPTION TO VEHICULAR CIRCULATION PRIOR TO COMMENCEMENT OF ANY WORK.
- PLANTING**
- ALL EXISTING TREES, PLANTS, AND ROOTS SHALL BE PROTECTED FROM DAMAGE FROM ANY CONSTRUCTION PREPARATION, REMOVAL OR INSTALLATION ACTIVITIES WITHIN AND ADJACENT TO PROJECT LIMITS.
 - SHRUBS ADJACENT TO PARKING AREAS SHALL BE PLANTED 2 FT MINIMUM AWAY FROM THE BACK OF CURB. SHRUBS AND GROUND COVER ALONG OTHER PAVEMENT EDGES SHALL BE PLANTED A MINIMUM OF ONE HALF THEIR ON CENTER SPACING AWAY FROM PAVEMENT EDGE.
 - ALL PLANT MATERIAL SHALL BE HEALTHY NURSERY STOCK, WELL BRANCHED AND ROOTED; FULL FOLIAGE, FREE FROM INSECTS, DISEASES, WEEDS, WEED ROT, INJURIES AND DEFECTS WITH NO LESS THAN MINIMUMS SPECIFIED IN AMERICAN STANDARDS FOR NURSERY STOCK, ANSI Z60.1-2004.
 - TREES IN THE RIGHT OF WAY SHALL BE TALL ENOUGH TO BE LIMBED UP TO AT LEAST 8 FT ABOVE DRIVE SURFACE GRADE WHILE MAINTAINING ENOUGH BRANCHES TO SUPPORT HEALTHY GROWTH.
 - DO NOT PLANT TREES ABOVE WATERLINES, UTILITIES, OR OTHER UNDERGROUND PIPING.
 - IF DISTURBANCE IS NECESSARY AROUND EXISTING TREES, CONTRACTOR SHALL PROTECT THE CROWN AND ALL WORK WITHIN THE TREE DRIPZONE SHALL BE LIMITED TO THE USE OF HAND TOOLS AND MANUAL EQUIPMENT ONLY.
 - REPLACE, REPAIR AND RESTORE DISTURBED LANDSCAPE AREAS DUE TO GRADING, TRENCHING OR OTHER REASONS TO PRE-CONSTRUCTION CONDITION AND PROVIDE MATERIAL APPROVED BY THE OWNER AND OWNER'S REPRESENTATIVE.
 - EXISTING AREAS PROPOSED FOR NEW PLANT MATERIAL SHALL BE CLEARED AND LEGALLY DISPOSED UNLESS SO NOTED.
 - A SOILS ANALYSIS, BY AN INDEPENDENT SOILS TESTING LABORATORY RECOGNIZED BY THE STATE DEPARTMENT OF AGRICULTURE, SHALL BE USED TO RECOMMEND AN APPROPRIATE PLANTING SOIL AND/OR SPECIFIED SOIL AMENDMENTS.
 - TOPSOIL SHALL BE AMENDED AS RECOMMENDED BY AN INDEPENDENT SOILS TESTING LABORATORY AND AS OUTLINED IN THE SPECIFICATION.
 - ALL LANDSCAPED AREAS SHALL BE COVERED BY A LAYER OF ORGANIC COMPOST MULCH TO A MINIMUM DEPTH OF 4-INCHES.
- IRRIGATION**
- UNLESS OTHERWISE INDICATED, ALL NEW LANDSCAPE AREAS TO BE IRRIGATED WITH A FULLY AUTOMATIC UNDERGROUND IRRIGATION SYSTEM. PROVIDE LOOP SYSTEM FOR OPTIMUM EFFICIENCY.
 - CONTRACTOR SHALL SUBMIT SHOP DRAWINGS (IRRIGATION PLANS) TO LANDSCAPE ARCHITECT PRIOR TO CONSTRUCTION. DRAWINGS TO INDICATE HEAD TYPE, GALLONS PER MINUTE, LATERAL LINES, AND BE AT MINIMUM SCALE OF 1"=20'
 - CONTRACTOR TO DETERMINE STATIC WATER PRESSURE AT THE P.O.C. PRIOR TO PREPARING SHOP DRAWINGS.
 - CONTRACTOR SHALL ESTABLISH MINIMUM PRESSURE AND MAXIMUM DEMAND REQUIREMENTS FOR IRRIGATION SYSTEM DESIGN, AND PROVIDE INFORMATION IN AN IRRIGATION SCHEDULE.
 - IRRIGATION SYSTEM AS DESIGNED AND INSTALLED SHALL PERFORM WITHIN THE TOLERANCES AND SPECIFICATIONS OF THE SPECIFIED MANUFACTURERS.
 - SYSTEM SHALL BE DESIGNED TO SUPPLY MANUFACTURER'S SPECIFIED MINIMUM OPERATING PRESSURE TO FARTHEST EMITTER FROM WATER METER.
 - SYSTEM SHALL PROVIDE HEAD TO HEAD COVERAGE WITHOUT OVERSPRAY ONTO BUILDING, FENCES, SIDEWALKS, PARKING AREAS, OR OTHER NON-VEGETATED SURFACES.
 - ALL IRRIGATION PIPE MATERIAL AND INSTALLATION SHALL CONFORM TO APPLICABLE CODE FOR PIPING AND COMPONENT REQUIREMENTS.
 - PROVIDE SLEEVING AT ALL AREAS WHERE PIPE TRAVELS UNDER CONCRETE OR HARD SURFACING.
 - VALVES SHALL BE WIRED AND INSTALLED PER MANUFACTURER'S RECOMMENDED INSTALLATION PROCEDURES AND CONNECTED TO THE IRRIGATION CONTROLLER.
 - REFER TO CIVIL DETAILS AND DETAILS ON L5.10 FOR POINT OF CONNECTION AND BACKFLOW PREVENTION INFORMATION.
 - MAINLINE LAYOUT IS DIAGRAMMATIC ONLY.
 - CONTROLLER TO BE MOUNTED ON BUILDING EXTERIOR. GENERAL CONTRACTOR TO COORDINATE LOCATION WITH OWNER'S REPRESENTATIVE.
 - ZONE THE FOLLOWING AREAS SEPARATELY. TEMPORARY AREAS, PERMANENT LANDSCAPE AREAS, AND TREES.
 - QUICK COUPLERS TO BE PLACED EVERY 300 LINEAR FEET MAX.
 - IRRIGATION SHALL BE WINTERIZED THROUGH LOW PRESSURE, HIGH VOLUME AIR BLOWOUT CONNECTION THROUGH QUICK COUPLER.
 - THE SYSTEM SHALL BE GRAVITY DRAINED. THE CONTRACTOR SHALL PROVIDE APPROPRIATE MANUAL DRAINS AT LOW POINTS.

SHEET INDEX

L0.01	LANDSCAPE GENERAL INFORMATION
L1.10	PLANTING PLAN EAST
L1.11	PLANTING PLAN CENTRAL
L1.12	PLANTING PLAN WEST
L1.20	MATERIALS AND LAYOUT PLAN
L5.10	LANDSCAPE DETAILS
L5.11	IRRIGATION DETAILS

TABLE OF ABBREVIATIONS

ANSI	AMERICAN NATIONAL STANDARDS INSTITUTE	GAL	GALLON MIXTURE
B&B	BALL AND BURLAP	POC	POINT OF CONNECTION
CAL	CALIPER	PVC	POLY VINYL CHLORIDE

SITE INFORMATION

JURISDICTION	PUYALLUP, WA
STORMWATER ZONE	PUYALLUP 2015 ML
SITE AREA	341,226 SF (7.82 AC)
BUFFER TYPE Ic - VISUAL BARRIER TREES (45 FT MATURE VIS MIN) EVERGREEN HEDGE (6 FT HT MIN) BUFFER WIDTH (6 FT MIN)	884 LF 38 FT HT 6 FT MIN 6 FT MIN
BUFFER TYPE IIb - FRONTAGE TREES (30 FT OC MAX) TREES (50% EVERGREEN MIN) SHRUBS (EVERGREEN, 5 FT OC MAX)	320 LF 9 TREES (112%) 5 (55%) 160 SHRUBS
BUFFER TYPE Ib - RESIDENTIAL SCREEN TREES (1 PER 40 LF MAX) EVERGREEN TREES (75% MAX) WALL (6 FT MIN)	109 LF 5 TREES (100%) 4 (80%) 6' HT
TYPE IV INTERNAL PARKING LOT LANDSCAPE PAVED AREA PARKING LOT LANDSCAPE AREA (10% MIN) TOTAL INTERNAL PARKING TREES TOTAL CONIFER TREES (50% MIN)	156,837 SF (100%) 18,822 SF (12%) 44 TREES (100%) 22 TREES (50%)
LOADING AREA BUFFER PER PMC 20.26.400(3) & 20.26.500(1) TREES (1 PER 15') SHRUBS (6' HT MIN)	133 LF 9 TREES 6' FT HT
TRAILER AREA PAVED AREA LANDSCAPE AREA (10% MIN)	33,012 SF (100%) 3,589 SF (10.8%)

BLANK WALL SCREEN MITIGATION
STAFF IS SUPPORTIVE OF REDUCING THE BLANK WALL PLANTER WIDTH ALONG THE SOUTH SIDE OF THE BUILDING DEPENDENT UPON MITIGATION IN THE FORM OF CU-STRUCTURAL PLANT SOILS (OR EQUIVALENT) IN A TOTAL SOIL VOLUME EQUAL TO THAT WHICH WOULD HAVE BEEN PROVIDED IF THE FULL 15' PLANTER WIDTH HAD BEEN INSTALLED.

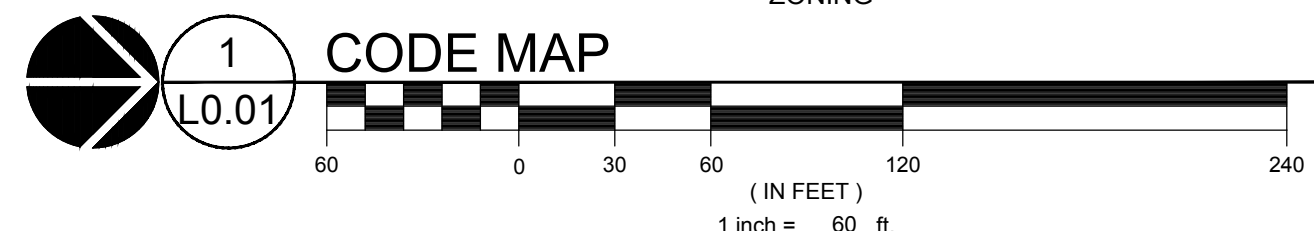
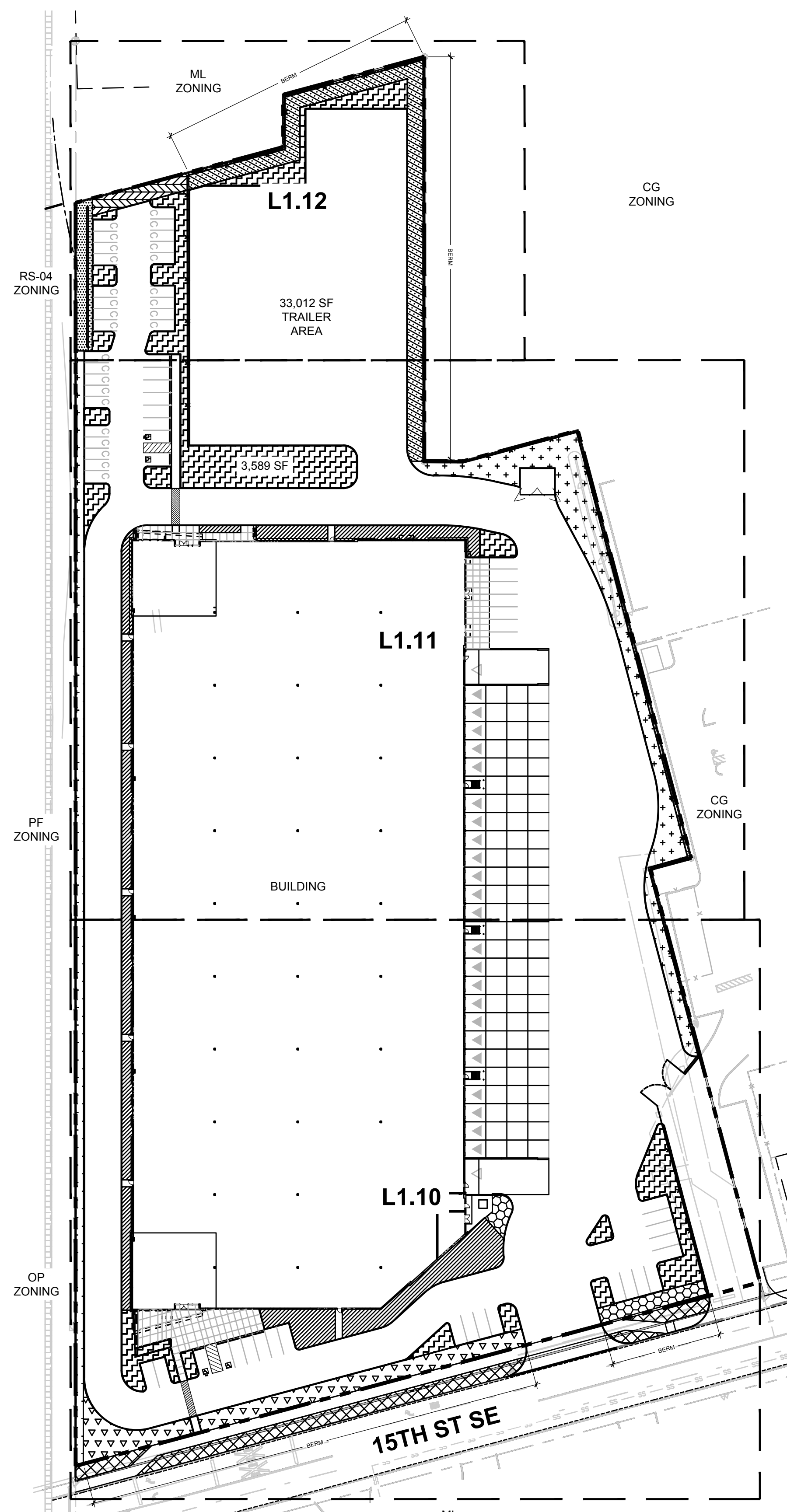

Architecture • Interiors
Planning • Engineering

Portland, OR 503.224.9560
Vancouver, WA 360.695.7879
Seattle, WA 206.749.9993
www.mcknz.com

MACKENZIE
DESIGN DRIVEN | CLIENT FOCUSED

Client
CREF3 PUYALLUP OWNER LLC

11611 SAN VICENTE BLVD
10TH FLOOR
LOS ANGELES CA 90049

Project
FORTRESS - PUYALLUP

240 15TH ST SE
PUYALLUP, WA, 98372

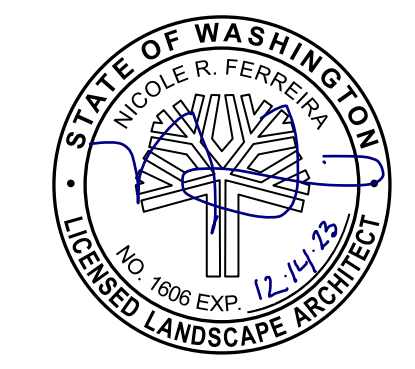

© MACKENZIE 2023
ALL RIGHTS RESERVED
THESE DRAWINGS ARE THE PROPERTY OF MACKENZIE AND ARE NOT TO BE USED OR REPRODUCED IN ANY MANNER WITHOUT PRIOR WRITTEN PERMISSION

REVISION SCHEDULE		
Delta	Issued As	Issue Date

SHEET TITLE:
LANDSCAPE GENERAL INFORMATION

DRAWN BY: LJM
CHECKED BY: NRF
SHEET:

L0.01

JOB NO. **2220290.00**



Architecture • Interiors
Planning • Engineering

Portland, OR
503.224.9560
Vancouver, WA
360.695.7879
Seattle, WA
206.749.9993
www.mcknze.com

MACKENZIE.

Client
**CREF3 PUYALLUP
OWNER LLC**

11611 SAN VICENTE
BLVD
10TH FLOOR
LOS ANGELES
CA 90049

Project
**FORTRESS -
PUYALLUP**

240 15TH ST SE
PUYALLUP, WA,
98372

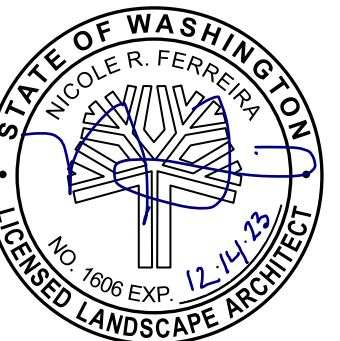

© MACKENZIE 2023
ALL RIGHTS RESERVED
THESE DRAWINGS ARE THE PROPERTY OF
MACKENZIE AND ARE NOT TO BE USED
OR REPRODUCED IN ANY MANNER
WITHOUT PRIOR WRITTEN PERMISSION

REFERENCE NOTES

1. PLANT SIZE, SPACING, AND QUANTITY, SEE PLANT SCHEDULE L0.01
2. EXISTING TREES TO REMAIN. DO NOT DISTURB. PROTECT IN PLACE.
3. PROPOSED UTILITY BOX. AVOID PLANTING WITHIN DEFINED ACCESS ZONE.
4. CAREFULLY EXCAVATE SHRUB PITS IN VICINITY OF EXISTING TREES, WITHOUT DISTURBING TREE ROOTS.
5. COORDINATE SHRUB LAYOUT WITH EXISTING UTILITIES, REPORT CONFLICTS TO LANDSCAPE ARCHITECT.

REVISION SCHEDULE		
Delta	Issued As	Issue Date

SHEET TITLE:
**PLANTING PLAN
EAST**

DRAWN BY: LJM
CHECKED BY: NRF
SHEET:

L1.10

JOB NO. **2220290.00**



DESIGN REVIEW AND SEPA SUBMISSION

222029000DRAWINGS\LANDSCAPE\220-L0.01.DWG\L1.10 AEZ 06/13/23 11:07 1:0.08

MATCHLINE - SEE L1.11

BUILDING

SOIL CELLS TO EXTEND ALONG SOUTH SIDE
OF BUILDING FROM EDGE OF CURB TO 15'
FROM EDGE OF BUILDING PER BLANK WALL
SCREENING MITIGATION NOTED ON L0.01

(P) BENCH (QTY 2)
(P) BIKE RACK (QTY 2)

(P) SOIL CELLS

15TH ST SE

(E) HYDRANT
(E) ELECTRICAL EQUIPMENT

(P) TRANSFORMER

(P) WALL

(P) SOIL CELLS

(E) UTILITY POLE

(E) HYDRANT

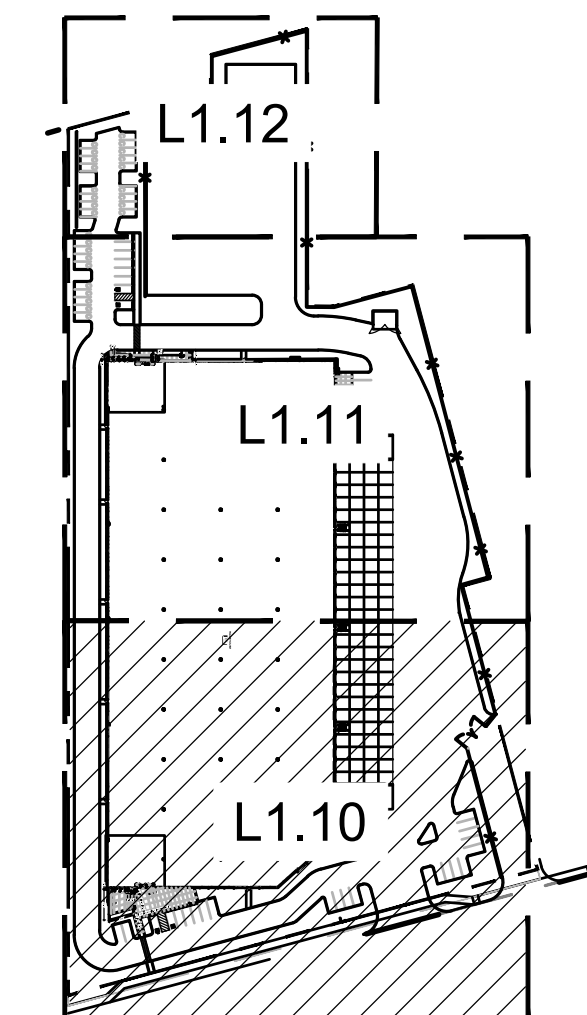
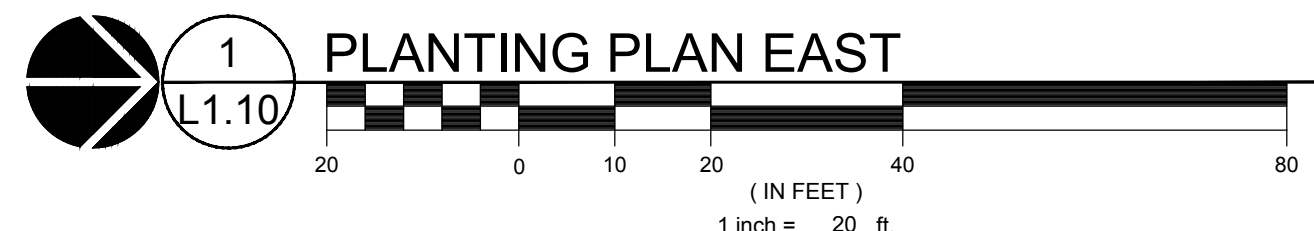



Architecture • Interiors
Planning • Engineering

Portland, OR
503.224.9560
Vancouver, WA
360.695.7879
Seattle, WA
206.749.9993
www.mcknze.com

MACKENZIE.
DESIGN DRIVEN | CLIENT FOCUSED

Client
**CREF3 PUYALLUP
OWNER LLC**

11611 SAN VICENTE
BLVD
10TH FLOOR
LOS ANGELES
CA 90049

Project
**FORTRESS -
PUYALLUP**

240 15TH ST SE
PUYALLUP, WA,
98372

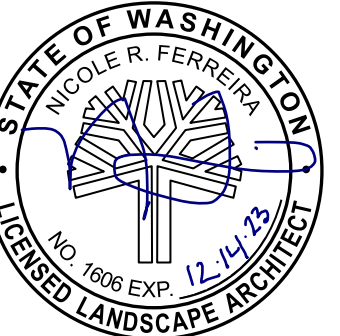

© MACKENZIE 2023
ALL RIGHTS RESERVED
THESE DRAWINGS ARE THE PROPERTY OF
MACKENZIE AND ARE NOT TO BE USED
OR REPRODUCED IN ANY MANNER,
WITHOUT PRIOR WRITTEN PERMISSION

REFERENCE NOTES

1. PLANT SIZE, SPACING, AND QUANTITY, SEE PLANT SCHEDULE L0.01
2. EXISTING TREE TO REMAIN. DO NOT DISTURB. PROTECT IN PLACE.
3. PROPOSED UTILITY BOX. AVOID PLANTING WITHIN DEFINED ACCESS ZONE.
4. CAREFULLY EXCAVATE SHRUB PITS IN VICINITY OF EXISTING TREES, WITHOUT DISTURBING TREE ROOTS.
5. COORDINATE SHRUB LAYOUT WITH EXISTING UTILITIES, REPORT CONFLICTS TO LANDSCAPE ARCHITECT.

REVISION SCHEDULE		
Delta	Issued As	Issue Date

SHEET TITLE:
**PLANTING PLAN
CENTRAL**

DRAWN BY: LJM, AEZ

CHECKED BY: NRF

SHEET:

L1.11

JOB NO. **2220290.00**

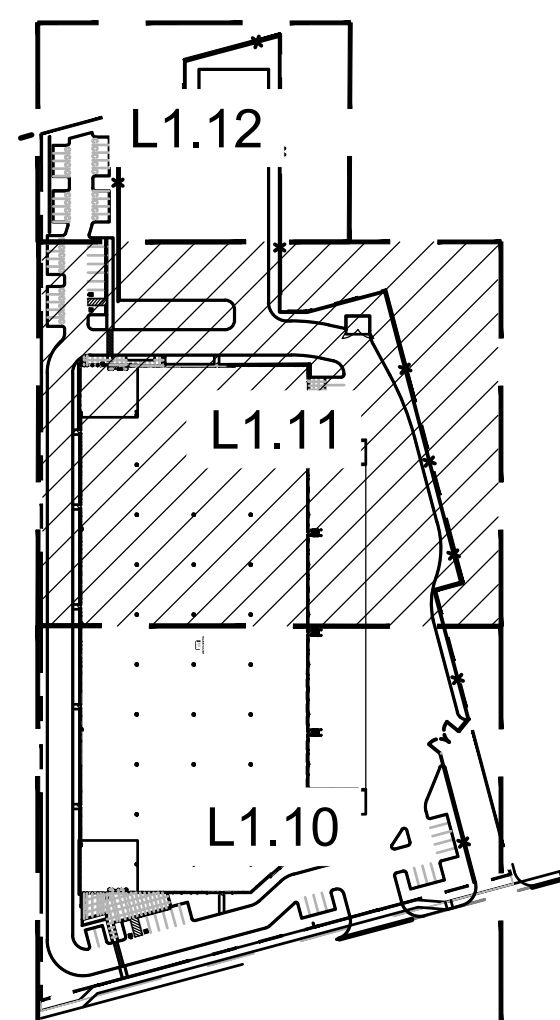

DESIGN REVIEW AND SEPA SUBMISSION
222029000\DRAWING\LANDSCAPE\2220290-01.DWG\L1.11 NRF 08/28/23 13:45 1.0/08

MATCHLINE - SEE L1.12

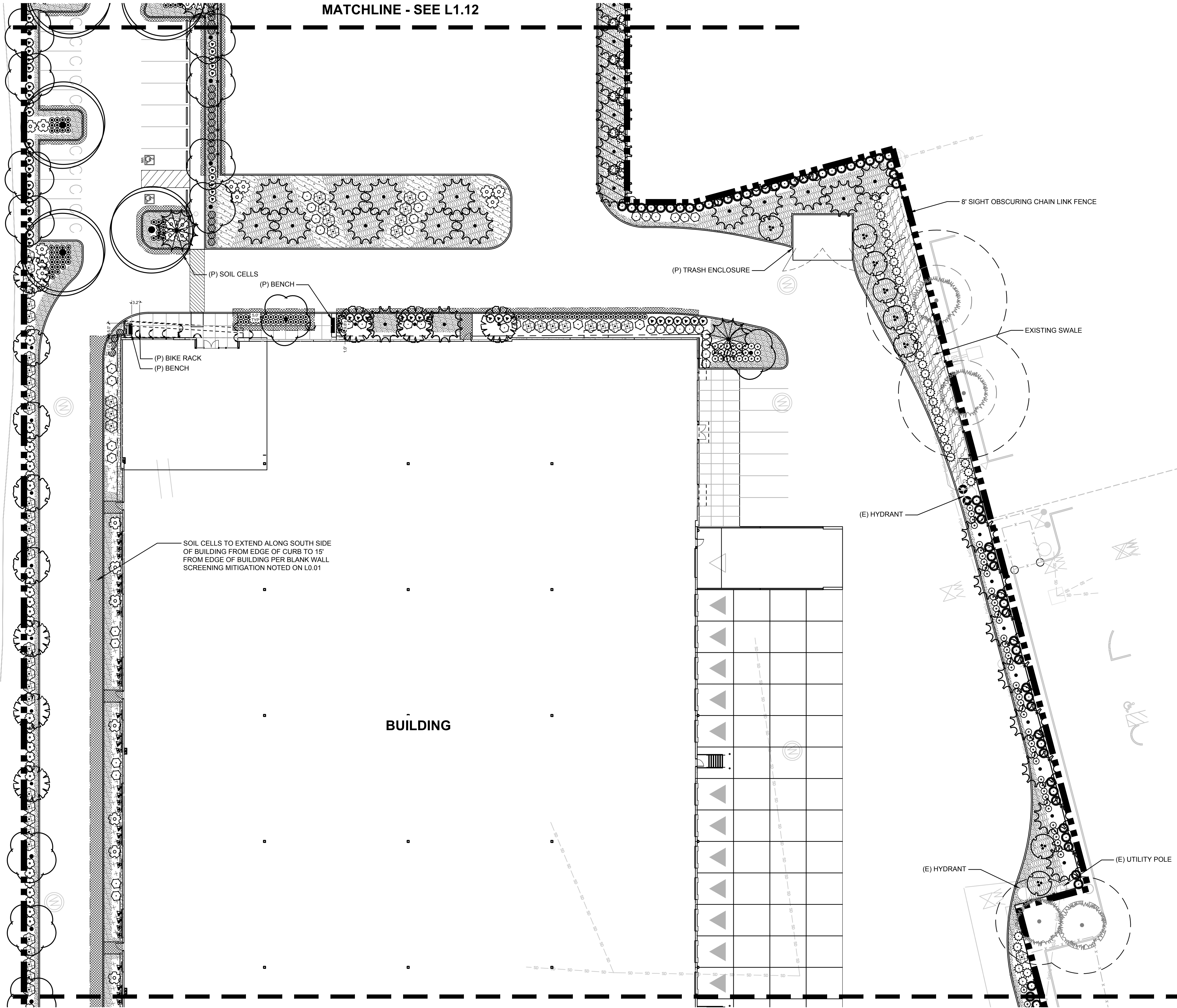

SOIL CELLS TO EXTEND ALONG SOUTH SIDE OF BUILDING FROM EDGE OF CURB TO 15' FROM EDGE OF BUILDING PER BLANK WALL SCREENING MITIGATION NOTED ON L0.01

BUILDING

MATCHLINE - SEE L1.10

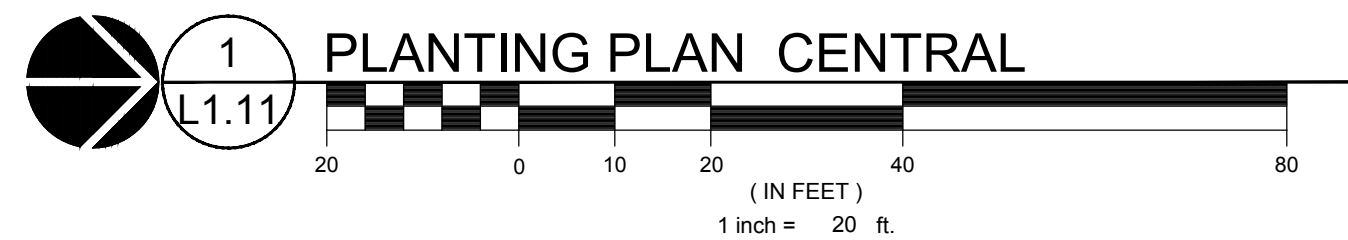

1 PLANTING PLAN CENTRAL

L1.11

1 inch = 20 ft.



Architecture • Interiors
Planning • Engineering

Portland, OR
503.224.9560
Vancouver, WA
360.695.7879
Seattle, WA
206.749.9993
www.mcknze.com

MACKENZIE.
DESIGN DRIVEN | CLIENT FOCUSED

Client
**CREF3 PUYALLUP
OWNER LLC**

11611 SAN VICENTE
BLVD
10TH FLOOR
LOS ANGELES
CA 90049

Project
**FORTRESS -
PUYALLUP**

240 15TH ST SE
PUYALLUP, WA,
98372

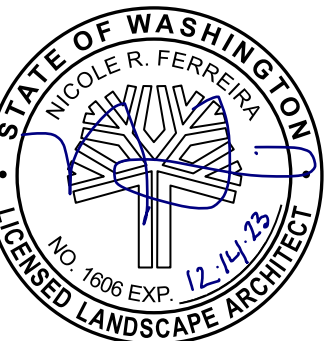

© MACKENZIE 2023 ALL RIGHTS RESERVED
THESE DRAWINGS ARE THE PROPERTY OF
MACKENZIE AND ARE NOT TO BE USED
OR REPRODUCED IN ANY MANNER
WITHOUT PRIOR WRITTEN PERMISSION

REFERENCE NOTES

- 1. PLANT SIZE, SPACING, AND QUANTITY, SEE PLANT SCHEDULE L0.01
- 2. COORDINATE SHRUB LAYOUT WITH EXISTING UTILITIES, REPORT CONFLICTS TO LANDSCAPE ARCHITECT.

REVISION SCHEDULE		
Delta	Issued As	Issue Date

SHEET TITLE:
PLANTING PLAN WEST

DRAWN BY: LJM
CHECKED BY: NRF
SHEET:

L1.12

JOB NO. **2220290.00**

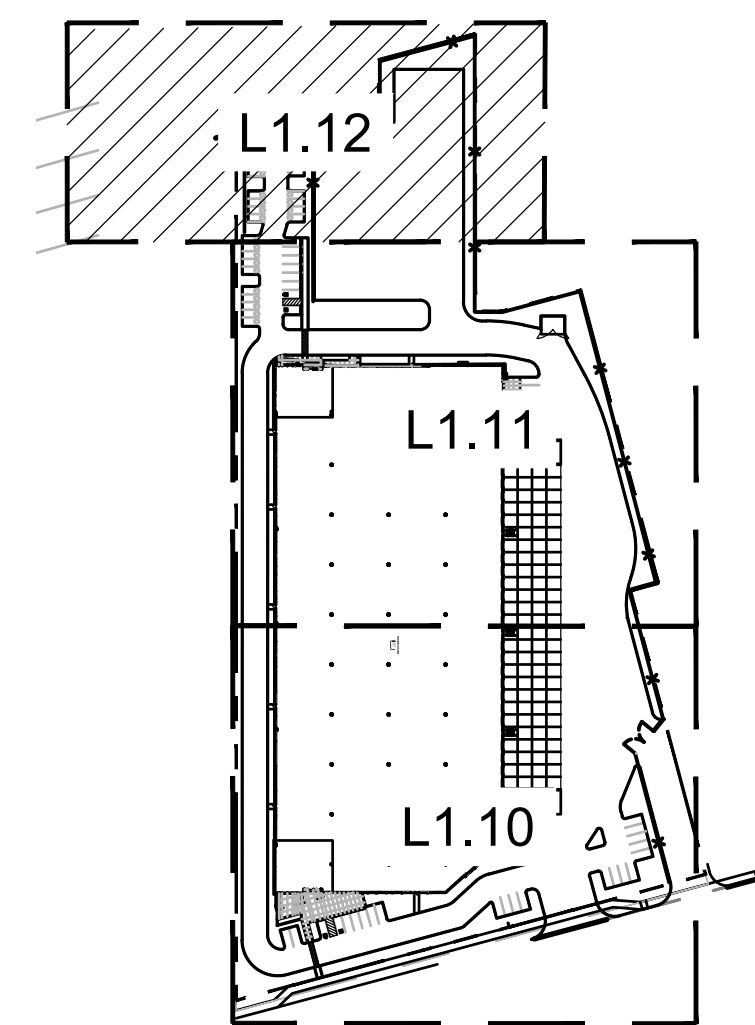

KEY MAP
SCALE: NTS

DESIGN REVIEW AND SEPA SUBMISSION
222029000\DRAWINGS\LANDSCAPE\220-L0.01.DWG\L1.12_AEZ_06/01/23_15:53 1.0.08

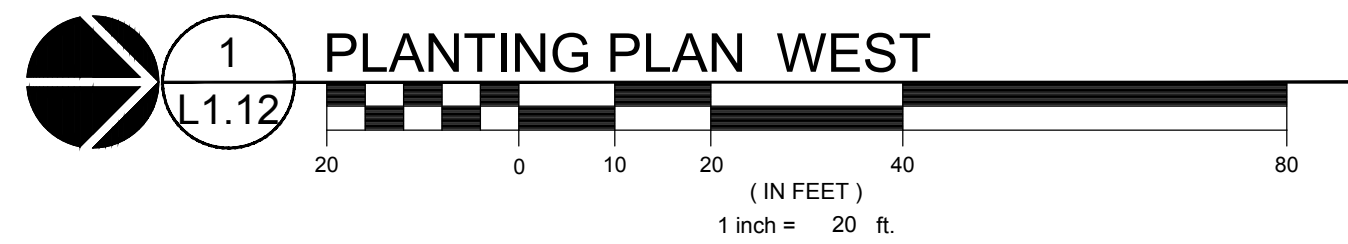
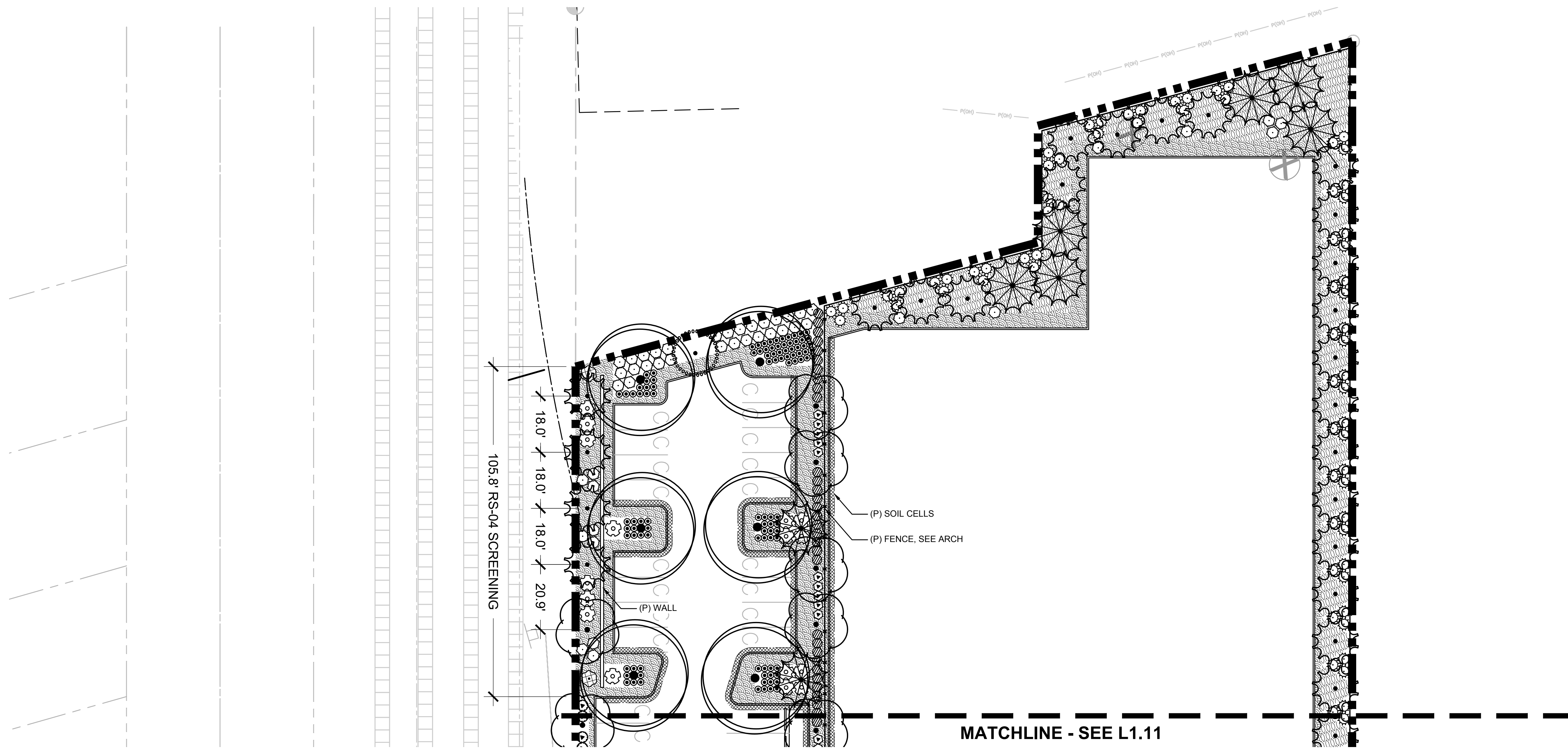

1 PLANTING PLAN WEST
L1.12



Architecture • Interiors
Planning • Engineering

Portland, OR
503.224.9560
Vancouver, WA
360.695.7879
Seattle, WA
206.749.9993
www.mcknze.com

MACKENZIE.
DESIGN DRIVEN | CLIENT FOCUSED

Client
**CREF3 PUYALLUP
OWNER LLC**

11611 SAN VICENTE
BLVD
10TH FLOOR
LOS ANGELES
CA 90049

Project
**FORTRESS -
PUYALLUP**

240 15TH ST SE
PUYALLUP, WA,
98372

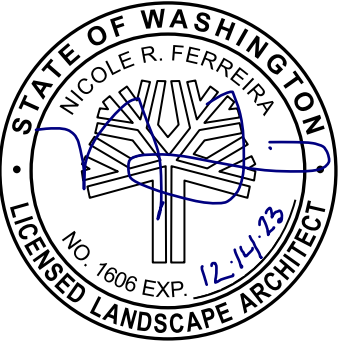

© MACKENZIE 2023
ALL RIGHTS RESERVED
THESE DRAWINGS ARE THE PROPERTY OF
MACKENZIE AND ARE NOT TO BE USED
OR REPRODUCED IN ANY MANNER
WITHOUT PRIOR WRITTEN PERMISSION

REFERENCE NOTES

1. PLANT SIZE, SPACING, AND QUANTITY, SEE PLANT SCHEDULE L0.01
2. EXISTING TREE TO REMAIN. DO NOT DISTURB. PROTECT IN PLACE.
3. PROPOSED UTILITY BOX. AVOID PLANTING WITHIN DEFINED ACCESS ZONE.
4. CAREFULLY EXCAVATE SHRUB PITS IN VICINITY OF EXISTING TREES. WITHOUT DISTURBING TREE ROOTS.
5. COORDINATE SHRUB LAYOUT WITH EXISTING UTILITIES, REPORT CONFLICTS TO LANDSCAPE ARCHITECT.

REVISION SCHEDULE

Delta	Issued As	Issue Date

SHEET TITLE:
**LAYOUT AND
MATERIALS
PLAN**

DRAWN BY: AEZ

CHECKED BY: NRF

SHEET:

L1.20

JOB NO. **2220290.00**



DESIGN REVIEW AND SEPA SUBMISSION
222029000\DRAWINGS\LANDSCAPE\22090-L01.DWG L1.20 NRF 08/28/23 16:24 1:0.08

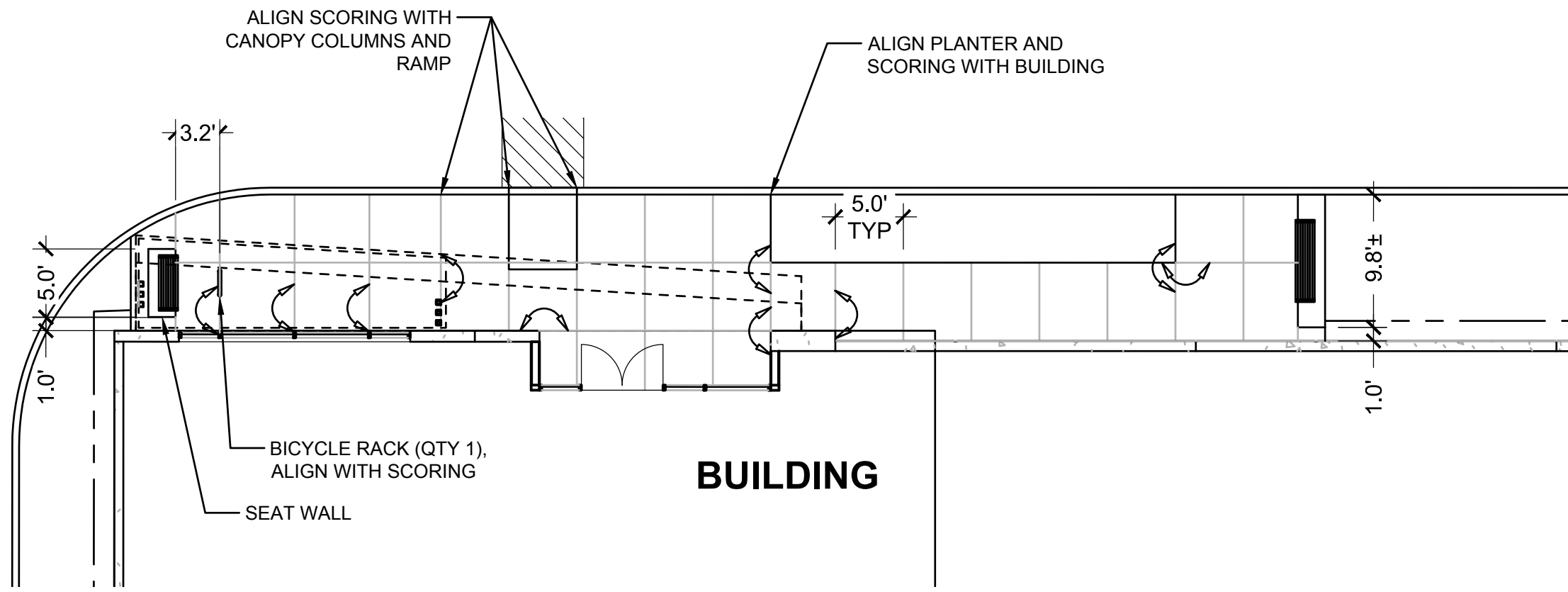

1 LAYOUT PLAN
L1.20
(IN FEET)
1 inch = 20 ft.

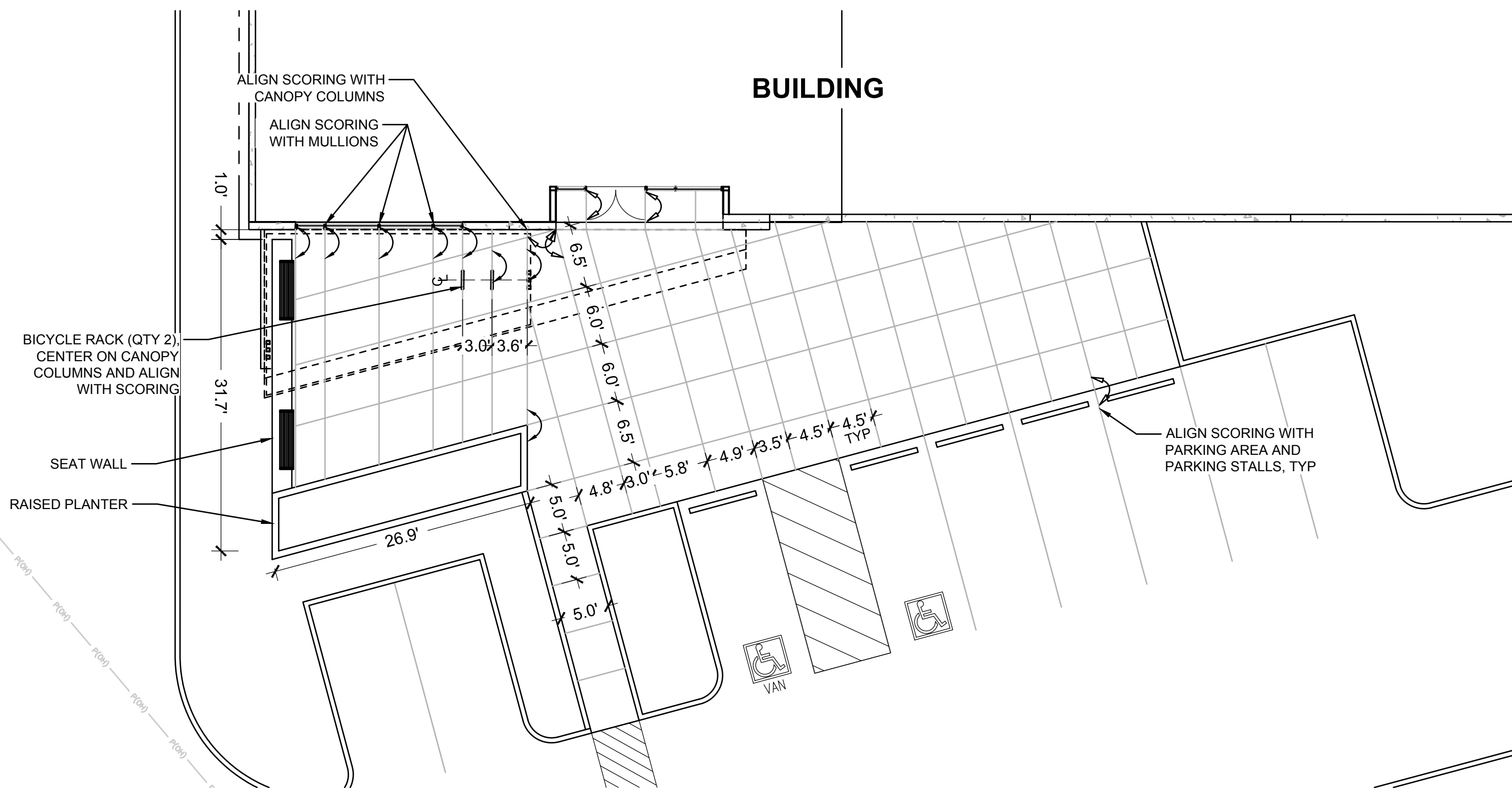

1 MATERIALS AND LAYOUT PLAN
L1.20
(IN FEET)
1 inch = 20 ft.

REVISION SCHEDULE		
Delta	Issued As	Issue Date

SHEET TITLE:
**LANDSCAPE
DETAILS**

DRAWN BY: LJM

CHECKED BY: NRF

SHEET:

L5.10

JOB NO. **2220290.00**

DESIGN REVIEW AND SEPA SUBMISSION

2220290001 C:\TEMP\AC3PUBLISH\10384290\10.01.DWG:L5.10.NRF 08/28/23 16:57 1:0.08

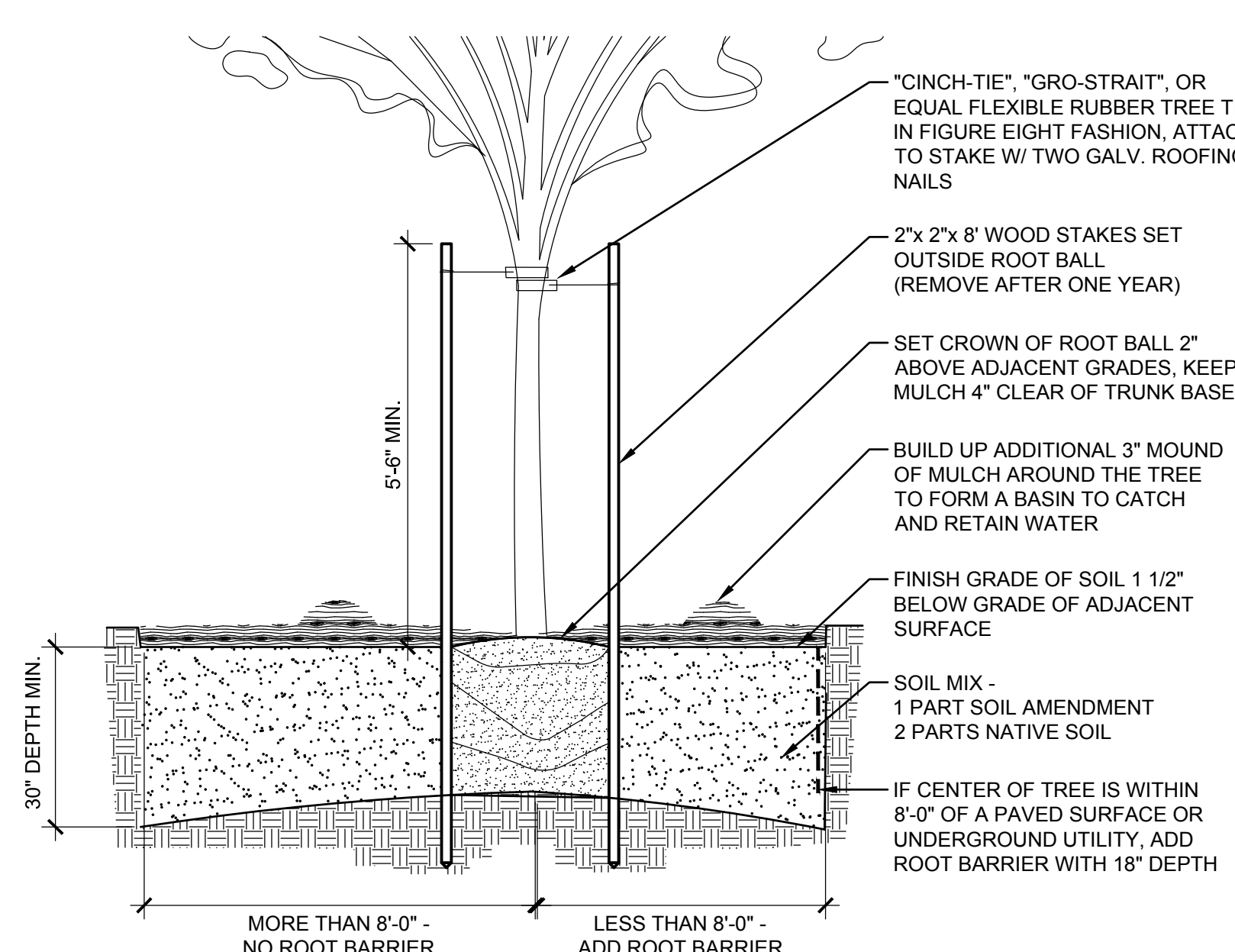

1 DECIDUOUS TREE PLANTING DETAIL

NOTES

- PLANT ALL TREES AT LEAST 32 INCHES FROM THE END OF HEAD-IN PARKING SPACES TO PREVENT DAMAGE FROM CAR OVERHANGS.
- ALL ROOTS MUST BE COMPLETELY COVERED. BACKFILL SHOULD BE THOROUGHLY WATERED AS IT IS PLACED AROUND THE ROOTS.
- SCARIFY AND ROUGHEN BOTTOM OF PLANTING PIT PRIOR TO PLACING TREE AND TOPSOIL. SLOPE BOTTOM TO DRAIN TO SIDES.
- THE ENTIRE WIDTH OF THE PLANTING ISLAND SHALL CONTAIN ONLY SOIL/COMPOST PLANTING MIX AND BE FREE OF ALL DEBRIS INCLUDING GARBAGE, CONCRETE, GRAVEL OR OTHER FOREIGN MATERIALS.
- ALL TREES SHALL CONFORM TO MOST RECENT ANSI Z60.1 AMERICAN STANDARD FOR NURSERY STOCK. FIRST LIMBS OF DECIDUOUS TREES IN PARKING LOTS AND ALONG STREETS AND SIDEWALKS SHALL BE 5 FEET ABOVE GROUND OR HIGHER.
- EXCAVATE HOLE INTO PREPARED SOIL TO ONE INCH LESS THAN HEIGHT OF ROOTBALL AND TWO TIMES THE WIDTH OF THE ROOTBALL. TAMP BOTTOM OF PIT UNDER ROOTBALL THOROUGHLY TO KEEP TREE FROM SETTLING. BUTTRESS AT THE BOTTOM OF THE PIT NO LESS THAN THREE FEET WIDE IF NEEDED TO REINFORCE LATERAL SUPPORT.
- DO NOT DAMAGE THE ROOTBALL WHEN PLANTING. REMOVE ALL WIRE, STRING AND BURLAP FROM TOP AND SIDES OF ROOTBALL ONLY AFTER PLACING IN THE HOLE.
- SET TREE STRAIGHT ON TAMPED SOIL.
- BACKFILL HOLE WITH APPROVED PLANTING MEDIUM MIX TO HALF DEPTH. TAMP SOIL TO STABILIZE ROOTBALL. FINISH BACKFILLING AND TAMP AGAIN.
- STAKE TREES OUTSIDE OF ROOTBALL AND PARALLEL TO PLANTING ISLAND CURBS WITH TREE STAKES. USE ONE INCH HEAVY CHAINLOCK TREE TIES OR SIMILAR. REMOVE AFTER ONE YEAR.
- WATER IMMEDIATELY AND THOROUGHLY, TWICE PER WEEK DURING THE FIRST MONTH, THEN ONCE PER WEEK THROUGH THE REMAINDER OF THE DRY SEASON. WATER A MINIMUM OF ONCE PER MONTH DURING THE SECOND SUMMER SEASON.
- ALL PLANTING BEDS CONTAINING TREES AND SHRUBS AND SURFACE DRAINAGE SHALL BE PREPARED SIMILAR TO THIS LANDSCAPE TREE PLANTING AND DRAINAGE DETAIL.

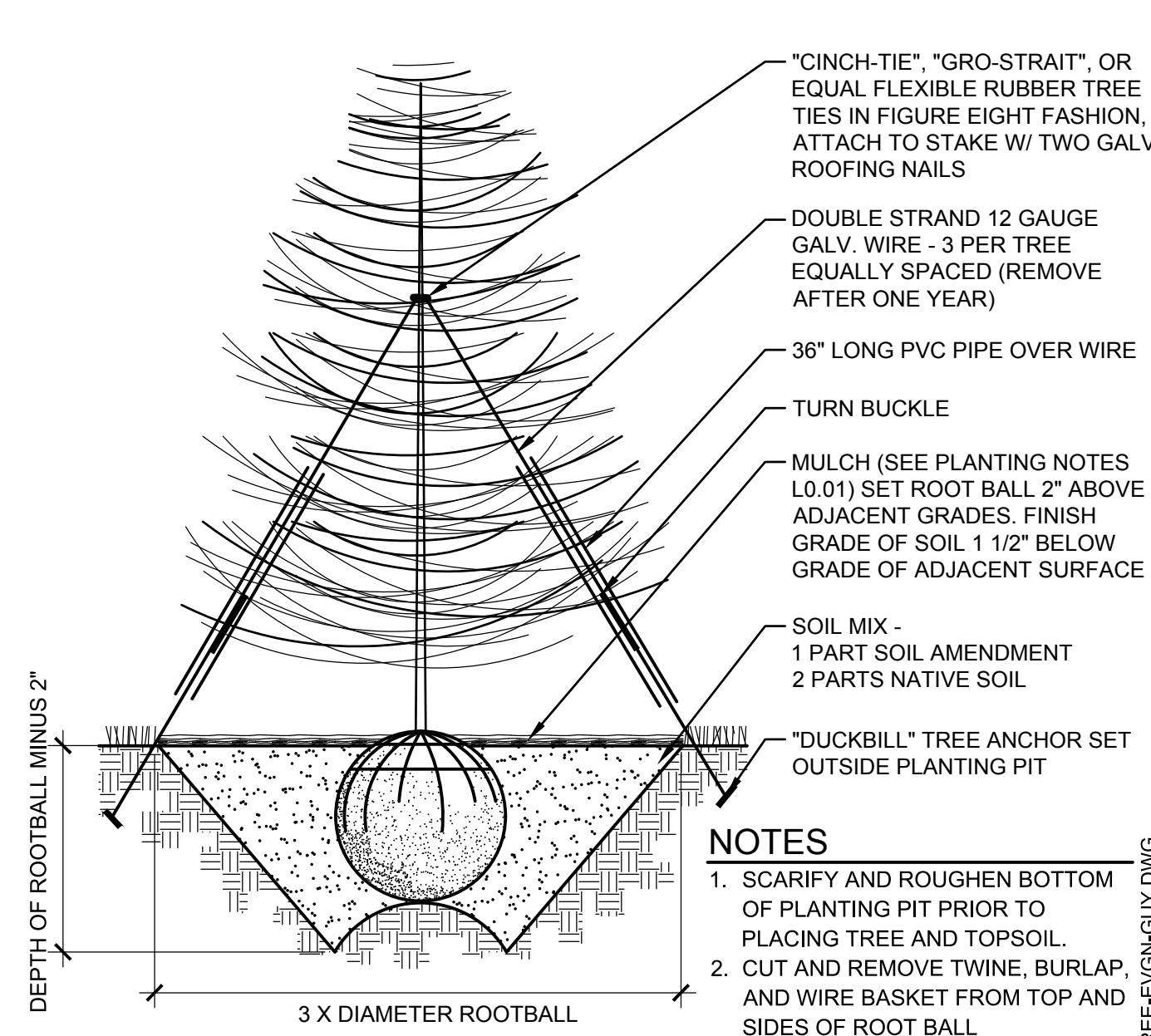

2 EVERGREEN TREE PLANTING DETAIL

NOTES

- SCARIFY AND ROUGHEN BOTTOM OF PLANTING PIT PRIOR TO PLACING TREE AND TOPSOIL.
- CUT AND REMOVE TWINE, BURLAP, AND WIRE BASKET FROM TOP AND SIDES OF ROOT BALL

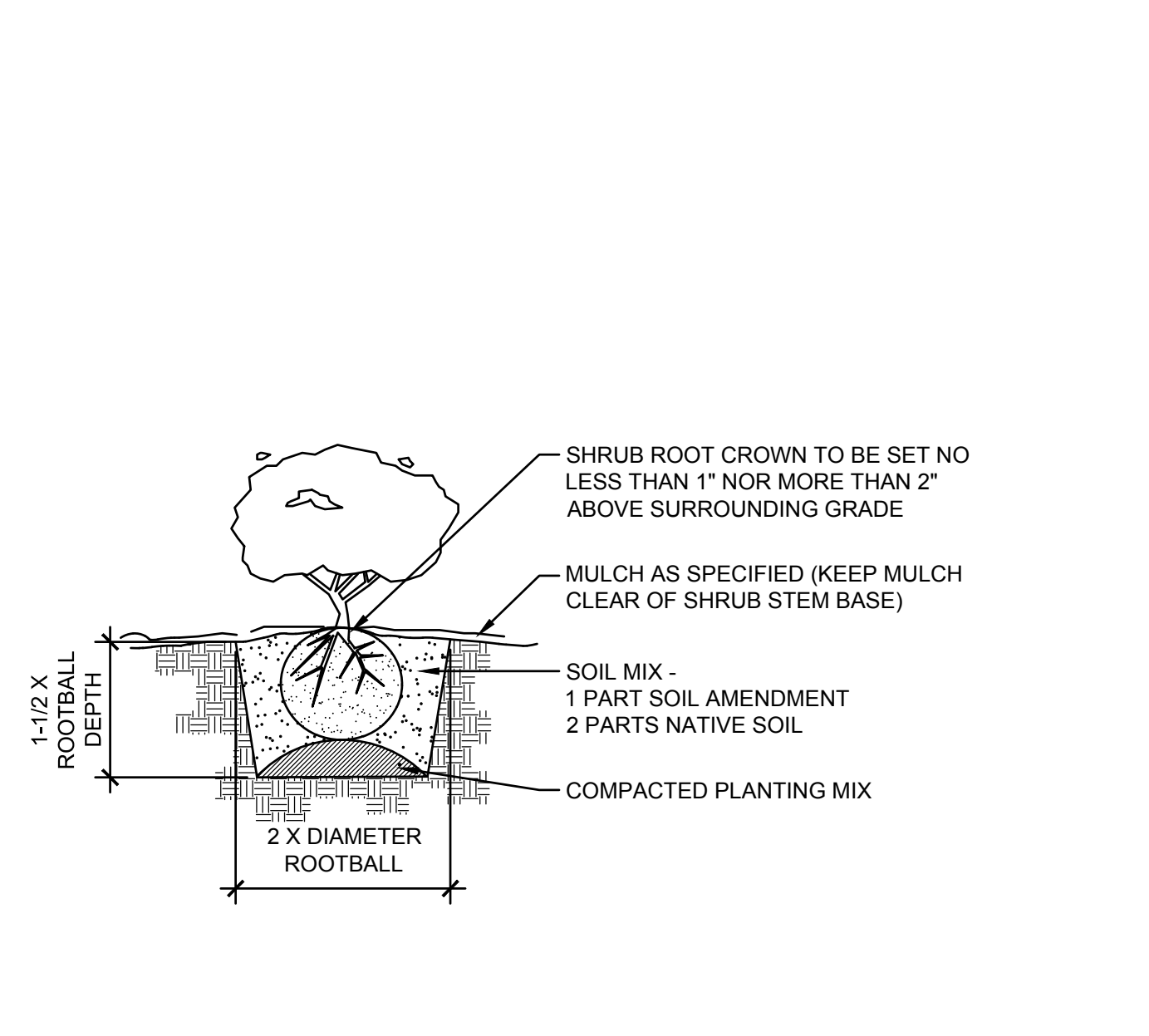

3 SHRUB PLANTING

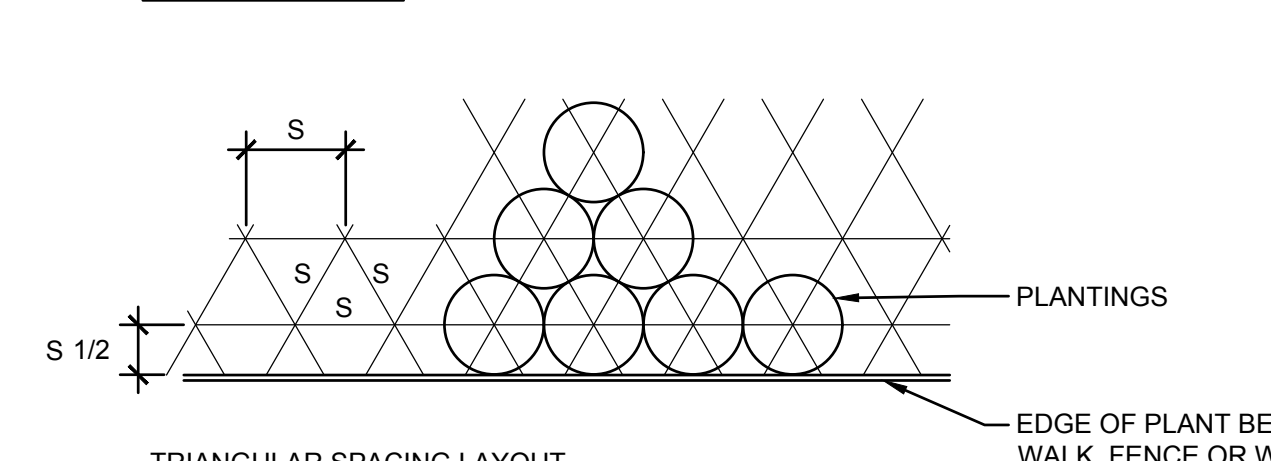
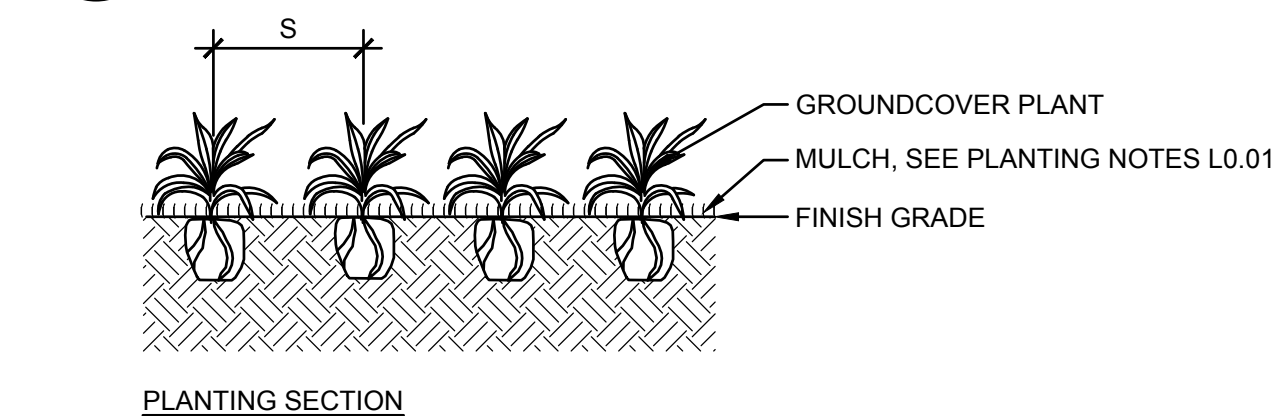

NOTES

- TILL SOIL SO THAT THERE ARE NO CLOUDS OR CLUMPS LARGER THAN 1 1/2\"/>

4 GROUNDCOVER PLANTING

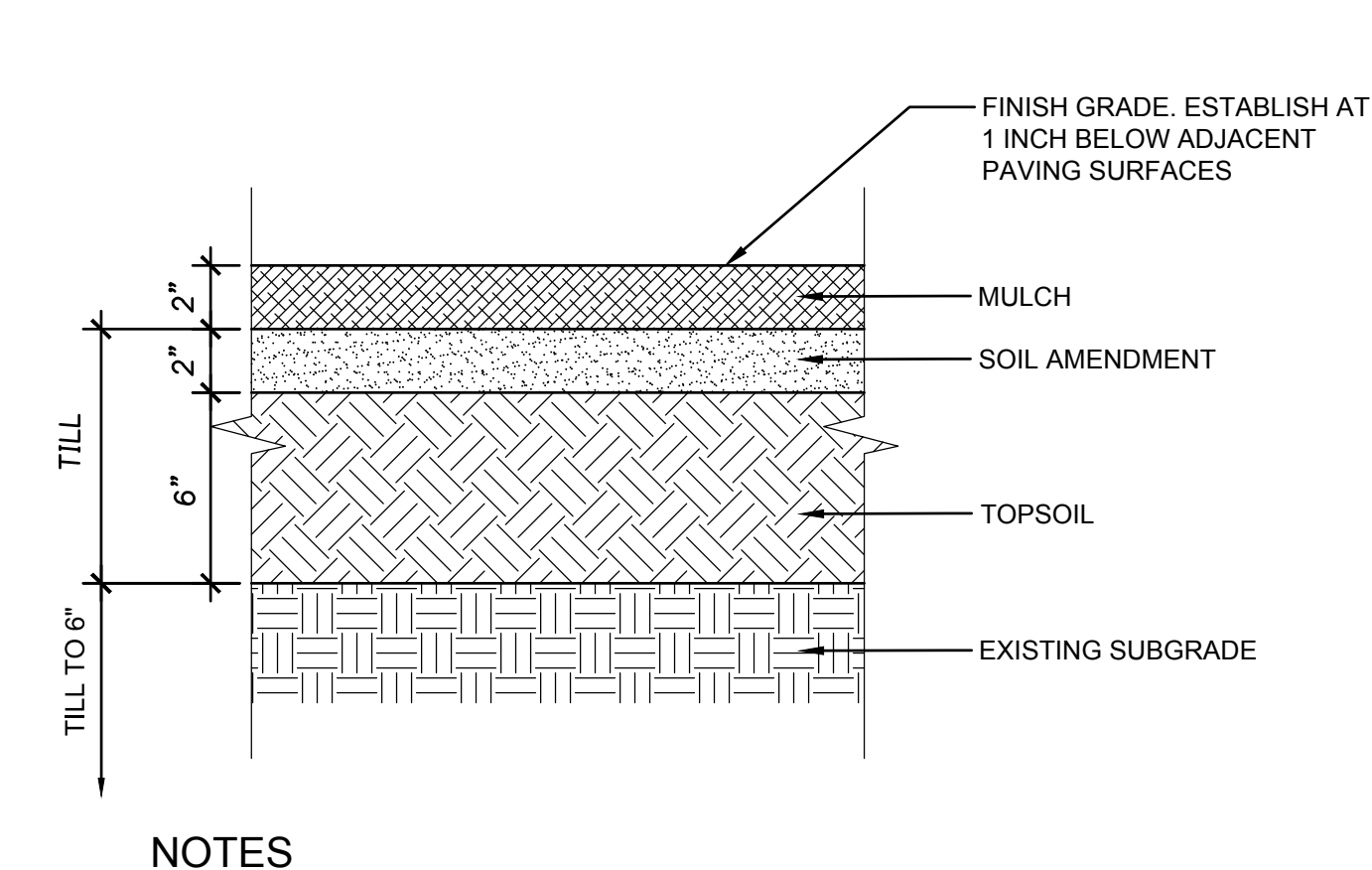

NOTES

- REMOVE ALL ROCK, DEBRIS AND OTHER FOREIGN MATTER OVER 2\"/>

5 SOIL PREPARATION

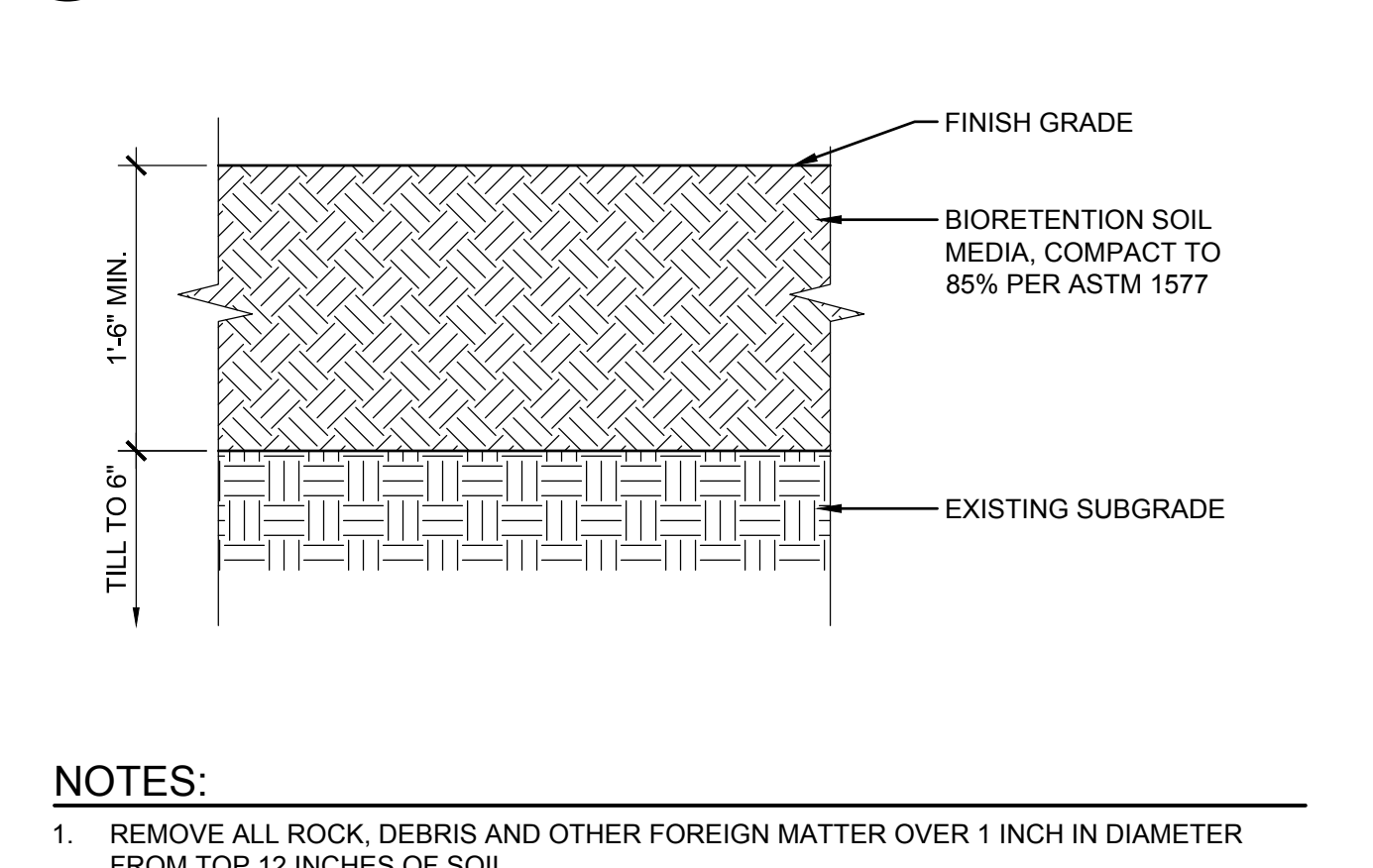

NOTES:

- REMOVE ALL ROCK, DEBRIS AND OTHER FOREIGN MATTER OVER 1 INCH IN DIAMETER FROM TOP 12 INCHES OF SOIL.
- BIORETENTION SOIL MEDIA SHALL MEET THE STANDARDS ESTABLISHED IN THE 2012 STORMWATER MANAGEMENT MANUAL FOR WESTERN WASHINGTON, AS AMENDED IN DECEMBER 2014, VOLUME V - CHAPTER 7 'DEFAULT' BIORETENTION SOIL MEDIA (BSM).
- RIP AND TILL EXISTING TOPSOIL TO 6 INCHES DEEP MINIMUM, PRIOR TO INSTALLING GROWING MEDIUM. TILL INTERFACE OF SUBGRADE AND TOPSOIL.
- MIX GROWING MEDIUM AND EXISTING TOPSOIL TO A MINIMUM 10 INCH DEPTH.

6 SOIL PREP. AT STORMWATER WESTERN WASHINGTON

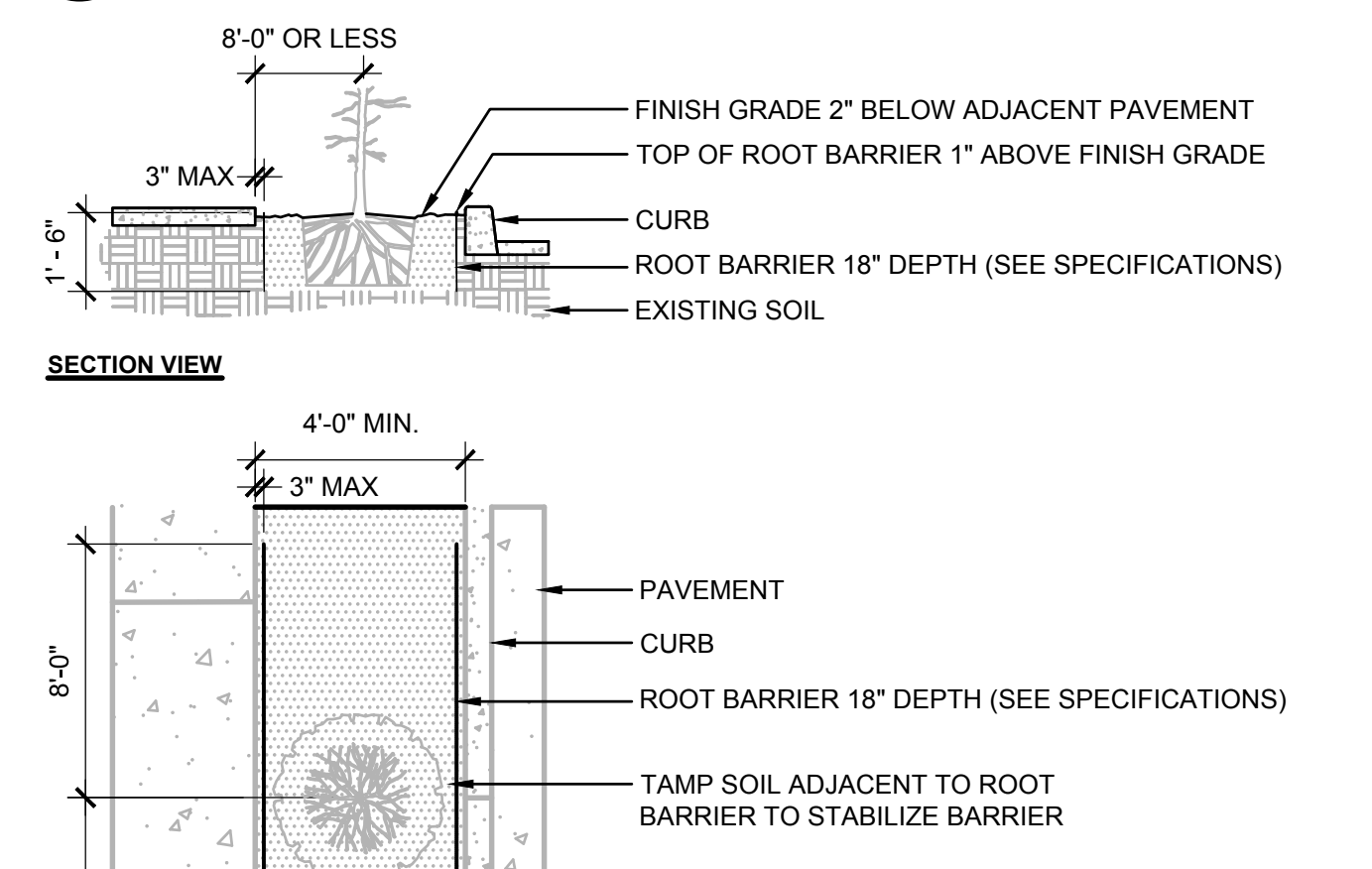

7 ROOT BARRIER DETAIL

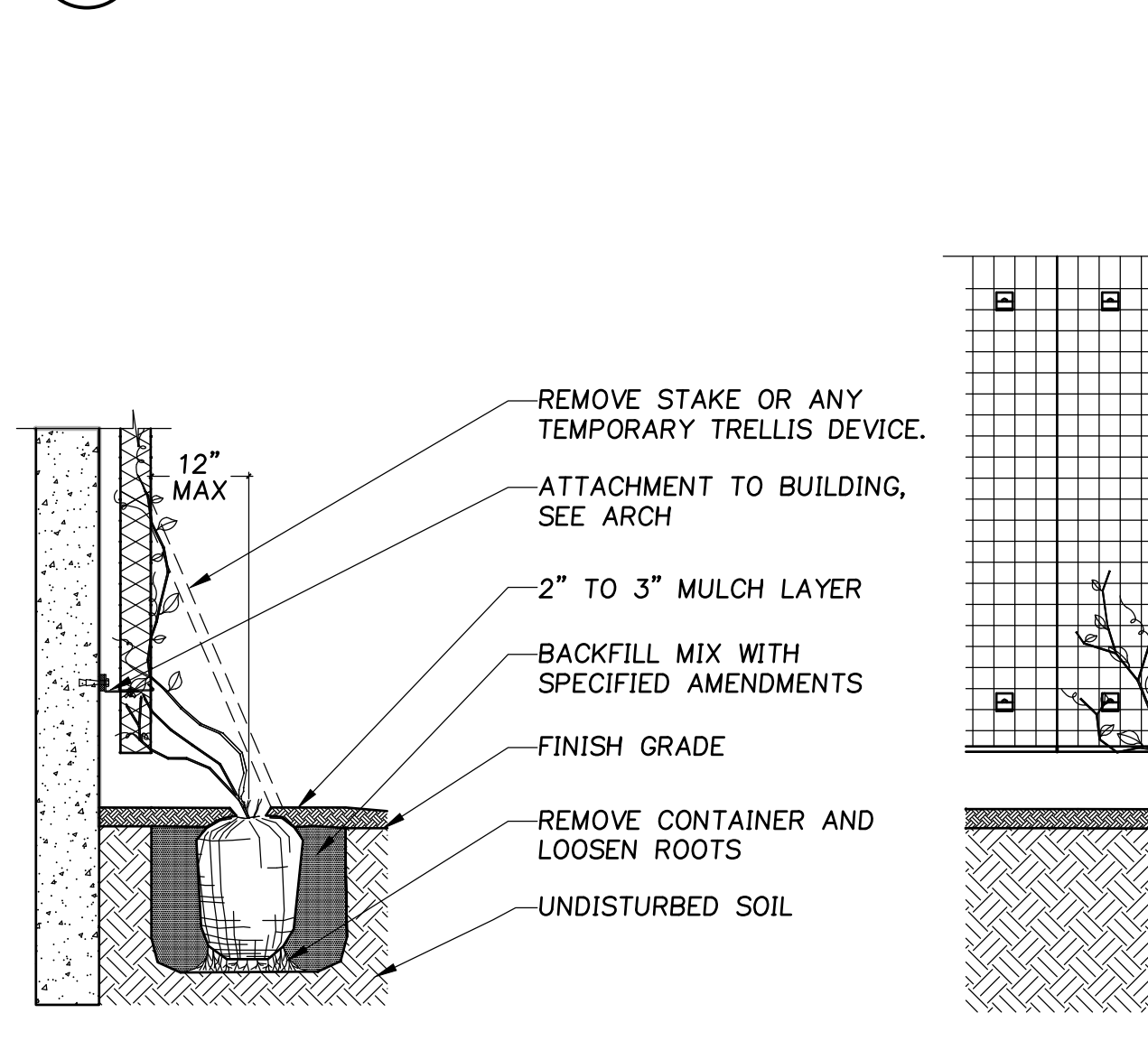

8 VINE PLANTING

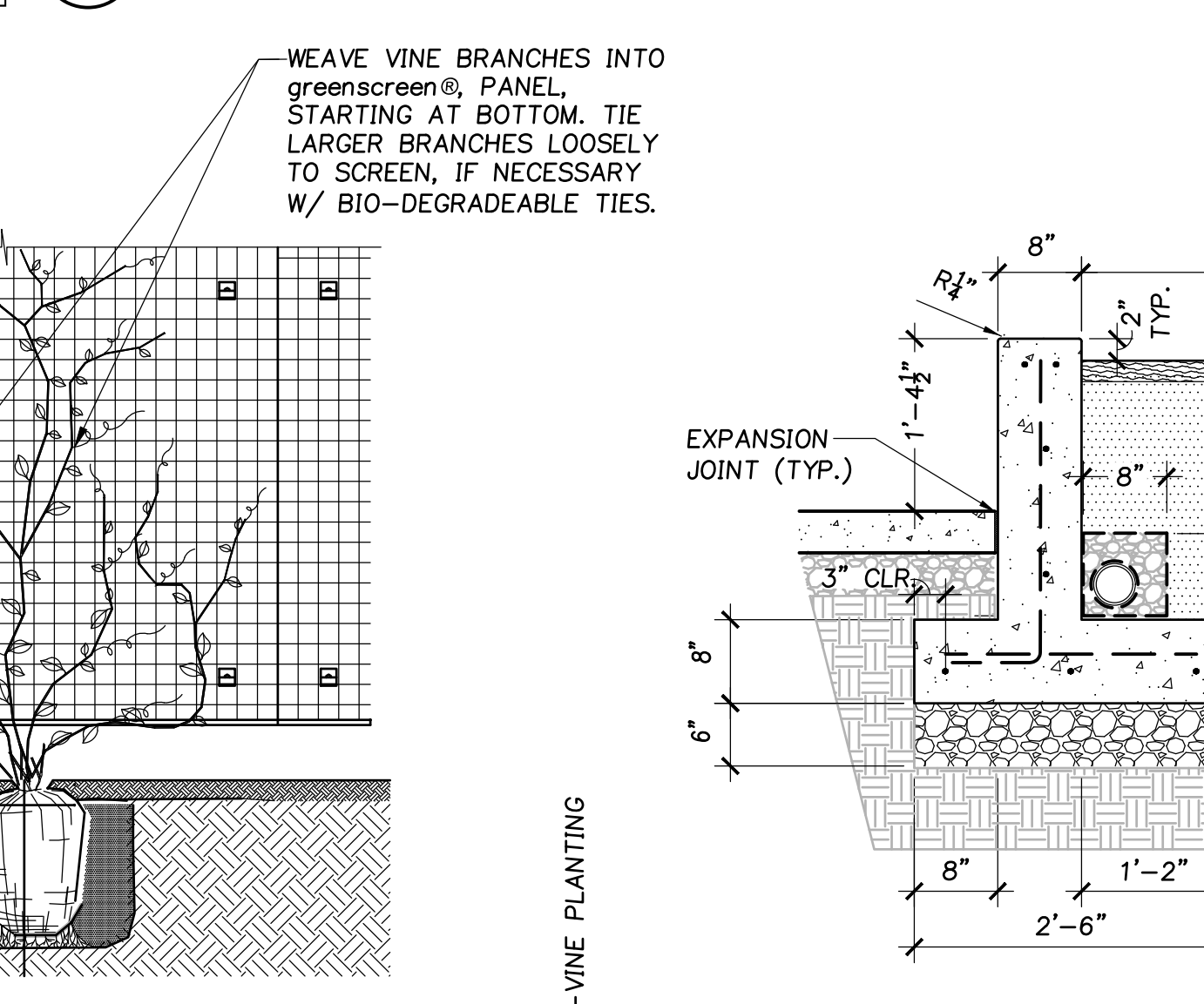

9 C.I.P. PLANTER

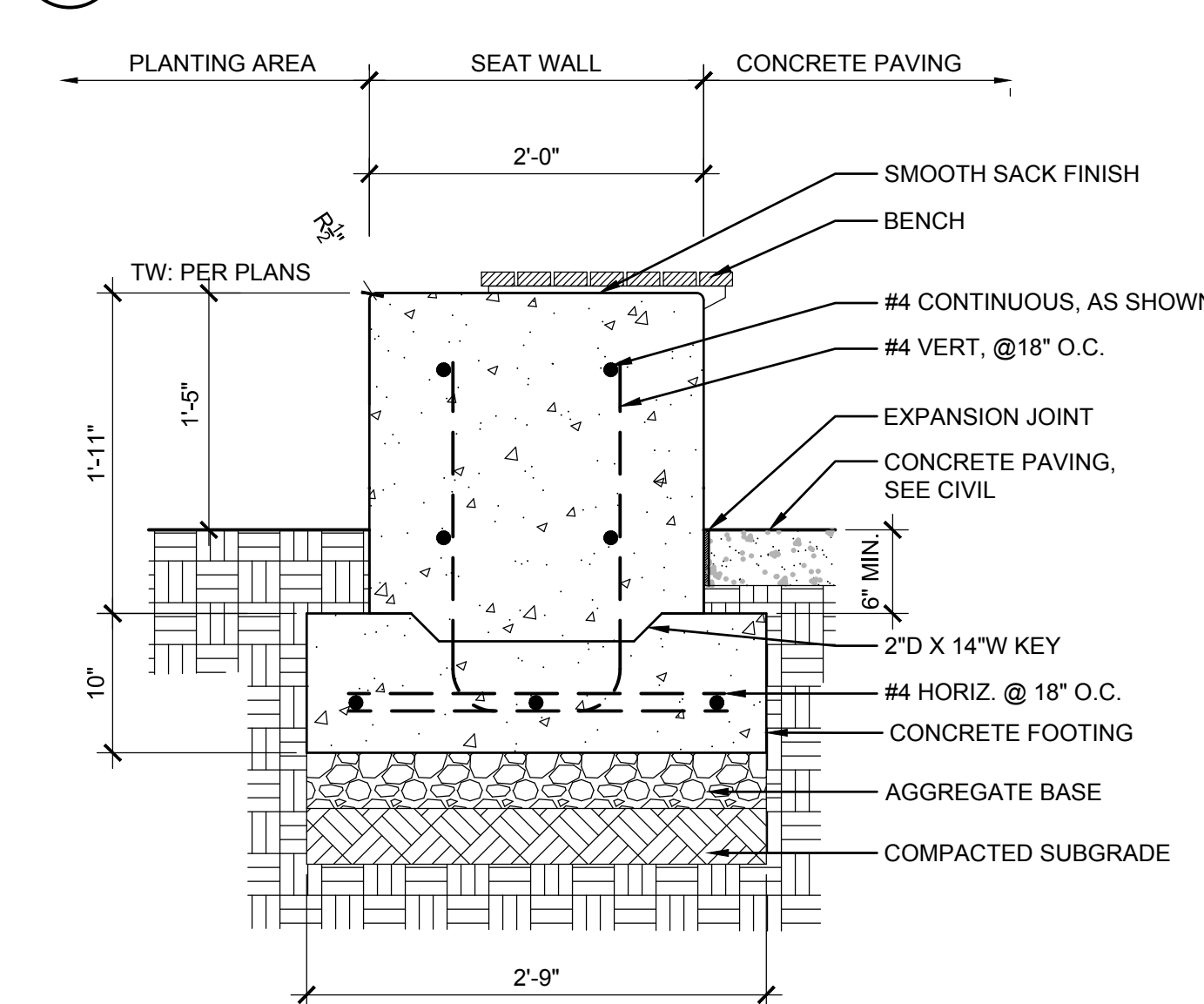

10 CONCRETE SEAT WALL

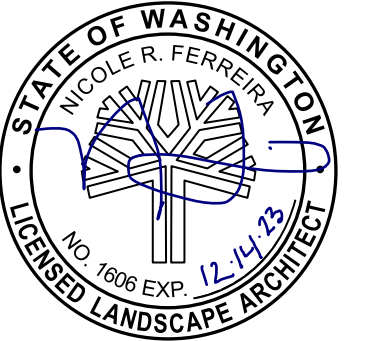

© MACKENZIE 2023
ALL RIGHTS RESERVED
THESE DRAWINGS ARE THE PROPERTY OF
MACKENZIE AND ARE NOT TO BE USED
OR REPRODUCED IN ANY MANNER,
WITHOUT PRIOR WRITTEN PERMISSION

REVISION SCHEDULE		
Delta	Issued As	Issue Date

SHEET TITLE:
**IRRIGATION
DETAILS**

DRAWN BY: LJM
CHECKED BY: NRF
SHEET:

L5.11

JOB NO. **2220290.00**

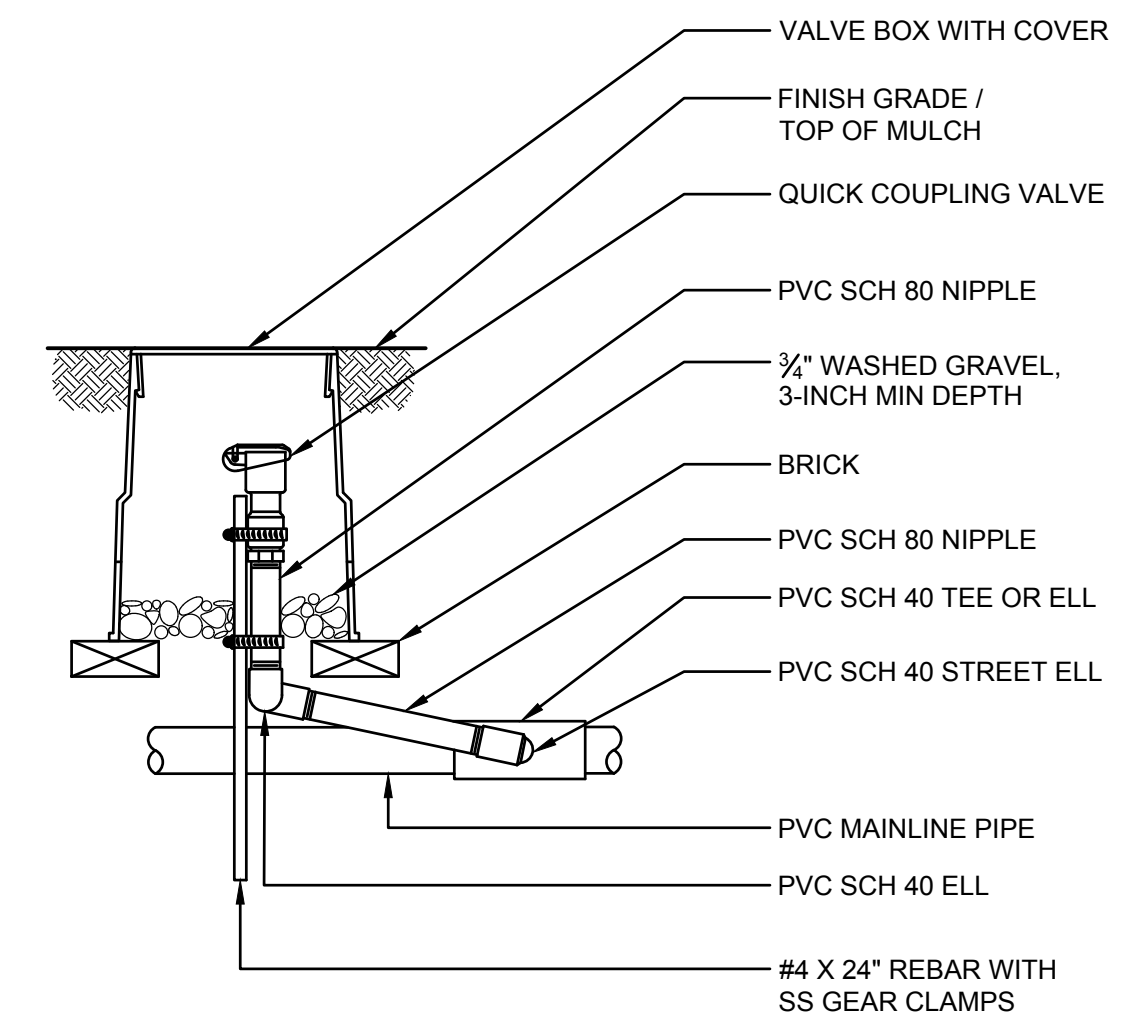

4 QUICK COUPLER VALVE
SCALE: NTS

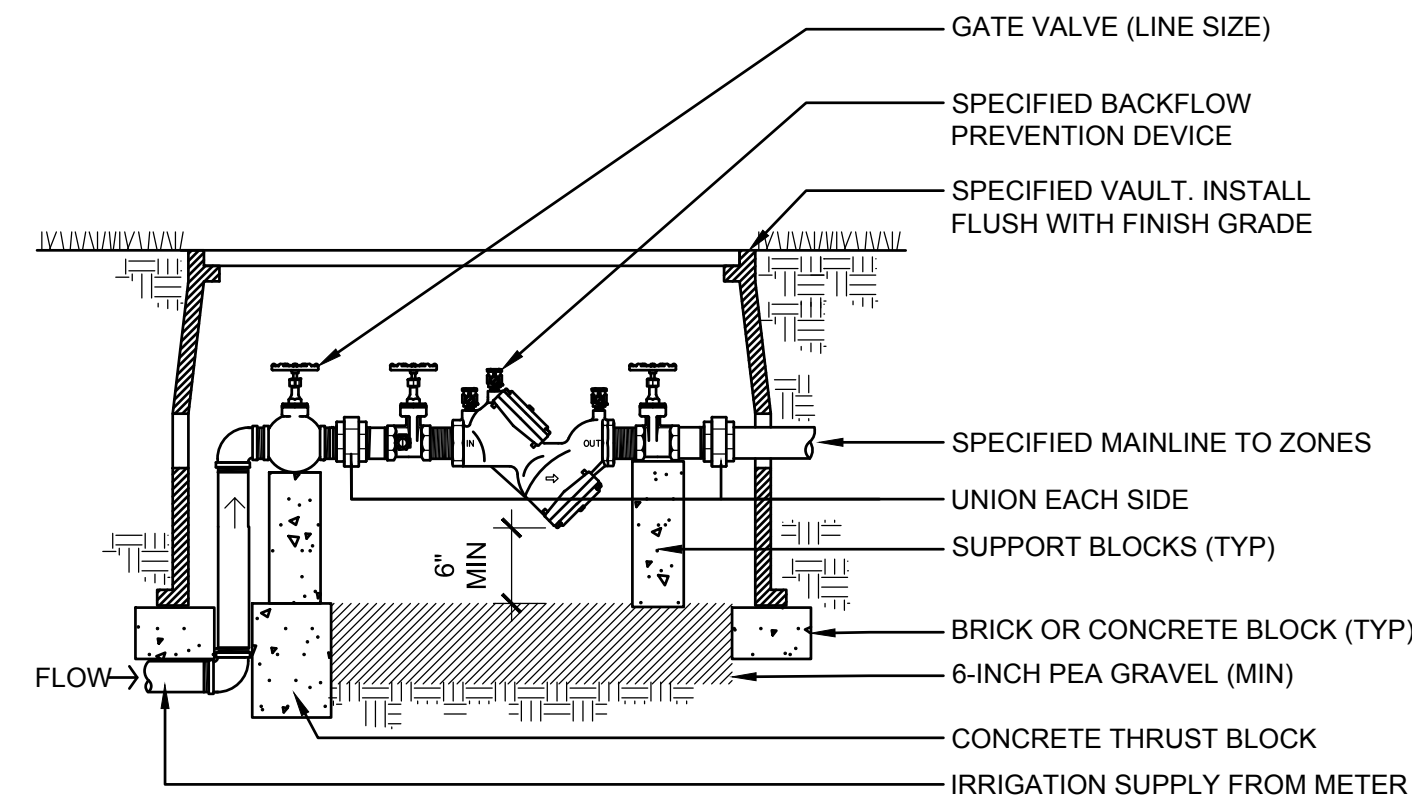

NOTE:
INSTALL BACKFLOW PREVENTOR PER CODE AND REQUIREMENTS OF PREVAILING JURISDICTIONS.

3 DOUBLE CHECK VALVE
BACKFLOW PREVENTOR (BELOW GRADE)
SCALE: NTS

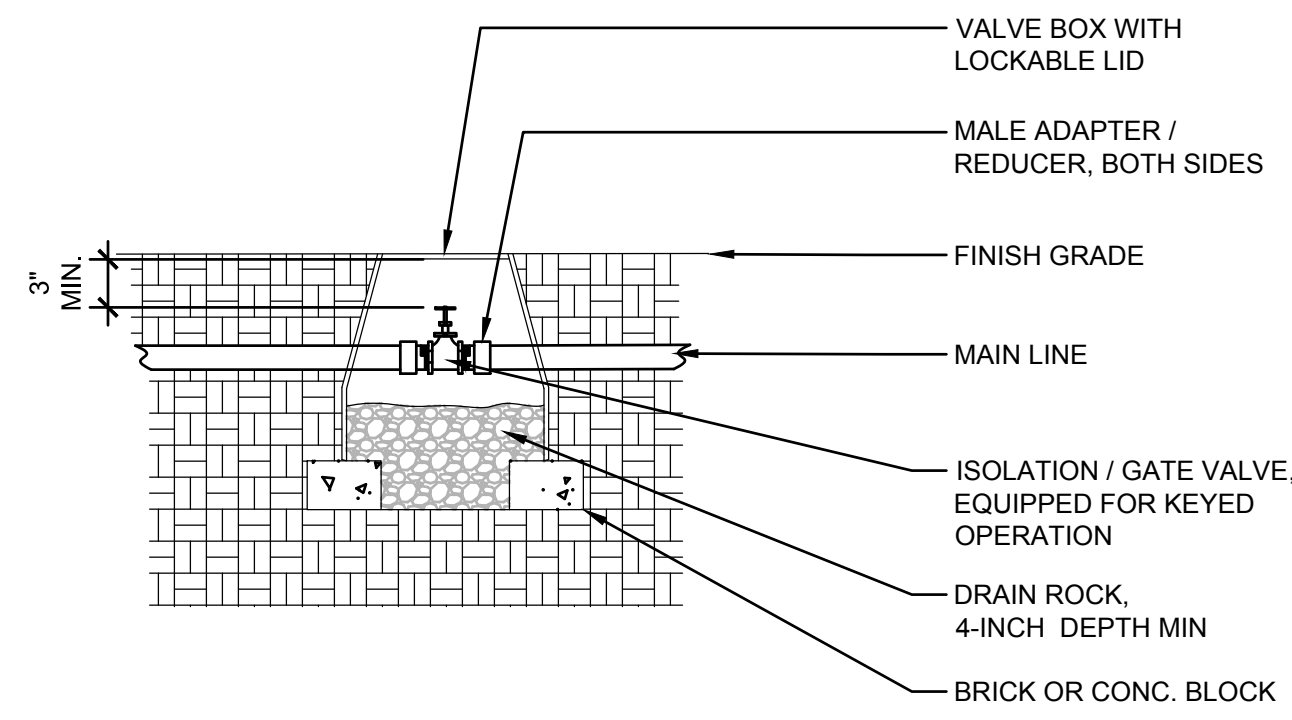

NOTES:
1. SCH 80 ADAPTER AND FITTINGS TO BE SAME SIZE AS ISOLATION VALVE

2 ISOLATION / GATE VALVE
SCALE: NTS

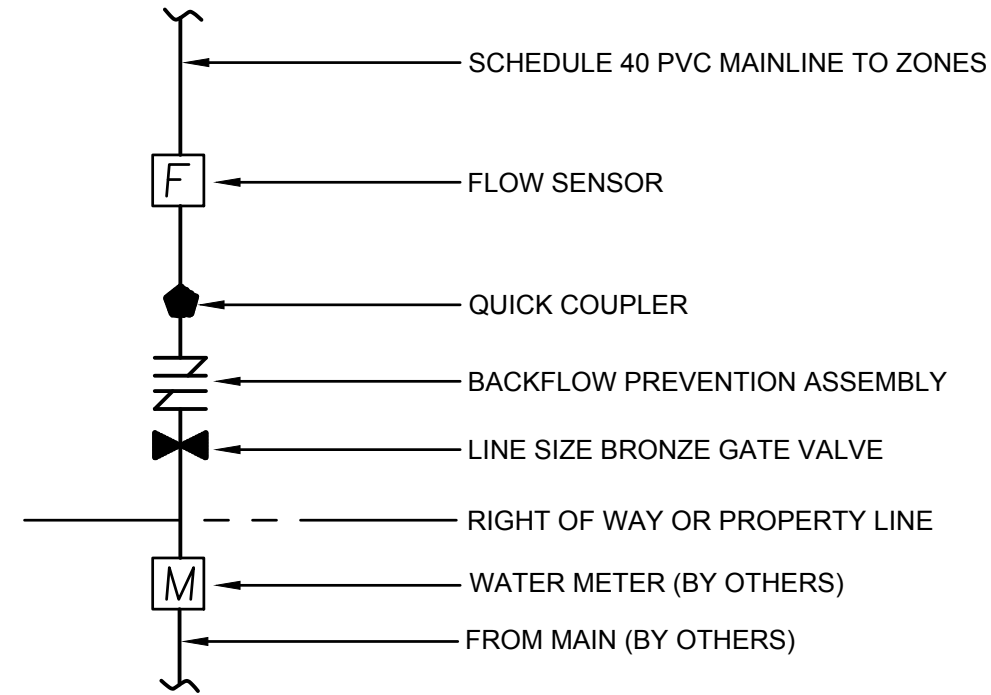

1 POINT OF CONNECTION
SCALE: NTS

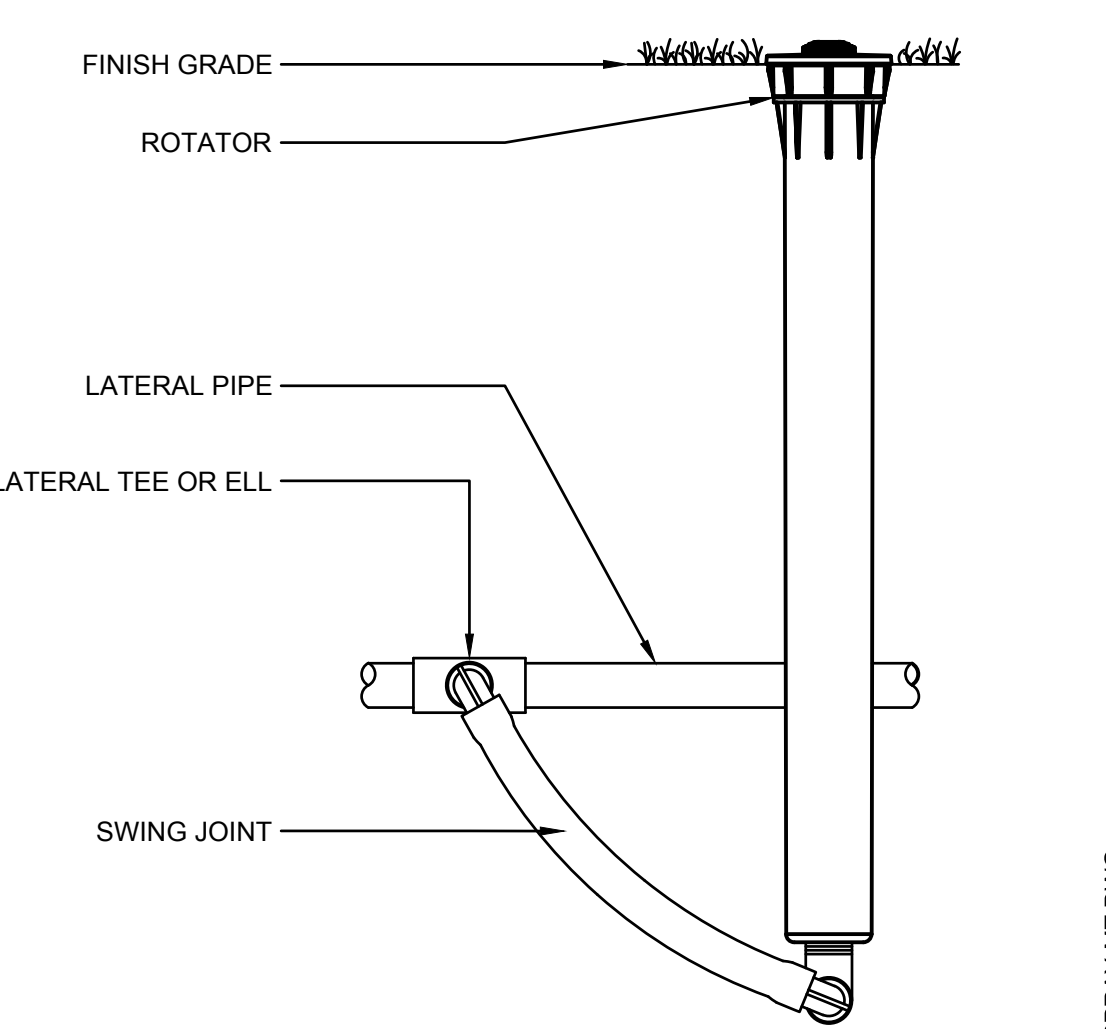

7 MULTI-TRAJECTORY SPRAY HEAD
SCALE: NTS

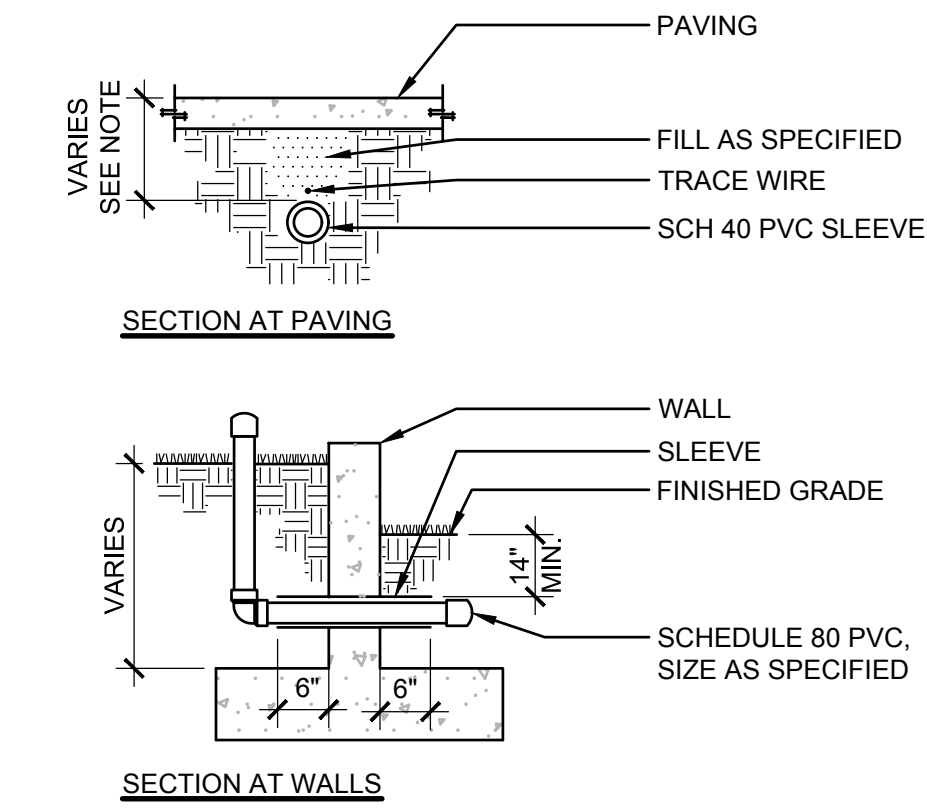

MIN DEPTH OF PIPE	
MAINLINE	18"
LATERAL AT PAVING	14"
AT DRIVING SURFACE	24"

NOTES:
1. SLEEVES TO BE TWICE DIAMETER OF LINE OR LINES PASSING THROUGH.
2. EXTEND IRRIGATION SLEEVE 6-INCHES BEYOND EDGE OF PAVING, EACH SIDE.
3. INSTALL SLEEVES AT SAME TIME AS WALL OR PAVING INSTALLATION.
4. INSTALL PIPE IN SLEEVE BEFORE BACKFILLING AND CAP BOTH ENDS WITHOUT GLUE.

6 IRRIGATION SLEEVES
SCALE: NTS

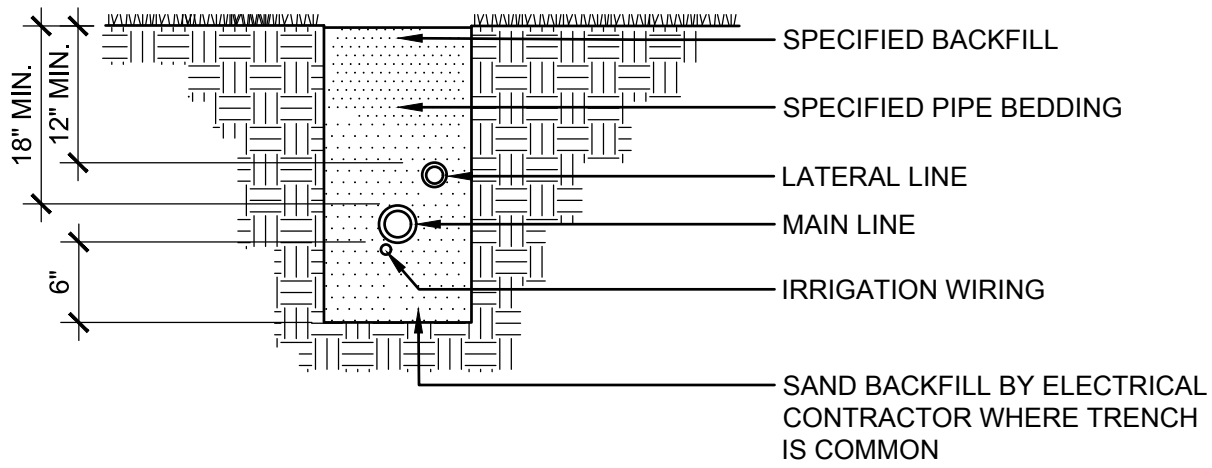

NOTES:
1. SNAKE ALL PVC PIPING IN TRENCHING
2. TIE LOOSE 3 FT LOOP IN ALL IRRIGATION WIRING AT CHANGES IN DIRECTION GREATER THAN 30 DEGREES. UNTIE AFTER ALL CONNECTIONS HAVE BEEN MADE.
3. WHERE ELECTRICAL WIRING DOES NOT SHARE COMMON TRENCH, OVER EXCAVATE TRENCH 2 INCHES MIN AND BACKFILL WITH SPECIFIED BEDDING MATERIAL.
4. LOCATE ALL WIRING NOT IN COMMON TRENCHES ACCURATELY ON RECORD DRAWINGS.

5 IRRIGATION TRENCHING (TYP)
SCALE: NTS