

CONTRACTOR SHALL VERIFY ALL NOTES, FRAMING CONDITIONS & MATERIALS PRIOR TO ORDER AND OR CONSTRUCTION

**BBO (Beams By Others) are NOT INCLUDED in material list. Hangers required for BBO'S are NOT INCLUDED in material list*

THE APPROVED CONSTRUCTION PLANS, DOCUMENTS AND ALL ENGINEERING MUST BE POSTED ON THE JOB AT ALL INSPECTIONS IN A VISIBLE AND READILY ACCESSIBLE LOCATION.

FULL SIZED LEDGIBLE COLOR PLANS ARE REQUIRED TO BE PROVIDED BY THE PERMITEE ON SITE FOR INSPECTION

City of Puyallup
Building
ACCEPTED

JMontgomery
11/10/2022
11:27:48 AM



MAIN FLOOR FRAMING

I Joist

Label	Description	Width	Depth	Qty	Plies	Pcs	Length
J15	LPI 18	2.5	11.875			6	40'-0"
J14	LPI 18	2.5	11.875			11	37'-0"
J13	LPI 18	2.5	11.875			7	33'-0"
J12	LPI 18	2.5	11.875			1	32'-0"
J11	LPI 18	2.5	11.875			7	31'-0"
J10	LPI 18	2.5	11.875			11	30'-0"
J8	LPI 18	2.5	11.875			1	18'-0"
J6	LPI 18	2.5	11.875			1	15'-0"
J2	LPI 18	2.5	11.875			1	6'-0"

Blocking

Label	Description	Width	Depth	Qty	Plies	Pcs	Length
Blk1	LPI 18	2.5	11.875	LinFt		Varies	147'-0"

Rim Board

Label	Description	Width	Depth	Qty	Plies	Pcs	Length
RM1	LP 1.35E LSL 1.25 X 11.875	1.25	11.875			9	20'-0"

LVL/LSL

Label	Description	Width	Depth	Qty	Plies	Pcs	Length
FB4	LP-LVL 2900Fb-2.0E	1.75	11.875			1	16'-0"
FB3	LP-LVL 2900Fb-2.0E	1.75	11.875			2	15'-0"
FB2	LP-LVL 2900Fb-2.0E	1.75	11.875			2	11'-0"
FB1	LP-LVL 2900Fb-2.0E	1.75	11.875			2	2'-0"
FB5	LP-LVL 2900Fb-2.0E	3.5	11.875			1	16'-0"

Hanger

Label	Pcs	Description	Skew	Slope	Beam/Girder fasteners	Supported Member fasteners
H1	4	IUS1.81/11.88 (Min)			10 10d	
H2	10	ITS2.56/11.88/Min			2 10dx1 1/2	
H3	2	IUS2.56/11.88 (Min)			10 10d	

CONTRACTOR TO VERIFY ALL CONNECTORS/CONNECTIONS BEFORE ORDERING

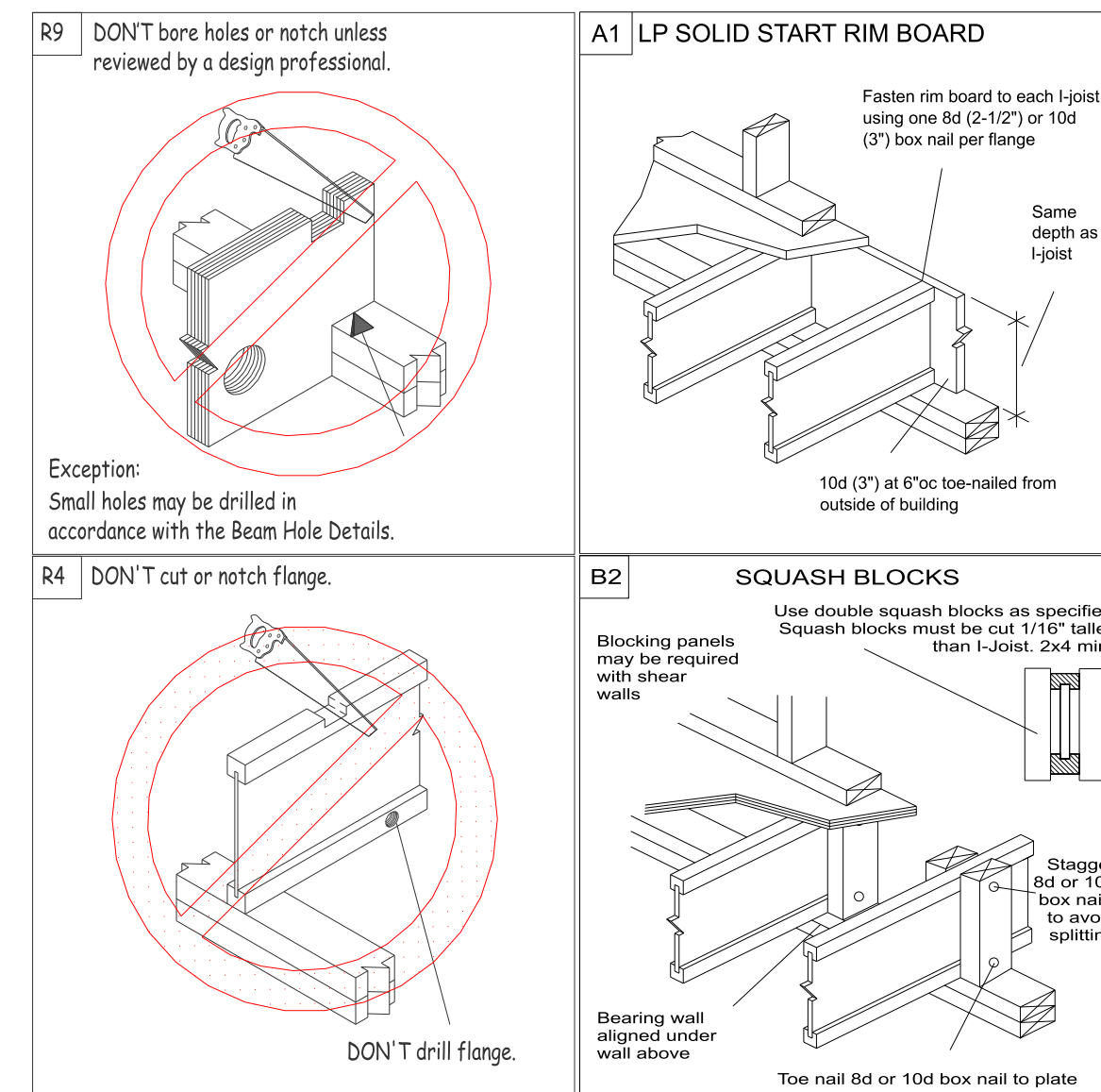

Layout Name
NIRIDERHOUSE PLAN_MICK ALLEN

Dealer
EVERGREEN LUMBER

Sales Rep
STEVE

Project
2210066-01

Designer
GW

Created
October 25, 2022

CONTRACTOR TO VERIFY PLUMBING DROPS DO NOT INTERFERE WITH FLOOR FRAMING

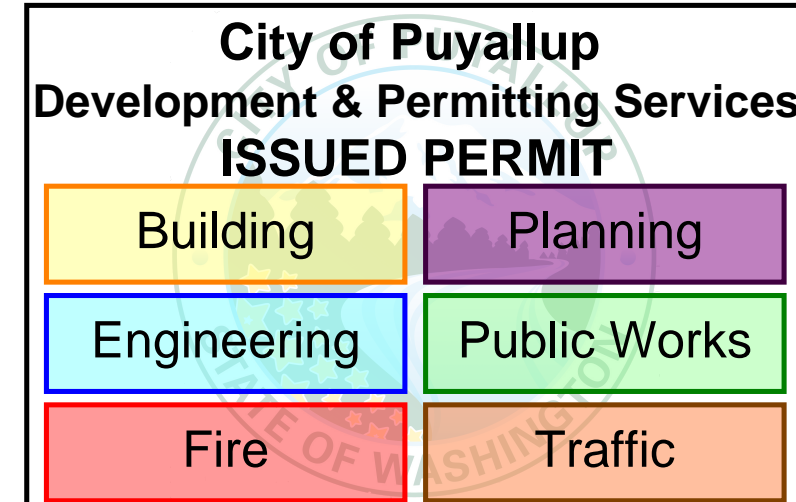
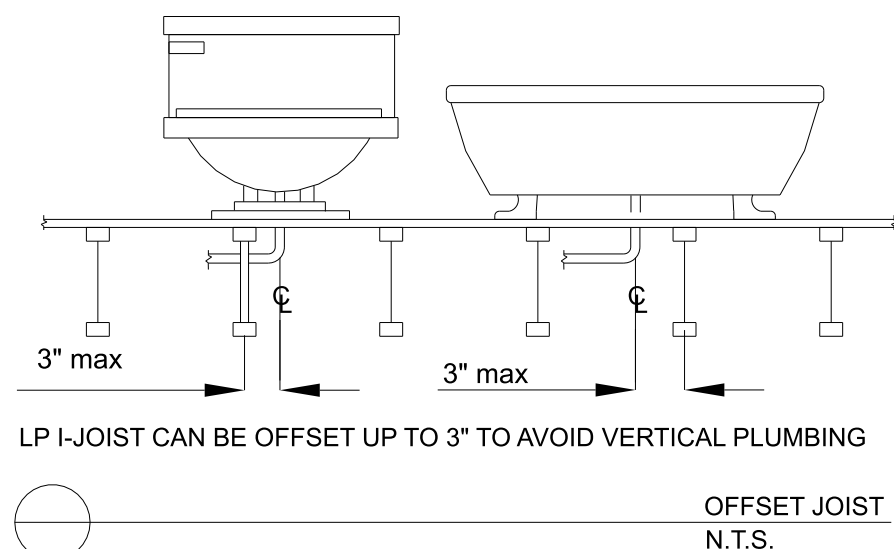

Important Notes
Review Manufacturers' installation guide for additional structural details where necessary.

Do Not cut or notch top or bottom flanges of joists to provide clearance for plumbing fixtures. Offset and/or install additional joists to provide clearance.

All dimensional stock "Dropped headers" by others
All Steel beams, angles and columns by others

CONTRACTOR SHALL VERIFY ALL NOTES,FRAMING CONDITIONS & MATERIALS PRIOR TO ORDER AND OR CONSTRUCTION

****BBO (Beams By Others) are NOT INCLUDED in material list. Hangers required for BBO'S are NOT INCLUDED in material list***

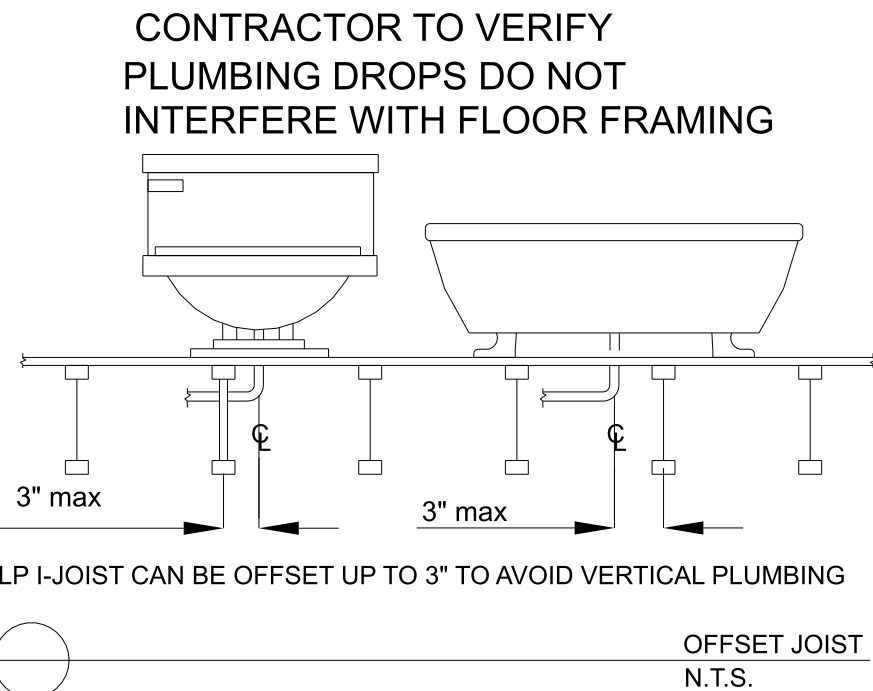

UPPER FLOOR FRAMING

I Joist

Label	Description	Width	Depth	Qty	Plies	Pcs	Length
J9	LPI 18	2.5	11.875			6	27-0-0
J7	LPI 18	2.5	11.875			11	17-0-0
J5	LPI 18	2.5	11.875			25	14-0-0
J4	LPI 18	2.5	11.875			1	13-0-0
J3	LPI 18	2.5	11.875			13	9-0-0
J1	LPI 18	2.5	11.875			1	5-0-0

Blocking

Label	Description	Width	Depth	Qty	Plies	Pcs	Length
Bk1	LPI 18	2.5	11.875	LinFt		Varies	58-0-0

Rim Board

Label	Description	Width	Depth	Qty	Plies	Pcs	Length
RM1	LP 1.35E LSL 1.25 X 11.875	1.25	11.875			7	20-0-0

LVL/LSL

Label	Description	Width	Depth	Qty	Plies	Pcs	Length
FB8	LP-LVL 2900Fb-2.0E	1.75	11.875	1	2	2	10-0-0
FB7	LP-LVL 2900Fb-2.0E	5.25	11.875			1	18-0-0
FB6	LP-LVL 2900Fb-2.0E	5.25	11.875			2	16-0-0

Glulam

Label	Description	Width	Depth	Qty	Plies	Pcs	Length
FB9	Rosboro 24F-V4	5.5	16.5			1	19-0-0

Hanger

Label	Pcs	Description	Skew	Slope	Beam/Girder fasteners	Supported Member fasteners
	1	Unknown Hanger				
H2	11	ITS2.56/11.88/Min			2 10dx1 1/2	
H3	69	IUS2.56/11.88 (Min)			10 10d	

CONTRACTOR TO VERIFY ALL CONNECTORS/CONNECTIONS BEFORE ORDERING

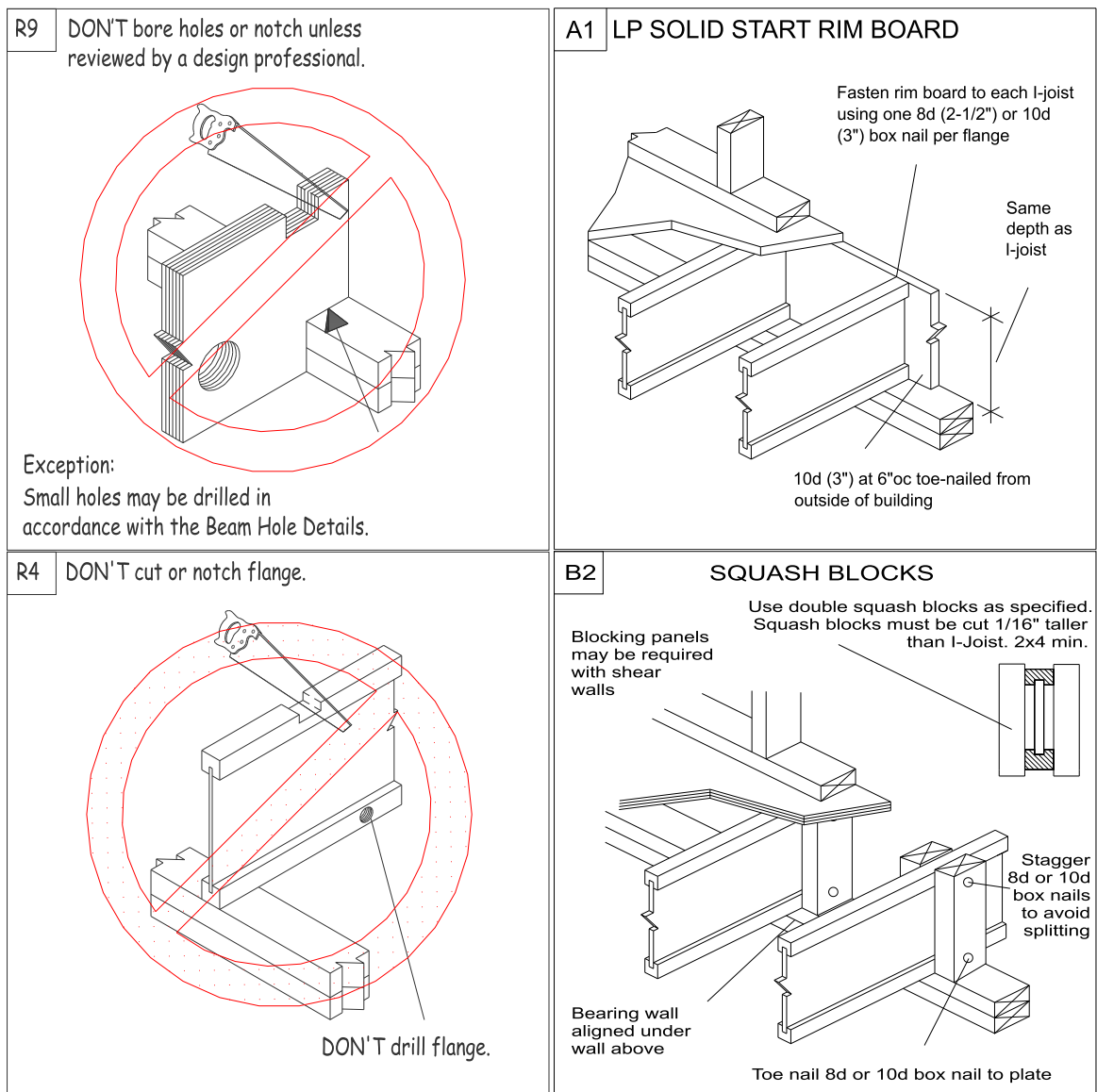

B3 BLOCKING AT INTERIOR SUPPORT

Blocking is not required if no wall above unless I-joists end at support. Blocking may be required at interior supports by project designer or by code for seismic design.

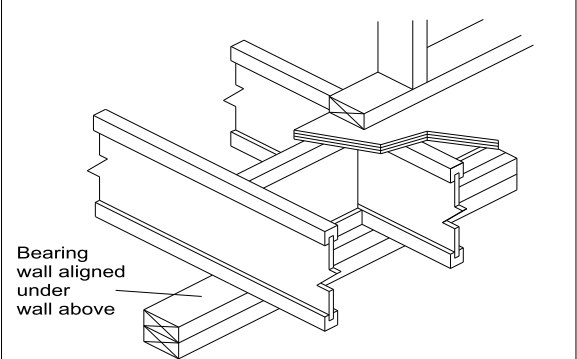

C1 CANTILEVER DETAIL

No reinforcement required. APA Rated 23/32" OSB (or equal) closure, or as required by code.

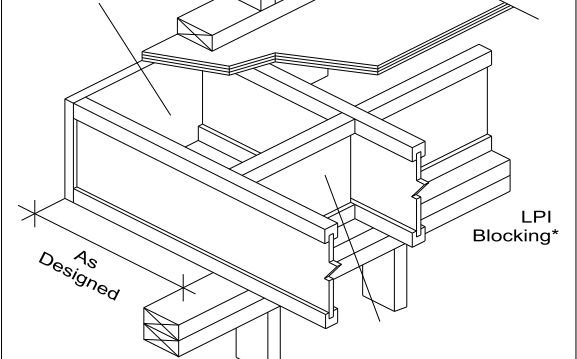

D2 POST LOADS

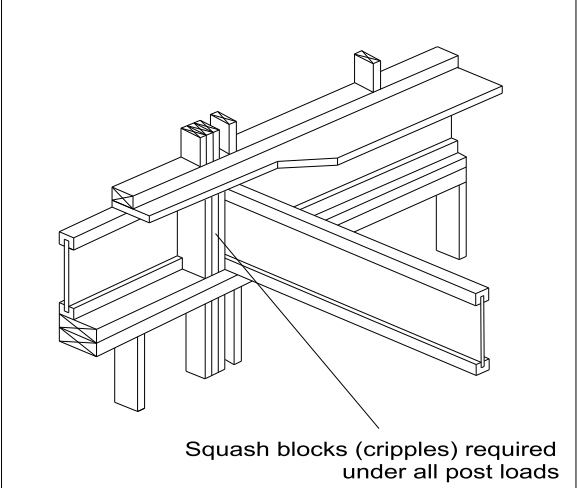

E2 HANGER DETAIL

Applied loads at end of I-joist must be supported directly by the girder or by a ledger or blocking fastened to the girder.

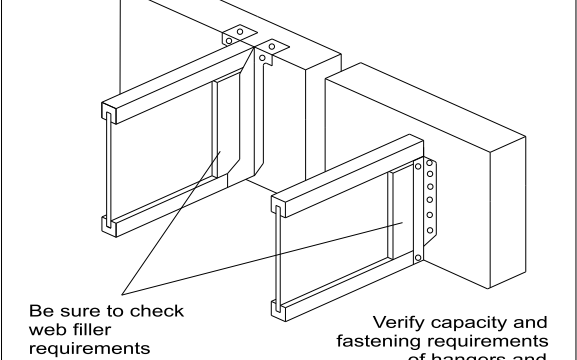

E5 DOUBLE I-JOIST CONNECTION

Floor sheathing to be glued and nailed to flanges of both joists. Filler Block Thickness Table: LPI 18, 20Plus, 23Plus = 2 1/8"; LPI 25 = 1 7/8"; LPI 26Plus, 52Plus, 56 = 2".

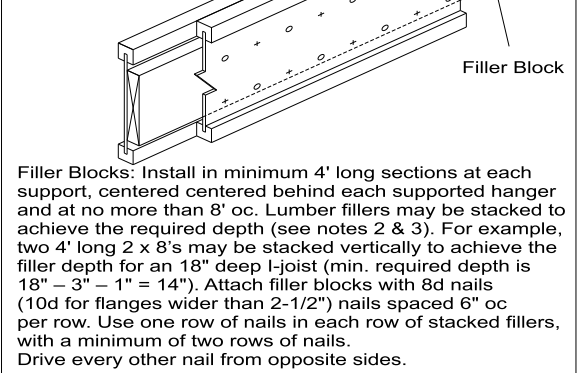

INTERNATIONAL WOOD PRODUCTS
8277 CENTER ST SW
TUMWATER, WA 98501
877.830.9663

This drawing is a general interpretation of the construction drawings for this project and assumes the adequacy of the supporting structure. It is intended only as a general guide for the engineered wood products placement. All dimensions, quantities and details must be carefully checked, verified by comparison to the actual field conditions and are the responsibility of the client, architect/engineer and builder. Engineered floor system does not account for roof loading unless noted otherwise.

Layout Name
NIRIDERHOUSE PLAN_MICK ALLEN

Dealer
EVERGREEN LUMBER

Sales Rep
STEVE

Project
2210066-01

Designer
GW

Created
October 25, 2022

Important Notes
Review Manufacturers' installation guide for additional structural details where necessary.

Do Not cut or notch top or bottom flanges of joists to provide clearance for plumbing fixtures. Offset and/or install additional joists to provide clearance.

All dimensional stock "Dropped headers" by others

All Steel beams, angles and columns by others

