

B-21-0741
CITY OF PUYALLUP

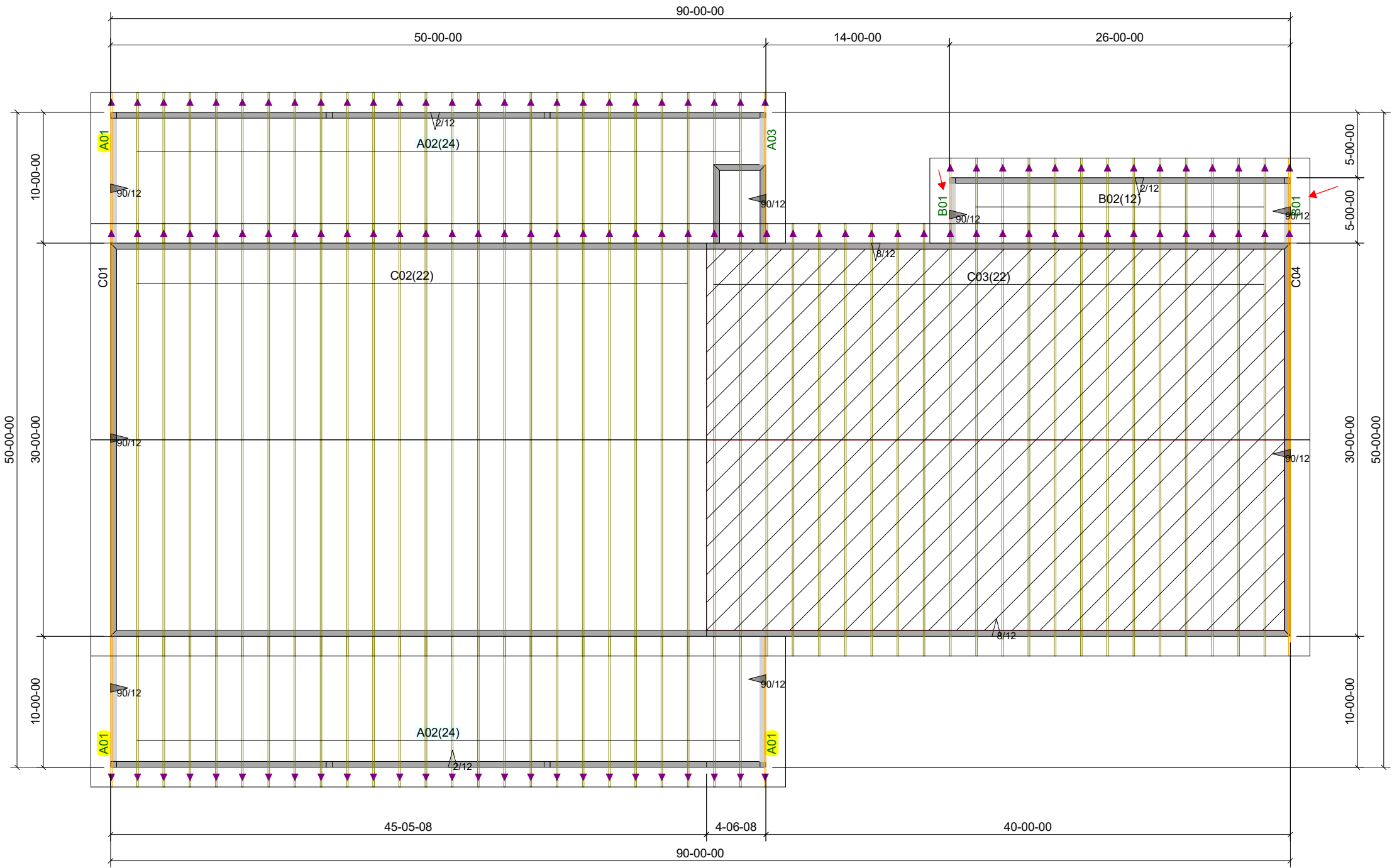

ROOF PITCH =
LOWER = 2/12
UPPER = 8/12
CEILING PITCH = 4/12
OVERHANG = 1'-6"
2x4 TOP CHORD
HEEL HEIGHT = STANDARD

153 2x4 VENT BLOCKS

THE APPROVED CONSTRUCTION PLANS,
DOCUMENTS AND ALL ENGINEERING MUST
BE POSTED ON THE JOB AT ALL
INSPECTIONS IN A VISIBLE AND READILY
ACCESSIBLE LOCATION.

FULL SIZED LEDGIBLE COLOR PLANS ARE
REQUIRED TO BE PROVIDED BY THE
PERMITEE ON SITE FOR INSPECTION

Approval of submitted plans is not an approval of
omissions or oversight by this office or
noncompliance with any applicable regulations of
local government. The contractor is responsible for
making sure that the building complies with all
applicable building codes and regulations of the
local government.

** IMPORTANT **

◀ = INDICATES LEFT END



Sales Rep:
Tony Campain
Estimate By:
Roxann Watson
Finalized By:
Roxann Watson
Date:
4/20/2020

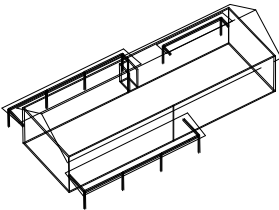

Lot:

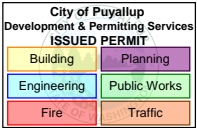

Address: 24XX West St Puyallup, WA 98371

Customer:
10-Phone Quote - PPTC100
Job Name:
Farris Residence
Job Number:
J1060421
Plan:

Drawing Type:
Roof Trusses
Loading
TC/LL = 25.0 lb
TC/DL= 8.0 lb
BC/DL= 7.0 lb
WIND = 110 mph 'B'

Sheet Number:

1 of 1