

15TH AVE SE @ 2ND ST SE HH 222

SPEED
LIMIT
25

City of Puyallup Development & Permitting Services ISSUED PERMIT	
Building	Planning
Engineering	Public Works
Fire	Traffic

Comments:
ACCESS HH 222
SOUTH SIDE OF 15TH AVE SE, EAST
OF 2ND ST SE.
LANE SHIFT.
SIDEWALK IS ACCESSIBLE.
SPOTTER WILL ASSIST PEDESTRIANS.

Closure Allowed
 Monday - Thursday
 10 AM - 2 PM
 Call Communications Center
 At (253) 287-4456
 On Day Of Closure



TRAFFIC CONTROL PLAN
JOB # P.148581 C.45
PERMIT #

PRFUP20231223

Work must yield to all emergency vehicles

Puyallup Construction Restriction Zones and routes shall be in effect during the Washington State Fair. September 1-24, 2023

The applicant shall notify property owner(s) of blocked driveway(s) at least 24 hours in advance.

When shifting traffic into a turn lane the use of double cones is required. Device spacing 1/2 distance for opposing traffic

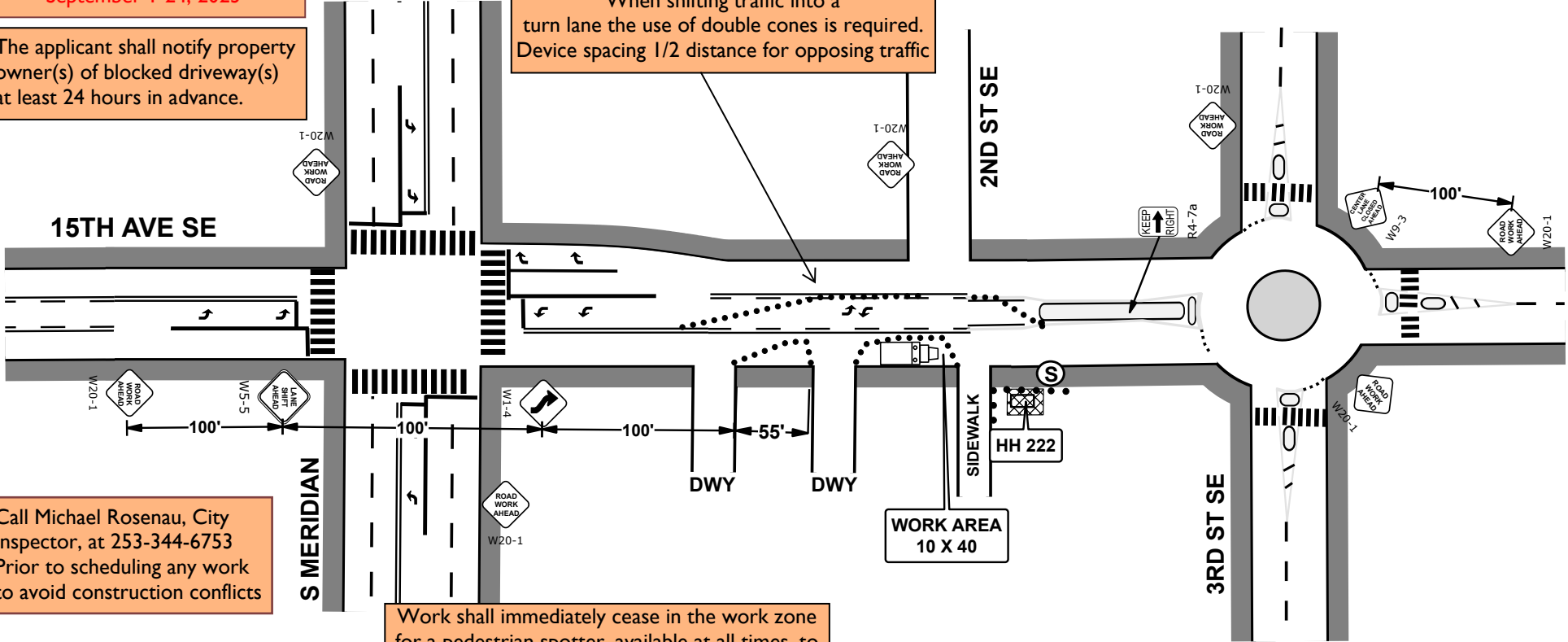

Call Michael Rosenau, City Inspector, at 253-344-6753 Prior to scheduling any work to avoid construction conflicts

Work shall immediately cease in the work zone for a pedestrian spotter, available at all times, to escort pedestrians around the work area

- General Requirements**
1. Traffic control devices shall be 28" retroreflective cones.
 2. Taper length equals width of offset times speed limit squared divided by 60.

$$L = \frac{WS^2}{60}$$
 3. Sign spacing shall be 100 feet when speed limit is 30 mph or less.
 4. Sign spacing shall be 350 feet when speed limit is greater than 30 mph.
 5. Distance between cones equals speed limit in units of feet.
 6. Travel lane width must be 11' minimum.

The permit holder shall notify MultiCare Good Samaritan Hospital by contacting Aaron Piche, Manager of Engineering Services, at aaron.piche@multicare.org and Heidi Rock at heidi.rock@multicare.org with the proposed impacts and closure hours at least 48 hours in advance of job start. No emergency service vehicle travel routes shall be blocked or rerouted. In a safe manner, flaggers shall prioritize travel for emergency service vehicles.

Legend

●	Cone
Ⓢ	Spotter
🚚	truck
⊠	Work Area

NOT TO SCALE

Project # P.148581 C.45
 Designed for LUMEN
 by: Sharon Martos
 Approved 8/21/2023
 Traffic Control Supervisor
 TCS # 010745
 Expires: 5/30/2021
 Phone 253-737-5198
 sharon.martos@gmail.com

Sharon Martos