

BRADLEY HEIGHTS

LOCATED IN THE SW 1/4 OF SECTION 03, TOWNSHIP 19 NORTH,
RANGE 4 EAST OF THE WILLAMETTE MERIDIAN, CITY OF PUYALLUP,
PIERCE COUNTY, WASHINGTON

PRUSR20231267

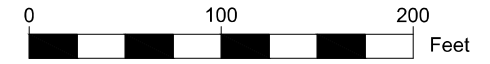
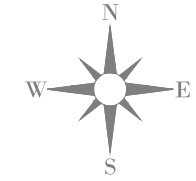

**City of Puyallup
Development
Engineering
APPROVED**

See permit conditions.

ycharitou
08/31/2023
7:15:18 AM

Call before you dig. It's the law.
Dial 811 or call 1-800-424-5555.

Prior to starting site work, request an erosion and sediment inspection through the CityView portal.

Refer to the City standard details 02.03.02 & 05.02.01 for typical erosion and sedimentation control methods.

LEGEND
Right of Way

NOTES

POWER AND PHONE FOR INTERIOR UNITS SERVED BY POLES (UNLOCATED).

ONSITE WATER SERVICES NOT LOCATED.

ALL OF THE UNITS ALONG THE PUBLIC ROAD ARE SERVED BY UNDERGROUND UTILITIES WHICH ARE NOT LOCATED. WITH THE EXCEPTION OF SEWER STUB LOCATIONS FOR 5, 6, 7, 8, AND 30 AS SHOWN.

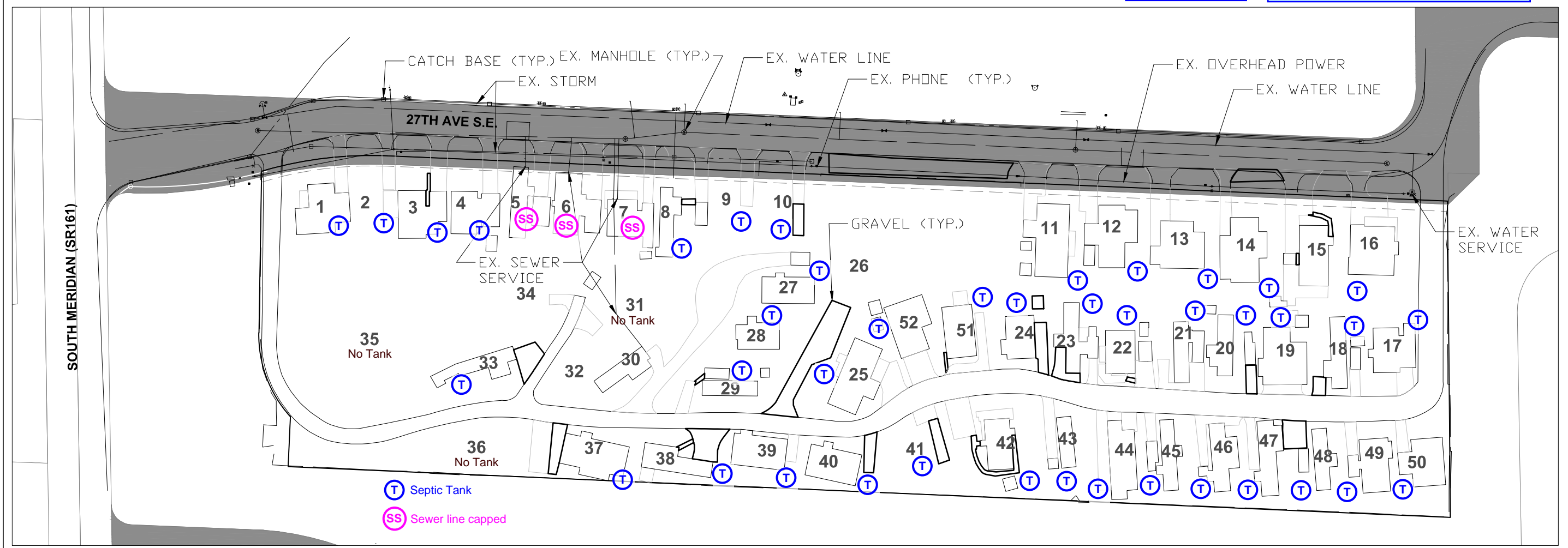

(T) Septic Tank
(SS) Sewer line capped

Septic Notes:
#05, 06, 07 tied to the sewer
#30 shared sewer with #07
Total of 42 septic tanks

**City of Puyallup
Development & Permitting Services
ISSUED PERMIT**

Building	Planning
Engineering	Public Works
Fire	Traffic

The applicant shall coordinate water service removal with Fruitland Mutual Water Company.

The applicant is responsible to demolish the existing septic systems that serve units 1-4, 9-11, 13-20, 22, 24-29, 31-32, 34-37, 39-41, 46, 49-50 per Tacoma Pierce County Health Department standards. The City Inspector shall verify that there are no septic tanks for units 31 and 35 as labeled on the site plan. Septic decommissioning certificates are required to be filed with Pierce County and copies submitted to the City of Puyallup.

The septic decommissioning for units 21, 44, 45, & 47 is permitted under PRDE20230753.
The septic decommissioning for units 8, 12, 23, 33, 38, 42, 43, & 48 is permitted under PRDE20231242.

The applicant shall expose, cut, and cap the inactive sanitary sewer stubs for units 1, 2, 3, and 4 under the supervision of a City Inspector prior to demolition or removal of the mobile home. Furthermore, the applicant shall cut and cap the sanitary sewer lateral for units 5, 6, and 7 under the supervision of a City Inspector prior to any demolition or removal of the mobile home. The sanitary sewer line for unit 30, permitted under PRDE20231242, must be cut and capped before disconnecting units 5, 6, or 7.

The existing sewer lateral shall not be reused. The applicant shall request an inspection through the CityView portal. Utility inspections are required prior to backfilling.

NO.	REVISION	DATE
1		
2		
3		
4		
5		
6		
7		
8		
9		
10		

JOB NO. 2379
DATE: 08/31/2023
DRAWN BY: Trevor Green
CHECKED BY: Jim Job
APPROVED BY: Paul Green

AZURE GREEN
CONSULTANTS

feasibility • planning • engineering • surveying

409 East Pioneer, Suite A - Puyallup, WA 98372 phone: 253.770.3144 fax: 253.770.3142

DEMOLITION PLAN
BRADLEY HEIGHTS

Azure Green Consultants
409 East Pioneer, Puyallup, WA 98372
Phone (253) 770-3144

DRAWING
D1
SHEET 1
OF 1

Project Desc: ### C:\Users\Trevor.AZUREGREEN\Documents (402)\402 - Bradley Heights\SITE 9-8-2022.dwg Plot Date/Time: 9/8/2022 11:58 AM