

SITE PLAN: P01 - P09  
SCALE: 1:100

All poles will be placed to allow a minimum 4' (foot) clearance as required by the ADA

Where a curb exists, the lateral offset for all vertical obstructions shall be a minimum of 1.5' from the face of the obstruction pole to the face of curb

PRFUP20231289

Puyallup Construction Restriction Zones and routes shall be in effect during the Washington State Fair. September 1-24, 2023

The applicant is responsible to notify the city of a job start 48 hours in advance using the CityView portal. The permit and traffic control plans shall be posted at the job site and available to inspectors at all times. Applicant must provide 48hr. notification to residents within 300 feet of the work area either via door hanger, message board or signs posted visibly along the right-of-way.

SITE SPECIFIC NOTES

- P01 (566930-155692)**  
- REMOVED FROM SCOPE OF WORK, COMPLETED ON WO# 186056331
- P02 (566930-155718)** See TCP Sheet 1 of 6  
- REPLACE EXIST 80' CL1 POLE W/ NEW 85' CLH2 POLE PER TRANSMISSION WO # 111025228  
- INST 3Ø SGL ARM UNDERBUILD (6034.1010.TANU313)  
- TRANSFER EXIST 15kVA 120/240v XF W/ LB C/O FUSED AT 6T (3412100)  
- INST NEW 2" RISER (6042.1000.RIS2CSS) APPROX 40' ( ) UP POLE  
- REPU LUG 4/0 TPX APPROX 80' ( ) TO EXIST HANDHOLE  
- TRANSFER EXIST OH TPX  
- TOP POLE TO COMMS
- P03 (566930-155751)** See TCP Sheet 2 of 6  
- REPLACE EXIST 70' CL1 POLE W/ NEW 80' CLH3 POLE PER TRANSMISSION WO# 111025228  
- INST 3Ø SGL ARM UNDERBUILD (6034.1010.TANU313)  
- INST 3Ø TERM OH-UG (6043.1000.TSU3L1F) W/LI C/O FUSED AT 65T (3412600)  
- INST NEW 4" RISER (6042.1000.RIS4CSS) APPROX 40' ( ) UP POLE  
- SPLICE AT BASE OF POLE NEW 3Ø 1/0 UG PRI APPROX 45' ( ) THROUGH NEW RISER  
- INST EXIST SW# P1887  
- TRANSFER EXIST OH TPX  
- TRANSFER EXIST OH SPAN GUY  
- TOP POLE TO COMMS
- P04 (566930-155779)** See TCP Sheet 3 of 6  
- REPLACE EXIST 70' CL1 POLE W/ NEW 75' CLH2 POLE PER TRANSMISSION WO # 111025228  
- INST 3Ø SGL ARM UNDERBUILD (6034.1010.TANU315)  
- TRANSFER EXIST 25kVA 120/240v XF W/ LB C/O FUSED AT 10T (3412200)  
- INST NEW 2" RISER (6042.1000.RIS2CSS) APPROX 40' ( ) UP POLE  
- SPLICE AT BASE OF POLE NEW 4/0 UG TPX APPROX 45' ( ) THROUGH NEW RISER  
- TRANSFER EXIST AMR UNIT  
- TOP POLE TO COMMS
- P05 (566928-155810)** ← Not included in scope of work  
- INCORRECT GRID# IN FIELD  
- CORRECT GRID# (366929-155818)
- P05A (566934-155809)** See TCP Sheet 4 of 6  
- REPLACE EXIST ANCHOR W/ NEW LARGE PLATE ANCHOR (6012.1000.ANDP24)  
- INST NEW 7/16" SIDEWALK GUY (6013.0180.GYD7PB)
- P06 (566920-155844)** See TCP Sheet 5 of 6  
- REPLACE EXIST 75' CLH1 POLE W/ NEW 80' CLH3 POLE PER TRANSMISSION WO # 111025228  
- INST 3Ø SGL ARM UNDERBUILD (6034.1010.TANU315)  
- TOP POLE TO COMMS
- P07A (566931-155869)**  
- REMOVED FROM SCOPE OF WORK, COMPLETED ON WO# 111022191
- P08 (566925-155912)**  
- REMOVED FROM SCOPE OF WORK, COMPLETED ON WO# 111022191
- P09 (566948-155994)** See TCP Sheet 2 of 6  
- REPLACE EXIST 70' CL1 POLE W/ NEW 80' CLH3 POLE PER TRANSMISSION WO # 111025228  
- INST 3Ø SGL ARM UNDERBUILD (6034.1010.TANU315)  
- INST 3Ø TERM OH-UG (6043.1000.TSU3L1F) W/LI C/O FUSED AT 10T (3412700)  
- INST NEW 4" RISER (6042.1000.RIS4CSS) APPROX 40' ( ) UP POLE  
- SPLICE AT BASE OF POLE NEW 3Ø 1/0 UG PRI APPROX 45' ( ) THROUGH NEW RISER  
- INST NEW SW# T82683  
- TRANSFER EXIST OH TPX  
- TOP POLE TO COMMS

THIS PAGE PERTAINS TO DISTRIBUTION UNDERBUILD  
SEE ADDITIONAL PRINT FOR TRANSMISSION NOTES

**EROSION & SEDIMENT CONTROL REQUIREMENTS**  
EROSION & SEDIMENT CONTROL SHALL BE PER PSE STANDARD PRACTICE 0150.3200 TECHNIQUES FOR TEMPORARY EROSION & SEDIMENT CONTROL & ANY ADDITIONAL LOCAL JURISDICTION REQUIREMENTS. (LOCAL JURISDICTIONS MAY HAVE ADDITIONAL REQUIREMENTS INCLUDING NOTES DETAILING WHERE EROSION OR SEDIMENT CONTROL STRUCTURES ARE TO BE INSTALLED, CROSS SECTION DETAILS OF THE TYPICAL EROSION STRUCTURES, & SPECIAL REQUIREMENTS FOR WORK IN SENSITIVE AREAS.)

POWER GENERAL NOTES

- All materials to be installed in accordance with Puget Sound Energy's (PSE) standards. Any deviation from this work sketch must be AUTHORIZED by Potelec's Project Manager and NOTED on the Foreman's Copy.
- All switching arrangements and/or outage arrangements are to be made with the Project Manager at least three (3) working days in advance.
- Contact the Utilities Underground Location Center (1-800-424-5555) at least 48 hours prior to commencing work to get the underground facilities located.
- All work is to be done in accordance with local municipal and county permit requirements as applicable.
- Inclement weather conditions may cause delays in construction times and dates.

City of Puyallup  
Development & Permitting Services  
ISSUED PERMIT

Building	Planning
Engineering	Public Works
Fire	Traffic

MAPS & RECORDS NOTE:  
P09 (566948-155994) WITH INCORRECT SWITCH NUMBER ON UNIVERSAL MAPS. INSTALL SW# P2358

P07 (566926-155870) WITH INCORRECT SWITCH NUMBER ON UNIVERSAL MAPS. INSTALL SW#3415

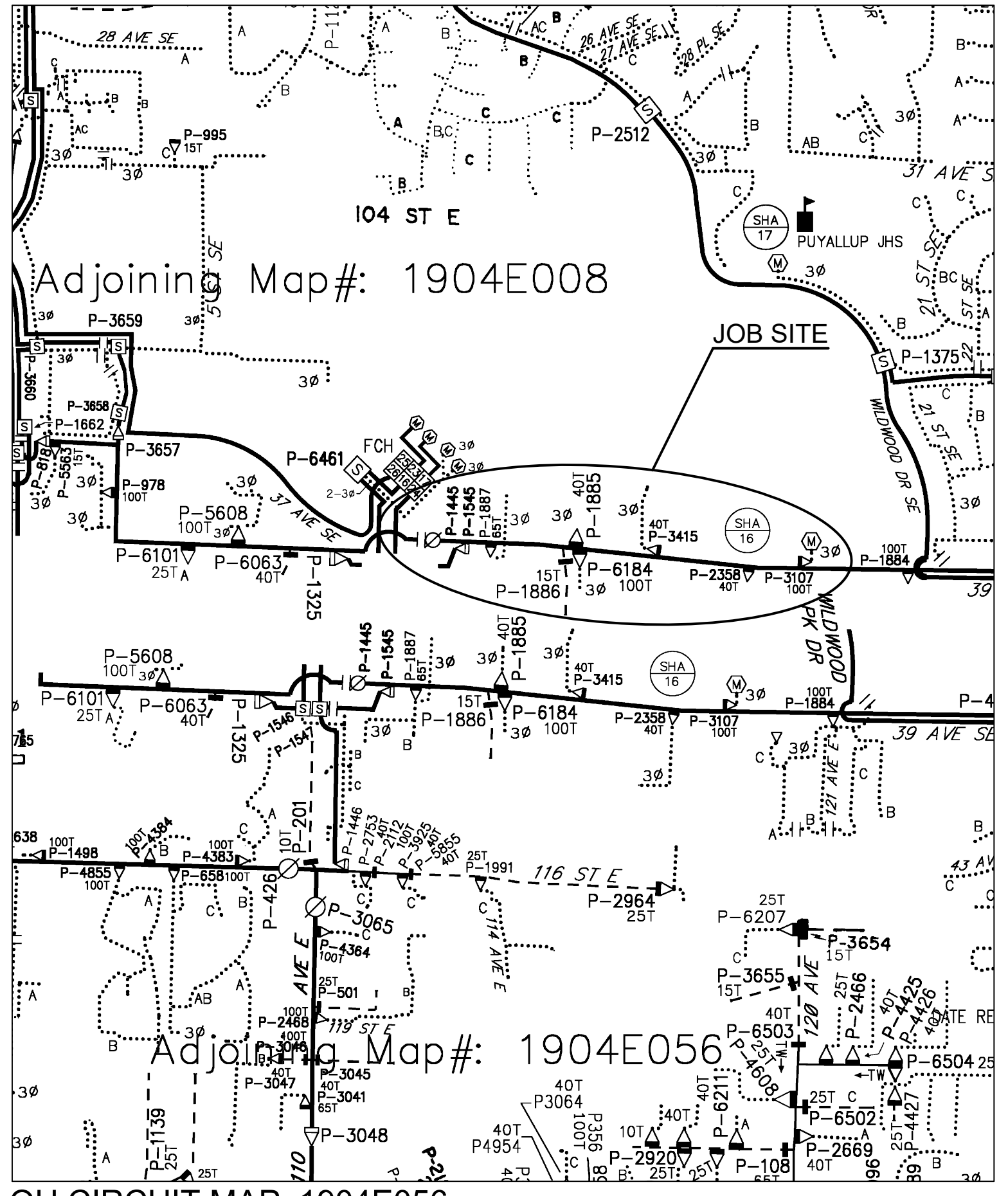

OH CIRCUIT MAP: 1904E056  
SCALE 6" = 1 MILE

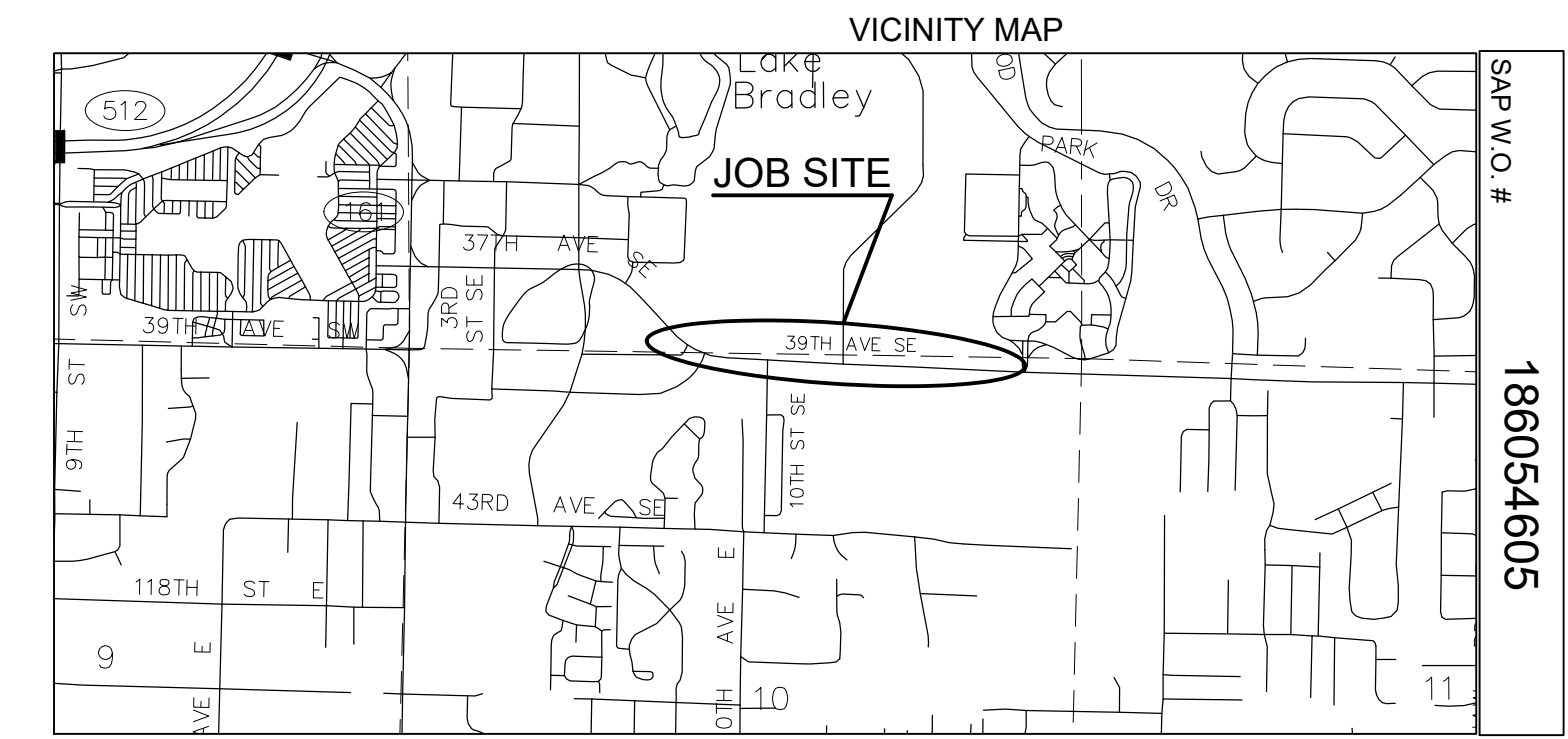

FOREMAN (CHECK BOX WHEN COMPLETED)

<input type="checkbox"/>	PSE Equipment LOCKED/SECURED & Work Area left in CLEAN/SAFE Condition.
<input type="checkbox"/>	Grid, Cable, and Switch numbers INSTALLED & VERIFIED.
<input type="checkbox"/>	Field Changes REDLINED on As-Built.
<input type="checkbox"/>	Material VERIFIED and CHANGES noted on Paperwork.
<input type="checkbox"/>	Total PRIMARY Cable noted on As-Built.
<input type="checkbox"/>	Company ID#s RECORDED in correct location on As-Built.
<input type="checkbox"/>	Indicate correct FUSE SIZE on As-Built & VERIFY proper PHASE.
<input type="checkbox"/>	Deviations noted on the As-Built and their reason.
<input type="checkbox"/>	I certify that the work performed meets PSE's standards and procedures and that all quality requirements are met.

Foreman's Signature \_\_\_\_\_ Date \_\_\_\_\_  
Print Name \_\_\_\_\_

PROJECT PHASE	NOTIF#	ORDER#
PWR Superior	507585853	186054605
Sub Order		111025228
		108114069
		186055139

CALL (800) 424-5555  
2 BUSINESS DAYS BEFORE YOU DIG

REAL ESTATE/EASEMENT PERMIT

3				
2				
1				

REV#	DATE	BY	DESCRIPTION	FUNCTION	CONTACT	PHONE NO	DATE
				PROJECT MGR	J. REYNA	253-259-7076	08/13/21
				ENGR - POWER	J. REYNA	253-259-7076	08/13/21
				ENGR - GAS	N/A	N/A	N/A

COUNTY	Emer Sect	Gas Wk Ctr	POWER WK CTR	DRAWN BY	B. JOHNSON	253-553-6882	08/13/21
PIERCE	N/A	N/A	QWSPRE	CHECKED BY			
1/4 SEC	OP MAP		PLAT MAP	APPROVED BY			
T19N, R04E, 03S	N/A		N/A	FOREMAN #1			
U-MAP NO (POWER)	OH CKT MAP	UG CKT MAP	CIRCUIT NO	FOREMAN #2			
1904E042.037	1904E056	1904E042.037	SHA-16	MAPPING			

UTILITIES	N/A	N/A	N/A	N/A
CONTACT	N/A	N/A	N/A	N/A
PHONE#	N/A	N/A	N/A	N/A

INCIDENT	MAOP
N/A	N/A
Gas Order	Elect Order
N/A	186054605
SCALE	PAGE
AS NOTED	1/2

DESIGNED BY POTELEC

PSE PUGET SOUND ENERGY

ENGR1 CLINK TK # 3870094  
REPLACE (6) POLES, UPGRADE GUYS & ANCHORS  
1106 39TH AVE SE., PUYALLUP, WA 98374

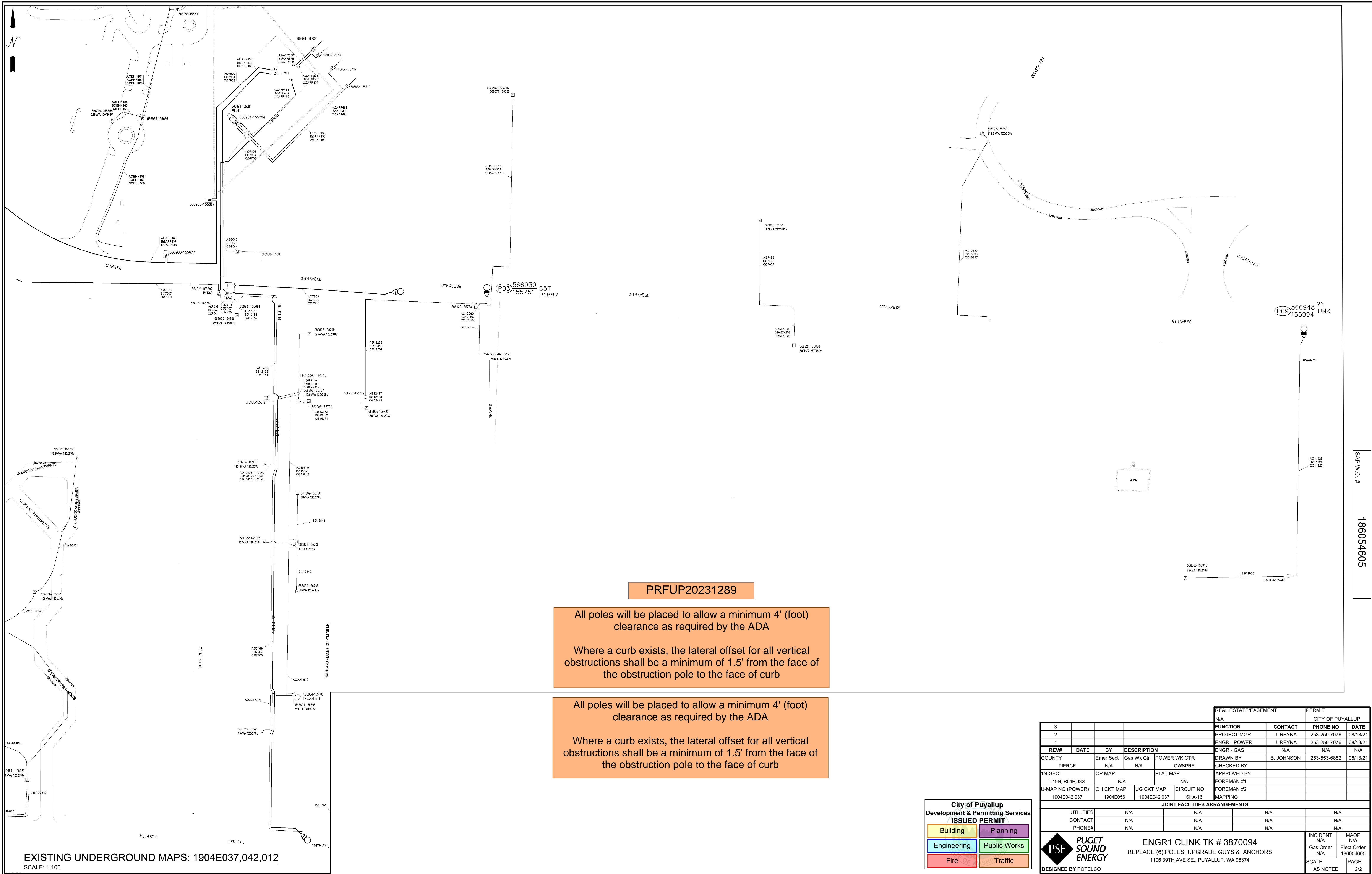

**PRFUP20231289**

All poles will be placed to allow a minimum 4' (foot) clearance as required by the ADA  
 Where a curb exists, the lateral offset for all vertical obstructions shall be a minimum of 1.5' from the face of the obstruction pole to the face of curb

All poles will be placed to allow a minimum 4' (foot) clearance as required by the ADA  
 Where a curb exists, the lateral offset for all vertical obstructions shall be a minimum of 1.5' from the face of the obstruction pole to the face of curb

EXISTING UNDERGROUND MAPS: 1904E037,042,012  
 SCALE: 1:100

**City of Puyallup**  
 Development & Permitting Services  
**ISSUED PERMIT**

Building	Planning
Engineering	Public Works
Fire	Traffic

		REAL ESTATE/EASEMENT		PERMIT			
		N/A		CITY OF PUYALLUP			
REV#	DATE	BY	DESCRIPTION	FUNCTION	CONTACT	PHONE NO	DATE
3							
2				PROJECT MGR	J. REYNA	253-259-7076	08/13/21
1				ENGR - POWER	J. REYNA	253-259-7076	08/13/21
ENGR - GAS	N/A	N/A	N/A				
COUNTY	PIERCE	Emer Sect	Gas Wk Ctr	POWER WK CTR	DRAWN BY	B. JOHNSON	253-553-6882
1/4 SEC	T19N, R04E.03S	OP MAP	N/A	QWSPRE	CHECKED BY		
U-MAP NO (POWER)	1904E042.037	OH CKT MAP	1904E056	UG CKT MAP	1904E042.037	CIRCUIT NO	SHA-16
					FOREMAN #1		
					FOREMAN #2		
					MAPPING		
JOINT FACILITIES ARRANGEMENTS							
UTILITIES	N/A	N/A	N/A	N/A	N/A	N/A	N/A
CONTACT	N/A	N/A	N/A	N/A	N/A	N/A	N/A
PHONE#	N/A	N/A	N/A	N/A	N/A	N/A	N/A
<b>PSE</b> PUGET SOUND ENERGY DESIGNED BY POTELCO				ENGR1 CLINK TK # 3870094 REPLACE (6) POLES, UPGRADE GUYS & ANCHORS 1106 39TH AVE SE., PUYALLUP, WA 98374			
INCIDENT		MAOP		N/A		N/A	
Gas Order		Elect Order		N/A		186054605	
SCALE		PAGE		AS NOTED		2/2	

SAP W/O.# 186054605