

PRFUP20231317

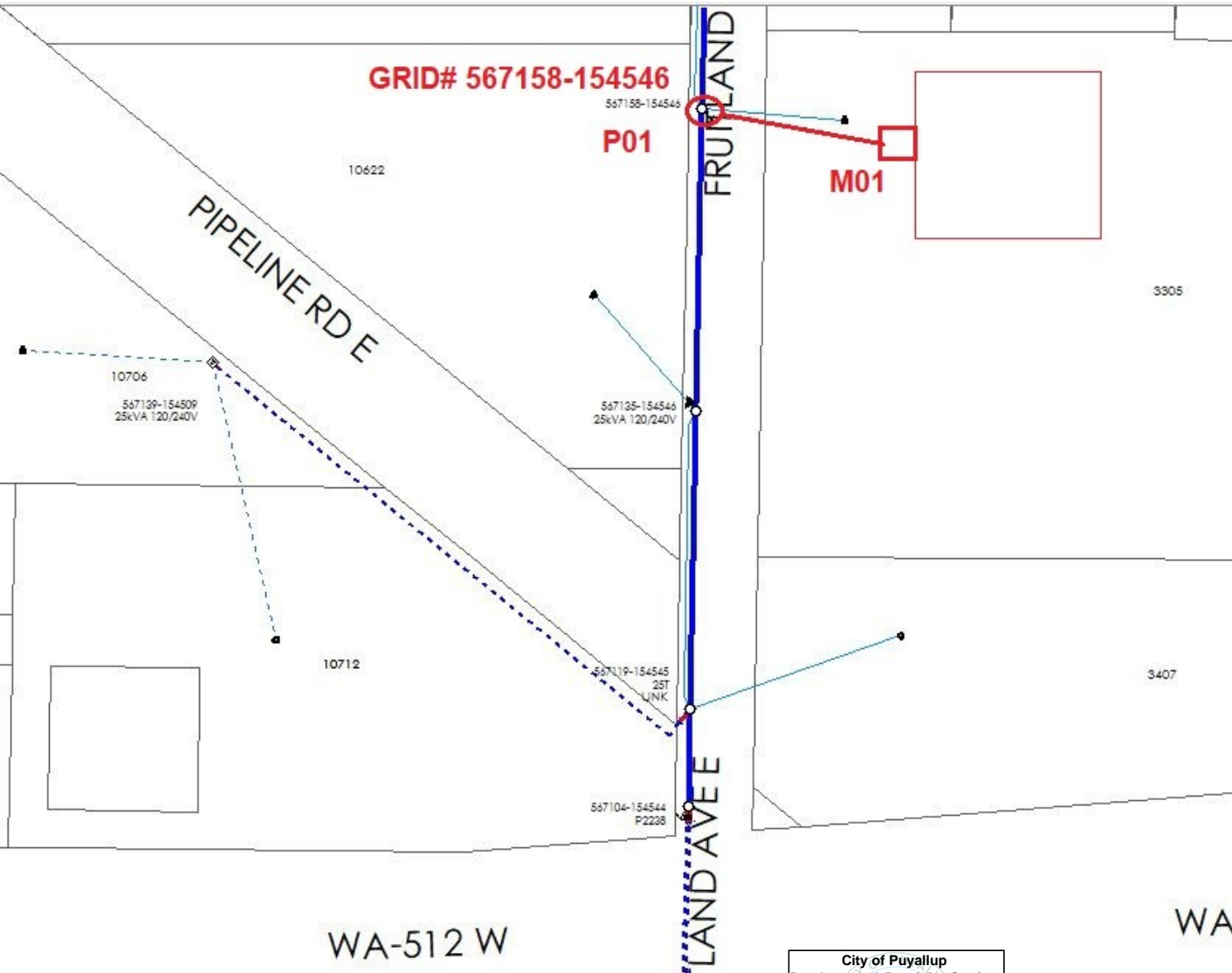

**TAKE A LANE ON FRUITLAND TO ACCESS POLE GRID#567158-154546 TO EXTEND OVERHEAD SERVICE TO PARCEL DIRECTLY ACROSS THE STREET. POLE GROUND NEEDS TO BE SPLICED AS WELL. NO GROUND SURFACE WILL BE DISTURBED.**

The applicant is responsible to notify the city of a job start 48 hours in advance using the CityView portal. The permit and traffic control plans shall be posted at the job site and available to inspectors at all times. Applicant must provide 48hr. notification to residents within 300 feet of the work area either via door hanger, message board or signs posted visibly along the right-of-way.

Puyallup Construction Restriction Zones and routes shall be in effect during the Washington State Fair. September 1-24, 2023

WA-512 W

WA-512 W

City of Puyallup  
Development & Permitting Services  
ISSUED PERMIT

Building	Planning
Engineering	Public Works
Fire	Traffic