

Right of Way



LEGEND

Aerial Splice Point
Ground Mount Splice
Existing Strand
Pole



JB#

JB0001380824

Address:

330 3RD ST SW

PRFUP20231179

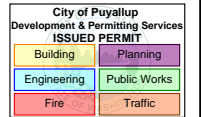

WORK DESCRIPTION

ROW 1

- MAINTENANCE SPlicing AT
- 1 - 330 3RD ST SW
 - 2 - PARCEL 5745300170
 - 3 - PARCEL 5745300240
 - 4 - 306 6TH AVE SW
 - 5 - 504 S MERIDIAN
 - 6 - 602 S MERIDIAN
 - 7 - 401 S MERIDIAN
 - 8 - 122 4TH AVE SE
 - 9 - 611 S MERIDIAN

ROW 2

STARTING AT POLE NEAR 204 4TH AVE SE, TIE IN AND OVERLASH 137' EAST, THEN 135' NORTH, THEN 1531' EAST, THEN 930' SOUTH. END AT POLE NEAR 720 7TH ST SE.

- MAINTENANCE SPlicing AT
- 10 - 404 3RD ST SE
 - 11 - 400 E PIONEER
 - 12 - 320 5TH ST SE
 - 13 - 504 E PIONEER
 - 14 - 524 E PIONEER
 - 15 - 344 7TH ST SE
 - 16 - 325 7TH ST SE
 - 17 - 808 5TH AVE SE

ROW 3

- MAINTENANCE SPlicing AT
- 18 - 601 7TH AVE SW
 - 19 - 622 4TH ST SW
 - 20 - 624 3RD ST SW
 - 21 - 626 2ND ST SW
 - 22 - 623 9TH AVE SW
 - 23 - 803 5TH ST SW
 - 24 - 808 4TH ST SW
 - 25 - 800 S MERIDIAN
 - 26 - 814 2ND ST SW
 - 27 - 902 S MERIDIAN

ROW 4

- MAINTENANCE SPlicing AT
- 28 - 721 4TH ST SE
 - 29 - 804 5TH ST SE
 - 30 - 210 9TH AVE SE
 - 31 - PARCEL 3115000010
 - 32 - 604 9TH AVE SE
 - 33 - 714 9TH AVE SE
 - 34 - 311 10TH AVE SE
 - 35 - 318 10TH AVE SE
 - 36 - 511 10TH AVE SE
 - 37 - 511 10TH AVE SE
 - 38 - 1008 7TH ST SE
 - 39 - 918 8TH ST SE
 - 40 - 1105 5TH ST SE
 - 41 - 619 11TH AVE SE



Right of Way



LEGEND

Aerial Splice Point
Ground Mount Splice
Existing Strand
Pole



JB#

JB0001380824

Address:

330 3RD ST SW

PRFUP20231179

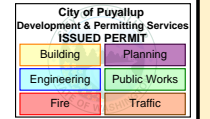

WORK DESCRIPTION

ROW 1

MAINTENANCE SPlicing AT

- 1 - 330 3RD ST SW
- 2 - PARCEL 5745300170
- 3 - PARCEL 5745300240
- 4 - 306 6TH AVE SW
- 5 - 504 S MERIDIAN
- 6 - 602 S MERIDIAN
- 7 - 401 S MERIDIAN
- 8 - 122 4TH AVE SE
- 9 - 611 S MERIDIAN

ROW 2

STARTING AT POLE NEAR 204 4TH AVE SE, TIE IN AND OVERLASH 137' EAST, THEN 135' NORTH, THEN 1531' EAST, THEN 930' SOUTH. END AT POLE NEAR 720 7TH ST SE.

MAINTENANCE SPlicing AT

- 10 - 404 3RD ST SE
- 11 - 400 E PIONEER
- 12 - 320 5TH ST SE
- 13 - 504 E PIONEER
- 14 - 524 E PIONEER
- 15 - 344 7TH ST SE
- 16 - 325 7TH ST SE
- 17 - 808 5TH AVE SE

ROW 3

MAINTENANCE SPlicing AT

- 18 - 601 7TH AVE SW
- 19 - 622 4TH ST SW
- 20 - 624 3RD ST SW
- 21 - 626 2ND ST SW
- 22 - 623 9TH AVE SW
- 23 - 803 5TH ST SW
- 24 - 808 4TH ST SW
- 25 - 800 S MERIDIAN
- 26 - 814 2ND ST SW
- 27 - 902 S MERIDIAN

ROW 4

MAINTENANCE SPlicing AT

- 28 - 721 4TH ST SE
- 29 - 804 5TH ST SE
- 30 - 210 9TH AVE SE
- 31 - PARCEL 3115000010
- 32 - 604 9TH AVE SE
- 33 - 714 9TH AVE SE
- 34 - 311 10TH AVE SE
- 35 - 318 10TH AVE SE
- 36 - 511 10TH AVE SE
- 37 - 511 10TH AVE SE
- 38 - 1008 7TH ST SE
- 39 - 918 8TH ST SE
- 40 - 1105 5TH ST SE
- 41 - 619 11TH AVE SE

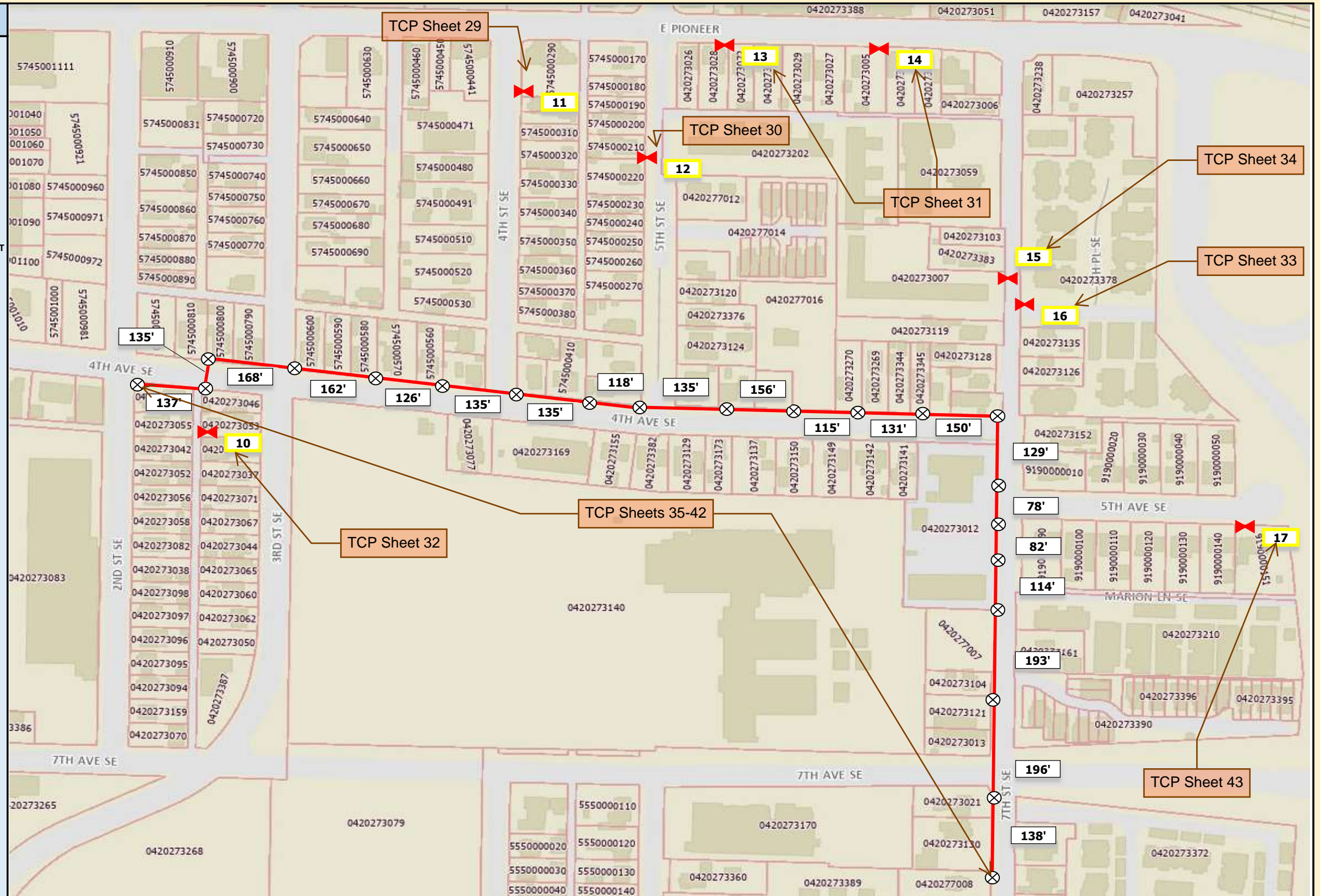

Right of Way



LEGEND

Aerial Splice Point
Ground Mount Splice
Existing Strand
Pole



JB#

JB0001380824

Address:

330 3RD ST SW

PRFUP20231179

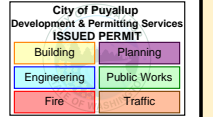

WORK DESCRIPTION

ROW 1

MAINTENANCE SPlicing AT

- 1 - 330 3RD ST SW
- 2 - PARCEL 5745300170
- 3 - PARCEL 5745300240
- 4 - 306 6TH AVE SW
- 5 - 504 S MERIDIAN
- 6 - 602 S MERIDIAN
- 7 - 401 S MERIDIAN
- 8 - 122 4TH AVE SE
- 9 - 611 S MERIDIAN

ROW 2

STARTING AT POLE NEAR 204 4TH AVE SE, TIE IN AND OVERLASH 137' EAST, THEN 135' NORTH, THEN 1531' EAST, THEN 930' SOUTH. END AT POLE NEAR 720 7TH ST SE.

MAINTENANCE SPlicing AT

- 10 - 404 3RD ST SE
- 11 - 400 E PIONEER
- 12 - 320 5TH ST SE
- 13 - 504 E PIONEER
- 14 - 524 E PIONEER
- 15 - 344 7TH ST SE
- 16 - 325 7TH ST SE
- 17 - 808 5TH AVE SE

ROW 3

MAINTENANCE SPlicing AT

- 18 - 601 7TH AVE SW
- 19 - 622 4TH ST SW
- 20 - 624 3RD ST SW
- 21 - 626 2ND ST SW
- 22 - 623 9TH AVE SW
- 23 - 803 5TH ST SW
- 24 - 808 4TH ST SW
- 25 - 800 S MERIDIAN
- 26 - 814 2ND ST SW
- 27 - 902 S MERIDIAN

ROW 4

MAINTENANCE SPlicing AT

- 28 - 721 4TH ST SE
- 29 - 804 5TH ST SE
- 30 - 210 9TH AVE SE
- 31 - PARCEL 3115000010
- 32 - 604 9TH AVE SE
- 33 - 714 9TH AVE SE
- 34 - 311 10TH AVE SE
- 35 - 318 10TH AVE SE
- 36 - 511 10TH AVE SE
- 37 - 511 10TH AVE SE
- 38 - 1008 7TH ST SE
- 39 - 918 8TH ST SE
- 40 - 1105 5TH ST SE
- 41 - 619 11TH AVE SE

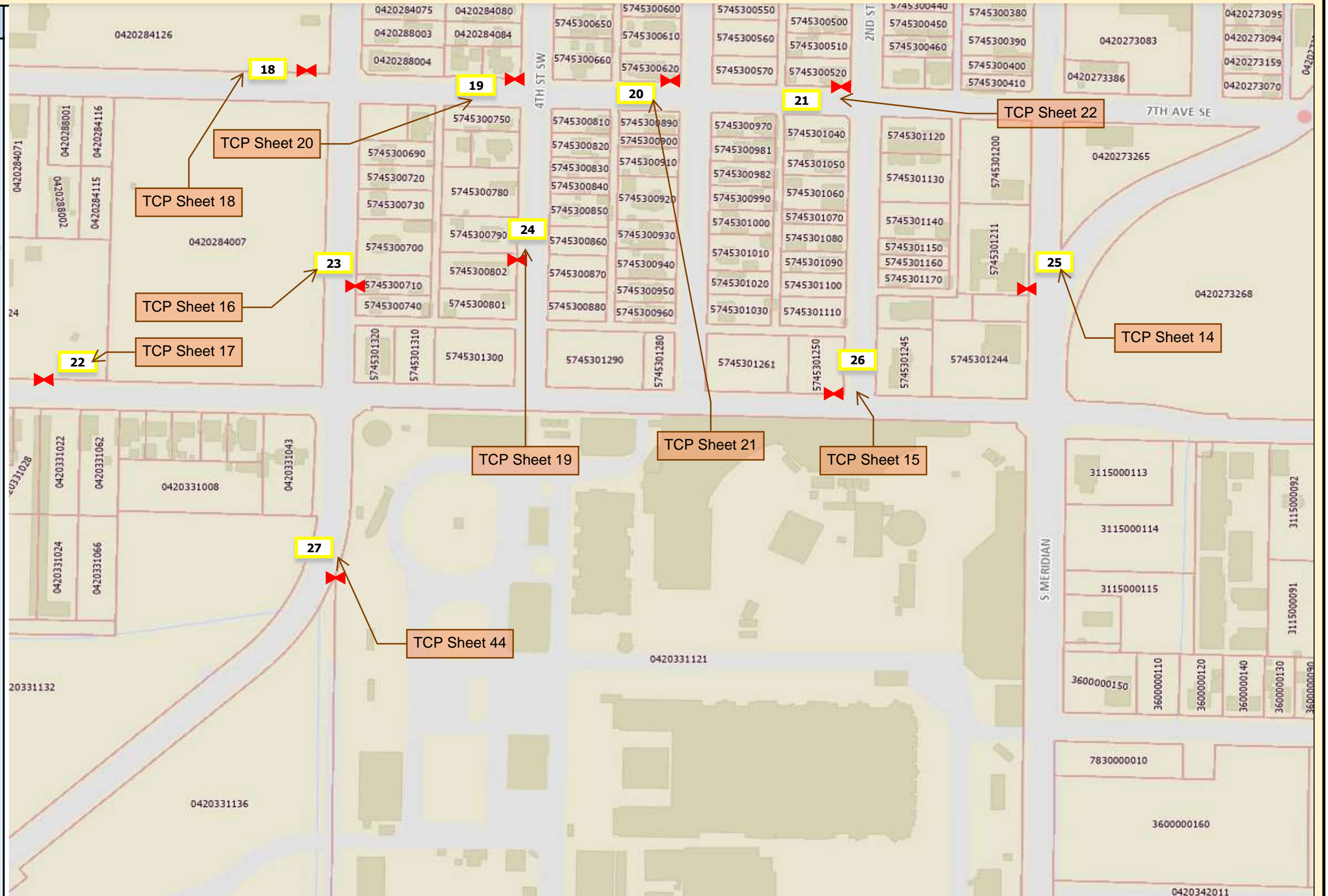

Right of Way



LEGEND

Aerial Splice Point
Ground Mount Splice
Existing Strand
Pole



JB#

JB0001380824

Address:

330 3RD ST SW

PRFUP20231179

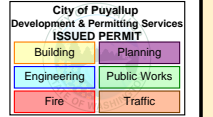

WORK DESCRIPTION

ROW 1

MAINTENANCE SPlicing AT

- 1 - 330 3RD ST SW
- 2 - PARCEL 5745300170
- 3 - PARCEL 5745300240
- 4 - 306 6TH AVE SW
- 5 - 504 S MERIDIAN
- 6 - 602 S MERIDIAN
- 7 - 401 S MERIDIAN
- 8 - 122 4TH AVE SE
- 9 - 611 S MERIDIAN

ROW 2

STARTING AT POLE NEAR 204 4TH AVE SE, TIE IN AND OVERLASH 137' EAST, THEN 135' NORTH, THEN 1531' EAST, THEN 930' SOUTH. END AT POLE NEAR 720 7TH ST SE.

MAINTENANCE SPlicing AT

- 10 - 404 3RD ST SE
- 11 - 400 E PIONEER
- 12 - 320 5TH ST SE
- 13 - 504 E PIONEER
- 14 - 524 E PIONEER
- 15 - 344 7TH ST SE
- 16 - 325 7TH ST SE
- 17 - 808 5TH AVE SE

ROW 3

MAINTENANCE SPlicing AT

- 18 - 601 7TH AVE SW
- 19 - 622 4TH ST SW
- 20 - 624 3RD ST SW
- 21 - 626 2ND ST SW
- 22 - 623 9TH AVE SW
- 23 - 803 5TH ST SW
- 24 - 808 4TH ST SW
- 25 - 800 S MERIDIAN
- 26 - 814 2ND ST SW
- 27 - 902 S MERIDIAN

ROW 4

MAINTENANCE SPlicing AT

- 28 - 721 4TH ST SE
- 29 - 804 5TH ST SE
- 30 - 210 9TH AVE SE
- 31 - PARCEL 3115000010
- 32 - 604 9TH AVE SE
- 33 - 714 9TH AVE SE
- 34 - 311 10TH AVE SE
- 35 - 318 10TH AVE SE
- 36 - 511 10TH AVE SE
- 37 - 511 10TH AVE SE
- 38 - 1008 7TH ST SE
- 39 - 918 8TH ST SE
- 40 - 1105 5TH ST SE
- 41 - 619 11TH AVE SE

