



PRFUP20231284

Job #: 887038150
 Date: 8/24/23
 Jurisdiction: Puyallup
 ROW Permit: Yes
 Est. Start Date:
 Est. Duration:

Service Address: SE 23RD ST & SHAW RD E VALVE 2
 City: Puyallup Zip: 98372
 Customer: PSE Phone:
 Customer Email:
 PM / Inspector: Gayle / Gary Inglin Phone:
 Site Contact Email: Phone:

Job Description

PROVIDE TRAFFIC CONTROL PLAN
 TO ALLOW PSE TO OPERATE VALVE @ 42'WCL SHAW RD & 21'NCL 23 AVE SE
 POLICE FLAGGER PLUS ONE FLAGGER

New Construction:
Construction Method
Building Foundation Type
Septic System

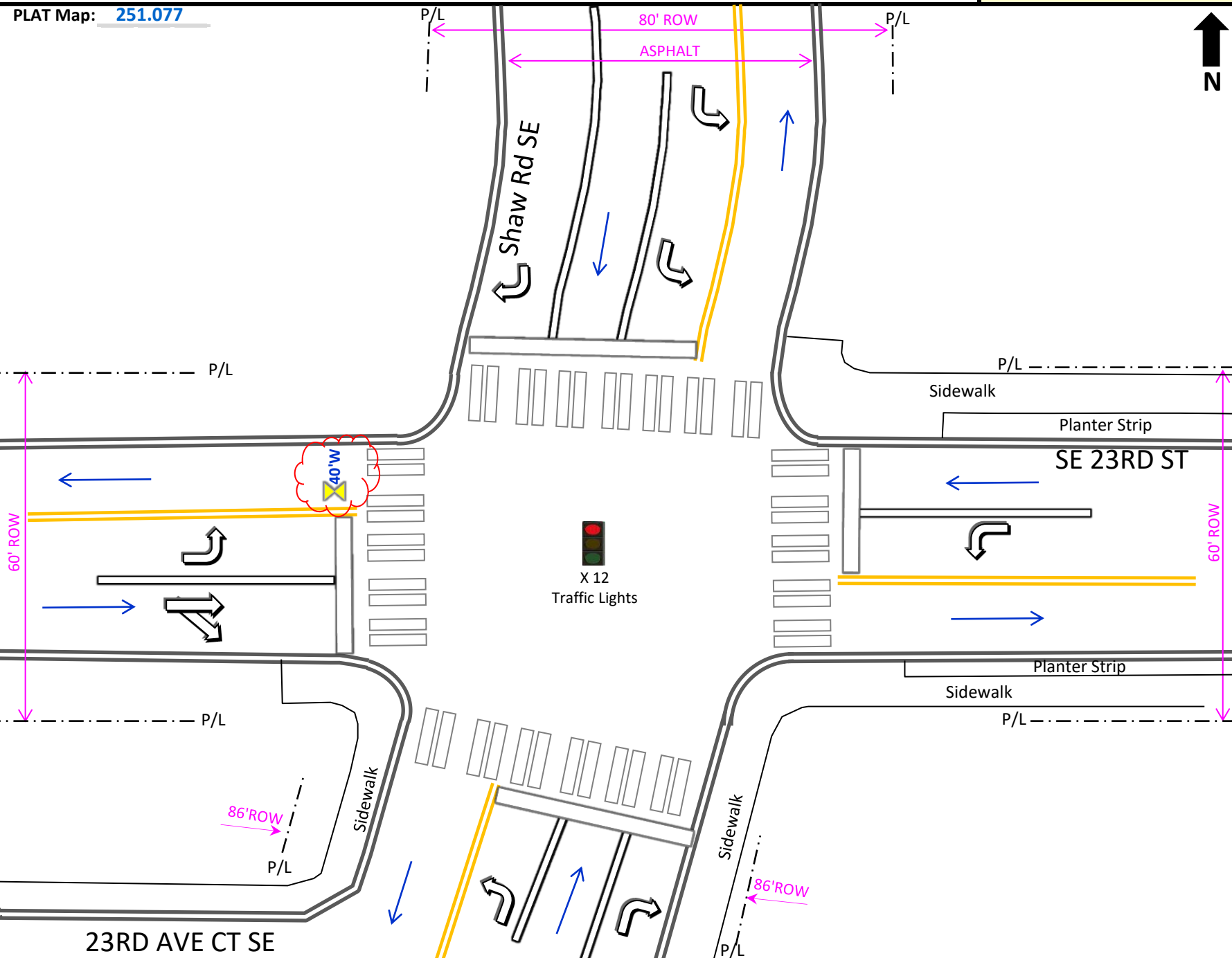

Work Location					Size of Cut	Surface Type
12'	N	of CL	23RD AVE SE	& 42' W of CL SHAW RD		
		of CL		& of CL		
		of CL		& of CL		
Service Information			Street Information			Job Type
Diameter:	0		Flaggers #:	0	Arterial:	No
EFV:	0		Police #:	0	TCP:	No
Meter:			Speed Limit:	0	No Parks #:	0
Meter Loc:	0		Trolley Lines:	No	Mtr Hoods #:	0
Del Press:			Traffic Signal:		Bus Stop:	No
Bollards:	2.5" #	4" #	ADA Ramps #:	0	Route #'s:	
						LAK - Lakewood

