

CITY OF PUYALLUP - CITY STANDARDS, ROAD DESIGN DICTATES THAT THE ENTERING SIGHT DISTANCE FOR AN ARTERIAL ROAD WITH A POSTED SPEED OF 45 MPH IS 530 FT.

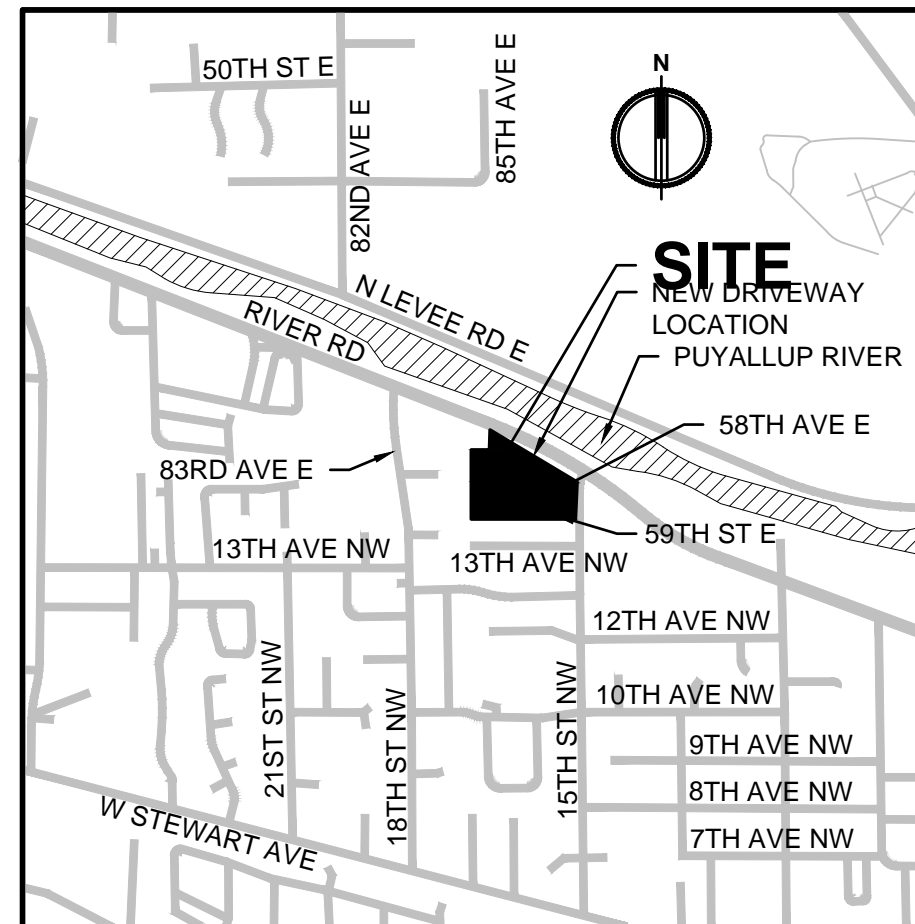
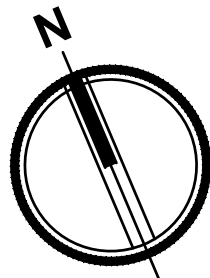
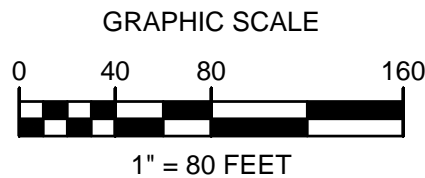

VICINITY MAP

SCALE: 1" = 1/4 MILE (1320')

TREE TO HAVE BRANCHES UNDER 8' TALL PRUNED TO IMPROVE SIGHT DISTANCE

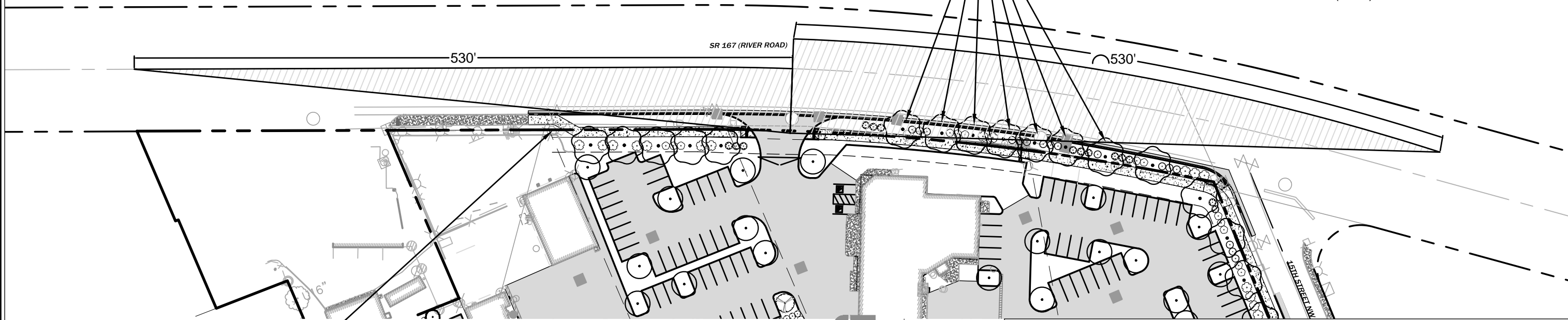

EXISTING UTILITY POLE OUTSIDE LINE OF SIGHT TRIANGLE

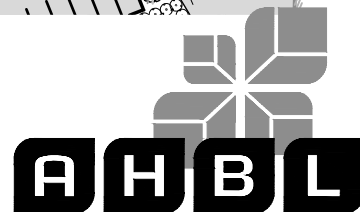

2215 North 30th Street,
Suite 300,
Tacoma, WA 98403
253.383.2422 TEL
253.383.2572 FAX

LARSON RIVER ROAD STORAGE

**SIGHT DISTANCE - ESD
RIVER ROAD**

JOB NO.
2160102.10

DATE:
07/13/2023

1 / 5

CITY OF PUYALLUP - CITY STANDARDS, ROAD DESIGN DICTATES THAT THE STOPPING SIGHT DISTANCE FOR AN ARTERIAL ROAD WITH A POSTED SPEED OF 45 MPH IS 550 FT.

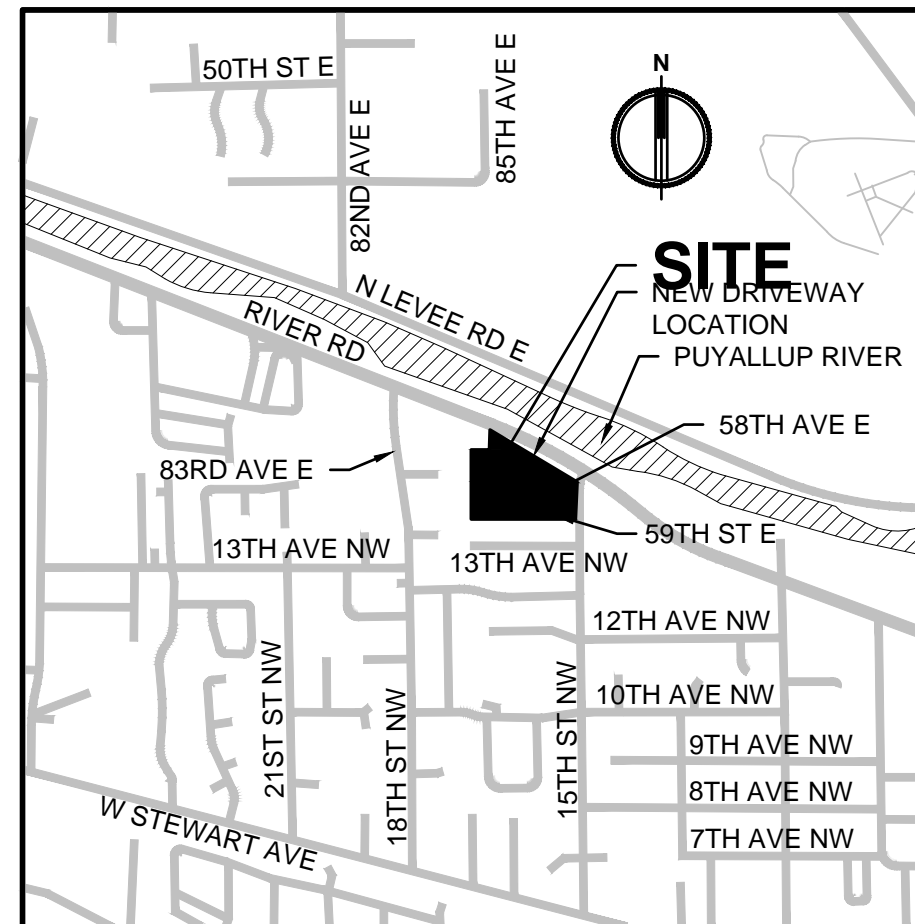
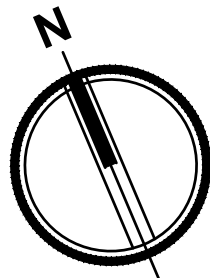
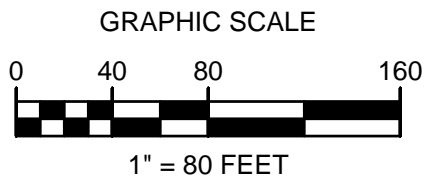

VICINITY MAP

SCALE: 1" = 1/4 MILE (1320')

TREE TO HAVE BRANCHES UNDER 8' TALL PRUNED TO IMPROVE SIGHT DISTANCE

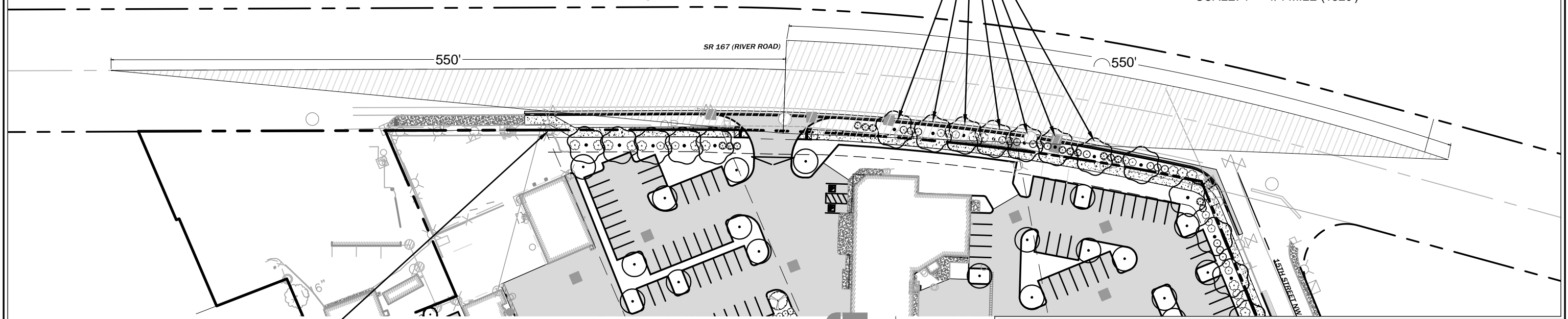

EXISTING UTILITY POLE OUTSIDE LINE OF SIGHT TRIANGLE

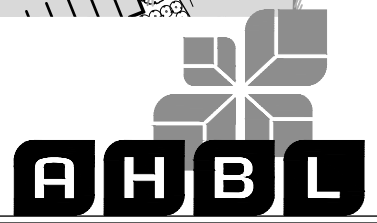

2215 North 30th Street,
Suite 300,
Tacoma, WA 98403
253.383.2422 TEL
253.383.2572 FAX

LARSON RIVER ROAD STORAGE	
SIGHT DISTANCE - SSD RIVER ROAD	

JOB NO. 2160102.10
DATE: 07/13/2023
2 / 5

CITY OF PUYALLUP - CITY STANDARDS, ROAD DESIGN DICTATES THAT THE ENTERING SIGHT DISTANCE FOR AN ARTERIAL ROAD WITH A POSTED SPEED OF 45 MPH IS 530 FT.

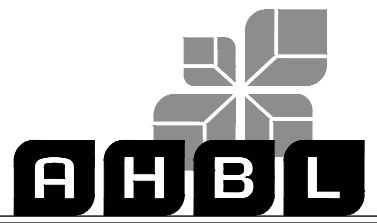
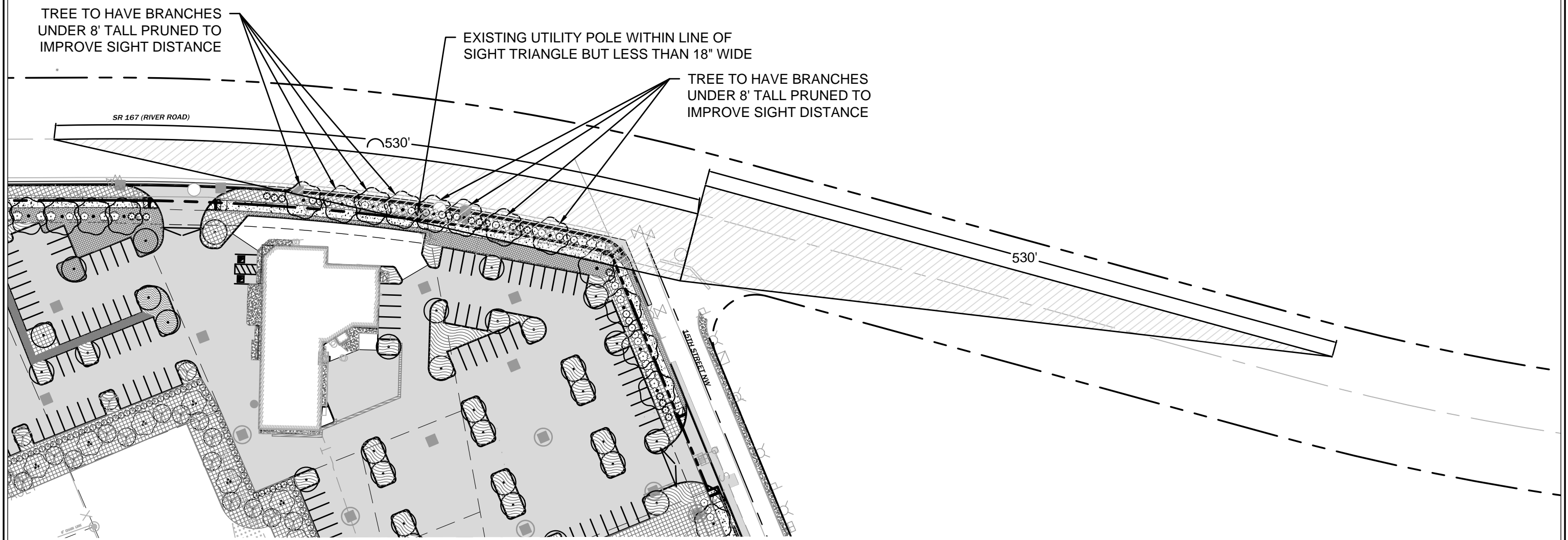
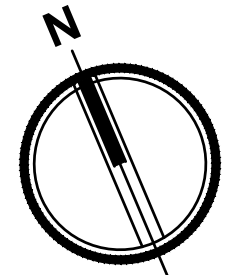
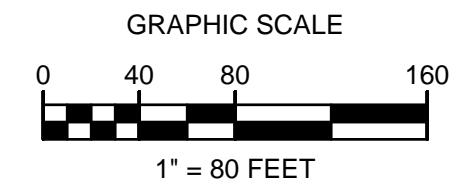

2215 North 30th Street,
Suite 300,
Tacoma, WA 98403
253.383.2422 TEL
253.383.2572 FAX

LARSON RIVER ROAD STORAGE	
SIGHT DISTANCE - ESD	
RIVER ROAD AND 15TH STREET NW	

JOB NO. 2160102.10
DATE: 07/13/2023
3 / 5

CITY OF PUYALLUP - CITY STANDARDS, ROAD DESIGN DICTATES THAT THE ENTERING SIGHT DISTANCE FOR A COLLECTOR WITH A POSTED SPEED OF 25 MPH IS 300 FT.

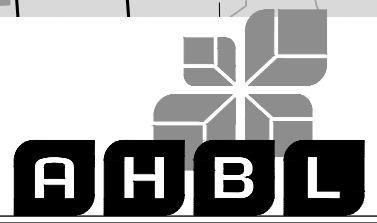
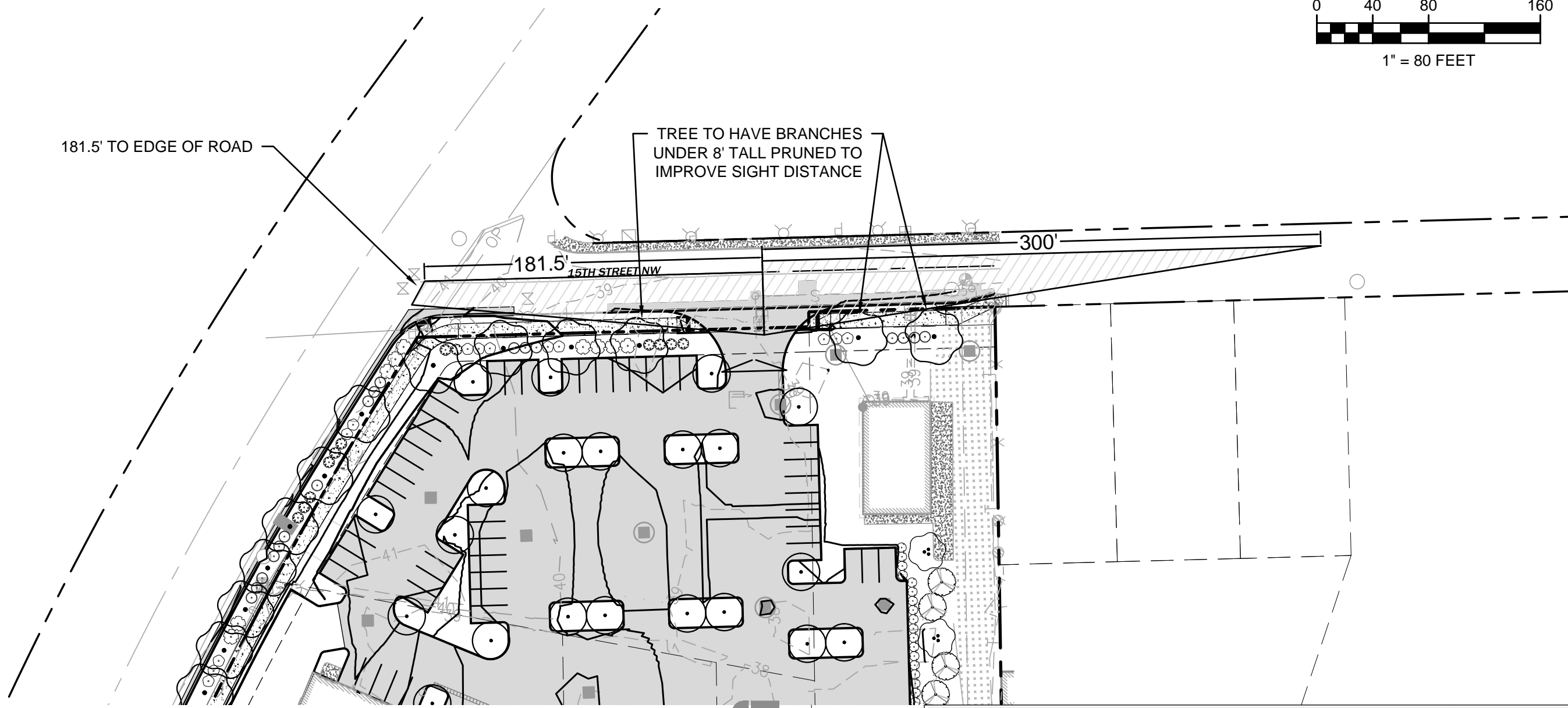
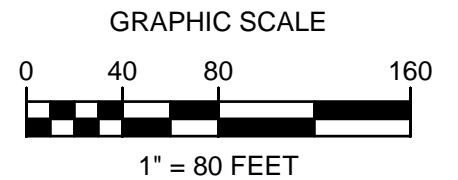
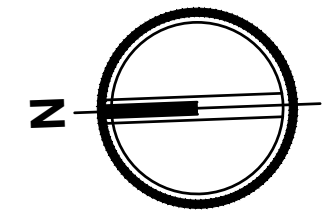

2215 North 30th Street,
 Suite 300,
 Tacoma, WA 98403
 253.383.2422 TEL
 253.383.2572 FAX

LARSON RIVER ROAD STORAGE	
SIGHT DISTANCE - ESD	
15TH ST NW	

JOB NO. 2160102.10
DATE: 07/13/2023
4 / 5

CITY OF PUYALLUP - CITY STANDARDS, ROAD DESIGN DICTATES THAT THE STOPPING SIGHT DISTANCE FOR A COLLECTOR WITH A POSTED SPEED OF 25 MPH IS 250 FT.

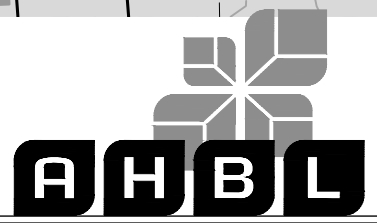
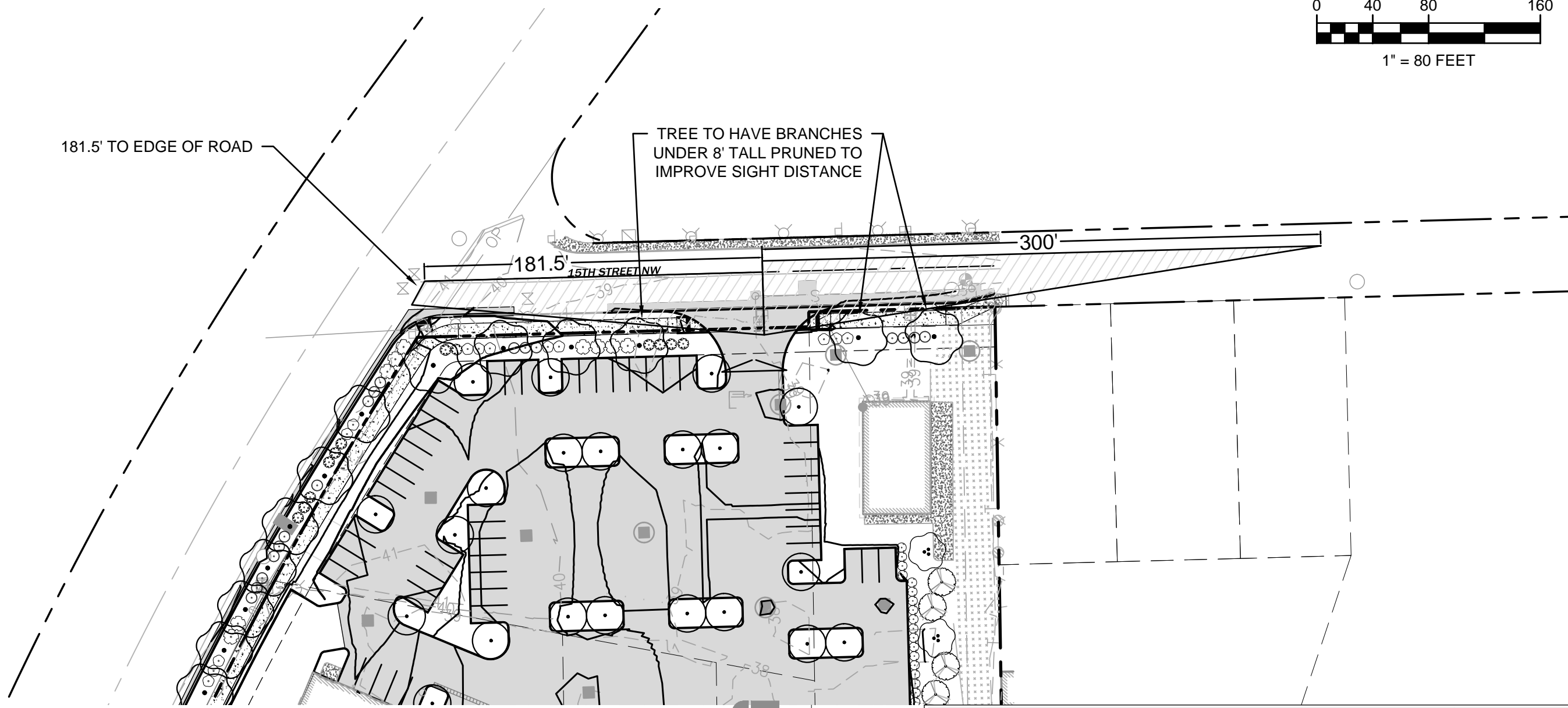
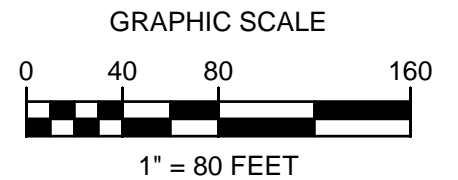
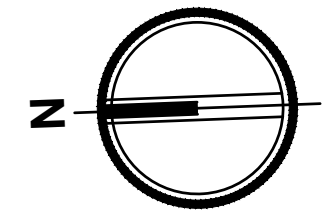

2215 North 30th Street,
 Suite 300,
 Tacoma, WA 98403
 253.383.2422 TEL
 253.383.2572 FAX

LARSON RIVER ROAD STORAGE

SIGHT DISTANCE - SSD
15TH ST NW

JOB NO. 2160102.10
DATE: 07/13/2023
5 / 5