

SITE PLAN:P01
SCALE: 1:100

SITE SPECIFIC NOTES

P01 (568238-155030) TREE TRIMMING REQ'D

- REPLACE 45' CL3 POLE
- INST 50 CL2 POLE (6010.1000 PD502)
- INST 3Ø DBL WING ARM (6033.4020 TADW312)
- INST 3Ø DBL DE (6033.1044 DDE2315)
- EXTEND #2 ACSR OH PRI AS NECESSARY (____')
- EXTEND #2 ACSR OH NEUT AS NECESSARY (____')
- INST JUMPERS (____/____')
- TRANSFER OH SEC SPLICE & EXTEND IF NECESSARY (____/____')
- TRANSFER S/L (SLAT2287)
- TRANSFER SPAN GUY NORTH
- TOP POLE TO COMMS

POLE RETIREMENT TABLE							TEMP TRANSFERS			ST. LIGHT TRANSFERS		
SITE #	POLE DATA				POLE		TEL	TV	FIBER	TRAN	RMVD	ID NUMBER
	GRID #	HEIGHT	CLASS	YEAR	TOPPED	RMVD						
P01	568238-155030	45	3	1977	<input type="checkbox"/>	<input type="checkbox"/>	<input type="checkbox"/>	<input type="checkbox"/>	<input type="checkbox"/>	<input type="checkbox"/>		SLAT2287

POLE TABLE (NEW)					
Site #	Pole Data				
	Grid #	Height	Class	Year	Remarks / Location Ref.
P01	568238-155030	50	2		

PRFUP20231610

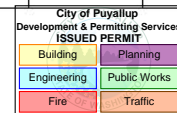

The applicant is responsible to notify the city of a job start 48 hours in advance using the CityView portal.

The permit and traffic control plans shall be posted at the job site and available to inspectors at all times.

Applicant must provide 48hr. notification to residents within 300 feet of the work area either via door hanger, message board or signs posted visibly along the right-of-way.

POWER GENERAL NOTES

- All materials to be installed in accordance with Puget Sound Energy's (PSE) standards. Any deviation from this work sketch must be AUTHORIZED by Potelco's Project Manager and NOTED on the Foreman's Copy.
- All switching arrangements and/or outage arrangements are to be made with the Project Manager at least three (3) working days in advance.
- Contact the Utilities Underground Location Center (1-800-424-5555) at least 48 hours prior to commencing work to get the underground facilities located.
- All work is to be done in accordance with local municipal and county permit requirements as applicable.
- Inclement weather conditions may cause delays in construction times and dates.

EROSION & SEDIMENT CONTROL REQUIREMENTS

EROSION & SEDIMENT CONTROL SHALL BE PER PSE STANDARD PRACTICE 0150.3200 TECHNIQUES FOR TEMPORARY EROSION & SEDIMENT CONTROL & ANY ADDITIONAL LOCAL JURISDICTION REQUIREMENTS. (LOCAL JURISDICTIONS MAY HAVE ADDITIONAL REQUIREMENTS INCLUDING NOTES DETAILING WHERE EROSION OR SEDIMENT CONTROL STRUCTURES ARE TO BE INSTALLED, CROSS SECTION DETAILS OF THE TYPICAL EROSION STRUCTURES, & SPECIAL REQUIREMENTS FOR WORK IN SENSITIVE AREAS.)

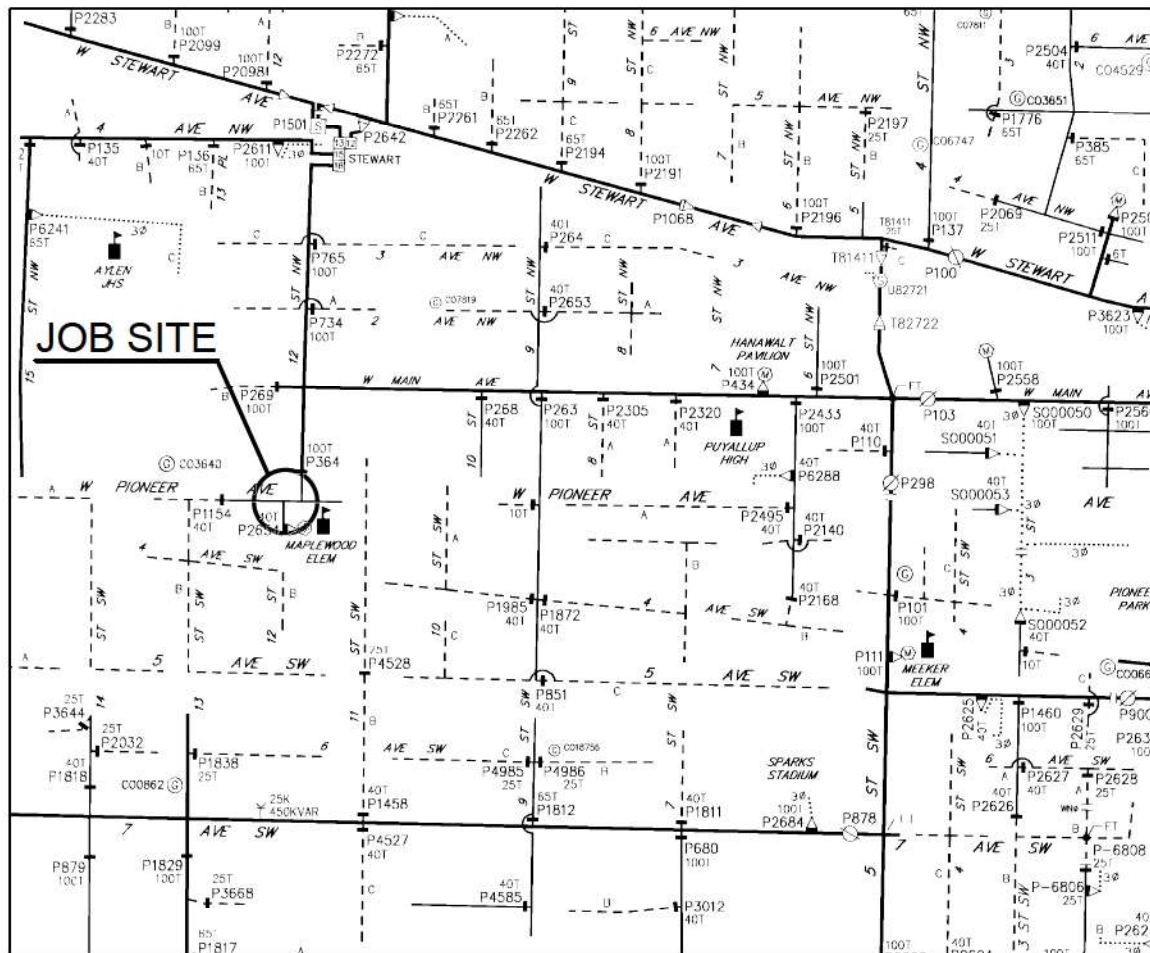

OH CIRCUIT MAP: D2004E112

SCALE 6" = 1 MILE

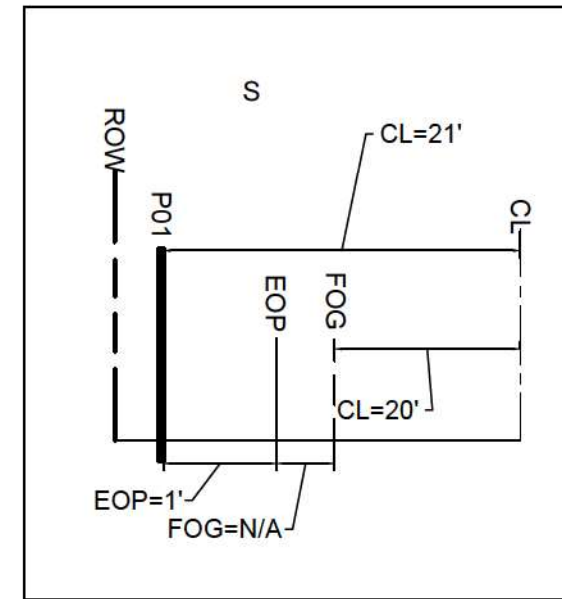

ROW PROFILE: P01

NOT TO SCALE

PRFUP20231610

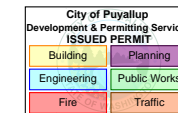

VICINITY MAP



SAP W.O. # 186065858

FOREMAN (CHECK BOX WHEN COMPLETED)

- PSE Equipment LOCKED/SECURED & Work Area left in CLEAN/SAFE Condition.
 - Grid, Cable, and Switch numbers INSTALLED & VERIFIED.
 - Field Changes RED-LINED on As-built.
 - Material VERIFIED and CHANGES noted on Paperwork.
 - Total PRIMARY Cable noted on As-built.
 - Company ID#'s RECORDED in correct location on As-built.
 - Indicate correct FUSE SIZE on As-built & VERIFY proper PHASE.
 - Deviations noted on the As-built and their reason.
- I certify that the work performed meets PSE's standards and procedures and that all quality requirements are met.

Foreman's Signature _____

Print Name _____ Date _____

PROJECT PHASE	NOTIF#	ORDER#
PWR Superior	514397160	186065858
Sub Order		101165752/108149247
		N/A
		N/A

Developer Yes Yes x PSE

"Locates Required"	No	No
"Outages Required"	Yes x	No
"Flagging Required"	Yes x	No

CALL (800) 424-5555
2 BUSINESS DAYS BEFORE YOU DIG

THIS SKETCH NOT TO BE RELIED UPON FOR EXACT LOCATION OF EXISTING FACILITIES

REV#	DATE	BY	DESCRIPTION
3			
2			
1			
COUNTY	PIERCE	Emer Sect	N/A
1/4 SEC	T20, R04E, DLC	Gas Wk Ctr	N/A
U-MAP NO (POWER)	A2004E111	POWER WK CTR	QSWPRE
OH CKT MAP	D2004E112	PLAT MAP	N/A
UG CKT MAP	R2004E111	CIRCUIT NO	STW-16

REAL ESTATE/EASEMENT	PERMIT		
N/A	CITY OF PUYALLUP		
FUNCTION	CONTACT	PHONE NO	DATE
PROJECT MGR	J. SPIVEY	253-308-1803	9/13/23
ENGR - POWER	J. REYNA	253-259-7076	9/13/23
ENGR - GAS	N/A	N/A	N/A
DRAWN BY	K. O-SAWKA	N/A	9/13/23
CHECKED BY			
APPROVED BY	<i>[Signature]</i>		10/13/23
FOREMAN #1			
FOREMAN #2			
MAPPING			

JOINT FACILITIES ARRANGEMENTS

UTILITIES	CONTACT	PHONE#	INCIDENT	MAOP
N/A	N/A	N/A	N/A	N/A
N/A	N/A	N/A	N/A	N/A
N/A	N/A	N/A	N/A	N/A



ENGR1 MWCMMO TK# 5713818

REPLACE [1] DISTRIBUTION POLE
1110 W PIONEER PUYALLUP WA 98371

INCIDENT N/A	MAOP N/A
Gas Order N/A	Elect Order 186065858
SCALE AS NOTED	PAGE 1/1