

LEGEND	
---	ROOF DRAIN
---	ROOF LINES
---	PROPERTY LINE
DS	DOWNSPOUT
o	PROPERTY CORNER

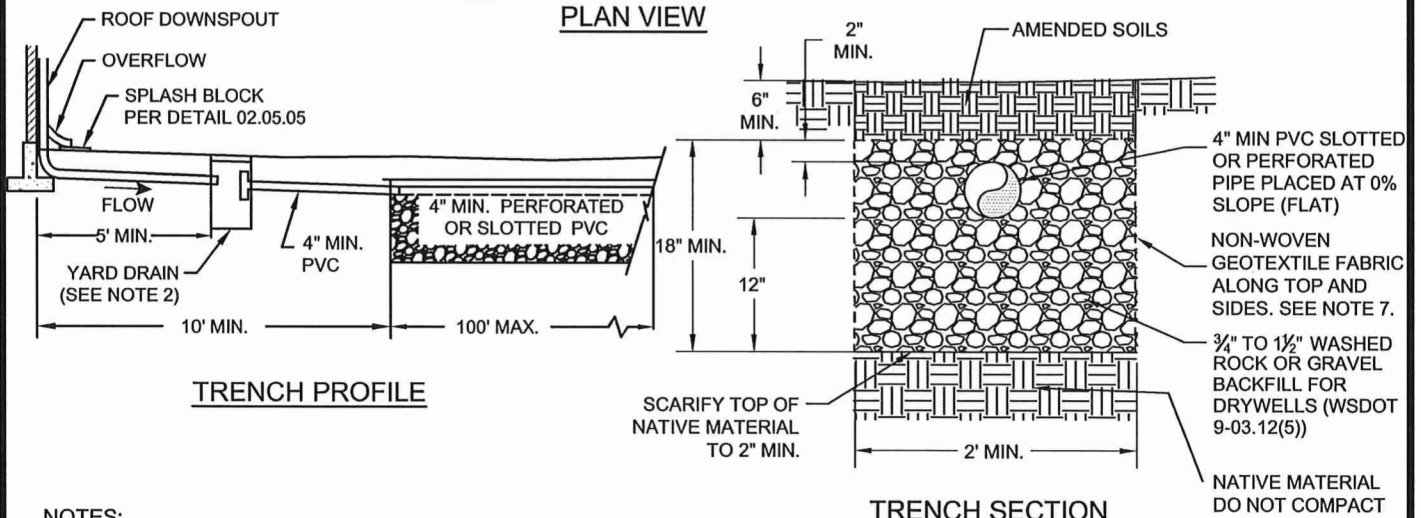

#### NOTES:

1. ROOF DRAIN SHALL PROVIDE POSITIVE FLOW FROM DOWNSPOUTS (DS) TO YARD DRAINS.
2. YARD DRAINS SHALL BE INSTALLED UPSTREAM OF EACH DOWNSPOUT INFILTRATION TRENCH IN ACCORDANCE WITH STD DETAIL 02.05.02.
3. TRENCH BOTTOM SHALL BE A MINIMUM OF 1' ABOVE SEASONAL HIGH GROUNDWATER OR IMPERMEABLE SOIL LAYER.
4. TRENCH SHALL BE DESIGNED IN ACCORDANCE WITH SECTION 210.2.
5. INFILTRATION TRENCH SHOULD NOT BE INSTALLED UNDER IMPERVIOUS SURFACES.
6. CLEANOUT(S) SHALL BE INSTALLED IN ACCORDANCE WITH STD DETAIL 02.01.09.
7. NON-WOVEN GEOTEXTILE TO CONFORM TO WSDOT 9-33.2(1), TABLE 1 AND 2.



**CITY OF  
PUYALLUP**

PUBLIC WORKS AND  
DEVELOPMENT ENGINEERING

APPROVED FOR PUBLICATION



DATE SEALED: 7/6/23

## DOWNSPOUT INFILTRATION TRENCH

SCALE  
NTS

DATE REVISED:  
05/19/2023

CITY  
STANDARD

FILE NAME: Y:\Shared\Drawings\City Standards\2018\02 - PART 2 -  
STANDARD DETAILS\CAD\200\02.05.01

02.05.01

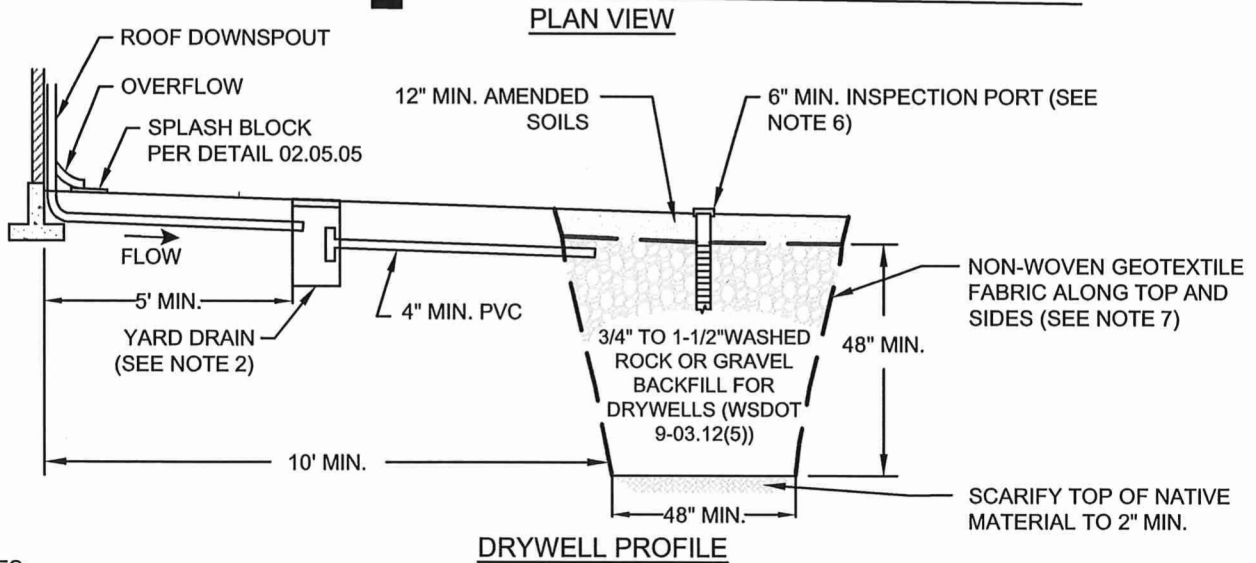
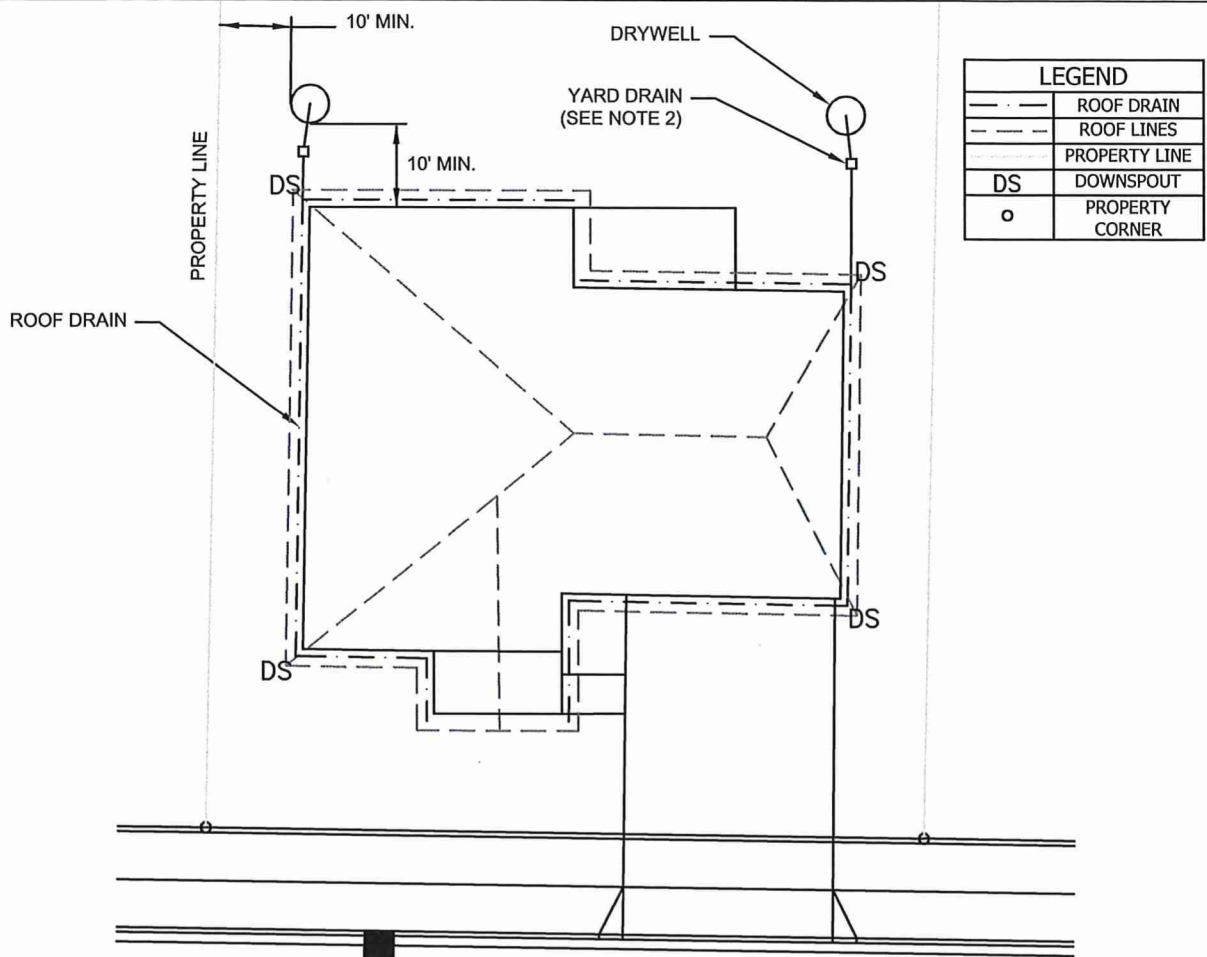

#### NOTES:

1. ROOF DRAIN SHALL PROVIDE POSITIVE FLOW FROM DOWNSPOUTS (DS) TO YARD DRAINS.
2. YARD DRAINS SHALL BE INSTALLED UPSTREAM OF EACH ROOF DOWNSPOUT DRYWELL IN ACCORDANCE WITH STD DETAIL 02.05.02.
3. DRYWELL BOTTOM SHALL BE A MINIMUM OF 1' ABOVE SEASONAL HIGH GROUNDWATER OR IMPERMEABLE SOIL LAYER.
4. DRYWELL SHALL BE DESIGNED IN ACCORDANCE WITH SECTION 210.3.
5. DRYWELL SHALL NOT BE INSTALLED UNDER IMPERVIOUS SURFACES.
6. INSPECTION PORT SHALL BE INSTALLED IN ACCORDANCE WITH STD DETAIL 02.01.10.
7. NON-WOVEN GEOTEXTILE TO CONFORM TO WSDOT 9-33.2(1), TABLE 1 AND 2.



**CITY OF  
PUYALLUP**  
PUBLIC WORKS AND  
DEVELOPMENT ENGINEERING

APPROVED FOR PUBLICATION



DATE SEALED: 1/16/23

## DOWNSPOUT DRYWELL

SCALE:  
NTS

DATE REVISED:  
05/19/2023

CITY  
STANDARD

FILE NAME: Y:\Shared\Drawings\City Standards\2018\02 - PART 2 -  
STANDARD DETAILS\CAD\200\02.05.04

02.05.04

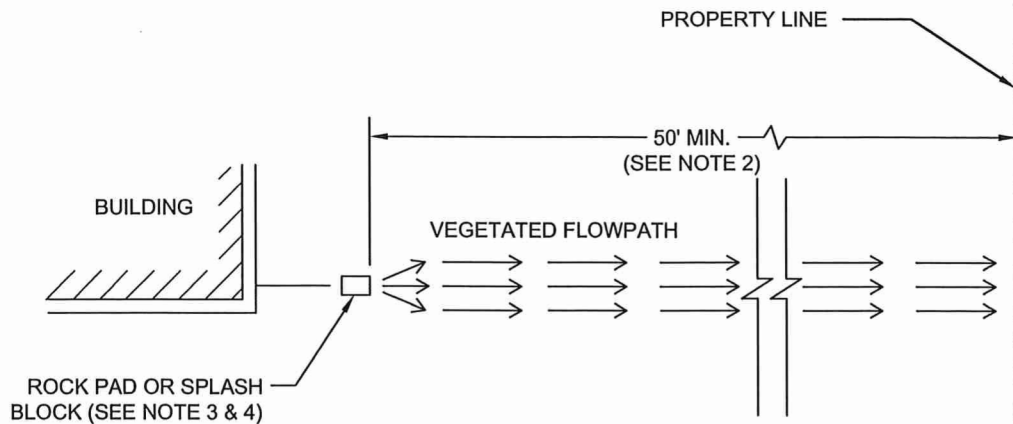

PLAN VIEW

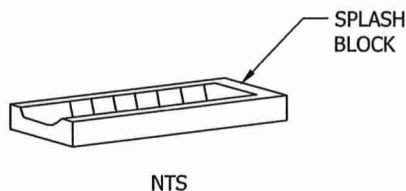

ROOF DOWNSPOUT  
SERVES UP TO  
700 S.F. OF ROOF

BUILDING

DOWNSPOUT EXTENSION

COMMERCIAL SPLASH BLOCK OR ROCK PAD WITH  
DIMENSIONS 2'x3'x8" (SEE NOTE 3 & 4) (SLOPE AWAY FROM  
DISCHARGE POINT)

50' MIN. VEGETATED  
FLOW PATH



PROFILE VIEW

NOTES:

1. SPLASH BLOCKS SHALL BE DESIGNED IN ACCORDANCE WITH SECTION 210.4.
2. THE VEGETATED FLOW PATH SHALL BE MEASURED FROM THE SPLASH BLOCK (DISCHARGE POINT) AND MEASURED PERPENDICULAR TO SITE CONTOURS.
3. SPLASH BLOCKS SHALL BE CONCRETE, PLASTIC, OR SIMILAR MATERIAL. COMMERCIALY AVAILABLE SPLASH BLOCKS GENERALLY MEET DESIGN CRITERIA.
4. ROCK PAD SHALL CONSIST OF 4" COBBLES PER WSDOT 9-03.11(2).



**CITY OF  
PUYALLUP**  
PUBLIC WORKS AND  
DEVELOPMENT ENGINEERING

APPROVED FOR PUBLICATION

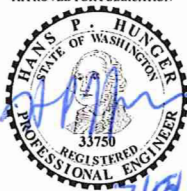

DATE SEALED: 7/10/23

**DOWNSPOUT  
SPLASHBLOCK**

SCALE  
NTS

DATE REVISED:  
04/17/2023

CITY  
STANDARD

FILE NAME: Y:\Shared\Drawings\City Standards\2018\02 - PART 2 -  
STANDARD DETAILS\CAD\200\02.05.05

02.05.05



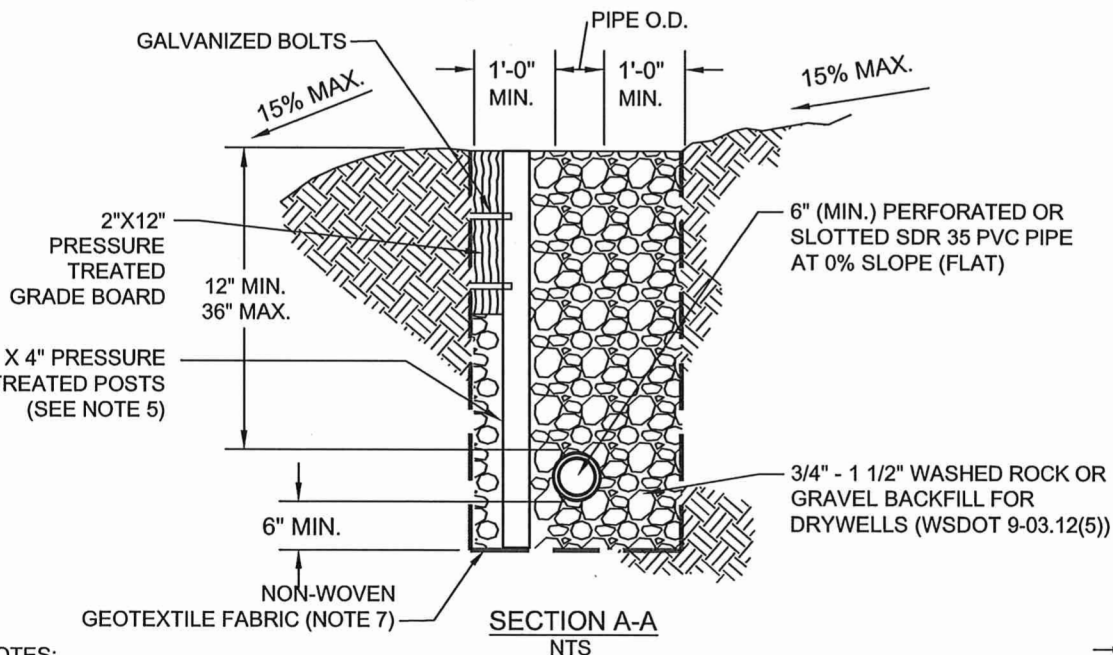

02.05.06



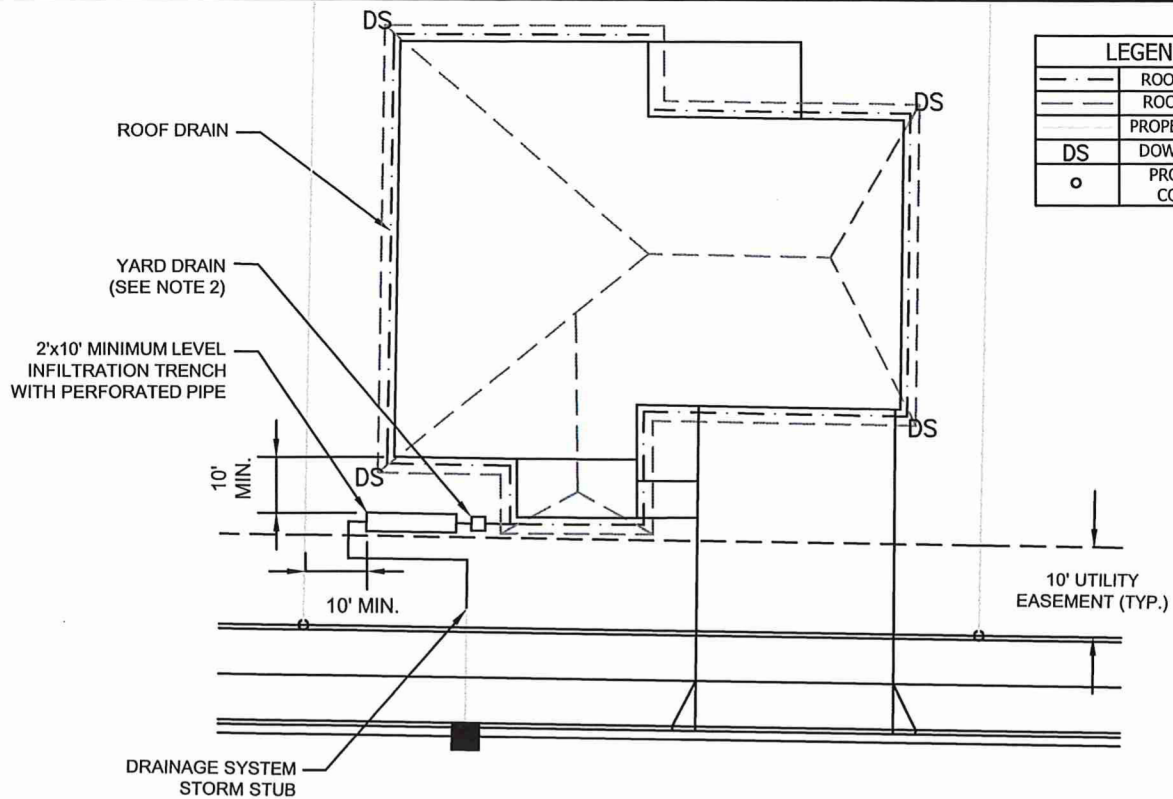

PLAN VIEW

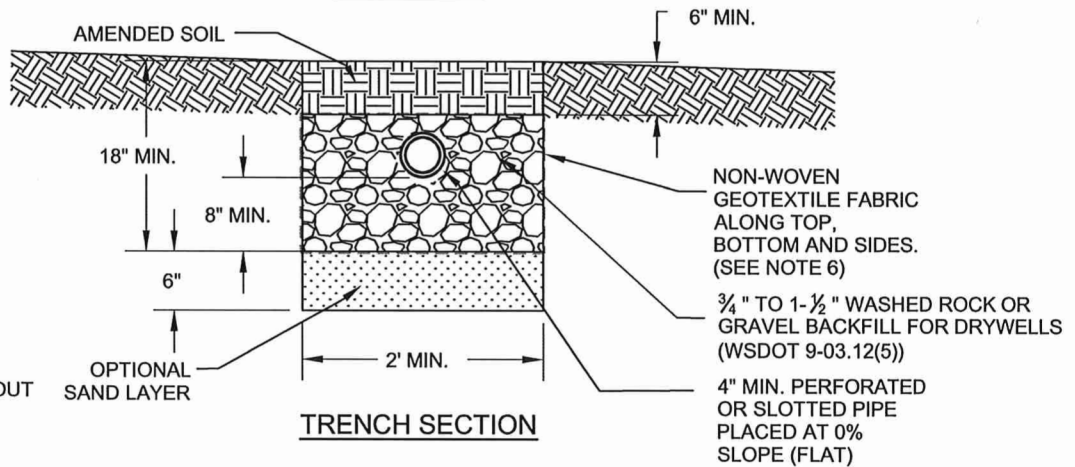

TRENCH SECTION

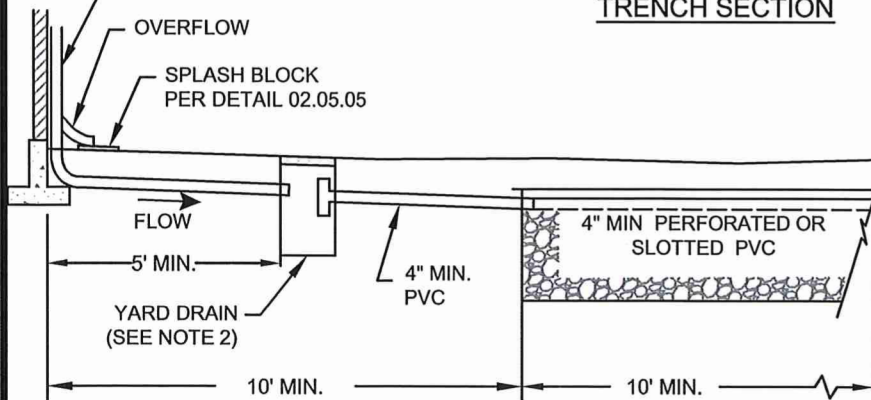

TRENCH PROFILE

NOTES:

1. ROOF DRAIN SHALL PROVIDE POSITIVE FLOW FROM DOWNSPOUTS (DS) TO YARD DRAINS.
2. YARD DRAINS SHALL BE INSTALLED UPSTREAM OF EACH PERFORATED STUB-OUT IN ACCORDANCE WITH STD DETAIL 02.05.02.
3. TRENCH BOTTOM SHALL BE A MINIMUM OF 1' ABOVE SEASONAL HIGH GROUNDWATER OR IMPERMEABLE SOIL LAYER.
4. TRENCH SHALL BE DESIGNED IN ACCORDANCE WITH SECTION 210.6.
5. TRENCH SHOULD NOT BE INSTALLED UNDER IMPERVIOUS SURFACES.
6. NON-WOVEN GEOTEXTILE TO CONFORM TO WSDOT 9-33.2(1), TABLE 1 AND 2.



**CITY OF  
PUYALLUP**  
PUBLIC WORKS AND  
DEVELOPMENT ENGINEERING

APPROVED FOR PUBLICATION



**PERFORATED STUB-OUT  
CONNECTION**

SCALE:  
NTS

DATE REVISED:  
05/19/2023

CITY  
STANDARD

FILE NAME: Y:\Shared\Drawings\City Standards\2018\02 - PART 2 -  
STANDARD DETAILS\CAD\200\02.05.07

02.05.07