

Update Architectural Plans to match Civil Plan Improvements. [Site Plan, A1.1]

The applicant shall request a sediment control and erosion inspection with a City Engineering Inspector through the CityView portal least 48 hours in advance of job start. See City Standards 02.03.02 & 05.02.01

Prior to starting site work, request an erosion and sediment inspection through the CityView portal.

Call Before You Dig. It's the law. Locate all utilities prior to starting work. Dial 811 or call 1-800-424-5555.

Sediment control and erosion procedures shall be practiced eliminating and preventing off site damage. Stormwater runoff originating upgrade of exposed areas shall be controlled to reduce erosion and sediment loss during the period of exposure. See civil permit PRCCP20231620 for specifications

Roof downspout control is required. Steps shall be taken to prevent drainage onto adjacent lots. See civil permit PRCCP20231620 for specifications

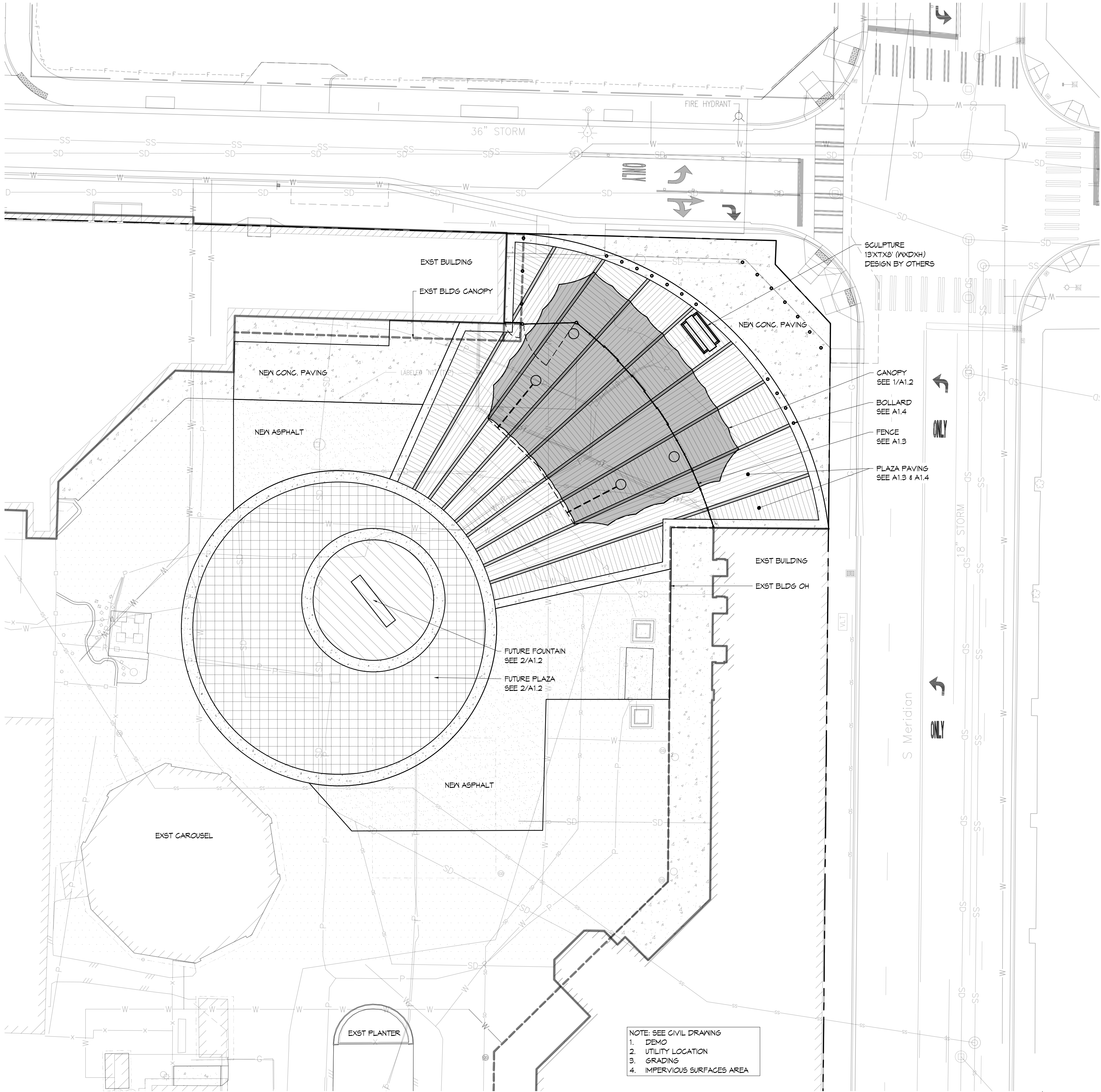

NOTE: SEE CIVIL DRAWING  
1. DEMO  
2. UTILITY LOCATION  
3. GRADING  
4. IMPERVIOUS SURFACES AREA

**SITE PLAN - OVERALL**  
(11x17) SCALE: 1" = 40'-0"  
(22x34) SCALE: 1" = 20'-0"

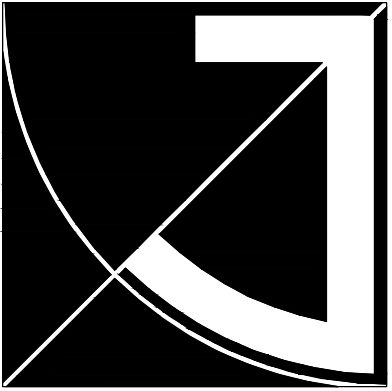

**JEFF BROWN  
ARCHITECTURE**

JEFF BROWN ARCHITECTURE  
12181 C STREET SOUTH  
TACOMA, WA 98444

**PROJECT LEAD**  
JEFFREY E. BROWN  
253.606.8324  
jeff@jeffbrowncarchitecture.com

37.4 REGISTERED ARCHITECT  
JEFFREY E. BROWN  
STATE OF WASHINGTON

PROJECT NAME/ADDRESS

**WASHINGTON STATE FAIR  
GOLD GATE - CANOPY**  
110 9TH AVE SW  
PUYALLUP, WA 98371

DRAWING TYPE

**PERMIT  
DOCUMENTS**

ISSUE DATE	ISSUE DESCRIP.	NO.
11.14.23	PERMIT	

SHEET TITLE

**SITE PLAN  
OVER ALL**

SHEET #

**A1.1**