

APPROVED PLAN
CITY OF PUYALLUP
PLANNING DIVISION

APPROVED BY: ARamirez

DATE: 01/09/2024

CASE NO.: PRSG20231751

CONDITIONS:

Approval of submitted plans is not an approval of omissions or oversights by this office or non compliance with any applicable regulations of local government. The contractor is responsible for making sure that the building complies with all applicable codes and regulations of the local government.

The approved construction plans, documents, and all engineering must be posted on the job at all inspections in a visible and readily accessible location.

Full sized legible color plans are required to be provided by the permittee on site for inspection.

City of Puyallup
Building
REVIEWED
FOR
COMPLIANCE

BSnowden
01/19/2024
11:03:58 AM



1 PHOTO INLAY PROPOSED SIGNAGE - WEST ELEVATION
SCALE: N/A

A1

City of Puyallup Development & Permitting Services ISSUED PERMIT						
<table border="1"> <tr> <td>Building</td> <td>Planning</td> </tr> <tr> <td>Engineering</td> <td>Public Works</td> </tr> <tr> <td>Fire</td> <td>Traffic</td> </tr> </table>	Building	Planning	Engineering	Public Works	Fire	Traffic
Building	Planning					
Engineering	Public Works					
Fire	Traffic					

PRSG20231751



ionsigngroup.com

© COPYRIGHT 2023 ION SIGN GROUP - THIS DESIGN IS PROPERTY OF ION SIGN GROUP. ANY USE OF THIS DESIGN OR SALIENT ELEMENTS BY OTHERS WITHOUT WRITTEN PERMISSION FROM ION SIGN GROUP IS PROHIBITED TO THE FULLEST EVENT OF THE LAW. ANY UNAUTHORIZED USE OF THIS DESIGN WILL RESULT IN A MINIMUM CHARGE OF \$1000 OR 25% VALUE OF SIGN(S) WHICHEVER IS GREATER.

client Petcare Clinic
address 4621 S. Meridian, Suite A
city, state, zip Puyallup, WA

project manager Michael Tilton
designer AM
date 12.06.2023 **revision** 1

PAGE
1



1 > PHOTO INLAY PROPOSED SIGNAGE - SOUTH ELEVATION
SCALE: N/A

A2

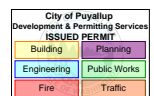

PRSG20231751



ionsigngroup.com

© COPYRIGHT 2023 ION SIGN GROUP - THIS DESIGN IS PROPERTY OF ION SIGN GROUP. ANY USE OF THIS DESIGN OR SALIENT ELEMENTS BY OTHERS WITHOUT WRITTEN PERMISSION FROM ION SIGN GROUP IS PROHIBITED TO THE FULLEST EVENT OF THE LAW. ANY UNAUTHORIZED USE OF THIS DESIGN WILL RESULT IN A MINIMUM CHARGE OF \$1000 OR 25% VALUE OF SIGN(S) WHICHEVER IS GREATER.

client Petcare Clinic
address 4621 S. Meridian, Suite A
city, state, zip Puyallup, WA

project manager Michael Tilton
designer AM
date 12.06.2023 **revision** 1

PAGE
2

FABRICATION SPECIFICATIONS

1	PAN CHANNEL	LIGHTING	WHITE LED
		FACE COLOR	WHITE ACRYLIC
		VINYL COLOR #1	3M #36 BLUE
		VINYL COLOR #2	3M #210 WHITE PERF w/ PMS #281 PAINT ON FACE
		VINYL COLOR #3	3M #156 VIVID GREEN
		TRIM CAP COLOR	WHITE
		TRIM CAP SIZE	1"
		RETURN COLOR	PRE-PAINTED WHITE
		RETURN DEPTH	3"

GENERAL NOTES

SIGNS A1 & A2 - FABRICATE & INSTALL TWO SETS OF 2'-6" X 16' SF INT/ILLUM. PAN CHANNEL LETTERS/LOGO ON SOUTH & WEST ELEVATIONS WOOD BUILDING FASCIA. REMOVE & SCRAP EXISTING "PIER 1 IMPORTS" SIGN ON WEST ELEVATION.

REVISIONS

- 1) X
- 2)
- 3)
- 4)

COLOR KEY

V1	VINYL	3M #36 BLUE
V2	VINYL/PAINT	#210 WHITE PERF w #281C BLUE PAINTED FACE
V3	VINYL	3M #156 VIVID GREEN

NOTE: THE COLORS DEPICTED ON THIS RENDERING REPRESENT COLOR INTENT ONLY AND MAY NOT MATCH ACTUAL COLORS ON FINISHED PRODUCT. PLEASE REFER TO COLOR CALL-OUTS AND SPECIFIED VENDOR SAMPLES FOR APPROVED COLOR SPECIFICATIONS.

APPROVALS

SALES REP: _____

CUSTOMER: _____

LANDLORD: _____

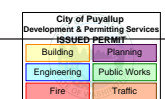

PRSG20231751

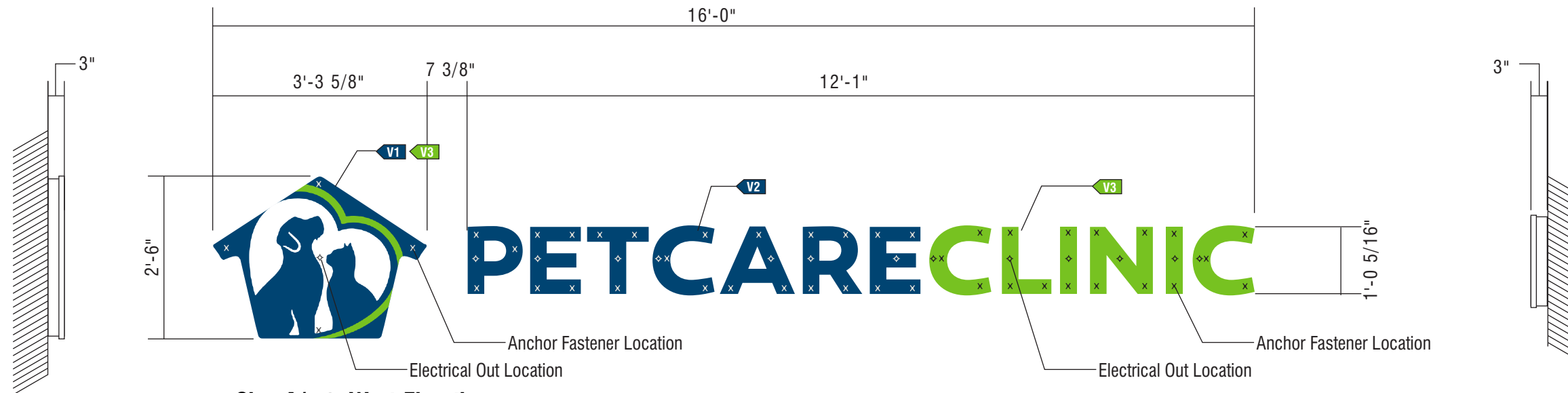

Sign A1 @ West Elevation

1 > ILLUMINATED CHANNEL LETTER SIGN 40SQ. FT.
 QUANTITY: 1 SCALE: 1/2" = 1'-0"



2 > NIGHT VIEW FRONT ELEVATION
 SCALE: N/A

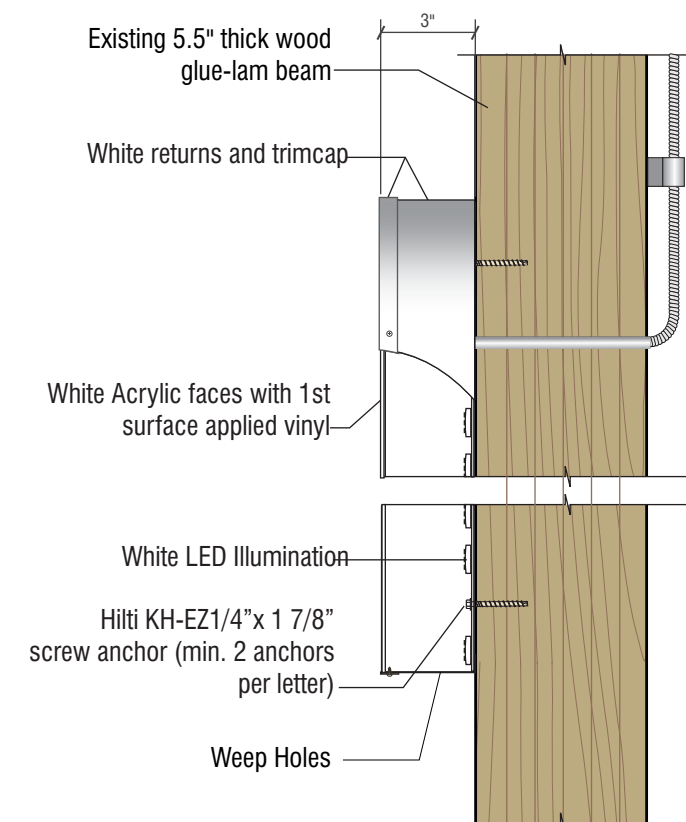

3 > Channel Logo Section
 SCALE: NTS

FABRICATION SPECIFICATIONS

1	PAN CHANNEL	LIGHTING	WHITE LED
		FACE COLOR	WHITE ACRYLIC
		VINYL COLOR #1	3M #36 BLUE
		VINYL COLOR #2	3M #210 WHITE PERF w/ PMS #281 PAINT ON FACE
		VINYL COLOR #3	3M #156 VIVID GREEN
		TRIM CAP COLOR	WHITE
		TRIM CAP SIZE	1"
		RETURN COLOR	PRE-PAINTED WHITE
		RETURN DEPTH	3"

GENERAL NOTES

SIGNS A1 & A2 - FABRICATE & INSTALL TWO SETS OF 2'-6" X 16' SF INT/ILLUM. PAN CHANNEL LETTERS/LOGO ON SOUTH & WEST ELEVATIONS WOOD BUILDING FASCIA. REMOVE & SCRAP EXISTING "PIER 1 IMPORTS" SIGN ON WEST ELEVATION.

REVISIONS

- 1) X
- 2)
- 3)
- 4)

COLOR KEY

V1	VINYL	3M #36 BLUE
V2	VINYL/PAINT	#210 WHITE PERF w #281C BLUE PAINTED FACE
V3	VINYL	3M #156 VIVID GREEN

NOTE: THE COLORS DEPICTED ON THIS RENDERING REPRESENT COLOR INTENT ONLY AND MAY NOT MATCH ACTUAL COLORS ON FINISHED PRODUCT. PLEASE REFER TO COLOR CALL-OUTS AND SPECIFIED VENDOR SAMPLES FOR APPROVED COLOR SPECIFICATIONS.

APPROVALS

SALES REP: _____

CUSTOMER: _____

LANDLORD: _____

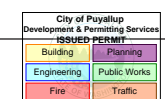

PRSG20231751

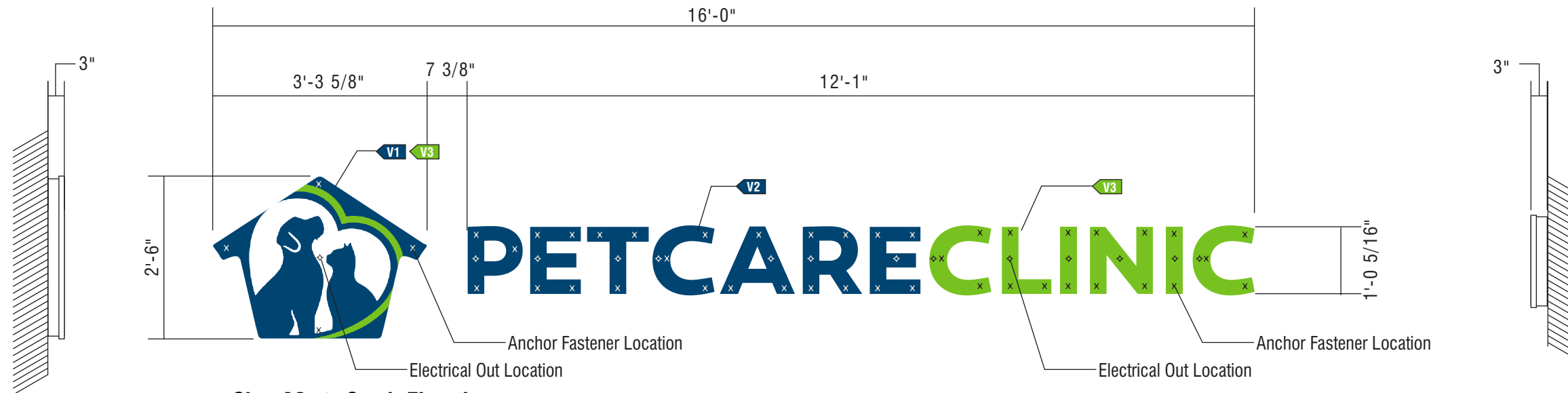

Sign A2 @ South Elevation

1 > ILLUMINATED CHANNEL LETTER SIGN 40SQ. FT.
 QUANTITY: 1 SCALE: 1/2" = 1'-0"



2 > NIGHT VIEW FRONT ELEVATION
 SCALE: N/A

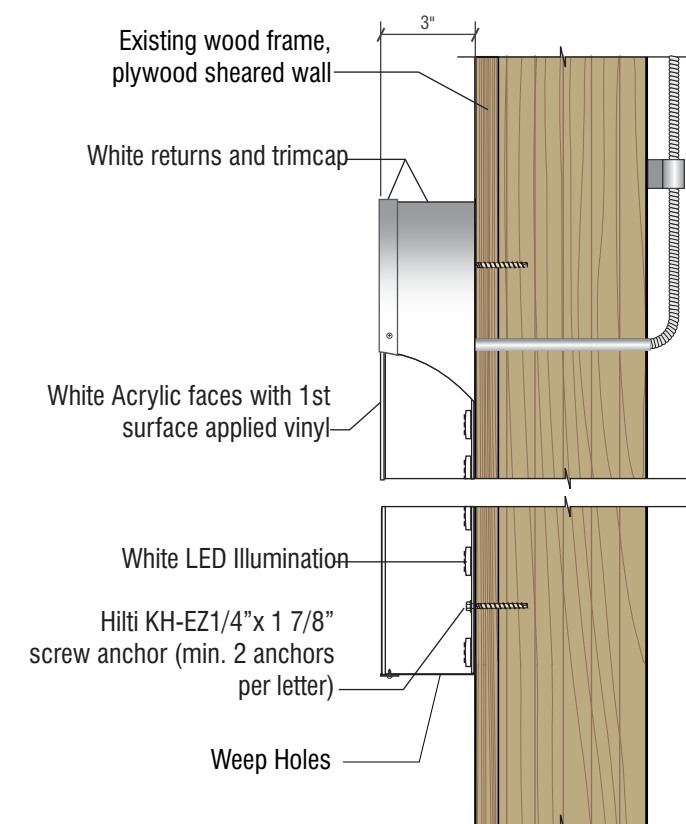

3 > Channel Logo Section
 SCALE: NTS

FABRICATION SPECIFICATIONS

1	TENANT FACE	MATERIAL	POLYCARBONATE, LEXAN
		FACE COLOR	WHITE
		VINYL COLOR #1	3M #36 BLUE
		VINYL COLOR #2	3M #156 VIVID GREEN
		INSTALL	EXISTING MONUMENT

GENERAL NOTES

SIGNS B - FABRICATE & INSTALL TWO EACH NEW 4' X 9' FLAT LEXAN FACES WITH VINYL DECORATION IN EXISTING DF INT/ILLUM. POLE SIGN CABINET. REMOVE & SCRAP EXISTING FACES.

PROVIDE LABOR AND MATERIALS TO RETRO-FIT EXISTING 4' X 9' POLE SIGN CABINET TO NEW LED LIGHTING.

PROVIDE LABOR AND MATERIALS TO PAINT EXISTING SIGN CABINET AND POLE COVER PAINTED SHERWIN WILLIAMS SW #7069 IRON ORE.

REVISIONS

- 1) X
- 2)
- 3)
- 4)

COLOR KEY

V1	VINYL	3M #36 BLUE
V3	VINYL	3M #156 VIVID GREEN
P1	PAINT	SW #7069 IRON ORE

NOTE: THE COLORS DEPICTED ON THIS RENDERING REPRESENT COLOR INTENT ONLY AND MAY NOT MATCH ACTUAL COLORS ON FINISHED PRODUCT. PLEASE REFER TO COLOR CALL-OUTS AND SPECIFIED VENDOR SAMPLES FOR APPROVED COLOR SPECIFICATIONS.

APPROVALS

SALES REP: _____

CUSTOMER: _____

LANDLORD: _____

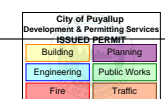

PRSG20231751



2) PHOTO INLAY PROPOSED SIGNAGE
SCALE: N/A



Sign A

1) REPLACEMENT FACES FOR EXISTING D/F PYLON
QUANTITY: 2

SCALE: 1.2" = 1'-0"