

# TEMPORARY TRAFFIC CONTROL PLAN

PRFUP20240015

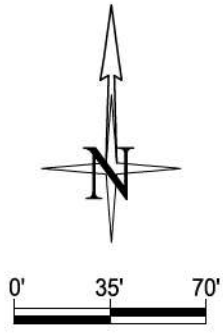

PRINT ON  
11X17" SHEETS ONLY

- Traffic control devices shall be 28 inch retro-reflective cones.
- Taper length equals width of offset times speed limit squared divided by 60.
- Sign spacing shall be 100 feet when speed limit is 30 mph or less.
- Sign spacing shall be 350 feet when speed limit is greater than 30 mph.
- Distance between cones equals speed limit in unit-feet.
- Travel lane width must be a minimum of 11 feet at all times.
- All flaggers and spotters shall remain in radio contact at all times.

Lane Taper Length =  $\frac{(\text{width of taper offset}) \times (\text{speed limit})^2}{(\text{width of taper typically measured as width of lane})}$

**NIGHT WORK REQUIRED. CLOSURE ALLOWED:**  
Sunday - Thursday  
9PM - 5AM  
Call communications center at 253-287-4456 on night of closure. Request a job start inspection through the CityView portal and leave a message for the inspectors by calling 253-435-3650 at least 48 hours in advance of job start.

The applicant shall notify all residents and businesses within 300 feet of the work area 48 hours in advance of start date by distributing informational door hangers, displaying work on message boards, or on signs posted visibly along the right-of-way. The City-issued permit packet shall be posted at the job site and available to inspectors at all times.

The applicant shall coordinate redundant traffic control devices with other traffic control plans authorized near this site.

No disruption of signal timing allowed at signalized intersection unless the traffic control plan depicts a uniformed police officer at the intersection.

When shifting traffic into a turn lane, use of double cones is required. Traffic device spacing shall be half distance for opposing traffic devices.

Work shall immediately cease in the work zone for a pedestrian spotter, available at all times, to escort pedestrians around the work area.

#525

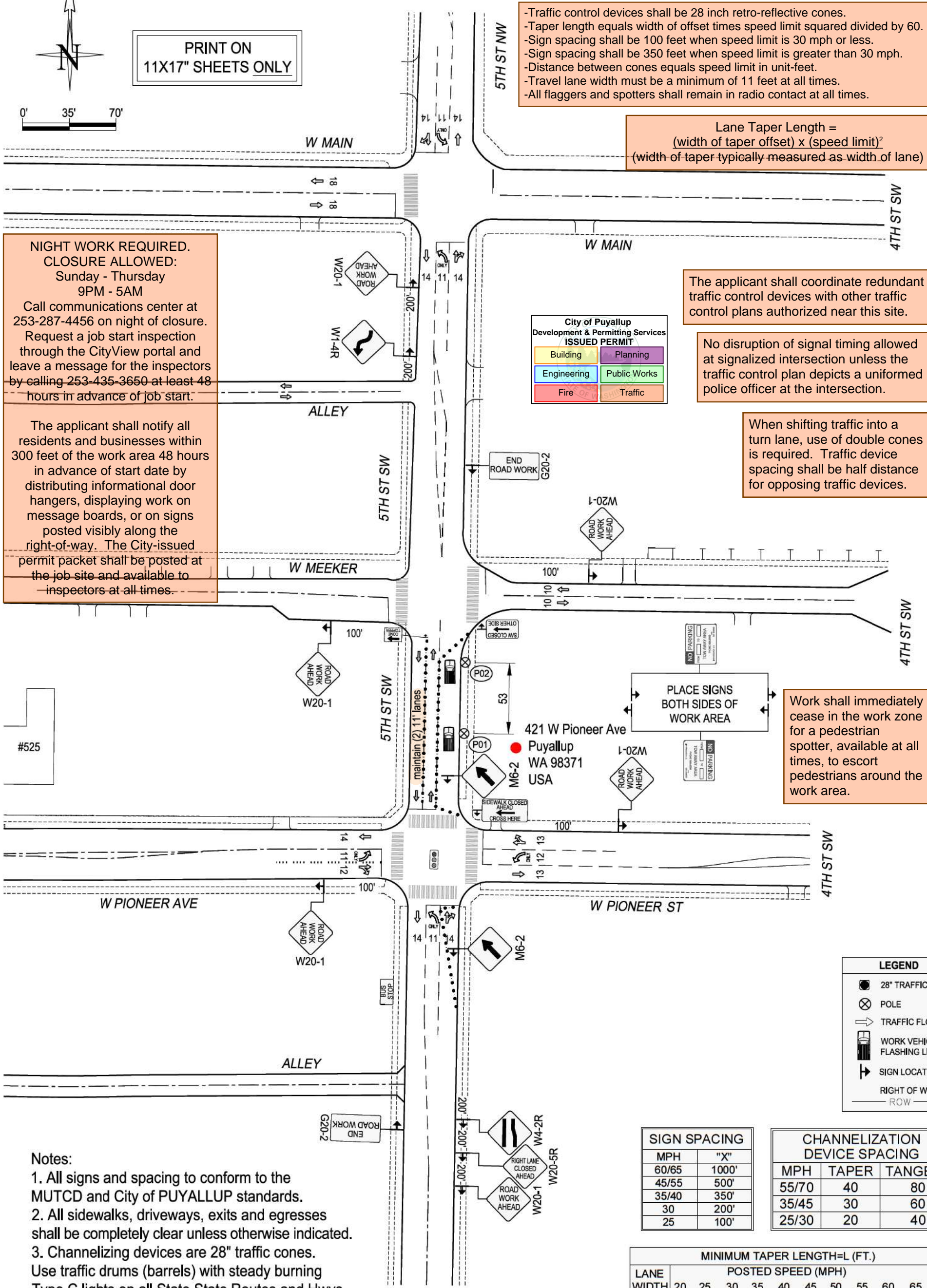

City of Puyallup  
Development & Permitting Services  
ISSUED PERMIT

|             |              |
|-------------|--------------|
| Building    | Planning     |
| Engineering | Public Works |
| Fire        | Traffic      |

**LEGEND**

- 28" TRAFFIC CONE
- ⊗ POLE
- TRAFFIC FLOW
- 🚚 WORK VEHICLE/ FLASHING LIGHTS
- ➔ SIGN LOCATION
- RIGHT OF WAY

**SIGN SPACING**

| MPH   | "X"   |
|-------|-------|
| 60/65 | 1000' |
| 45/55 | 500'  |
| 35/40 | 350'  |
| 30    | 200'  |
| 25    | 100'  |

**CHANNELIZATION DEVICE SPACING**

| MPH   | TAPER | TANGENT |
|-------|-------|---------|
| 55/70 | 40    | 80      |
| 35/45 | 30    | 60      |
| 25/30 | 20    | 40      |

**MINIMUM TAPER LENGTH=L (FT.)**

| LANE WIDTH | POSTED SPEED (MPH) |     |     |     |     |     |     |     |     |     |     |
|------------|--------------------|-----|-----|-----|-----|-----|-----|-----|-----|-----|-----|
|            | 20                 | 25  | 30  | 35  | 40  | 45  | 50  | 55  | 60  | 65  | 70  |
| 10         | 70                 | 105 | 150 | 205 | 270 | 475 | 500 | 550 | -   | -   | -   |
| 11         | 75                 | 115 | 165 | 225 | 295 | 495 | 550 | 605 | 660 | -   | -   |
| 12         | 80                 | 125 | 180 | 245 | 320 | 540 | 600 | 660 | 720 | 780 | 840 |

- Notes:**
- All signs and spacing to conform to the MUTCD and City of PUYALLUP standards.
  - All sidewalks, driveways, exits and egresses shall be completely clear unless otherwise indicated.
  - Channelizing devices are 28" traffic cones. Use traffic drums (barrels) with steady burning Type C lights on all State State Routes and Hwys.
  - Sign size can be a minimum of 36" x 36" and shall not obstruct pedestrian access.
  - Crew is required to leave a minimum of 11' for traveling lane width.
  - Alert affected residents and businesses.
  - ~~Work to take place between 9 a.m. and 4 p.m. unless otherwise specified. All work for arterials and major roadways will be from 9 a.m. to 3 p.m.~~

**PSE PUGET SOUND ENERGY**

Designer:  
Yuriy Bashtovoy  
(425)424-6603  
Yuriy.Bashtovoy@PSE.com

Project Address:  
1326 W PIONEER AVE, Puyallup, WA 98371

Puget Sound Energy  
Traffic Control Supervisor:  
Gregory Harwood  
Card No. 012238  
Card Exp. 09/30/2023  
gregory.harwood@pse.com  
(425)424-6425  
*Gregory Harwood*

04/27/2023  
Job #  
186061635

REV  
2

Page 1 OF 2



# TEMPORARY TRAFFIC CONTROL PLAN

PRFUP20240015

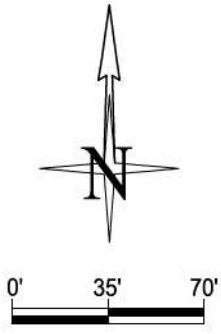

PRINT ON  
11X17" SHEETS ONLY

**NIGHT WORK REQUIRED.**  
**CLOSURE ALLOWED:**  
 Sunday - Thursday  
 9PM - 5AM

Call communications center at 253-287-4456 on night of closure. Request a job start inspection through the CityView portal and leave a message for the inspectors by calling 253-435-3650 at least 48 hours in advance of job start.

The applicant shall notify all residents and businesses within 300 feet of the work area 48 hours in advance of start date by distributing informational door hangers, displaying work on message boards, or on signs posted visibly along the right-of-way. The City-issued permit packet shall be posted at the job site and available to inspectors at all times.

The applicant shall coordinate redundant traffic control devices with other traffic control plans authorized near this site.

Lane Taper Length =  $\frac{(\text{width of taper offset}) \times (\text{speed limit})^2}{(\text{width of taper typically measured as width of lane})}$

- Traffic control devices shall be 28 inch retro-reflective cones.
- Taper length equals width of offset times speed limit squared divided by 60.
- Sign spacing shall be 100 feet when speed limit is 30 mph or less.
- Sign spacing shall be 350 feet when speed limit is greater than 30 mph.
- Distance between cones equals speed limit in unit-feet.
- Travel lane width must be a minimum of 11 feet at all times.
- All flaggers and spotters shall remain in radio contact at all times.

Work shall immediately cease in the work zone for a pedestrian spotter, available at all times, to escort pedestrians around the work area.

No disruption of signal timing allowed at signalized intersection unless the traffic control plan depicts a uniformed police officer at the intersection.

When shifting traffic into a turn lane, use of double cones is required. Traffic device spacing shall be half distance for opposing traffic devices.

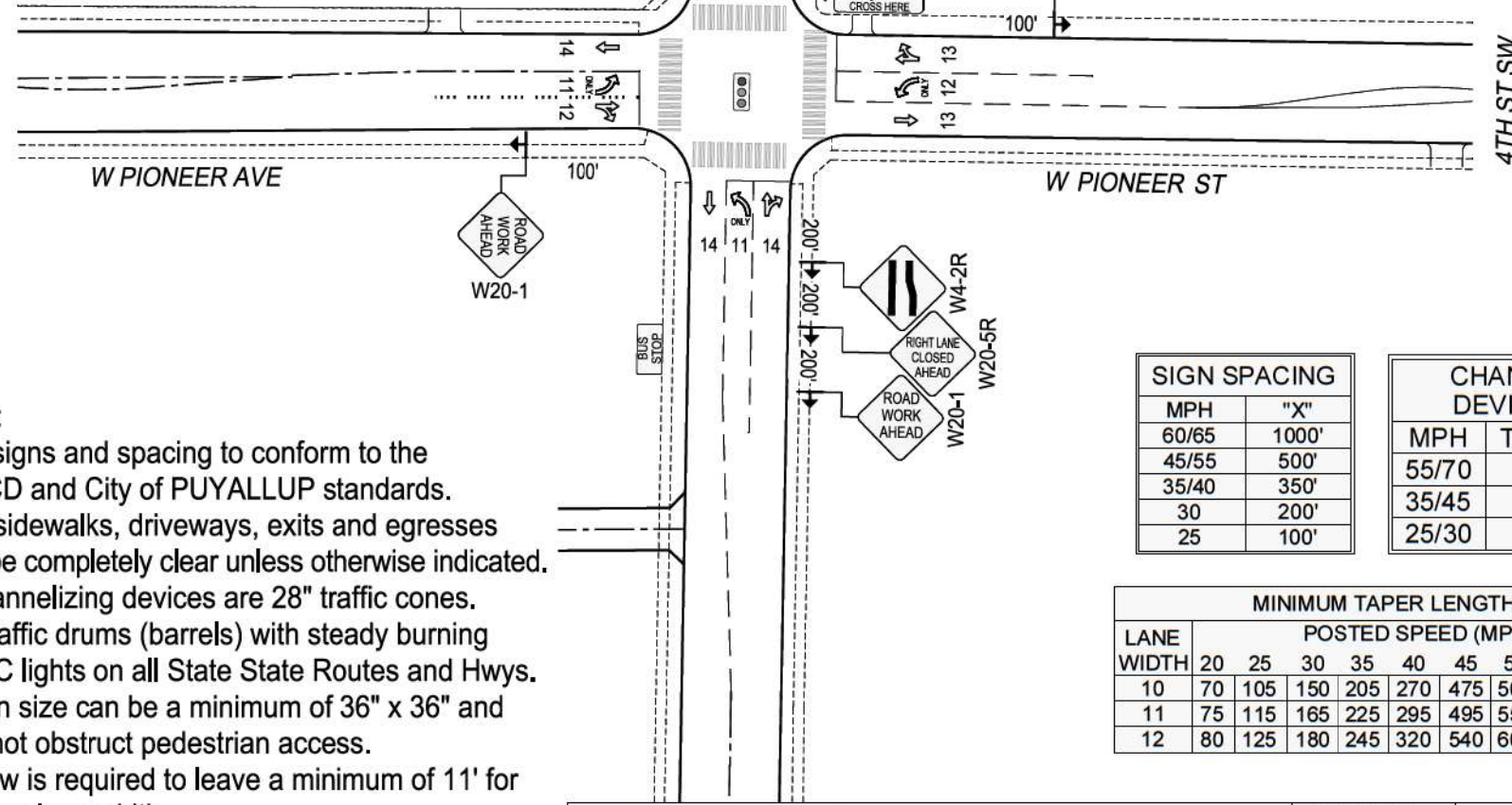

- Notes:
1. All signs and spacing to conform to the MUTCD and City of PUYALLUP standards.
  2. All sidewalks, driveways, exits and egresses shall be completely clear unless otherwise indicated.
  3. Channelizing devices are 28" traffic cones. Use traffic drums (barrels) with steady burning Type C lights on all State State Routes and Hwys.
  4. Sign size can be a minimum of 36" x 36" and shall not obstruct pedestrian access.
  5. Crew is required to leave a minimum of 11' for traveling lane width.
  6. Alert affected residents and businesses.
  7. Work to take place between 9 a.m. and 4 p.m. unless otherwise specified. All work for arterials and major roadways will be from 9 a.m. to 3 p.m.

City of Puyallup  
Development & Permitting Services  
ISSUED PERMIT

|             |              |
|-------------|--------------|
| Building    | Planning     |
| Engineering | Public Works |
| Fire        | Traffic      |

**LEGEND**

- 28" TRAFFIC CONE
- ⊗ POLE
- TRAFFIC FLOW
- 🚚 WORK VEHICLE/ FLASHING LIGHTS
- 📍 SIGN LOCATION
- RIGHT OF WAY

**SIGN SPACING**

| MPH   | "X"   |
|-------|-------|
| 60/65 | 1000' |
| 45/55 | 500'  |
| 35/40 | 350'  |
| 30    | 200'  |
| 25    | 100'  |

**CHANNELIZATION DEVICE SPACING**

| MPH   | TAPER | TANGENT |
|-------|-------|---------|
| 55/70 | 40    | 80      |
| 35/45 | 30    | 60      |
| 25/30 | 20    | 40      |

**MINIMUM TAPER LENGTH=L (FT.)**

| LANE WIDTH | POSTED SPEED (MPH) |     |     |     |     |     |     |     |     |     |     |
|------------|--------------------|-----|-----|-----|-----|-----|-----|-----|-----|-----|-----|
|            | 20                 | 25  | 30  | 35  | 40  | 45  | 50  | 55  | 60  | 65  | 70  |
| 10         | 70                 | 105 | 150 | 205 | 270 | 475 | 500 | 550 | -   | -   | -   |
| 11         | 75                 | 115 | 165 | 225 | 295 | 495 | 550 | 605 | 660 | -   | -   |
| 12         | 80                 | 125 | 180 | 245 | 320 | 540 | 600 | 660 | 720 | 780 | 840 |

|  |   |                                  |          |
|--|---|----------------------------------|----------|
| <p><b>PUGET SOUND ENERGY</b></p> <p>Designer:<br/>Yuriy Bashtovoy<br/>(425)424-6603<br/>Yuriy.Bashtovoy@PSE.com</p> <p>Project Address:<br/>1326 W PIONEER AVE, Puyallup, WA 98371</p> | Puget Sound Energy<br>Traffic Control Supervisor:<br>Gregory Hanwood<br>Card No. 012238<br>Card Exp. 09/30/2023<br>gregory.hanwood@pse.com<br>(425)424-6425<br><i>Gregory Hanwood</i> | 04/27/2023<br>Job #<br>186061635 | REV<br>2 |
|  | Page 2 OF 2   |                                  |          |