

DRAWING SYMBOLS

ABBREVIATIONS

VICINITY MAP

PROJECT DIRECTORY

SHEET INDEX

H

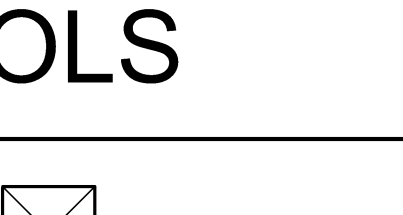
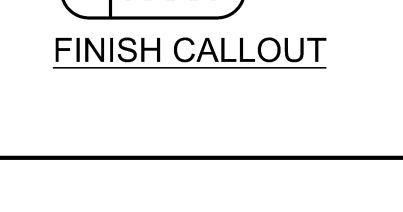
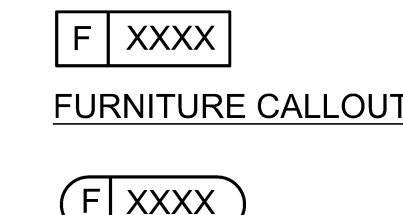
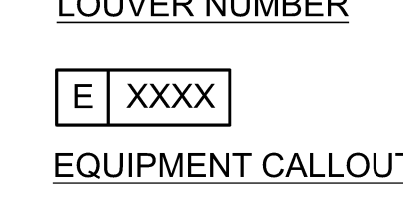
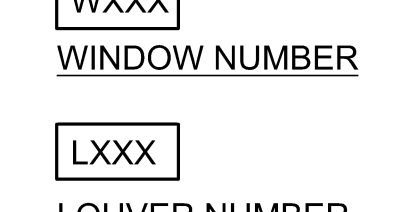
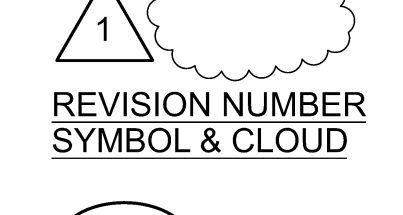
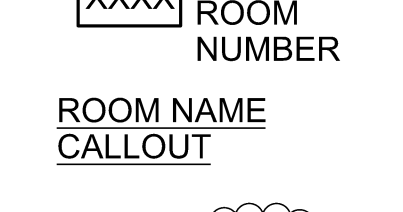
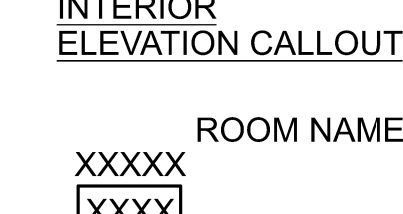
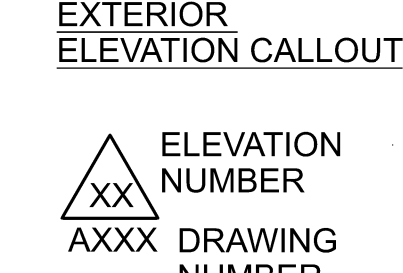
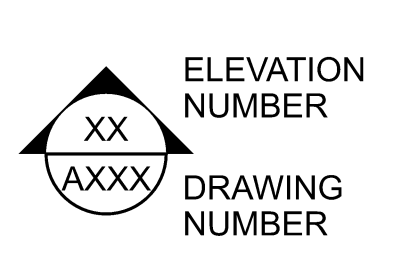
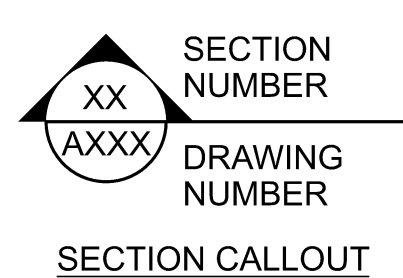
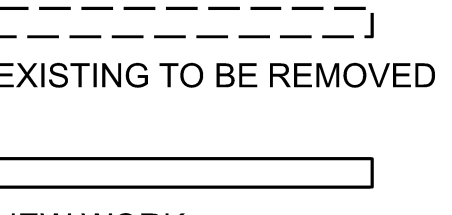
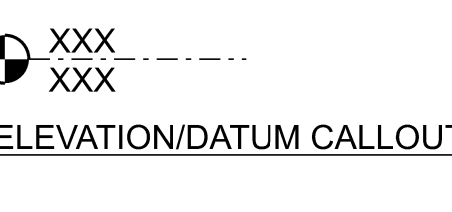
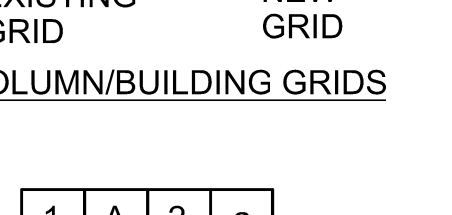
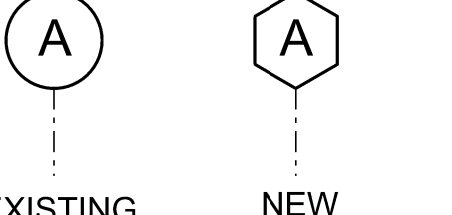
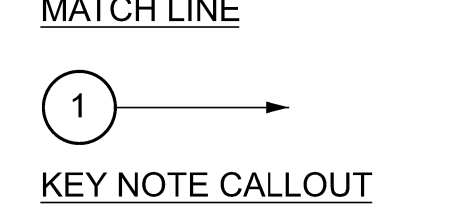
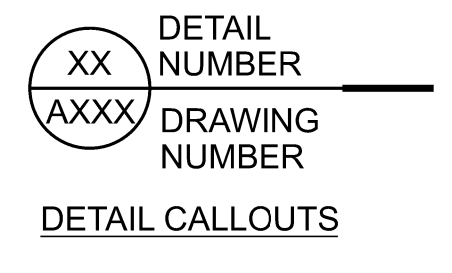
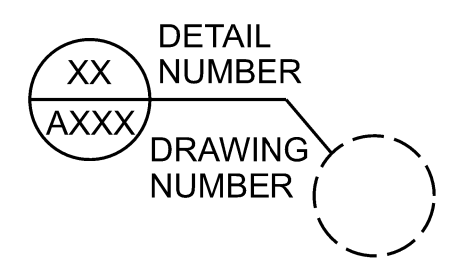

Table of abbreviations: A AMP, AB ANCHOR BOLT, AC ALTERNATING CURRENT, AD ACCESSIBLE, ACP ACOUSTIC CEILING PANEL, etc.

Table of abbreviations: C CABINETS, CAP CAPACITY, CB CATCH BASIN, CE CEMENT, etc.

Table of abbreviations: D DEEP, DECIBELS, DBL DOUBLE, DC DIRECT CURRENT, etc.

Table of abbreviations: E EAST, EXHAUST AIR, EXPANSION BOLT, EXHAUST FAN, etc.

Table of abbreviations: F FARENHEIT, FA FIRE ALARM, FAB FABRICATE, etc.

Table of abbreviations: G GAUGE / GYPSUM ASSOCIATION, GAL GALLON, GALV GALVANIZED, etc.

Table of abbreviations: H HIGH, HB HOSE BIBB, HC HOLLOW CORE, HD HAND DRYER, etc.

Table of abbreviations: I INTERNATIONAL BUILDING CODE, IC INTERCOM, ICN INSIDE DIAMETER, etc.

Table of abbreviations: J JANITOR, JAN JANITOR'S SINK, JT JOINT, K KITCHEN, KV KILO-VOLT, etc.

Table of abbreviations: L LONG, LAM LAMINATE, LAU LAUNDRY, LAV LAVATORY, etc.

Table of abbreviations: M MASONRY, MATL MATERIAL, MAX MAXIMUM, MDF MEDIUM DENSITY FIBERBOARD, etc.

Table of abbreviations: N NORTH, NEC NATIONAL ELECTRIC CODE, NFPA NATIONAL FIRE PROTECTION ASSOCIATION, etc.

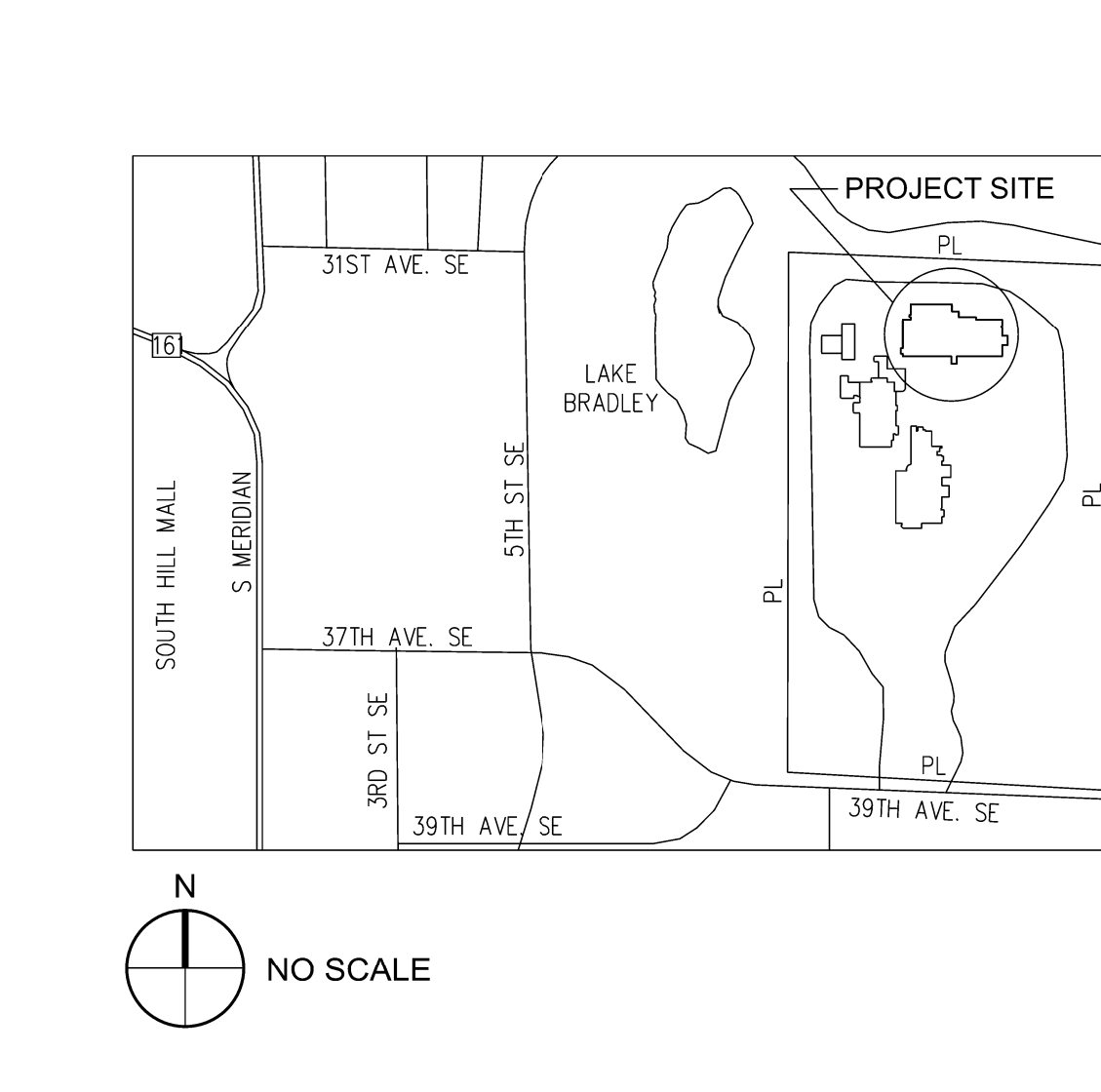

OWNER: BENAROYA CAPITAL, LLC, 9675 SE 36TH STREET, SUITE 115, MERCER ISLAND, WA 98040

ARCHITECT: CASCADE MISSION CRITICAL, LLC, 6210 36TH AVENUE N.E., SEATTLE, WA 98115

STRUCTURAL ENGINEER: QUANTUM CONSULTING ENGINEERS, LLC, 1511 THIRD AVENUE, SUITE 323, SEATTLE, WA 98101

PROJECT INFORMATION

PROJECT ADDRESS: 1023 39TH AVENUE SE, PUYALLUP, WA 98374-2121

LEGAL DESCRIPTION: SECTION 03 TOWNSHIP 19 RANGE 04 QUARTER 43 PARCEL "1" OF ROS 2007-04-30-5001

SCOPE OF WORK

WORK UNDER THIS PERMIT: CONSTRUCT CONCRETE PAD FOUNDATIONS FOR TWO NEW STANDBY GENERATORS.

WORK UNDER SEPARATE PERMITS: GENERATORS, ELECTRICAL, ACCESS PLATFORMS AND STAIRS.

SEPA is required, prior to separate permits and other slab.

PLAN SYMBOLS

D

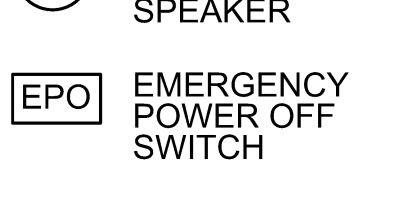
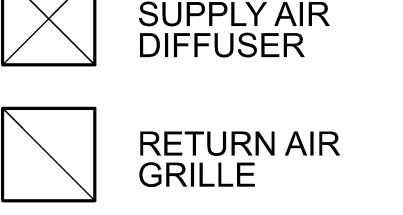
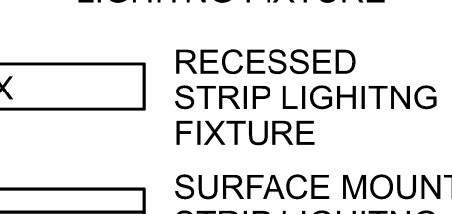
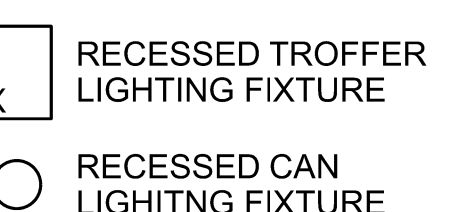
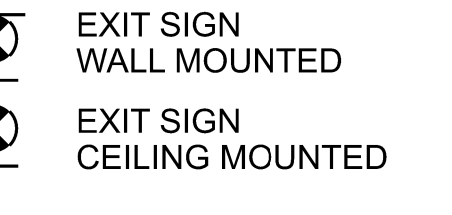
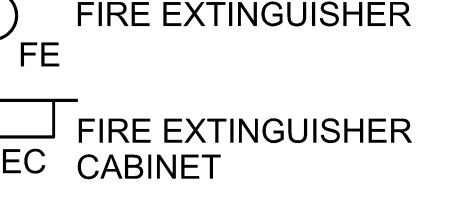

C

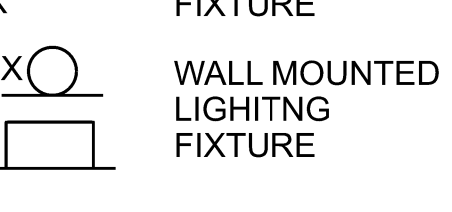
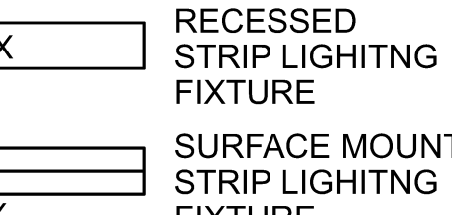

B

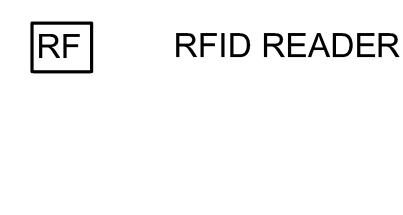
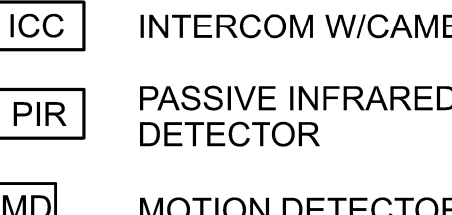
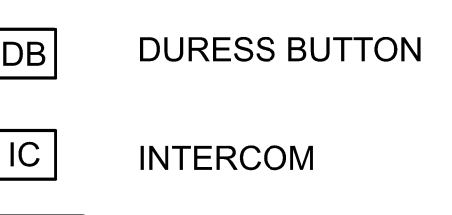
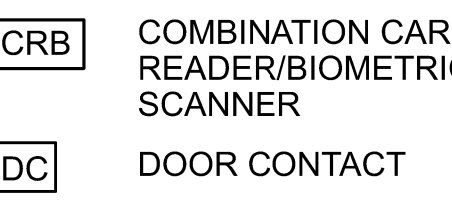
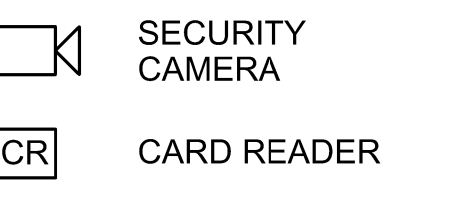

A

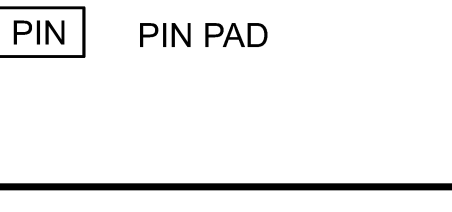
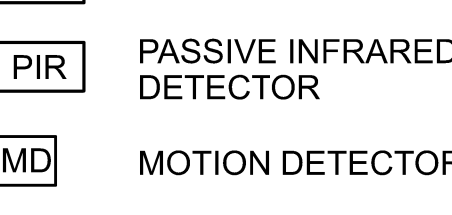

CODE INFORMATION

APPLICABLE CODES: WASHINGTON BUILDING CODE, 2018 EDITION; WASHINGTON FIRE CODE, 2018 EDITION; WASHINGTON MECHANICAL CODE, 2018 EDITION.

LAND USE CODES: PUYALLUP MUNICIPAL CODE; EXISTING ZONING DESIGNATION: MP - BUSINESS PARK; PROPOSED ZONING DESIGNATION: MP - BUSINESS PARK.

BUILDING CODE INFORMATION: BUILDING OCCUPANCY GROUP: TYPE B, DATA CENTER; TYPE OF CONSTRUCTION: TYPE IIA, FULLY SPRINKLERED.

LAND USE CODE INFORMATION: EXISTING SITE AREA: 15.77ACRES.

GENERAL NOTES

- 1. DO NOT SCALE THE DRAWINGS.
2. THE DRAWINGS AND SPECIFICATIONS ARE COMPLEMENTARY. WHAT IS SHOWN ON ONE SHALL BE CONSTRUED TO BE REQUIRED BY BOTH.
3. THE CONTRACTOR SHALL VERIFY ALL FIELD CONDITIONS PRIOR TO COMMENCING ANY WORK.

ARCHITECTURAL

A-001 GENERAL INFORMATION, A-101 OVERLAP SITE PLAN, A-102 ENLARGED SITE PLANS SECTIONS.

STRUCTURAL: S1.0 GENERAL STRUCTURAL NOTES, S1.1 GENERAL STRUCTURAL NOTES, S3.0 DETAILS.

OWNER: BENAROYA CAPITAL, LLC, Centeris Data Centers, 9675 SE 36th St, Suite 115, Mercer Island, WA 98040, +1.253.200.4120

CONSULTANT: LEONARD A. RUFF, REGISTERED ARCHITECT, STATE OF WASHINGTON.

City of Puyallup Development & Permitting Services ISSUED PERMIT. Building, Planning, Engineering, Public Works, Fire, Traffic.

Revision for one pad approved by Ken Cook 2/6/2024, per email. Revision for PRF202317611 uploaded in Documents, Ken Cook.

City of Puyallup Development Engineering APPROVED. See permit conditions. ycharitou 01/17/2024 10:38:57 AM.

City of Puyallup Planning Division APPROVED. See permit conditions. RNBrown 01/24/2024 10:16:11 AM.

City of Puyallup Building REVIEWED FOR COMPLIANCE. BSnowden 01/25/2024 7:56:53 AM.

City of Puyallup Building REVIEWED FOR COMPLIANCE. BSnowden 01/25/2024 7:56:53 AM.

City of Puyallup Building REVIEWED FOR COMPLIANCE. BSnowden 01/25/2024 7:56:53 AM.

City of Puyallup Building REVIEWED FOR COMPLIANCE. BSnowden 01/25/2024 7:56:53 AM.

City of Puyallup Building REVIEWED FOR COMPLIANCE. BSnowden 01/25/2024 7:56:53 AM.

PERMIT REVISION: 01/19/24, PRCTI202317611.

GENERAL NOTES: The approved construction plans, documents, and all engineering must be posted on the job at all inspections in a visible and readily accessible location.

Table with columns: ISSUED/REVISED, DATE. Rows: PERMIT SUBMITTAL (12/20/23), PERMIT REVISION (01/19/24).

PERMIT REVISION: 01/19/24, PRCTI202317611.

GENERAL NOTES: The approved construction plans, documents, and all engineering must be posted on the job at all inspections in a visible and readily accessible location.

A-000

Call before you dig. It's the law. Dial 811 or call 1-800-424-5555.

Approval of submitted plans is not an approval of omissions or oversights by this office or non-compliance with any applicable regulations of local government.

Full sized legible color plans are required to be provided by the permittee on site for inspection.

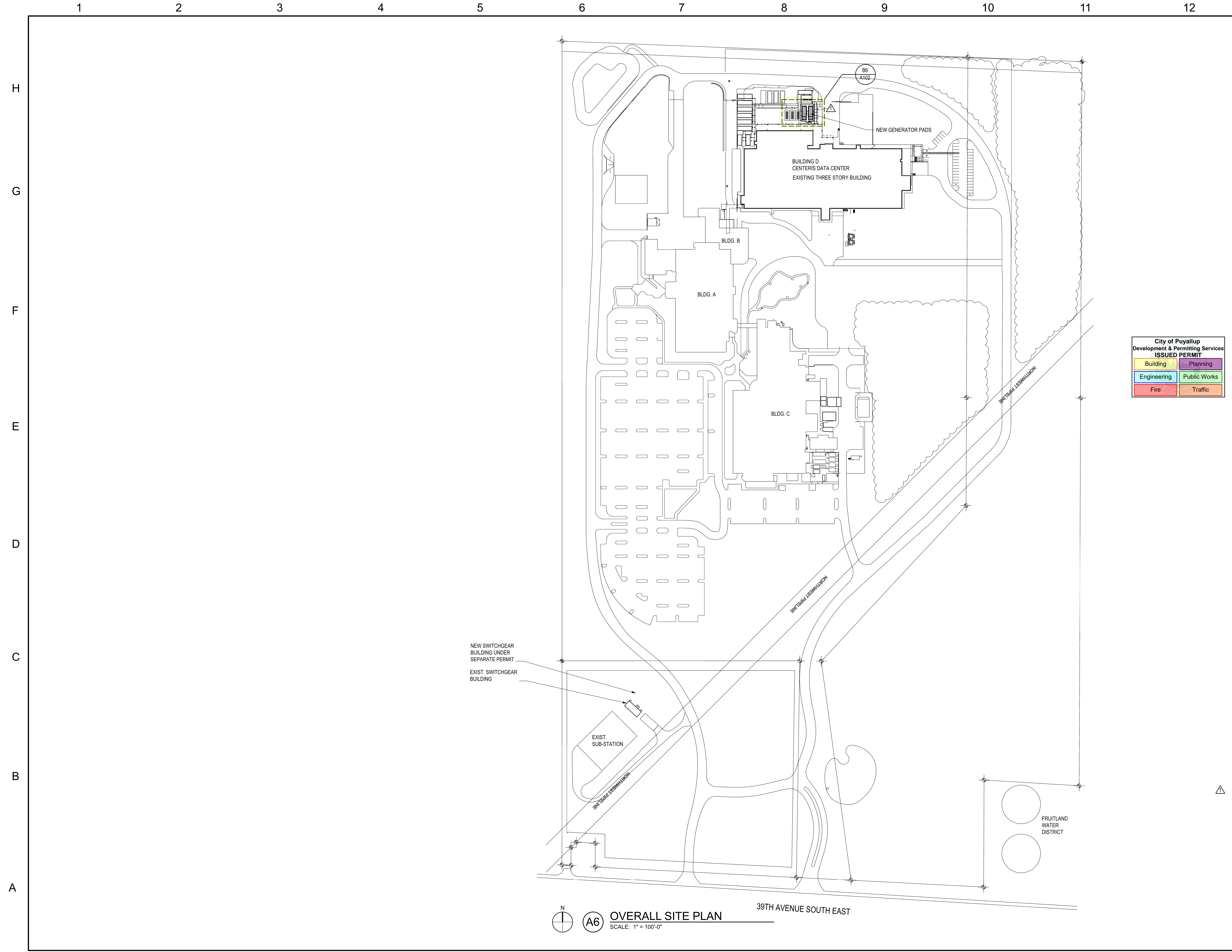

City of Puyallup
Development & Permitting Services
ISSUED PERMIT

Building	Planning
Engineering	Public Works
Fire	Traffic

OWNER:
BENAROYA CAPITAL, LLC
Centeris Data Centers
9675 SE 36th St, Suite 115
Mercer Island, WA 98040
+1.253.200.4120

CONSULTANT:

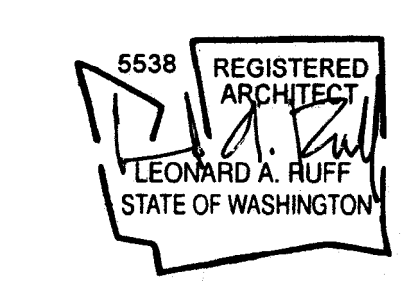

CASCADE MISSION CRITICAL, LLC
Data Center Consulting and Design
6210 36th Avenue N.E. Seattle, WA 98115
P: 206-294-1288 www.cascademissioncritical.com

CENTERIS VOLTAGE PARK
1023 39th Avenue South East
Puyallup, WA 98374-2121
Work Block 01 - Generator Pad Installation

ISSUED/REVISED	DATE
PERMIT SUBMITTAL	12/20/23
PERMIT REVISION	01/19/24

PERMIT REVISION
01/19/24 PRCTI20231761

OVERALL SITE PLAN

A-101

F1 SECTION - GENERATOR PADS
SCALE: 1/4" = 1'-0"

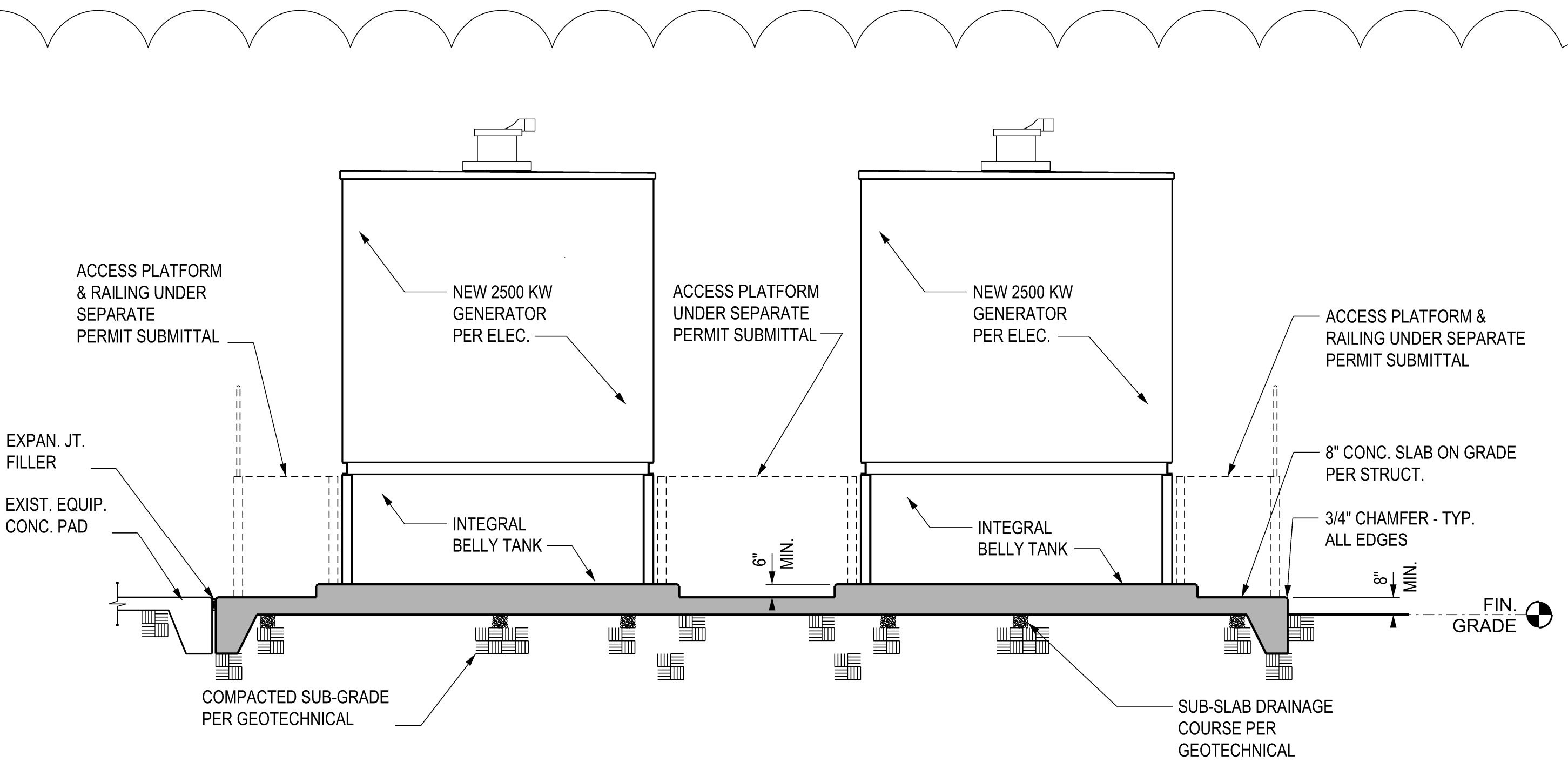

B6 ENLARGED SITE PLAN
SCALE: 1/8" = 1'-0"
TOTAL CONCRETE AREA: 2,293 S.F.

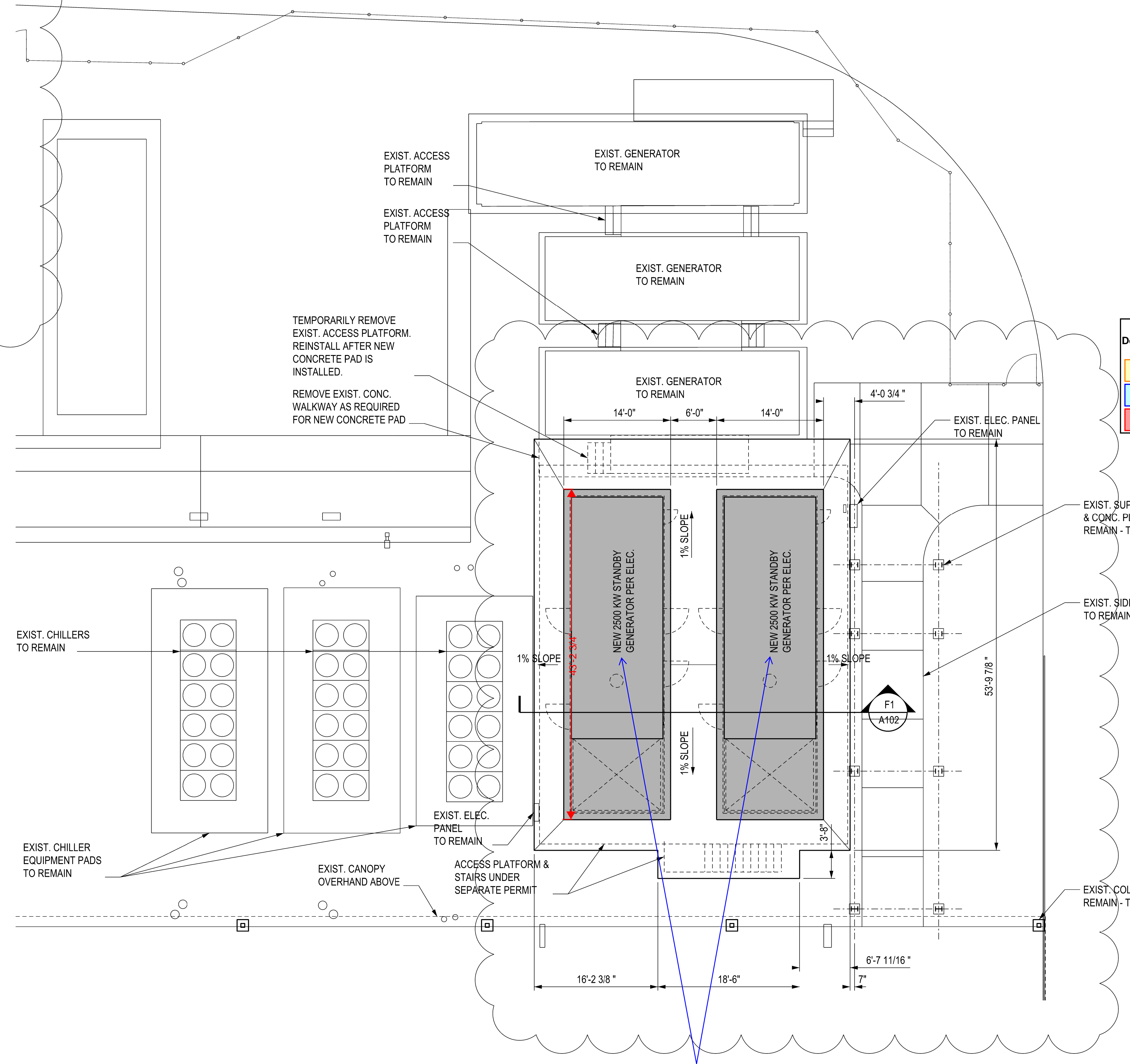

See project scope on cover page. Only construction of two concrete pad foundations permitted. Installation of generators, electrical, access platforms, and stairs under separate permit.

OWNER:
BENAROYA CAPITAL, LLC
Centeris Data Centers
9675 SE 36th St, Suite 115
Mercer Island, WA 98040
+1.253.200.4120

CONSULTANT:

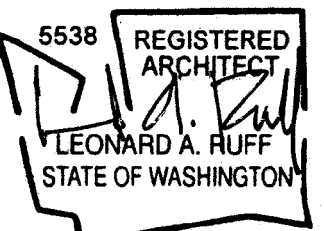

CASCADE MISSION CRITICAL, LLC
Data Center Consulting and Design
6210 36th Avenue N.E. Seattle, WA 98115
P: 206-294-1288 www.cascademissioncritical.com

CENTERIS VOLTAGE PARK
1023 39th Avenue South East
Puyallup, WA 98374-2121
Work Block 01 - Generator Pad Installation

ISSUED/REVISED	DATE
PERMIT SUBMITTAL	12/20/23
PERMIT REVISION	01/19/24

PERMIT REVISION
01/19/24 PRCTI20231761

ENLARGED SITE PLAN SECTION

A-102