

DATE:	DRAWING HISTORY:	EMAIL CONTACT:
10/27/2021	APPROVAL DRAWINGS	Miranda.Tuck@rewnill.com
2/2/2022	FIELD USE DRAWINGS	Miranda.Tuck@rewnill.com

Field Use



**NEW MILLENNIUM**  
BUILDING SERVICES

New Millennium Building Systems, LLC  
6115 County Road 42  
Butler, Indiana 46721 | [www.newmill.com](http://www.newmill.com)  
Phone: (260) 868-6000 | Fax: (260) 868-6001

W.

TAKT

710

CONTRACT

C.O. NUMBER

CUSTOMER

JOB NO. WI21-0027

DRAWING NO. J1.0

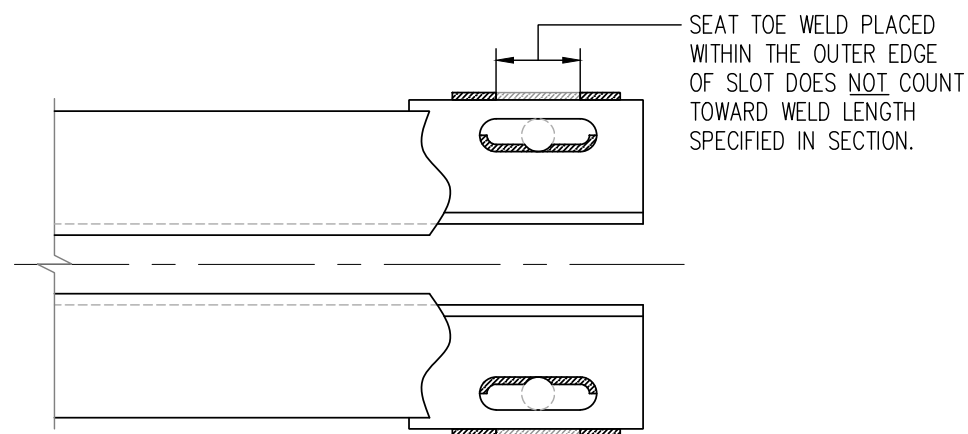

TYPICAL BOLTED JOIST/JOIST GIRDER SEAT  
CONNECTION IF ERECTION BOLTS ARE REMOVED

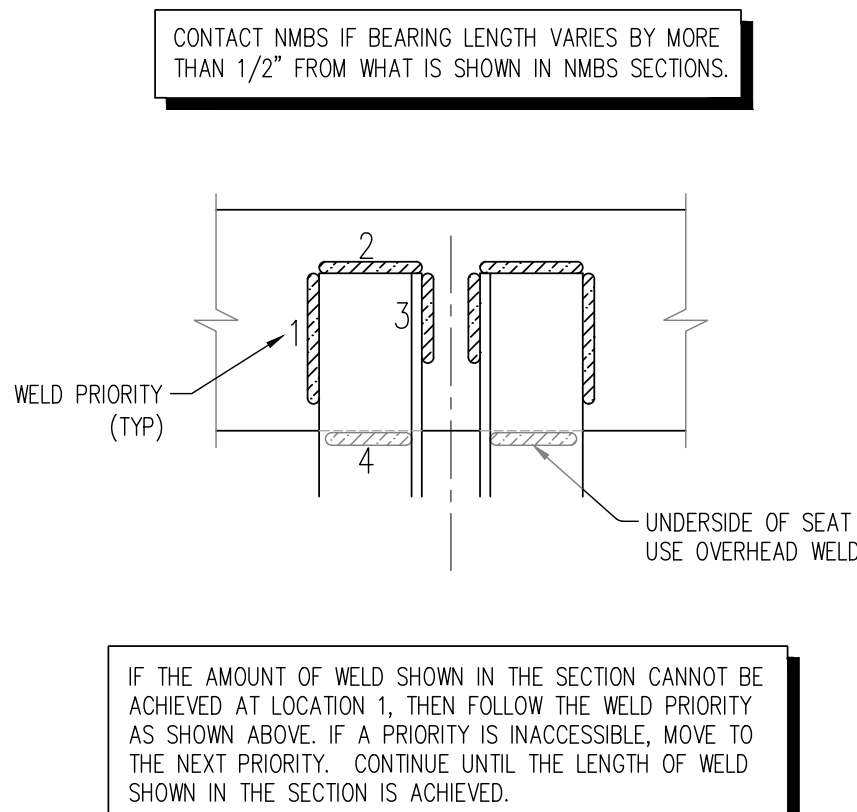

### ALTERNATE WELD LOCATIONS FOR SEAT

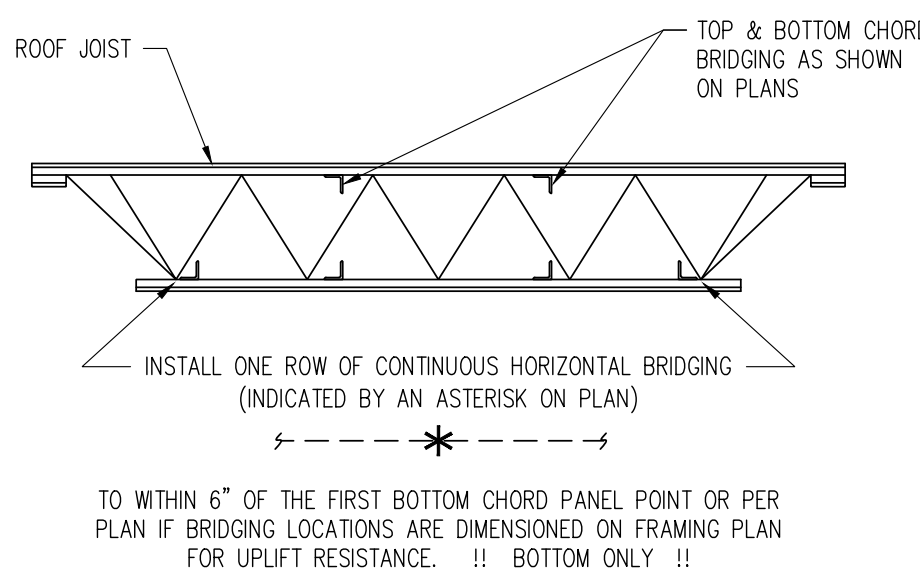

1. SEE TYPICAL BRIDGING DETAILS FOR ADDITIONAL INFORMATION

### TYPICAL UPLIFT BRIDGING DETAIL

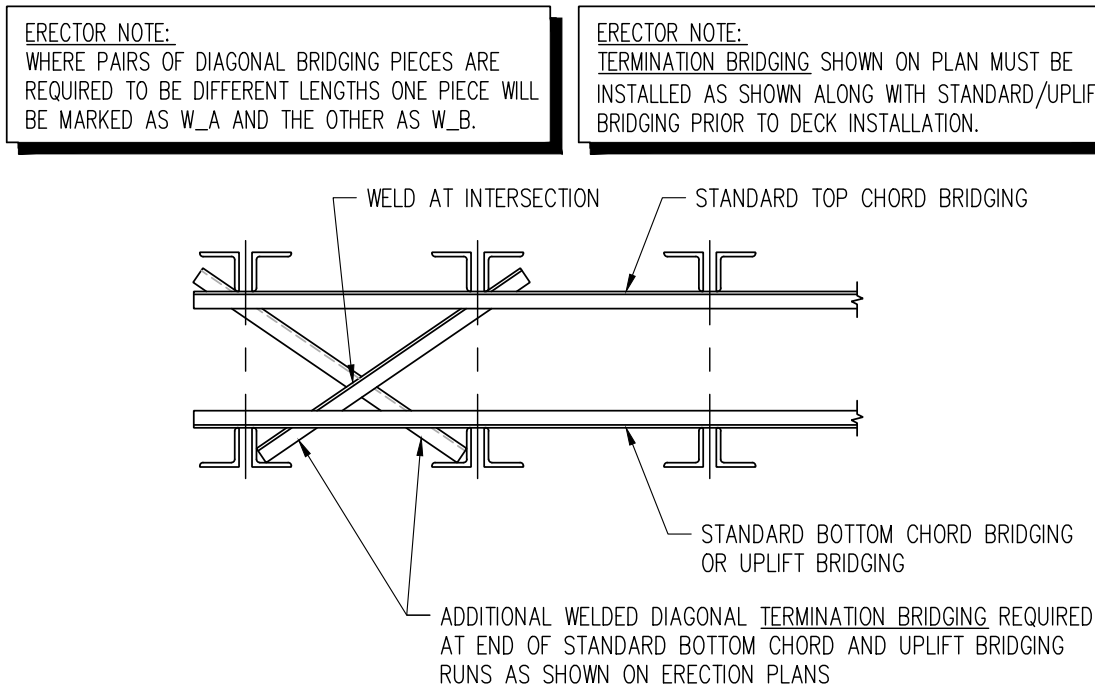

1. FIELD WELD AT CONTACT POINTS PER JOIST INSTALLATION NOTE 7 - BRIDGING.
2. ALL HORIZONTAL BRIDGING SHALL HAVE A STANDARD 3" LAP. FIELD WELD LAPS PER JOIST INSTALLATION NOTE 7 - BRIDGING. WELD INDICATED IS TOTAL WELD REQUIRED.
3. FIELD CUT HORIZONTAL BRIDGING AS REQUIRED FROM 20'-0" LENGTHS. USE ALL DROP

TYPICAL WELDED HORIZONTAL BRIDGING  
TERMINATING @ JOIST

PRCA20231436

**City of Puyallup  
Building  
ACCEPTED**

JMontgomery  
12/29/2023  
2:13:50 PM



City of Puyallup  
Development & Permitting Services  
**ISSUED PERMIT**

## Building

## Engineering

Fire

**submittal review**

This submittal review is only for general compliance with the project design concept. WD Partners assumes no responsibility for correctness of details, dimensions, or compliance with the construction documents and specifications.

No substitutions or deviations may be made from the construction documents and specifications without prior written approval by the Owner or WD Partners. No approval for substitutions/deviation is given or implied by WD Partners' submittal review. Items other than those specified are installed at Contractor's risk and are subject to removal and replacement at Contractor's own expense, regardless of comments made during this review.

<input checked="" type="checkbox"/> REVIEWED/FURNISH AS SUBMITTED	<input type="checkbox"/> REJECTED
<input type="checkbox"/> REVIEWED/FURNISH AS NOTED	<input type="checkbox"/> SUBMIT PROPER ITEM
<input type="checkbox"/> REVIEWED/REVISE AND RESUBMIT AS NOTED	<input type="checkbox"/> NOT REVISED
<input type="checkbox"/> PRELIMINARY REVIEW/NOT FOR CONSTRUCTION	

Corrections or comments made on the submittal do not relieve Contractor from compliance with requirements of the construction documents and specifications. The review of a specific item shall not include approval of an assembly of which the item is a component. The Contractor is responsible for confirming and correlating all quantities and dimensions; selecting fabrication processes and the means, methods, sequences, techniques, and procedures of construction; coordinating its work with that of all other trades; and performing its work in a safe and satisfactory manner.

Carlos Vazquez WALGP0402  
print name project #

Carlos Vazquez      5/3/2022  
signature      date

**WD PARTNERS**  
7007 DISCOVERY BLVD. DUBLIN, OH 43017  
614.634.7000 T 614.634.7777 F

JOB NAME

JOB NO.

DRAWING NO.

1

121	
-----	--



