

# City of Puyallup Traffic Scoping Worksheet

## PROJECT INFORMATION

Project Title: Freeman Logistics Date: 03/27/2023

Applicant Name: Matt Palmer (Representative) Telephone Number: 425-708-8275

Project Description: 494,306 of Industrial Park Year of Occupancy: 2024

Project Location: 49th St E and Freeman Road Parcel Size: 23.70 acres

Proposed Number of Access Point(s): 3 Existing Number of Access Point(s): 5

Land Use	Quantity	ITE Land Use Code	Average Daily Trips	AM Peak Hour Trips*	PM Peak Hour Trips*
Existing Use(s)					
Single-Family Detached	-14 units	210	-132.0	-9.8	-13.2
Proposed Use(s)					
Industrial Park	494,306 SF	130	1,665.8	168.1	168.1
<b>Net New Trips</b>			<b>1,533.8</b>	<b>158.3</b>	<b>154.9</b>
<b>Traffic Impact Fees:</b> Net New PM Peak Hour Trips x \$4,500.00 = \$ <u>697,050.00</u>					

- \* The peak hour project trips shall be rounded to the nearest tenth.
- \* The project trips shall be estimated using the ITE's *Trip Generation*, 11<sup>th</sup> Edition.
- \* Trip generation regression equations shall be used when the R<sup>2</sup> value is 0.70 or greater.
- \* For land uses that do not exist within the ITE's *Trip Generation*, actual field data shall be collected from three local facilities that have similar characteristics to the proposal.
- \* For all single-family units and offices and specialty retail centers smaller than 30,000 SF, use ITE's *Trip Generation*, 11th Edition, average rate.

Identify all intersections that will be affected by 25 new project peak hour trips or more: **20 Trips for Fife**

1. All Arterial/Arterial Roadways 4. \_\_\_\_\_
2. impacted with 20 or more trips 5. \_\_\_\_\_
3. in Puyallup and Fife shown on 6. \_\_\_\_\_
4. Figure 1 attached. 8. \_\_\_\_\_

Prepared by: Traffic Engineer: Matt Palmer, PE (KH) Telephone Number: 425-708-8275

Address: 10900 NE 4th Street, Suite 2302 Bellevue, WA 98004

### Office Use Only

TIS  TAS  TAIS  No Further Work Required

Checklist (Please make sure you have included the following information):

- Completed Worksheet    Attach Site Plan    Attach Trip Assignment    Attach Trip Distribution  
 Mail or hand deliver to 333 South Meridian, Puyallup, WA 98371 or e-mail to broberts@puyallupwa.gov

## Study Intersections

1. 54th Ave E / I-5 Southbound Ramps (Fife/WSDOT)
2. 54th Ave E / 20th St E (Fife)
3. 70th Ave E / Pacific Hwy E (SR 99) (Fife/WSDOT)
4. 70th Ave E / 20th St E (Fife)
5. 70th Ave E / Valley Ave E (Fife)
6. Freeman Rd E / Valley Ave E (Fife)
7. Freeman Rd E / 48th St E (Fife)
8. Freeman Rd E / N Levee Rd (Fife)
9. Meridian Ave N (SR 161) / SR 167 Ramps (Puyallup/WSDOT)
10. Meridian Ave N (SR 161) / River Road / 2nd St NE (Puyallup/WSDOT)

**Trip Generation for: Development Peak Weekday  
(a.k.a.): Average Weekday Daily Trips (AWDT)**

LAND USES		NET EXTERNAL TRIPS BY TYPE																		
		IN BOTH DIRECTIONS						DIRECTIONAL ASSIGNMENTS												
		Gross Trips			Internal Crossover			TOTAL	PASS-BY		DIVERTED LINK		NEW		PASS-BY		DIVERTED LINK		NEW	
ITE LU code	VARIABLE	Trip Rate	% IN	% OUT	In+Out (Total)	% of Gross Trips	% of Trips	In+Out (Total)	% of Ext. Trips	In+Out (Total)	% of Ext. Trips	In+Out (Total)	% of Ext. Trips	In	Out	In	Out	In	Out	
Industrial Park Building A (Total)	235.606 KSF	3.37	50%	50%	793.99	0%	0.00	793.99	0%	0.00	0%	793.99	0%	0.00	0.00	0.00	0.00	0.00	0.00	396.99
Industrial Park Building B (Total)	258.700 KSF	3.37	50%	50%	871.82	0%	0.00	871.82	0%	0.00	0%	871.82	0%	0.00	0.00	0.00	0.00	0.00	0.00	435.91
Single-Family Detached	-14 Units	9.43	50%	50%	-132.02	0%	0.00	-132.02	0%	0.00	0%	-132.02	0%	0.00	0.00	0.00	0.00	0.00	0.00	-66.01
<b>Industrial</b>					<b>1,533.79</b>		<b>0.00</b>	<b>1,533.79</b>		<b>0.00</b>		<b>1,533.79</b>		<b>0.00</b>	<b>0.00</b>	<b>0.00</b>	<b>0.00</b>	<b>0.00</b>	<b>0.00</b>	<b>766.89</b>

LAND USES		NET EXTERNAL TRIPS BY TYPE																		
		IN BOTH DIRECTIONS						DIRECTIONAL ASSIGNMENTS												
		Gross Truck Trips			Internal Crossover			TOTAL	PASS-BY		DIVERTED LINK		NEW		PASS-BY		DIVERTED LINK		NEW	
ITE LU code	VARIABLE	Truck Trip Rate	% IN	% OUT	In+Out (Total)	% of Gross Trips	% of Trips	In+Out (Total)	% of Ext. Trips	In+Out (Total)	% of Ext. Trips	In+Out (Total)	% of Ext. Trips	In	Out	In	Out	In	Out	
Industrial Park Building A (Truck)	235.606 KSF	0.57	50%	50%	134.30	0%	0.00	134.30	0%	0.00	0%	134.30	0%	0.00	0.00	0.00	0.00	0.00	0.00	67.15
Industrial Park Building B (Truck)	258.700 KSF	0.57	50%	50%	147.46	0%	0.00	147.46	0%	0.00	0%	147.46	0%	0.00	0.00	0.00	0.00	0.00	0.00	73.73
<b>Total Truck Trips</b>					<b>281.76</b>		<b>0.00</b>	<b>281.76</b>		<b>0.00</b>		<b>281.76</b>		<b>0.00</b>	<b>0.00</b>	<b>0.00</b>	<b>0.00</b>	<b>0.00</b>	<b>0.00</b>	<b>140.88</b>

**Total Passenger Car Trips: 1,252.03**

**626.02**

**626.01**

Freeman Road Logistics  
KH #090222083

**Trip Generation for: Development Peak Weekday, Peak Hour of Adjacent Street Traffic, One Hour between 7 and 9 AM  
(a.k.a.): Weekday AM Peak Hour**

LAND USES		NET EXTERNAL TRIPS BY TYPE																		
		Gross Trips						Internal Crossover			IN BOTH DIRECTIONS				DIRECTIONAL ASSIGNMENTS					
		ITE LU code	VARIABLE	Trip Rate	% IN	% OUT	In+Out (Total)	% of Gross Trips	In+Out (Total)	% of Ext. Trips	PASS-BY In+Out (Total)	% of Ext. Trips	DIVERGED LINK In+Out (Total)	NEW In+Out (Total)	PASS-BY		DIVERGED LINK		NEW	
															In	Out	In	Out	In	Out
Industrial Park Building A (Total)	235.606 KSF	130	0.34	81%	19%	80.11	0%	0.00	0.00	0%	0.00	80.11	0.00	0.00	0.00	0.00	64.89	15.22		
Industrial Park Building B (Total)	258.700 KSF	130	0.34	81%	19%	87.96	0%	0.00	0.00	0%	0.00	87.96	0.00	0.00	0.00	0.00	71.25	16.71		
Single-Family Detached	-14 Units	210	0.70	26%	74%	-9.80	0%	0.00	0.00	0%	0.00	-9.80	0.00	0.00	0.00	0.00	-2.55	-7.25		
<b>Total Vehicle Trips</b>						158.27		0.00	0.00		0.00	158.27		0.00	0.00	0.00	133.59	24.68		

LAND USES		NET EXTERNAL TRIPS BY TYPE																		
		Gross Truck Trips						Internal Crossover			IN BOTH DIRECTIONS				DIRECTIONAL ASSIGNMENTS					
		ITE LU code	VARIABLE	Truck Trip Rate	% IN	% OUT	In+Out (Total)	% of Gross Trips	In+Out (Total)	% of Ext. Trips	PASS-BY In+Out (Total)	% of Ext. Trips	DIVERGED LINK In+Out (Total)	NEW In+Out (Total)	PASS-BY		DIVERGED LINK		NEW	
															In	Out	In	Out	In	Out
Industrial Park Building A (Truck)	235.606 KSF	130	0.04	45%	55%	9.42	0%	0.00	0.00	0%	0.00	9.42	0.00	0.00	0.00	0.00	4.24	5.18		
Industrial Park Building B (Truck)	258.700 KSF	130	0.04	45%	55%	10.35	0%	0.00	0.00	0%	0.00	10.35	0.00	0.00	0.00	0.00	4.66	5.69		
<b>Total Truck Trips</b>						19.77		0.00	0.00		0.00	19.77		0.00	0.00	0.00	8.90	10.87		

**Total Passenger Car Trips: 138.50      Total Passenger Car Trips: 138.50      Total Passenger Car Trips: 138.50**

Freeman Road Logistics  
KH #090222083

**Trip Generation for: Development Peak Weekday, Peak Hour of Adjacent Street Traffic, One Hour between 4 and 6 PM  
(a.k.a.): Weekday PM Peak Hour**

LAND USES		NET EXTERNAL TRIPS BY TYPE																		
		Gross Trips						Internal Crossover			IN BOTH DIRECTIONS				DIRECTIONAL ASSIGNMENTS					
		ITE LU code	VARIABLE	Trip Rate	% IN	% OUT	In+Out (Total)	% of Gross Trips	In+Out (Total)	% of Ext. Trips	PASS-BY In+Out (Total)	% of Ext. Trips	DIVERGED LINK In+Out (Total)	NEW In+Out (Total)	PASS-BY		DIVERGED LINK		NEW	
															In	Out	In	Out	In	Out
Industrial Park Building A (Total)	235.606 KSF	130	0.34	22%	78%	80.11	0%	0.00	0.00	0%	0.00	80.11	0.00	0.00	0.00	0.00	17.62	62.49		
Industrial Park Building B (Total)	258.700 KSF	130	0.34	22%	78%	87.96	0%	0.00	0.00	0%	0.00	87.96	0.00	0.00	0.00	0.00	19.35	68.61		
Single-Family Detached	-14 Units	210	0.94	63%	37%	-13.16	0%	0.00	0.00	0%	0.00	-13.16	0.00	0.00	0.00	0.00	-8.29	-4.87		
<b>Total Vehicle Trips</b>						154.91		0.00			0.00	154.91		0.00		0.00	28.68	126.23		

LAND USES		NET EXTERNAL TRIPS BY TYPE																		
		Gross Truck Trips						Internal Crossover			IN BOTH DIRECTIONS				DIRECTIONAL ASSIGNMENTS					
		ITE LU code	VARIABLE	Truck Trip Rate	% IN	% OUT	In+Out (Total)	% of Gross Trips	In+Out (Total)	% of Ext. Trips	PASS-BY In+Out (Total)	% of Ext. Trips	DIVERGED LINK In+Out (Total)	NEW In+Out (Total)	PASS-BY		DIVERGED LINK		NEW	
															In	Out	In	Out	In	Out
Industrial Park Building A (Truck)	235.606 KSF	130	0.04	38%	62%	9.42	0%	0.00	0.00	0%	0.00	9.42	0.00	0.00	0.00	0.00	3.58	5.84		
Industrial Park Building B (Truck)	258.700 KSF	130	0.04	38%	62%	10.35	0%	0.00	0.00	0%	0.00	10.35	0.00	0.00	0.00	0.00	3.93	6.42		
<b>Total Truck Trips</b>						19.77		0.00			0.00	19.77		0.00		0.00	7.51	12.26		

**Total Passenger Car Trips: 135.14      21.17      113.97**

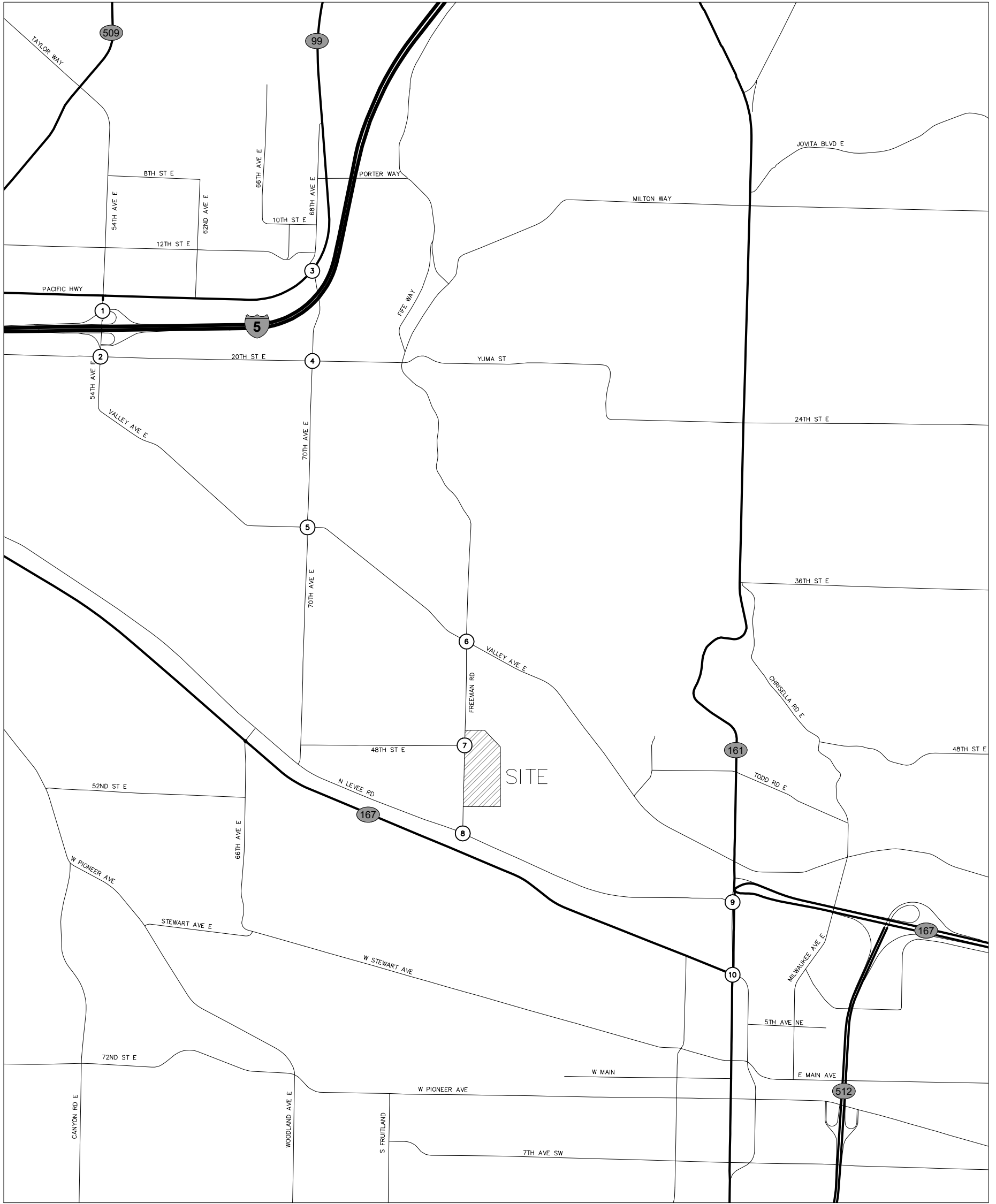

FREEMAN ROAD  
LOGISTICS

CITY OF PUYALLUP

LEGEND



IMPACTED INTERSECTION

FIGURE 1  
MAXIMUM TRIP  
GENERATION –  
IMPACTED  
INTERSECTIONS

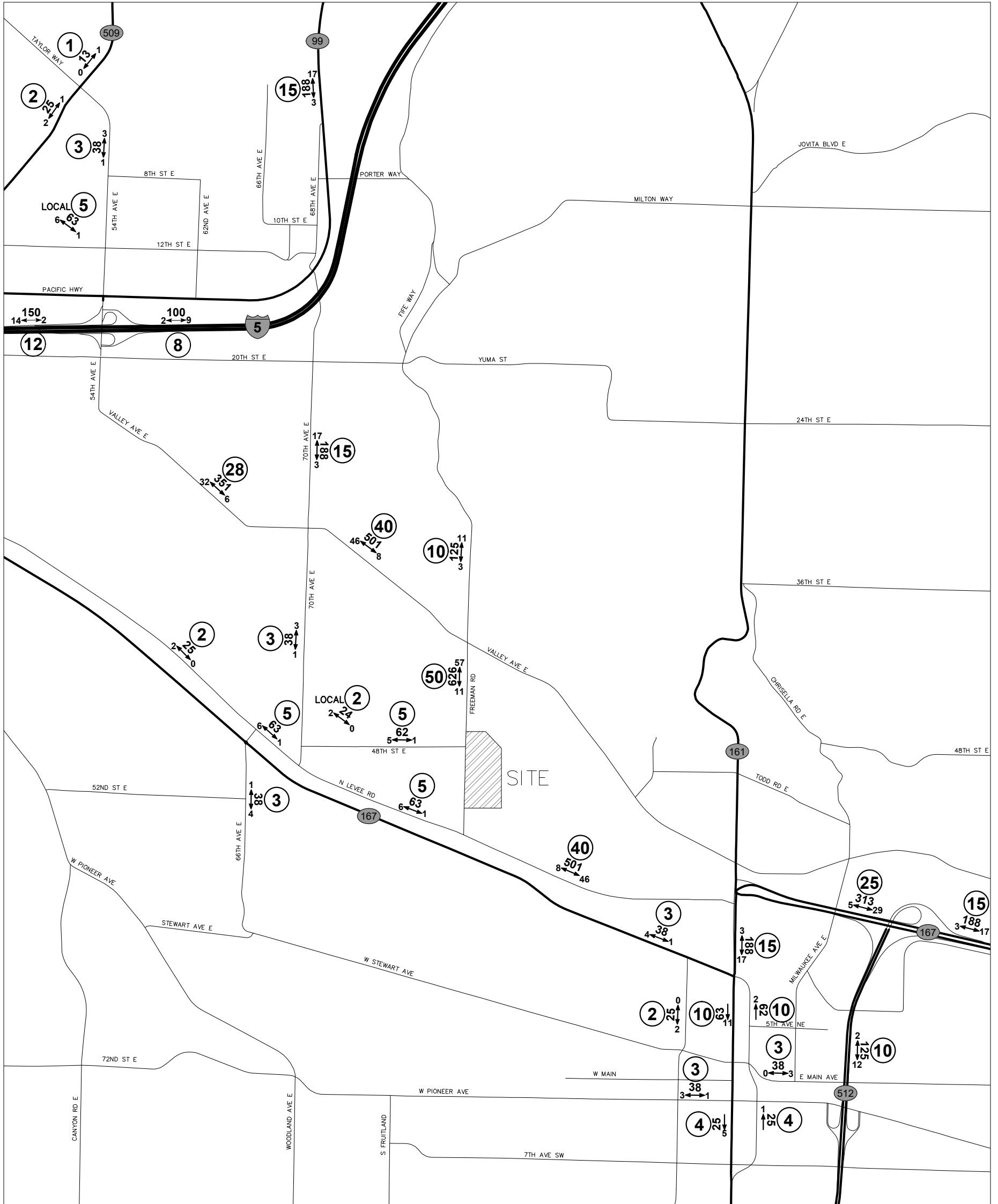

**FREEMAN ROAD LOGISTICS**

CITY OF PUYALLUP

**LEGEND**

- AWDT** NEW DAILY TRAFFIC
- PM ← PEAK** NEW PEAK-HOUR TRIPS
- XX** TRIP DISTRIBUTION

**FIGURE 2**  
DEVELOPMENT  
TRIP DISTRIBUTION  
PM PEAK-HOUR  
CAR

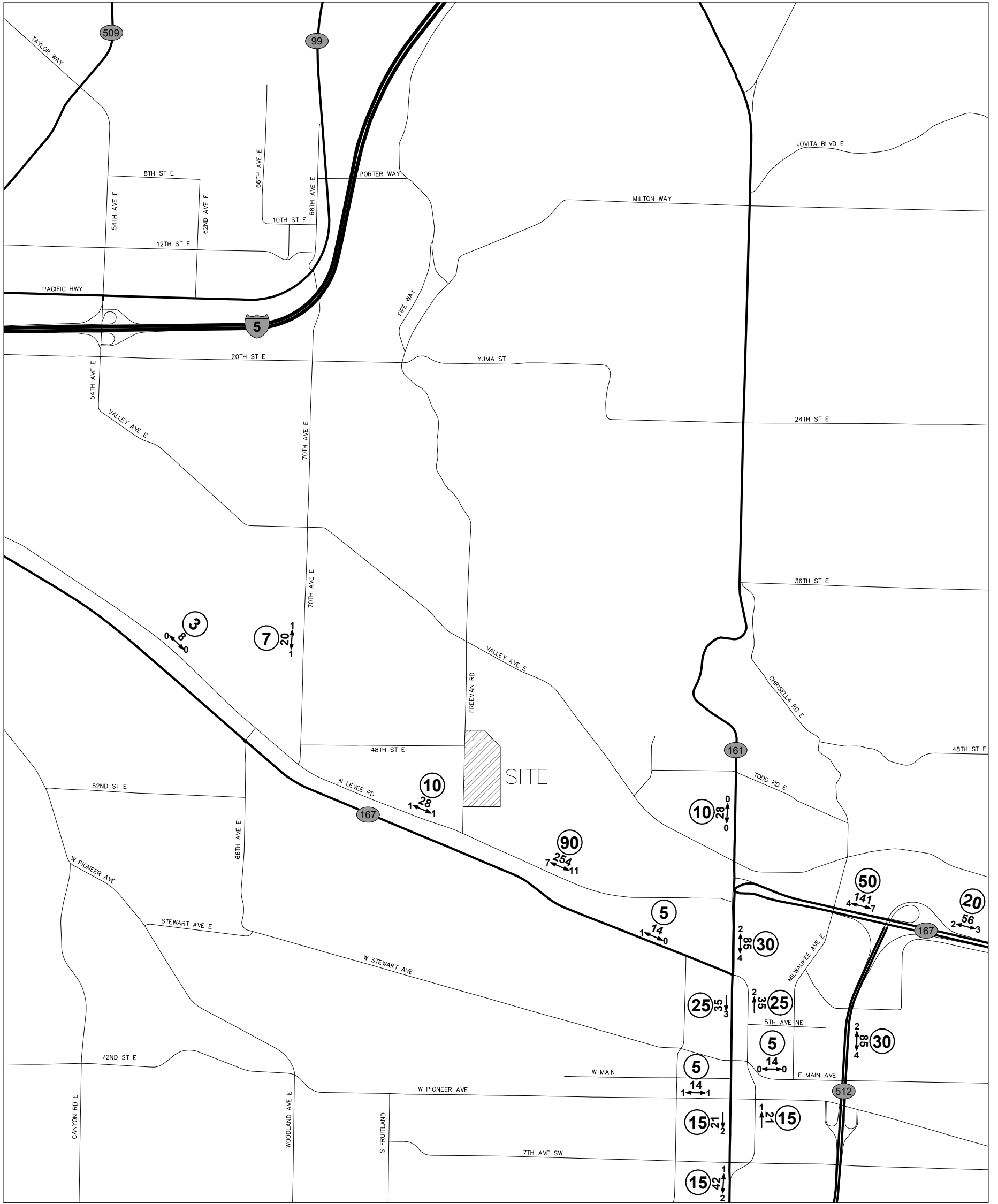

**FREEMAN ROAD LOGISTICS**

**LEGEND**  
 AWDT PM ← PEAK → NEW DAILY TRAFFIC  
 NEW PEAK-HOUR TRIPS  
 (XX) TRIP DISTRIBUTION

**FIGURE 3**  
 DEVELOPMENT TRIP DISTRIBUTION  
 PM PEAK-HOUR TRUCK

CITY OF PUYALLUP



Date: March 27, 2023 - 6:58pm / User: jaywiller  
 Path: K:\SNO\_H170\2022\22-083\_Freeman\_Rd\_Logistics\Update April 2023\Figures\Freeman\_Rd\_Logistics - 130\_Figures.dwg / Xref:



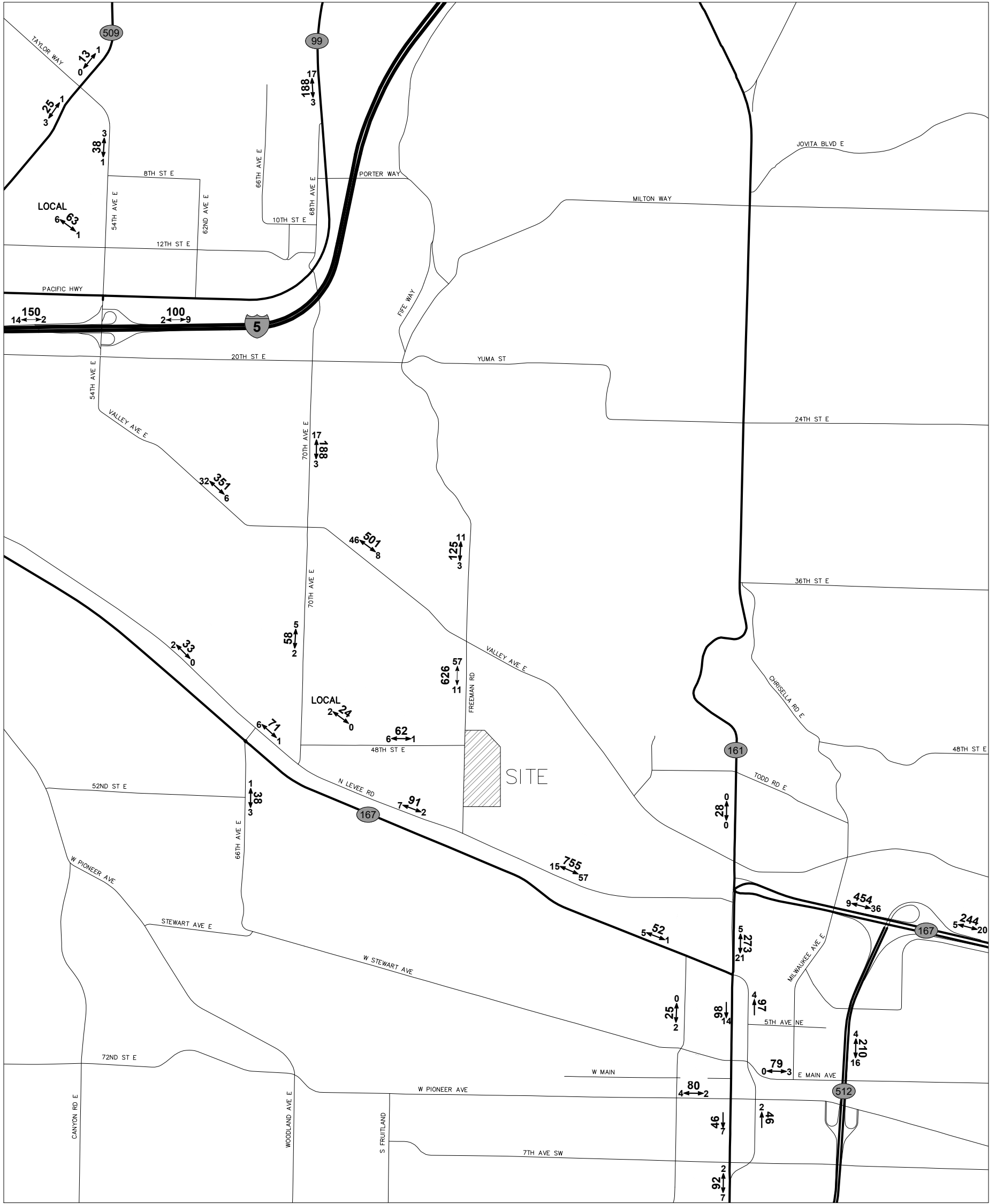

**FREEMAN ROAD LOGISTICS**

CITY OF PUYALLUP

**LEGEND**

- AWDT** NEW DAILY TRAFFIC
- PM ← PEAK** NEW PEAK-HOUR TRIPS
- (XX)** TRIP DISTRIBUTION

**FIGURE 4**  
TOTAL DEVELOPMENT TRIP DISTRIBUTION  
PM PEAK-HOUR  
CARS AND TRUCKS

Date: March 27, 2023 - 6:59pm / User: jaywiller  
Path: K:\SNO\_H70\2022\22-083\_Freeman\_Rd\_Logistics\Update April 2023\Figures\Freeman\_Rd\_Logistics - 130\_Figures.dwg / Xref:

# City of Puyallup Traffic Scoping Worksheet

## PROJECT INFORMATION

Project Title: Freeman Logistics Date: 03/27/2023

Applicant Name: Matt Palmer (Representative) Telephone Number: 425-708-8275

Project Description: 494,306 of Manufacturing Year of Occupancy: 2024

Project Location: 49th St E and Freeman Road Parcel Size: 23.70 acres

Proposed Number of Access Point(s): 3 Existing Number of Access Point(s): 5

Land Use	Quantity	ITE Land Use Code	Average Daily Trips	AM Peak Hour Trips*	PM Peak Hour Trips*
Existing Use(s)					
Single-Family	-14 units	210	-132.0	-9.8	-13.2
Detached					
Proposed Use(s)					
Manufacturing	494,306 SF	140	2,348.0	336.1	365.8
<b>Net New Trips</b>			<b>2,216.0</b>	<b>326.3</b>	<b>352.6</b>
<b>Traffic Impact Fees: Net New PM Peak Hour Trips x \$4,500.00 = \$ <u>1,586,700.00</u></b>					

- \* The peak hour project trips shall be rounded to the nearest tenth.
- \* The project trips shall be estimated using the ITE's *Trip Generation*, 11<sup>th</sup> Edition.
- \* Trip generation regression equations shall be used when the R<sup>2</sup> value is 0.70 or greater.
- \* For land uses that do not exist within the ITE's *Trip Generation*, actual field data shall be collected from three local facilities that have similar characteristics to the proposal.
- \* For all single-family units and offices and specialty retail centers smaller than 30,000 SF, use ITE's *Trip Generation*, 11th Edition, average rate.

Identify all intersections that will be affected by 25 new project peak hour trips or more: **20 Trips for Fife**

1. All Arterial/Arterial Roadways 4. \_\_\_\_\_
2. impacted with 20 or more trips 5. \_\_\_\_\_
3. in Puyallup and Fife shown on 6. \_\_\_\_\_
4. Figure 1 attached. 8. \_\_\_\_\_

Prepared by: Traffic Engineer: Matt Palmer, PE (KH) Telephone Number: 425-708-8275

Address: 10900 NE 4th Street, Suite 2302 Bellevue, WA 98004

### Office Use Only

TIS  TAS  TAIS  No Further Work Required

Checklist (Please make sure you have included the following information):

- Completed Worksheet  Attach Site Plan  Attach Trip Assignment  Attach Trip Distribution  
 Mail or hand deliver to 333 South Meridian, Puyallup, WA 98371 or e-mail to broberts@puyallupwa.gov

## Study Intersections

1. 54th Ave E / 12th St E (Fife)
2. 54th Ave E / Pacific Hwy E (SR 99) (Fife/WSDOT)
3. 54th Ave E / I-5 Southbound Ramps (Fife/WSDOT)
4. 54th Ave E / 20th St E (Fife)
5. 70th Ave E / Pacific Hwy E (SR 99) (Fife/WSDOT)
6. 70th Ave E / 20th St E (Fife)
7. 70th Ave E / Valley Ave E (Fife)
8. Freeman Rd E / Valley Ave E (Fife)
9. Freeman Rd E / 48th St E (Fife)
10. Freeman Rd E / N Levee Rd (Fife)
11. Meridian Ave N (SR 161) / SR 167 Ramps (Puyallup/WSDOT)
12. Meridian Ave N (SR 161) / River Road / 2nd St NE (Puyallup/WSDOT)
13. Meridian Ave N (SR 161) / W Stewart Ave (Puyallup/WSDOT)
14. 2nd Street NE / E Stewart Ave / E Main Ave (Puyallup)

Freeman Road Logistics  
KH #090222083

**Trip Generation for: Development Peak Weekday  
(a.k.a.): Average Weekday Daily Trips (AWDT)**

		NET EXTERNAL TRIPS BY TYPE																
		IN BOTH DIRECTIONS						DIRECTIONAL ASSIGNMENTS										
LAND USES	ITE LU code	Gross Trips			Internal Crossover			TOTAL In+Out (Total)	PASS-BY		DIVERGED LINK		PASS-BY		DIVERGED LINK		NEW	
		Trip Rate	% IN	% OUT	In+Out (Total)	% of Gross Trips	In+Out (Total)		% of Ext. Trips	In+Out (Total)	% of Ext. Trips	In	Out	In	Out	In	Out	
Manufacturing Building A (Total)	140	4.75	50%	50%	1,119.13	0%	0.00	1,119.13	0%	0.00	0.00	0%	0.00	0.00	0.00	0.00	559.57	559.56
Manufacturing Building B (Total)	140	4.75	50%	50%	1,228.83	0%	0.00	1,228.83	0%	0.00	0.00	0%	0.00	0.00	0.00	0.00	614.42	614.41
Single-Family Detached	210	9.43	50%	50%	-132.02	0%	0.00	-132.02	0%	0.00	0.00	0%	0.00	0.00	0.00	0.00	-66.01	-66.01
<b>Total Vehicle Trips</b>					2,215.94		0.00	2,215.94		0.00	0.00		0.00	0.00	0.00	0.00	1,107.98	1,107.96

		Gross Truck Trips						Internal Crossover			TOTAL In+Out (Total)	PASS-BY		DIVERGED LINK		NEW		DIVERGED LINK		NEW	
LAND USES	ITE LU code	Truck Trip Rate	% IN	% OUT	In+Out (Total)	% of Gross Trips	In+Out (Total)	% of Gross Trips	In+Out (Total)	% of Ext. Trips		In+Out (Total)	% of Ext. Trips	In	Out	In	Out	In	Out	In	Out
		Manufacturing Building A (Truck)	140	0.45	50%	50%	106.02	0%	0.00	0%	0.00	0%	0.00	0%	0.00	0.00	0.00	0.00	0.00	0.00	53.01
Manufacturing Building B (Truck)	140	0.45	50%	50%	116.42	0%	0.00	0%	0.00	0%	0.00	0%	0.00	0.00	0.00	0.00	0.00	0.00	58.21	58.21	
<b>Total Truck Trips</b>					222.44		0.00		0.00		0.00		0.00	0.00	0.00	0.00	0.00	0.00	111.22	111.22	

**Total Passenger Car Trips: 1,993.50**

**996.76**

**996.74**

Freeman Road Logistics  
KH #090222083

**Trip Generation for: Development Peak Weekday, Peak Hour of Adjacent Street Traffic, One Hour between 7 and 9 AM  
(a.k.a.): Weekday AM Peak Hour**

LAND USES		NET EXTERNAL TRIPS BY TYPE																		
		Gross Trips						Internal Crossover			IN BOTH DIRECTIONS				DIRECTIONAL ASSIGNMENTS					
		ITE LU code	VARIABLE	Trip Rate	% IN	% OUT	In+Out (Total)	% of Gross Trips	In+Out (Total)	% of Ext. Trips	PASS-BY In+Out (Total)	% of Ext. Trips	DIVERTED LINK In+Out (Total)	NEW In+Out (Total)	PASS-BY		DIVERTED LINK		NEW	
															In	Out	In	Out	In	Out
Manufacturing Building A (Total)	235.606 KSF	140	0.68	76%	24%	160.21	0%	0.00	0%	0.00	0%	160.21	0.00	0.00	0.00	0.00	121.76	38.45		
Manufacturing Building B (Total)	258.700 KSF	140	0.68	76%	24%	175.92	0%	0.00	0%	0.00	0%	175.92	0.00	0.00	0.00	0.00	133.70	42.22		
Single-Family Detached	-14 Units	210	0.70	26%	74%	-9.80	0%	0.00	0%	0.00	0%	-9.80	0.00	0.00	0.00	0.00	-2.55	-7.25		
<b>Total Vehicle Trips</b>						326.33		0.00		0.00		326.33		0.00		0.00	252.91	73.42		

LAND USES		NET EXTERNAL TRIPS BY TYPE																		
		Gross Truck Trips						Internal Crossover			IN BOTH DIRECTIONS				DIRECTIONAL ASSIGNMENTS					
		ITE LU code	VARIABLE	Truck Trip Rate	% IN	% OUT	In+Out (Total)	% of Gross Trips	In+Out (Total)	% of Ext. Trips	PASS-BY In+Out (Total)	% of Ext. Trips	DIVERTED LINK In+Out (Total)	NEW In+Out (Total)	PASS-BY		DIVERTED LINK		NEW	
															In	Out	In	Out	In	Out
Manufacturing Building A (Truck)	235.606 KSF	140	0.03	56%	44%	7.07	0%	0.00	0%	0.00	0%	7.07	0.00	0.00	0.00	0.00	3.96	3.11		
Manufacturing Building B (Truck)	258.700 KSF	140	0.03	56%	44%	7.76	0%	0.00	0%	0.00	0%	7.76	0.00	0.00	0.00	0.00	4.35	3.41		
<b>Total Truck Trips</b>						14.83		0.00		0.00		14.83		0.00		0.00	8.31	6.52		

**Total Passenger Car Trips: 311.50      244.60      66.90**

Freeman Road Logistics  
KH #090222083

**Trip Generation for: Development Peak Weekday, Peak Hour of Adjacent Street Traffic, One Hour between 4 and 6 PM  
(a.k.a.): Weekday PM Peak Hour**

LAND USES		NET EXTERNAL TRIPS BY TYPE																	
		IN BOTH DIRECTIONS					DIRECTIONAL ASSIGNMENTS												
		Gross Trips		Internal Crossover		TOTAL In+Out (Total)	PASS-BY		DIVERTED LINK		PASS-BY		DIVERTED LINK						
		% IN	% OUT	In+Out (Total)	% of Gross Trips		% of Ext. Trips	In+Out (Total)	% of Ext. Trips	In	Out	In	Out	In	Out				
Manufacturing Building A (Total)	235.606 KSF	140	0.74	31%	69%	174.35	0%	0.00	0%	174.35	0%	0.00	0%	0.00	0.00	0.00	0.00	54.05	120.30
Manufacturing Building B (Total)	258.700 KSF	140	0.74	31%	69%	191.44	0%	0.00	0%	191.44	0%	0.00	0%	0.00	0.00	0.00	0.00	59.35	132.09
Single-Family Detached	-14 Units	210	0.94	63%	37%	-13.16	0%	0.00	0%	-13.16	0%	0.00	0%	0.00	0.00	0.00	0.00	-8.29	-4.87
<b>Total Vehicle Trips</b>						352.63		0.00		352.63		0.00		0.00	0.00	0.00	0.00	105.11	247.52

LAND USES		NET EXTERNAL TRIPS BY TYPE																	
		IN BOTH DIRECTIONS					DIRECTIONAL ASSIGNMENTS												
		Gross Truck Trips		Internal Crossover		TOTAL In+Out (Total)	PASS-BY		DIVERTED LINK		PASS-BY		DIVERTED LINK						
		% IN	% OUT	In+Out (Total)	% of Gross Trips		% of Ext. Trips	In+Out (Total)	% of Ext. Trips	In	Out	In	Out	In	Out				
Manufacturing Building A (Truck)	235.606 KSF	140	0.03	41%	59%	7.07	0%	0.00	0%	7.07	0%	0.00	0%	0.00	0.00	0.00	0.00	2.90	4.17
Manufacturing Building B (Truck)	258.700 KSF	140	0.03	41%	59%	7.76	0%	0.00	0%	7.76	0%	0.00	0%	0.00	0.00	0.00	0.00	3.18	4.58
<b>Total Truck Trips</b>						14.83		0.00		14.83		0.00		0.00	0.00	0.00	0.00	6.08	8.75

**Total Passenger Car Trips: 337.80      99.03      238.77**



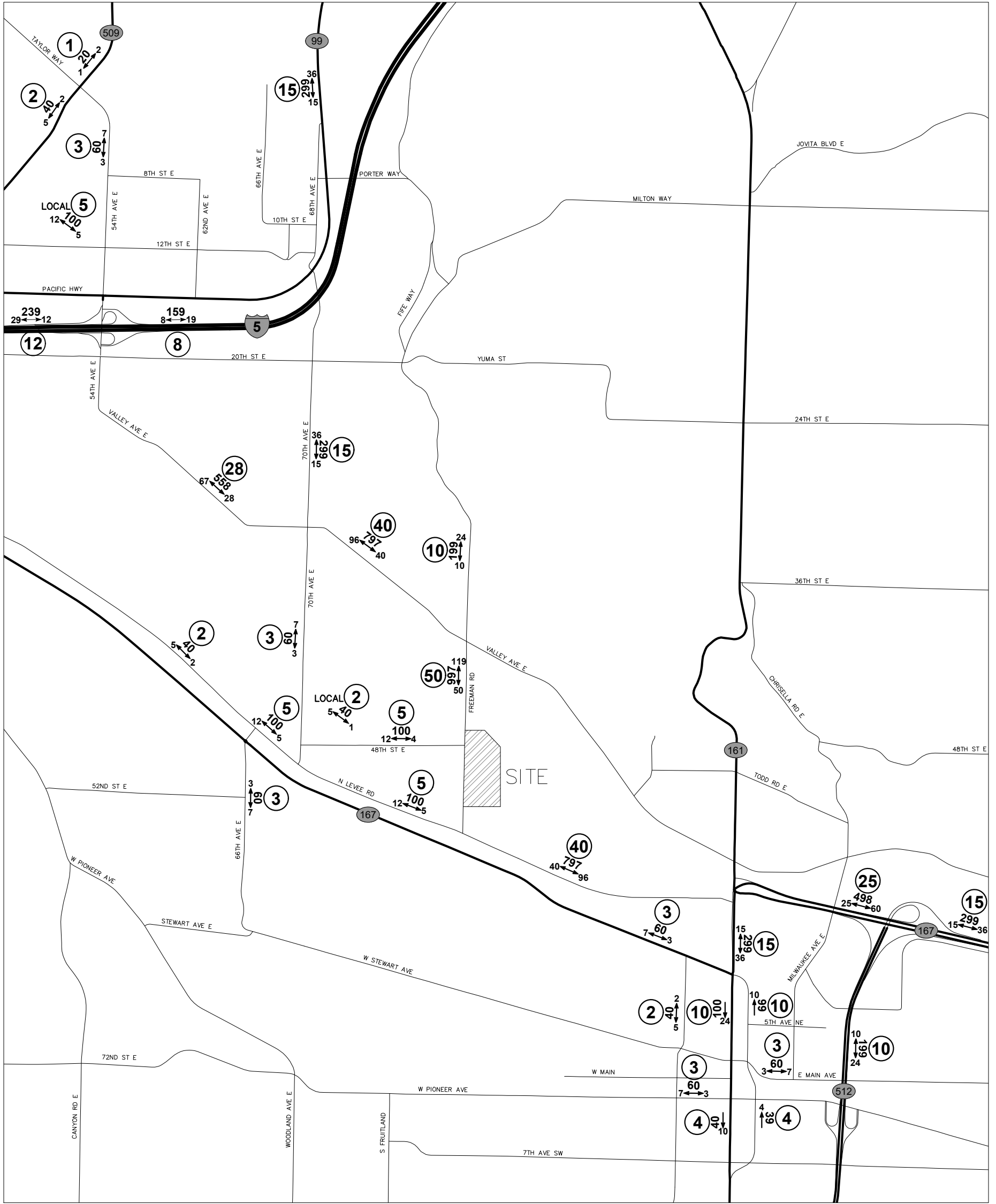

FREEMAN ROAD  
LOGISTICS

LEGEND

- AWDT** NEW DAILY TRAFFIC
- PM ← PEAK** NEW PEAK-HOUR TRIPS
- XX** TRIP DISTRIBUTION

CITY OF PUYALLUP

**FIGURE 2**  
DEVELOPMENT  
TRIP DISTRIBUTION  
PM PEAK-HOUR  
CAR





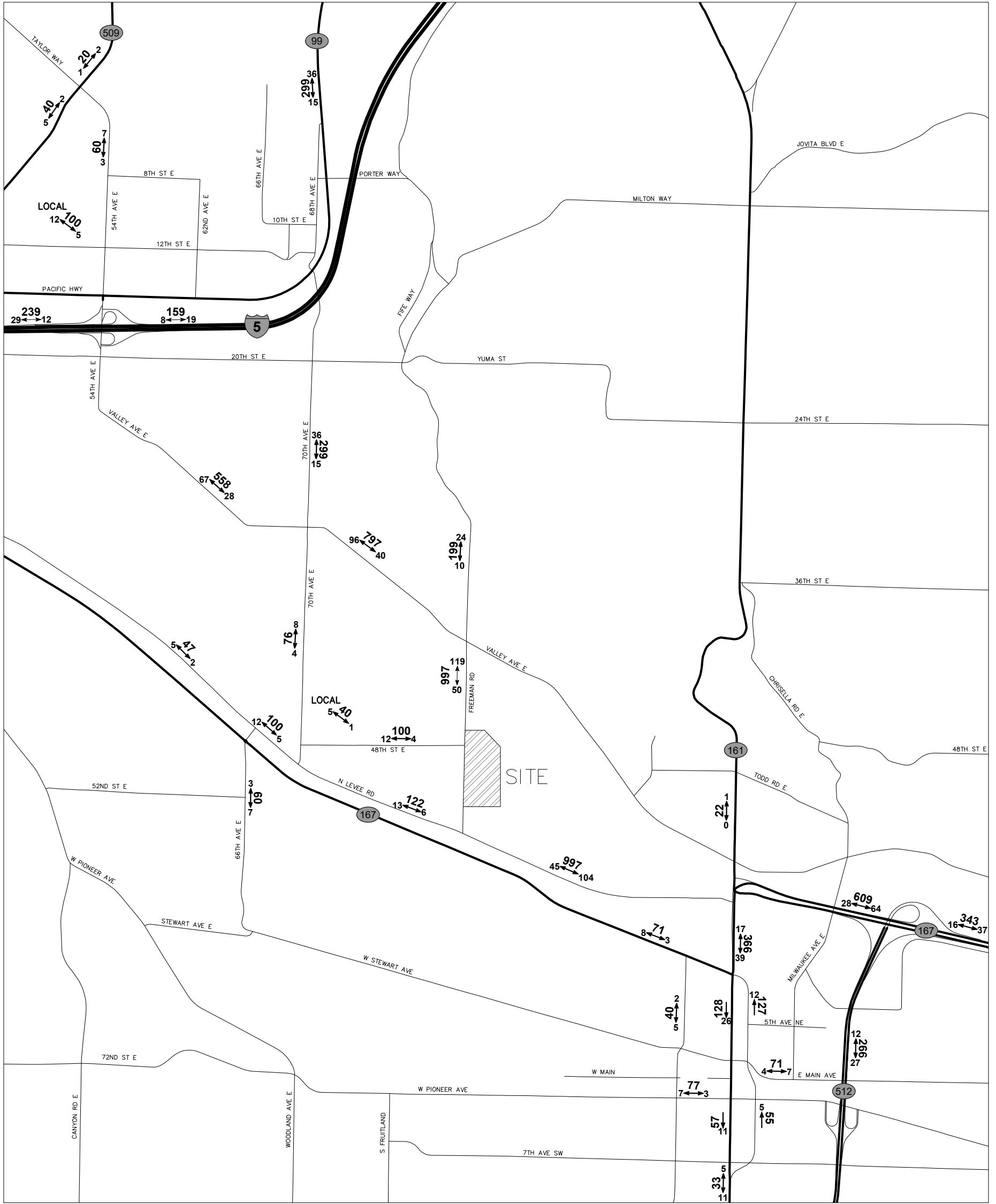

**FREEMAN ROAD  
LOGISTICS**

**CITY OF PUYALLUP**

**LEGEND**

- AWDT** NEW DAILY TRAFFIC
- PM ← PEAK** NEW PEAK-HOUR TRIPS
- XX** TRIP DISTRIBUTION

**FIGURE 4**  
TOTAL DEVELOPMENT  
TRIP DISTRIBUTION  
PM PEAK-HOUR  
CARS AND TRUCKS

# City of Puyallup Traffic Scoping Worksheet

## PROJECT INFORMATION

Project Title: Freeman Logistics Date: 03/27/2023

Applicant Name: Matt Palmer (Representative) Telephone Number: 425-708-8275

Project Description: 494,306 of Warehousing Year of Occupancy: 2024

Project Location: 49th St E and Freeman Road Parcel Size: 23.70 acres

Proposed Number of Access Point(s): 3 Existing Number of Access Point(s): 5

Land Use	Quantity	ITE Land Use Code	Average Daily Trips	AM Peak Hour Trips*	PM Peak Hour Trips*
Existing Use(s)					
Single-Family	-14 units	210	-132.0	-9.8	-13.2
Detached					
Proposed Use(s)					
Warehousing	494,306 SF	150	845.3	84.0	89.0
<b>Net New Trips</b>			<b>713.3</b>	<b>74.2</b>	<b>75.8</b>
<b>Traffic Impact Fees:</b> Net New PM Peak Hour Trips x \$4,500.00 = \$ <u>341,100.00</u>					

- \* The peak hour project trips shall be rounded to the nearest tenth.
- \* The project trips shall be estimated using the ITE's *Trip Generation*, 11<sup>th</sup> Edition.
- \* Trip generation regression equations shall be used when the R<sup>2</sup> value is 0.70 or greater.
- \* For land uses that do not exist within the ITE's *Trip Generation*, actual field data shall be collected from three local facilities that have similar characteristics to the proposal.
- \* For all single-family units and offices and specialty retail centers smaller than 30,000 SF, use ITE's *Trip Generation*, 11th Edition, average rate.

Identify all intersections that will be affected by 25 new project peak hour trips or more: **20 Trips for Fife**

1. 70th Ave E / Valley Ave E (Fife) 4. \_\_\_\_\_
2. Freeman Rd E / Valley Ave E (Fife) 5. Meridian Ave N (SR 161) / SR 167 Ramps
3. Freeman Rd E / 48th St E (Fife) 6. (Puyallup/WSDOT)
4. Freeman Rd E / N Levee Rd (Fife) 8. \_\_\_\_\_

Prepared by: Traffic Engineer: Matt Palmer, PE (KH) Telephone Number: 425-708-8275

Address: 10900 NE 4th Street, Suite 2302 Bellevue, WA 98004

### **Office Use Only**

TIS  TAS  TAIS  No Further Work Required

Checklist (Please make sure you have included the following information):

- Completed Worksheet  Attach Site Plan  Attach Trip Assignment  Attach Trip Distribution  
 Mail or hand deliver to 333 South Meridian, Puyallup, WA 98371 or e-mail to broberts@puyallupwa.gov

**Trip Generation for: Development Peak Weekday  
(a.k.a.): Average Weekday Daily Trips (AWDT)**

		NET EXTERNAL TRIPS BY TYPE																			
		IN BOTH DIRECTIONS						DIRECTIONAL ASSIGNMENTS													
LAND USES	ITE LU code	Gross Trips			Internal Crossover			TOTAL In+Out (Total)	PASS-BY		DIVERGED LINK		NEW		PASS-BY		DIVERGED LINK		NEW		
		Trip Rate	% IN	% OUT	In+Out (Total)	% of Gross Trips	In+Out (Total)		% of Ext. Trips	In+Out (Total)	% of Ext. Trips	In+Out (Total)	% of Ext. Trips	In	Out	In	Out	In	Out	In	Out
Warehousing Building A (Total)	150	235.606 KSF	50%	50%	402.89	0%	0.00	402.89	0%	0.00	0%	0.00	0.00	0.00	402.89	0%	0.00	0.00	0.00	201.45	201.44
Warehousing Building B (Total)	150	258.700 KSF	50%	50%	442.38	0%	0.00	442.38	0%	0.00	0%	0.00	0.00	0.00	442.38	0%	0.00	0.00	0.00	221.19	221.19
Single-Family Detached	210	-14 Units	50%	50%	-132.02	0%	0.00	-132.02	0%	0.00	0%	0.00	0.00	0.00	-132.02	0%	0.00	0.00	0.00	-66.01	-66.01
<b>Total Vehicle Trips</b>					713.25		0.00	713.25		0.00		0.00	0.00	0.00	713.25		0.00	0.00	0.00	356.63	356.62

		NET EXTERNAL TRIPS BY TYPE																			
		IN BOTH DIRECTIONS						DIRECTIONAL ASSIGNMENTS													
LAND USES	ITE LU code	Gross Truck Trips			Internal Crossover			TOTAL In+Out (Total)	PASS-BY		DIVERGED LINK		NEW		PASS-BY		DIVERGED LINK		NEW		
		Truck Trip Rate	% IN	% OUT	In+Out (Total)	% of Gross Trips	In+Out (Total)		% of Ext. Trips	In+Out (Total)	% of Ext. Trips	In+Out (Total)	% of Ext. Trips	In	Out	In	Out	In	Out	In	Out
Warehousing Building A (Truck)	150	235.606 KSF	50%	50%	141.36	0%	0.00	141.36	0%	0.00	0%	0.00	0.00	0.00	141.36	0%	0.00	0.00	0.00	70.68	70.68
Warehousing Building B (Truck)	150	258.700 KSF	50%	50%	155.22	0%	0.00	155.22	0%	0.00	0%	0.00	0.00	0.00	155.22	0%	0.00	0.00	0.00	77.61	77.61
<b>Total Truck Trips</b>					296.58		0.00	296.58		0.00		0.00	0.00	0.00	296.58		0.00	0.00	0.00	148.29	148.29

**Total Passenger Car Trips: 416.67      208.34      208.33**



Freeman Road Logistics  
KH #090222083

**Trip Generation for: Development Peak Weekday, Peak Hour of Adjacent Street Traffic, One Hour between 4 and 6 PM  
(a.k.a.): Weekday PM Peak Hour**

LAND USES		NET EXTERNAL TRIPS BY TYPE																		
		Gross Trips						Internal Crossover			IN BOTH DIRECTIONS				DIRECTIONAL ASSIGNMENTS					
		ITE LU code	VARIABLE	Trip Rate	% IN	% OUT	In+Out (Total)	% of Gross Trips	In+Out (Total)	% of Ext. Trips	PASS-BY In+Out (Total)	% of Ext. Trips	DIVERGED LINK In+Out (Total)	NEW In+Out (Total)	PASS-BY		DIVERGED LINK		NEW	
															In	Out	In	Out	In	Out
Warehousing Building A (Total)	235.606 KSF	150	0.18	39%	61%	42.41	0%	0.00	0%	0.00	0%	0.00	42.41	0.00	0.00	0.00	0.00	16.54	25.87	
Warehousing Building B (Total)	258.700 KSF	150	0.18	39%	61%	46.57	0%	0.00	0%	0.00	0%	0.00	46.57	0.00	0.00	0.00	0.00	18.16	28.41	
Single-Family Detached	-14 Units	210	0.94	63%	37%	-13.16	0%	0.00	0%	0.00	0%	0.00	-13.16	0.00	0.00	0.00	0.00	-8.29	-4.87	
<b>Total Vehicle Trips</b>						75.82		0.00		0.00		0.00	75.82		0.00		0.00	26.41	49.41	

LAND USES		NET EXTERNAL TRIPS BY TYPE																		
		Gross Truck Trips						Internal Crossover			IN BOTH DIRECTIONS				DIRECTIONAL ASSIGNMENTS					
		ITE LU code	VARIABLE	Truck Trip Rate	% IN	% OUT	In+Out (Total)	% of Gross Trips	In+Out (Total)	% of Ext. Trips	PASS-BY In+Out (Total)	% of Ext. Trips	DIVERGED LINK In+Out (Total)	NEW In+Out (Total)	PASS-BY		DIVERGED LINK		NEW	
															In	Out	In	Out	In	Out
Warehousing Building A (Truck)	235.606 KSF	150	0.03	52%	48%	7.07	0%	0.00	0%	0.00	0%	0.00	7.07	0.00	0.00	0.00	0.00	3.68	3.39	
Warehousing Building B (Truck)	258.700 KSF	150	0.03	52%	48%	7.76	0%	0.00	0%	0.00	0%	0.00	7.76	0.00	0.00	0.00	0.00	4.04	3.72	
<b>Total Truck Trips</b>						14.83		0.00		0.00		0.00	14.83		0.00		0.00	7.72	7.11	

**Total Passenger Car Trips: 60.99      18.69      42.30**

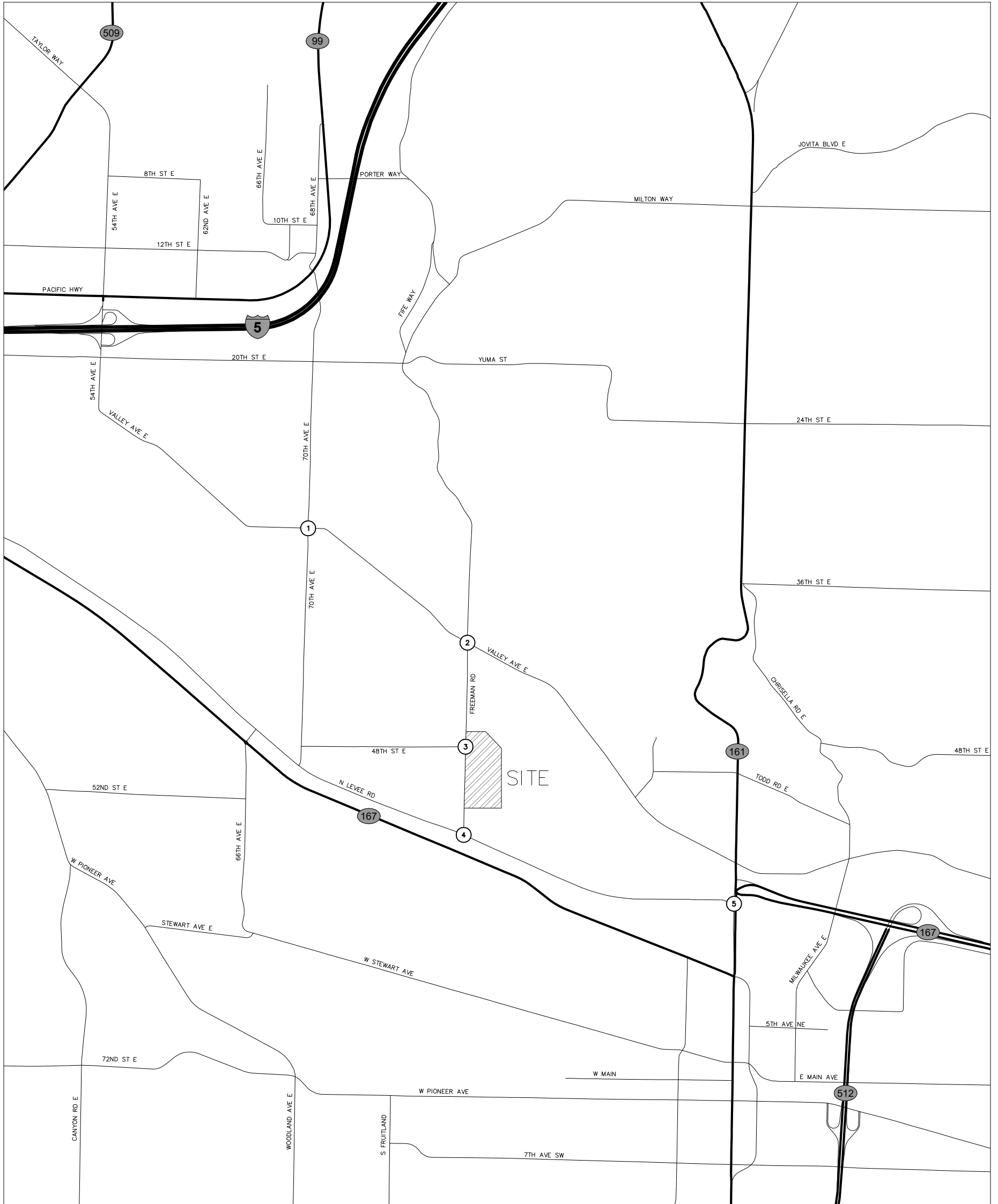

FREEMAN ROAD LOGISTICS

LEGEND

(X) IMPACTED INTERSECTION

FIGURE 1  
MAXIMUM TRIP GENERATION –  
IMPACTED INTERSECTIONS

CITY OF PUYALLUP

Date: March 27, 2023 - 6:54am / User: jaywiller  
Path: K:\SNO\_H70\2022\22-083\_Freeman Rd Logistics\Update April 2023\Figures\Freeman Rd Logistics - 150\_Figures.dwg / Xref:

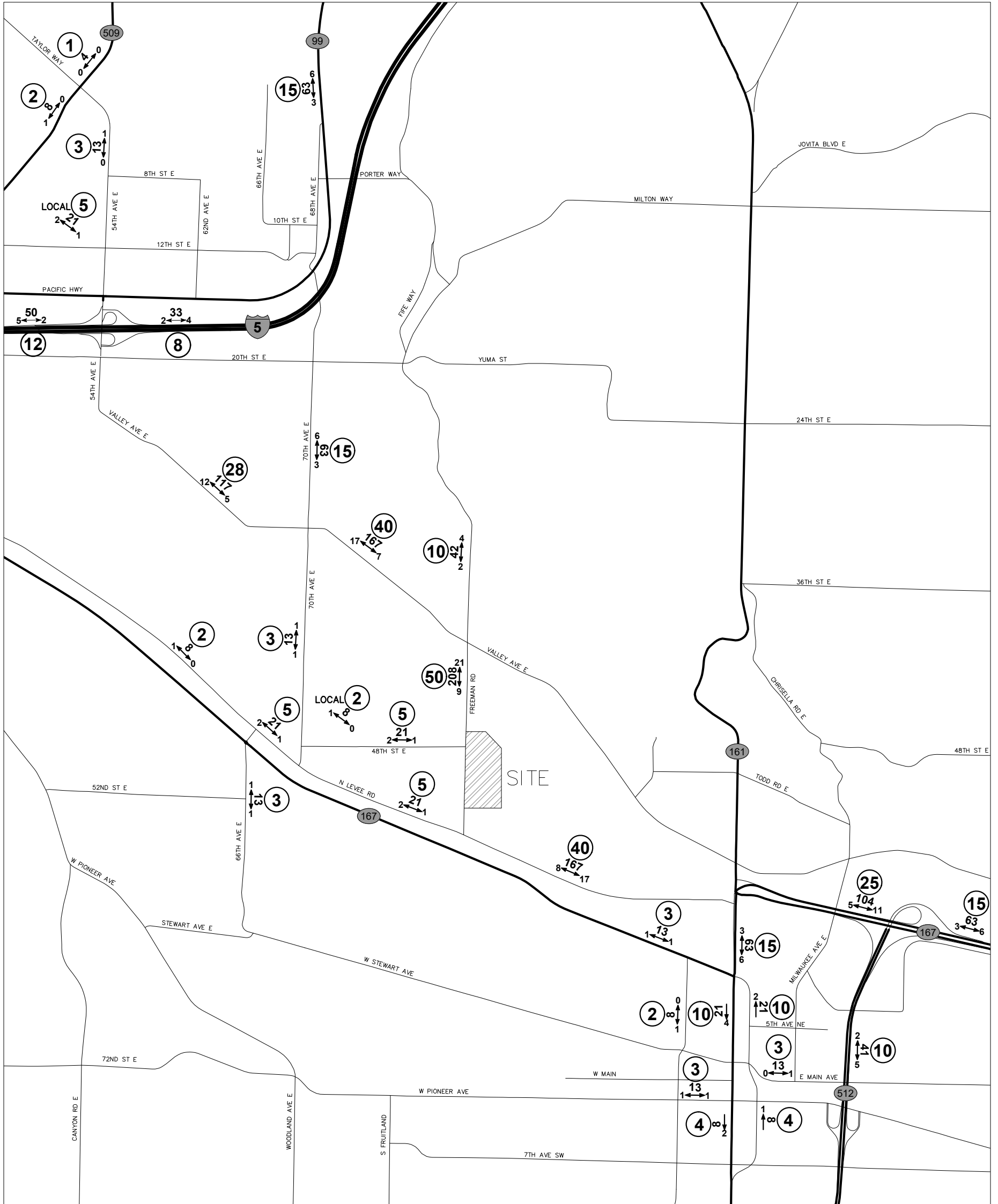

**FREEMAN ROAD  
LOGISTICS**

**CITY OF PUYALLUP**

**LEGEND**

- AWDT** NEW DAILY TRAFFIC
- PM ← PEAK** NEW PEAK-HOUR TRIPS
- XX** TRIP DISTRIBUTION

**FIGURE 2**  
DEVELOPMENT  
TRIP DISTRIBUTION  
PM PEAK-HOUR  
CAR



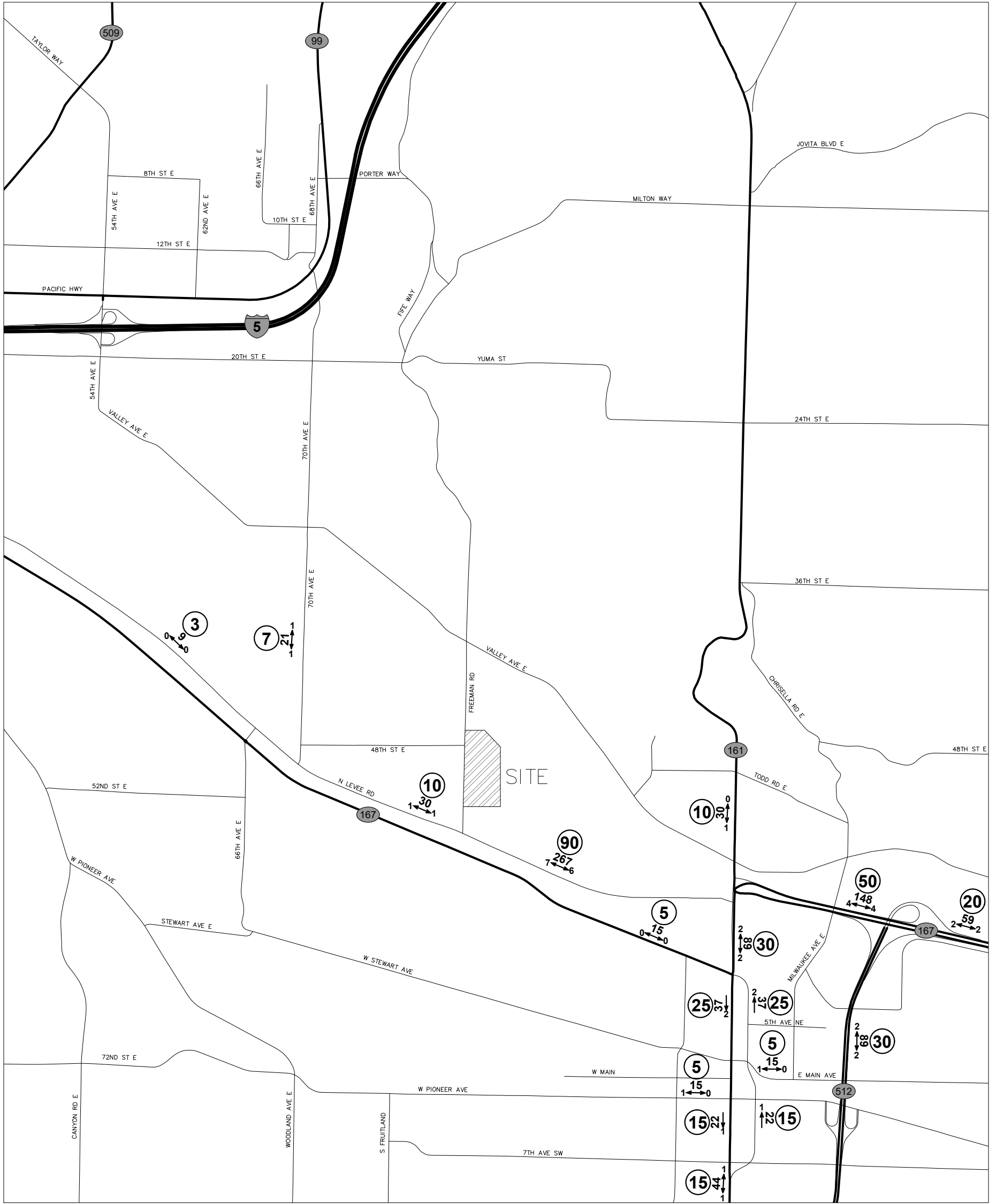

**FREEMAN ROAD  
LOGISTICS**

**CITY OF PUYALLUP**

**LEGEND**

- AWDT** NEW DAILY TRAFFIC
- PM ← → PEAK** NEW PEAK-HOUR TRIPS
- (XX)** TRIP DISTRIBUTION

**FIGURE 3**  
DEVELOPMENT  
TRIP DISTRIBUTION  
PM PEAK-HOUR  
TRUCK

Date: March 27, 2023 - 6:59pm / User: jaywiller / Path: K:\SNO\_H\70\2022\22-083\_Freeman\_Rd\_Logistics\Update\_April\_2023\Figures\Freeman\_Rd\_Logistics - 150\_Figures.dwg / Xref:

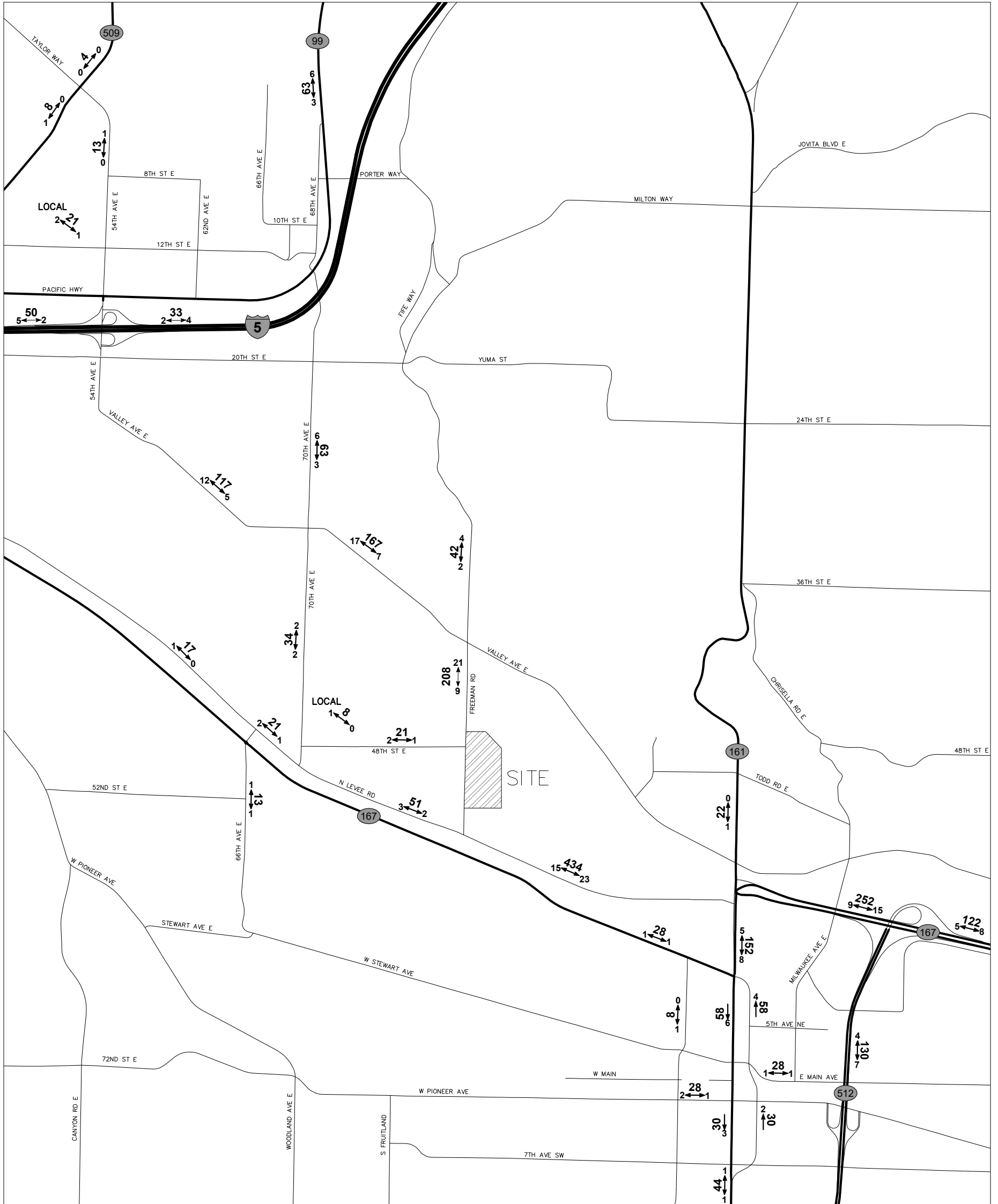

**FREEMAN ROAD LOGISTICS**

CITY OF PUYALLUP

**LEGEND**

**AWDT**  
PM-PEAK

NEW DAILY TRAFFIC  
NEW PEAK-HOUR TRIPS



TRIP DISTRIBUTION

**FIGURE 4**

TOTAL DEVELOPMENT  
TRIP DISTRIBUTION  
PM PEAK-HOUR  
CARS AND TRUCKS

Date: March 27, 2023 - 6:59pm / User: jaywiller  
Path: K:\SNO\_H70\2022\22-083\_Freeman\_Rd\_Logistics\Update April 2023\Figures\Freeman\_Rd\_Logistics - 150\_Figures.dwg / Xref: