

PRMH20240371

FULL SIZED LEDGIBLE COLOR
PLANS ARE REQUIRED TO BE
PROVIDED BY THE PERMITTEE ON
SITE FOR ALL INSPECTIONS
(MIN. PLAN SIZE 24" X 36")

City of Puyallup
Building
ACCEPTED

JMontgomery
03/19/2024
10:04:48 AM



GDM
ARCHITECTS - ENGINEERS

4317 6th Avenue SE, Suite 300
Lacey, WA 98503
ph 360-318-7095
www.gdm-ae.com

1000 West Steuben St, Unit 3
Bingen, WA 98605
ph 541-436-4723
www.gdm-ae.com

1401 W 34th Ave, Suite 200
Anchorage, AK 99503
ph 907-917-2957
www.gdm-ae.com

2600 American Road, Suite 100
Rio Rancho, NM 87124
ph 575-300-1481
www.gdm-ae.com

City of Puyallup
Development & Permitting Services
ISSUED PERMIT

| | |
|-------------|--------------|
| Building | Planning |
| Engineering | Public Works |
| Fire | Traffic |

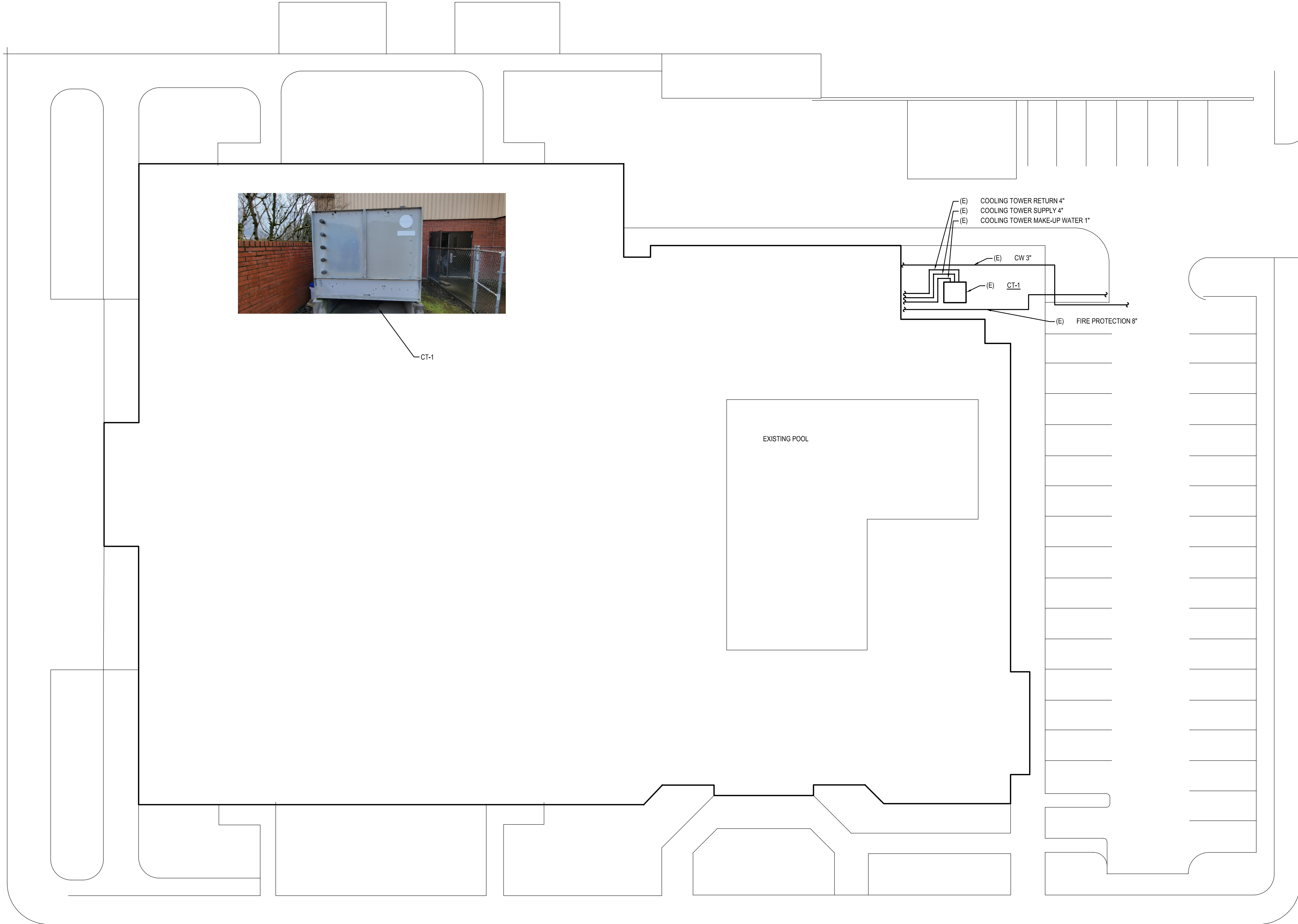

THIS DRAWING WAS PRODUCED FROM ORIGINAL AS-BUILT DRAWINGS AND FIELD OBSERVATIONS, AND MAY NOT REPRESENT AN ACCURATE AS-BUILT CONDITION. DISCREPANCIES MAY BE ENCOUNTERED, AND IT IS THE CONTRACTOR'S RESPONSIBILITY TO FIELD VERIFY ALL CONDITIONS.



PROJECT TITLE
Puyallup High School Pool Mechanical Repairs

PROJECT ADDRESS
105 7th St SW
Puyallup, WA 98371

OWNER INFORMATION
Puyallup School District
302 2nd St SE
Puyallup, WA 98372

DRAWING REVISIONS

DRAWING ISSUE
Construction Set

DRAWING ISSUE DATE
2024/01/30

DRAWN JB
CHECKED JB
GDM PROJECT # 22-162
CLIENT PROJECT #

SHEET TITLE

Site Plan

SHEET NUMBER
K004
SHEET OF