

DRAWING SYMBOLS

ABBREVIATIONS

VICINITY MAP

PROJECT DIRECTORY

SHEET INDEX

H



NORTH INDICATOR

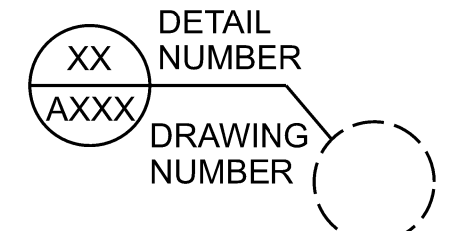

DETAIL NUMBER DRAWING NUMBER

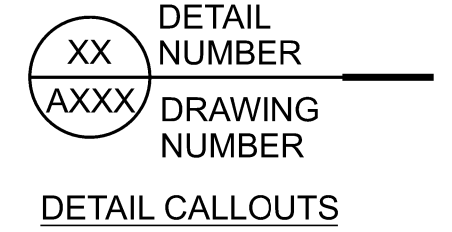

DETAIL NUMBER DRAWING NUMBER



MATCH LINE

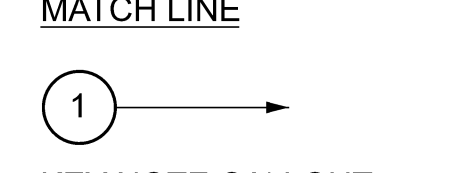

KEY NOTE CALLOUT

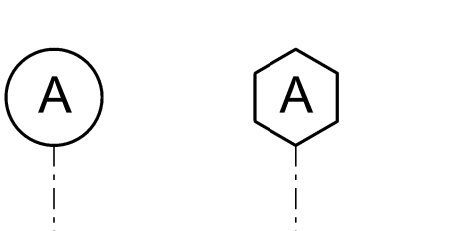

EXISTING GRID NEW GRID

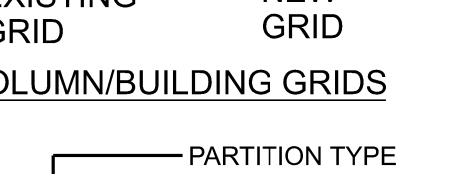

COLUMN/BUILDING GRIDS

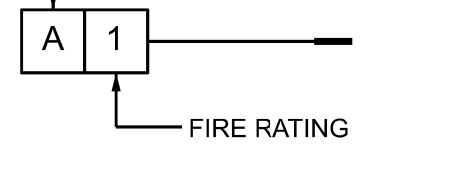

PARTITION TYPE CALLOUT



ELEVATION/DATUM CALLOUT

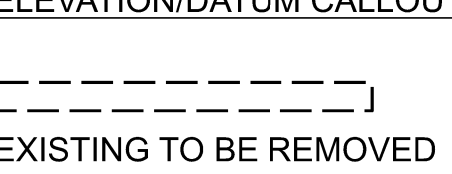

EXISTING TO BE REMOVED

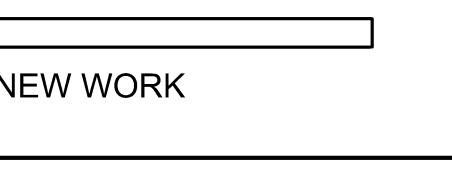

NEW WORK

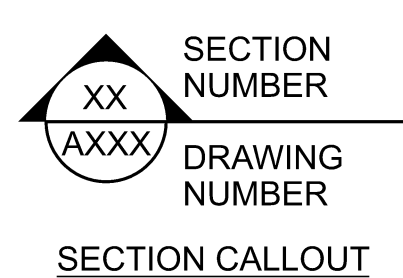

SECTION CALLOUT

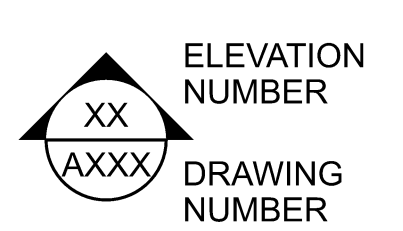

ELEVATION CALLOUT

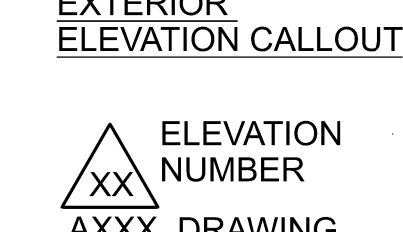

ELEVATION CALLOUT

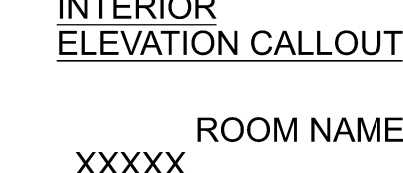

ROOM NAME CALLOUT

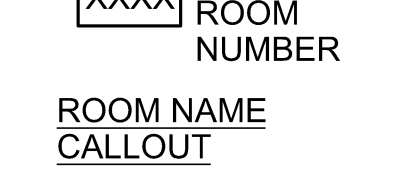

ROOM NAME CALLOUT

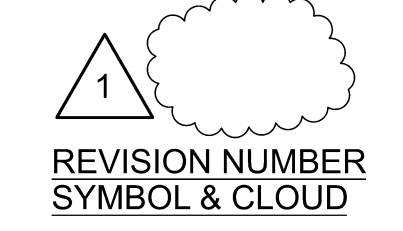

REVISION NUMBER SYMBOL & CLOUD



DOOR/OPENING NUMBER

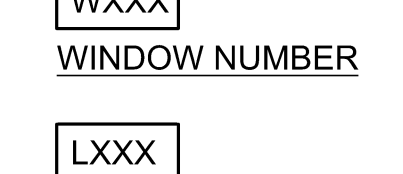

WINDOW NUMBER

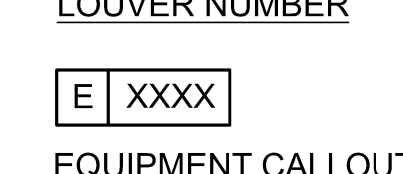

EQUIPMENT CALLOUT



FURNITURE CALLOUT

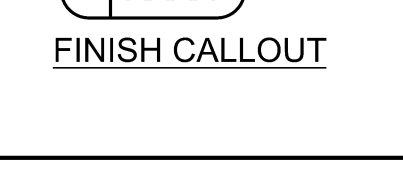

FINISH CALLOUT

Table of abbreviations from A to Z, including terms like AMP, ANCHOR BOLT, ALTERNATING CURRENT, etc.

Table of abbreviations from A to Z, including terms like BALANCE, BULLETIN BOARD, BATTERY CABINET, etc.

Table of abbreviations from F to Z, including terms like FARENHEIT, FIRE ALARM, FABRICATE, etc.

Table of abbreviations from A to Z, including terms like HIGH, HOSE BIBB, HOLLOW CORE, etc.

Table of abbreviations from S to Z, including terms like SOUTH, SUPPLY AIR, SOLID CORE, etc.

Table of abbreviations from A to Z, including terms like INTERNATIONAL BUILDING CODE, INTERCOM, INSIDE DIAMETER, etc.

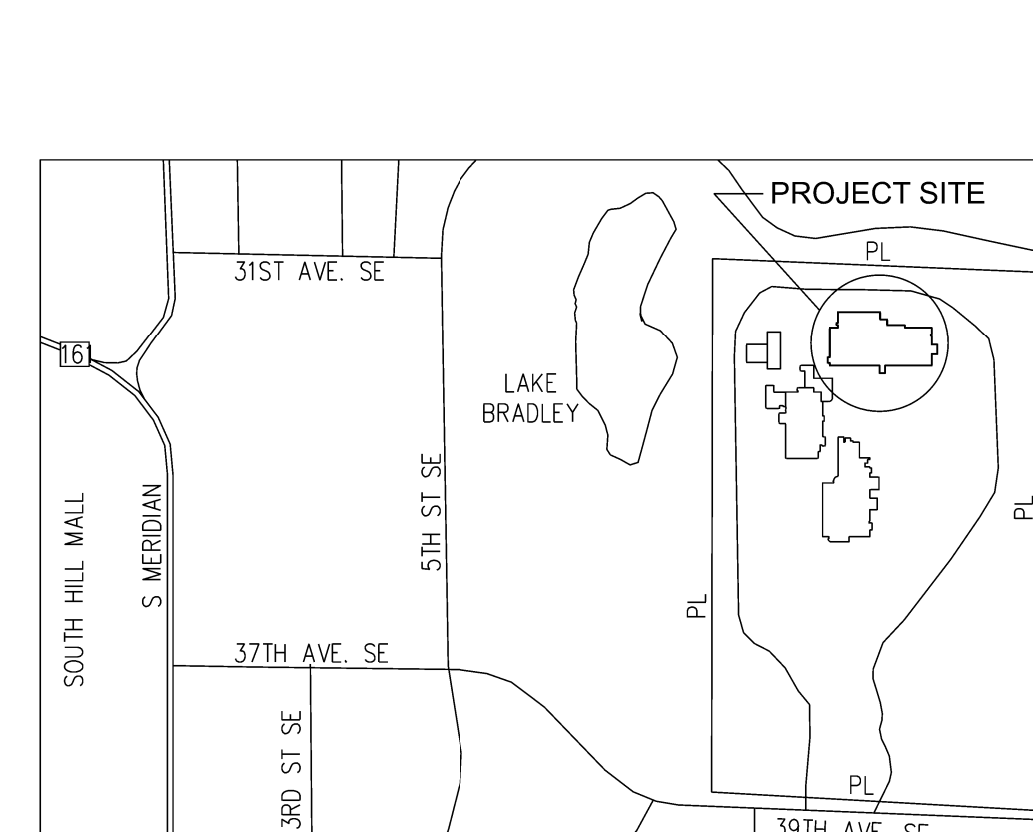

NO SCALE

OWNER: BENAROYA CAPITAL, LLC. 9675 SE 36TH STREET, SUITE 115. MERCER ISLAND, WA 98040.

ARCHITECT: CASCADE MISSION CRITICAL, LLC. 6210 36TH AVENUE N.E. SEATTLE, WA 98115.

STRUCTURAL ENGINEER: BRIENEN STRUCTURAL ENGINEERS. 1316 CENTRAL AVENUE SOUTH, SUITE 200. KENT, WA 98032.

ARCHITECTURAL: A-000-08 GENERAL INFORMATION, A-101-08 OVERALL SITE PLAN, A-102-08 OVERALL LEVEL 01 FLOOR PLAN, A-103-08 ENLARGED FLOOR PLAN.

STRUCTURAL: A-301-08 BATTERY & UPS ROOM, A-601-08 DETAILS SCHEDULES.

City of Puyallup Building ACCEPTED. JMontgomery 03/20/2024 1:39:02 PM.

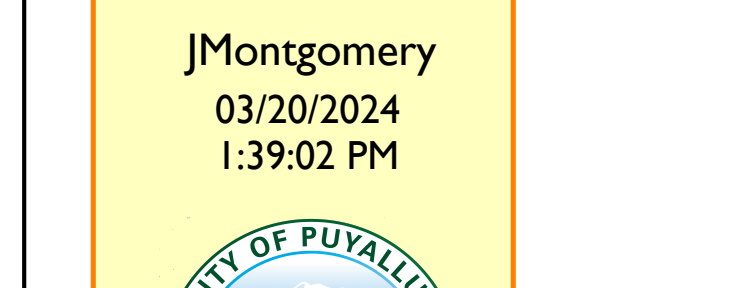

PROJECT INFORMATION

SCOPE OF WORK

PROJECT ADDRESS: 1023 39TH AVENUE SE PUYALLUP, WA 98374-2121.

LEGAL DESCRIPTION: SECTION 03 TOWNSHIP 19 RANGE 04 QUARTER 43 PARCEL "1" OF ROS 2007-04-30-5001.

WORK UNDER THIS PERMIT: INTERIOR TENANT IMPROVEMENTS TO CONSTRUCT 1,474 S.F. BATTERY ROOM AND 2,223 S.F. UPS ELECTRICAL ROOM.

WORK UNDER SEPARATE PERMITS: ELECTRICAL WORK.

FULL SIZED LEDGIBLE COLOR PLANS ARE REQUIRED TO BE PROVIDED BY THE PERMITTEE ON SITE FOR ALL INSPECTIONS (MIN. PLAN SIZE 24" X 36").

CODE INFORMATION

APPLICABLE CODES

WASHINGTON BUILDING CODE, 2018 EDITION; WASHINGTON FIRE CODE, 2018 EDITION; WASHINGTON ADMINISTRATIVE CODE WAC SECTION 51-54A-1207.

LAND USE CODES

PUYALLUP MUNICIPAL CODE; EXISTING ZONING DESIGNATION: MP - BUSINESS PARK; PROPOSED ZONING DESIGNATION: MP - BUSINESS PARK.

BUILDING CODE INFORMATION

BUILDING OCCUPANCY GROUP: TYPE B, DATA CENTER; TYPE OF CONSTRUCTION: TYPE IIA, FULLY SPRINKLERED.

LAND USE CODE INFORMATION

EXISTING SITE AREA: 15.77ACRES.

Approval of submitted plans is not an approval of omissions or oversights by this office or noncompliance with any applicable regulations of local government.

GENERAL NOTES

- 1. DO NOT SCALE THE DRAWINGS.
2. THE DRAWINGS AND SPECIFICATIONS ARE COMPLEMENTARY. WHAT IS SHOWN ON ONE SHALL BE CONSTRUED TO BE REQUIRED BY BOTH.
3. THE CONTRACTOR SHALL VERIFY ALL FIELD CONDITIONS PRIOR TO COMMENCING ANY WORK.

PLAN SYMBOLS

D

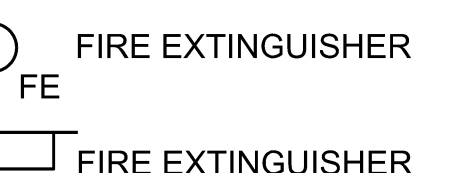

FIRE EXTINGUISHER

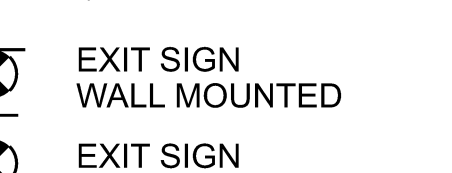

FIRE EXTINGUISHER CABINET



EXIT SIGN WALL MOUNTED

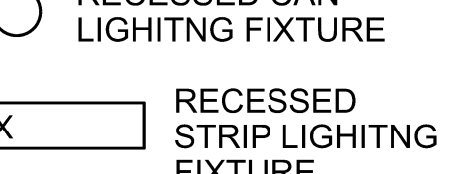

EXIT SIGN CEILING MOUNTED



RECESSED TROFFER LIGHTING FIXTURE



RECESSED CAN LIGHTING FIXTURE



SURFACE MOUNTED STRIP LIGHTING FIXTURE

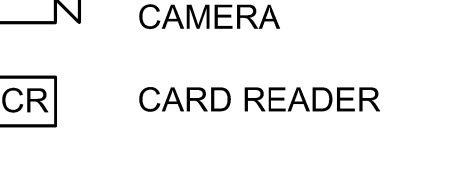

WALL MOUNTED LIGHTING FIXTURE

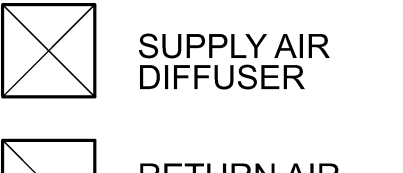

SUPPLY AIR DIFFUSER

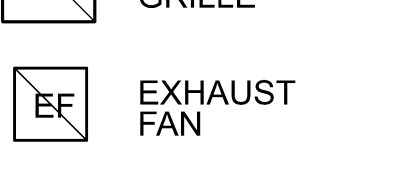

RETURN AIR GRILLE



EXHAUST FAN



PUBLIC ANNOUNCEMENT SPEAKER



EMERGENCY POWER OFF SWITCH

A

SECURITY SYMBOLS



SECURITY CAMERA

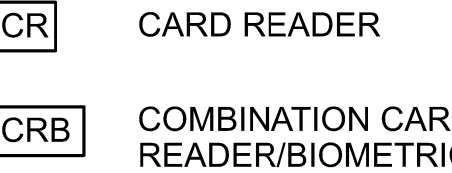

CARD READER

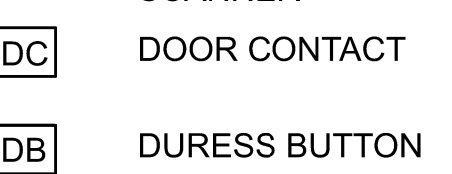

COMBINATION CARD READER/BIOMETRIC SCANNER

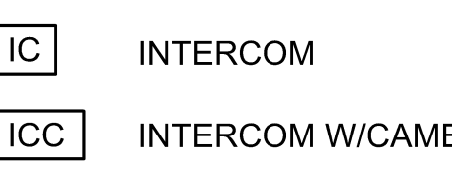

DOOR CONTACT

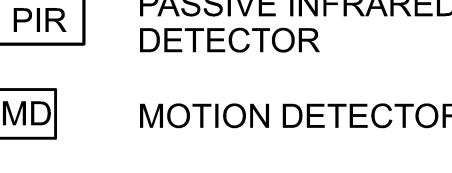

DURESS BUTTON



INTERCOM



INTERCOM W/CAMERA

PASSIVE INFRARED DETECTOR

MOTION DETECTOR

PIN PAD



RFID READER

Table of abbreviations from A to Z, including terms like AMP, ANCHOR BOLT, ALTERNATING CURRENT, etc.

Table of abbreviations from F to Z, including terms like FARENHEIT, FIRE ALARM, FABRICATE, etc.

Table of abbreviations from S to Z, including terms like SOUTH, SUPPLY AIR, SOLID CORE, etc.

OWNER: BENAROYA CAPITAL, LLC. Centeris Data Centers 9675 SE 36th St, Suite 115 Mercer Island, WA 98040 +1.253.200.4120

PRCTI20240333

CONSULTANT: City of Puyallup Development & Permitting Services ISSUED PERMIT Building Planning Engineering Public Works Fire Traffic

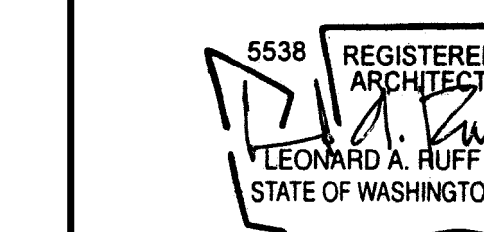

CASCADE MISSION CRITICAL, LLC Data Center Consulting and Design 1023 39th Avenue N.E. Seattle, WA 98115 P: 206-294-1288 www.cascadecommissioncritical.com

CENTERIS VOLTAGE PARK 1023 39th Avenue South East Puyallup, WA 98374-2121 WB02 VOLTAGE PARK UPS & BATTERY ROOMS

Table with columns: ISSUED/REVISED, DATE. Row: PERMIT SUBMITTAL, 3/1/24.

PERMIT SUBMITTAL MARCH 1, 2024

GENERAL NOTES

A-000-08

SITE INFORMATION

PARCEL NO. 0419034037
 ADDRESS: 1023 39TH AVENUE S.E.
 PARCEL AREA: 15.77 ACRES

LEGAL DESCRIPTION
 Section 03 Township 19 Range 04 Quarter 42 LOT 2 OF BLR 2022-03-22-5003 A POR OF BLR 2019-05-22-5002 LY IN CY OF PUYALLUP
 MORE PARTICULARLY DESC AS FOLL COM AT STONE MON MARKING S 1/4 COR OF SEC 3 SD STONE MON LIES N 86 DEG 31 MIN 42
 SEC E 2621.06 FT FROM SE COR OF SD SEC 3 TH N 00 DEG 00 MIN 24 SEC E 2599.51 FT TH S 87 DEG 44 MIN 17 SEC E 496.53 FT TO
 POB TH S 00 DEG 04 MIN W 132.96 FT TH S 16 DEG 29 MIN 57 SEC E 15.96 FT TH S 00 DEG 00 MIN 36 SEC E 335.82 FT TH S 52 DEG 49 MIN
 01 SEC E 132.81 FT TH S 89 DEG 15 MIN 41 SEC E 28.82 FT TH S 82 DEG 14 MIN 13 SEC E 58.63 FT TH S 53 DEG 48 MIN 38 SEC E 78.9 FT TH
 S 89 DEG 41 MIN 48 SEC E 655.79 FT TH S 83 DEG 08 MIN 36 SEC E 199.54 FT TH N 00 DEG 13 MIN 45 SEC E 602.4 FT TH N 87 DEG 44 MIN 17
 SEC W 1118.01 FT TO POB EASE OF REC. OUT OF 04-19-03-4-031 & 4-034 SEG 2019-0472 05/30/19 JP 20190652DC 03/31/22 JP

OVERALL SCOPE OF WORK

DATA CENTER BUILDING (PARCEL 0419034037)
 INTERIOR TENANT IMPROVEMENTS
 CONSTRUCT NEW BATTERY ROOM OF 1,474 S.F. AND NEW
 UPS ELECTRICAL ROOM OF 2,223 S.F.

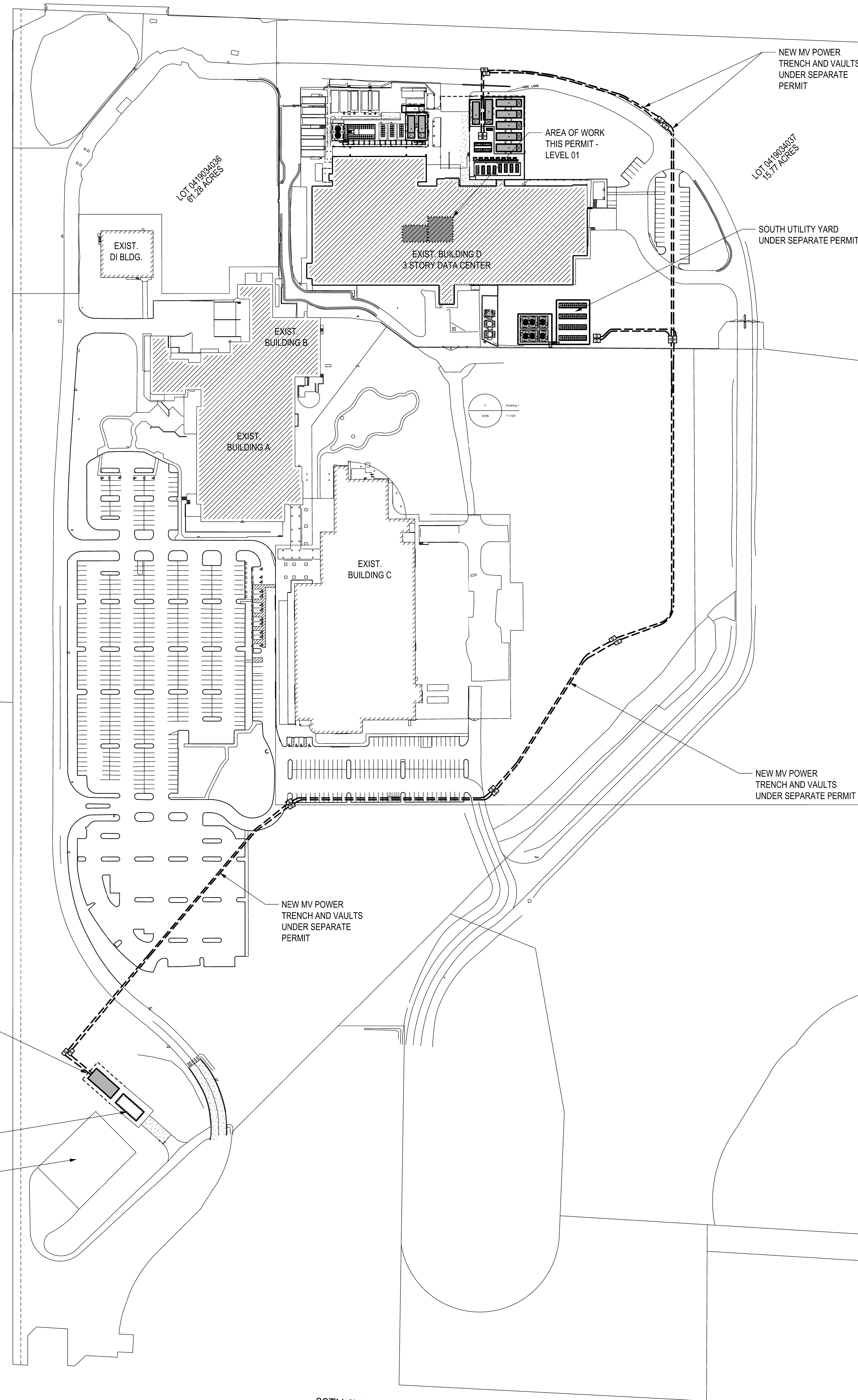

A6 OVERALL SITE PLAN
 SCALE: 1" = 100'

OWNER:
 BENAROYA CAPITAL, LLC
 Centeris Data Centers
 9675 SE 36th St, Suite 115
 Mercer Island, WA 98040
 +1.253.200.4120

PRCTI20240333

CONSULTANT:

City of Puyallup Development & Permitting Services ISSUED PERMIT						
<table border="1"> <tr> <td>Building</td> <td>Planning</td> </tr> <tr> <td>Engineering</td> <td>Public Works</td> </tr> <tr> <td>Fire</td> <td>Traffic</td> </tr> </table>	Building	Planning	Engineering	Public Works	Fire	Traffic
Building	Planning					
Engineering	Public Works					
Fire	Traffic					

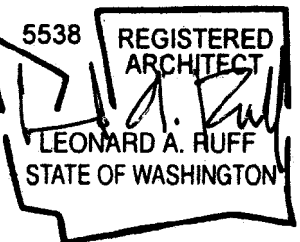

CASCADE MISSION CRITICAL, LLC
 Data Center Consulting and Design
 6210 36th Avenue N.E. Seattle, WA 98115
 P: 206-294-1288 www.cascademissioncritical.com



CENTERIS VOLTAGE PARK
 1023 39th Avenue South East
 Puyallup, WA 98374-2121
 WB02 VOLTAGE PARK
 UPS & BATTERY ROOMS

ISSUED/REVISED	DATE
PERMIT SUBMITTAL	3/1/24

PERMIT SUBMITTAL
 MARCH 1, 2024

OVERALL SITE PLAN

A-101-08

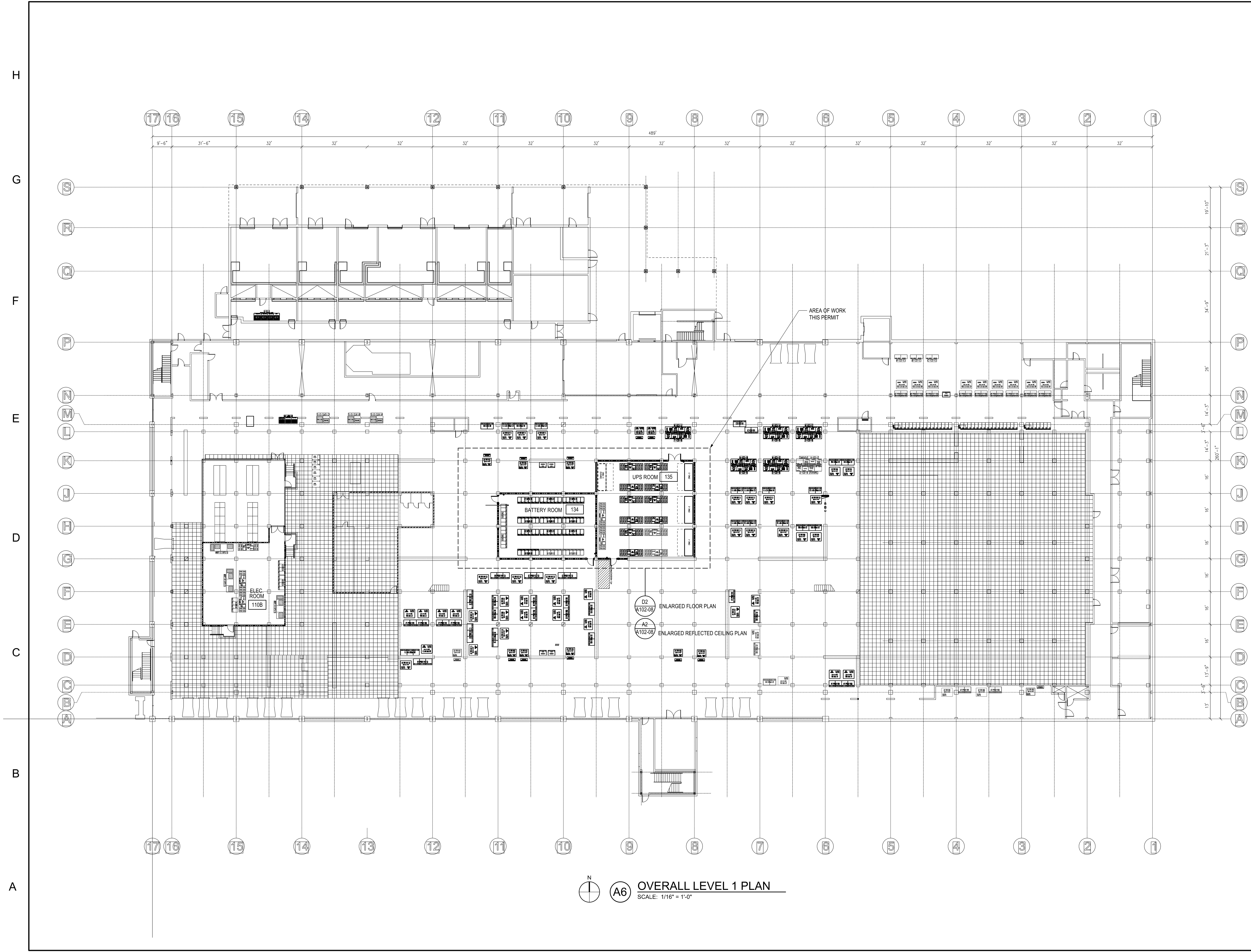

A6 **OVERALL LEVEL 1 PLAN**
 SCALE: 1/16" = 1'-0"

OWNER:
 BENAROYA CAPITAL, LLC
 Centeris Data Centers
 9675 SE 36th St, Suite 115
 Mercer Island, WA 98040
 +1.253.200.4120

PRCTI20240333

CONSULTANT:
 City of Puyallup
 Development & Permitting Services
ISSUED PERMIT
 Building Planning
 Engineering Public Works
 Fire Traffic

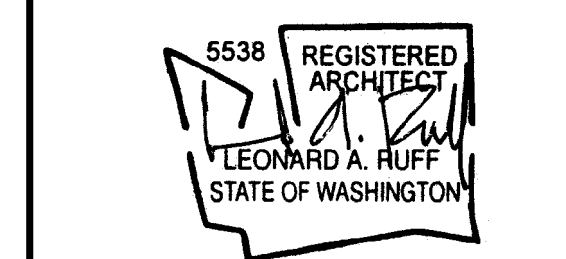

CASCADE MISSION CRITICAL, LLC
 Data Center Consulting and Design
 6210 36th Avenue N.E., Seattle, WA 98115
 P: 206-294-1288 www.cascadecritical.com

CENTERIS VOLTAGE PARK
 1023 39th Avenue South East
 Puyallup, WA 98374-2121
 WB02 VOLTAGE PARK
 UPS & BATTERY ROOMS

ISSUED/REVISED	DATE
PERMIT SUBMITTAL	3/1/24

PERMIT SUBMITTAL
 MARCH 1, 2024
 OVERALL LEVEL 1
 FLOOR PLAN

A102-08

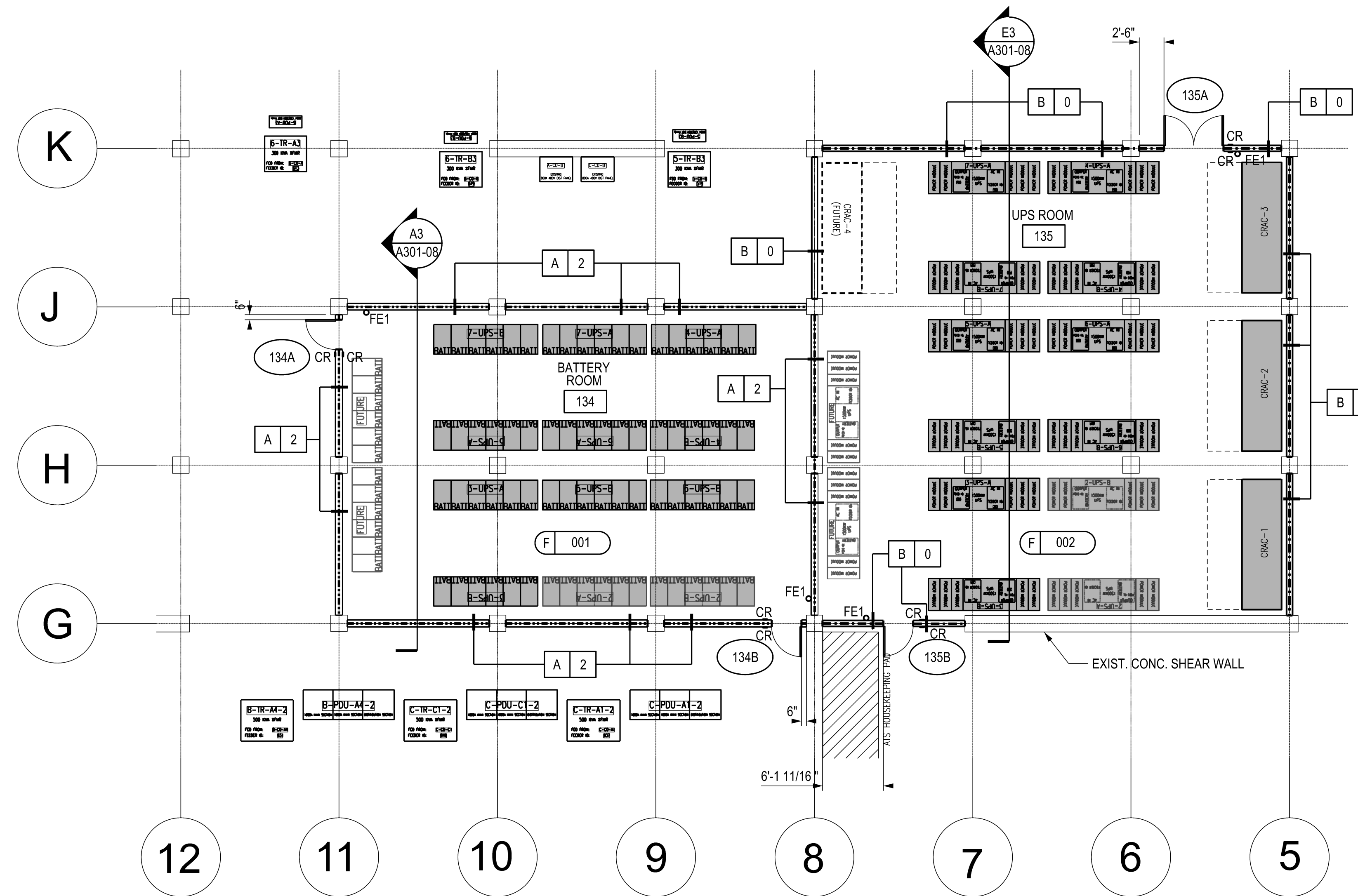

D2 ENLARGED FLOOR PLAN - BATTERY ROOM 134 & UPS ROOM 135
SCALE: 1/8" = 1'-0"

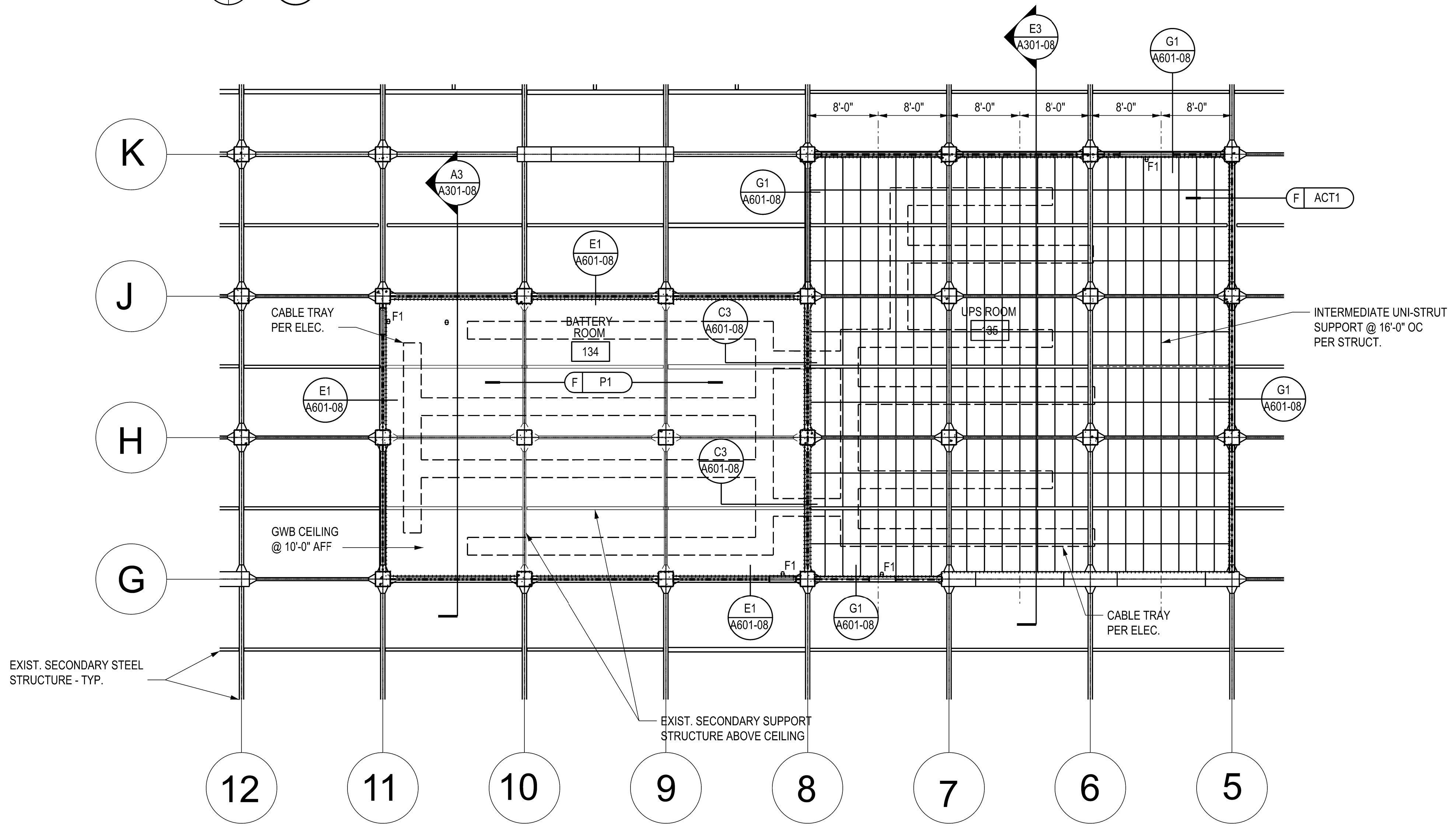

A2 ENLARGED REFLECTED CEILING PLAN - BATTERY ROOM 134 & UPS ROOM 135
SCALE: 1/8" = 1'-0"

BATTERY SUMMARY FOR BATTERY ROOM 134

PROPOSED BATTERY TYPE: NICKEL - ZINC

BATTERY CAPACITY: 38 KWH PER BATTERY CABINET

BATTERY STRING 2-UPS-A: 6 BATTERY CABINETS, 228 KWH
 BATTERY STRING 2-UPS-B: 6 BATTERY CABINETS, 228 KWH
 BATTERY STRING 3-UPS-A: 6 BATTERY CABINETS, 228 KWH
 BATTERY STRING 3-UPS-B: 6 BATTERY CABINETS, 228 KWH
 BATTERY STRING 4-UPS-A: 6 BATTERY CABINETS, 228 KWH
 BATTERY STRING 4-UPS-B: 6 BATTERY CABINETS, 228 KWH
 BATTERY STRING 5-UPS-A: 6 BATTERY CABINETS, 228 KWH
 BATTERY STRING 5-UPS-B: 6 BATTERY CABINETS, 228 KWH
 BATTERY STRING 6-UPS-A: 6 BATTERY CABINETS, 228 KWH
 BATTERY STRING 6-UPS-B: 6 BATTERY CABINETS, 228 KWH
 BATTERY STRING 7-UPS-A: 6 BATTERY CABINETS, 228 KWH
 BATTERY STRING 7-UPS-B: 6 BATTERY CABINETS, 228 KWH
 FUTURE BATTERY STRING: 8-UPS-A: 6 BATTERY CABINETS, 228 KWH
 FUTURE BATTERY STRING: 8-UPS-B: 6 BATTERY CABINETS, 228 KWH

TOTAL BATTERY CAPACITY IN ROOM: 3,648 KWH

WASHINGTON FIRE CODE COMPLIANCE
 MAXIMUM BATTERY CAPACITY PER CONTROL AREA: UNLIMITED FOR NICKEL ZINC BATTERIES PER WAC 51-54A-1207

SEPARATION BETWEEN BATTERIES: 0'-0" PER APPROVED HAZARD MITIGATION ANALYSIS

MAXIMUM CAPACITY PER BATTERY STRING: 228 KWH PER APPROVED HAZARD MITIGATION ANALYSIS

REQUIRED BATTERY ROOM SEPARATION: 2 HOURS

REQUIRED UPS ROOM SEPARATION: 0 HOURS

OWNER:
 BENAROYA CAPITAL, LLC
 Centeris Data Centers
 9675 SE 36th St, Suite 115
 Mercer Island, WA 98040
 +1.253.200.4120

PRCTI20240333

CONSULTANT:
 City of Puyallup
 Development & Permitting Services
 ISSUED PERMIT
 Building Planning
 Engineering Public Works
 Fire Traffic

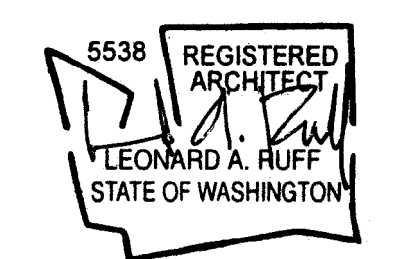

CASCADE MISSION CRITICAL, LLC
 Data Center Consulting and Design
 6210 36th Avenue N.E., Seattle, WA 98115
 P: 206-294-1288 www.cascadecritical.com

CENTERIS VOLTAGE PARK
 1023 39th Avenue South East
 Puyallup, WA 98374-2121
 WB02 VOLTAGE PARK
 UPS & BATTERY ROOMS

ISSUED/REVISED DATE
 PERMIT SUBMITTAL 3/1/24

PERMIT SUBMITTAL
 MARCH 1, 2024

LEVEL 1
 ENLARGED FLOOR PLAN
 BATTERY ROOM 134
 UPS ROOM 135

A-103-08

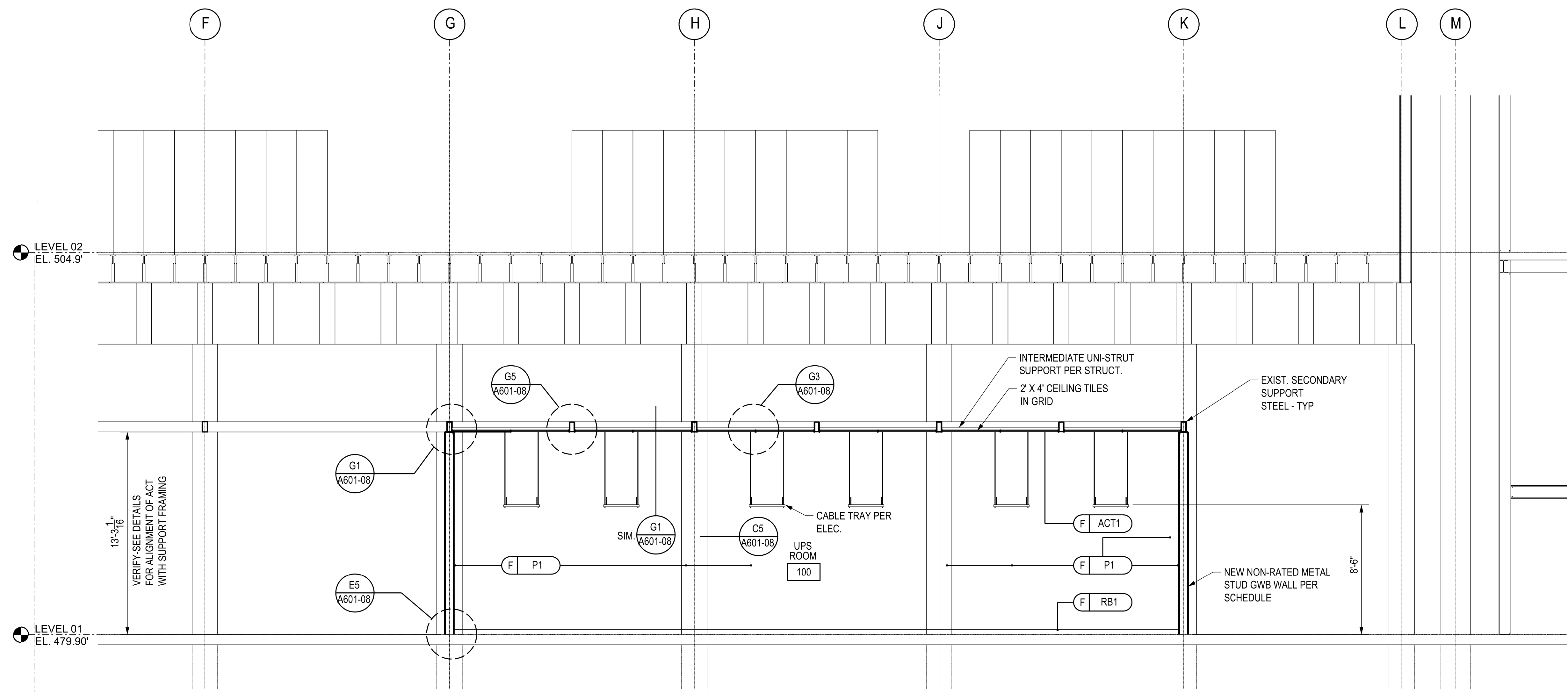

E3 UPS ROOM SECTION
SCALE: 1/4" = 1'-0"

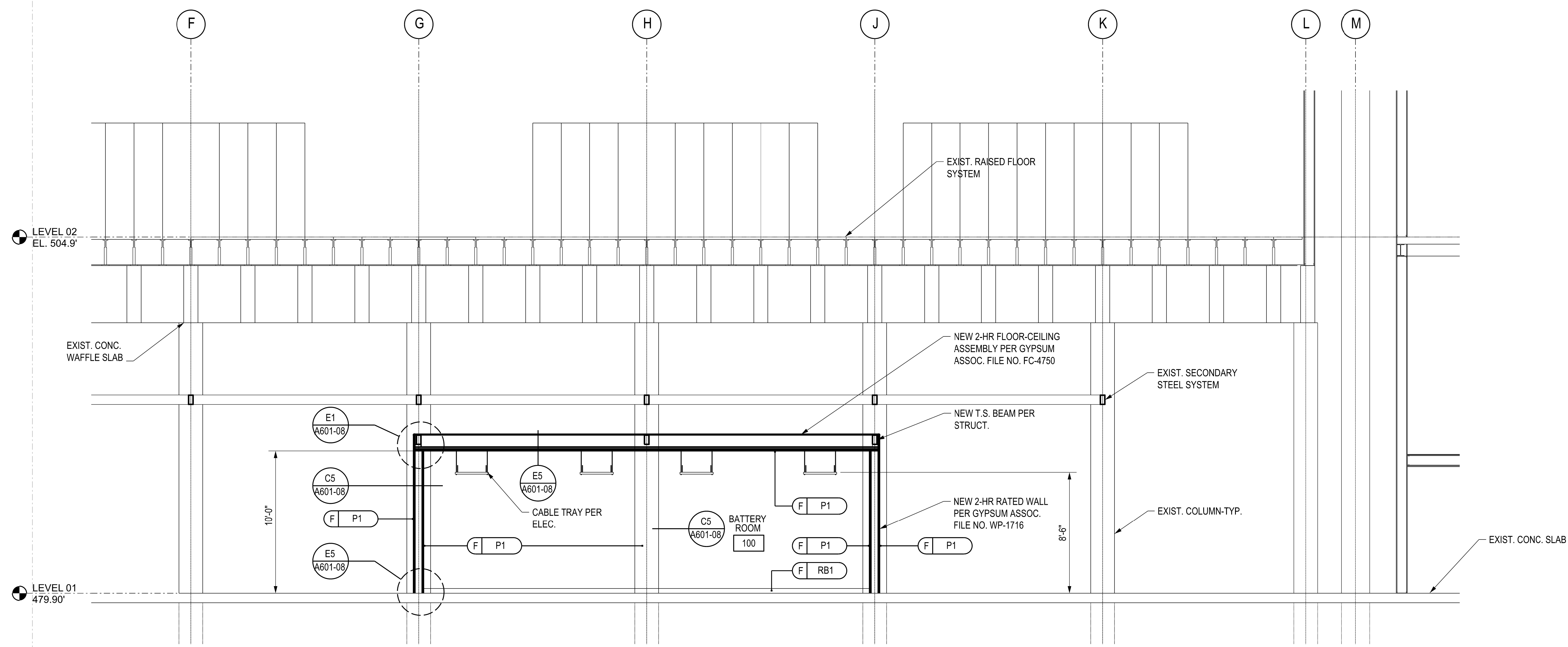

A3 BATTERY ROOM SECTION
SCALE: 1/4" = 1'-0"

OWNER:
BENAROYA CAPITAL, LLC
Centeris Data Centers
9675 SE 36th St, Suite 115
Mercer Island, WA 98040
+1.253.200.4120

PRCTI20240333

CONSULTANT:

City of Puyallup Development & Permitting Services ISSUED PERMIT	
Building	Planning
Engineering	Public Works
Fire	Traffic

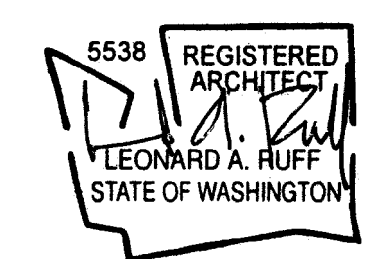

CASCADE MISSION CRITICAL, LLC
Data Center Consulting and Design
6210 36th Avenue N.E. Seattle, WA 98115
P: 206-294-1288 www.cascadecommissioncritical.com

CENTERIS VOLTAGE PARK
1023 39th Avenue South East
Puyallup, WA 98374-2121
WB02 VOLTAGE PARK
UPS & BATTERY ROOMS

ISSUED/REVISED	DATE
PERMIT SUBMITTAL	3/1/24

PERMIT SUBMITTAL
MARCH 1, 2024

SECTIONS

A-301-08

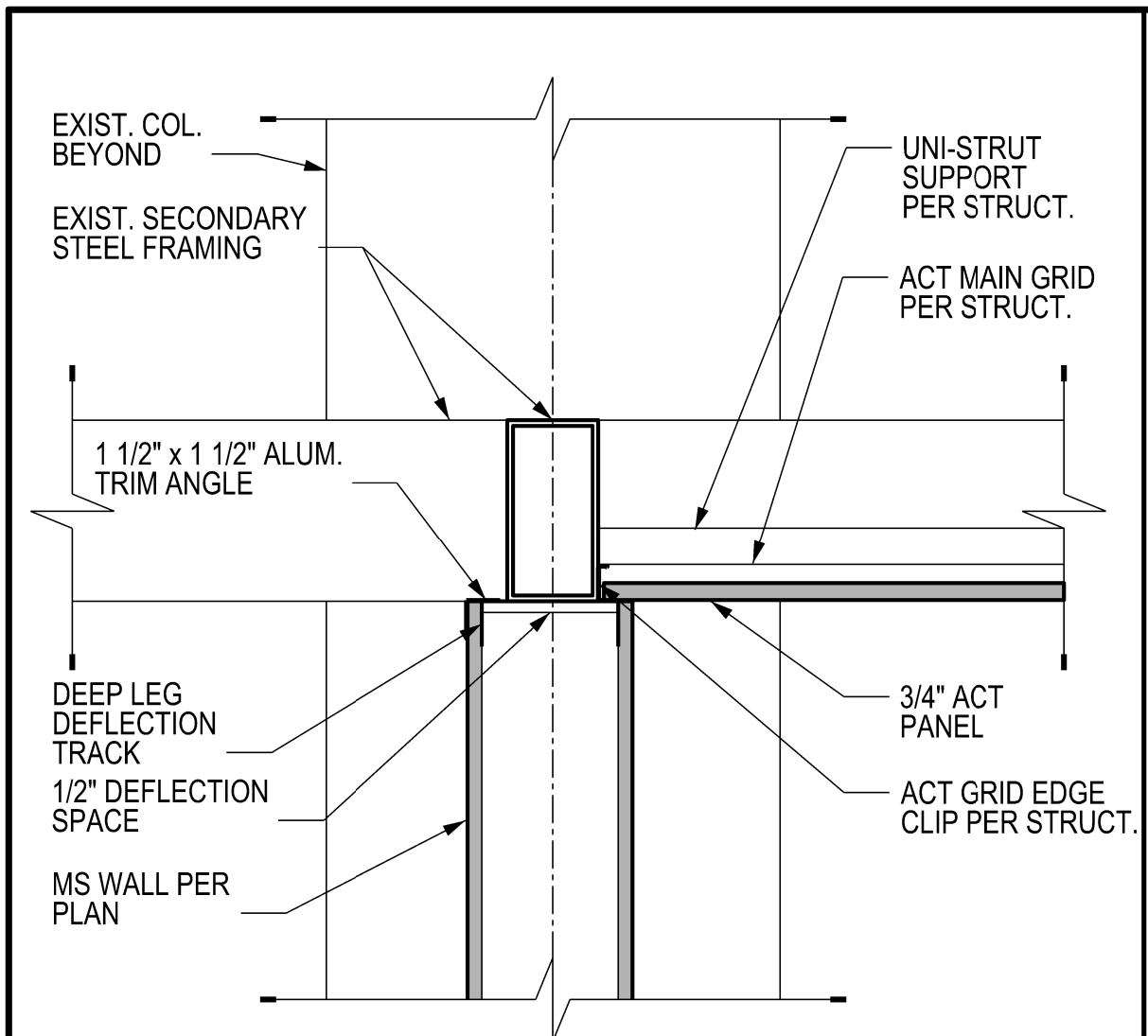

G1 ACT AT PERIMETER
SCALE: 1 1/2" = 1'-0"

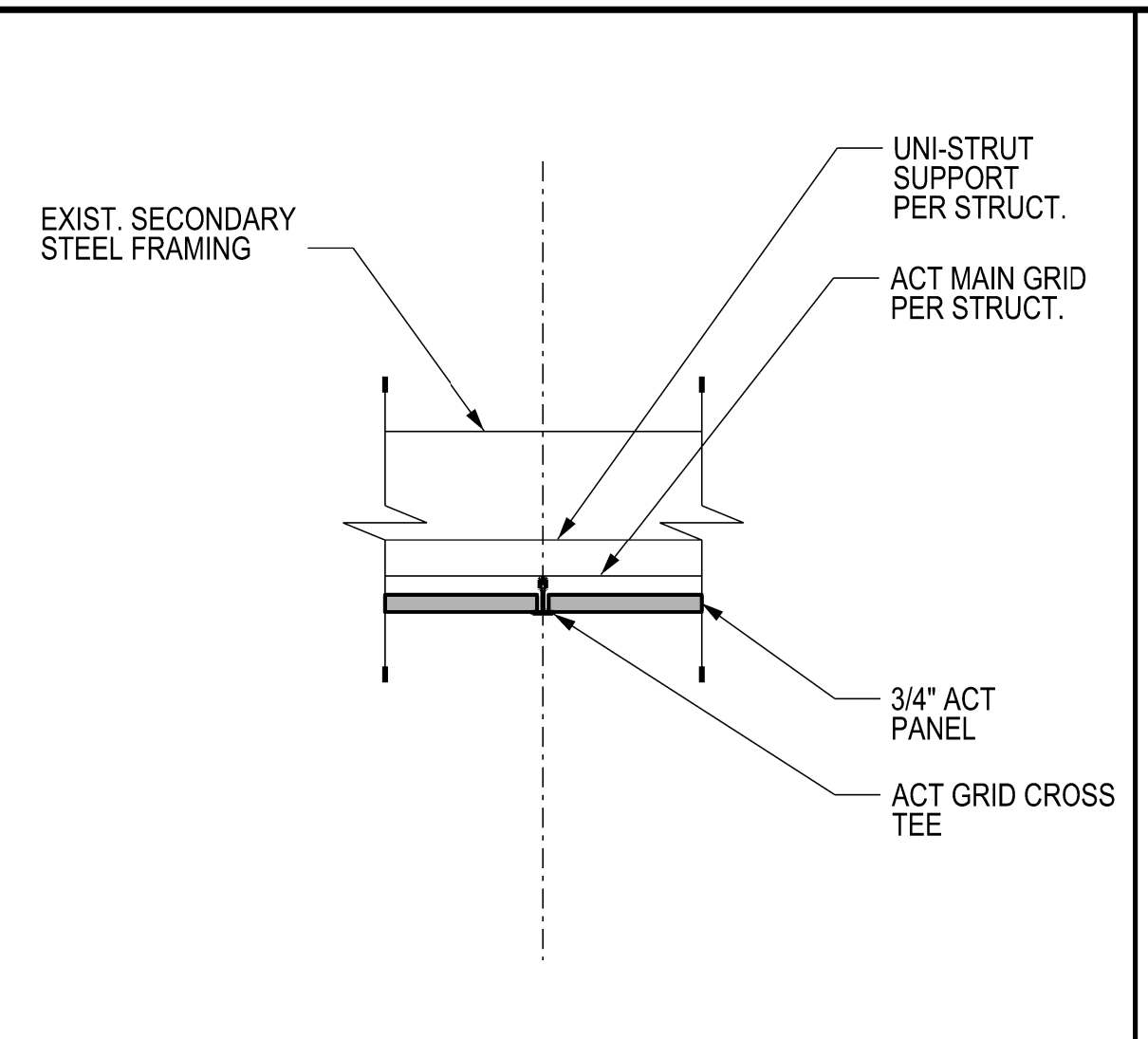

G3 ACT AT CROSS TEE
SCALE: 1 1/2" = 1'-0"

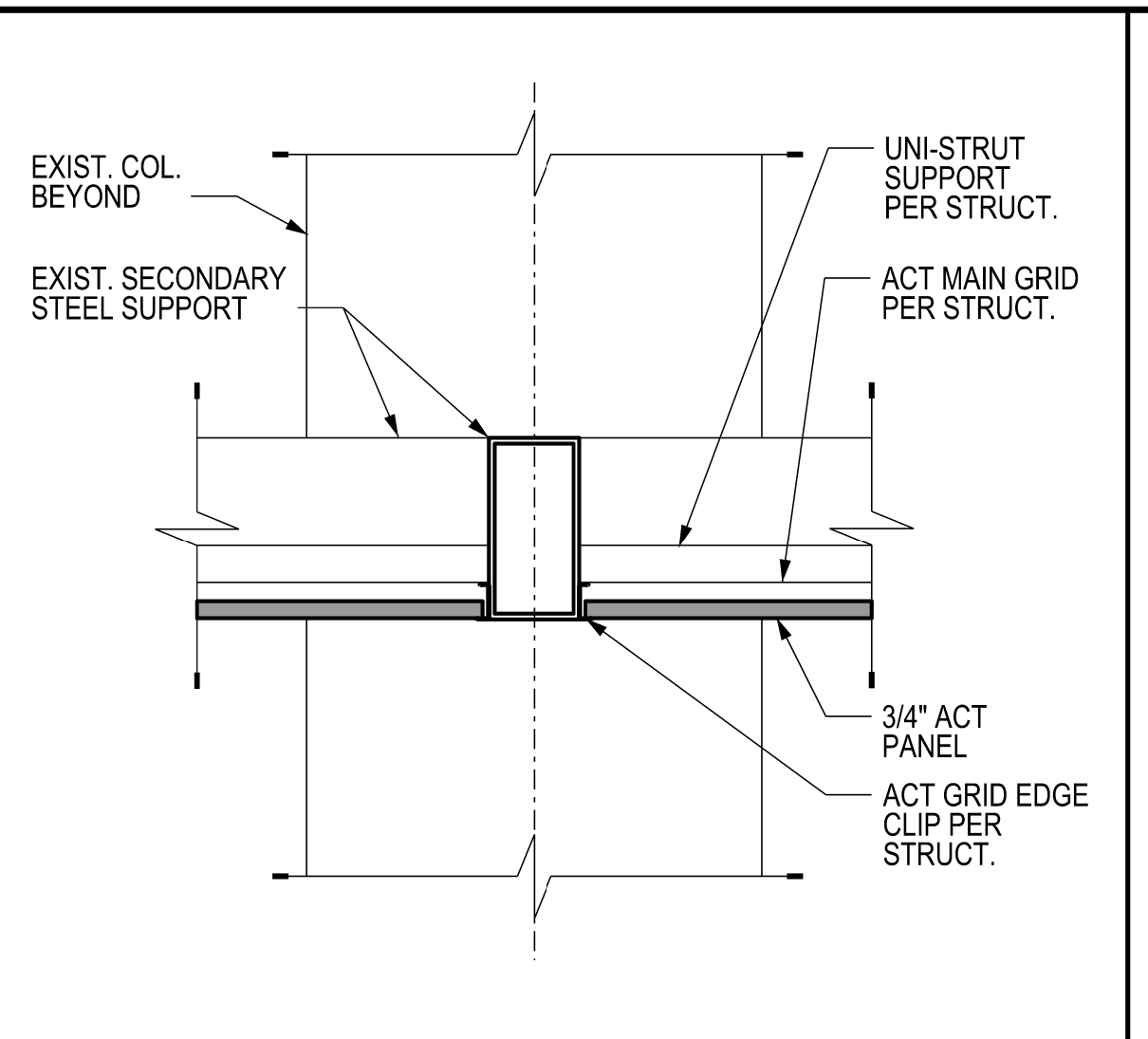

G5 ACT AT CROSS BEAM
SCALE: 1 1/2" = 1'-0"

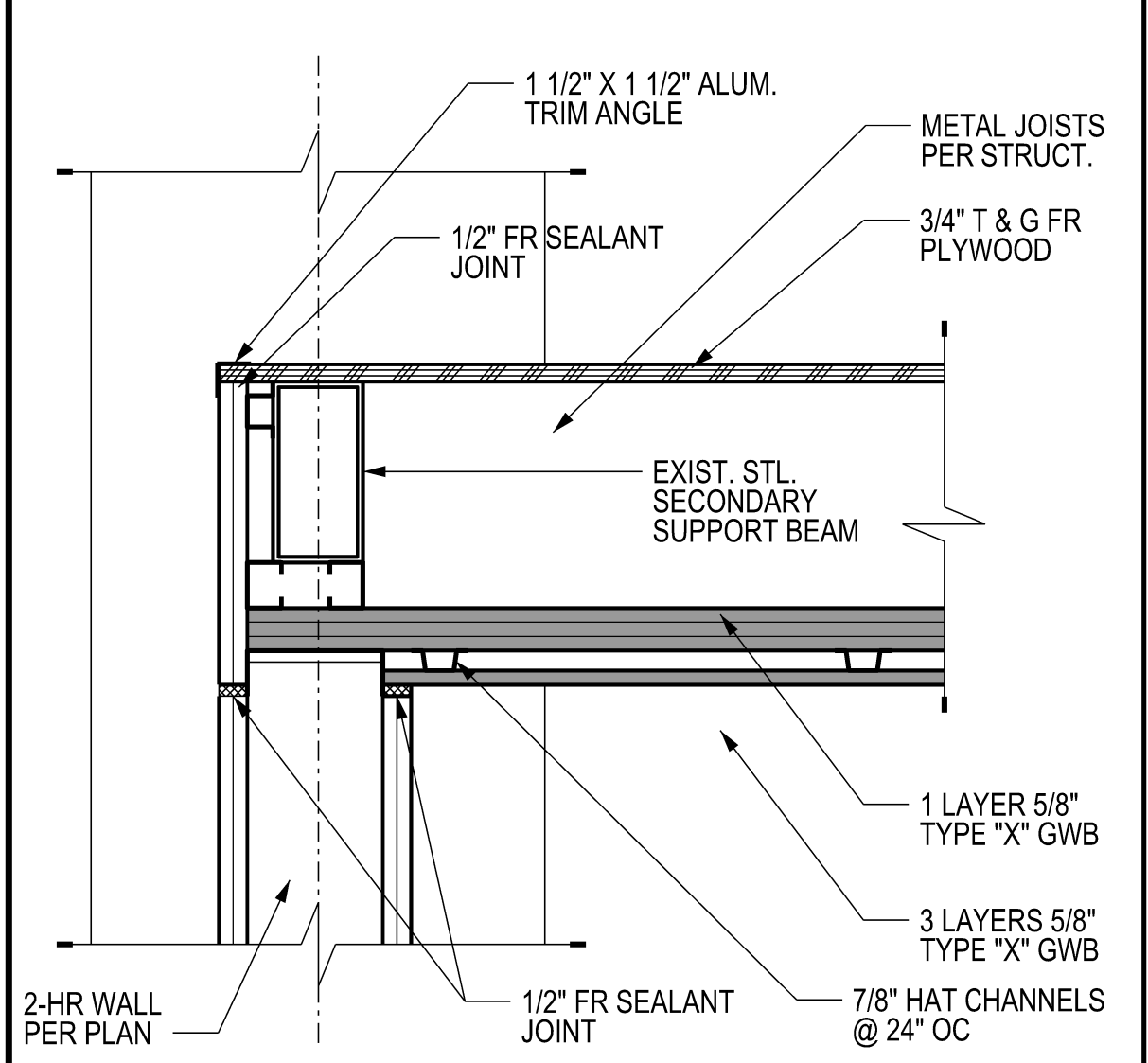

E1 2-HR RATED LID AT PERIMETER
SCALE: 1 1/2" = 1'-0"

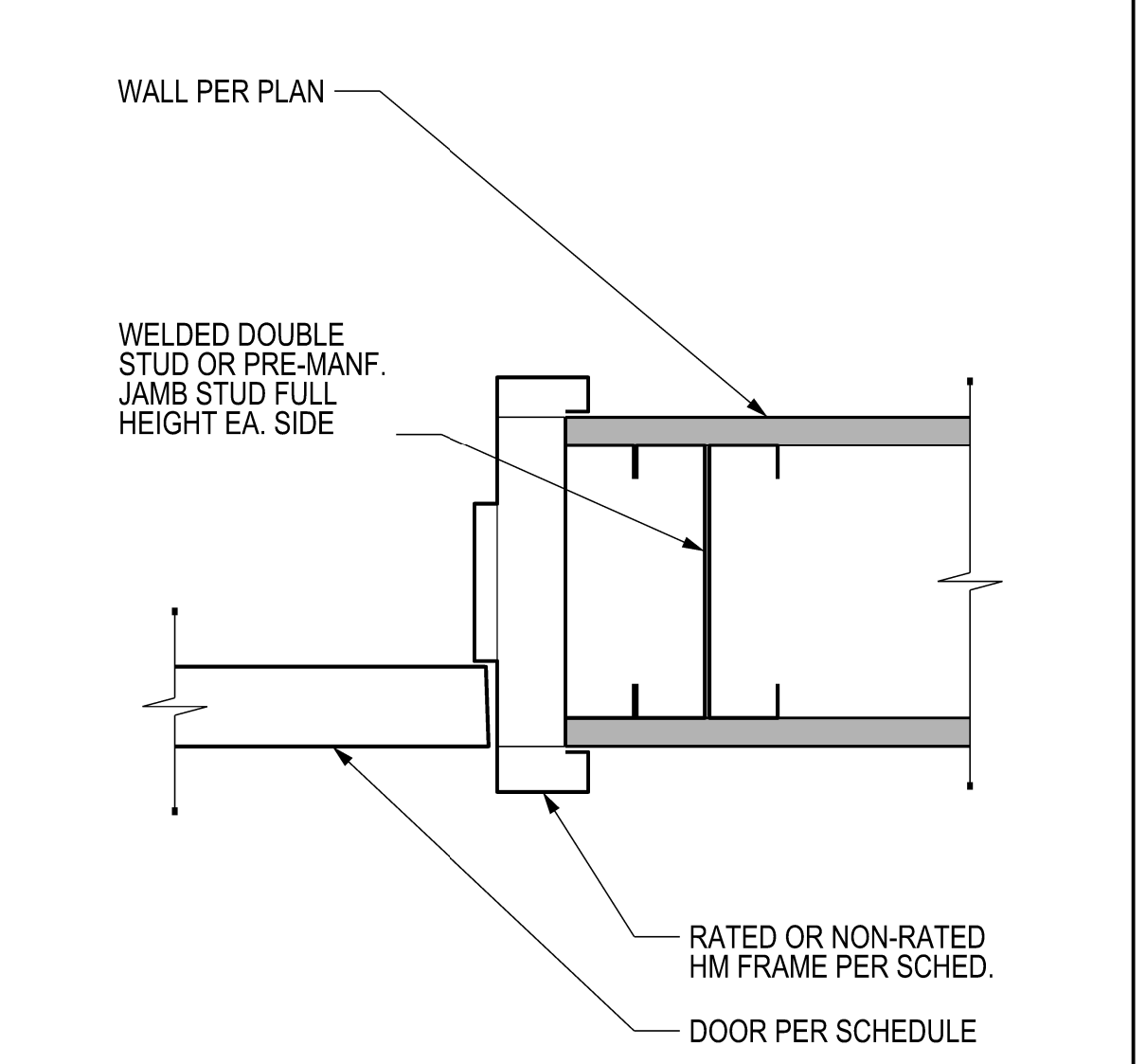

E3 TYP. DOOR JAMB-RATED & NON-RATED - HEAD SIM.
SCALE: 3" = 1'-0"

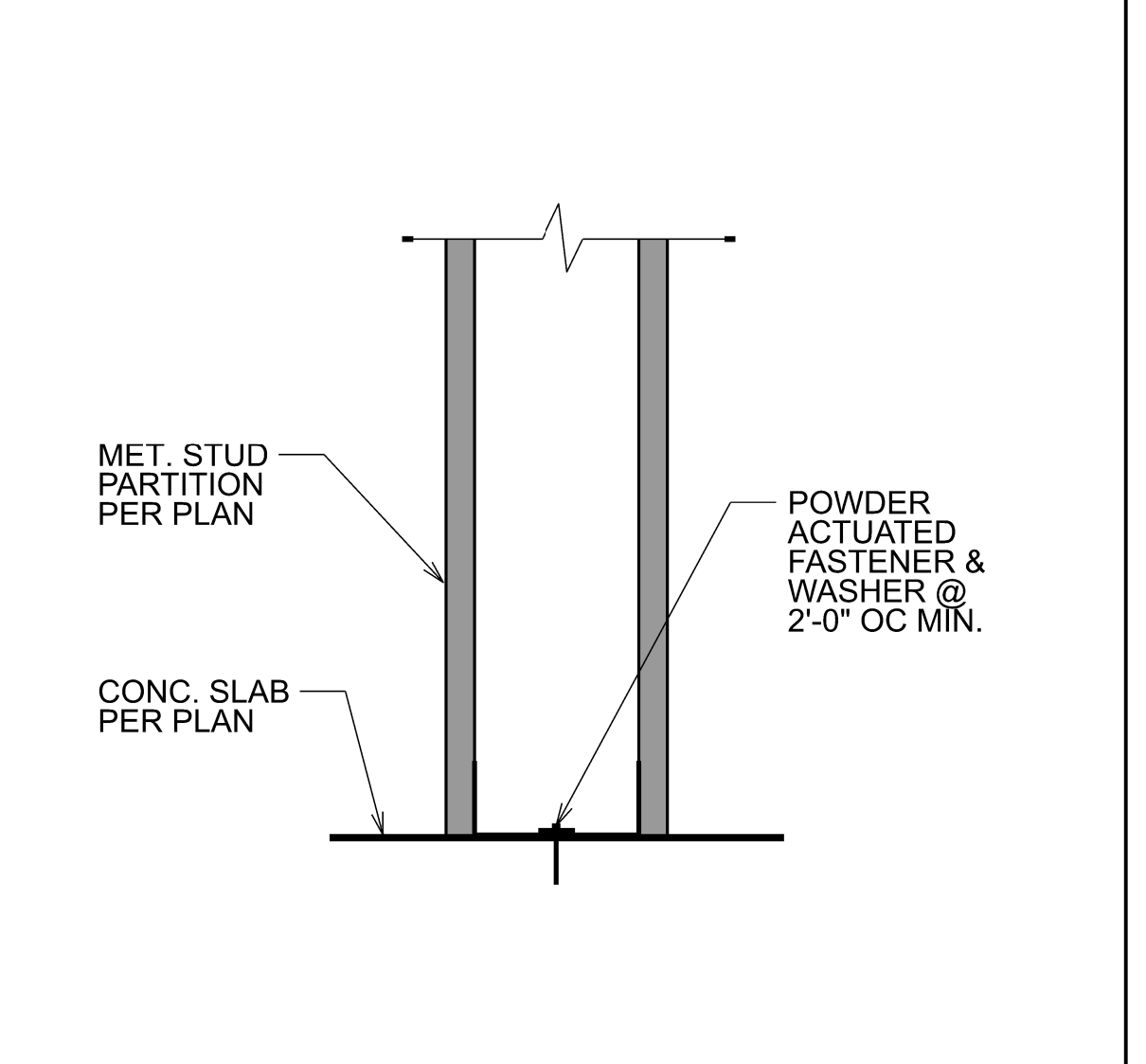

E5 METAL STUD PARTITION - TYP. SILL
SCALE: 3" = 1'-0" MSPSL-01

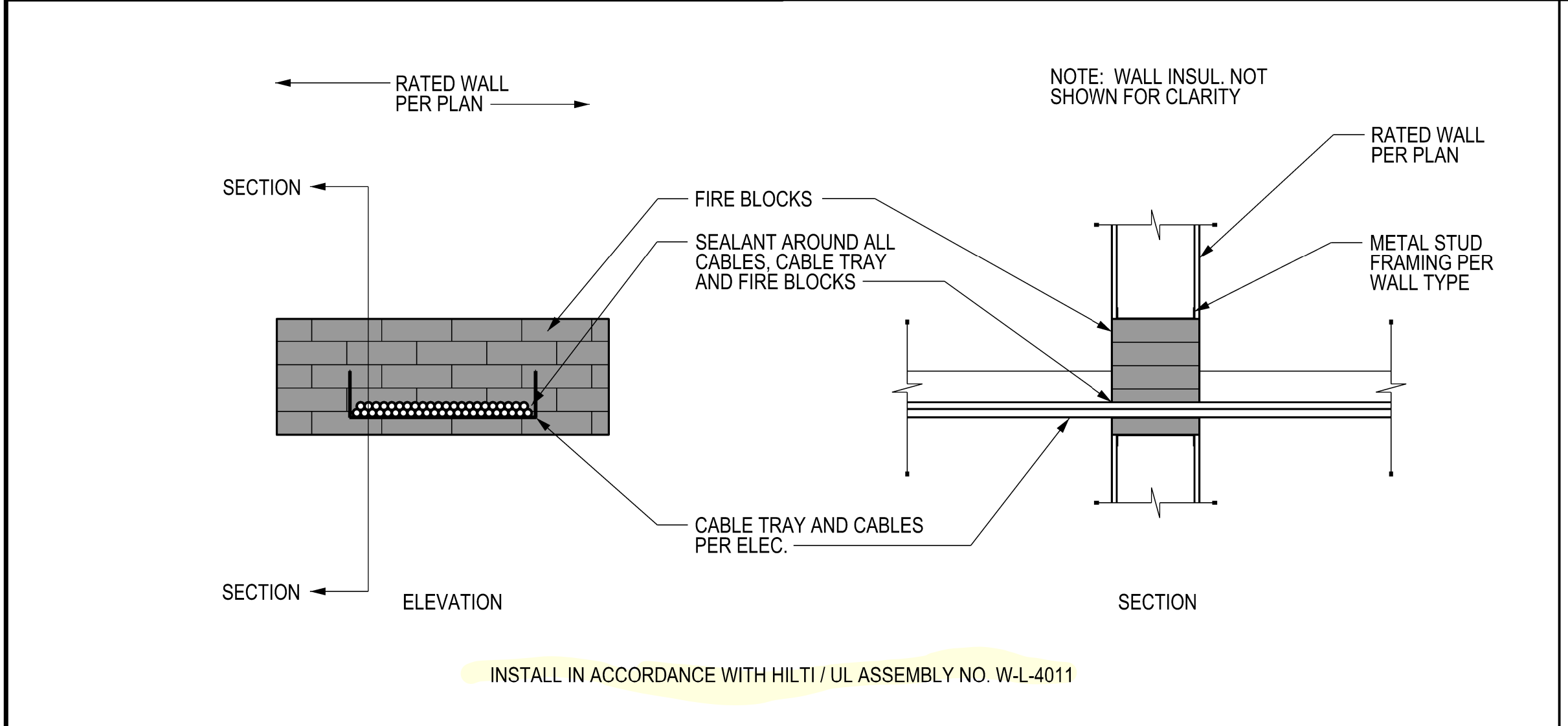

C1 FIRE STOP AT CABLETRAY 2-HOUR RATED
SCALE: 3/4" = 1'-0"

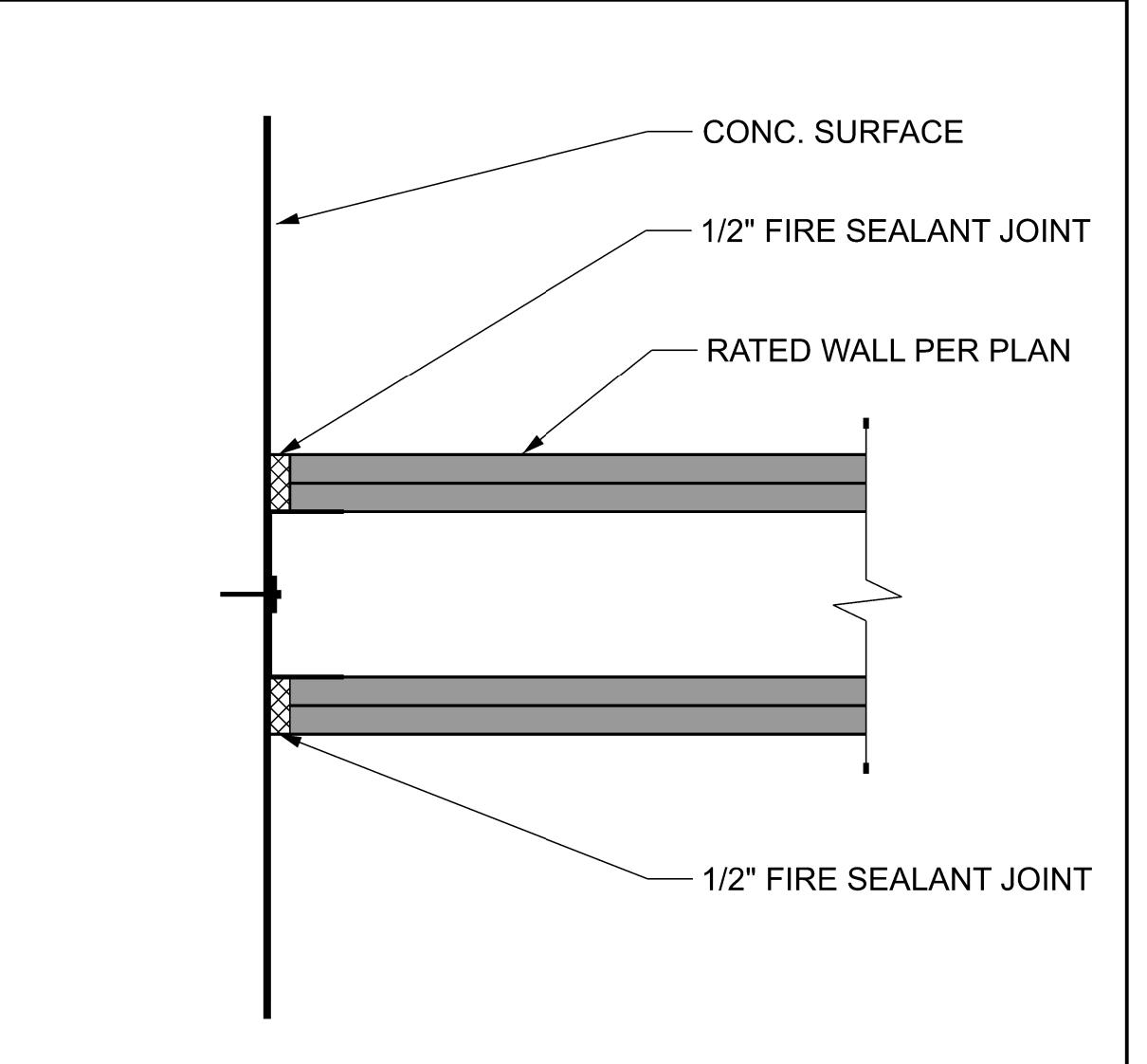

C5 RATED METAL STUD PARTITION - TO CONCRETE
SCALE: 3" = 1'-0" MSPSL-01

OPENING SCHEDULE

NO.	TYPE	CONFIG.	WIDTH	HEIGHT	MAT.	F.R.	FRAME MAT.	FRAME F.R.	HW.	SILL	JAMB	HEAD	COMMENTS
134A	A	SGL	3'-0"	8'-0"	HM	45 MIN.	HM-PTD.	45 MIN.	1	---	XXX	XXX	CARD READ IN & OUT.
134B	A	SGL	3'-0"	8'-0"	HM	45 MIN.	HM-PTD.	45 MIN.	1	---	XXX	XXX	CARD READ IN & OUT.
135A	B	PAIR	6'-0"	9'-0"	HM	NR	HM-PTD.	NR	3	---	XXX	XXX	CARD READ IN & OUT.
135B	A	SGL	3'-0"	8'-0"	HM	NR	HM-PTD.	NR	2	---	XXX	XXX	CARD READ IN & OUT.

DOOR TYPES

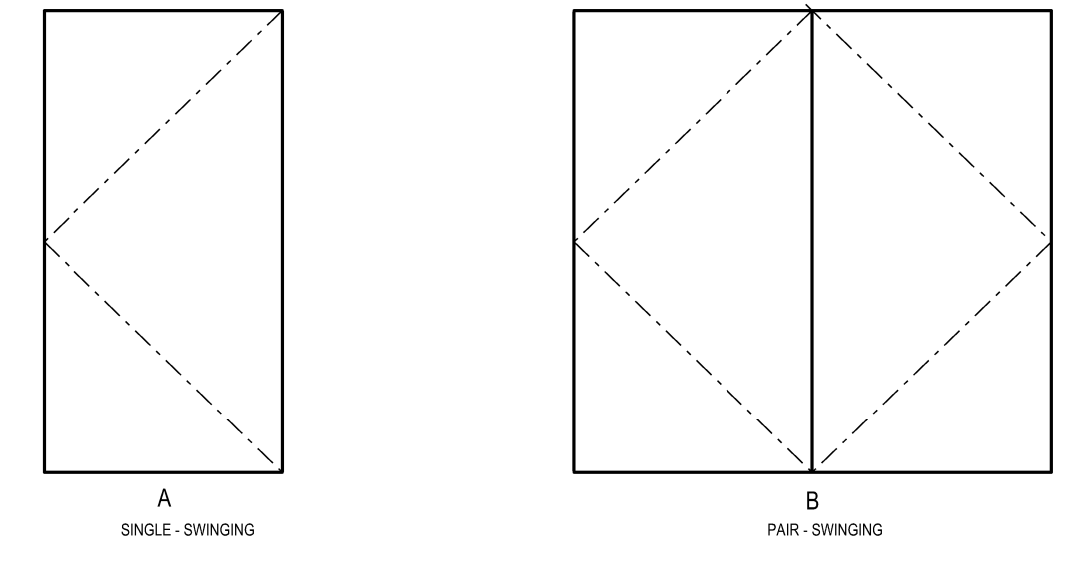

DOOR HARDWARE SCHEDULE

- HW-1 PAIR - NON-RATED**
- HINGES HW-1 4 1/2" X 5 1/2" KEYP.
 - SET POINT LOCK BODY 7838P
 - DOOR HANDLE 7838S
 - DOORSTOP, 2" DIA. X 1/2" DIA.
 - DOORSTOP, 2" DIA. X 1/2" DIA.
 - DOORSTOP, 2" DIA. X 1/2" DIA.
 - DOORSTOP, 2" DIA. X 1/2" DIA.
 - DOORSTOP, 2" DIA. X 1/2" DIA.
 - DOORSTOP, 2" DIA. X 1/2" DIA.
 - DOORSTOP, 2" DIA. X 1/2" DIA.
- HW-2 PAIR - 45 MIN. RATED**
- HINGES HW-2 4 1/2" X 5 1/2" KEYP.
 - SET POINT LOCK BODY 7838P
 - DOOR HANDLE 7838S
 - DOORSTOP, 2" DIA. X 1/2" DIA.
 - DOORSTOP, 2" DIA. X 1/2" DIA.
 - DOORSTOP, 2" DIA. X 1/2" DIA.
 - DOORSTOP, 2" DIA. X 1/2" DIA.
 - DOORSTOP, 2" DIA. X 1/2" DIA.
 - DOORSTOP, 2" DIA. X 1/2" DIA.
 - DOORSTOP, 2" DIA. X 1/2" DIA.
- HW-3 PAIR - 45 MIN. RATED SECURE**
- CONTINUOUS HINGE 2244 X 453
 - CONTINUOUS HINGE 2244 X 453
 - CONTINUOUS HINGE 2244 X 453
 - CONTINUOUS HINGE 2244 X 453
 - CONTINUOUS HINGE 2244 X 453
 - CONTINUOUS HINGE 2244 X 453
 - CONTINUOUS HINGE 2244 X 453
 - CONTINUOUS HINGE 2244 X 453
 - CONTINUOUS HINGE 2244 X 453
 - CONTINUOUS HINGE 2244 X 453
- HW-4 PAIR - GATE**
- 1 1/2" WOOD CHIMNES GUDEN P/MSR/SP
 - DOOR STOP/STOP

PARTITION SCHEDULE

MARK	FRAMING	WALL SHEATHING	GA FILE NO. OR UL NO.	F.R.	SILL	HEAD	COMMENTS
A1	6" METAL STUDS @ 24" OC - GAUGE PER STRUCT.	2 LAYERS 5/8" GWB TYPE "X" BOTH SIDES	GA FILE NO. WP 1716	2-HR.	XX/A501-08	XX/A501-08	PROVIDE 2" DEFLECTION TRACK AT HEAD
B0	6" METAL STUDS @ 24" OC - GAUGE PER STRUCT.	1 LAYER 5/8" GWB	NA	NR	XX/A501-08	XX/A501-08	PROVIDE 2" DEFLECTION TRACK AT HEAD

ROOM FINISH SCHEDULE

ROOM NO.	ROOM NAME	FLOOR	BASE	WALL	CEILING	COMMENTS
134	VP BATTERY ROOM	SC (EXIST)	RB1	P1	P1	APPLY WALL PAINT TO INTERIOR OF ROOM AND EXTERIOR OF ROOM. APPLY RB1 TO INTERIOR OF ROOM AND EXTERIOR OF ROOM.
135	VP UPS ROOM	SC (EXIST)	RB1	P1	ACT1	APPLY WALL PAINT TO INTERIOR OF ROOM AND EXTERIOR OF ROOM. APPLY RB1 TO INTERIOR OF ROOM AND EXTERIOR OF ROOM.

FINISH MATERIALS SCHEDULE

NO.	TYPE	MFG.	DESCRIPTION	COLOR NUMBER	COLOR NAME	COMMENTS
ACT1	ACOUSTICAL TILE CEILING PANELS	USG	2' X 4' x 3/4" PANELS NO. 88389, SQUARE EDGE		WHITE	
P1	PAINT	BENJAMIN MOORE	ECO SPEC. WB INTERIOR LATEX EGG-SHELL N374	2121-70	CHANTILLY LACE	APPLY ON WALLS & GWB CEILINGS
P2	PAINT	BENJAMIN MOORE	ECO SPEC. WB INTERIOR LATEX SEMI-GLOSS N376	2121-70	CHANTILLY LACE	APPLY ON HM DOORS & FRAMES
EP1	EPOXY FLOOR COATING					
SC	SEALED CONCRETE					EXIST.
RB1	RESILIENT BASE	ROPPE	4" COVED BASE	193	BLACK BROWN	EXIST.

EQUIPMENT SCHEDULE

NO.	MFG.	DESCRIPTION	FURNISHED BY	INSTALLED BY
FE1	KIDDE	CLEAN AGENT FIRE EXTINGUISHER 5LB AGENT WEIGHT, 9-B-C RATING, WALL MOUNTED	GC	GC

OWNER:
BENAROYA CAPITAL, LLC
Centeris Data Centers
9675 SE 36th St, Suite 1.15
Mercer Island, WA 98040
+1.253.200.4120

PRCTI20240333

CONSULTANT:

City of Puyallup
Development & Permitting Services
ISSUED PERMIT

Building Planning
Engineering Public Works
Fire Traffic

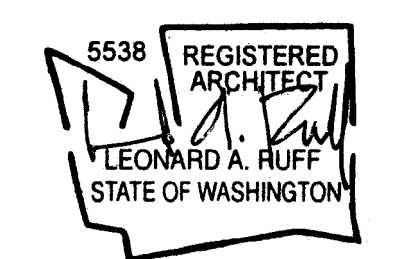

CASCADE MISSION CRITICAL, LLC
Data Center Consulting and Design
6210 36th Avenue N.E., Seattle, WA 98115
P: 206-294-1288 www.cascadecritical.com

CENTERIS VOLTAGE PARK
1023 39th Avenue South East
Puyallup, WA 98374-2121
WB02 VOLTAGE PARK
UPS & BATTERY ROOMS

ISSUED/REVISED	DATE
PERMIT SUBMITTAL	3/1/24

PERMIT SUBMITTAL
MARCH 1, 2024

DETAILS
SCHEDULES

A-601-08