

SUPERCHARGER POST SCHEDULE		SIGNAGE		PARKING STALL ANALYSIS		
CABINET	POST	SIGN TYPE	DEDICATED	VAN ACCESSIBLE		
1	1A	DEDICATED PARKING, VAN ACCESSIBLE			EXISTING STALLS UTILIZED AS A RESULT OF THIS PROJECT	18
	1B	DEDICATED PARKING			PROPOSED DCFC TESLA STALLS	12
	1C	DEDICATED PARKING			PROPOSED NON-EV STALLS	3
2	2A	DEDICATED PARKING			NET STALL COUNT	-3
	2B	DEDICATED PARKING			WHITE SYMBOL	
	2C	DEDICATED PARKING			WHITE TEXT	
3	3A	DEDICATED PARKING			SOLID FEDERAL BLUE #15090 IN FED STANDARD 595C BACKGROUND PAINT. SIGNS SHALL BE REFLECTORIZED.	
	3B	DEDICATED PARKING			WHITE TEXT	
	3C	DEDICATED PARKING			DESIGNED FOR DISABLED ACCESS USE LAST	

The need to verify that there will be no impact to Fruitland Mutual Water Co is required. The proposed charging stations and or equipment cannot be placed over or near their water mains [Site Plan Sheet 1 of 1]

The applicant shall request a sediment control and erosion inspection with a City Engineering Inspector through the CityView portal at least 48 hours in advance of job start. See City Standards 02.03.02 & 05.02.01

Sediment control and erosion procedures shall be practiced eliminating and preventing off site damage. Stormwater runoff originating upgrade of exposed areas shall be controlled to reduce erosion and sediment loss during the period of exposure. Refer to the Stormwater Fact Sheet and City standard details 02.03.02 & 05.02.01 for typical erosion and sedimentation control methods. Attached in CityView

Call Before You Dig. It's the law. Locate all utilities prior to starting work Dial 811 or call 1-800-424-5555.

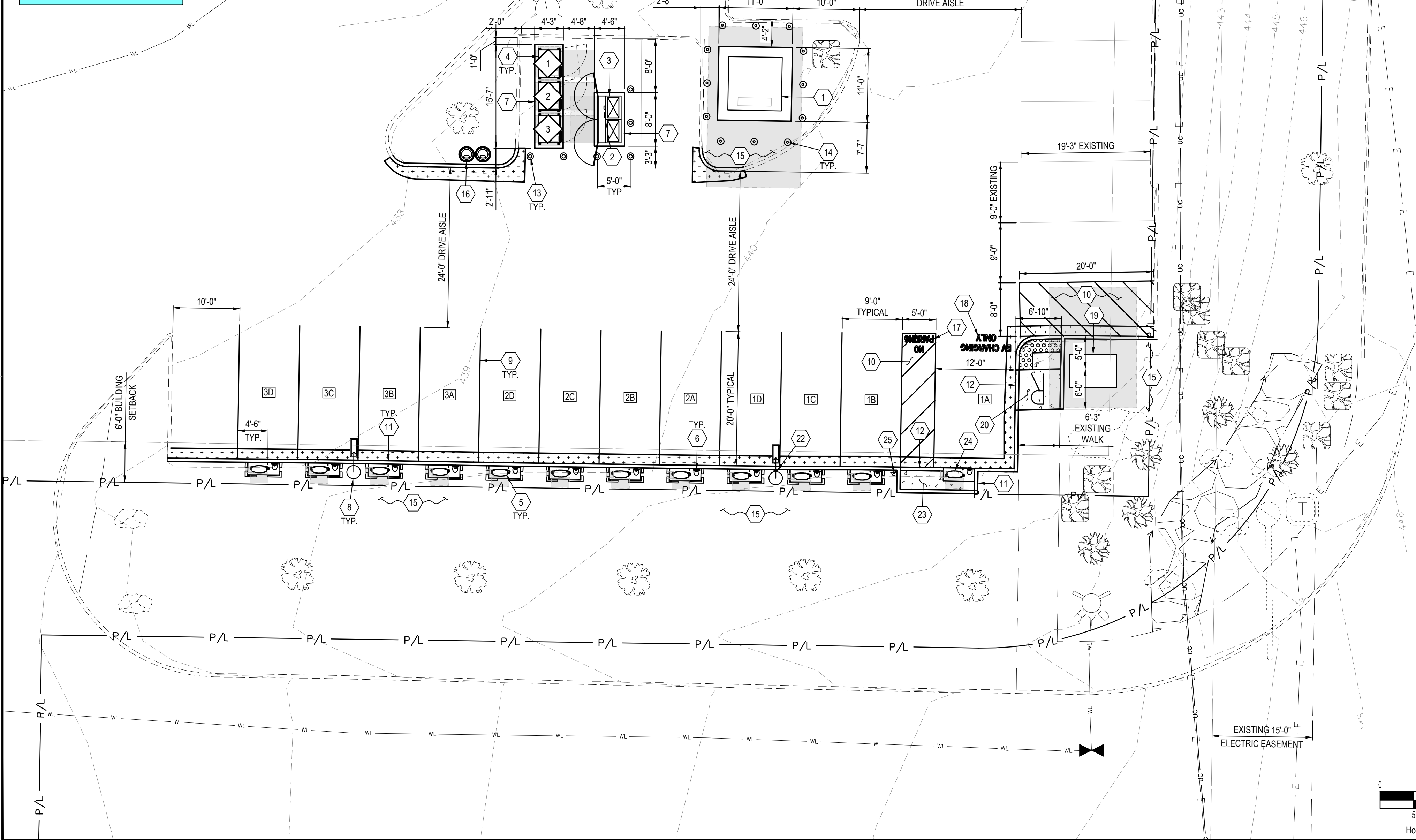

- ### GENERAL SHEET NOTES
- EXISTING PROPERTY LINES, RIGHT-OF-WAY BOUNDARIES, EASEMENT BOUNDARIES, SETBACKS, AND UTILITIES ARE SHOWN FOR REFERENCE ONLY.
 - CONTRACTOR SHALL REMOVE EXISTING PAVEMENT AND/OR CURB USING CLEAN SAWCUTS TO INSTALL PROPOSED UNDERGROUND CONDUITS AND REPLACE PAVEMENT AND/OR CURB AFTER CONDUITS HAVE BEEN INSTALLED. SEE ELECTRICAL SHEETS FOR CONDUIT ROUTING, APPROXIMATE CONDUIT RUN LENGTHS AND TRENCH DETAIL. CONTRACTOR SHALL MEET OR EXCEED EXISTING PAVEMENT SPECIFICATIONS. NOTIFY ENGINEER OF ANY DISCREPANCIES PRIOR TO PERFORMING WORK.
 - APPLY LIQUID ASPHALT AT ALL JOINTS BETWEEN CONCRETE AND ASPHALT AND WHERE PROPOSED ASPHALT MEETS EXISTING, INCLUDING SAW CUT JOINTS.
 - CONTRACTOR SHALL VERIFY ALL EXISTING SLOPES AND GRADES PRIOR TO CONSTRUCTION. FINAL GRADES SHALL BE DETERMINED IN FIELD BY THE CONTRACTOR AND APPROVED BY THE CONSTRUCTION MANAGER.
 - THE CONTRACTOR SHALL ENSURE POSITIVE DRAINAGE TOWARDS THE NEAREST EXISTING DRAINAGE STRUCTURE AND ENSURE NO PONDING OCCURS ON SITE.
 - CONTRACTOR SHALL ENSURE SLOPES OF PARKING STALL 1A AND ADJACENT TRANSVERSE STRIPED AREA(S) ARE COMPLIANT WITH NATIONAL ADA STANDARDS. NO SLOPE SHALL EXCEED 2% IN ANY DIRECTION WITHIN PARKING STALL 1A AND ADJACENT TRANSVERSE STRIPED AREA(S). CONTRACTOR SHALL REMOVE AND REGRADE AREA(S) AS REQUIRED TO ACHIEVE NECESSARY SLOPES. CONTRACTOR SHALL INSTALL FINAL PAVEMENT MARKINGS IN ACCORDANCE WITH THE CURRENT AHJ'S REGULATIONS.

- ### PLAN KEYNOTES
- PROPOSED PAD MOUNTED ELECTRICAL UTILITY TRANSFORMER (BY UTILITY). CONTRACTOR SHALL PROVIDE CONCRETE PAD AND VAULT PER UTILITY SPECIFICATIONS. COORDINATE FINAL LOCATION WITH UTILITY. SEE ELECTRICAL PLANS FOR PROPOSED ROUTING.
 - PROPOSED UTILITY METER MOUNTED IN SWITCHGEAR PER ELECTRIC COMPANY SPECIFICATIONS AND DETAILS ON ELECTRICAL SHEETS.
 - PROPOSED SWITCHGEAR ASSEMBLY WITH INTEGRATED TESLA SITE CONTROLLER AND PRIMARY BROADCAST UNIT PER ELECTRICAL DRAWINGS. SEE CIVIL DETAILS FOR ANCHORAGE.
 - PROPOSED TESLA SUPERCHARGER CABINET (TYPICAL OF 3). SEE CIVIL DETAILS.
 - PROPOSED TESLA SUPERCHARGER POST WITH INDIVIDUAL PRECAST CONCRETE FOUNDATION AND ATTACHED DETERRENT BOLLARD (TYPICAL OF 11). SEE CIVIL DETAILS.
 - PROPOSED NON-ILLUMINATED PARKING SIGN (TYPICAL OF 12). SEE CIVIL DETAILS. SEE SUPERCHARGER POST SCHEDULE. THIS SHEET. MOUNT SIGN POST IN BOLLARD AS NOTED.
 - PROPOSED CONCRETE EQUIPMENT PAD. SEE CIVIL DETAILS.
 - PROPOSED LIGHT POLE (TOTAL OF 2), SEE CIVIL DETAILS. SEE ELECTRICAL DRAWINGS FOR POLE AND FIXTURE SPECIFICATIONS AND WIRING.
 - PROPOSED PAINTED 4" WIDE SOLID STRIPE TO MATCH EXISTING STRIPING IN COLOR. SEE PAVEMENT MARKING NOTES ON SHEET C-003.
 - PROPOSED PAINTED 4" WIDE TRANSVERSE STRIPING TO MATCH EXISTING STRIPING IN COLOR. STRIPING SHALL BE 3'-0" O.C. SEE PAVEMENT MARKING NOTES ON SHEET C-003 AND CIVIL DETAILS.
 - PROPOSED CONCRETE CURB TO MATCH EXISTING. SEE CIVIL DETAILS.
 - PROPOSED FLUSH CONCRETE CURB. SEE CIVIL DETAILS.
 - PROPOSED CRASHCOURSE DETERRENT BOLLARD (TYPICAL OF 6). SEE CIVIL DETAILS.
 - PROPOSED DETERRENT BOLLARD PER UTILITY SPECIFICATION (TYPICAL OF 12)
 - ALL DISTURBED AREAS NOT TO BE PAVED SHALL BE RETURNED TO MATCH EXISTING GROUND CONDITIONS UNLESS OTHERWISE NOTED. FINAL MATERIAL SHALL BE COORDINATED WITH TESLA.
 - PROPOSED TRASH CAN AND RECYCLING BIN (TYPICAL OF 1 EACH). SEE CIVIL DETAILS.
 - PROPOSED "NO PARKING" IN WHITE LETTERS, 12 INCHES. SEE PAVEMENT MARKING NOTES ON SHEET C-003.
 - PROPOSED "EV CHARGING ONLY" IN WHITE LETTERS, 12 INCHES. SEE PAVEMENT MARKING NOTES ON SHEET C-003.
 - PROPOSED UTILITY JUNCTION BOX PER UTILITY SPECIFICATION.
 - PROPOSED ACCESSIBLE CONCRETE RAMP. SEE CIVIL DETAILS.
 - PROPOSED CONCRETE CURB TAPER. SEE CIVIL DETAILS.
 - PROPOSED WIRELESS ACCESS POINT (TYPICAL OF 1). MOUNT PER MANUFACTURER'S SPECIFICATIONS AT MINIMUM 10'-0" ABOVE GRADE. WHERE APPLICABLE, CONTRACTOR SHALL MOUNT TO EXISTING LIGHT POLE.
 - PROPOSED CONCRETE ACCESSIBLE WALK. SEE CIVIL DETAILS.
 - PROPOSED TESLA SUPERCHARGER POST WITH INDIVIDUAL CAST-IN-PLACE CONCRETE FOUNDATION (TYPICAL OF 1). SEE CIVIL DETAILS.
 - PROPOSED NO PARKING SIGN ON POST. SEE CIVIL DETAILS.

LEGEND

(SEE SHEET C-003 FOR EXISTING LEGEND)

	PROPOSED EQUIPMENT CLEAR SPACE
	PROPOSED CONCRETE PAVEMENT TO MATCH EXISTING IN TYPE AND DEPTH. INCLUDE ENGINEERED COMPACTED BACKFILL BELOW PAVEMENT SECTION. TRENCHING NOT INCLUDED. CONTRACTOR SHALL REPLACE ANY FABRIC ENCOUNTERED DURING EXCAVATION INCLUDING BUT NOT LIMITED TO; GEOTEXTILE, WATER-PROOFING, PAVING FABRICS, ETC. THE REPLACEMENT MATERIAL(S) SHALL BE EQUAL TO OR BETTER THAN EXISTING AND SHALL BE CONFIRMED BY THE MANUFACTURER'S REPRESENTATIVE TO BE COMPATIBLE WITH THE EXISTING INSTALLATION.
	PROPOSED ASPHALT PAVEMENT TO MATCH EXISTING IN TYPE AND DEPTH. INCLUDE ENGINEERED COMPACTED BACKFILL BELOW PAVEMENT SECTION. TRENCHING NOT INCLUDED. FOR FULL DEPTH REPLACEMENT, CONTRACTOR SHALL REPLACE ANY FABRIC ENCOUNTERED DURING EXCAVATION INCLUDING BUT NOT LIMITED TO; GEOTEXTILE, WATER-PROOFING, PAVING FABRICS, ETC. THE REPLACEMENT MATERIAL(S) SHALL BE EQUAL TO OR BETTER THAN EXISTING AND SHALL BE CONFIRMED BY THE MANUFACTURER'S REPRESENTATIVE TO BE COMPATIBLE WITH THE EXISTING INSTALLATION. IN LIEU OF FULL DEPTH REPLACEMENT, CONTRACTOR CAN MILL AND OVERLAY (1.5" MIN.) PROPOSED ASPHALT PROVIDED THAT THE FINAL ASPHALT SECTION IS EQUAL TO OR GREATER THAN THE EXISTING SECTION AND DRAINAGE AND ADA COMPLIANCE IS NOT NEGATIVELY AFFECTED.

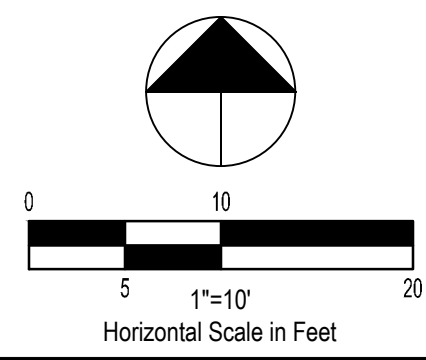

3500 DEER CREEK RD.
PALO ALTO, CA 94304
(650) 681-5000

520 South Main Street, Suite 2531
Akron, OH 44311
330.572.2100 Fax 330.572.2101

REV.	DATE	DESCRIPTION
A	08/11/2023	ISSUED FOR 50% REVIEW
B	09/11/2023	ISSUED FOR 50% REVIEW
C	09/13/2023	ISSUED FOR 90% REVIEW
D	10/30/2023	ISSUED FOR SIGN & SEAL

11/09/23
EXPIRES 04/16/2024

TESLA SUPERCHARGER STATION
3310 S MERIDIAN ST. (TESLA SUPERCHARGER)
PUYALLUP, WA 98373

PROJECT MANAGER	DESIGNER
IM	MAM

JOB NO.
2023241.47

C-111

Drawing Name: C:2023\2023241.47 - TRT 27473 - South Hill Mall (Target) Puyallup, WA\dwg\2023241.47 - Puyallup, WA - CD\100.dwg
November 9, 2023 11:20 AM - cobbay