

SITE SPECIFIC NOTES:

- P01: 568060-156260**
REPLACE 80' CL-1 T-POLE W/ 90' CL-H3 POLE (SET 3' SOUTH) (UNDER TRANSMISSION # 111025027)
RETIRE 25kVA 120/240V OH XFMR
RETIRE ST LIGHT
INST. 3Ø 397AAC UNDERBUILD PRIMARY DOUBLE DE FRAMING PER STD. 6034.1044 (DDEU315)
INST. G.O. SWITCH W/ EXTENDED HANDLE PER STD 6022.2000 (DLG51)
INST. RIGID CLEVIS (NORTH)
INST. SW # P3835
INST. GRID # 568060-156260
- P02: 568051-156292**
REPLACE 80' CL-1 T-POLE W/ 90' CL-H3 POLE (SET 7' SOUTH) (UNDER TRANSMISSION # 111025027)
RETIRE G.O. SWITCH P3835
RETIRE ST LIGHT SLAR0996
REMOVE SPAN GUY TO P03
INST. 3Ø 397AAC UNDERBUILD SINGLE ARM FRAMING PER STD. 6034.1010 (TANU313)
INST. 1/0 AL. 3Ø PRI. TERMS ON TRI-UNIT
INST. (3) LI C/Os & SURGE ARRESTERS, FUSE @ 100T
INST. (3) STIRRUPS
INST. 4" PRI. RISER ON STANDOFF BRACKETS (ACTUAL = _____)
INST. RIGID CLEVIS (NORTH)
INST. SW # T82090
INST. GRID # 568051-156292
- P03: 568047-156292**
REMOVE 30' CL-3 SPAN GUY POLE (UNDER TRANSMISSION # 111025027)
REMOVE GUY AND ANCHOR (NORTH)
- P04: 568045-156315**
REPLACE 80' CL-1 T-POLE W/ 90' CL-H5 POLE (AS STAKED) (UNDER TRANSMISSION # 111025027)
REMOVE GUY AND ANCHOR (SOUTH)
REMOVE ST LIGHT
INST. 3Ø 397AAC UNDERBUILD SINGLE ARM FRAMING PER STD. 6034.1010 (TANU313)
TRANSFER 15kVA 120/240V OH XFMR
INST. #6CU 1Ø ARM MOUNTED TAP TO POLE 568058-156317 PER STD 6031.5060 (NORTH) (FR13RDE)
INST. STD. 9' ARM FOR C/Os
INST. 1/0 AL. 3Ø PRI. TERMS PER STD 6043.1003 (TSU3LTV)
INST. L/B C/O ON PRIMARY ARM FOR TAP, FUSE @ 10T
INST. (3) LI C/Os & SURGE ARRESTERS ON C/O ARM, FUSE @ 100T
INST. L/B XFMR C/O ON C/O ARM, FUSE @ 5T
INST. (3) STIRRUPS FOR TERMS
INST. STIRRUP FOR 1Ø TAP C/O, TAP CØ
INST. STIRRUP FOR XFMR C/O, TAP CØ
INST. 4" PRI. RISER ON STANDOFF BRACKETS (ACTUAL = _____)
INST. RIGID CLEVIS (NORTH)
INST. SW # P3830 FOR TAP
INST. SW # T82091 FOR TERM
INST. GRID # 568045-156315
- P05:**
INST. 65' CL-2 PRIMARY POLE (AS STAKED) 3-10
INST. 3Ø 397AAC SINGLE WINGARM FRAMING W/ NEUTRAL IN PRI. POSITION PER STD 6033.4012 (TASW313)
INST. 11' ARM FOR C/Os
INST. 1/0 AL. 3Ø PRI. TERMS PER STD 6044.1000 (TSUWGL)
INST. (3) LI C/Os & SURGE ARRESTERS ON C/O ARM, FUSE @ 100T
INST. (3) STIRRUPS
INST. 4" PRI. RISER ON STANDOFF BRACKETS (ACTUAL = _____)
INST. SW # T82092
INST. GRID # 568003-156359

- P06: 567985-156358**
REMOVE 65' CL-3 PRIMARY POLE 2-26
TRANSFER 15kVA 120/240V OH XFMR TO P07 2-129
- P07:**
INST. 65' CL-2 PRIMARY POLE (AS STAKED) 2-23
INST. 3Ø 397AAC SINGLE WINGARM FRAMING W/ NEUTRAL IN PRI. POSITION PER STD 6033.4012 (TASW313) 2-24
HANG 15kVA 120/240V OH XFMR FROM P06
INST. STIRRUP, TAP BØ
INST. L/B XFMR C/O ON C/O BRACKET, FUSE @ 6T
INST. RIGID CLEVIS (EAST)
TRANSFER OH SEC TPLX TO POLE 567985-156358 FROM P06
INST. GRID # 567984-156358
- J01:**
INST. 575 VAULT & COVER W/ STD DIAMONDPLATE DOORS 3-20
INST. (3) 4-POS JBOXES
INST. (9) L/B ELBOWS & (3) INSULATED CAPS
INST. (3) 4" BELL ENDS
INST. GRID # 568039-156280
- J02:**
INST. 575 VAULT & COVER W/ STD DIAMONDPLATE DOORS 3-20
INST. (3) 4-POS JBOXES
INST. (9) L/B ELBOWS & (3) INSULATED CAPS
INST. (3) 4" BELL ENDS
INST. GRID # 568039-156329
- J03:**
INST. 575 VAULT & COVER W/ STD DIAMONDPLATE DOORS 3-20
INST. (3) 4-POS JBOXES
INST. (6) L/B ELBOWS & (6) INSULATED CAPS
INST. (3) 4" BELL ENDS
INST. GRID # 568006-156356
- V01:**
INST. 504 VAULT W/ 5'-6" x 4'-8" COVER 3-19B
SET 3Ø 225kVA 120/208V PM XFMR
INST. (3) L/B ELBOWS
INST. 4" BELL END
INST. (8) 501-1000KCM 4-POS CONNECTOR BARS
INST. GRID # 568032-156323
- V02:**
INST. 774 VAULT W/ 8' SQUARE COVER 3-19B
SET 3Ø 750kVA 120/208V PM XFMR
INST. (3) L/B ELBOWS
INST. 4" BELL END
INST. (8) 501-1000KCM 4-POS CONNECTOR BARS
INST. GRID # 568002-156286
- V03:**
INST. 504 VAULT W/ 5'-6" x 4'-8" COVER 3-19B
SET 3Ø 112.5kVA 120/208V PM XFMR
INST. (3) L/B ELBOWS
INST. 4" BELL END
INST. (4) #2-500KCM 1-POS CONNECTOR BARS
CONNECT & TAG CUST. RAN UG SVC LINES TO M04 (BLDG D) (1-RUN OF 500KCM)
INST. GRID # 568032-156323

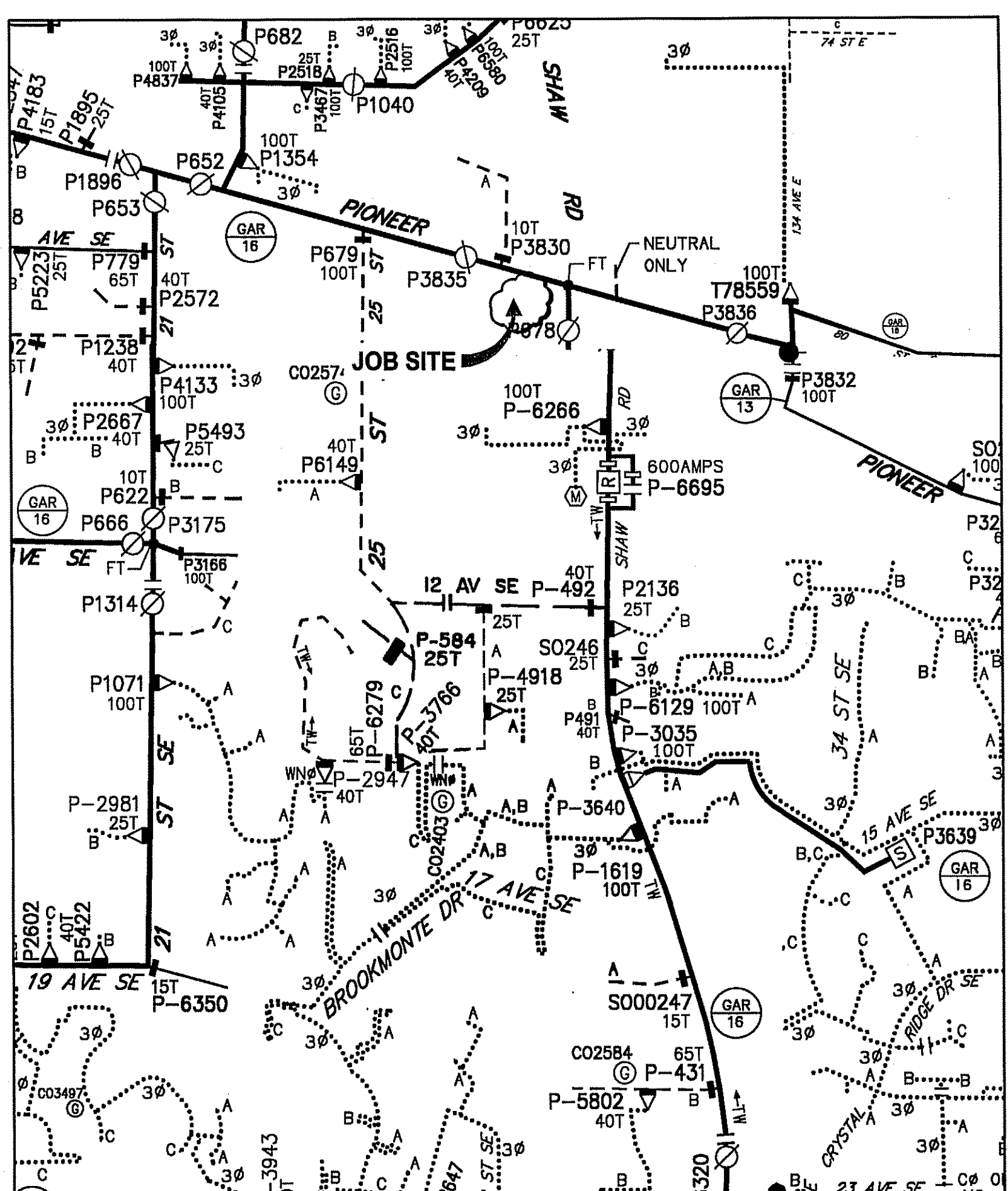

- V04:**
INST. 504 VAULT W/ 5'-6" x 4'-8" COVER 3-19B
SET 3Ø 225kVA 120/208V PM XFMR
INST. (3) L/B ELBOWS
INST. 4" BELL END
INST. (4) #2-500KCM 4-POS CONNECTOR BARS
CONNECT & TAG CUST. RAN UG SVC LINES TO M05 (BLDG E) (2-RUNS OF 350KCM)
CONNECT & TAG CUST. RAN UG SVC LINES TO M06 (BLDG F) (2-RUNS OF 350KCM)
INST. GRID # 568036-156342
- V05:**
INST. 504 VAULT W/ 5'-6" x 4'-8" COVER 3-19B
SET 3Ø 225kVA 120/208V PM XFMR
INST. (3) L/B ELBOWS
INST. 4" BELL END
INST. (4) 501-1000KCM 4-POS CONNECTOR BARS
INST. GRID # 568011-156354
- E01:**
INST. 4" ELECTRONIC MARKER
- M01: BLDG B**
METER FOR 1000A PANEL
- M02: BLDG C**
METER FOR 800A PANEL
- M03: BLDG A**
METER FOR 4000A PANEL
- M04: BLDG D**
METER FOR 400A PANEL
- M05: BLDG E**
METER FOR 600A PANEL
- M06: BLDG F**
METER FOR 600A PANEL
- M07: BLDG G**
METER FOR 1300A PANEL
- J03 - E01:**
INST. EMPTY 4" DB120 CONDUIT +35' FOR FUTURE USE
- CREW NOTES:**
CHARGE NCC UNITS TO 105091225
CHARGE SYSTEM UNITS TO 101118256
COMPLETE TRANSMISSION WORK UNDER WO# 111025027
- MAPPING NOTE:**
E01 IS DUMB OBJECT, ENSURE E01 IS MAPPED CORRECTLY

POWER GENERAL NOTES - COMMERCIAL PROJECT

- All materials to be installed in accordance with Puget Sound Energy's (PSE) standards. Any deviation from this work sketch must be AUTHORIZED by PSE's Project Manager and NOTED on the Foreman's Copy.
- All switching arrangements and/or outage arrangements are to be made with the Project Manager at least three (3) working days in advance.
- Contact the Utilities Underground Location Center (1-800-424-5555) at least 48 hours prior to commencing work to get the underground facilities located.
- STAKING: The customer will provide all staking (transformer, handhole, trench, grade, lot, pole, sidewalk, etc.). See sketch and details for locations. Equipment locations must be approved by the Project Manager.
- SITE PREPARATION: The work area will be at or near finished grade, clear of trench spoils or construction materials which would restrict construction and/or equipment access, before work can begin.
- Roads shall be paved or have a compacted, crushed rock base in place.
- CLEARANCES: Transformers require a minimum of 8 feet from fire fighting equipment, 10 feet from combustible walls, awnings, doors, and windows, and a minimum of 5 feet from the back of curb (or guard posts) will be required per PSE standards. All conduits and vaults are to be at least 5 feet away from water, storm and sewer lines when paralleling them in the right of way, and at least 1 foot when crossing them.
- All work is to be done in accordance with local municipal and county permit requirements as applicable.
- Customer/Developer is responsible to provide, install and maintain all secondary service cables, conduits and crossings from the individual unit's meter base to the designated connection point.
- Inclement weather conditions may cause delays in construction times and dates.
- EXCAVATION: The customer is to provide all trenching, backfill, vault excavations, compaction and restoration per this sketch and per PSE standards. A minimum protective cover of 36" is required over PSE's primary voltage equipment and 24" is required of PSE's secondary voltage equipment. The customer will provide any and all shoring or they will side slope the trench to 1:1.

CIRCUIT LOADING TABLE

Circuit:	GAR-16	Customer 3Ø Load:	922.5
As Of:	2018	Power Factor:	.85
		Phase to Phase Voltage:	12500
Existing Peak Load:	A Phase	B Phase	C Phase
	243.0	255.0	257.0
Estimated New Load:	50.2	50.2	50.2
Total:	293.2	305.2	307.2

NOTE: THE ADDED LOAD IS A ROUGH ESTIMATE BASED ON 60% OF TOTAL TRANSFORMER NAMEPLATE AMOUNTS

EROSION & SEDIMENT CONTROL REQUIREMENTS
EROSION & SEDIMENT CONTROL SHALL BE PER PSE STANDARD PRACTICE 0150.3200 TECHNIQUES FOR TEMPORARY EROSION & SEDIMENT CONTROL & ANY ADDITIONAL LOCAL JURISDICTION REQUIREMENTS. (LOCAL JURISDICTIONS MAY HAVE ADDITIONAL REQUIREMENTS INCLUDING NOTES DETAILING WHERE EROSION OR SEDIMENT CONTROL STRUCTURES ARE TO BE INSTALLED, CROSS SECTION DETAILS OF THE TYPICAL EROSION STRUCTURES, & SPECIAL REQUIREMENTS FOR WORK IN SENSITIVE AREAS.)

FOREMAN (CHECK BOX WHEN COMPLETED)

PSE Equipment LOCKED/SECURED & Work Area left in CLEANSAFE Condition.

Grid, Cable, and Switch numbers INSTALLED & VERIFIED.

Field Changes REDLINED on As-built.

Material VERIFIED and CHANGES noted on Paperwork.

Total PRIMARY Cable noted on As-built.

Company ID's RECORDED in correct location on As-built.

Indicate correct FUSE SIZE on As-built & VERIFY proper PHASE.

Deviations noted on the As-built and their reason.

I certify that the work performed meets PSE's standards and procedures and that all quality requirements are met.

Foreman's Signature _____ Date _____

Print Name _____ Date _____

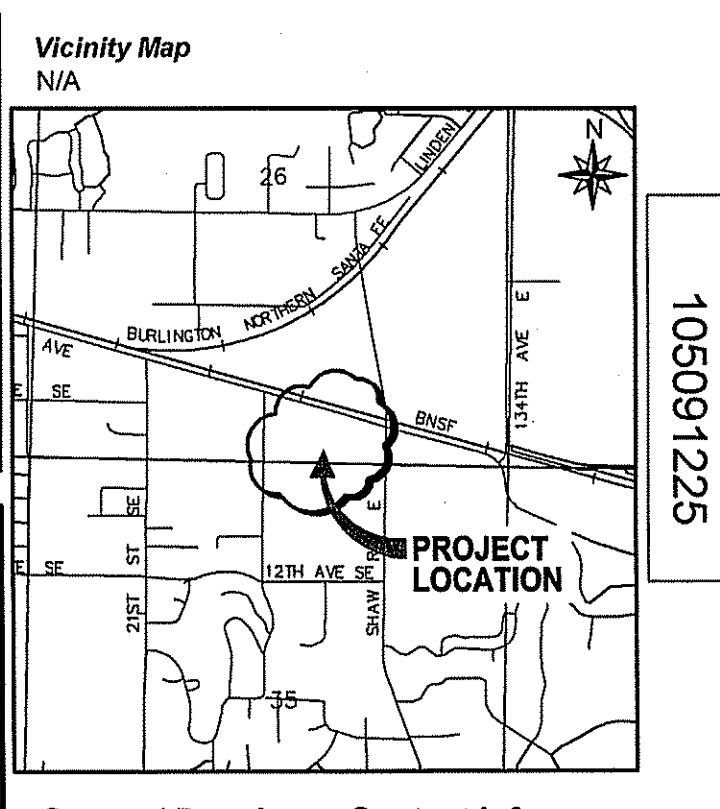

PROJECT PHASE	NOTIF#	ORDER#
PWR Superior	501646553	105091225
Work Order	N/A	101118256
Removal	N/A	10811923
OH Work	N/A	593204693
OH Xfms	N/A	583061652
Job Order	N/A	N/A
Distribution	N/A	N/A
Service Stub	N/A	N/A
HP Svc/MSA	N/A	N/A

GAS
Distribution N/A
Service Stub N/A
HP Svc/MSA N/A

CABLE TV
PHONE

Owner / Developer Contact Info
FRANKLIN PUYALLUP, LLC
15015 MAIN ST, SUITE 203
BELLEVUE, WA 98007
ATTN: TIM JACKSON 425-746-6066 office
For contacts below dial 1-888-CALL PSE (225-5773)

CALL 811 TWO BUSINESS DAYS BEFORE YOU DIG

THIS SKETCH NOT TO BE RELIED UPON FOR EXACT LOCATION OF EXISTING FACILITIES

REAL ESTATE/EASEMENT	PERMIT					
EASEMENT	CITY OF PUYALLUP					
3	N/A					
2	N/A					
1	N/A					
REV#	DATE	BY	DESCRIPTION	ENGR - GAS	PHONE NO	DATE
1				N/A	N/A	N/A
2				N/A	N/A	N/A
3				N/A	N/A	N/A
4				N/A	N/A	N/A
5				N/A	N/A	N/A
6				N/A	N/A	N/A
7				N/A	N/A	N/A
8				N/A	N/A	N/A
9				N/A	N/A	N/A
10				N/A	N/A	N/A
11				N/A	N/A	N/A
12				N/A	N/A	N/A
13				N/A	N/A	N/A
14				N/A	N/A	N/A
15				N/A	N/A	N/A
16				N/A	N/A	N/A
17				N/A	N/A	N/A
18				N/A	N/A	N/A
19				N/A	N/A	N/A
20				N/A	N/A	N/A
21				N/A	N/A	N/A
22				N/A	N/A	N/A
23				N/A	N/A	N/A
24				N/A	N/A	N/A
25				N/A	N/A	N/A
26				N/A	N/A	N/A
27				N/A	N/A	N/A
28				N/A	N/A	N/A
29				N/A	N/A	N/A
30				N/A	N/A	N/A
31				N/A	N/A	N/A
32				N/A	N/A	N/A
33				N/A	N/A	N/A
34				N/A	N/A	N/A
35				N/A	N/A	N/A
36				N/A	N/A	N/A
37				N/A	N/A	N/A
38				N/A	N/A	N/A
39				N/A	N/A	N/A
40				N/A	N/A	N/A
41				N/A	N/A	N/A
42				N/A	N/A	N/A
43				N/A	N/A	N/A
44				N/A	N/A	N/A
45				N/A	N/A	N/A
46				N/A	N/A	N/A
47				N/A	N/A	N/A
48				N/A	N/A	N/A
49				N/A	N/A	N/A
50				N/A	N/A	N/A
51				N/A	N/A	N/A
52				N/A	N/A	N/A
53				N/A	N/A	N/A
54				N/A	N/A	N/A
55				N/A	N/A	N/A
56				N/A	N/A	N/A
57				N/A	N/A	N/A
58				N/A	N/A	N/A
59				N/A	N/A	N/A
60				N/A	N/A	N/A
61				N/A	N/A	N/A
62				N/A	N/A	N/A
63				N/A	N/A	N/A
64				N/A	N/A	N/A
65				N/A	N/A	N/A
66				N/A	N/A	N/A
67				N/A	N/A	N/A
68				N/A	N/A	N/A
69				N/A	N/A	N/A
70				N/A	N/A	N/A
71				N/A	N/A	N/A
72				N/A	N/A	N/A
73				N/A	N/A	N/A
74				N/A	N/A	N/A
75				N/A	N/A	N/A
76				N/A	N/A	N/A
77				N/A	N/A	N/A
78				N/A	N/A	N/A
79				N/A	N/A	N/A
80				N/A	N/A	N/A
81				N/A	N/A	N/A
82				N/A	N/A	N/A
83				N/A	N/A	N/A
84				N/A	N/A	N/A
85				N/A	N/A	N/A
86				N/A	N/A	N/A
87				N/A	N/A	N/A
88				N/A	N/A	N/A
89				N/A	N/A	N/A
90				N/A	N/A	N/A
91				N/A	N/A	N/A
92				N/A	N/A	N/A
93				N/A	N/A	N/A
94				N/A	N/A	N/A
95				N/A	N/A	N/A
96				N/A	N/A	N/A
97				N/A	N/A	N/A
98				N/A	N/A	N/A
99				N/A	N/A	N/A
100				N/A	N/A	N/A

UTILITIES
CENTURY LINK UNITE PRIVATE NETWORKS COMCAST WAVE BROADBAND

CONTACT
MARIA HAYES N/A N/A N/A

PHONE#
206-733-8865 N/A N/A N/A

INCIDENT
N/A

MAOP
N/A

Gas Order
N/A

Elect Order
105091225

SCALE
AS NOTED

PAGE
1/3