

BUFFER DATA										
LONGITUDINAL BUFFER SPACE = B										
SPEED (MPH)	25	30	35	40	45	50	55	60	65	70
LENGTH (feet)	155	200	250	305	360	425	495	570	645	730
TRANSPORTABLE ATTENUATOR ROLL AHEAD DISTANCE = R										
HOST VEHICLE WEIGHT 9,900 TO 22,000 lbs.					HOST VEHICLE WEIGHT > 22,000 lbs.					
< 45 MPH	45-55 MPH	> 55 MPH	< 45 MPH	45-55 MPH	> 55 MPH	< 45 MPH	45-55 MPH	> 55 MPH	< 45 MPH	45-55 MPH
100'	123'	172'	74'	100'	150'	74'	100'	150'	74'	100'
PROTECTIVE VEHICLE (WORK VEHICLE) = R										
NO SPECIFIED DISTANCE REQUIRED										

LANE WIDTH (feet)	MINIMUM TAPER LENGTH = L (feet)									
	Posted Speed (mph)									
	25	30	35	40	45	50	55	60	65	70
10	105	150	205	270	450	500	-	-	-	-
11	115	165	225	295	495	550	-	-	-	-
12	125	180	245	320	540	600	-	-	-	-

CHANNELIZATION DEVICE SPACING (feet)		
MPH	TAPER	TANGENT
50	40	80
35/45	30	60
25/30	20	40

NORTH



SIGN SPACING = X (1)		
RURAL ROADS	45 / 55 MPH	500' ±
RURAL ROADS & URBAN ARTERIALS	35 / 40 MPH	350' ±
RURAL ROADS & URBAN ARTERIALS	25 / 30 MPH	200' ± (2)
RESIDENTIAL & BUSINESS DISTRICTS		
URBAN STREETS	25 MPH OR LESS	100' ± (2)

(1) ALL SPACING MAY BE ADJUSTED TO ACCOMMODATE INTERCHANGE RAMP, AT-GRADE INTERSECTIONS AND DRIVEWAYS.
(2) THIS SPACING MAY BE REDUCED IN URBAN AREAS TO FIT ROADWAY CONDITIONS.

CLOSURE ALLOWED:

Monday - Friday
9AM - 3PM

Call communications center at 253-287-4456 on day of closure. Request a job start inspection through the CityView portal. Public notification shall comply with PMC Chapter 11.05.110. The City-issued permit packet shall be posted at the job site and available to inspectors at all times.

Call Michael Rosenau, City Inspector, at 253-344-6753 prior to starting any work.

Expected duration of work is one day. Applicant will notify the City Inspector as soon as possible if additional time is required.

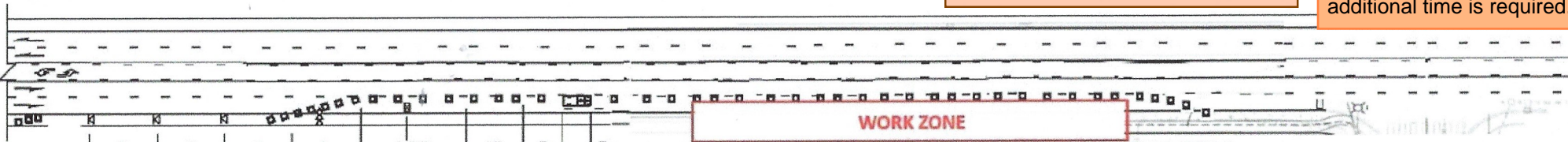

Work shall immediately cease in the work zone for a pedestrian spotter, available at all times, to escort pedestrians around the work area.

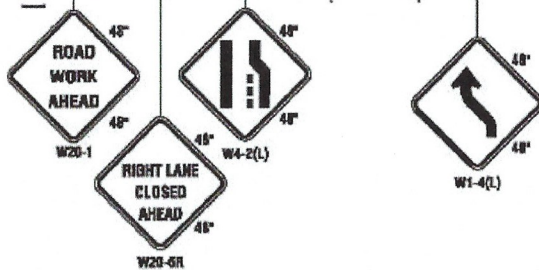

LEGEND	
K	TEMPORARY SIGN LOCATION
□	CHANNELIZING DEVICES
⇄	SEQUENTIAL ARROW SIGN
CB	PROTECTIVE VEHICLE
⊠	TEMPORARY SIGN LOCATION (5' MOUNTING HEIGHT)

**VALLEY AVE YARD
RIGHT LANE CLOSED TCP**

- NOTES**
- SEE SPECIAL PROVISIONS FOR WORK HOUR RESTRICTIONS.
 - RECOMMEND EXTENDING DEVICE TAPER (L3) ACROSS SHOULDER.
 - FOR POSTED SPEED LIMITS OF 30 MPH OR LESS, USE SIGN W1-3 IN LIEU OF SIGN W1-4.
 - ALL SIGNS ARE BLACK ON ORANGE UNLESS OTHERWISE DESIGNATED.

NOT TO SCALE

FILE NAME		REGION	STATE	PRO GRADE Enterprises Inc • EXCAVATING • UTILITIES •	VALLEY AVE YARD	TC1
TIME		WASH				
DATE		JOB NUMBER		TRAFFIC CONTROL PLAN		
DESIGNED BY		CONTRACT NO.				
ENTERED BY		LOOKUP NO.				
CHECKED BY						
PROJ. ENGR.						
REGIONAL ADM.						
REVISION		DATE	BY	P.E. STAMP BOX	DATE	P.E. STAMP BOX