

REVISIONS

ISSUE NO.	DATE	ITEM
2	01 31 24	PERMIT SUBMITTAL
1	10 14 22	SEPA RESUBMITTAL
D	11 01 21	DESIGN REVIEW APPLICATION
C	09 15 21	PRELIMINARY BID
B	03 19 21	SEPA APPLICATION
A	01 05 21	PRE-APPLICATION

PROFESSIONAL STAMP

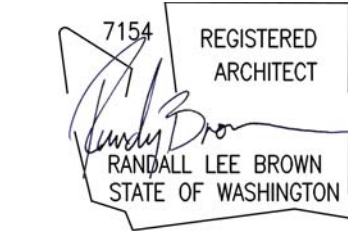

Digitally signed by
Randy Brown
Date:
2024.02.01
09:18:41
-08'00'

PROJECT INFORMATION

BUILDING B
Freeman Logistics
Puyallup, WA - 98371

SHEET INFORMATION

RELEASE FOR:	PERMIT SUBMITTAL
TITLE:	SITE PLAN
DESIGNED BY:	DRAWN BY:
REVIEWED BY:	APPROVED BY:
DATE:	01 05 21
PROJECT NO:	201401.13.031

A1.1-B

SITE KEYNOTES

NOTE: NOT ALL KEYNOTES ARE USED

- 1 AC PAVT RAMP, 1:12 MAX SLOPE, SEE CIVIL DWGS.
- 2 CONC LANDING, 5'-0"W x 5'-0"L, MIN. PAINT STRIPING ON FLOOR OR PAVEMENT.
- 3 EXTRUDED CONC CURB - 6" TYP W/ 24" RAD. OUTSIDE CORNERS TYP. NON-USE THICK-FACE CURB AT SIDEWALKS.
- 4 7'-0" HIGH CONC. ENCL. W/ CHAIN LINK GATES & SIGHT OBSCURING SLATS. SEE STRUCTURAL FOR WALL CONST.
- 5 ACCESSIBLE PARKING SIGN, SEE DET 8/A1.2.
- 6 ACCESSIBLE PARKING STALL W/ PAINTED INTERNATIONAL SYMBOL OF ACCESS. MAX SLOPE 1v:48h.
- 7 VAN ACCESSIBLE PARKING STALL W/ PAINTED INTERNATIONAL SYMBOL OF ACCESS. MAX SLOPE 1v:48h.
- 8 ACCESSIBLE RAMP, MAX SLOPE 1v:12h, MAX RISE 6" MIN LENGTH 6'-0", W/ NON-SLIP SURFACE.
- 9 4" THICK, 5'-0"W (UON) CONC WALK, MAX SLOPE 1v:20h.
- 10 COMPACT PARKING STALL W/ PAINTED "COMPACT" DESIGNATION.
- 11 PROVIDE SIGN W/ THE INTERNATIONAL SYMBOL OF ACCESS, ATTACH TO GLASS ADJACENT TO DOOR.
- 12 APPROXIMATE ELECTRICAL TRANSFORMER LOCATION
- 13 APPROXIMATE GAS METER LOCATION
- 14 ACCESSIBLE PATH OF TRAVEL TO THE PUBLIC WAY
- 15 EXTERIOR AREA FOR ASSISTED RESCUE (BC 1009.7)
- 16 CONCRETE WHEEL STOP
- 17 BICYCLE RACK (FOR 2 OR MORE BICYCLES)
- 18 EV CHARGING STATIONS PER WAC 51-50-0429

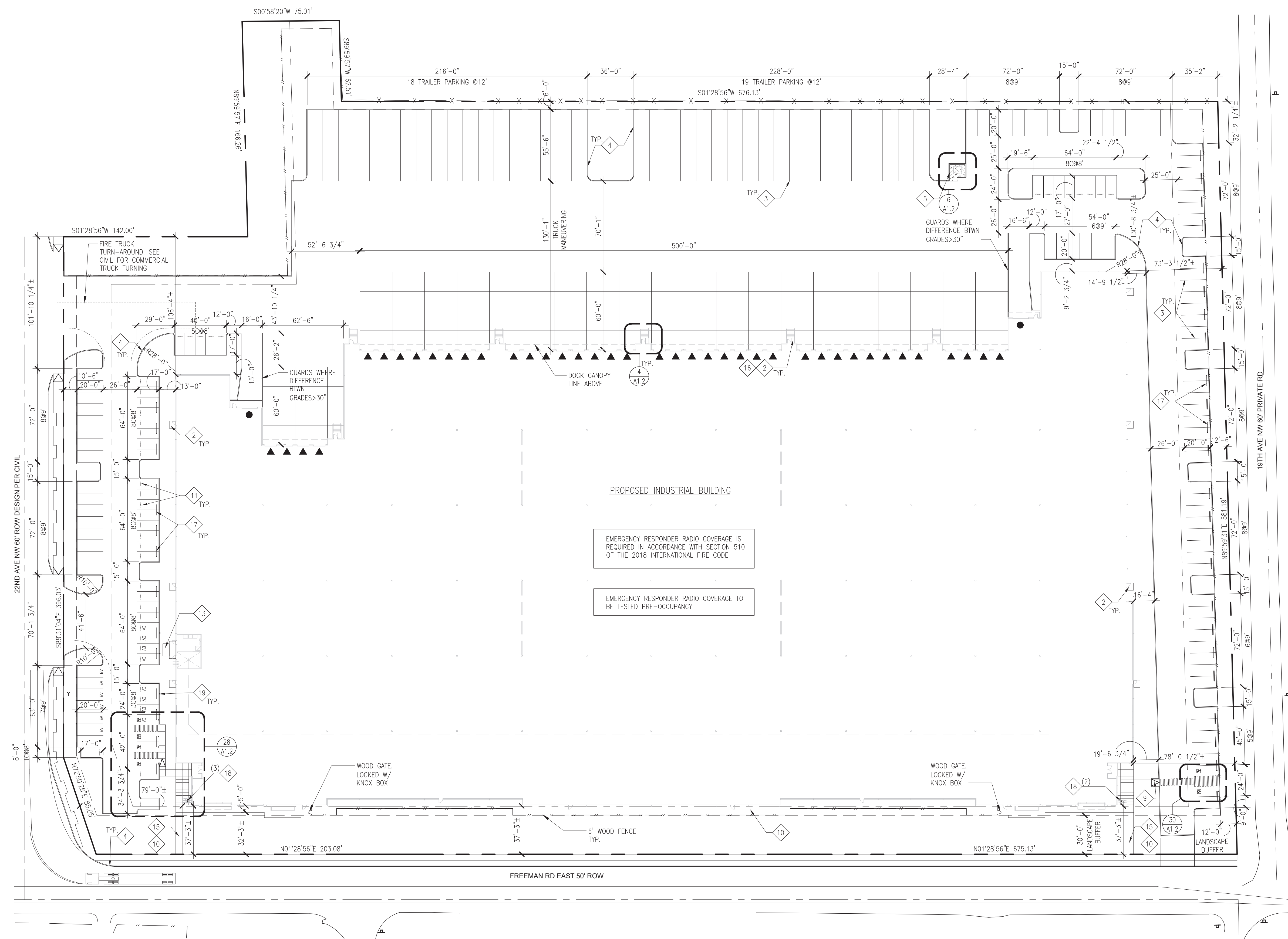

PROPOSED INDUSTRIAL BUILDING

EMERGENCY RESPONDER RADIO COVERAGE IS REQUIRED IN ACCORDANCE WITH SECTION 510 OF THE 2018 INTERNATIONAL FIRE CODE

EMERGENCY RESPONDER RADIO COVERAGE TO BE TESTED PRE-OCCUPANCY

1 SITE PLAN
SCALE: 1" = 40'-0"



P:\2024\10 - VECTOR\BIA\DWG\13 - Puyallup\03 - Freeman Road Logistics Building\A1.1-B.dwg, 1/27/2024, 4:42 PM

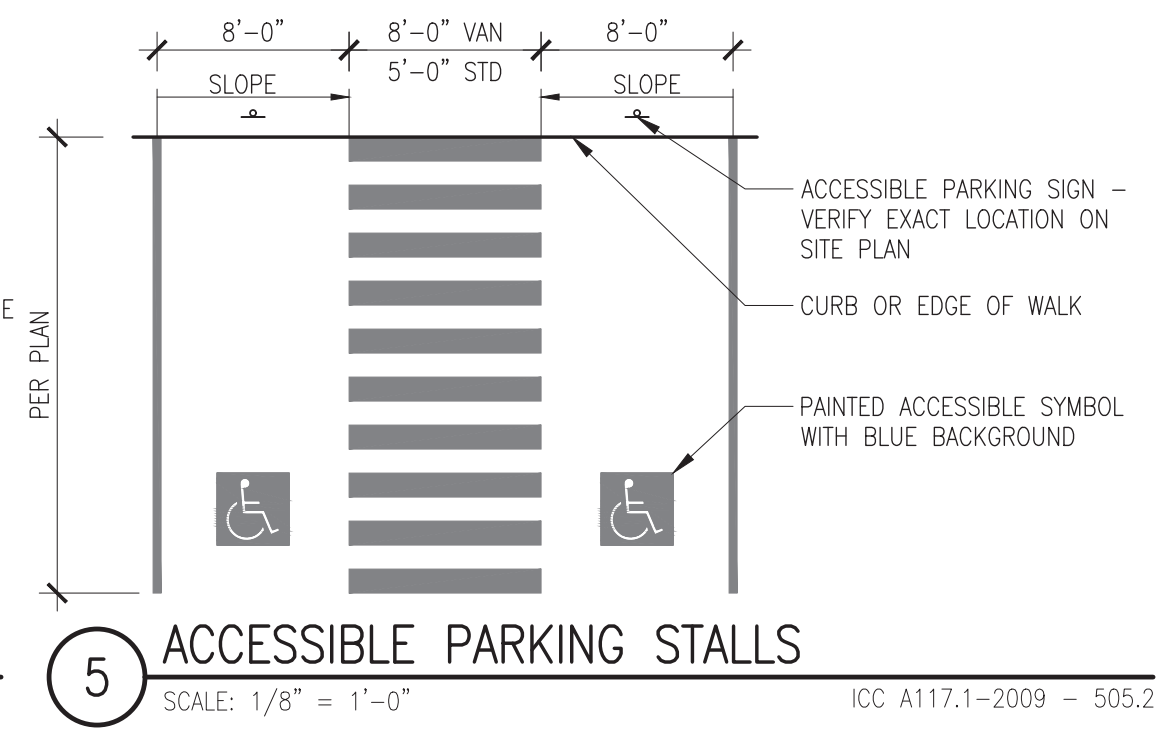
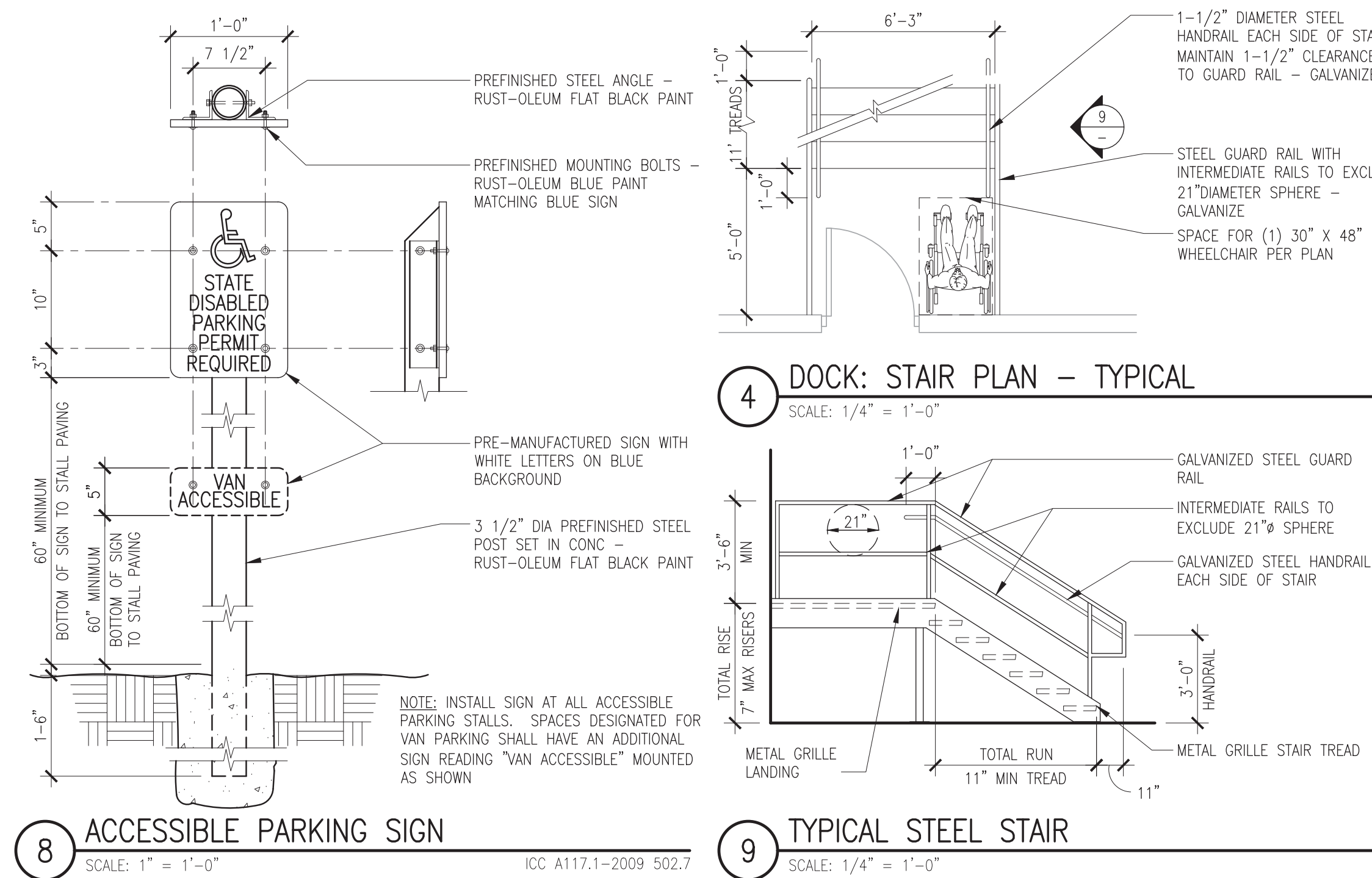
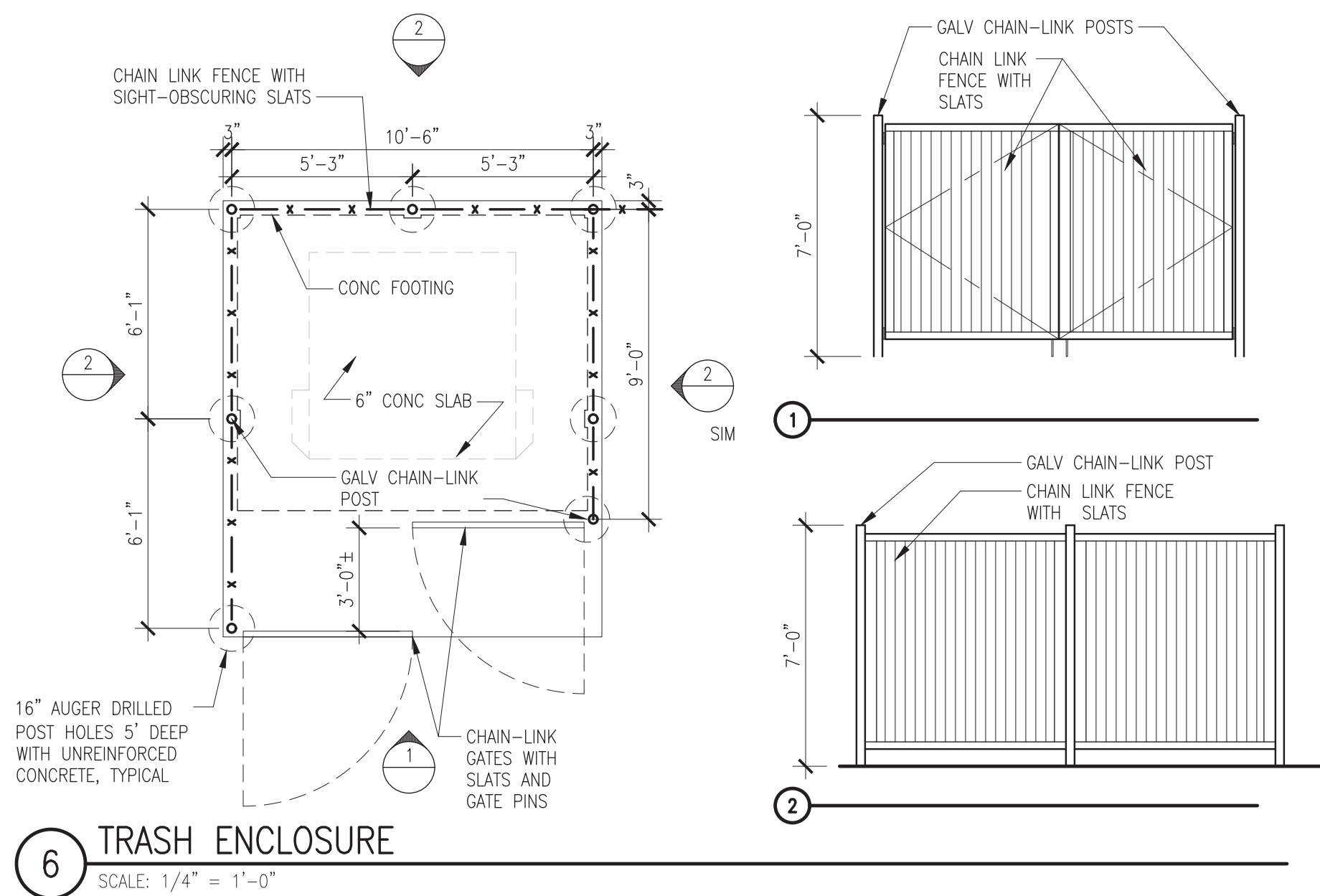

SITE KEYNOTES

- NOTE: NOT ALL KEYNOTES ARE USED
- 1 AC PVMT RAMP, 1:12 MAX SLOPE, SEE CIVIL DWGS.
 - 2 CONC LANDING, 5'-0"W x 5'-0"L MIN.
 - 3 PAINT STRIPING ON FLOOR OR PAVEMENT.
 - 4 EXTRUDED CONC CURB - 6" TYP W/ 24" RAD. OUTSIDE CORNERS, TYP UON. USE THICK-FACE CURB AT SIDEWALKS.
 - 5 7'-0" HIGH CONC. ENCL. W/ CHAIN LINK GATES & SIGHT OBSCURING SLATS. SEE STRUCTURAL FOR WALL CONST.
 - 6 ACCESSIBLE PARKING SIGN, SEE DET 8/A1.2.
 - 7 ACCESSIBLE PARKING STALL W/ PAINTED INTERNATIONAL SYMBOL OF ACCESS. MAX SLOPE 1v:48h.
 - 8 VAN ACCESSIBLE PARKING STALL W/ PAINTED INTERNATIONAL SYMBOL OF ACCESS. MAX SLOPE 1v:48h.
 - 9 ACCESSIBLE RAMP, MAX SLOPE 1v:12h, MAX RISE 6" MIN LENGTH 6'-0", W/ NON-SLIP SURFACE.
 - 10 4" THICK, 5'-0"W (UON) CONC WALK, MAX SLOPE 1v:20h.
 - 11 COMPACT PARKING STALL W/ PAINTED "COMPACT" DESIGNATION.
 - 12 PROVIDE SIGN W/ THE INTERNATIONAL SYMBOL OF ACCESS, ATTACH TO GLASS ADJACENT TO DOOR.
 - 13 APPROXIMATE ELECTRICAL TRANSFORMER LOCATION.
 - 14 APPROXIMATE GAS METER LOCATION.
 - 15 ACCESSIBLE PATH OF TRAVEL TO THE PUBLIC WAY.
 - 16 EXTERIOR AREA FOR ASSISTED RESCUE (IBC 1009.7)
 - 17 CONCRETE WHEEL STOP
 - 18 BICYCLE RACK (FOR 2 OR MORE BICYCLES)
 - 19 EV CHARGING STATIONS PER WAC 51-50-0429

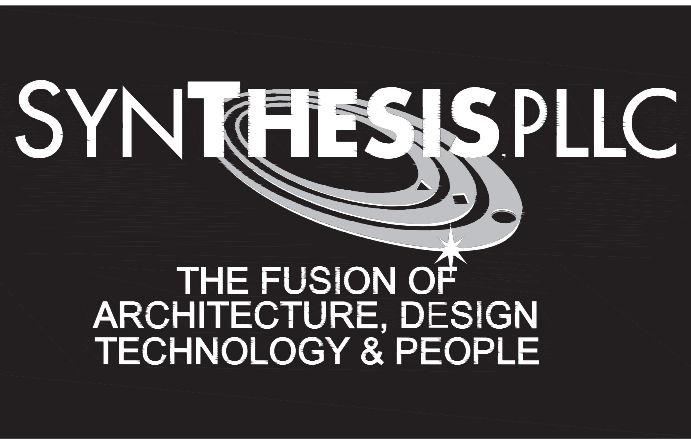
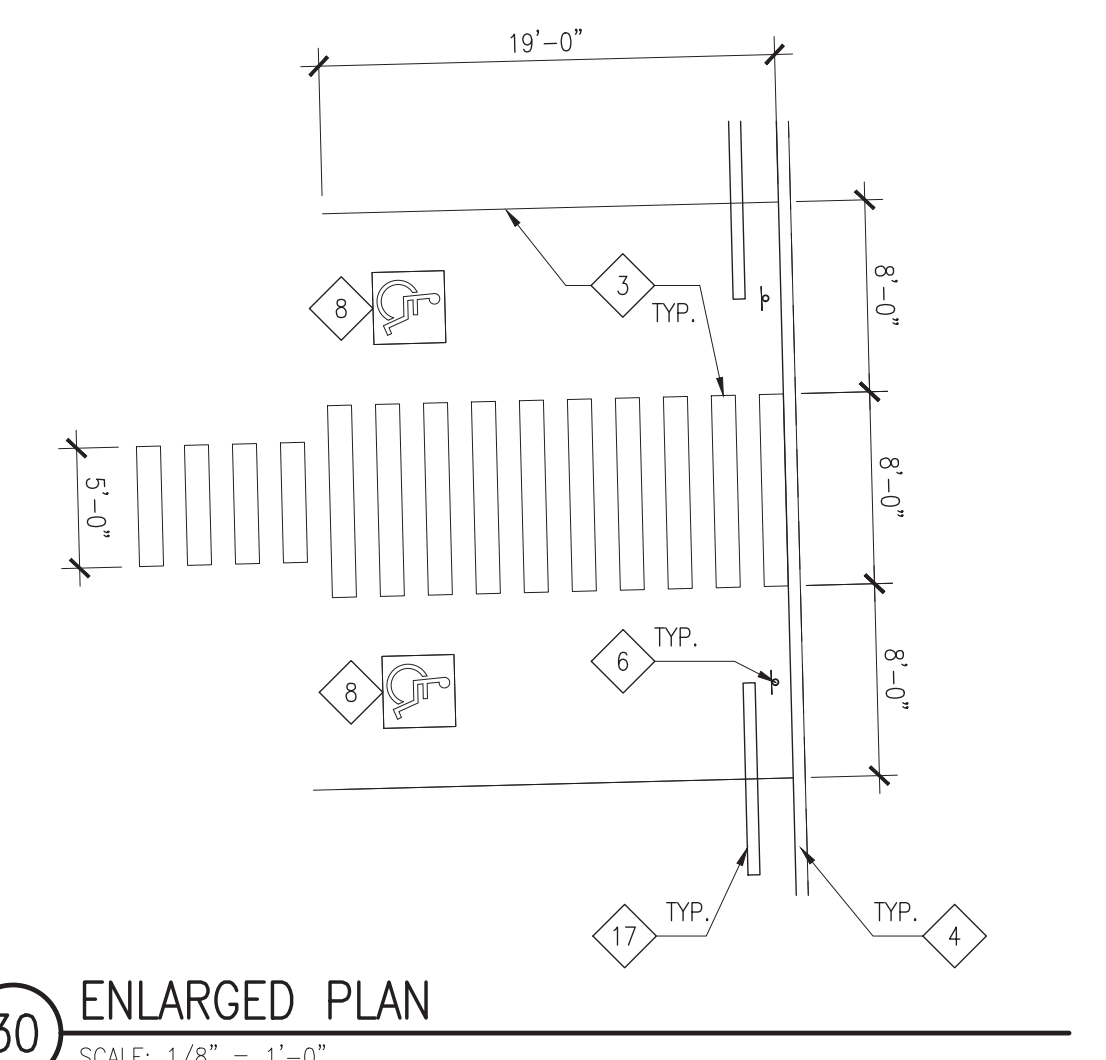
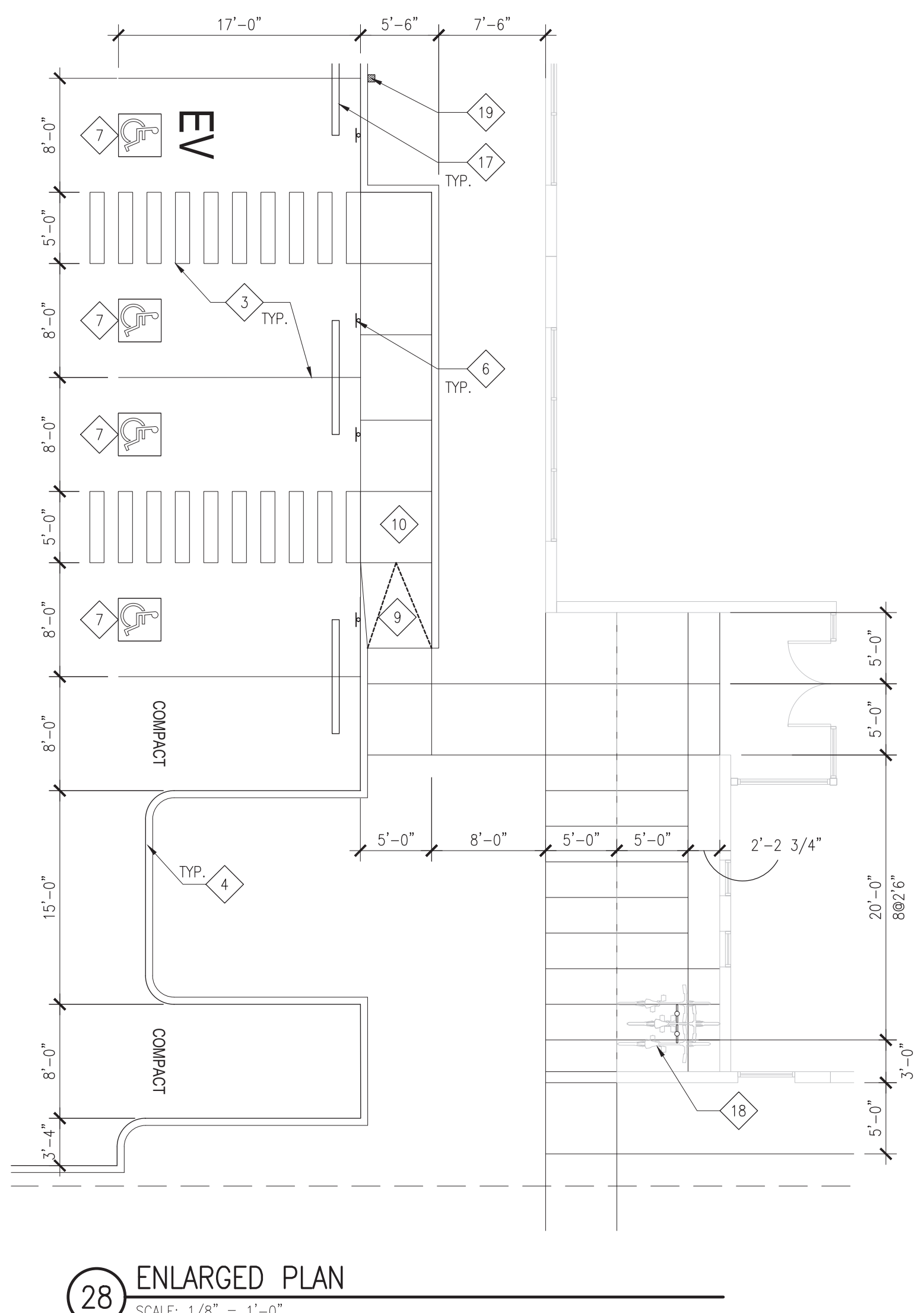

12503 Bel-Red Road, Suite 100
Bellevue, WA 98005
p 425 646 1818 f 425 646 4141



11411 NE 124th Street
Suite 190
Kirkland, WA 98034

REVISIONS

ISSUE NO.	DATE	ITEM
2	01 31 24	PERMIT SUBMITTAL
1	10 14 22	SEPA RESUBMITTAL
D	11 01 21	DESIGN REVIEW APPLICATION
C	09 15 21	PRELIMINARY BID
B	03 19 21	SEPA APPLICATION
A	01 05 21	PRE-APPLICATION

PROFESSIONAL STAMP

Digitally signed by
Randy Brown
Date:
2024.02.01
09:18:59
-08'00'

PROJECT INFORMATION

BUILDING B
Freeman Logistics
Puyallup, WA - 98371

SHEET INFORMATION

RELEASE FOR:	PERMIT SUBMITTAL
TITLE:	SITE DETAILS & ENLARGED SITE PLANS
DESIGNED BY:	DRAWN BY:
REVIEWED BY:	APPROVED BY:
DATE:	01 05 21
SHEET NO.:	A1.2
PROJECT NO.:	201401.13.031