

PROJECT MAP:

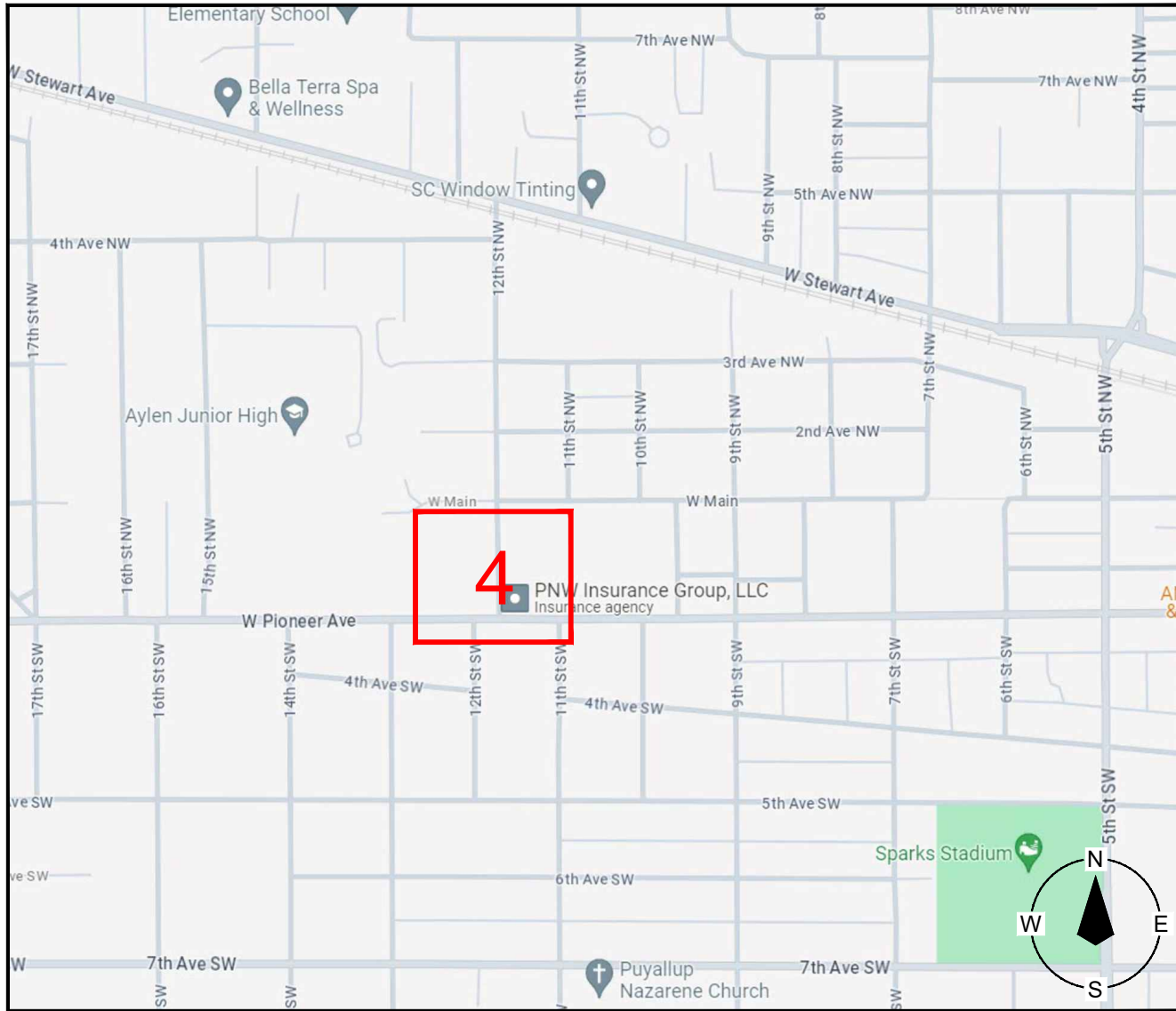

PRFUP20240862

The applicant is responsible to notify the city of a job start 48 hours in advance using the CityView portal.
 The permit and traffic control plans shall be posted at the job site and available to inspectors at all times.
 ** Public notification shall comply with PMC Chapter 11.05.110 **

Connecting The Future Since 1985



SAFETY | QUALITY | INTEGRITY | TEAMWORK

24-131

12TH & PIONEER POLE TRANSFER

SITE ADDRESS:

1110 W Pioneer Ave
 Puyallup, WA 98371

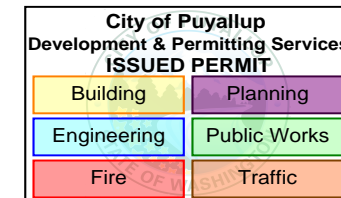

Know what's below.
 CALL before you dig.

CONTACTS:

CANNON COMPANIES

Jamie Stidhams - (253) 961-2537- jstidhams@teamcannon.com

CANNON COMPANIES

Paul Arechiga - (360) 259-3530 - parechiga@teamcannon.com

SCOPE OF WORK:

- TRANSFER UPN FIBER LINE TO NEW PSE POLE AND RAISE ATTACHMENT TO 23'-6"
- RAISE EXISTING ATTACHMENT TO 22'-0" ON EXISTING PSE POLE

POLE INFORMATION:

POLE COUNT	=	4	TRANSMISSION	=	0
POLES THAT NEED PERMIT	=	0	DISTRIBUTION	=	0
POLES THAT NEED MAKE READY	=	0			

BILL OF MATERIALS*:

*ALL FOOTAGES AND MATERIALS ARE ESTIMATED

ROW FOOTAGES*:		SITE FOOTAGES*:	
NEW AERIAL	= 0FT.	NEW BUILDING PATHWAY	= 0FT.
OVERLASH	= 0FT.	EXISTING BUILDING PATHWAY	= 0FT.
NEW UNDERGROUND	= 0FT.	NEW UNDERGROUND	= 0FT.
EXISTING UNDERGROUND	= 0FT.	EXISTING UNDERGROUND	= 0FT.
RISER(0)	= 0FT.		
TOTAL ROW FOOTAGE	= 0FT.	TOTAL SITE FOOTAGE	= 0FT.
TOTAL PROJECT FOOTAGE =		0 FT.	

SHEET INDEX

- 1 - COVER
- 2 - GENERAL NOTES
- 3 - LEGEND
- 4 - CONSTRUCTION PLAN



STANDARD

1. THE LOCATIONS OF UTILITIES SHOWN ON THE PLANS ARE APPROXIMATE. ALL UTILITY LOCATIONS SHALL BE VERIFIED PRIOR TO CONSTRUCTION. THE CONTRACTOR, AT HIS OWN EXPENSE, SHALL MAKE EXCAVATIONS AND BORINGS AHEAD OF THE WORK, AS NECESSARY, TO DETERMINE THE EXACT LOCATIONS OF UTILITIES AND UNDERGROUND STRUCTURES. IT IS UNDERSTOOD THAT THERE WILL BE INTERFERING UTILITIES AND OTHER UNDERGROUND PIPES, DRAINS OR STRUCTURES ENCOUNTERED THAT ARE NOT SHOWN OR AREAS SHOWN INCORRECTLY ON THE PLANS OR THAT HAVE NOT BEEN PREVIOUSLY DISCOVERED IN THE FIELD. THE CONTRACTOR AGREES THIS IS A NORMAL AND USUAL OCCURRENCE IN THE CONSTRUCTION OF UNDERGROUND IMPROVEMENTS. FURTHERMORE, CONTRACTORS UNDERSTAND AND AGREE THAT WORK IN SOME CASES PROPOSED PATH MAYBE IN CLOSE PROXIMITY TO SAID UTILITIES AND UNDERGROUND PIPES, DRAINS AND STRUCTURES NOT SHOWN ON THE PLANS WHICH MAY REQUIRE A CHANGE IN OPERATIONS AND MAY CAUSE SLOUGHING OF THE TRENCH, ADDITIONAL TRAFFIC CONTROL, ADDITIONAL PAVEMENT AND BACKFILL COSTS AND TIME. THE CONTRACTOR AGREES THAT A REASONABLE NUMBER OF THESE OCCURRENCES IS USUAL AND ORDINARY, AND ARE REFLECTED IN THE BID AND PLAN OF OPERATION. THE CONTRACTORS AGREES TO PROVIDE FOR THESE CONFLICTS AND AGREES TO PROVIDE FOR A REASONABLE AMOUNT OF TIME FOR DESIGN CHANGES AND/OR UTILITY RELOCATIONS DUE TO SAID CONFLICTS.
2. CALL THE UTILITIES UNDERGROUND LOCATION CENTER AT 811
3. INSPECTIONS - THE CONTRACTOR SHALL NOTIFY LOCAL JURISDICTIONS FOR REQUIRED INSPECTION SERVICES.
4. EXCESS WATER - SHOULD WATER BE ENCOUNTERED DURING CONSTRUCTION, IT SHALL BE THE CONTRACTOR'S RESPONSIBILITY TO DEWATER, AS PER LOCAL JURISDICTIONS STANDARD SPECIFICATIONS, BEFORE CONSTRUCTION CONTINUES.
5. NO SILT LADEN WATER IS TO BE DISCHARGED FROM THE SITE WITHOUT PASSING THROUGH AN EROSION CONTROL SYSTEM.
6. THE CONTRACTOR SHALL SCHEDULE AND CONTROL HIS/HER WORK SO AS TO COMPLY WITH ALL APPLICABLE ORDINANCES TO PREVENT ANY HAZARDS TO PUBLIC SAFETY, HEALTH AND WELFARE.
7. ALL STREETS SHALL BE KEPT FREE OF DIRT AND DEBRIS ON A CONTINUOUS BASIS.
8. AN APPROVED COPY OF THESE PLANS WILL BE ON THE JOB SITE WHENEVER CONSTRUCTION IS IN PROGRESS.
9. THE CONTRACTOR SHALL BE SOLELY AND COMPLETELY RESPONSIBLE FOR THE CONDITIONS OF THE JOB SITE, INCLUDING SAFETY OF ALL PERSONS AND PROPERTY DURING THE PERFORMANCE OF THE WORK. THIS REQUIREMENT WILL APPLY CONTINUOUSLY AND NOT BE LIMITED TO NORMAL WORKING HOURS.
10. PEDESTRIAN AND VEHICULAR ACCESS TO ADJACENT PROPERTIES SHALL BE MAINTAINED AT ALL TIMES EXCEPT WHERE PRIOR WRITTEN APPROVAL FROM THE PROPERTY OWNER HAS BEEN OBTAINED.
11. BARRICADE OPEN DEPRESSIONS AND HOLES OCCURRING AS PART OF THIS WORK, AND POST WARNING LIGHTS ON ADJACENT PROPERTIES WITH PUBLIC ACCESS. OPERATE WARNING LIGHTS DURING HOURS FROM DUSK TO DAWN EACH DAY AND AS OTHERWISE REQUIRED.
12. PROTECT STRUCTURES, UTILITIES, PAVEMENTS, AND OTHER FACILITIES FROM DAMAGE CAUSED BY SETTLEMENT, LATERAL MOVEMENT, UNDERMINING WASHOUT AND OTHER HAZARDS CREATED BY OPERATIONS UNDER THIS SECTION.

TRAFFIC CONTROL

1. THE CONTRACTOR IS ADVISED THAT ALL LANE CLOSURES SHALL BE KEPT TO A MINIMUM. LOCAL JURISDICTIONS WILL APPROVE ONLY THOSE LANE AND ROADWAY CLOSURES DETERMINED TO BE NECESSARY FOR THE CONTRACTOR TO ACCOMPLISH A SPECIFIC TASK. NO LANE OR ROADWAY CLOSURES WILL BE PERMITTED WITHOUT PRIOR APPROVALS.
2. THE CONTRACTOR SHALL KEEP ALL TRAFFIC LANES AND SHOULDERS CLEAR OF EQUIPMENT AND MATERIALS DURING NON-WORKING HOURS. EQUIPMENT AND MATERIALS SHALL NOT BE STORED ON THE STREETS. THE CONTRACTOR'S EMPLOYEES AND AGENTS SHALL NOT PARK PRIVATE VEHICLES ALONG THE ROADWAY OR MEDIAN.

SITE PREPARATION

1. SOD AND LAWN TO BE REMOVED SHALL BE CUT TO A NEAT VERTICAL LINE 6" MINIMUM BEYOND THE TRENCH LINE. SOD SHALL BE EITHER REMOVED FROM THE SITE, OR CAREFULLY STOCKPILED FOR REUSE.
2. SAW CUT PAVEMENT TO A NEAT VERTICAL LINE 8" TO 12" MINIMUM BEYOND THE TRENCH LINE. REPLACE PAVEMENT WITH LIKE MATERIAL (I.E., ASPHALT WITH ASPHALT, CONCRETE WITH CONCRETE).
3. EXCEPT AS NOTED HEREIN, ALL MATERIAL REMOVED SHALL BE TAKEN FROM THE SITE AND DISPOSED OF BY THE CONTRACTOR.

TRENCH EXCAVATION AND BACKFILL

1. TRENCH BACKFILL - WHERE MATERIAL EXCAVATED FROM TRENCHES IS UNSUITABLE FOR BACKFILL, THE CONTRACTOR SHALL BACKFILL WITH BANK RUN GRAVEL OR MAY ELECT TO USE CDF IN LIEU OF THE COMPACTION/PROCTOR PROCESS. STONEWAY MIX 351 IS ACCEPTABLE IN ALL LOCATIONS. QUICK SETTING MIX 1004 IS ACCEPTABLE IN NON-TRAFFIC AREAS. MIX 1121 IS TO BE USED IN TRAFFIC-BEARING LOCATIONS.
2. COMPACTION, WHEN NECESSARY, SHALL BE PERFORMED IN ACCORDANCE WITH LOCAL JURISDICTION REQUIREMENTS.

UTILITY DUCT

1. BURIED DUCT SHALL BE SCHEDULE 80 PVC OR EQUIVALENT, UNLESS NOTED OTHERWISE. MINIMUM CONDUIT COVER SHALL BE 36" WITH A MINIMUM SLOPE OF 1/2 % TO VAULT.
2. THOROUGHLY CLEAN CONDUIT BEFORE USING OR LAYING. DURING CONSTRUCTION AND AFTER THE DUCT LINE IS COMPLETED, PLUG ENDS OF CONDUITS TO PREVENT WATER WASHING INTO CONDUIT OR MANHOLES, TAKE PARTICULAR CARE TO KEEP CONDUITS CLEAR OF CONCRETE, DIRT AND ANY OTHER SUBSTANCE DURING THE COURSE OF CONSTRUCTION.
3. AFTER DUCT PLACEMENT HAS BEEN COMPLETED, PROOF AND CLEAN DEBRIS FROM EACH DUCT, ITS ENTIRE LENGTH. INSTALL PULL ROPE AND PLACE WATERTIGHT COMPRESSION PLUGS AT BOTH ENDS. ANY CONDUITS CONTAINING FIBER CABLE WILL REQUIRE SIMPLEX COMPRESSION PLUGS SEALING THE CONDUITS AROUND THE CABLE.
4. OUTSIDE INNERDUCT SHALL BE 1-1/4" OPTIC-GUARD NON-METALLIC FLEXIBLE, IN COLOR SUCH AS RED OR ORANGE, WITH PULL ROPES AND PLUGS. EXPOSED INNERDUCT INSIDE OF BUILDINGS SHALL BE PLENUM-RATED.

CEMENT CONCRETE PAVEMENT

1. ALL CONCRETE PAVEMENT REMOVED OR DAMAGED BY THIS WORK SHALL BE REPLACED ACCORDING TO THE STANDARD SPECIFICATIONS OF EACH JURISDICTION.

ASPHALT CONCRETE PAVEMENT

1. ALL ASPHALT CONCRETE PAVEMENT REMOVED OR DAMAGED BY THIS WORK SHALL BE REPLACED WITH CLASS B ASPHALT CONCRETE ACCORDING TO THE REQUIREMENTS OF EACH JURISDICTION.

GRAVEL AREAS

1. ALL GRAVEL AREAS DAMAGED OR REMOVED BY THIS WORK SHALL BE REPLACED WITH CRUSHED SURFACING TOP COURSE IN ACCORDANCE WITH THE REQUIREMENTS OF EACH JURISDICTION.

SITE RESTORATION

1. ALL DISTURBED OR DAMAGED AREAS SHALL BE RESTORED TO A CONDITION EQUAL TO, OR BETTER THAN, THAT WHICH EXISTED PRIOR TO PLACEMENT OF THE CONDUIT AND STRUCTURES.
2. VEGETATION REMOVED FOR THIS WORK SHALL BE REPLACED WITH IN-KIND PLANT MATERIAL AND SHALL BE PROPERLY PLANTED AND WATERED IN TO ENSURE ITS SURVIVAL.
3. SITE RESTORATION SHALL INCLUDE REPLACING EXISTING CABLING AND PULL ROPES IN EXISTING CONDUITS AS THEY EXISTED PRIOR TO CONSTRUCTION.

WATER QUALITY

1. CONSTRUCTION ACTIVITIES OCCURRING ADJACENT TO STORM DRAINAGE STRUCTURES SHALL COMPLY WITH THE STATE OF WASHINGTON'S WATER QUALITY STANDARDS
2. THE CONTRACTOR SHALL LIMIT THE USE OF PETROLEUM PRODUCTS ON THE SITE.

DIRECTIONAL BORING

1. WHEN BORING ROADWAYS, INSTALL (1) 4" SCHEDULE 40 PVC CONDUIT WITH PULL ROPES AND PLUGS.
2. PROTECT EXISTING UTILITIES -- COORDINATE WITH LOCAL JURISDICTIONS TO POTHOLE AS REQUIRED TO LOCATE EXISTING UTILITIES.

FIRE PROTECTION

1. ALL INSTALLED BACKBOARDS SHALL BE PAINTED WITH FIRE-RESISTANT PAINT.
2. ALL FIRE SEALED DUCT ENDS AND CORES SHALL BE 2 HOUR FIRE-RATED. ALL FIRE SEAL IN EXISTING LOCATIONS SHALL BE REPAIRED OR REPLACED UPON DUCT OR CABLE PLACEMENT.

AERIAL INSTALLATION

1. ALL AERIAL CONSTRUCTION IS TO BE PERFORMED TO INDUSTRY ACCEPTABLE STANDARDS.
2. ALL NEW AERIAL (AND EXISTING) CABLE HEIGHTS OF ATTACHMENT TO BE DOCUMENTED AT TIME OF CONSTRUCTION.
3. 6.35 MM STRAND TO BE USED WITH STANDARD 1/4" POLE LINE HARDWARE UNLESS OTHERWISE SPECIFIED. BOND STRAND TO POWER MAIN WHERE APPLICABLE.
4. ALL ANCHORS TO BE USED WILL BE 3/4" SCREW TYPE.
5. IT IS THE CONTRACTOR'S RESPONSIBILITY TO MAINTAIN AND FOLLOW ALL NESG CODES ALONG WITH APPLICABLE LOCAL AND REGIONAL GOVERNING AUTHORITIES. ANY DISCREPANCIES BETWEEN THESE AUTHORITIES AND OR THE CONSTRUCTION PERMITS IS TO BE VALIDATED WITH THE DESIGNER OR ENGINEER PRIOR TO CONSTRUCTION.

PRFUP20240862

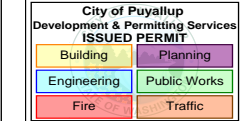

24-131
 12TH & PIONEER POLE TRANSFER
 1110 W PIONEER AVE
 PUYALLUP, WA 98371

PROJECT REVISIONS		
REV	DATE	DESCRIPTION OF CHANGE

CODE: 24-131
 DATE: 05/23/2024
 PROJECT MANAGER: JS
 DRAWN BY: AB
 SCALE:
 NO SCALE

GENERAL NOTES

2 / 4

REV	DATE	DESCRIPTION OF CHANGE	BY	QC

CODE:	24-131
DATE:	05/23/2024
PROJECT MANAGER:	JS
DRAWN BY:	AB
SCALE:	NO SCALE

LINE TYPES

- PARCEL LINES
- BUILDING OUTLINE
- LANE LINE
- CENTER LINE / STATION LINE
- FOG LINE
- EDGE OF PAVEMENT
- RIGHT OF WAY
- SIDEWALK
- CROSSWALK
- FENCE
- GUARD RAIL
- POWER
- TRAFFIC SIGNAL
- COMMUNICATION
- TELECOMMUNICATION
- SEWER MAIN
- SIDE SEWER
- DRAIN MAIN
- DRAINAGE DITCH
- GAS
- OIL
- STEAM
- WATER
- UNKNOWN UTILITY
- STRAW WATTLES
- TRAFFIC CONES
- PROPOSED NEW CONDUIT
- PROPOSED NEW STRUCTURE
- EXISTING CONDUIT/INFRASTRUCTURE
- PROPOSED NEW AERIAL STRAND
- EXISTING AERIAL

SYMBOLS

	UTILITY POLE (EXIST / NEW)		TIGER HOUSE
	UTILITY RISER (EXIST / NEW)		CABINET
	STREET LIGHT		PEDESTAL
	CROSS WALK SIGNAL		BOREPIT (SIZE MAY VARY)
	SHRUBBERY		EXISTING SPLICE CASE
	TREE		NEW SPLICE CASE
	CATCH BASIN		NEW COAX TAP
	CATCH BASIN W/ SOCKET		NEW STORAGE
	FIRE HYDRANT		POLE ANCHOR/GUY PROPOSED
	WATER METER		FOOTAGE NOTE
	MANHOLE		FOOTAGE NOTE OVER MULTIPLE SHEETS
	UTILITY VALVE		UTILITY POTHOLE
	17X30 VAULT		STREET SIGN
	24X36 VAULT		NORTH ARROW
	36X48 VAULT		LANE DIRECTION INDICATOR
	4X4 VAULT		BUS STOP LOCATION
	25-TA VAULT		
	35-TA VAULT		
	253-TA VAULT		
	233-LA		
	444-LA		
	UNK VAULT (SIZE MAY VARY)		
	DOG HOUSE		

MARK-UP NOTATIONS

	DISTANCE STATION
	DISTANCE DIMENSION
	POLE # CALLOUT
	CONSTRUCTION NOTE CALLOUT
	CROSS SECTION SYMBOL
	CROSS SECTION NAME
	CROSS SECTION PAGE
	WORK BEING DONE LOCATION
	PHOTO NOTE CALLOUT
	PHOTO LOCATOR/ORIENTATION CALLOUT

HATCH PATTERNS

	CONCRETE ASPHALT
	CONCRETE PANELS
	BRICK/COBBLE
	LANDSCAPE
	GRAVEL
	LIMITS OF RESTORATION

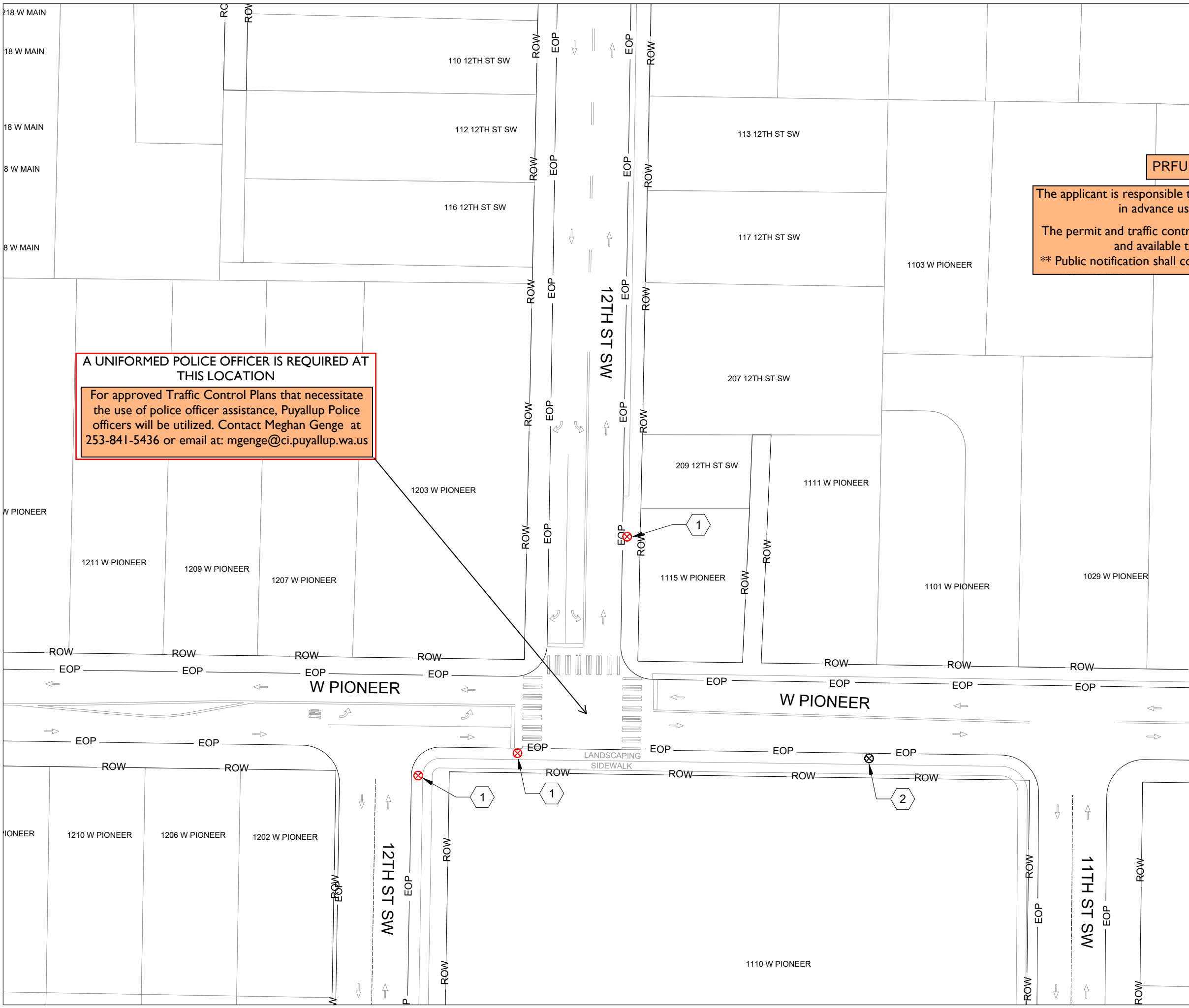

- CONSTRUCTION NOTES:**
- 1 TRANSFER UPN FIBER LINE TO NEW PSE POLE AND RAISE ATTACHMENT TO 23'-6"
 - 2 RAISE EXISTING ATTACHMENT TO 22'-0" ON EXISTING PSE POLE

City of Puyallup
Development & Permitting Services
ISSUED PERMIT

Building	Planning
Engineering	Public Works
Fire	Traffic

PRFUP20240862

The applicant is responsible to notify the city of a job start 48 hours in advance using the CityView portal.

The permit and traffic control plans shall be posted at the job site and available to inspectors at all times.

**** Public notification shall comply with PMC Chapter 11.05.110 ****

A UNIFORMED POLICE OFFICER IS REQUIRED AT THIS LOCATION

For approved Traffic Control Plans that necessitate the use of police officer assistance, Puyallup Police officers will be utilized. Contact Meghan Genge at 253-841-5436 or email at: mgenge@ci.puyallup.wa.us

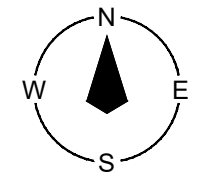

24-131
12TH & PIONEER POLE TRANSFER
1110 W PIONEER AVE
PUYALLUP, WA 98371

REV	DATE	DESCRIPTION OF CHANGE	BY	QC

CODE: 24-131
DATE: 05/23/2024
PROJECT MANAGER: JS
DRAWN BY: AB
SCALE:

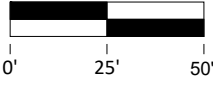

CONSTRUCTION PLAN