

**City of Puyallup**  
**Development & Permitting Services**  
**ISSUED PERMIT**

Building	Planning
Engineering	Public Works
Fire	Traffic

PRFUP20240510

**CONSTRUCTION NOTES**

- CALL UTILITY LOCATE AT 811 72 HOURS PRIOR TO TRENCHING OR DIGGING.
- THE EXISTENCE AND LOCATION OF ANY UNDER GROUND UTILITY PIPES OR DIGGING, STRUCTURE SHOWN ON THESE PLANS WERE OBTAINED BY FIELD INSPECTION AND A SEARCH OF THE AVAILABLE CITY OR COUNTY RECORDS. SINCE THE ACTUAL LOCATION AND NATURE OF THE UNDER GROUND FACILITIES MAY BE SOME WHAT DIFFERENT FROM THE SHOWN, THE CONTRACTOR IS REQUIRED TO VERIFY PRIOR TO EXCAVATION.
- FOR UNDERGROUND ACTIVITY: TEST AND VENTILATE MANHOLE/UTILITY VAULT PRIOR TO ENTRY. PLACE WARNING DEVICES AND WORK AREA PROTECTION AS REQUIRED, AND USE EYE AND HEAD SAFETY PROTECTION PER FEDERAL, STATE, AND LOCAL REGULATIONS.
- ALL EXCAVATION, TRENCHING, AND SHORING IS TO ADHERE TO THE CODE OF FEDERAL WAY REGULATIONS (CFR) 1926.650 SUBPART P.
  - PROVIDED ALL PITS WITH 1'X 1' SLOPE ART ONE END OF EXCAVATION FOR TECHNICIAN INGRESS/EGRESS.
  - EXCAVATED SPOILS ARE TO BE NO LESS THAN 24" FROM EDGE OF PIT OR TRENCH.
  - BARRICADE ALL OPEN PITS AND TRENCHING FOR PUBLIC SAFETY. ALL BARRICADE MUST BE EQUIPPED WITH FLASHING LIGHTS FOR NIGHT VISIBILITY.
  - FOR PITS GREATER THAN 4' IN DEPTH, USE APPROPRIATE SHORING FOR WALL STABILITY.
- TRENCH COVER IS TO BE 9" MINIMUM AND FREE OF ROCKS, DEBRIS, AND CLODS. THE TRENCH IS TO BE A MINIMUM OF 9" COVER IN DEVELOPED AREAS AND A MINIMUM OF 48" OF COVER IN UNDEVELOPED AREAS (ANY VARIANCE FROM THESE STANDARDS WILL BE SPECIFIED ON THE PLANS)
- ALL ASPHALT/CONCRETE AND LANDSCAPING REMOVED, DISTURBED, OR DAMAGES AS A RESULT OF CONSTRUCTION SHALL BE RESTORED TO ORIGINAL CONDITION OR BETTER.
- NORMAL / GUIDED-BORING METHOD RECOMMENDED WHEN BORING.
- ADHERE TO AIRTIGHT GUIDELINES UNLESS OTHERWISE NOTED.
- BOND BURIED/AERIAL FACILITIES AS A REQUIRED BY JURISDICTIONAL AGENCY(S).
- AERIAL FACILITIES ARE TO BE TESTED PRIOR TO BEGINING WORK PER STATE AND LOCAL REGULATIONS.
- ALL WORK AREA PROTECTION FOR TRAFFIC CONTROL IS TO BE WITH APPROVED WARNING DEVICES AND PLACED PER STATE DEPARTMENT OF TRANSPORTATION AND/OR PUBLIC WORKS ENGINEERING DEPARTMENT STANDARDS AND SPECIFICATIONS. IF REQUIRED A TRAFFIC CONTROL PLAN SHALL BE SUBMITTED TO THE REQUESTING PERMITTING AGENCY PRIOR TO BEGINNING WORK. PERMITTING AGENCIES MUST BE NOTIFIED 48 HOURS IN ADVANCE OF CONSTRUCTION ACTIVITIES.
- EXISTING PEDESTRIAN CROSSWALKS AND WALKING AREAS SHALL BE MAINTAINED AT ALL TIMES. AS NECESSARY, TEMPORARY PEDESTRIAN CROSSWALKS AND WALKING AREAS SHALL BE PROVIDED AND MAINTAINED PER STATE DEPARTMENT OF TRANSPORTATION AND/OR PUBLIC WORKS ENGINEERING DEPARTMENT STANDARDS AND SPECIFICATIONS.
- THE FOLLOWING FOOTAGES ARE ESTIMATES. FOOTAGES TO BE VERIFIED PRIOR TO CONSTRUCTIONS.

**ESTIMATED TOTALS**

SIDEWALK (PCC) R&R:	0 S.F.
ASPHALT (AC) R&R:	0 S.F.
TOTAL EXISTING CONDUIT USED:	533 L.F.
TOTAL NEW BORE:	0 L.F.
TOTAL NEW DIRT TRENCH:	0 L.F.
TOTAL NEW AERIAL:	462 L.F.
TOTAL OVER LASH:	0 L.F.
TOTAL AERIAL USED:	0 L.F.
TOTAL AERIAL AND UG USED:	0 L.F.

CUSTOMER NAME: N/A  
 LCON NAME: N/A  
 LCON NUMBER: N/A  
 ARMOR ID: N/A  
 WFMT ID: N/A

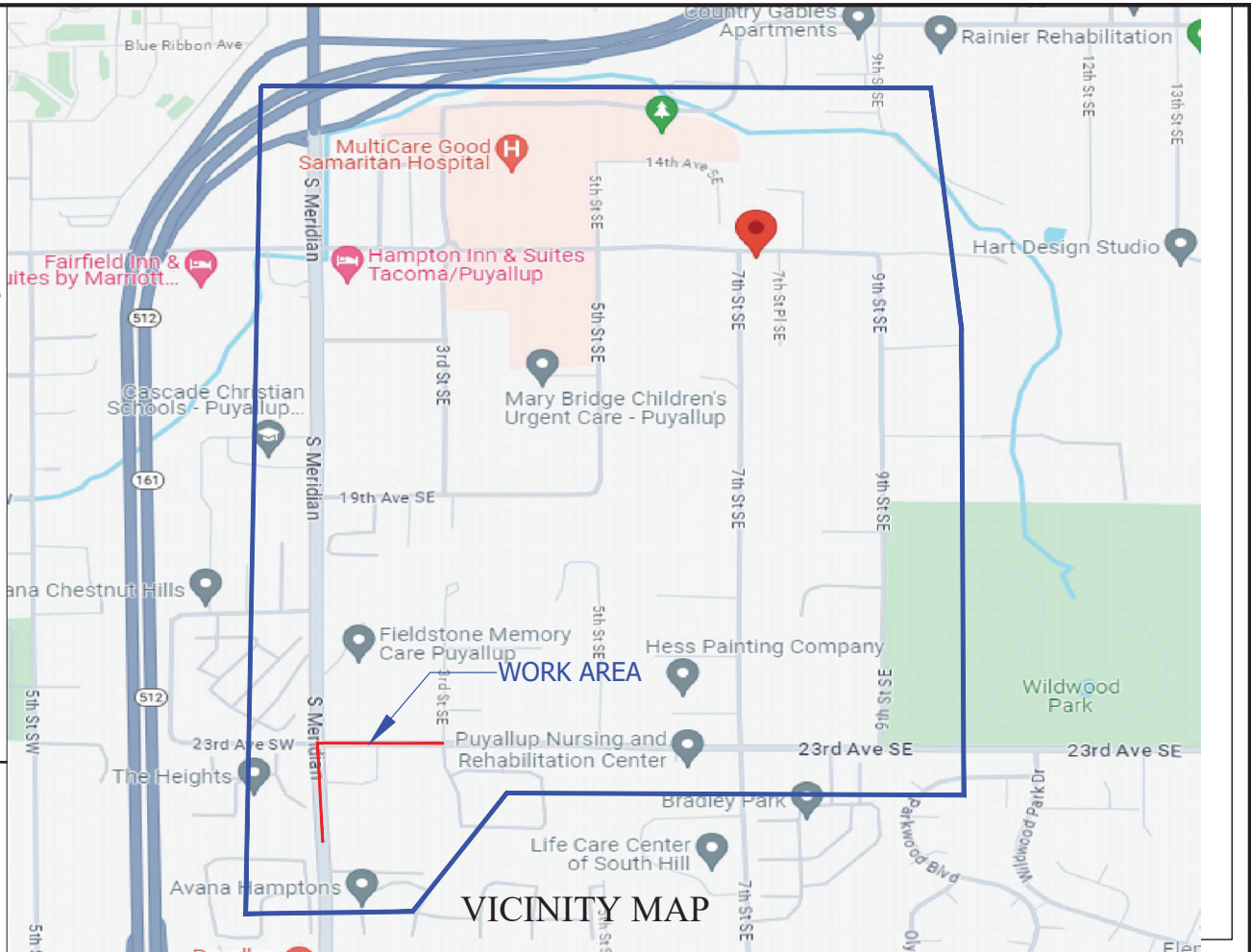

**VICINITY MAP**

DESCRIPTION OF WORK:  
 POF:

Lumen to access Existing HH1803, ex PED, create 2 bore pits, bore approx 70', access MH177, create 1 bore pit and place new conduit - JOB# N.981500



FIBER ENGINEER  
 NAME: MARIA HAYES  
 PHONE: (253) 393-5387  
 EMAIL: MARIA.HAYES@LUMEN.COM

CUSTOMER INFORMATION  
 1502 7th St Pl SE, Puyallup, WA 98372, USA

CONTACT ENGINEER  
 NAME: CHRISTOPHER  
 PHONE: 1-940-465-4662  
 EMAIL: Christopher.Huff@cyient.com

DRAFTED BY:  
 CYIENT INC



NOTICE- NOT FOR DISCLOSURE OUTSIDE OF LUMEN AND AFFILIATES EXCEPT UNDER WRITTEN AGREEMENT

SECTION: 34  
 TOWNSHIP: 20N  
 RANGE: 4E

CLLI: PYLPWA01  
 SCALE: 1"=100'  
 JOB: P.981500 DATE: 01/02/2023

GEO CODE: NA  
 REVISION: 1  
 SH: 01 OF 03

### AERIAL LEGEND

ANC	ANCHOR
CA ARM	CABLE ARM
CATV	CABLE TV
DG	DOWN GUY
DGA	DOUBLE GUARD ARM
FGA	FIBER GLASS ARM
F/S	FIELD SIDE
GA	GUARD ARM
HOA	HEIGHT OF ATTACHMENT
M/R	MAKE READY
OHG	OVERHEAD GUY
R/S	ROAD SIDE
SLAN	LIGHT OR POWER COMPANY INVENTORY NUMBER
SWA	SIDEWALK ANCHOR AND GUY
T	TELEPHONE
TERM	TERMINAL
TRANS	TRANSFORMER
TAPE & SHAPE	REQUEST FOR POWER COMPANY TO CLEAN UP SECONDARY POWER CABLES AND/OR TOP OF RISER CABLES SO PROPOSED CABLE CAN BE ATTACHED WITHOUT VIOLATING THE 40" RULE

**CABLE ARM ATTACHMENT LOCATION:**

TF	TOP FIELD SIDE
TS	TOP STREET SIDE
TIP	TOP INSIDE POSITION
TIS	TOP INSIDE STREET SIDE
TMP	TOP MIDDLE POSITION
TOP	TOP OUTSIDE POSITION
TOS	TOP OUTSIDE STREET SIDE
BF	BOTTOM FIELD SIDE
BS	BOTTOM STREET SIDE
BIP	BOTTOM INSIDE POSITION
BIS	BOTTOM INSIDE STREET SIDE
BMP	BOTTOM MIDDLE POSITION
BOP	BOTTOM OUTSIDE POSITION
BOS	BOTTOM OUTSIDE STREET SIDE

### EXISTING EQUIPMENT LEGEND

	CENTERLINE		TELEPHONE BULLET PEDESTAL		ELECTRIC PEDESTAL/CABINET		GAS METER		IRRIGATION METER
	TRAFFIC LANE		TELEPHONE REPEATER		ELECTRIC TRANSFORMER		GAS VALVE		IRRIGATION VALVE
	BIKE/FOG LANE		TELEPHONE PEDESTAL		ELECTRIC METER		TRAFFIC SIGNAL VAULT/HANDHOLE		CULVERT
	RIGHT OF WAY		TELEPHONE VAULT/HANDHOLE		ELECTRIC VAULT/HANDHOLE		TRAFFIC SIGNAL POLE		C/L MONUMENT
	PROPERTY LINE		TELEPHONE CABINET		ELECTRIC MANHOLE		WATER METER		POLE ITEM NO.
	EASEMENT		TELEPHONE MANHOLE		ELECTRIC J-BOX		WATER VALVE		TREES
	CURB & GUTTER		TELEPHONE COOL PED		STREETLIGHT		FIRE HYDRANT		SHRUB
	EDGE OF PAVEMENT		TELEPHONE SAI		CATV BULLET PEDESTAL		WATER MANHOLE		
	RAILROAD		TELEPHONE USAM		CATV PED		STORM DRAIN CATCH BASIN		
	FENCE		TELEPHONE OWNED POLE		CATV VAULT/HANDHOLE		STORM DRAIN INLET		
	TELCO		JOINT USE POLE		SEWER MANHOLE		STORM DRAIN MANHOLE		
	TELCO		TRAFFIC ARROW		MANHOLE				
	ELECTRIC		TURN ARROWS		PEDESTAL				
	CATV								
	GAS								
	TRAFFIC SIGNAL								
	WATER								
	SEWER								
	STORM DRAIN								
	IRRIGATION								
	TRENCH/BORE								

POLE NUMBER	XX'-X"
DISTANCE FROM EOP	X'
LOWEST POWER ATTACHMENT	X'
PROPOSED ATTACHMENT	XX'

00	POWER POLE #	NT		
	LUMEN POLE # / A #	NT / NT		
	POLE HEIGHT-CLASS	00-0	PROP HOA	0'-0"
	ATTACHMENTS	HOA	POSITION	MISC
MAKE READY NOTES:				

### PROPOSED EQUIPMENT LEGEND

	PARKWAY TRENCH		4'X4' BORE PIT		SIDEWALK ANCHOR & DOWN GUY
	BORE		FSAI		ANCHOR & DOWN GUY
	ASPHALT TRENCH		HANDHOLE		DOWN GUY
	UNDERGROUND BUILD		PEDESTAL		ASPHALT TRENCH FOOTAGE
	AERIAL BUILD		FLOWERPOT		DIRT OR S/W TRENCH FOOTAGE
	UNDERGROUND BUILD-SLACK				
	AERIAL BUILD-SLACK SPAN				
	AERIAL STRAND				
			BORE FOOTAGE		AERIAL FOOTAGE
			P.5		PROPOSED POLE / POLE NUMBER

### PROPOSED CABLE

	LONG TERMINAL TAIL
	F1 FEEDER
	PRETERM FLEXNAP FIBER
	24A
	48A
	72A
	96A
	144A
	216A
	144A
	216A
	288A
	432A
	48F FLEXNAP
	72F FLEXNAP
	96F FLEXNAP
	144F FLEXNAP
	216F FLEXNAP
	BULK FIBER



FIBER ENGINEER  
NAME: MARIA HAYES  
PHONE: (253) 393-5387  
EMAIL: MARIA.HAYES@LUMEN.COM

CONTRACT ENGINEER  
NAME: CHRISTOPHER  
PHONE: 1-940-465-4662  
EMAIL: Christopher.Huff@cyient.com



NOTICE- NOT FOR DISCLOSURE OUTSIDE OF LUMEN AND AFFILIATES EXCEPT UNDER WRITTEN AGREEMENT

CUSTOMER INFORMATION  
1502 7th St P1 SE, Puyallup, WA 98372, USA

DRAFTED BY:  
CYIENT INC

SECTION: 34  
TOWNSHIP: 20N  
RANGE: 4E

CLLI:PYLPWA01  
SCALE: 1"=100'  
JOB: P.981500 DATE:01/02/2023

GEO CODE: NA  
REVISION: 1  
SH: 02 OF 03

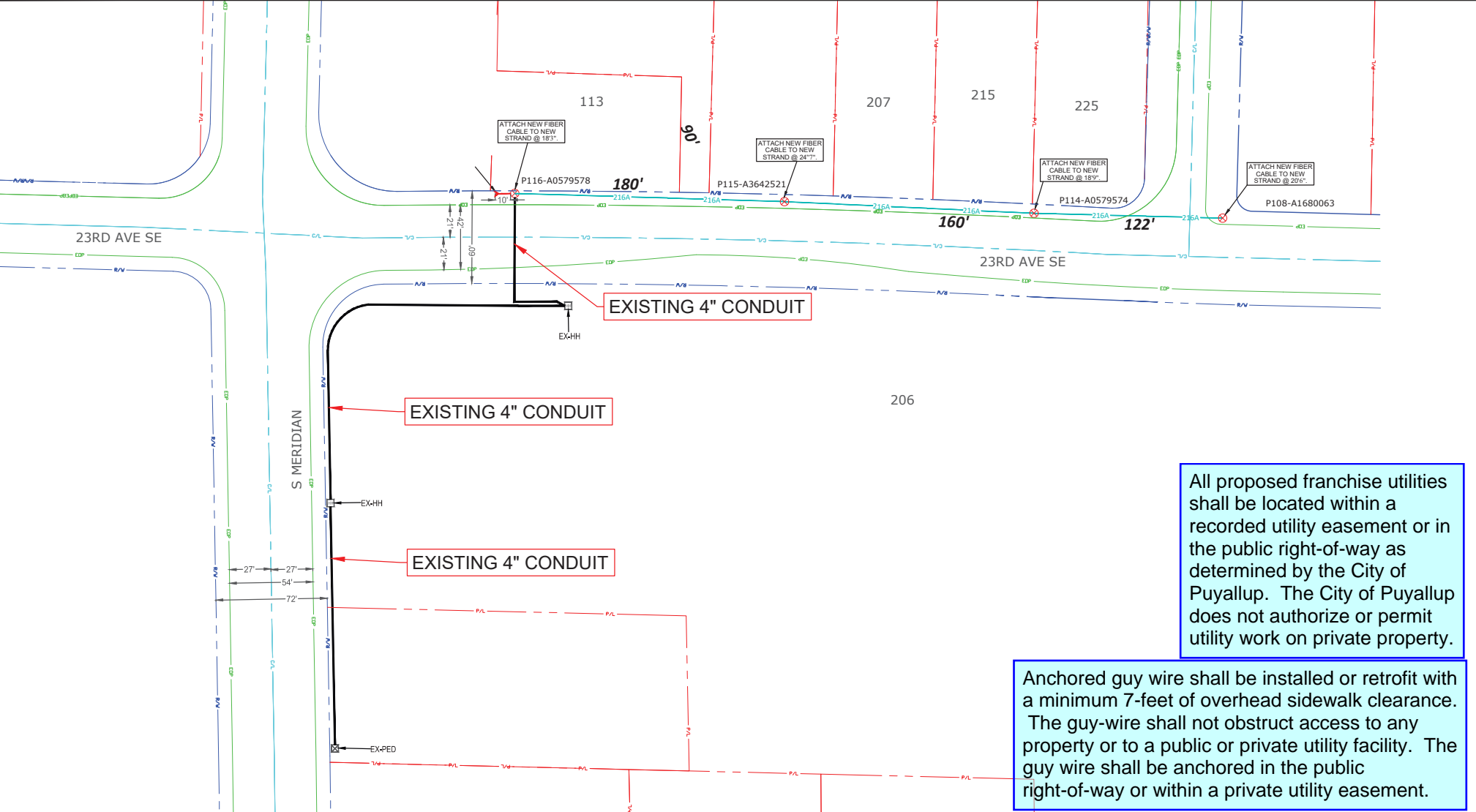

All proposed franchise utilities shall be located within a recorded utility easement or in the public right-of-way as determined by the City of Puyallup. The City of Puyallup does not authorize or permit utility work on private property.

Anchored guy wire shall be installed or retrofit with a minimum 7-feet of overhead sidewalk clearance. The guy-wire shall not obstruct access to any property or to a public or private utility facility. The guy wire shall be anchored in the public right-of-way or within a private utility easement.



FIBER ENGINEER  
NAME: MARIA HAYES  
PHONE: (253) 393-5387  
EMAIL: MARIA.HAYES@LUMEN.COM

CONTRACT ENGINEER  
NAME: CHRISTOPHER  
PHONE: 1-940-465-4662  
EMAIL: Christopher.Huff@cyient.com



NOTICE- NOT FOR DISCLOSURE OUTSIDE OF LUMEN AND AFFILIATES EXCEPT UNDER WRITTEN AGREEMENT

CUSTOMER INFORMATION  
1502 7th St P1 SE, Puyallup, WA 98372, USA

DRAFTED BY:  
CYIENT INC

SECTION: 34  
TOWNSHIP: 20N  
RANGE: 4E

CLLI:PYLPWA01  
SCALE: 1"=100'  
JOB: P.981500 DATE:01/02/2023

GEO CODE: NA  
REVISION: 1  
SH: 03 OF 03