

PAGE

SHEET INDEX

1	SHEET INDEX
2	COVER SHEET & VICINITY MAP
3	LEGEND
4-5	SITE-PLAN



FIBER ENGINEER
 NAME: MARIA HAYES
 PHONE: (253) 393-5387
 EMAIL: MARIA.HAYES@LUMEN.COM

CONTRACT ENGINEER
 NAME: CHRISTOPHER
 PHONE: 1-940-465-4662
 EMAIL: Christopher.Huff@cyient.com



NOTICE- NOT FOR DISCLOSURE OUTSIDE OF LUMEN AND AFFILIATES EXCEPT UNDER WRITTEN AGREEMENT

CUSTOMER INFORMATION
 1502 7th St Pl SE, Puyallup, WA 98372, USA

DRAFTED BY:
 CYIENT INC

SECTION: 34
 TOWNSHIP: 20N
 RANGE: 4E

CLLI:PYLPWA01
 SCALE: 1"=100'

GEO CODE: NA
 REVISION: 1

JOB: P.981500 DATE: 04/19/2024 SH: 01 OF 05

CONSTRUCTION NOTES

1. CALL UTILITY LOCATE AT 811 72 HOURS PRIOR TO TRENCHING OR DIGGING.
2. THE EXISTENCE AND LOCATION OF ANY UNDER GROUND UTILITY PIPES OR DIGGING STRUCTURE SHOWN ON THESE PLANS WERE OBTAINED BY FIELD INSPECTION AND A SEARCH OF THE AVAILABLE CITY OR COUNTY RECORDS. SINCE THE ACTUAL LOCATION AND NATURE OF THE UNDER GROUND FACILITIES MAY BE SOME WHAT DIFFERENT FROM THE SHOWN. THE CONTRACTOR IS REQUIRED TO VERIFY PRIOR TO EXCAVATION.
3. FOR UNDERGROUND ACTIVITY: TEST AND VENTILATE MANHOLE/UTILITY VAULT PRIOR TO ENTRY. PLACE WARNING DEVICES AND WORK AREA PROTECTION AS REQUIRED, AND USE EYE AND HEAD SAFETY PROTECTION PER FEDERAL WAY, STATE, AND LOCAL REGULATIONS.
4. ALL EXCAVATION, TRENCHING, AND SHORING IS TO ADHERE TO THE CODE OF FEDERAL WAY REGULATIONS (CFR) 1926.650 SUBPART P.
 - a. PROVIDED ALL PITS WITH 1'X 1' SLOPE ART ONE END OF EXCAVATION FOR TECHNICIAN INGRESS/EGRESS.
 - b. EXCAVATED SPOILS ARE TO BE NO LESS THAN 24" FROM EDGE OF PIT OR TRENCH.
 - c. BARRICADE ALL OPEN PITS AND TRENCHING FOR PUBLIC SAFETY. ALL BARRICADE MUST BE EQUIPPED WITH FLASHING LIGHTS FOR NIGHT VISIBILITY.
 - d. FOR PITS GREATER THAN 4' IN DEPTH, USE APPROPRIATE SHORING FOR WALL STABILITY
5. TRENCH COVER IS TO BE 9" MINIMUM AND FREE OF ROCKS, DEBRIS, AND CLODS. THE TRENCH IS TO BE A MINIMUM OF 9" COVER IN DEVELOPED AREAS AND A MINIMUM OF 48" OF COVER IN UNDEVELOPED AREAS (ANY VARIANCE FROM THESE STANDARDS WILL BE SPECIFIED ON THE PLANS)
6. ALL ASPHALT/CONCRETE AND LANDSCAPING REMOVED, DISTURBED, OR DAMAGES AS A RESULT OF CONSTRUCTION SHALL BE RESTORED TO ORIGINAL CONDITION OR BETTER.
7. NORMAL / GUIDED-BORING METHOD RECOMMENDED WHEN BORING.
8. ADHERE TO AIRTIGHT GUIDELINES UNLESS OTHERWISE NOTED.
9. BOND BURIED/AERIAL FACILITIES AS A REQUIRED BY JURISDICTIONAL AGENCY(S).
10. AERIAL FACILITIES ARE TO BE TESTED PRIOR TO BEGINING WORK PER STATE AND LOCAL REGULATIONS.
11. ALL WORK AREA PROTECTION FOR TRAFFIC CONTROL IS TO BE WITH APPROVED WARNING DEVICES AND PLACED PER STATE DEPARTMENT OF TRANSPORTATION AND/OR PUBLIC WORKS ENGINEERING. DEPARTMENT STANDARDS AND SPECIFICATIONS. IF REQUIRED A TRAFFIC CONTROL PLAN SHALL BE SUBMITTED TO THE REQUESTING PERMITTING AGENCY PRIOR TO BEGINNING WORK PERMITTING AGENCIES MUST BE NOTIFIED 48 HOURS IN ADVANCE OF CONSTRUCTION ACTIVITIES.
12. EXISTING PEDESTRIAN CROSSWALKS AND WALKING AREAS SHALL BE MAINTAINED AT ALL TIMES. AS NECESSARY, TEMPORARY PEDESTRIAN CROSSWALKS AND WALKING AREAS SHALL BE PROVIDED AND MAINTAINED PER STATE DEPARTMENT OF TRANSPORTATION AND/OR PUBLIC WORKS ENGINEERING DEPARTMENT STANDARDS AND SPECIFICATIONS.
13. THE FOLLOWING FOOTAGES ARE ESTIMATES. FOOTAGES TO BE VERIFIED PRIOR TO CONSTRUCTIONS.

ESTIMATED TOTALS

SIDEWALK (PCC) R&R:	0 S.F.
ASPHALT (AC) R&R:	0 S.F.
TOTAL EXISTING CONDUIT USED:	1339 L.F.
TOTAL NEW BORE:	0 L.F.
TOTAL NEW DIRT TRENCH:	0 L.F.
TOTAL NEW AERIAL:	0 L.F.
TOTAL OVER LASH:	136 L.F.
TOTAL AERIAL USED:	0 L.F.
TOTAL AERIAL AND UG USED:	0 L.F.

CUSTOMER NAME: N/A
 LCON NAME: N/A
 LCON NUMBER: N/A
 ARMOR ID: N/A
 WFMT ID: N/A

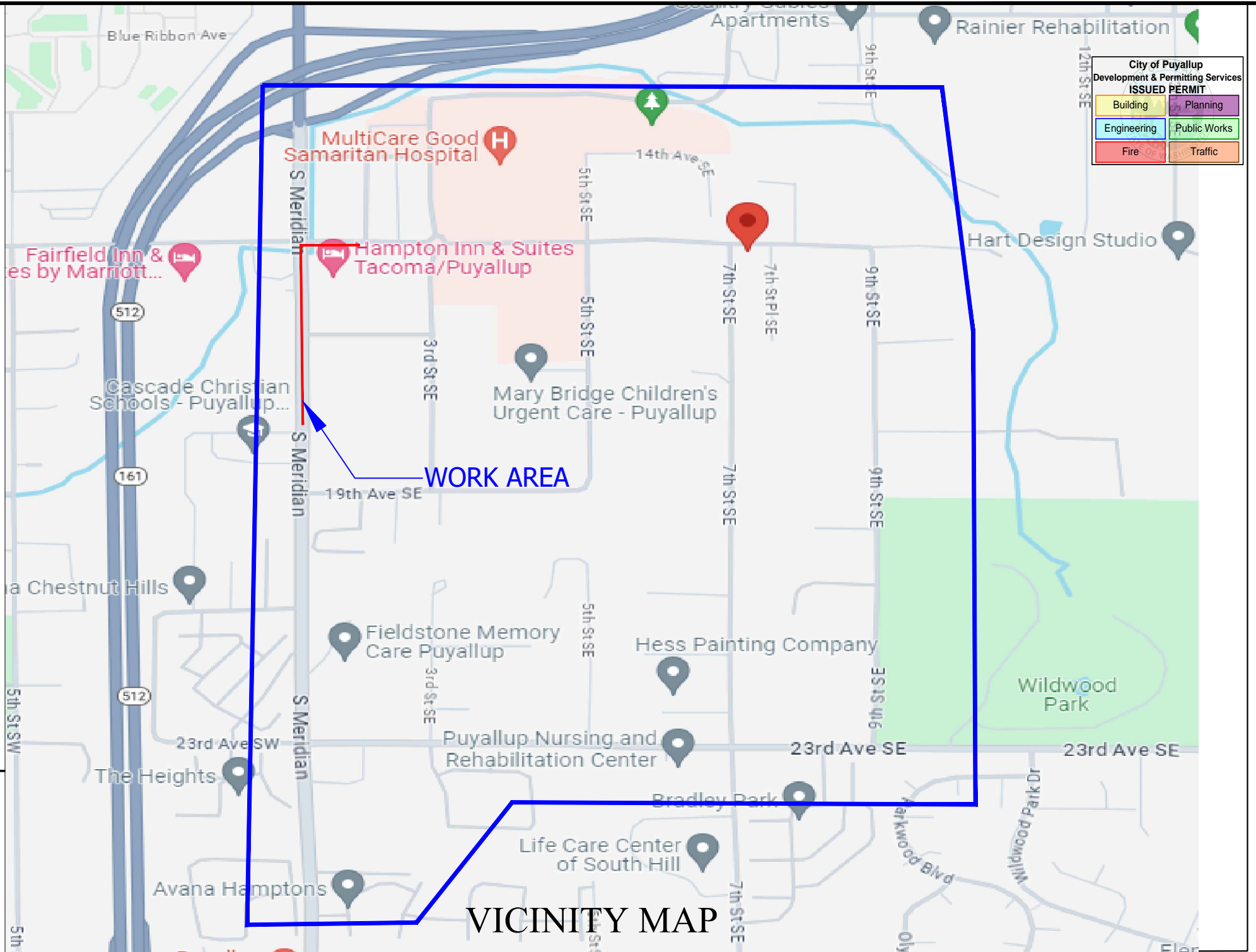

VICINITY MAP

DESCRIPTION OF WORK:
 POF: PULL FIBER VIA THE AERIAL AND UG IN MANY LOCATIONS WHILE SPLICING AT THE HH/CABINET.

All proposed franchise utilities shall be located within a recorded utility easement or in the public right-of-way as determined by the City of Puyallup. The City of Puyallup does not authorize or permit utility work on private property.

A 10" diameter core drill is allowed for potholing. For pothole windows larger than 10" in diameter or trenching completed in existing roadway, the contractor shall restore the pavement by installing the trench patch and then grinding/overlaying. All roadway restoration and street patches shall comply with City Standard Detail 01.01.20. Restoration limits and requirements shall be at the discretion of the City.



FIBER ENGINEER
 NAME: MARIA HAYES
 PHONE: (253) 393-5387
 EMAIL: MARIA.HAYES@LUMEN.COM

CUSTOMER INFORMATION
 1502 7th St SE, Puyallup, WA 98372, USA

CONTACT ENGINEER
 NAME: CHRISTOPHER
 PHONE: 1-940-465-4662
 EMAIL: Christopher.Huff@cyient.com

DRAFTED BY:
CYIENT INC

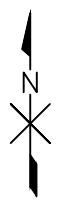

NOTICE- NOT FOR DISCLOSURE OUTSIDE OF LUMEN AND AFFILIATES EXCEPT UNDER WRITTEN AGREEMENT

SECTION: 34
 TOWNSHIP: 20N
 RANGE: 4E

CLLI: PYLPWA01
 SCALE: 1"=100'
 JOB: P.981500

GEO CODE: NA
 REVISION: 1
 DATE: 04/19/2024
 SH: 02 OF 05

City of Puyallup
Development & Permitting Services
ISSUED PERMIT

Building	Planning
Engineering	Public Works
Fire	Traffic

AERIAL LEGEND

- ANC ANCHOR
- CA ARM CABLE ARM
- CATV CABLE TV
- DG DOWN GUY
- DGA DOUBLE GUARD ARM
- FGA FIBER GLASS ARM
- F/S FIELD SIDE
- GA GUARD ARM
- HOA HEIGHT OF ATTACHMENT
- M/R MAKE READY
- OHG OVERHEAD GUY
- R/S ROAD SIDE
- SLAN LIGHT OR POWER COMPANY INVENTORY NUMBER
- SWA SIDEWALK ANCHOR AND GUY
- T TELEPHONE
- TERM TERMINAL
- TRANS TRANSFORMER
- TAPE & SHAPE REQUEST FOR POWER COMPANY TO CLEAN UP SECONDARY POWER CABLES AND/OR TOP OF RISER CABLES SO PROPOSED CABLE CAN BE ATTACHED WITHOUT VIOLATING THE 40" RULE

CABLE ARM ATTACHMENT LOCATION:

- TF TOP FIELD SIDE
- TS TOP STREET SIDE
- TIP TOP INSIDE POSITION
- TIS TOP INSIDE STREET SIDE
- TMP TOP MIDDLE POSITION
- TOP TOP OUTSIDE POSITION
- TOS TOP OUTSIDE STREET SIDE
- BF BOTTOM FIELD SIDE
- BS BOTTOM STREET SIDE
- BIP BOTTOM INSIDE POSITION
- BIS BOTTOM INSIDE STREET SIDE
- BMP BOTTOM MIDDLE POSITION
- BOP BOTTOM OUTSIDE POSITION
- BOS BOTTOM OUTSIDE STREET SIDE

EXISTING EQUIPMENT LEGEND

CENTERLINE	TELEPHONE BULLET PEDESTAL	ELECTRIC PEDESTAL/CABINET	GAS METER	IRRIGATION METER
TRAFFIC LANE	TELEPHONE REPEATER	ELECTRIC TRANSFORMER	GAS VALVE	IRRIGATION VALVE
BIKE/FOG LANE	TELEPHONE PEDESTAL	ELECTRIC METER	TRAFFIC SIGNAL VAULT/HANDHOLE	CULVERT
RIGHT OF WAY	TELEPHONE VAULT/HANDHOLE	ELECTRIC VAULT/HANDHOLE	TRAFFIC SIGNAL POLE	C/L MONUMENT
PROPERTY LINE	TELEPHONE CABINET	ELECTRIC MANHOLE	WATER METER	POLE ITEM NO.
EASEMENT	TELEPHONE MANHOLE	ELECTRIC J-BOX	WATER VALVE	TREES
CURB & GUTTER	TELEPHONE COOL PED	STREETLIGHT	FIRE HYDRANT	SHRUB
EDGE OF PAVEMENT	TELEPHONE SAI	CATV BULLET PEDESTAL	WATER MANHOLE	EXISTING DOWNGUY & ANCHORS
RAILROAD	TELEPHONE USAM	CATV PED	STORM DRAIN CATCH BASIN	
FENCE	TELEPHONE OWNED POLE	CATV VAULT/HANDHOLE	STORM DRAIN INLET	
TELCO	JOINT USE POLE	SEWER MANHOLE	STORM DRAIN MANHOLE	
ELECTRIC	TRAFFIC ARROW	MANHOLE		
CATV	TURN ARROWS	PEDESTAL		
GAS		HANDHOLE		
TRAFFIC SIGNAL		EXISTING CONDUIT		
WATER				
SEWER				
STORM DRAIN				
IRRIGATION				
TRENCH/BORE				

POLE NUMBER	XX'-X"
DISTANCE FROM EOP	X'
LOWEST POWER ATTACHMENT	X'
PROPOSED ATTACHMENT	XX'

00	POWER POLE #	NT		
	LUMEN POLE # / A #	NT / NT		
	POLE HEIGHT-CLASS	00-0	PROP HOA	0'-0"
	ATTACHMENTS	HOA	POSITION	MISC
	MAKE READY NOTES:			

PROPOSED EQUIPMENT LEGEND

PARKWAY TRENCH	4'x4' BORE PIT	SIDEWALK ANCHOR & DOWN GUY
BORE	FSAI/HH/CABINET	ANCHOR & DOWN GUY
ASPHALT TRENCH	HANDHOLE	DOWN GUY
UNDERGROUND BUILD	PEDESTAL	ASPHALT TRENCH FOOTAGE
AERIAL BUILD	FLOWERPOT	DIRT OR S/W TRENCH FOOTAGE
UNDERGROUND BUILD-SLACK	PROPOSED CONDUIT	BORE FOOTAGE
AERIAL BUILD-SLACK SPAN		AERIAL FOOTAGE
AERIAL STRAND		P.5
		MULTIPORT FIBER TERMINAL

PROPOSED CABLE

- MST LONG TERMINAL TAIL
- F1 FEEDER
- 24A PRETERM FLEXNAP FIBER
- 48A 48F FLEXNAP
- 72A 72F FLEXNAP
- 96A 96F FLEXNAP
- 144A 144F FLEXNAP
- 216A 216F FLEXNAP
- 144A BULK FIBER
- 216A
- 288A
- 432A



FIBER ENGINEER
NAME: MARIA HAYES
PHONE: (253) 393-5387
EMAIL: MARIA.HAYES@LUMEN.COM

CONTRACT ENGINEER
NAME: CHRISTOPHER
PHONE: 1-940-465-4662
EMAIL: Christopher.Huff@cyient.com



NOTICE- NOT FOR DISCLOSURE OUTSIDE OF LUMEN AND AFFILIATES EXCEPT UNDER WRITTEN AGREEMENT

CUSTOMER INFORMATION
1502 7th St Pl SE, Puyallup, WA 98372, USA

DRAFTED BY:
CYIENT INC

SECTION: 34
TOWNSHIP: 20N
RANGE: 4E

CLLI:PYLPWA01
SCALE: 1"=100'
JOB: P.981500 DATE: 04/19/2024

GEO CODE: NA
REVISION: 1
SH: 03 OF 05

City of Puyallup
Development & Permitting Services
ISSUED PERMIT

Building	Planning
Engineering	Public Works
Fire	Traffic

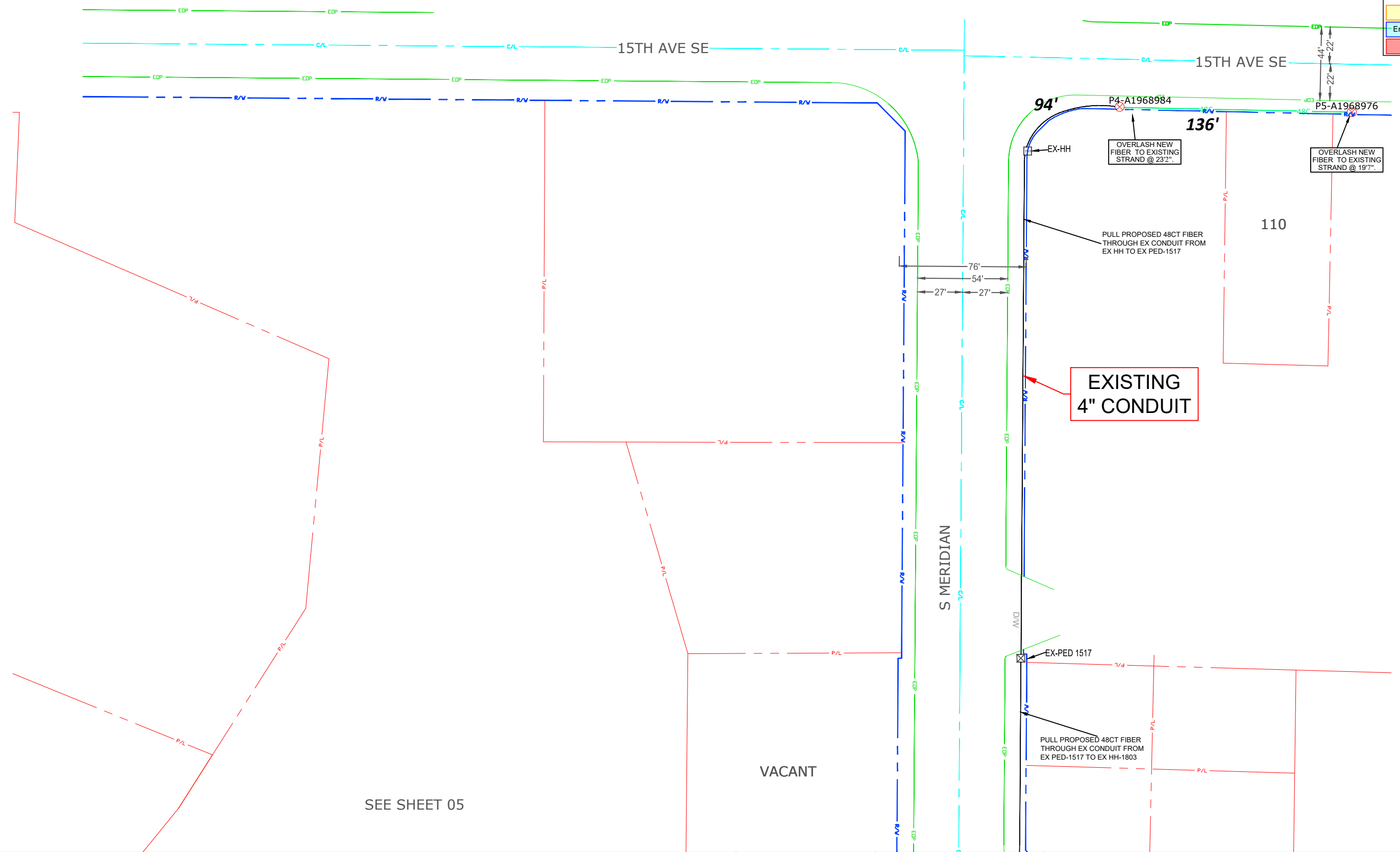

SEE SHEET 05



FIBER ENGINEER
NAME: MARIA HAYES
PHONE: (253) 393-5387
EMAIL: MARIA.HAYES@LUMEN.COM

CONTRACT ENGINEER
NAME: CHRISTOPHER
PHONE: 1-940-465-4662
EMAIL: Christopher.Huff@cyient.com



NOTICE - NOT FOR DISCLOSURE OUTSIDE OF LUMEN AND AFFILIATES EXCEPT UNDER WRITTEN AGREEMENT

CUSTOMER INFORMATION
1502 7th St PI SE, Puyallup, WA 98372, USA

DRAFTED BY:
CYIENT INC

SECTION: 34
TOWNSHIP: 20N
RANGE: 4E

CLLI:PYLPWA01
SCALE: 1"=100'
JOB: P.981500 DATE: 04/19/2024

GEO CODE: NA
REVISION: 1
SH: 04 OF 05

City of Puyallup
Development & Permitting Services
ISSUED PERMIT

Building	Planning
Engineering	Public Works
Fire	Traffic

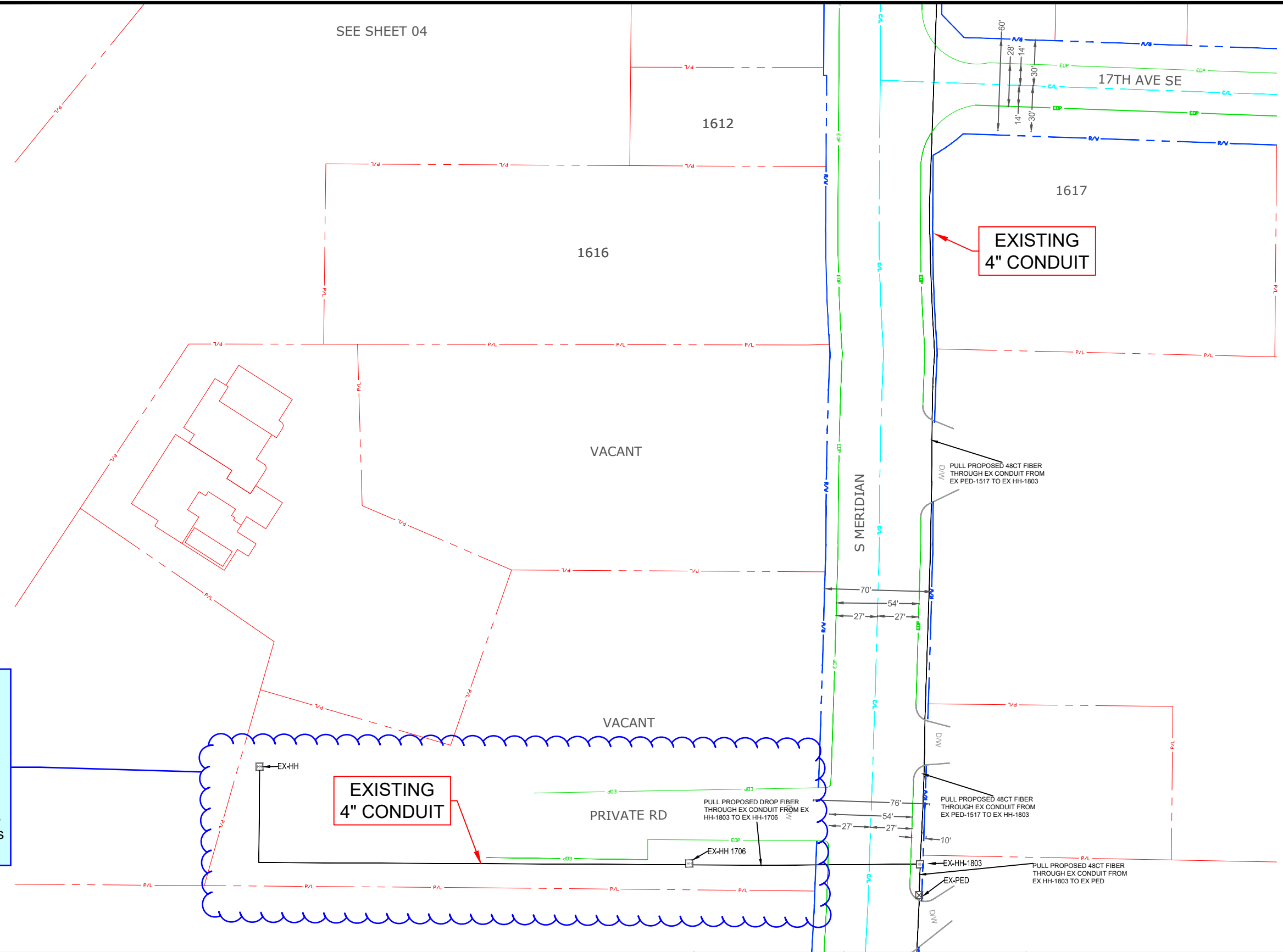

The City of Puyallup does not authorize or permit work on private property or outside City limits. The permit holder shall be responsible to obtain the necessary permissions or permits from all property owners or jurisdictional agencies prior to starting work.



FIBER ENGINEER
NAME: MARIA HAYES
PHONE: (253) 393-5387
EMAIL: MARIA.HAYES@LUMEN.COM

CONTRACT ENGINEER
NAME: CHRISTOPHER
PHONE: 1-940-465-4662
EMAIL: Christopher.Huff@cyient.com



NOTICE - NOT FOR DISCLOSURE OUTSIDE OF LUMEN AND AFFILIATES EXCEPT UNDER WRITTEN AGREEMENT

CUSTOMER INFORMATION
1502 7th St Pl SE, Puyallup, WA 98372, USA

DRAFTED BY:
CYIENT INC

SECTION: 34
TOWNSHIP: 20N
RANGE: 4E

CLLI:PYLPWA01
SCALE: 1"=100'
JOB: P.981500 DATE: 04/19/2024

GEO CODE: NA
REVISION: 1
SH: 05 OF 05