

City of Puyallup
Building
REVIEWED
FOR
COMPLIANCE
B5snowden
05/08/2024
11:28:21 AM

City of Puyallup
Engineering
APPROVED
See permit
for additional
requirements.
Linda Lian
04/15/2024
2:21:48 PM

City of Puyallup
Development & Permitting Services
ISSUED PERMIT
Building Planning
Engineering Public Works
Fire Traffic

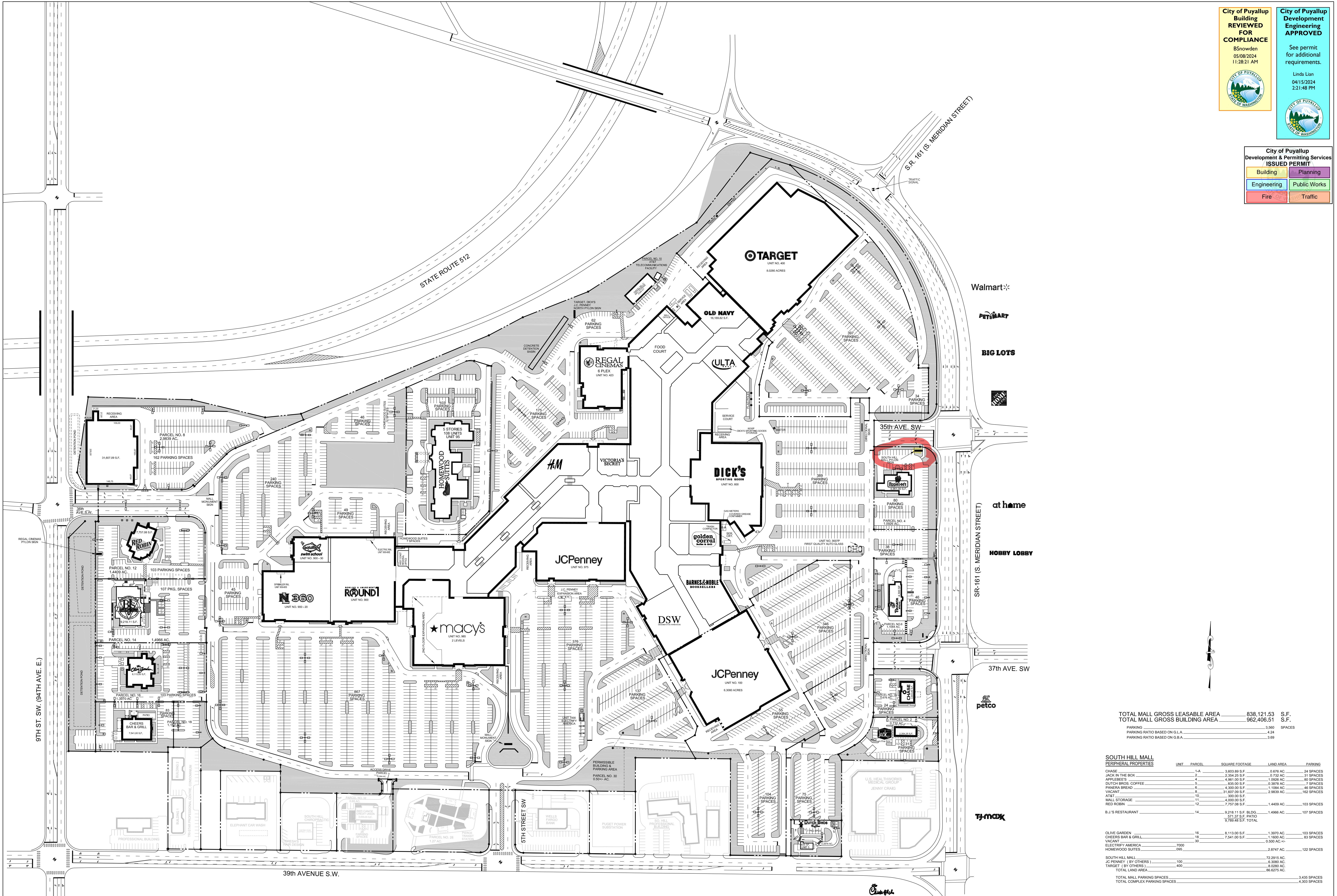

TOTAL MALL GROSS LEASABLE AREA	838,121.53	S.F.
TOTAL MALL GROSS BUILDING AREA	962,406.51	S.F.
PARKING RATIO BASED ON G.L.A.	3.560	SPACES
PARKING RATIO BASED ON G.B.A.	4.24	SPACES
PARKING RATIO BASED ON G.B.A.	3.99	SPACES

SOUTH HILL MALL PERIPHERAL PROPERTIES					
UNIT	PARCEL	SQUARE FOOTAGE	LAND AREA	PARKING	
CHASE	1-A	3,603.89 S.F.	0.076 AC.	24 SPACES	
JACK-IN-THE-BOX	2	2,924.25 S.F.	0.752 AC.	21 SPACES	
APPLEBEE'S	4	4,981.00 S.F.	1.0926 AC.	80 SPACES	
DUTCH BROS COFFEE	5	335.00 S.F.	0.3878 AC.	7 SPACES	
PANERA BREAD	6	4,300.00 S.F.	1.1084 AC.	46 SPACES	
VACANT	8	31,807.00 S.F.	2.9839 AC.	162 SPACES	
AT&T	10	300.00 S.F.	0.007 AC.	0 SPACES	
MALL STORAGE	11	4,000.00 S.F.	0.092 AC.	103 SPACES	
RED ROBIN	12	7,757.00 S.F.	1.4409 AC.	103 SPACES	
B.J.'S RESTAURANT	14	9,218.11 S.F. BLDG. 571.37 S.F. PATIO	1.4966 AC.	107 SPACES	
			9,789.48 S.F. TOTAL		
OLIVE GARDEN	16	8,113.00 S.F.	1.3970 AC.	103 SPACES	
CHEERS BAR & GRILL	18	7,541.00 S.F.	1.1600 AC.	83 SPACES	
VACANT	20	0.00 S.F.	0.000 AC.	0 SPACES	
ELECTRIFY AMERICA	7000	0.00 S.F.	0.000 AC.	0 SPACES	
HOMWOOD SUITES	099	0.00 S.F.	0.000 AC.	122 SPACES	
SOUTH HILL MALL				72,291 S.F.	
JC PENNEY (BY OTHERS)	100			4,380 AC.	
TARGET (BY OTHERS)	400			5,026 AC.	
TOTAL LAND AREA			86,627 S.F.		
TOTAL MALL PARKING SPACES				3,435 SPACES	
TOTAL COMPLEX PARKING SPACES				4,303 SPACES	

THIS PLAN SHOWS ONLY APPROXIMATE LOCATIONS AND DIMENSIONS. LANDLORD'S RESERVED RIGHTS INCLUDE, BUT ARE NOT LIMITED TO, THE RIGHT TO CONSTRUCT ADDITIONAL BUILDINGS, INSTALL SIGNAGE, CHANGE THE IDENTITY AND LOCATION OF OTHER OCCUPANTS, NUMBER OF ROOMS, PARKING ARRANGEMENTS, ENTRANCES, SERVICES, ETC.

PRSG20240614

CAFARO
- Est. 1949 -
Commercial & Industrial Real Estate Developers
5577 Youngtown Warren Road
Niles, Ohio 44448
Phone: 330-747-2661, Fax: 330-743-2902, Web Page: www.cafarocompany.com
3500 South Meridian - Unit 902
Puyallup, WA 98373

DESCRIPTION: CURRENT SITE PLAN
DRAWN BY: ES
DATE: 03-06-2024
SCALE: 1"=100'
PROJECT: SOUTH HILL MALL - 62
PUYALLUP, WASHINGTON
DRAWING NO.: P-1