

1 LEVEL 1 - FLOOR PLAN
1/8" = 1'-0"

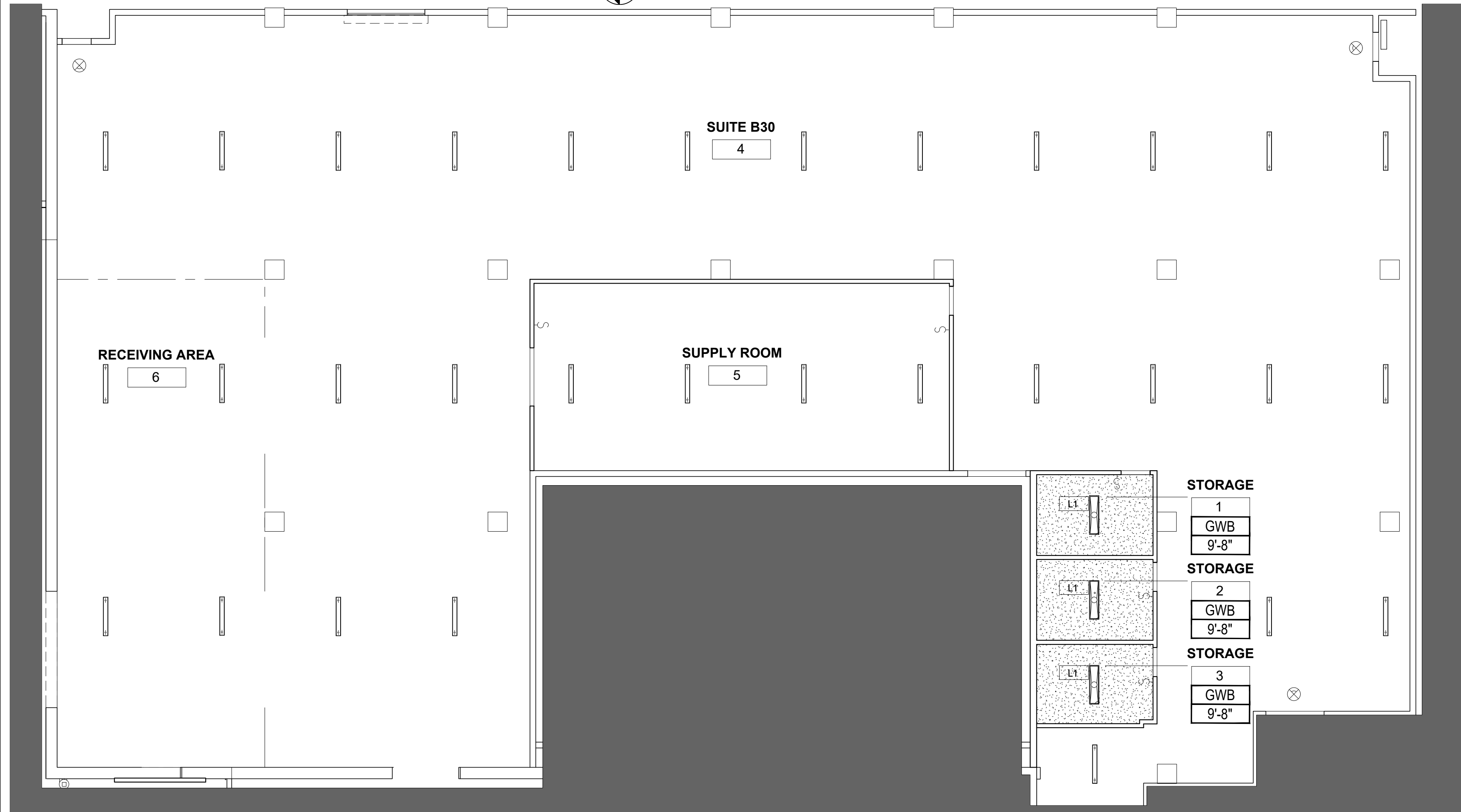

2 LEVEL 1 - REFLECTED CEILING PLAN
1/8" = 1'-0"

FLOOR PLAN LEGEND

- EXISTING PARTITION TO REMAIN
- NEW PARTITION
- NEW DOOR
- FIRE EXTINGUISHER

RCP LEGEND

- 2x4 SURFACE MOUNTED LIGHT FIXTURE
- EXISTING 4' PENDANT LIGHT FIXTURE
- NEW GYP CEILING
- CEILING MATERIAL AND HEIGHT ABOVE FINISHED FLOOR TAG
- EXIT SIGNAGE, DIRECTIONAL AND NON DIRECTIONAL

FLOOR PLAN KEY NOTES

- 1 SEE ATTACHED STRUCTURAL SHEET FOR EXISTING EXTERIOR WALL CUT AND NEW DOOR OPENINGS
- 2 5/8"x1/2" SECO MA CHAIN LINK FENCE WITH 2 - 12" WIDE DOUBLE GATES. CONNECTIONS TO BE COORDINATED WITH FENCE CONTRACTOR
- 3 EXISTING CONCRETE FLOOR TO REMAIN THROUGHOUT
- 4 EXISTING SPRINKLER MAINS TO REMAIN

FLOOR PLAN GENERAL NOTES

1. CONTRACTOR TO VERIFY ALL EXISTING CONDITIONS. DESIGNS ARE BASED ON INFORMATION PROVIDED BY THE OWNER AND MAY NOT REFLECT THE ACTUAL CONDITIONS IN THE FIELD.
2. ALL PARTITIONS, UNLESS OTHERWISE NOTED SHALL BE CONSTRUCTED W/ 3/8", 22 GA METAL STUDS @ 24" O.C WITH 5/8" TYPE 'X' GYPSUM WALLBOARD EACH SIDE.
3. THERE SHALL BE NO EXPOSED PIPE, CONDUIT, DUCTS, VENTS, ETC. ALL SUCH LINES SHALL BE CONCEALED OR FURRED AND FINISHED, UNLESS OTHERWISE NOTED AS EXPOSED CONSTRUCTION ON THE DRAWING.
4. ALL EXIT DOORS SHALL BE OPERABLE FROM THE INSIDE WITHOUT USE OF KEY OR ANY SPECIAL KNOWLEDGE OR EFFORT.
5. CONTRACTOR TO PROVIDE SHOP DRAWINGS FOR DESIGNERS PRIOR TO MANUFACTURE OF ANY CARPET WORK, MILLWORK AND ANY OTHER SPECIAL ITEMS REQUIRING CUSTOM SHOP FABRICATED WORK.
6. INTERIOR DOORS (RATED AND NONRATED ARE TO BE OFFSET 6" FROM ADJACENT WALK AT HINGE SIDE UNLESS NOTED OTHERWISE.
7. CONFLICTS BETWEEN SITE CONDITIONS AND DRAWINGS SHALL BE BROUGHT TO THE IMMEDIATE ATTENTION OF THE ARCHITECT.
8. ALL WORK SHALL BE ERRECTED AND INSTALLED PLUMB, LEVEL, SQUARE AND TRUE AND IN PROPER ALIGNMENT, U.N.O.
9. ALL DIMENSIONS ARE TO FINISH CONSTRUCTION, U.N.O. "ALIGN" MEANS TO ACCURATELY LOCATE FINISHED FACES IN THE SAME PLANE. DIMENSIONS NOTED "CLEAR" ARE MINIMUM DIMENSIONS WHICH MUST BE MAINTAINED WITHOUT EXCEPTION. DIMENSIONS MARKED ± MEAN A VARIANCE NOT GREATER THAN 1/8" INCH. VERIFY DIMENSIONS EXCEEDING TOLERANCE WITH THE ARCHITECT. ALL DIMENSIONS TO THE EXTERIOR WINDOW WALL ARE TO THE FINISH FACE OF WALL BELOW SILL, U.N.O.
10. ALL EXISTING FLOORS, PARTITIONS, DEMISING WALLS, AND CORRIDOR WALLS TO REMAIN ARE TO BE PATCHED AND REPAIRED TO MATCH ADJACENT SURFACES.
11. ALL GLASS SHALL BE CLEAR TEMPERED U.N.O. GLAZING TONG MARKS SHALL NOT BE VISIBLE. CLEAN & POLISH ALL GLASS TO ACHIEVE RATING INDICATED.
12. PARTITION DEPTH AT FIRE EXTINGUISHER CABINET LOCATIONS SHALL ACCOMMODATE FULL CONCEALMENT OF RECESSED CABINETS OR PARTIAL CONCEALMENT OF SEMI-RECESSED CABINETS AS SPECIFIED BY THE MANUFACTURER.
13. ALL PARTITIONS ABUTTING COLUMNS ARE TO ALIGN WITH THE FACE OF THE COLUMN, U.N.O.
14. ALL GYPSUM BOARD PARTITIONS SHALL BE TAPED AND SANDED SMOOTH WITH NO VISIBLE JOINTS. PROVIDE LEVEL 4 FINISH.
15. U.N.O. - REFER TO MATERIAL SCHEDULE & FINISH PLAN FOR MATERIALS & LOCATIONS THAT REQUIRE A LEVEL 5 FINISH, U.N.O.
16. REFER TO THE PARTITION TYPES FOR PARTITION THICKNESS.
17. CONSTRUCTION OF FIRE-RATED PARTITIONS, INCLUDING TAPING AND FINISHING OF GYPSUM WALLBOARD FOR FULL HEIGHT TO STRUCTURE ABOVE, SHALL BE IN ACCORDANCE WITH UL SPECIFICATIONS TO ACHIEVE RATING INDICATED.
18. ALL FINISH SPECIFICATIONS BY OWNER.
19. WHERE PARTITIONS EXTEND ONLY TO UNDERSIDE OF SUSPENDED CEILING, SECURE THE TOP TRACK TO THE EXPOSED CEILING GRID. PROVIDE A COMPRESSIBLE GASKET BETWEEN THE TOP TRACK AND THE CEILING GRID. PROVIDE TAPABLE METAL J-BEAD AT TOP OF GYPSUM WALLBOARD, WITH NO JOINTS VARYING MORE THAN 1/8" OVER 6'-0" AND NO JOINTS GREATER THAN 3/16", U.N.O. CAULK PERIMETER AT TOP OF GWB.
20. PROVIDE GROUNDS AND BLOCKING IN METAL STUD WALL FRAMING FOR SUPPORT OF CASEWORK, SHELF-STANDARDS, AV DEVICES, FURNITURE, ETC. ALL CONCEALED LUMBER AND BLOCKING TO BE FIRE TREATED. COORDINATE BLOCKING REQUIREMENTS WITH FURNITURE & AV INSTALLERS. WHERE BLOCKING OR ADDITIONAL STUDS ARE REQUIRED AT EXISTING PARTITIONS, THEY ARE TO BE PATCHED AND REPAIRED. SEE CONSTRUCTION PLANS FOR WALL-MOUNTED MARKERBOARD, MONITORS & PROJECTION SCREENS; PROVIDE BLOCKING PER MANUFACTURERS REQUIREMENTS.
21. ALL HINGED DOORS TO BE 4" FROM NEAREST PERPENDICULAR PARTITION. U.N.O. DIMENSIONS LOCATING DOORS ARE TO THE INSIDE EDGE OF JAMB. ALL DOORS SHALL HAVE 1'-6" CLEAR ON THE STRIKE/PULL SIDE OF DOOR AND 1'-0" CLEAR ON THE STRIKE/PUSH SIDE (IF THEY HAVE BOTH A LATCH AND A CLOSER) VERIFY AND ADVISE ARCHITECT OF EXCEPTIONS PRIOR TO CLOSING OUT PARTITIONS.
22. THE CONTRACTOR SHALL ESTABLISH A SINGLE FLOOR ELEVATION THAT IS TO BE USED TO SET THE TOP OF ALL DOORS SUCH THAT THE TOP OF ALL DOORS OF THE SAME HEIGHT WILL ALIGN REGARDLESS OF VARIATIONS IN THE FLOOR SLAB OR FINISHED FLOOR THICKNESS.
23. PROVIDE DOUBLE STUDS AT DOOR HEADER AND JAMBS. INSTALL ADDITIONAL STUDS IN EXISTING PARTITIONS AT NEW DOOR OPENINGS IN ORDER TO PROVIDE DOUBLE STUDS.
24. METAL STUDS AT PARTITIONS TO RECEIVE CERAMIC TILE ARE TO BE 20 GAGE (MINIMUM) @ 16" O.C. (MAXIMUM). REFER TO THE FINISH PLANS FOR TILE LOCATIONS.
25. PROVIDE DIAGONAL STUD BRACING TO SLAB ABOVE @ 48" O.C. AT DROP ARCHES/BULKHEADS.
26. GYPSUM WALLBOARD AT BOTH SIDES OF ALL PARTITIONS WITH PLUMBING ROUGH-IN (E.G. BATHROOMS, PANTRY, JANITOR'S CLOSET, WET COLUMNS) SHALL BE WATER-RESISTANT. PROVIDE VERTICAL CONTROL JOINTS 30" O.C. MAX. IN ALL GWB PARTITIONS LONGER THAN 30". WHEN POSSIBLE CONTROL JOINTS SHOULD BE LOCATED ABOVE THE CORNER OF A DOOR.

RCP GENERAL NOTES

1. THE REFLECTED CEILING PLAN INDICATES THE LOCATION OF CEILING HEIGHTS, LIGHT FIXTURES, SWITCH LOCATIONS, AND ASSOCIATED ITEMS. REFER TO ENGINEERING DRAWINGS FOR CIRCUITING, WIRING LAYOUT, AND ADDITIONAL INFORMATION. ALL MEP-F-F DEVICE LOCATIONS NOT SHOWN ON DRAWINGS, OR IN CONFLICT WITH MEPP/P DRAWINGS, ARE TO BE COORDINATED WITH ARCHITECT PRIOR TO INSTALLATION. IN THE EVENT OF DISCREPANCIES BETWEEN THE ARCHITECT'S REFLECTED CEILING PLAN AND THE ENGINEERS' PLANS, IMMEDIATELY NOTIFY THE ARCHITECT IN WRITING BEFORE ORDERING MATERIALS OR PROCEEDING WITH THE WORK.
2. DIRTY OR DISCOLORED SURFACES OF TILE ARE TO BE CLEANED OR REPLACED, AND LEFT FREE OF DEFECTS. AFTER 30 DAYS FROM SUBSTANTIAL COMPLETION, INSPECT THE WORK AND ADJUST TILE NOT IN ALIGNMENT WITH OTHER CEILING TILES AND REPLACE MISSING OR DAMAGED UNITS.
3. VERIFY FIELD CONDITIONS AND LOCATIONS OF ALL MEPP/P AND STRUCTURAL ELEMENTS. CONTRACTOR TO COORDINATE THE WORK OF ALL TRADES NECESSARY TO MAINTAIN THE FINISHED CEILING HEIGHTS INDICATED. INSTALL DUCTWORK TIGHT TO UNDERSIDE OF BEAMS, WITH A SMALL SPACE TO AVOID VIBRATION. INSTALLATION AND/OR ALTERATION OF DUCTWORK, PIPING OR OTHER EQUIPMENT THAT WILL REQUIRE FASCIAS, SOFFITS AND OTHER TRANSITIONS IN CEILING HEIGHT SHALL BE REVIEWED WITH THE ARCHITECT PRIOR TO PROCEEDING. CONTRACTOR TO PROVIDE COMPLETE COORDINATION DRAWINGS FOR THE ARCHITECT AND ENGINEERS REVIEW.
4. MULTIPLE SWITCHES AT ONE LOCATION SHALL BE GANGED TOGETHER WITHIN ONE COVER PLATE U.N.O.
5. ALL FIXTURES AND DEVICES TO BE UNDERWRITERS LABORATORIES INC. (UL) LABELED.
6. LIGHT FIXTURES, REGISTERS, SPEAKERS, RECESSED FIXTURES AND SIMILAR CEILING ELEMENTS, AND LIFE-SAFETY DEVICES SHALL BE LOCATED IN THE CENTER OF CEILING TILE IN BOTH DIRECTIONS AND SHALL ALIGN WITH ADJACENT FIXTURES, DEVICES OR HEADS IN A RUN OR ROW, U.N.O.
7. FURNISH AND INSTALL ALL FIXTURES, ASSOCIATED TRIM, LAMPS, AND SEISMIC BRACING.
8. INSTALL LIGHT FIXTURES WITH PROTECTIVE FILM OR SIMILAR COVER OVER LOUVER, LENS, BAFFLE, AND EXPOSED SURFACES. TO AVOID FIXTURE SOILING OR DAMAGE DURING CONSTRUCTION. FIXTURES SHALL BE MAINTAINED CLEAN AND AS NEW.
9. PROVIDE BLOCKING ABOVE CEILING REQUIRED FOR ALL CEILING MOUNTED EQUIPMENT. PROVIDE ADDITIONAL SUPPORT FOR LIGHT FIXTURES AS RECOMMENDED BY FIXTURE MANUFACTURER.
10. CONTRACTOR TO VERIFY ALL PENDANT FIXTURE HEIGHTS WITH ARCHITECT PRIOR TO INSTALLATION.
11. REFER TO ELECTRICAL DRAWINGS FOR EMERGENCY LIGHT FIXTURE LOCATIONS.
12. CONTRACTOR SHALL REPAIR AND/OR REPLACE CEILING WHICH ARE REMOVED TO FACILITATE PLENUM SYSTEMS INSTALLATION.
13. PROVIDE CEILING ACCESS REQUIRED FOR EQUIPMENT AND SYSTEM MAINTENANCE. MATCH ADJACENT CEILING FINISH U.N.O. SYSTEMS AND EQUIPMENT REQUIRING ACCESS SHALL BE LOCATED AT ACCESSIBLE CEILINGS - ACCESS PANELS NOT SHOWN ON DRAWINGS SHALL NOT BE INSTALLED IN GYPSUM BOARD CEILINGS WITHOUT PRIOR APPROVAL.
14. COORDINATE SCHEDULING OF WORK WITH DATA/TELEPHONE INSTALLER. INSTALL CEILING TILES AFTER FINISH PAINTING TO MINIMIZE VOC ABSORPTION INTO THE CEILING TILES. INSTALL CEILING TILES AFTER DATA/TELEPHONE CABLES HAVE BEEN INSTALLED.
15. PATCH ALL HOLES IN EXISTING PLASTER FIREPROOFING AT BEAMS AND COLUMNS TO RESTORE THE REQUIRED FIRE RATINGS OF BEAMS AND COLUMNS (3 HR) TYPICAL THROUGHOUT.
16. ALL LIGHT FIXTURES FURNISHED BY OWNER SHALL BE U.L. APPROVED AND WHERE APPLICABLE, APPROVED BY LOCAL AUTHORITIES FOR SPECIFIED USE.
17. CEILING GRID AND TILE SHALL MATCH BUILDING STANDARD.
18. SWITCHES AND PLATES SHALL MATCH BUILDING STANDARD. COLOR TO MATCH BUILDING STANDARD.
19. ALL LIGHT FIXTURES SHALL MATCH BUILDING STANDARD.
20. REPAIR AND/OR REPLACE COMPONENTS NECESSARY TO INSURE ALL EXISTING AND OR RELOCATED LIGHT FIXTURES ARE FUNCTIONING, INCLUDING BUT NOT LIMITED TO LAMPS, BALLASTS, AND LENSES.
21. ALL LAMP COLOR TEMPERATURES TO BE CONSISTENT WITHIN SIMILAR FIXTURE TYPES.
22. REBALANCE HVAC AS NEEDED TO ACCOMMODATE NEW LAYOUT.

DESIGNER



CLIENT



PROJECT



ARCHITECT



STAMP

ISSUANCE

ISSUE DATE: 02.16.2024
DRAWN BY: RRO
CHECKED BY: MM

REVISION LIST

NO.	DATE	DESCRIPTION	BY

KEY PLAN

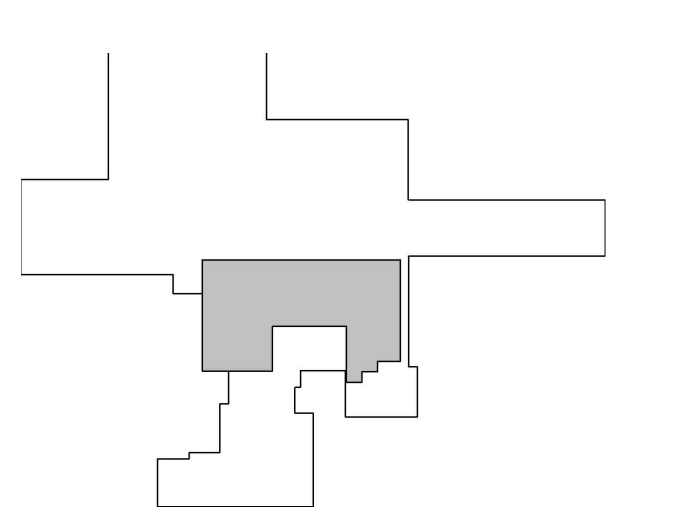

SHEET TITLE

FLOOR PLAN/
REFLECTED CEILING PLAN

SHEET NUMBER

A1.3

