

TEMPORARY TRAFFIC CONTROL PLAN

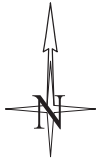

**City of Puyallup
Development & Permitting Services
ISSUED PERMIT**

Building	Planning
Engineering	Public Works
Fire	Traffic

CLOSURE ALLOWED:
Monday - Thursday
10AM - 1PM

Call communications center at 253-287-4456 on day of closure.
Request a job start inspection through the CityView portal.

The City-issued permit packet shall be posted at the job site and available to inspectors at all times.

The applicant shall contact Meghan Genge, Puyallup Police Department Support Specialist, at 253-841-5436 or mgenge@puyallupwa.gov to coordinate traffic support with a uniformed police officer at least 24 business hours in advance of job start.

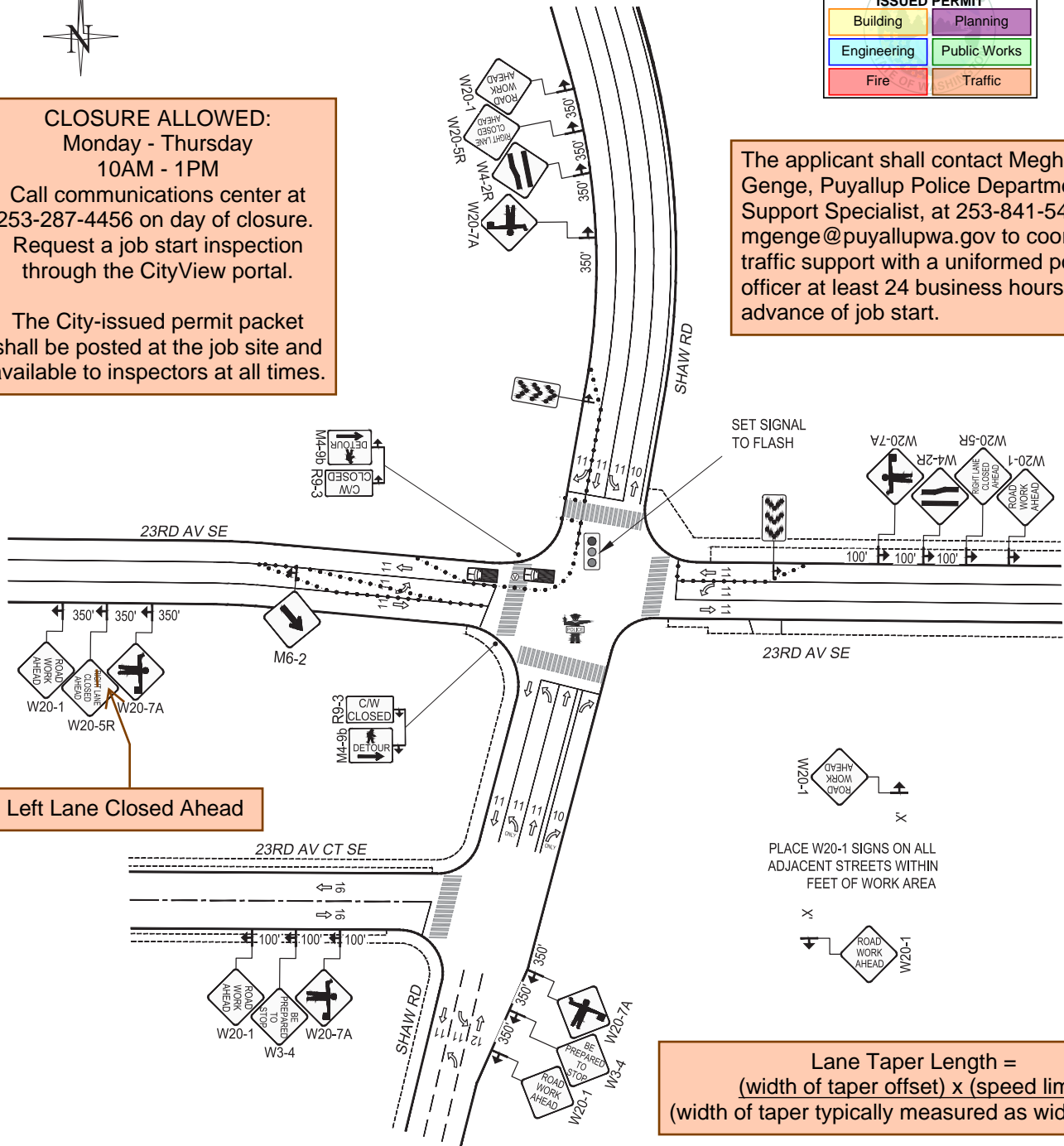

Left Lane Closed Ahead

Lane Taper Length =
(width of taper offset) x (speed limit)²
(width of taper typically measured as width of lane)

Notes:

- All signs and spacing to conform to the MUTCD and City of Puyallup standards.
- All sidewalks, driveways, exits and egresses shall be completely clear unless otherwise indicated.
- Channelizing devices are 28" traffic cones. Use traffic drums (barrels) with steady burning Type C lights on all State State Routes and Hwys.
- Sign size can be a minimum of 36" x 36" and shall not obstruct pedestrian access.
- Crew is required to leave a minimum of 11' for traveling lane width.
- Alert affected residents and businesses.
- Work to take place between 9 a.m. and 4 p.m unless otherwise specified. All work for arterials and major roadways will be from 9 a.m. to 3 p.m.
- Work area will be approx. 12' NCL of 23rd Av SE & 42' WCL of Shaw Av E.

$$L = \frac{W \cdot S^2}{60}$$

MPH	"X"
60/65	1000'
45/55	500'
35/40	350'
25/30	100'

LEGEND

- 28" TRAFFIC CONE
- VALVE LOCATION
- TRAFFIC FLOW
- UNIFORMED POLICE OFFICER
- FLAGGER
- WORK VEHICLE/ FLASHING LIGHTS
- SIGN LOCATION
- RIGHT OF WAY ROW
- CHEVRON ARROW BOARD

PSE PUGET SOUND ENERGY
Designer: Stephen R Gadke
425-424-6431
stephen.gadke@pse.com

Project Address:
23rd Av SE & Shaw Av E Puyallup, WA

Puget Sound Energy
Traffic Control Supervisor:
Stephen R Gadke
Card No. 012522
Exp. 7/31/2025
stephen.gadke@pse.com
425-424-6431

06/03/24	REV 0
Job # 887038867	
Page 1 OF 1	