

City of Puyallup
Development & Permitting Services
ISSUED PERMIT

Building	Planning
Engineering	Public Works
Fire	Traffic

9th Ave SW

9th Ave SW

9th Ave SW

9th Ave SW

Washington State
Fair Foundation

ATM - Umpqua Bank

Washington State Fair

STRUCTURE/SIGN
LOCATION

Gold Gate Puyallup Fair

Rights For the Home

Funnel Cakes

1000

S Meridian

S Meridian

S Meridian

North

SITE MAP



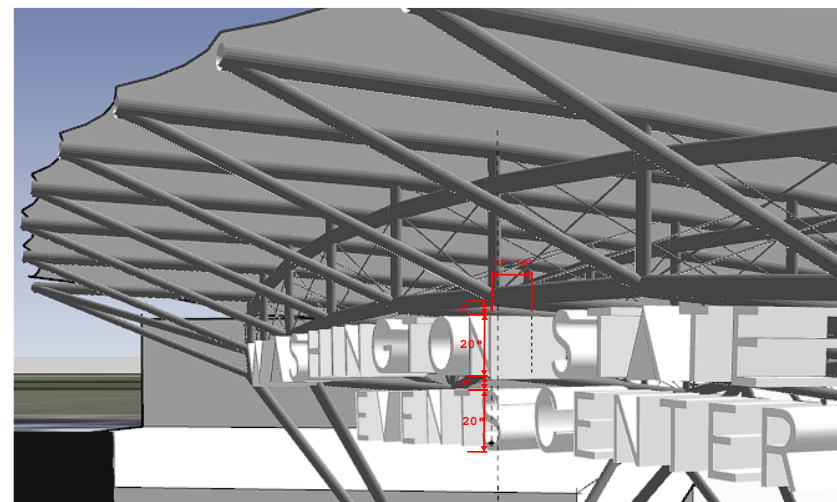

**City of Puyallup
Building
REVIEWED
FOR
COMPLIANCE**

RayC
07/25/2024
12:09:45 PM



Approval of submitted plans is not an approval of omissions or oversight by this office or noncompliance with any applicable regulations of local government. The contractor is responsible for making sure that the building complies with all applicable building codes and regulations of the local government.

THE APPROVED CONSTRUCTION PLANS AND ALL ENGINEERING MUST BE POSTED ON THE JOB AT ALL INSPECTIONS IN A VISIBLE AND READILY ACCESSIBLE LOCATION.
PRINT in COLOR and to SCALE.

Call for foundation/anchor inspection prior to placing concrete.

Please see canopy permit plans for loading capacity and connection locations. BIRDAIR – GOLD GATE CANOPY DETAILS (Stamped). Page 4/25

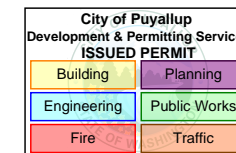

Jeff Brown Architecture



SIGN 1 | ILLUMINATED CHANNEL LETTERS
EXTERNALLY ILLUMINATED USING LIGHT FIXTURES

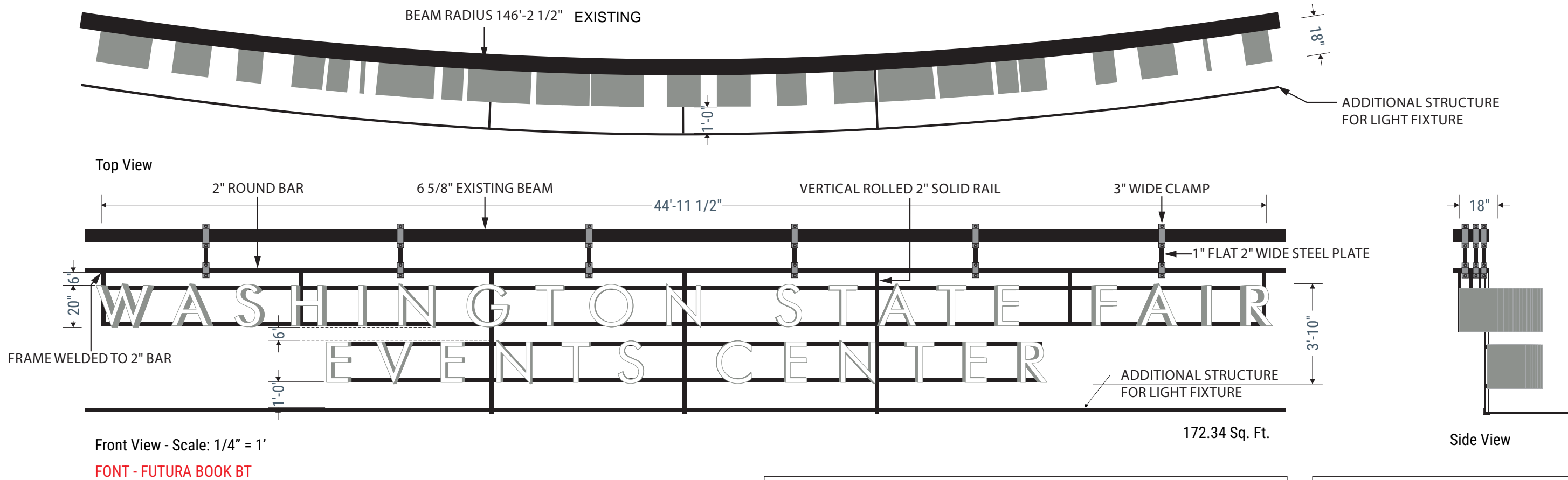

1B ILLUMINATED CHANNEL LETTERS - QTY: 1

172.34 SQ FT

CHANNEL LETTERS: 18" deep aluminum fabricated, fully enclosed, non-illuminated, face-aluminum, painted white, returns and back- aluminum, painted gunmetal grey.
ILLUMINATION: Externally illuminated using color changing RGBs, remote controlled.
 Client to supply and install to berry frame their own LED light bars
MOUNTING: Sign welded to 2" round bar

- FACE: WHITE**
- RETURN AND BACK: GUNMETAL GREY**

APPROVED PLAN
 CITY OF PUYALLUP
 PLANNING DIVISION

APPROVED BY: ARamirez
 DATE: 07/10/2024
 CASE NO.: PRSG20240960

CONDITIONS:

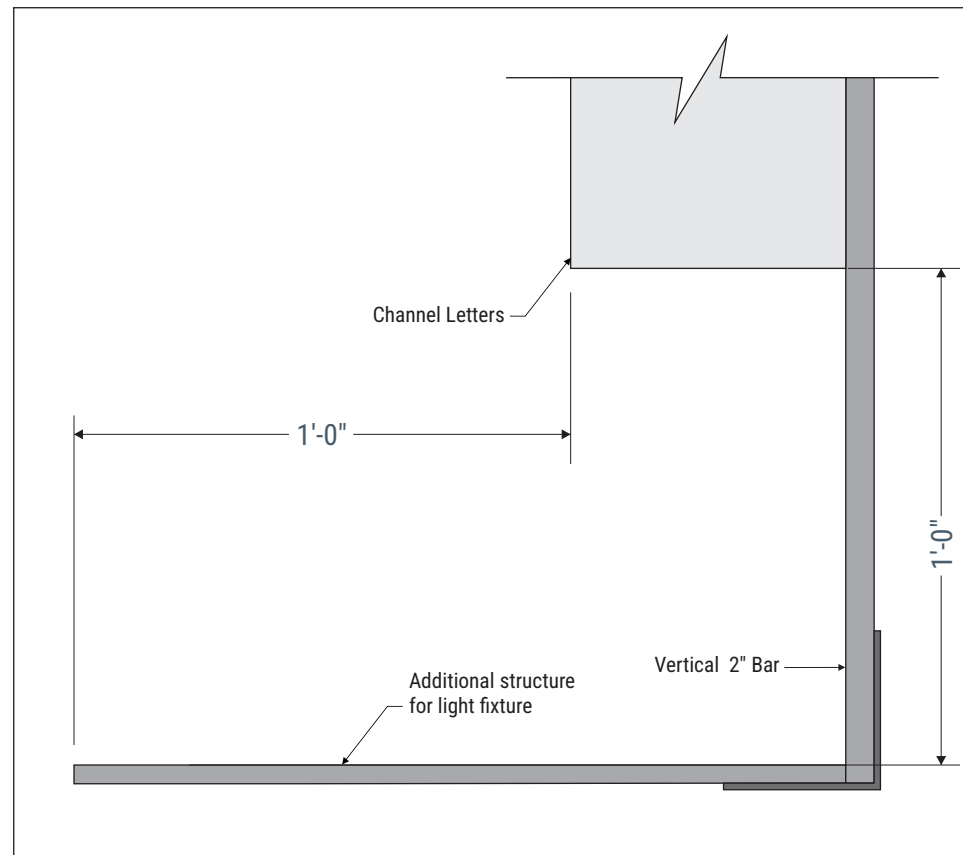
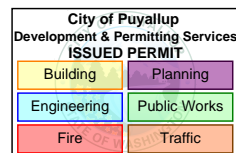

Channel section for RGBs - Scale: NTS

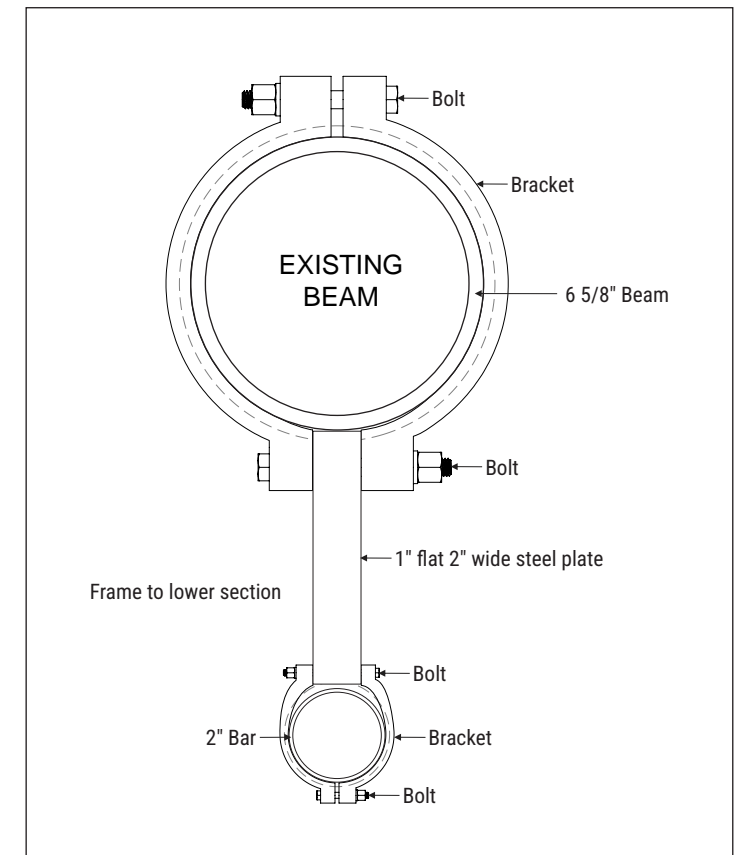

Typical clamp on mounting - Scale: NTS

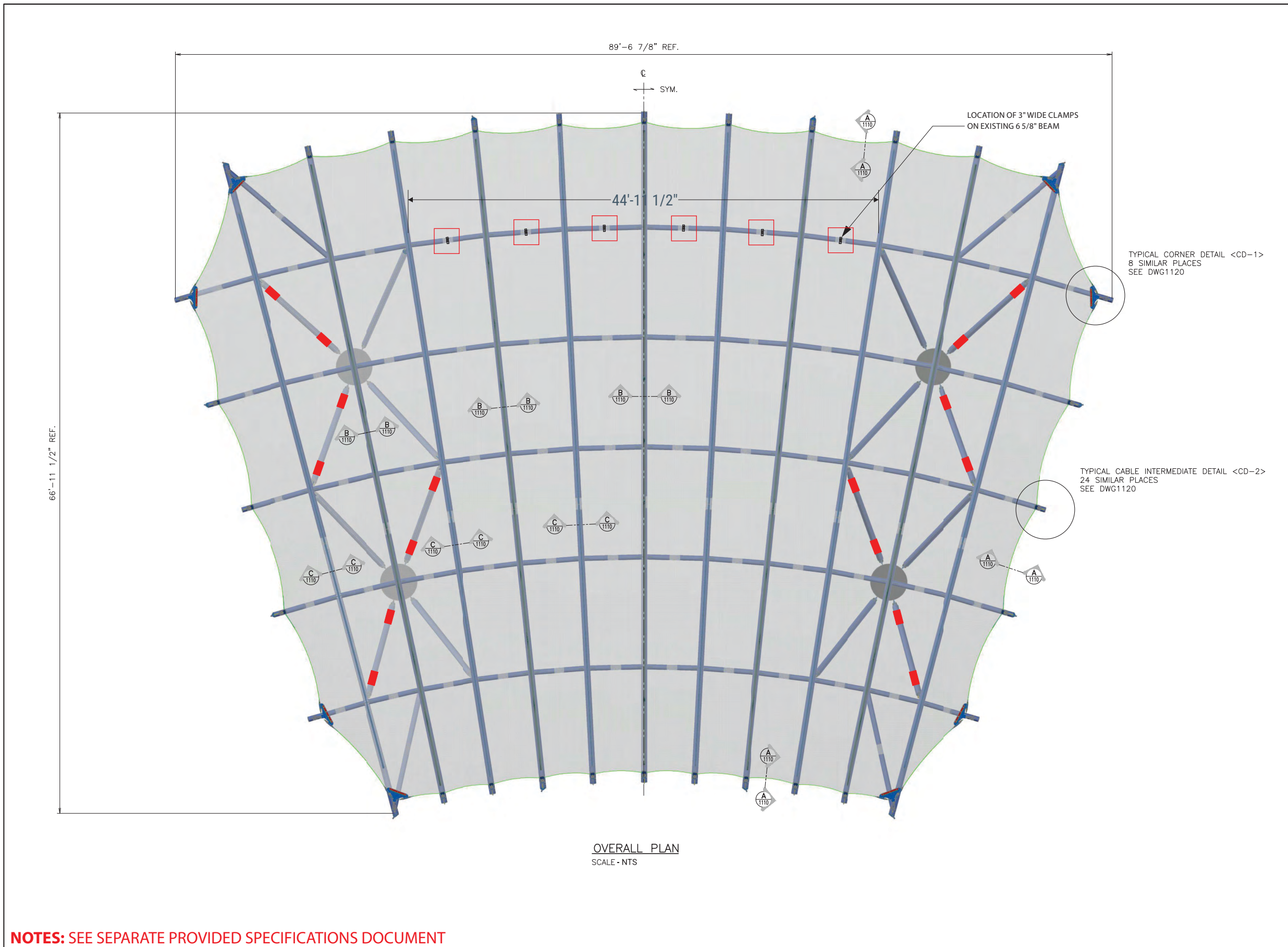

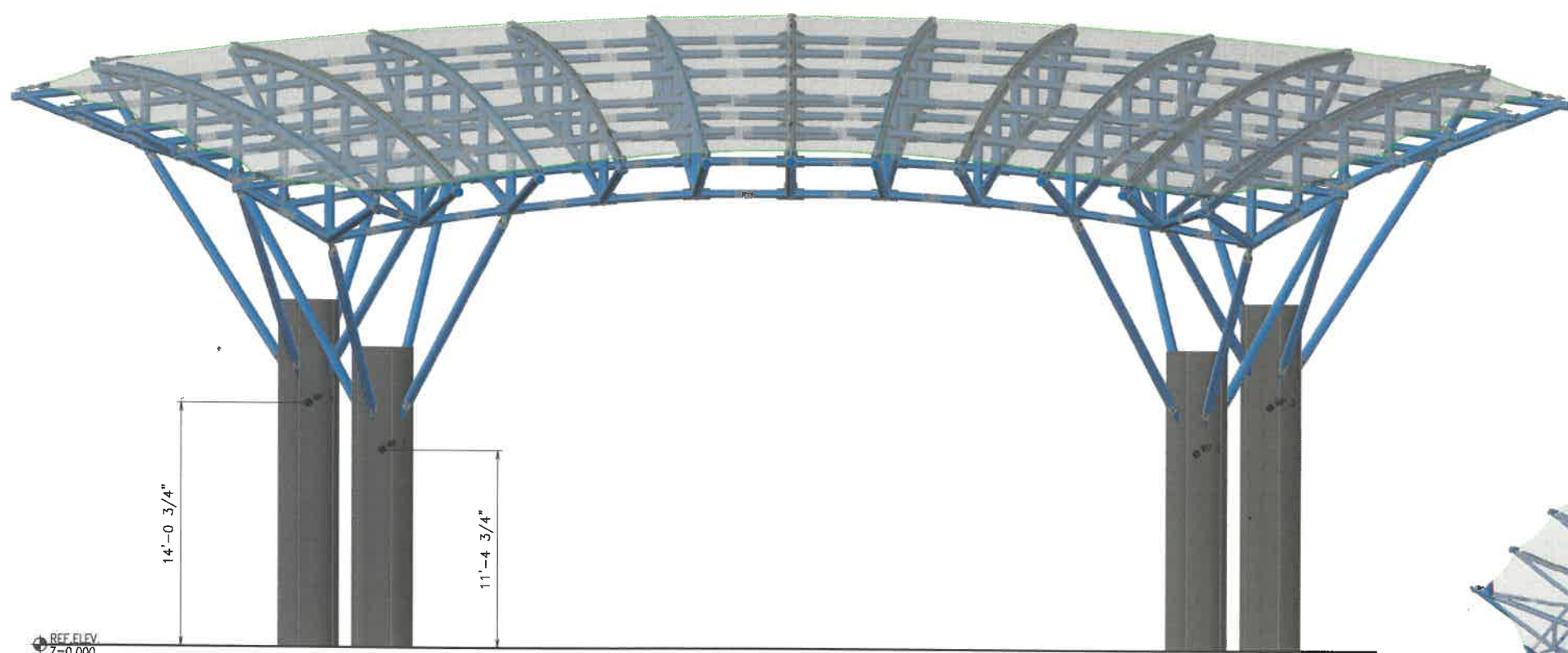

FRONT VIEW
SCALE 1/4" = 1'-0"

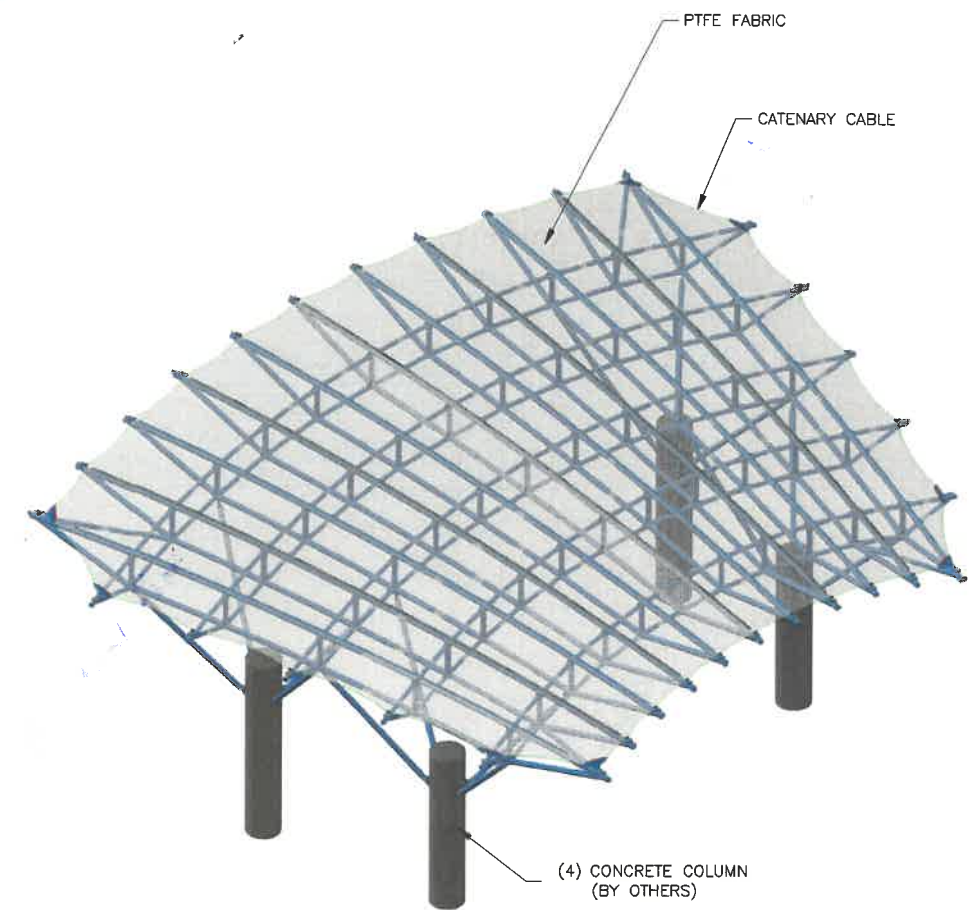

PERSPECTIVE VIEW
NTS



SIDE VIEW
SCALE 1/4" = 1'-0"

SUBMITTED FOR
Oct 20 2023
APPROVAL

REV	DESCRIPTION	DATE	DRWN	CHKD	ENGR	
REVISIONS						
<small>THIS DRAWING INCLUDING THE INFORMATION, DATA AND DESIGN IS CONFIDENTIAL AND THE PROPERTY OF BIRDAR INC. IT IS NOT TO BE COPIED, REPRODUCED OR ITS CONTENTS DIVULGED WITHOUT THE WRITTEN PERMISSION OF BIRDAR INC.</small>						
NAME	DATE	 6461 MAIN STREET AMHERST, N.Y. 14221-7075, U.S.A. TELEPHONE: 716-633-9500 FAX: 716-204-1234				
DRAWN BY	MI					10/13/23
CHECKED BY	MI					10/13/23
ENGINEER	MI					10/13/23
FINAL REVIEW			TITLE INTERFACE OVERALL CANOPY VIEW WASHINGTON STATE FAIRGROUNDS			
SCALE	DRAWING SIZE AS NOTED	DWG. NO.	23008 - 1101		REV	

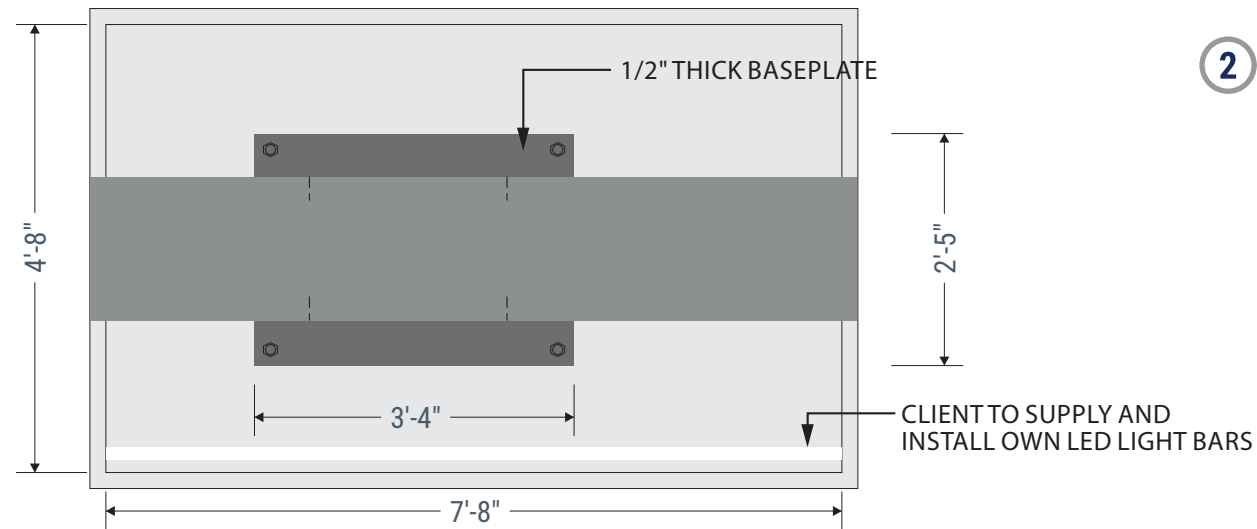

Top View - Scale: 1/2" = 1'

2 ILLUMINATED CHANNEL LETTER - QTY: 1 **48 SQ FT**

CHANNEL LETTER: 18" deep aluminum fabricated, fully enclosed, non-illuminated, face-aluminum, painted gunmetal grey, returns and back- aluminum, painted gunmetal grey.
PAD: 10'X3'X1' #4 rebar concrete pad, baseplate fastened using J-bolts, 2 blades welded to letter internally
MOUNTING: Sign mounted to a 1/2" thick baseplate.
ILLUMINATION: Client to supply and install own led light bars

FACE, RETURN AND BACK: GUNMETAL GREY

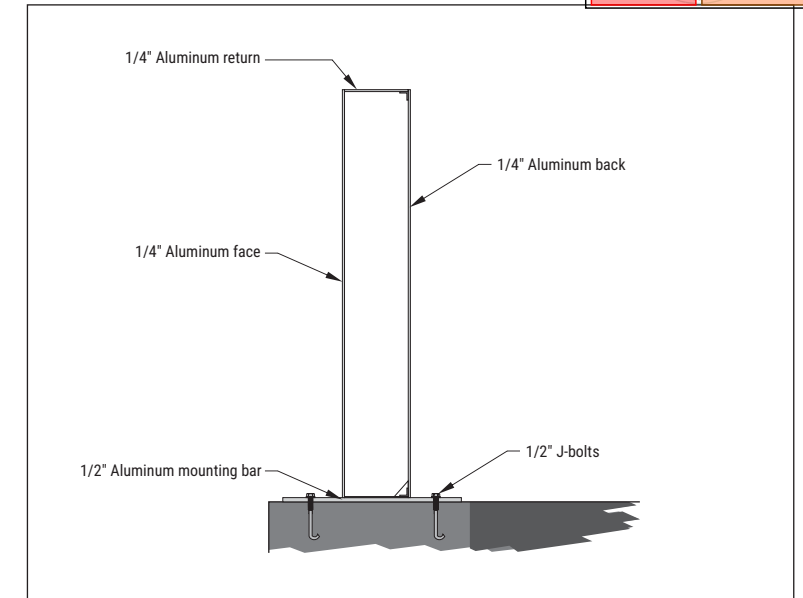

Typical Mounting On Base Plate - Scale: NTS

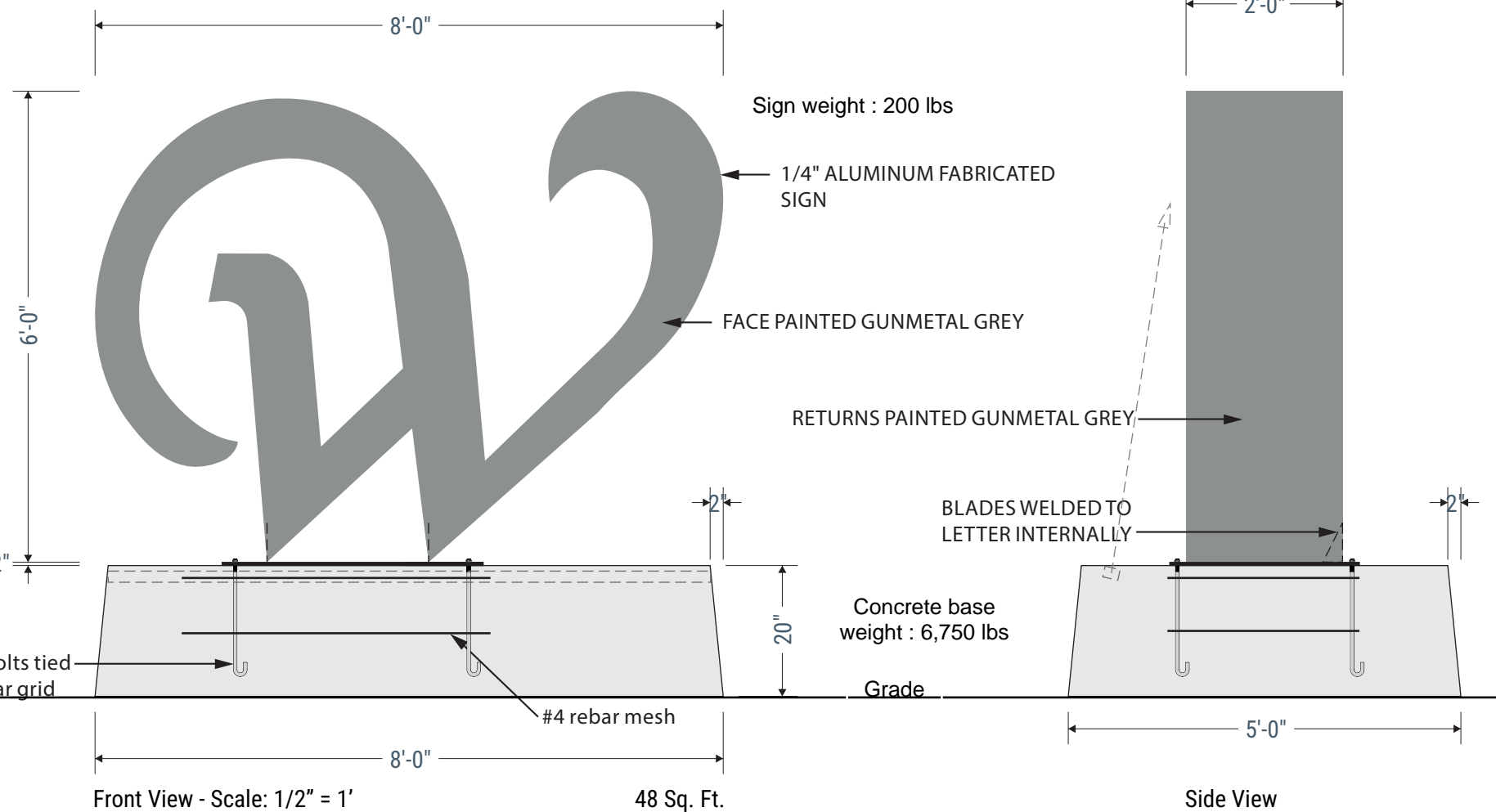

Front View - Scale: 1/2" = 1'

48 Sq. Ft.

Side View



Night View - Scale: 1/2" = 1'

NOTES: SEE SEPARATE PROVIDED SPECIFICATIONS DOCUMENT

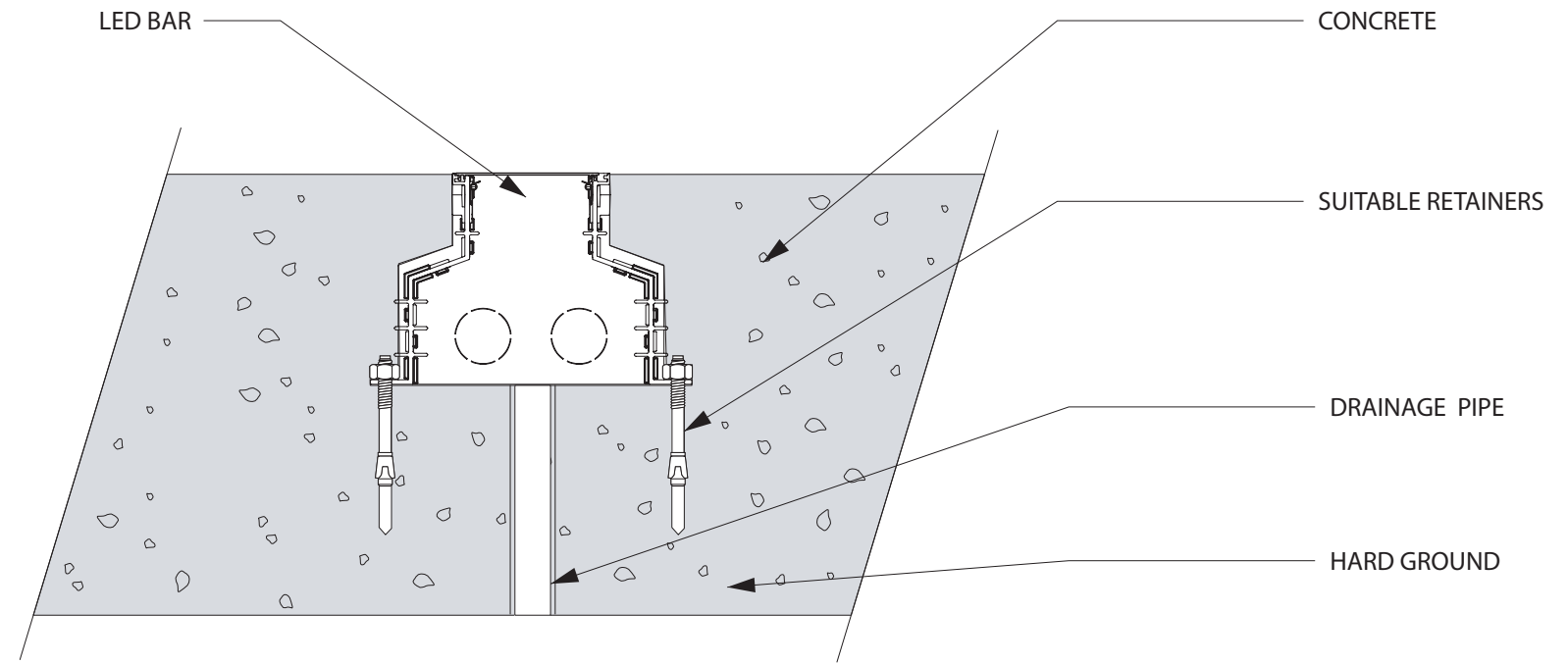
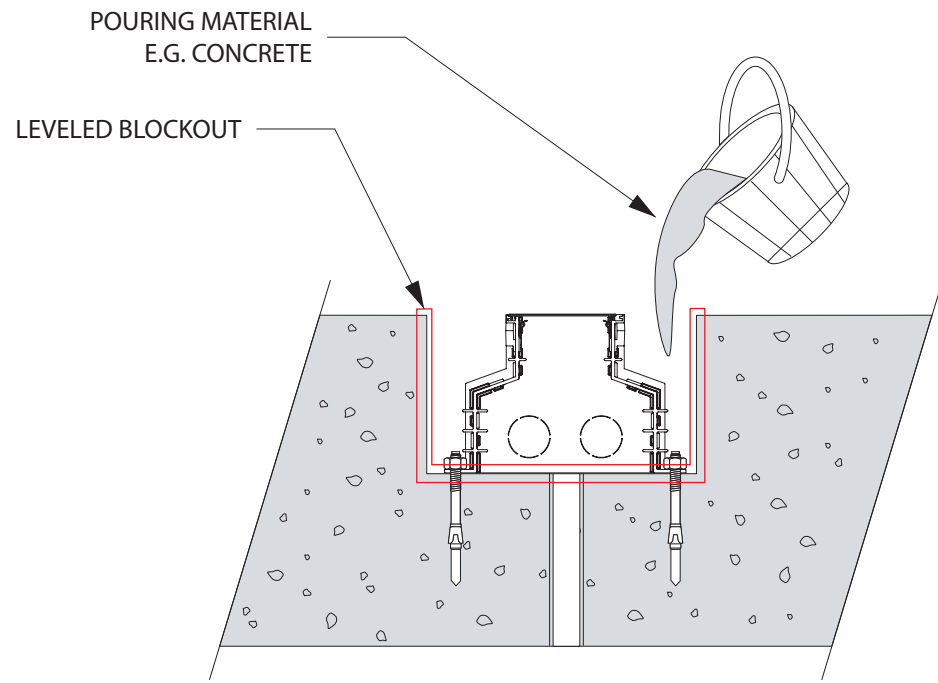

AS INSTALLED

Section View - Scale: NTS



LUMENPULSE LIGHTING MODULE | Scale: NTS