

GENERAL BUILDING SECTION NOTES

1. ARCHITECTURAL FINISH FLOOR ELEVATIONS REFER TO TOP OF FINISH FLOOR ASSEMBLY. SEE STRUCTURAL DRAWING FOR TOP OF STRUCTURE AND BEARING HEIGHT LEGEND CODES.
2. A 1" CONTROL JOINT MUST BE PROVIDED AT THE EXTERIOR FINISH FLOOR LINE OF ALL FLOORS.
3. REFER STRUCTURAL DRAWINGS FOR FOUNDATION LEVELS AND DETAILS.

CEILING FINISH LEGEND

- 1. PRIME & PAINTED GYPSUM BOARD
- 2. PRIME & PAINTED GYPSUM BOARD, MOISTURE RESISTANT
- 3. UNDERSIDE OF FLOOR / ROOF SYSTEM - PRIME & PAINTED TO RECEIVE FINAL FINISH
- 4. 2x2 LAY IN ACCESSIONAL C.E. THE SUSPENSION PRODUCT
- 5. 2x2 LAY IN ACCESSIONAL C.E. THE SUSPENSION FROM STRUCTURE MOISTURE RESISTANT

ENERGY CODE INFORMATION

REFERENCED ENERGY CODE: 2015 WASHINGTON STATE ENERGY CODE
 CHAPTER 3: GENERAL REQUIREMENTS
 (C) 301.1 CLIMATE ZONE: 4C, PIERCE COUNTY, WA

CHAPTER 4: COMMERCIAL ENERGY EFFICIENCY
 TABLE C402.1.3: OPAQUE THERMAL ENVELOPE INSULATION REQUIREMENTS

ROOFS
 INSULATION ENTIRELY ABOVE DECK R-38 ci
WALLS ABOVE GRADE
 MASS WOOD FRAMED AND OTHER R-13.3 ci
 WOOD FRAMED AND OTHER R-21
WALLS BELOW GRADE
 BELOW GRADE WALLS R-13.3 ci
FLOORS
 JOIST FRAMING R-30
 SLAB-ON-GRADE FLOORS R-10 FOR 24" BELOW
 UNHEATED SLABS R-10 FOR 24" BELOW
 OPAQUE DOORS R-4.75
 NONSWINGING

TABLE C402.4: BUILDING ENVELOPE FENESTRATION REQUIREMENTS

VERTICAL FENESTRATION
 FIXED FENESTRATION U-0.38
 OPERABLE FENESTRATION U-0.40
 ENTRANCE DOORS U-0.60

SHGC
 PROJECTION FACTOR NOT APPLICABLE
 SKYLIGHTS
 U-FACTOR U-0.50
 SHGC U-0.35

EXTERIOR FINISH LEGEND

SPACE	MATERIAL - BRAND	FINISH - COLOR	SPACE
EP.1	EPS - DRYFIT	SLIM BEIGE - EPS 08	
EP.2	EPS - DRYFIT	CONNECTED GRAY - EPS 08	
EP.3	EPS - DRYFIT	LETTE - EPS 08	
EP.4	EPS - DRYFIT	COVER WHITE - EPS 08	
ET.1	STONE MASON	MANDARIN CLIFFSTONE	

City of Puyallup
 Development & Permitting Services
ISSUED PERMIT

Building	Planning
Engineering	Public Works
Fire	Traffic

City of Puyallup
 Building
 Reviewed
 FOR
 COMPLIANCE

SKinnear
 09/04/2024
 2:24:12 PM

PRSG20241236

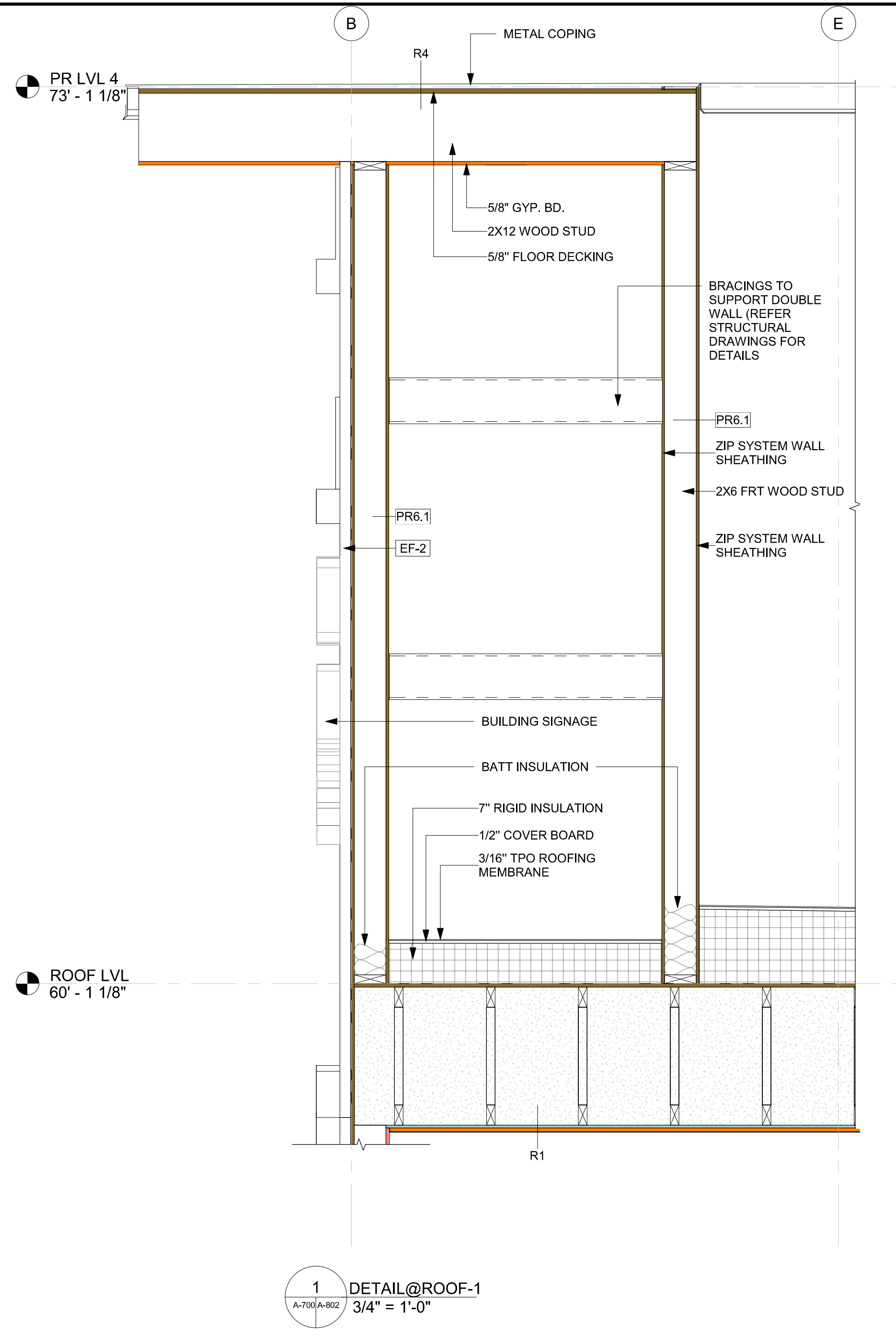

1 DETAIL@ROOF-1
 A-700A-802 3/4" = 1'-0"

Separate Electrical Permit is required with the Washington State Department of Labor & Industries.
<https://mi.wa.gov/licensing-permits/electrical/electrical-permits-fees-and-inspections>
 or call for Licensing Information: 1-800-647-0982

Approval of submitted plans is not an approval of omissions or oversights by this office or non compliance with any applicable regulations of local government. The contractor is responsible for making sure that the building complies with all applicable codes and regulations of the local government.

The approved construction plans, documents, and all engineering must be posted on the job at all inspections in a visible and readily accessible location.

Full sized legible color plans are required to be provided by the permittee on site for inspection.

Details reviewed for installation of wall sign only, in correlation with the plans provided by Persona.

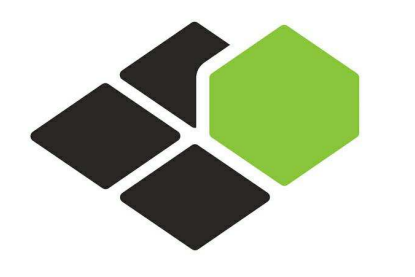

BASE4

BASE4
 2901 CLINT MOORE ROAD, #114
 BOCA RATON, FLORIDA 33496
 888.901.8008 www.base-4.com

RICARDO J. MUNIZ-GUILLET, AIA
 5453 NW 106TH DR
 CORAL SPRINGS, FL 33076

Seal:
 13084 REGISTERED ARCHITECT
 RICARDO J. MUNIZ-GUILLET
 STATE OF WASHINGTON

2020.02.21

Owner:

 Dakota Legacy Group
 Hospitality Development
 4500 36th AVE, S SUITE
 200, FARGO, ND 58104
 701.551.8000 (OFFICE)

HOMWOOD SUITES
 BY HILTON

3500 S MERIDIAN, PUYALLUP, WA 98373
 PROTOTYPE VERSION: V9.2 2014 FEB

ISSUE NO.	DELTA	ISSUE DATE	DESCRIPTION
1	A0	2020.02.21	ISSUED FOR PERMIT

CURRENT ISSUE
ISSUED FOR PERMIT

CURRENT ISSUE DATE
 2020.02.21

DRAWN BY
 NS/PS

CHECKED BY
 NBL/JGC

PROJECT NO.
 B4-124-1803

SHEET NAME

**CONSTRUCTION
 DETAILS @ ROOF**

DRAWINGS NO.
A-802