

Bell Property

Section 15, Township 20 N, Range 4 E, Willamette Meridian, Pierce County, Washington

Parking Floor Dimensions

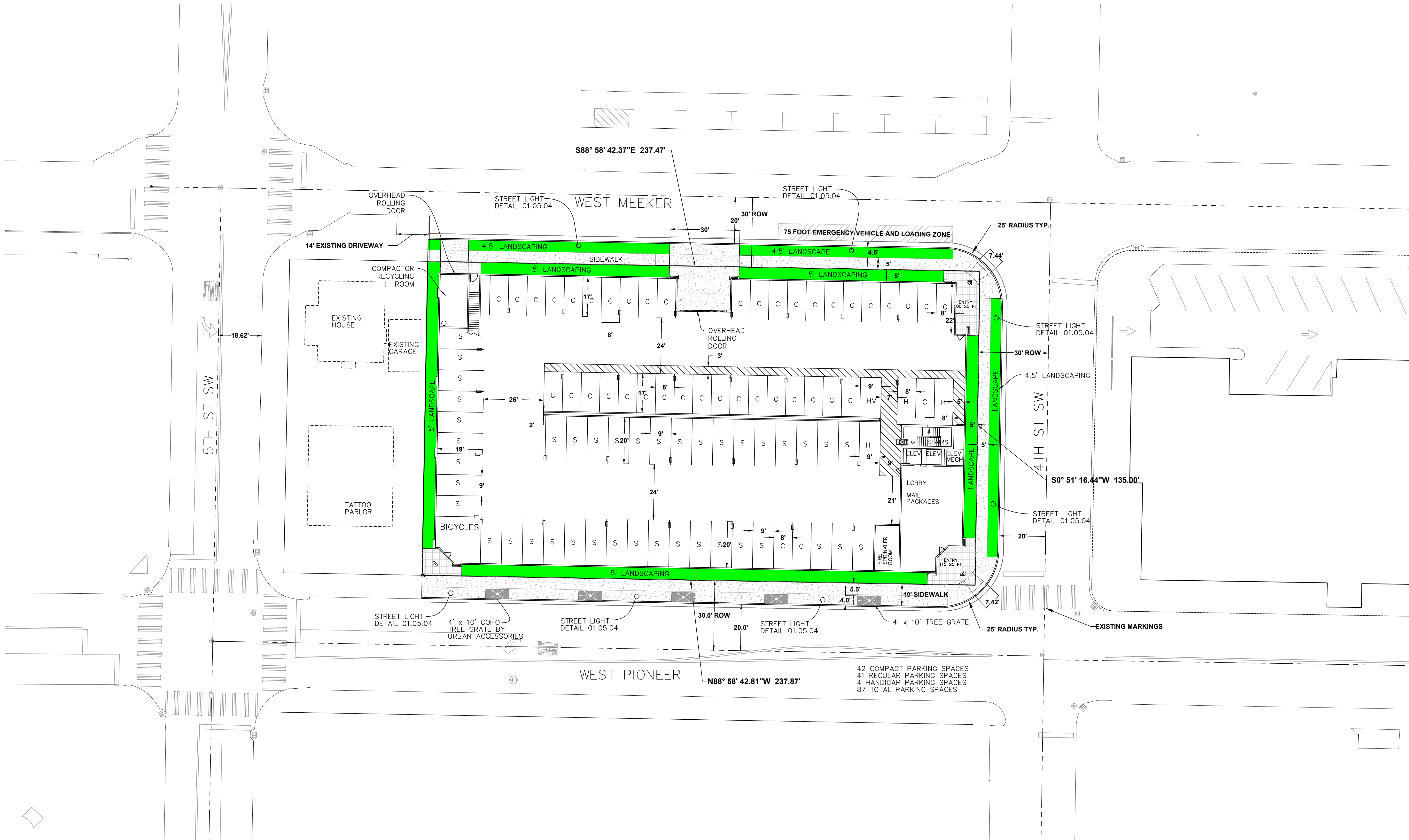
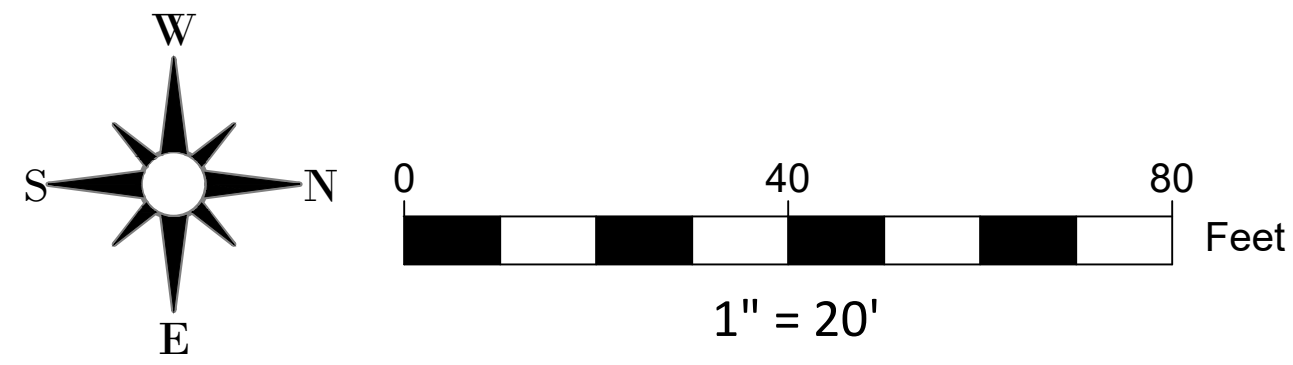

NO.	REVISION	DATE
1		
2		
3		
4		
5		
6		
7		
8		
9		
10		

JOB NO. 3856
DATE 12/19/2021
DESIGNED BY PEG
DRAWN BY TREVOR GREEN
CHECKED BY TJM JOB
APPROVED BY Paul Green

AZURE GREEN
CONSULTANTS

409 East Pioneer, Suite A - Puyallup, WA 98372 Phone: 253.770.3144 / fax: 253.770.3142

+ feasibility + planning + engineering + surveying

Parking Floor Dimensions

Bell Property

Azure Green Consultants
409 East Pioneer, Puyallup WA, 98372
Phone 253.770.3144

DRAWING
S1
SHEET 1
OF 1

Project Desc: ### C:\Users\trevor\OneDrive\AzureGreen\Dropbox\WCS\Jen\3340 Bell\Bell_Vello_02122024.dwg Plot Date/Time: 2/12/2024 4:32 PM