



Location: 401 South Meridian, Puyallup, WA

Contact: Darrell Rowe
Environmental Scientist
Direct: +1 206-239-0276

Site Name: Former BP Facility No. 11082

TCP DESIGNS

Zone 1

The applicant shall notify property owner(s) of blocked driveway(s) at least 24 hours in advance.

Work shall immediately cease in the work zone for a pedestrian spotter, available at all times, to escort pedestrians around the work area.

PRROW20241361

Traffic Control Plan

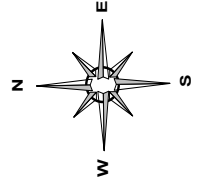

MW-22 and SB-34 in the sidewalk east of S Meridian St (will need the adjoining lane closed)

MW-22:
Hand Cleared to 8 feet bgs using air knife, vac, and hand auger
Drilled using geoprobe
Total depth 15 feet bgs
Install a permanent 2-inch monitoring well screened between 3 and 10 feet, completed with a traffic-rated well monument

SB-34:
Hand Cleared to 6 feet bgs using air knife, vac, and hand auger
Total depth 6 feet bgs
Boring decommissioned, patched with concrete and dyed to match surrounding pavement.

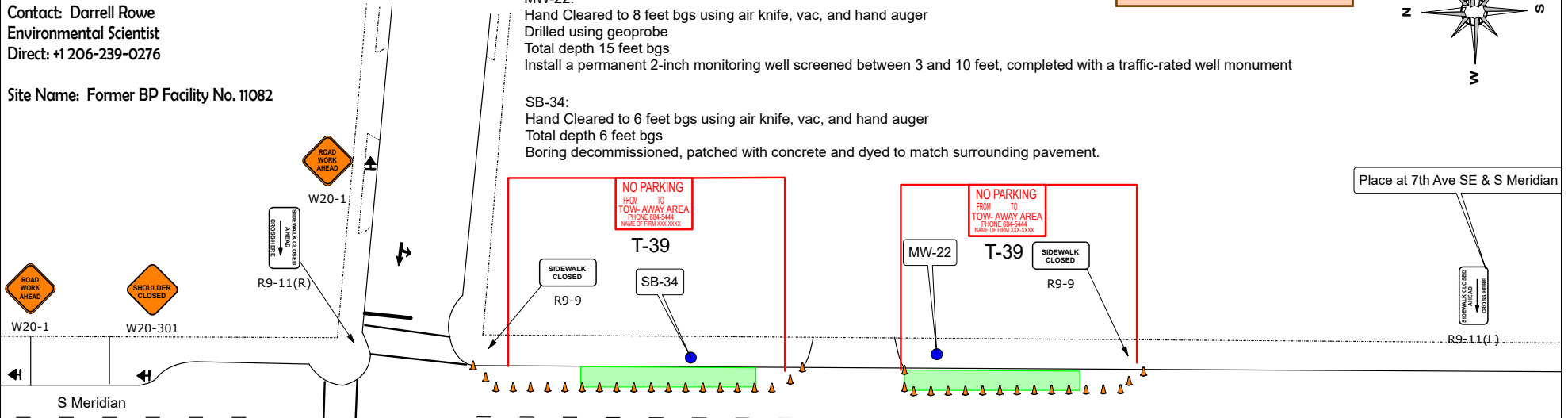

Place at 7th Ave SE & S Meridian

CLOSURE ALLOWED:
Monday - Thursday
9AM - 2PM
Call communications center at 253-287-4456 on day of closure. Request a job start inspection through the CityView portal. Public notification shall comply with PMC Chapter 11.05.110. The City-issued permit packet shall be posted at the job site and available to inspectors at all times.

- Job Notes**
- * All signs and spacing shall conform to MUTCD
 - * NOT TO SCALE
 - * Notify all local emergency services of closure times and dates
 - * Sign spacing may be reduced to fit roadway conditions
 - * Alert Metro Impact 5 days in advance of any Bus stop changes 206-477-1140
 - * No Parking must be placed 72 hours in advance of work
 - * No Parking signs spaced out at 40'

Portable changeable message signs shall be posted at least 72 hours in advance of work start date notifying travelers of impending road work and traffic impacts.

ROAD TYPE	SPEED	SUGGESTED ADVANCE WARNING SIGN PLACEMENT			
		DISTANCE BETWEEN SIGNS			
		A	B	C	D
URBAN/LOW MPH	25/30	200'	200'	200'	X
URBAN/HIGH MPH	35/40	350'	350'	350'	X
RURAL	45/60	500'	500'	500'	500'
RURAL/HVYS	60/65	800'	800'	800'	800'
FREEWAYS/EXPRESSWAYS	55/70	1500'	1500'	1500'	1500'

Legend

- Cone
- R9-9 R9-9
- R9-11(L) Sidewalk Closed Ahead, Cross Here R9-11(L)
- R9-11(R) Sidewalk Closed Ahead, Cross Here R9-11(R)
- W20-1 Road Work Ahead
- W20-301 W20-301
- Work Area

LANE WIDTH (FEET)	MINIMUM TAPER LENGTH (L) IN FEET									
	POSTED SPEED (MPH)									
	25	30	35	40	45	50	55	60	65	70
10	105	150	205	265	450	500	550	-	-	-
11	115	165	225	295	495	550	605	660	-	-
12	125	180	245	320	540	600	660	720	780	840

MPH	CHANNELIZING DEVICES SPACING (FEET)	
	TAPER	TANGENT
50/70	40	80
35/45	30	60
25/30	20	40

Jera Kane
TCS # 012684
Phone: 206-573-2962
Trafficplandesigns@gmail.com
Ex Date: 1/31/2025