



Location: 401 South Meridian (Alley way) Puyallup, WA

Contact: Darrell Rowe
Environmental Scientist
Direct: +1 206-239-0276

Site Name: Former BP Facility No. 11082

2ND ST SE

CLOSURE ALLOWED:
Monday - Thursday
9AM - 2PM
Call communications center at 253-287-4456 on day of closure. Request a job start inspection through the CityView portal. Public notification shall comply with PMC Chapter 11.05.110. The City-issued permit packet shall be posted at the job site and available to inspectors at all times.

TCP DESIGNS

Zone 2

Traffic Control Plan

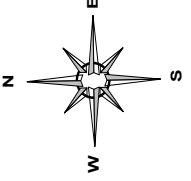

CHANNELIZING DEVICES SPACING (FEET)		
MPH	TAPER	TANGENT
50/70	40	80
35/45	30	60
25/30	20	40

Legend

- Barrier
- Cone
- W20-1 Road Work Ahead
- W20-3 Road Closed Ahead
- Work Area

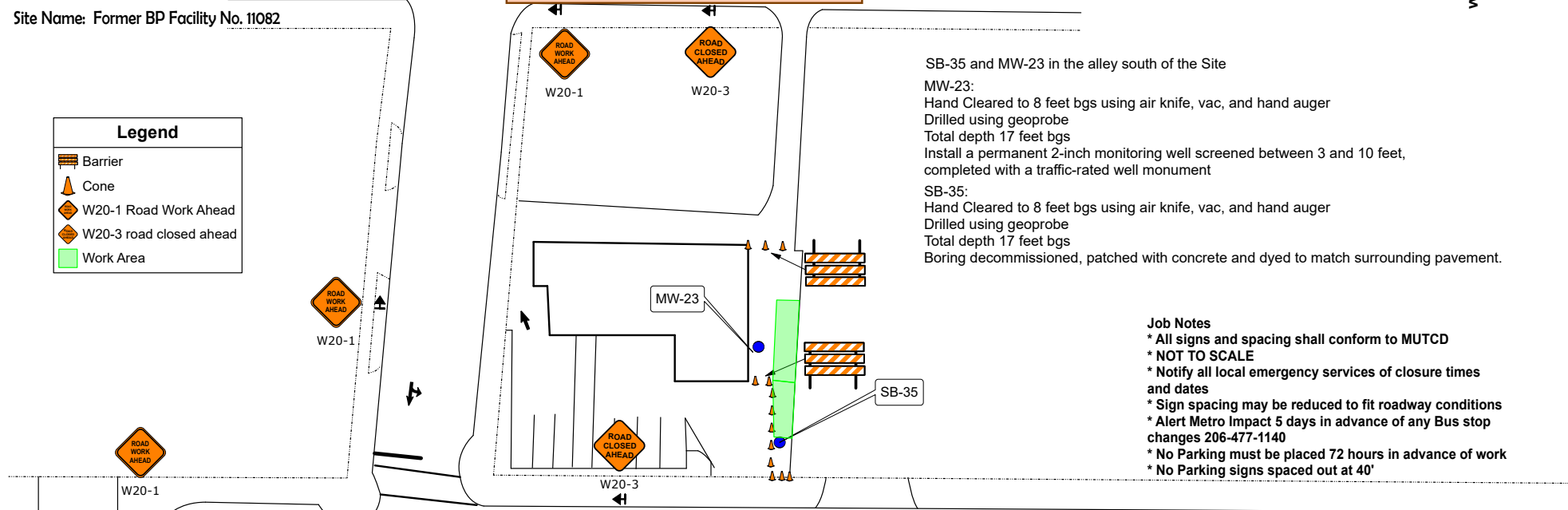

SB-35 and MW-23 in the alley south of the Site

MW-23:
Hand Cleared to 8 feet bgs using air knife, vac, and hand auger
Drilled using geoprobe
Total depth 17 feet bgs
Install a permanent 2-inch monitoring well screened between 3 and 10 feet, completed with a traffic-rated well monument

SB-35:
Hand Cleared to 8 feet bgs using air knife, vac, and hand auger
Drilled using geoprobe
Total depth 17 feet bgs
Boring decommissioned, patched with concrete and dyed to match surrounding pavement.

- Job Notes**
- * All signs and spacing shall conform to MUTCD
 - * NOT TO SCALE
 - * Notify all local emergency services of closure times and dates
 - * Sign spacing may be reduced to fit roadway conditions
 - * Alert Metro Impact 5 days in advance of any Bus stop changes 206-477-1140
 - * No Parking must be placed 72 hours in advance of work
 - * No Parking signs spaced out at 40'

MINIMUM TAPER LENGTH (L) IN FEET

LANE WIDTH (FEET)	POSTED SPEED (MPH)									
	25	30	35	40	45	50	55	60	65	70
10	105	150	205	265	450	500	550	-	-	-
11	115	165	225	295	495	550	605	660	-	-
12	125	180	245	320	540	600	660	720	780	840

SUGGESTED ADVANCE WARNING SIGN PLACEMENT

ROAD TYPE	SPEED	DISTANCE BETWEEN SIGNS			
		A	B	C	D
URBAN/LOW MPH	25/30	200'	200'	200'	X
URBAN/HIGH MPH	35/40	350'	350'	350'	X
RURAL	45/60	500'	500'	500'	500'
RURAL HWYS	60/65	800'	800'	800'	800'
FREEWAYS EXPRESSWAYS	55/70	1500'	1500'	1500'	1500'

Jera Kane
TCS # 012684
Phone: 206-573-2962
Trafficplandesigns@gmail.com
Ex Date: 1/31/2025