

- Distance between cones equals speed limit in unit feet
- Taper length equals width of offset times speed squared divided by 60
- Sign spacing shall be 100 feet when speed limits is 30 MPH or less
- Sign spacing shall be 350 feet when speed limit is greater than 30 MPH
- Distance between signs is mandatory unless field conditions determine otherwise

Typical Shoulder Closure

- Shoulder on W/B 43rd Ave SW closed between 4th St PI SW & 98th Ave E.
- Sidewalk not present within the work area.
- Bike Lane not present.
- Transit Route not present.

CLOSURE ALLOWED:  
Monday - Friday  
9AM - 3PM  
Call communications center at  
253-287-4456 on day of closure.

TRAFFIC CONTROL PLAN  
PUYALLUP, WA

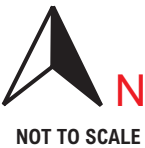

WASHINGTON STATE TRAFFIC CONTROL  
**SUPERVISOR**  
NAME: Greg Siler  
PCC CARD # 07804  
EXP. DATE 10/16/24  
Greg Siler

**SILER**  
Traffic Control  
Plan

PREPARED BY  
**Greg Siler**  
PHONE #  
253-600-9353  
EMAIL  
SilerTCPco@outlook.com

JOB#  
PROJECT LOCATION  
Puyallup, WA  
DATE PREPARED  
8/16/24  
SHEET #  
1

**HCHOMES**  
UNIQUELY NORTHWEST

CONTRACTOR  
HC Homes Inc  
SUPERVISOR  
Sallie James  
PHONE NUMBER  
253-205-7887

ADVANCE WARNING SIGNS  
SPACED @ (X) OR AS PER  
SITE CONDITIONS.  
REFER TO SIGN SPACING CHART.

- **REASON: New Construction:**  
(Ground Disturbance Required)
- **Work Duration:**
- **Work Hrs:**

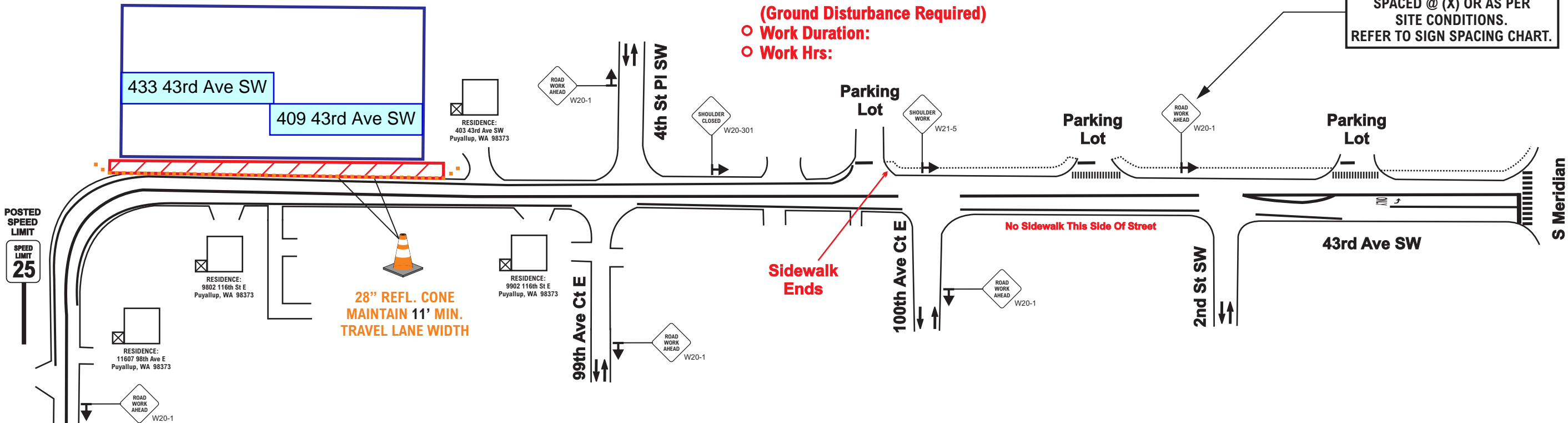

ADDL. NOTES:

IF APPLICABLE  
THESE SIGNS SHALL BE DISPLAYED  
DURING NON-WORKING HOURS  
ACCORDING TO RCW 47.36.200



LEGEND



WORK AREA



CONSTRUCTION SITE



28" REFL. CONE



SIGN LOCATION



EXISTING TRAFFIC FLOW

GENERAL NOTES:

1. ALL SIGNS AND SPACING SHALL CONFORM TO THE MUTCD SPECS.
2. NOTIFY LOCAL EMERGENCY SERVICES OF CLOSURE TIMES AND DATES (OPTIONAL).
3. SIGN SPACING MAY BE REDUCED IN URBAN AREAS TO FIT ROAD CONDITIONS.
4. PROTECTIVE VEHICLE RECOMMENDED-MAY BE A WORK TRUCK.
5. ALL SIGNS MIN. 48" x 48" UNLESS OTHERWISE SPECIFIED.
6. CHANNELIZATION DEVICES ARE 28" REFL. CONES (see TABLE (1) for spacing distances).
7. ALL SPACING MAY BE ADJUSTED TO ACCOMMODATE AT-GRADE INTERSECTIONS AND/OR DRIVEWAYS.



- Distance between cones equals speed limit in unit feet
- Taper length equals width of offset times speed squared divided by 60
- Sign spacing shall be 100 feet when speed limits is 30 MPH or less
- Sign spacing shall be 350 feet when speed limit is greater than 30 MPH
- Distance between signs is mandatory unless field conditions determine otherwise

Typical One-Lane, Two-Way Operation

- W/B 43rd Ave SW closed between 4th St PI SW & 98th Ave E.
- FLAGGERS shall alternate traffic, as needed.
- Sidewalk not present within the work area.
- Bike Lane not present.
- Transit Route not present.

CLOSURE ALLOWED:  
Monday - Friday  
9AM - 3PM  
Call communications center at  
253-287-4456 on day of closure.

TRAFFIC CONTROL PLAN  
PUYALLUP, WA



WASHINGTON STATE TRAFFIC CONTROL  
**SUPERVISOR**  
NAME: Greg Siler  
PCC CARD # 070604  
EXP. DATE 10/16/24  
Greg Siler



- **REASON:** New Construction: Utility / Frontage Work.  
(Ground Disturbance Required)
- **Work Duration:**
- **Work Hrs:**

ADVANCE WARNING SIGNS  
SPACED @ (X) OR AS PER  
SITE CONDITIONS.  
REFER TO SIGN SPACING CHART.

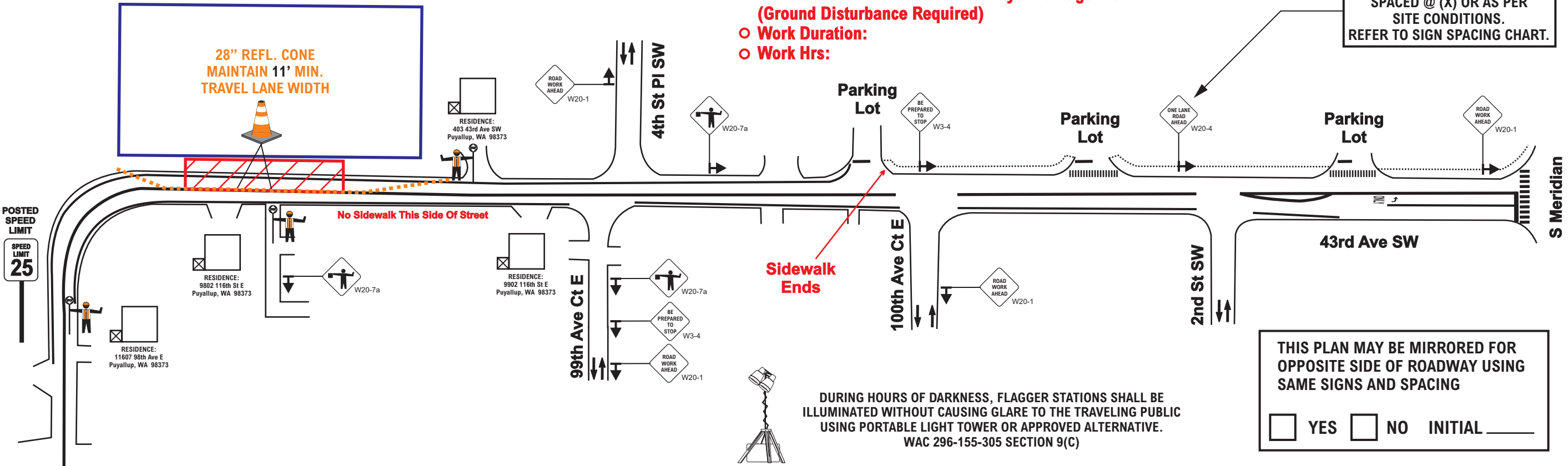

**MANDATORY**  
DURING NON-WORKING HOURS, TRAFFIC CONTROL SHALL BE  
REMOVED AND ROW SHALL BE OPENED TO IT'S FULL WIDTH



GENERAL NOTES:

1. ALL SIGNS AND SPACING SHALL CONFORM TO THE MUTCD SPECS.
2. NOTIFY LOCAL EMERGENCY SERVICES OF CLOSURE TIMES AND DATES (OPTIONAL).
3. SIGN SPACING MAY BE REDUCED IN URBAN AREAS TO FIT ROAD CONDITIONS.
4. PROTECTIVE VEHICLE RECOMMENDED-MAY BE A WORK TRUCK.
5. ALL SIGNS MIN. 48" x 48" UNLESS OTHERWISE SPECIFIED.
6. CHANNELIZATION DEVICES ARE 28" REFL. CONES (see TABLE (1) for spacing distances).
7. ALL SPACING MAY BE ADJUSTED TO ACCOMMODATE AT-GRADE INTERSECTIONS AND/OR DRIVEWAYS.

ADDL. NOTES:

- Flagger's shall remain in radio contact at all times
- A minimum of 11' travel lanes must be maintained

THIS PLAN MAY BE MIRRORED FOR  
OPPOSITE SIDE OF ROADWAY USING  
SAME SIGNS AND SPACING

☐ YES ☐ NO INITIAL \_\_\_\_\_

IF APPLICABLE  
THESE SIGNS SHALL BE DISPLAYED  
DURING NON-WORKING HOURS  
ACCORDING TO RCW 47.36.200

W8-24

W21-1701

LEGEND

- WORK AREA
- CONSTRUCTION SITE
- 28" REFL. CONE
- SIGN LOCATION
- FLAGGING STATION
- EXISTING TRAFFIC FLOW

JOB#	PREPARED BY	PHONE #	SHEET #
	Greg Siler	253-600-9353	
PROJECT LOCATION	DATE PREPARED	8/16/24	
	Puyallup, WA	2	
CONTRACTOR	SUPERVISOR	PHONE NUMBER	
HC Homes Inc	Sallie James	253-205-7887	

- E/B 43rd Ave SW closed between 98th Ave E & 4th St PI SW.
- FLAGGERS shall alternate traffic, as needed.
- Sidewalk not present within the work area.
- Bike Lane not present.
- Transit Route not present.



- **REASON: New Construction: Light Pole Install.**  
**(Ground Disturbance Required)**
- **Work Duration:**
- **Work Hrs:**

