

PRFUP20241583

Handhole H01 shall be located on private property.

H01  
INST 17"x 30" SEC HH W/#10-350 (6) POS CONN BARS

H01-M01  
CONNECT & TAG CUST INSTALLED UG SVC  
CONDUCTORS (1 RUNS OF 4/0 )

H01-M02  
CONNECT & TAG CUST INSTALLED UG SVC  
CONDUCTORS (1 RUNS OF 4/0 )

H01-M03  
CONNECT & TAG CUST INSTALLED UG SVC  
CONDUCTORS (1 RUNS OF 4/0 )

H01-M04  
CONNECT & TAG CUST INSTALLED UG SVC  
CONDUCTORS (1 RUNS OF 4/0 )

A 10" diameter core drill is allowed for potholing. For pothole windows larger than 10" in diameter or trenching completed in existing roadway, the contractor shall restore the pavement by installing the trench patch and then grinding/overlaying. All roadway restoration and street patches shall comply with City Standard Detail 01.01.20.

PSE shall provide as-builts to the property owner and project manager for utility crossing conflicts, particularly with water and stormwater, during future site development.

The City of Puyallup does not authorize or permit private utility work on private property or outside City limits. The permit holder shall be responsible to obtain the necessary permissions or permits from all property owners or jurisdictional agencies prior to starting work.

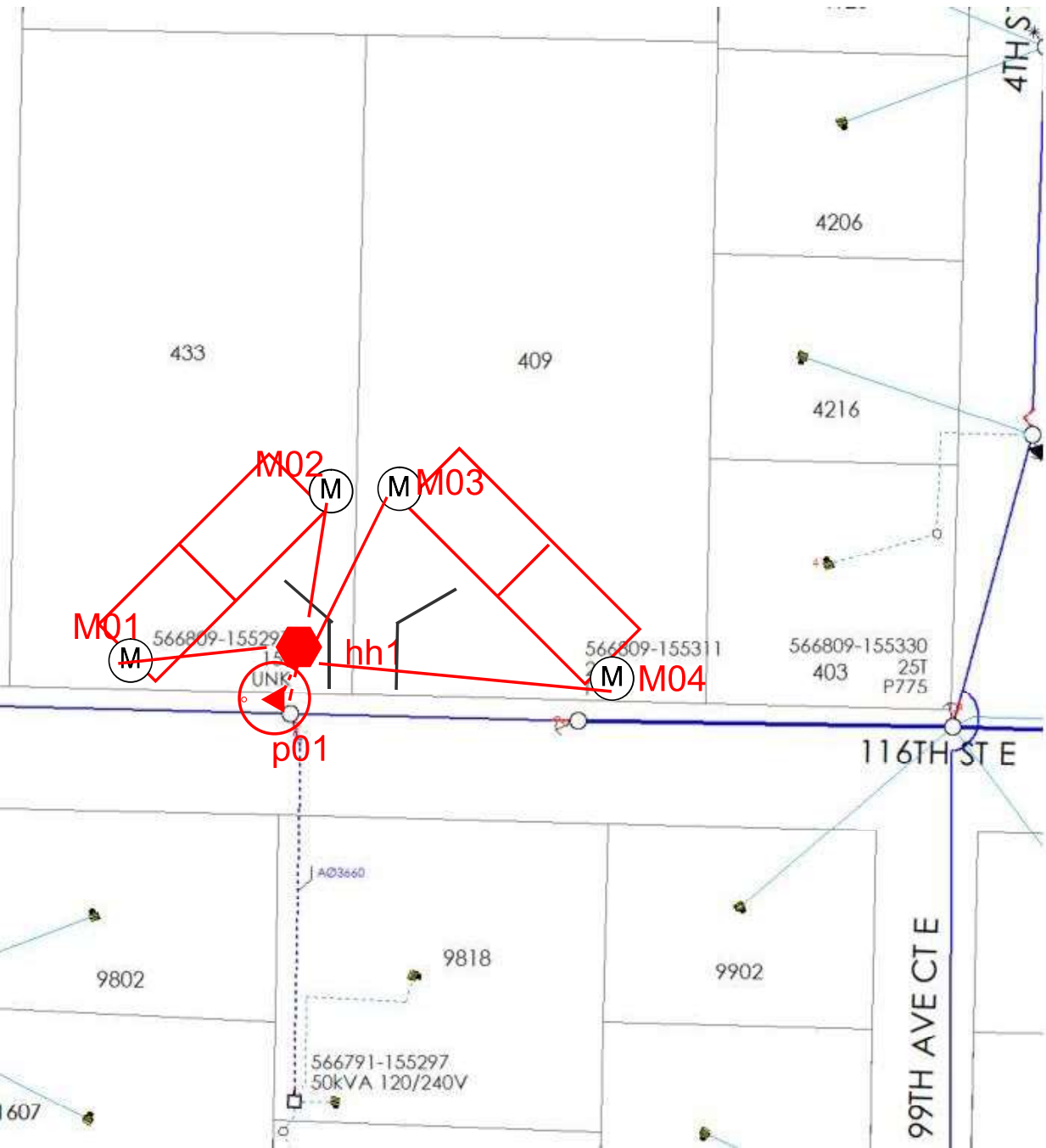

JOB NUMBER: 105103711 / 104356950-433 A&B  
104356951-409 A&B

ADDRESS: 409 & 433 43RD AVE SW PUYALLUP

PERMIT: Y  
EASEMENT: Y  
FLAGGERS: Y  
OUTAGES: Y  
LOCATES: CUSTOMER  
LRC: 65  
SQ FT: 1864 EACH  
PANEL: 200A EACH  
VDROP: 0.6%  
FLICKER: 2.1%

DESCRIPTION:

P01: GRID # 566809-155297 3-11  
HANG 25 KVA, 120/240V OH XFMR OR  
INST L/B C/O ON C/O BRACKET, FUSE @ T  
OR INST L/B C/O ON PRIMARY ARM, FUSE @ T  
INST STIRRUP TAP PHASE  
INST POLE GND (AS REQ'D)  
INST " SEC RISER ON EXIST S/O BRACKETS,  
(ACTUAL= ')  
INST GRID#

P01-H01 3-22  
INST 350 UG TPLX, ± 60 ' IN PSE PROVIDED 3"  
CONDUIT, (ACTUAL= ')