

A 10" diameter core drill is allowed for potholing. For pothole windows larger than 10" in diameter or trenching completed in existing roadway, the contractor shall restore the pavement by installing the trench patch and then grinding/overlaying. All roadway restoration and street patches shall comply with City Standard Detail 01.01.20.

Where a curb exists, the lateral offset of all vertical obstructions shall be a minimum of 1.5' from the face of the curb to the face of the vertical obstruction and a minimum of 3' at intersections. Where no curb exists, the lateral offset of all vertical obstructions shall be a minimum of 4' measured from the edge of pavement to the face of the obstruction.

Handhole H01 shall be located on private property.

City of Puyallup Development & Permitting Services ISSUED PERMIT			
Building	Planning		
Engineering	Public Works		
Fire	Traffic		

All proposed franchise utilities shall be located within a recorded utility easement or in the public right-of-way as determined by the City of Puyallup. The City of Puyallup does not authorize or permit utility work on private property.

PSE shall provide as-builts to the property owner and project manager for utility crossing conflicts, particularly with water and stormwater, during future site development.

PRFUP20241583

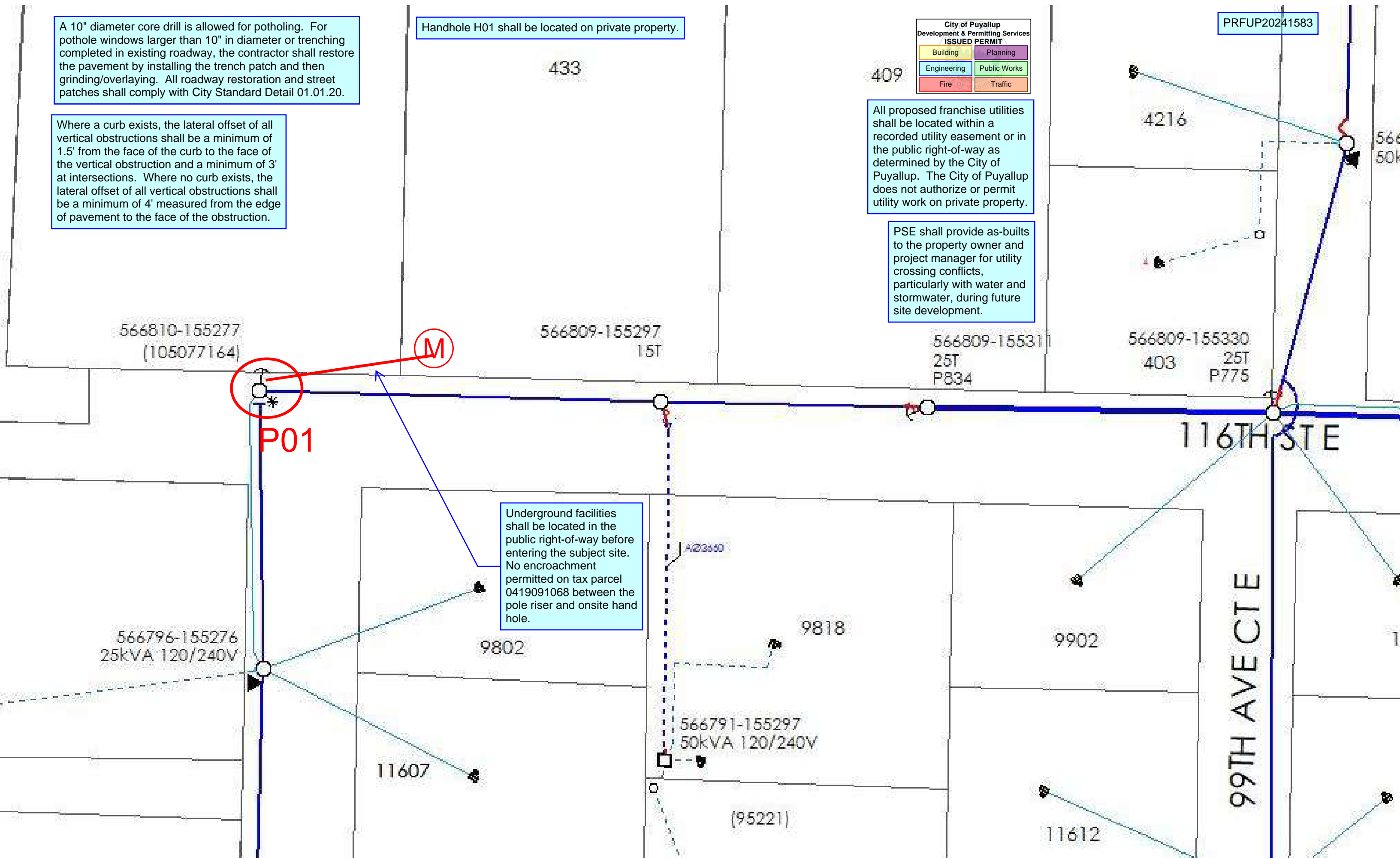

Underground facilities shall be located in the public right-of-way before entering the subject site. No encroachment permitted on tax parcel 0419091068 between the pole riser and onsite hand hole.