



# SHOEPALACE

**City of Puyallup  
Planning  
Division  
APPROVED**  
See permit  
conditions.  
NComstock  
11/06/2024  
11:31:13 AM



**City of Puyallup  
Building  
Division  
REVIEWED  
FOR  
COMPLIANCE**  
SKinnear  
10/28/2024  
10:47:17 AM



The approved construction plans, documents, and all engineering must be posted on the job at all inspections in a visible and readily accessible location.  
**Full sized legible color plans** are required to be provided by the permittee on site for inspection.

Approval of submitted plans is not an approval of omissions or oversights by this office or non compliance with any applicable regulations of local government. The contractor is responsible for making sure that the building complies with all applicable codes and regulations of the local government.

Separate Electrical Permit is required with the Washington State Department of Labor & Industries.  
<https://lni.wa.gov/licensing-permits/electrical/electrical-permits-fees-and-inspections>  
or call for Licensing Information: 1-800-647-0982



**SOUTH HILL MALL - PUYALLUP, WA PRSG20241650**

## SCOPE OF WORK

SIGN A: Manufacture and install (1) New Face-Lit Channel Letter Sign on Storefront Elevation  
SIGN B: Manufacture and install (1) New Face-Lit Channel Letter Sign on Storefront Elevation

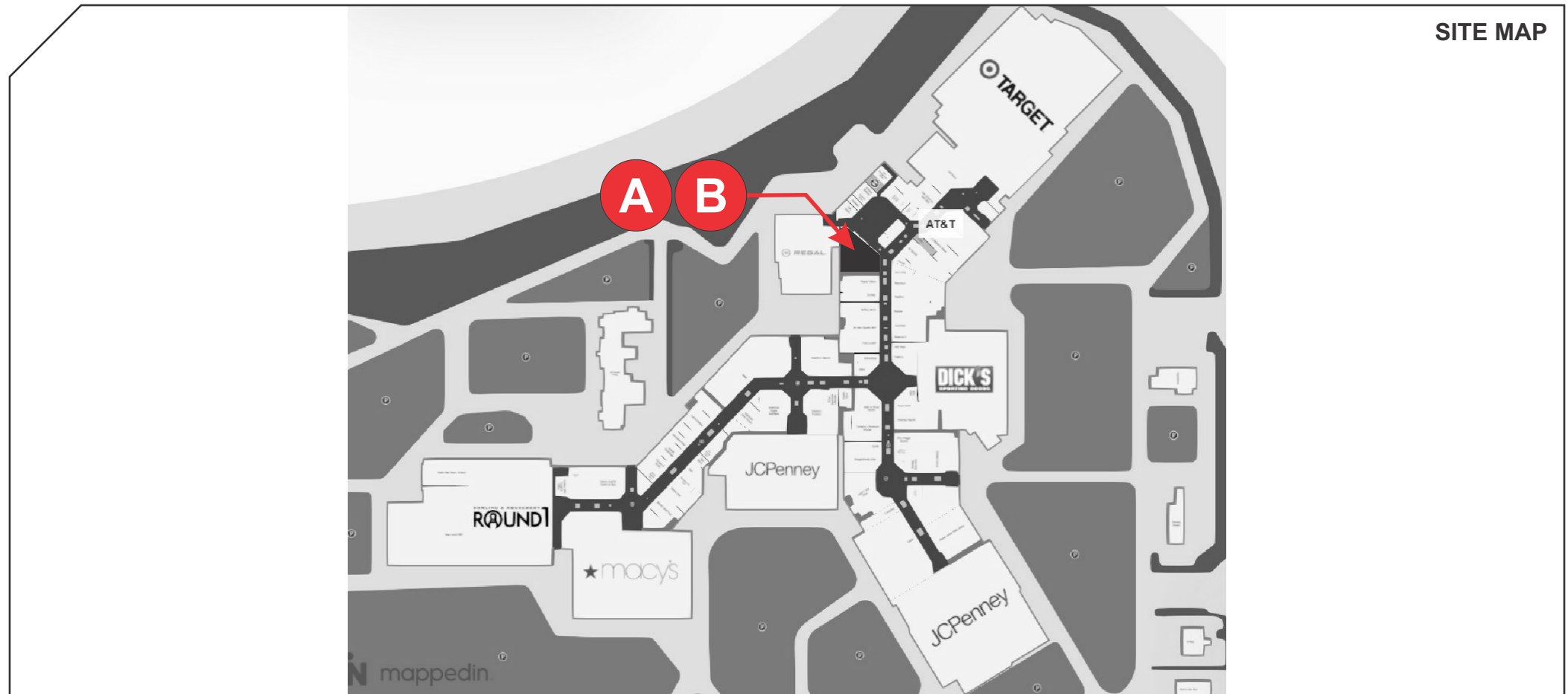
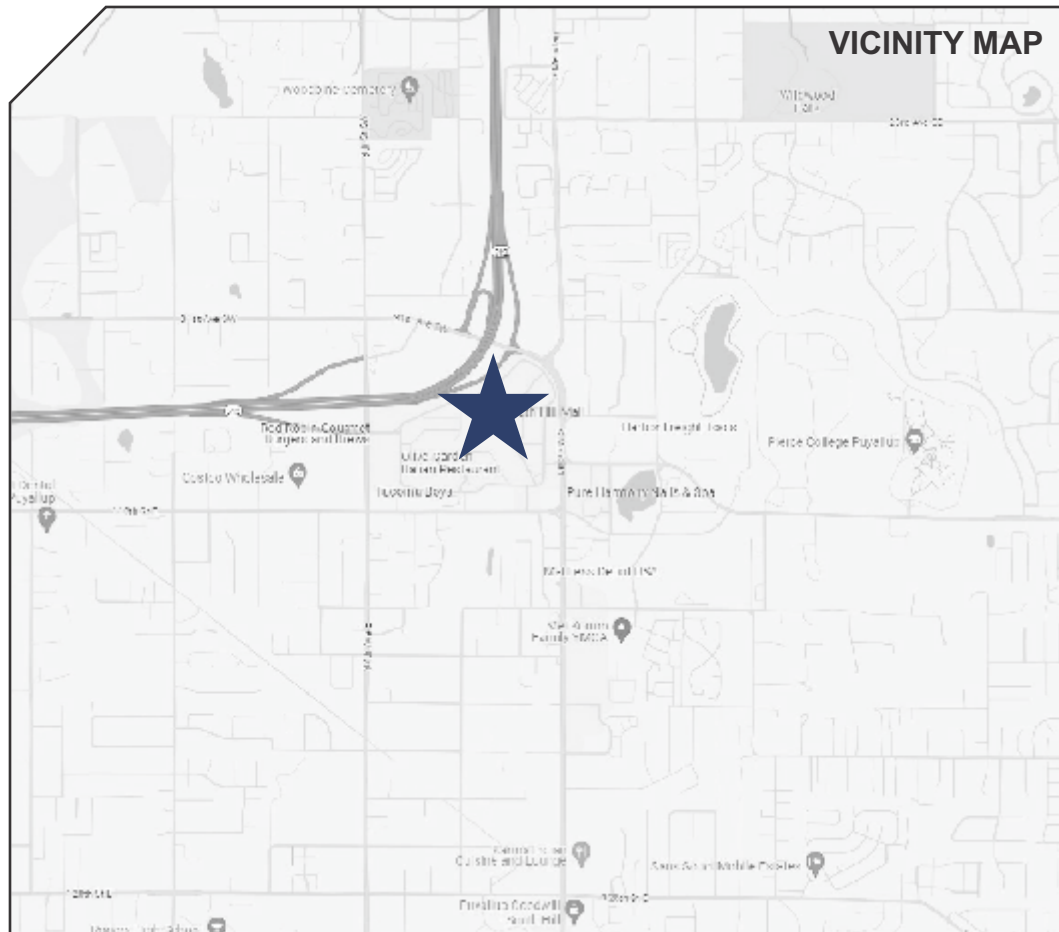

13158 ARCTIC CIR.  
SANTA FE SPRINGS  
CALIFORNIA 90670  
PH: (562) 436-5188  
www.TDISIGNS.com

THIS DESIGN IS THE PROPERTY OF TDI SIGNS INC. IT IS NOT TO BE SHOWN TO ANYONE OUTSIDE OF YOUR ORGANIZATION, REPRODUCED, OR COPIED IN ANY FASHION WITHOUT THE WRITTEN AUTHORIZATION OF TDI SIGNS INC.. COLORS DEPICTED ARE A GRAPHIC REPRESENTATION, REFER TO CALLOUTS FOR ACTUAL COLORS TO BE USED.

**PROJECT INFO:**  
SHOE PALACE  
SOUTH HILL MALL  
Space 410 & 420  
3500 S Meridian  
Puyallup, WA 98373

**Account Manager:** G. Verduzco  
**Designer:** H. Schneider  
**Project Manager:** J. Palomino

**Approval:**

#	INT.	DATE	DESCRIPTION
1	EA	09/01	INITIAL DRAWING
2	EA	09/09	UPDATED TO NEW LOGO & DUAL-LIT W/ CHROME.FIN.
3	EA	09/30	UPDATED ELEVATION AS PER EMAIL REEQUEST
4	EA	10/07	UPDATED SOW OF SIGN A & B

**1 OF 5**  
**10/07/24**  
**240708-04.0**

# STOREFRONT ELEVATION: SIGN A

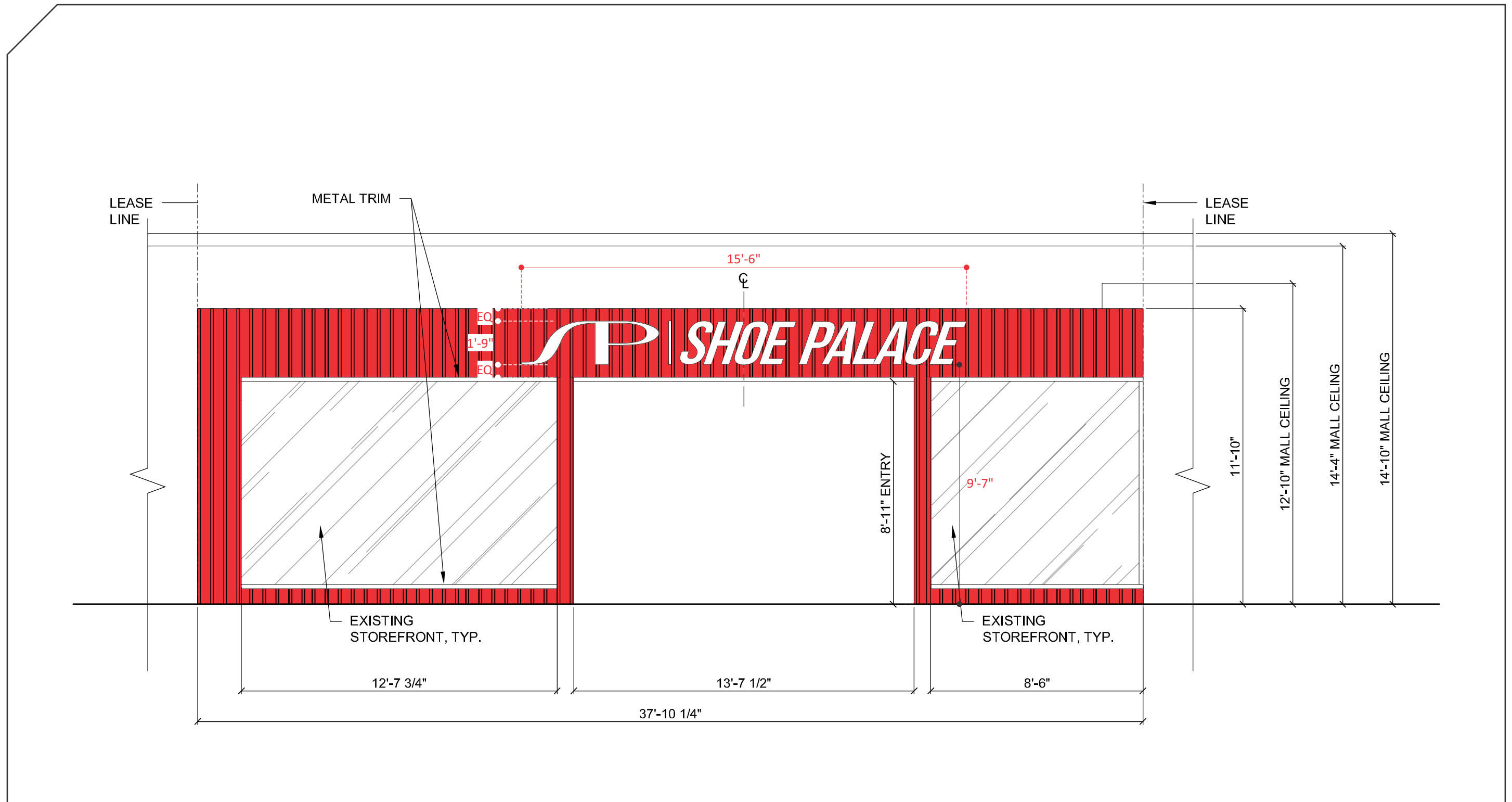

**SCALE:** 1/4" = 1'



13158 ARCTIC CIR.  
SANTA FE SPRINGS  
CALIFORNIA 90670  
PH: (562) 436-5188  
www.TDISIGNS.com

THIS DESIGN IS THE PROPERTY OF TDI SIGNS INC. IT IS NOT TO BE SHOWN TO ANYONE OUTSIDE OF YOUR ORGANIZATION, REPRODUCED, OR COPIED IN ANY FASHION WITHOUT THE WRITTEN AUTHORIZATION OF TDI SIGNS INC.. COLORS DEPICTED ARE A GRAPHIC REPRESENTATION, REFER TO CALLOUTS FOR ACTUAL COLORS TO BE USED.

**PROJECT INFO:**  
SHOE PALACE  
SOUTH HILL MALL  
Space 410 & 420  
3500 S Meridian  
Puyallup, WA 98373

**Account Manager:** G. Verduzco  
**Designer:** H. Schneider  
**Project Manager:** J. Palomino

**Approval:**

#	INT.	DATE	DESCRIPTION
1	EA	09/01	INITIAL DRAWING
2	EA	09/09	UPDATED TO NEW LOGO & DUAL-LIT W/ CHROME.FIN.
3	EA	09/30	UPDATED ELEVATION AS PER EMAIL REEQUEST
4	EA	10/07	UPDATED SOW OF SIGN A & B

# STOREFRONT ELEVATION: SIGN B

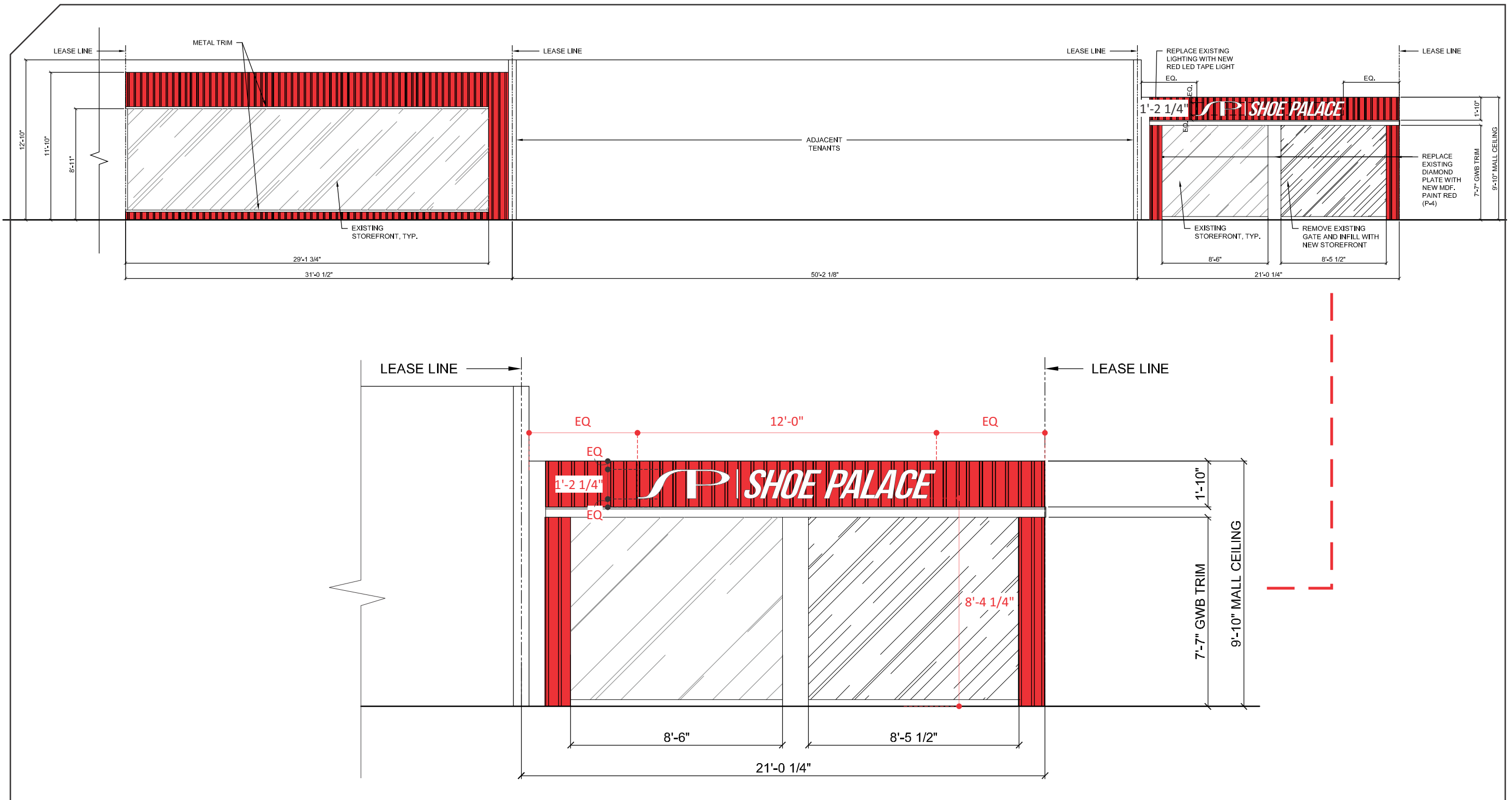

**SCALE:** 1/4" = 1'



13158 ARCTIC CIR.  
SANTA FE SPRINGS  
CALIFORNIA 90670  
PH: (562) 436-5188  
www.TDISIGNS.com

THIS DESIGN IS THE PROPERTY OF TDI SIGNS INC. IT IS NOT TO BE SHOWN TO ANYONE OUTSIDE OF YOUR ORGANIZATION, REPRODUCED, OR COPIED IN ANY FASHION WITHOUT THE WRITTEN AUTHORIZATION OF TDI SIGNS INC.. COLORS DEPICTED ARE A GRAPHIC REPRESENTATION, REFER TO CALLOUTS FOR ACTUAL COLORS TO BE USED.

**PROJECT INFO:**  
SHOE PALACE  
SOUTH HILL MALL  
Space 410 & 420  
3500 S Meridian  
Puyallup, WA 98373

**Account Manager:** G. Verduzco  
**Designer:** H. Schneider  
**Project Manager:** J. Palomino

**Approval:**

#	INT.	DATE	DESCRIPTION
1	EA	09/01	INITIAL DRAWING
2	EA	09/09	UPDATED TO NEW LOGO & DUAL-LIT W/ CHROME.FIN.
3	EA	09/30	UPDATED ELEVATION AS PER EMAIL REEQUEST
4	EA	10/07	UPDATED SOW OF SIGN A & B

# FACE-LIT CHANNEL LETTERS: SIGN A

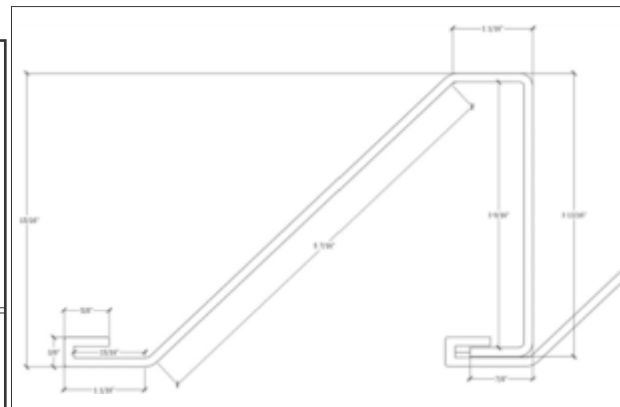
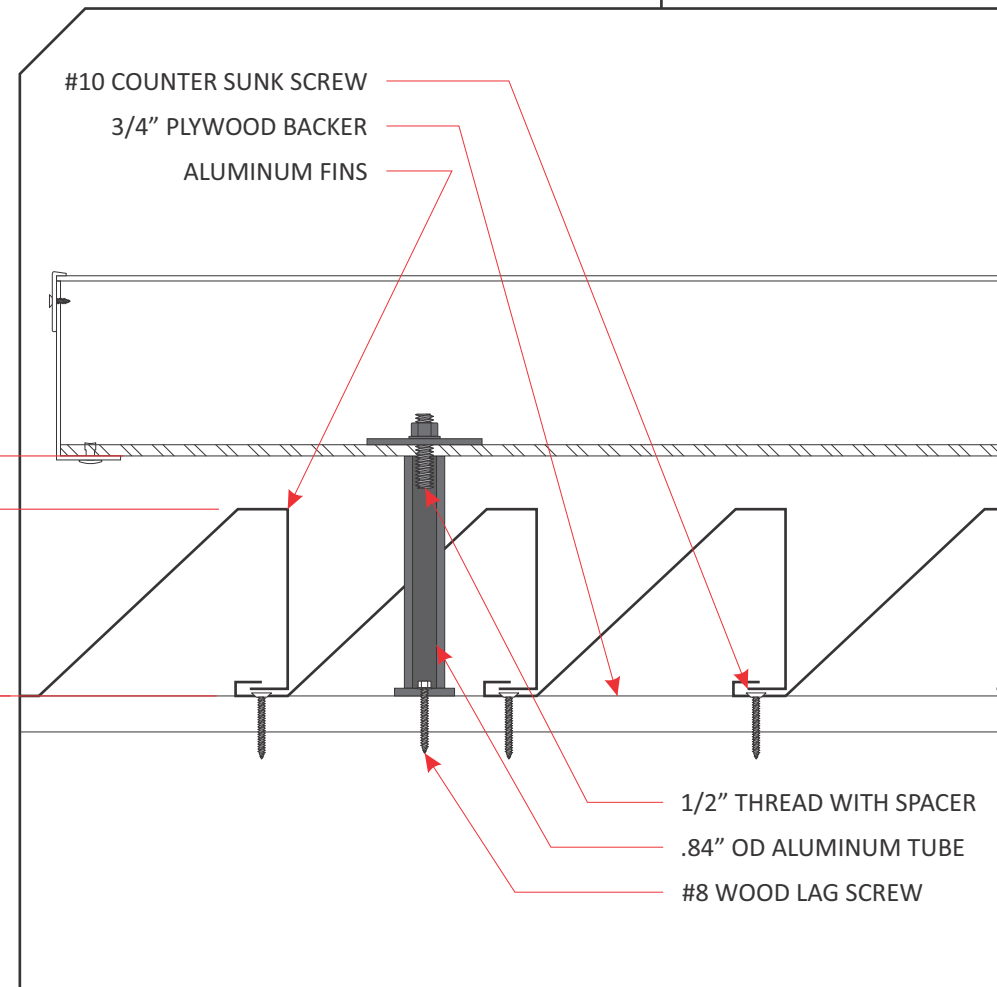
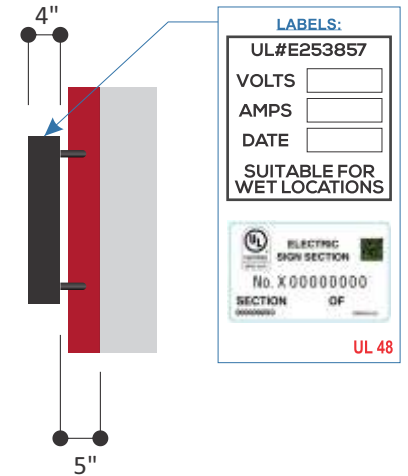
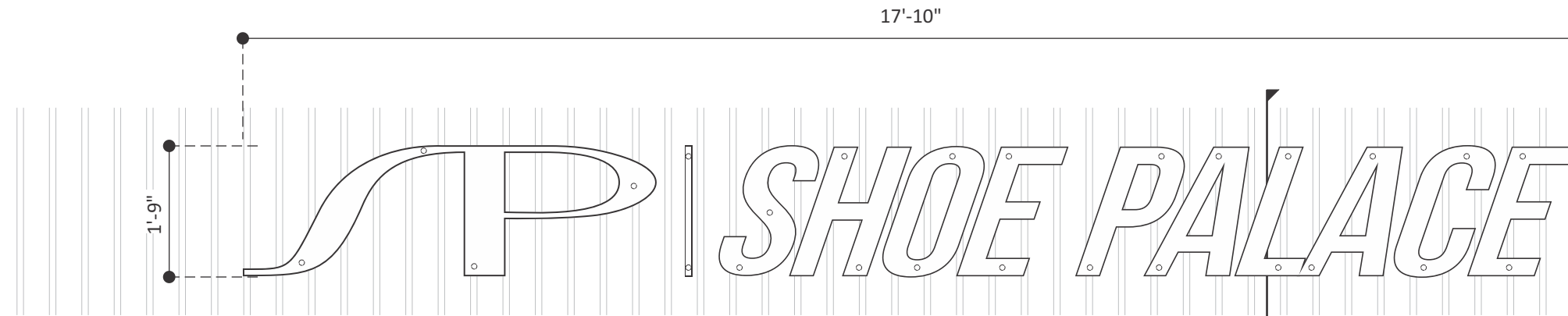

### DESIGN STANDARD DEVIATIONS:

- None

### FACE-LIT LETTERSET ON FIN TYP.

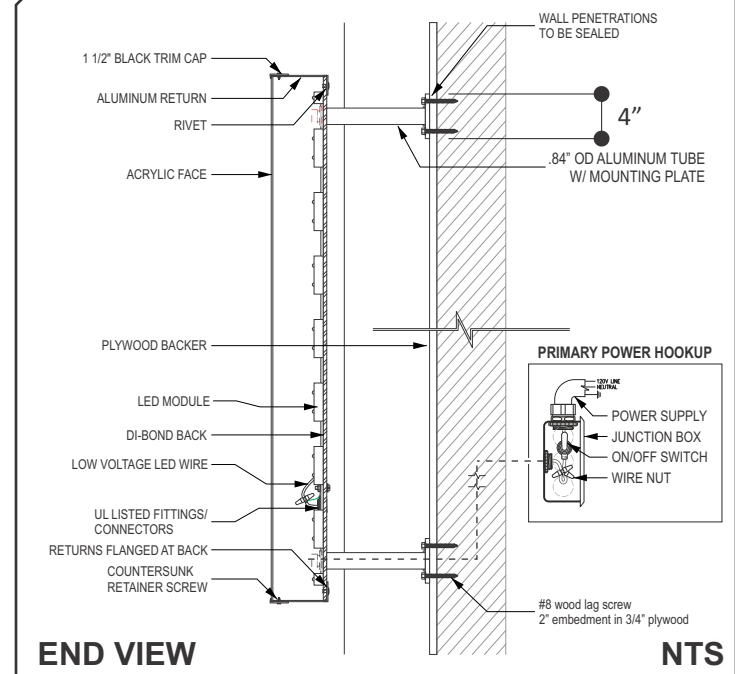

Fins Section Details

### MATERIALS: CHANNEL LETTERS

FACE: White Acrylic w/ 1 1/2" Black Trim Cap.  
 RETURNS: .040" Alum.- 4" deep painted black.  
 BACKS: 3mm Dibond (ACM)  
 LED: 5000k White LED modules front face lighting

### LED CHART

5000 LEDs

QTY: ONE (1) 12 PCS TOTAL

SIGN AREA: 31.20 SF

SCALE: 1/2" = 1'-0"

### COLOR SCHEDULE

- Milky White
- Black Returns



13158 ARCTIC CIR.  
 SANTA FE SPRINGS  
 CALIFORNIA 90670  
 PH: (562) 436-5188  
 www.TDISIGNS.com

THIS DESIGN IS THE PROPERTY OF TDI SIGNS INC. IT IS NOT TO BE SHOWN TO ANYONE OUTSIDE OF YOUR ORGANIZATION, REPRODUCED, OR COPIED IN ANY FASHION WITHOUT THE WRITTEN AUTHORIZATION OF TDI SIGNS INC.. COLORS DEPICTED ARE A GRAPHIC REPRESENTATION, REFER TO CALLOUTS FOR ACTUAL COLORS TO BE USED.

**PROJECT INFO:**  
 SHOE PALACE  
 SOUTH HILL MALL  
 Space 410 & 420  
 3500 S Meridian  
 Puyallup, WA 98373

**Account Manager:** G. Verduzco  
**Designer:** H. Schneider

**Project Manager:** J. Palomino

**Approval:**

#	INT.	DATE	DESCRIPTION
1	EA	09/01	INITIAL DRAWING
2	EA	09/09	UPDATED TO NEW LOGO & DUAL-LIT W/ CHROME.FIN.
3	EA	09/30	UPDATED ELEVATION AS PER EMAIL REEQUEST
4	EA	10/07	UPDATED SOW OF SIGN A & B

4 OF 5  
 10/07/24  
 240708-04.0

# FACE-LIT CHANNEL LETTERS: SIGN B

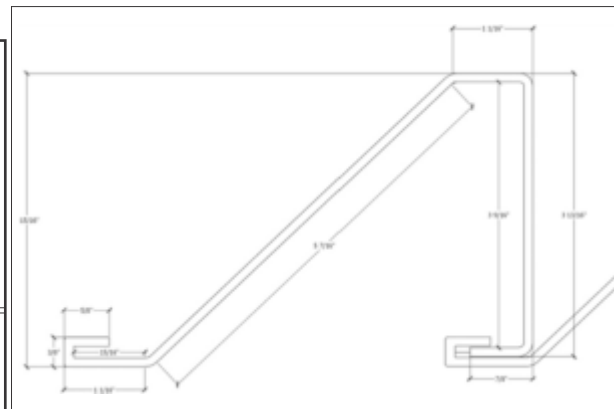
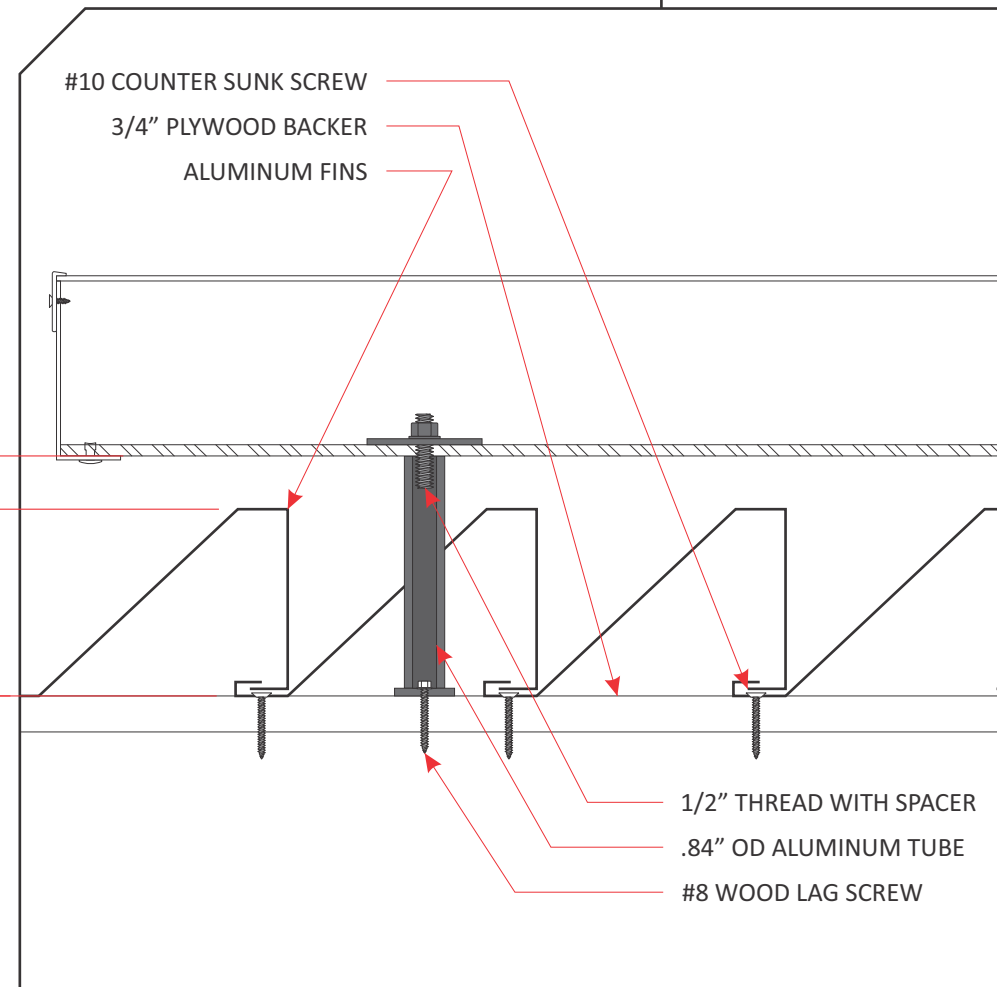
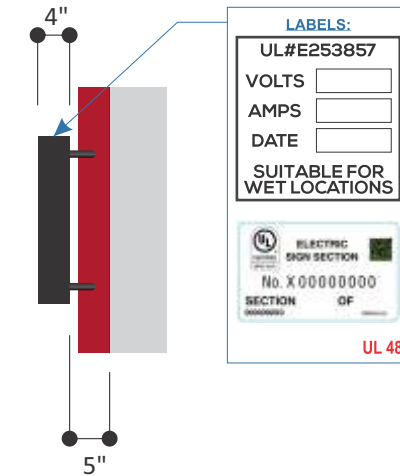
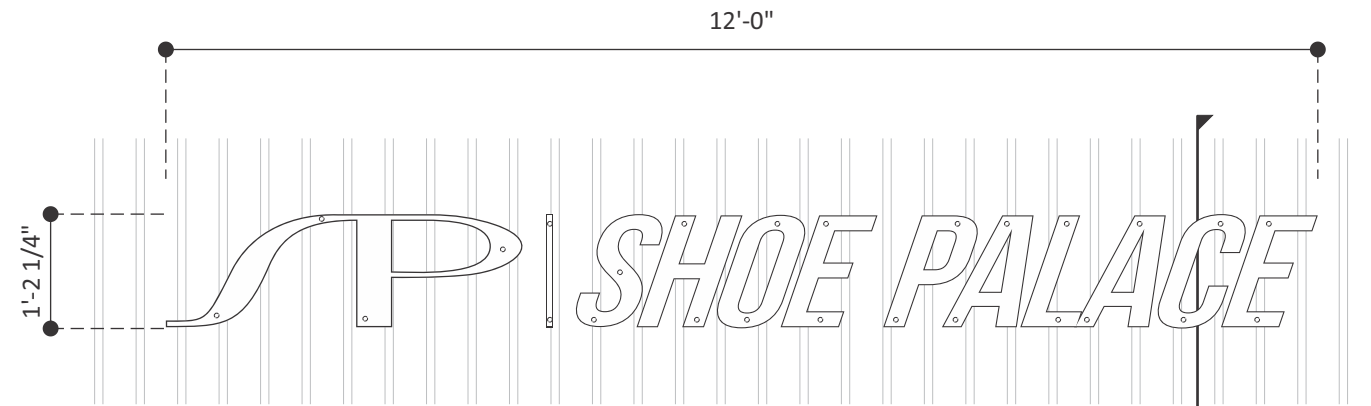

**DESIGN STANDARD DEVIATIONS:**

- None

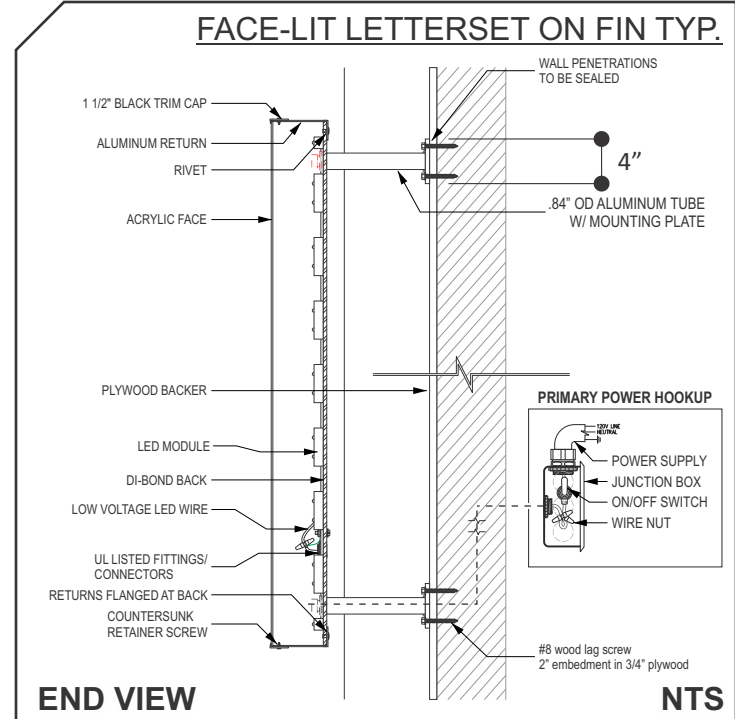

**LED CHART**

5000 LEDs

**QTY: ONE (1) 12 PCS TOTAL**

**SIGN AREA: 14.25 SF**

**SCALE: 1/2" = 1'-0"**

**MATERIALS: CHANNEL LETTERS**

FACE: White Acrylic w/ 1 1/2" Black Trim Cap.  
 RETURNS: .040" Alum.- 4" deep painted black.  
 BACKS: 3mm Dibond (ACM)  
 LED: 5000k White LED modules front face lighting

**COLOR SCHEDULE**

Milky White  
 Black Returns

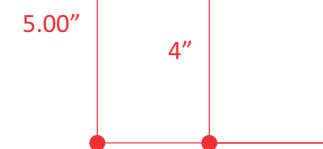

13158 ARCTIC CIR.  
 SANTA FE SPRINGS  
 CALIFORNIA 90670  
 PH: (562) 436-5188  
 www.TDISIGNS.com

THIS DESIGN IS THE PROPERTY OF TDI SIGNS INC. IT IS NOT TO BE SHOWN TO ANYONE OUTSIDE OF YOUR ORGANIZATION, REPRODUCED, OR COPIED IN ANY FASHION WITHOUT THE WRITTEN AUTHORIZATION OF TDI SIGNS INC.. COLORS DEPICTED ARE A GRAPHIC REPRESENTATION, REFER TO CALLOUTS FOR ACTUAL COLORS TO BE USED.

**PROJECT INFO:**  
 SHOE PALACE  
 SOUTH HILL MALL  
 Space 410 & 420  
 3500 S Meridian  
 Puyallup, WA 98373

**Account Manager:** G. Verduzco  
**Designer:** H. Schneider  
**Project Manager:** J. Palomino

**Approval:**

#	INT.	DATE	DESCRIPTION
1	EA	09/01	INITIAL DRAWING
2	EA	09/09	UPDATED TO NEW LOGO & DUAL-LIT W/ CHROME.FIN.
3	EA	09/30	UPDATED ELEVATION AS PER EMAIL REEQUEST
4	EA	10/07	UPDATED SOW OF SIGN A & B