

# Meridian Firs Apartments

## Deck Repair

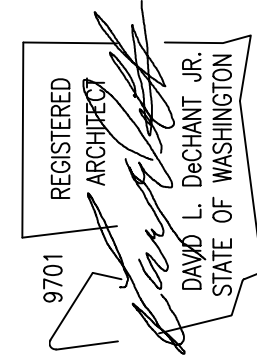

REVISIONS THIS SHEET

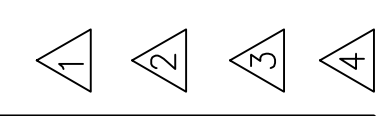

Project Statistics	
CODE COMPLIANCE:	2021 INTERNATIONAL EXIST BLDG CODE
SITE ADDRESS:	2923 S. MERIDIAN ST (BLDG H) PUYALLUP, WA
PARCEL NUMBER:	0419032096
EXISTING USE:	R-2 OCCUPANCY MULTI-FAMILY 2 STORY APARTMENTS
NUMBER OF DECKS:	6 DECKS

Project Team	
<b>OWNER:</b>	MERIDIAN FIRS LLC C/O DMCI PO BOX 111088 TACOMA, WA 98411 (253) 475-2405 DEARTH@DMCIMAIL.COM
<b>ARCHITECT:</b>	CASEY + DeCHANT ARCHITECTS, LLC PO BOX 456 PUYALLUP, WA 98371 (253) 584-5207 CELL 253-677-0364 LARRY DeCHANT LDECHANT@CASEYDECHANTARCH.COM
<b>STRUCTURAL ENGINEER:</b>	SOLUTIONS 4 STRUCTURES, INC. 11605 135TH ST. CT. E. PUYALLUP, WA 983742 (253) 314-9822 TOM@SOLUTIONS4STRUCTURES.COM

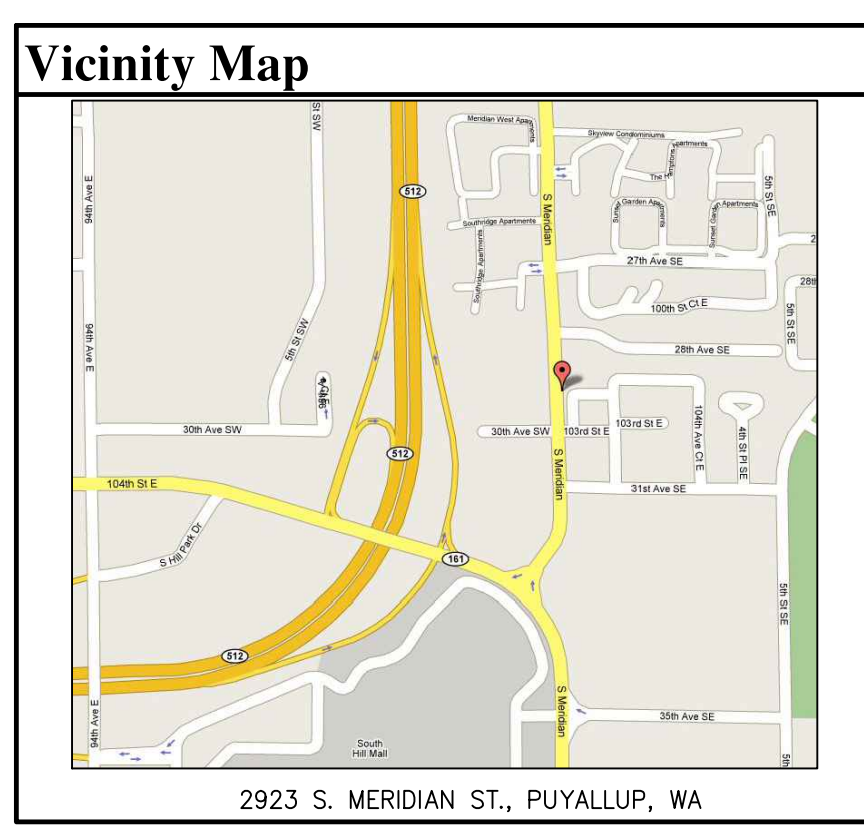

Scope of Work	
<b>EXTERIOR WORK:</b>	<ol style="list-style-type: none"> <li>PROVIDE 42" HIGH PHYSICAL BARRIER AT SLIDING GLASS DOOR TO PREVENT TENANT ACCESS TO EXTERIOR DURING CONSTRUCTION.</li> <li>REMOVE CORNER OF EXISTING CONCRETE PATIOS AS NEEDED FOR NEW FOOTINGS WHERE CALLED OUT.</li> <li>POUR NEW CONCRETE FOOTINGS PER DETAILS AT NEW POST LOCATIONS WHERE CALLED OUT.</li> <li>ADD NEW BEAM &amp; POSTS PER DETAILS WHERE CALLED OUT.</li> <li>INSTALL NEW HORIZ. DECORATIVE BOARDS OVER EXISTING PICKETS.</li> <li>REMOVE EXISTING DECKING AND REPLACE WITH MARINE GRADE PLYWOOD.</li> <li>NO REPLACEMENT OF DOORS, WINDOWS, CONC. PATIOS, WALKS PROPOSED OR SCHEDULED.</li> </ol>
<b>INTERIOR WORK:</b>	<ol style="list-style-type: none"> <li>NO INTERIOR WORK PROPOSED.</li> </ol>

Drawing Notes	
1.	FOLLOW THE CONSTRUCTION DETAILS IN THE ATTACHED CONSTRUCTION DOCUMENT. HIDDEN OR UNKNOWN DEFECTS ARE NOT ADDRESSED IN THIS DOCUMENT.
2.	CONTRACTOR IS RESPONSIBLE FOR DETERMINING QUANTITIES BY USING THE CONSTRUCTION DOCUMENTS, CONTRACTOR SITE OBSERVATIONS AND FIELD MEASUREMENTS.
3.	PROVIDE DEMOLITION OF EXISTING MATERIALS AS REQUIRED TO COMPLETE THE SCOPE OF WORK AND AS OUTLINED IN THE CONSTRUCTION DOCUMENTS. LEGALLY DISPOSE OF ALL MATERIALS.
4.	INFORMATION SHOWN IN CONSTRUCTION DOCUMENTS IS SUBJECT TO THE REVIEW AND APPROVAL OF THE JURISDICTION AND MAY BE AMENDED.

Owner/Contractor Coordination Notes	
THE FOLLOWING NOTES SHALL SERVE AS A GUIDE TO THE CONTRACTOR TO VERIFY EACH CONDITION WITH THE PRODUCT MANUFACTURER OR SUPPLIER, AND/OR LOCAL JURISDICTIONS FOR THEIR REQUIREMENTS PRIOR TO SUBMITTING A BID TO THE OWNER OR PROCEEDING WITH THEIR WORK.	
THE ITEMS OUTLINED BELOW ARE NOT INTENDED TO BE AN EXHAUSTIVE ANALYSIS OF ALL POSSIBLE AREAS OF CONCERN OR CONFLICT, BUT RATHER TO SERVE AS A BEGINNING POINT IN IDENTIFYING COMMONLY OVERLOOKED AREAS IN THE CONSTRUCTION PROCESS.	
1.	REVIEW SPECIFICATION, MANUFACTURER'S PRODUCT LITERATURE, AND GENERAL NOTES FOR INSTALLATION INSTRUCTION UNIQUE TO THE PROJECT CONSTRUCTION TYPE
<ul style="list-style-type: none"> <li>A. MARINE GRADE PLYWOOD DECK WITH NON-SLIP SURFACE</li> <li>B. SEALANT</li> <li>C. PRESSURE TREATED LUMBER</li> <li>D. METAL STRUCTURAL HANGERS, CLIPS, STRAPS, ETC.</li> <li>E. MEMBRANE FLASHING</li> <li>F. WEATHER RESISTANT BARRIER</li> </ul>	
2.	REVIEW LOCAL & STATE JURISDICTIONAL REQUIREMENTS FOR COMPLETE INSTALLATIONS OF THE FOLLOWING: <ul style="list-style-type: none"> <li>A. CONCRETE FOOTINGS</li> <li>B. FRAMING CONNECTIONS</li> <li>C. STRUCTURAL INSPECTIONS</li> </ul>
3.	IF SPECIAL STRUCTURAL INSPECTIONS ARE REQUIRED BY IBC AND/OR THE CITY OF PUYALLUP, THE OWNER IS REQUIRED TO HIRE INDEPENDENT STRUCTURAL INSPECTOR.
4.	DRAWINGS PREPARED BY OTHERS ARE CONSIDERED ADDITIVE TO THE ARCHITECTURAL DRAWINGS SUBMITTED

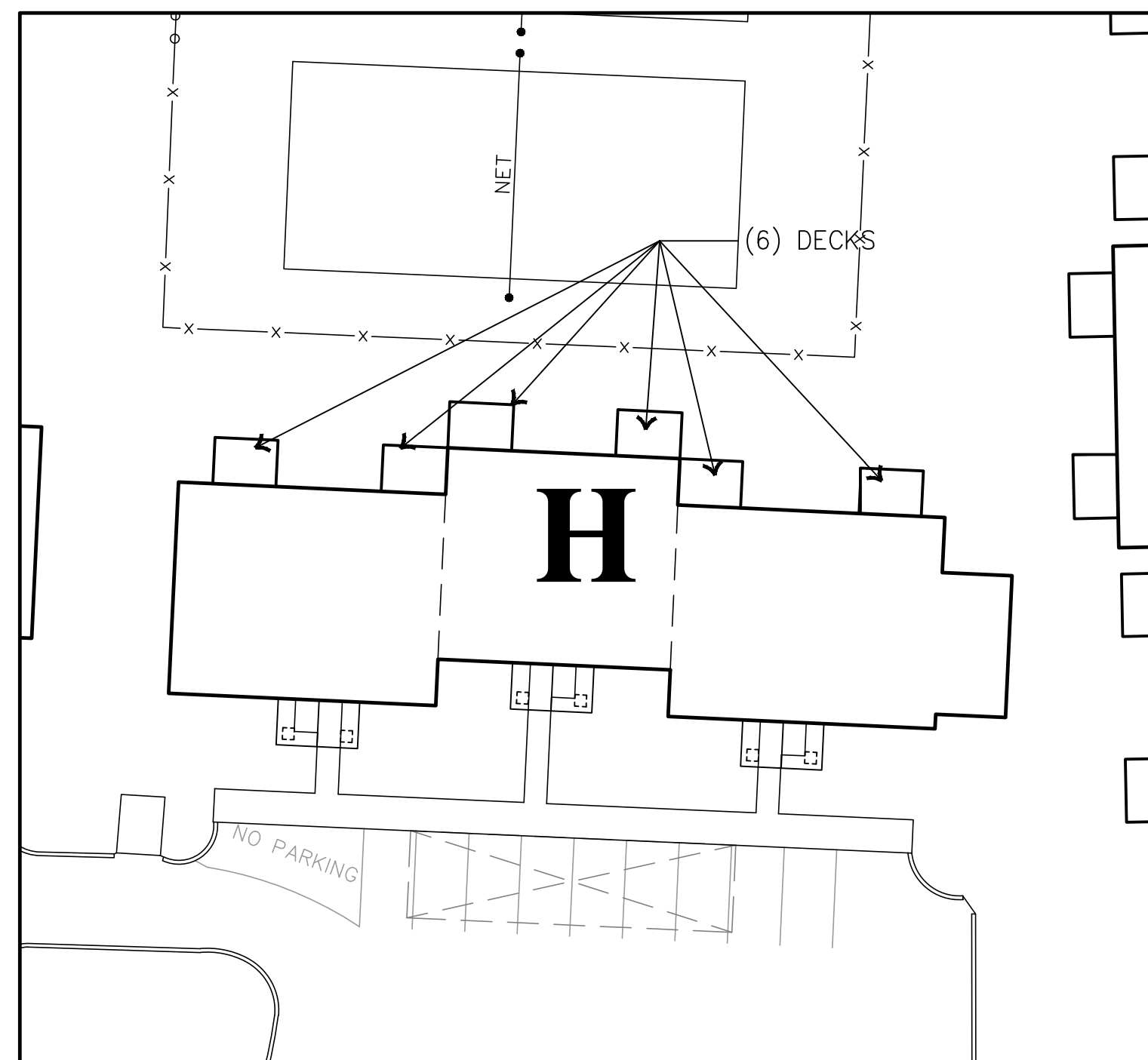
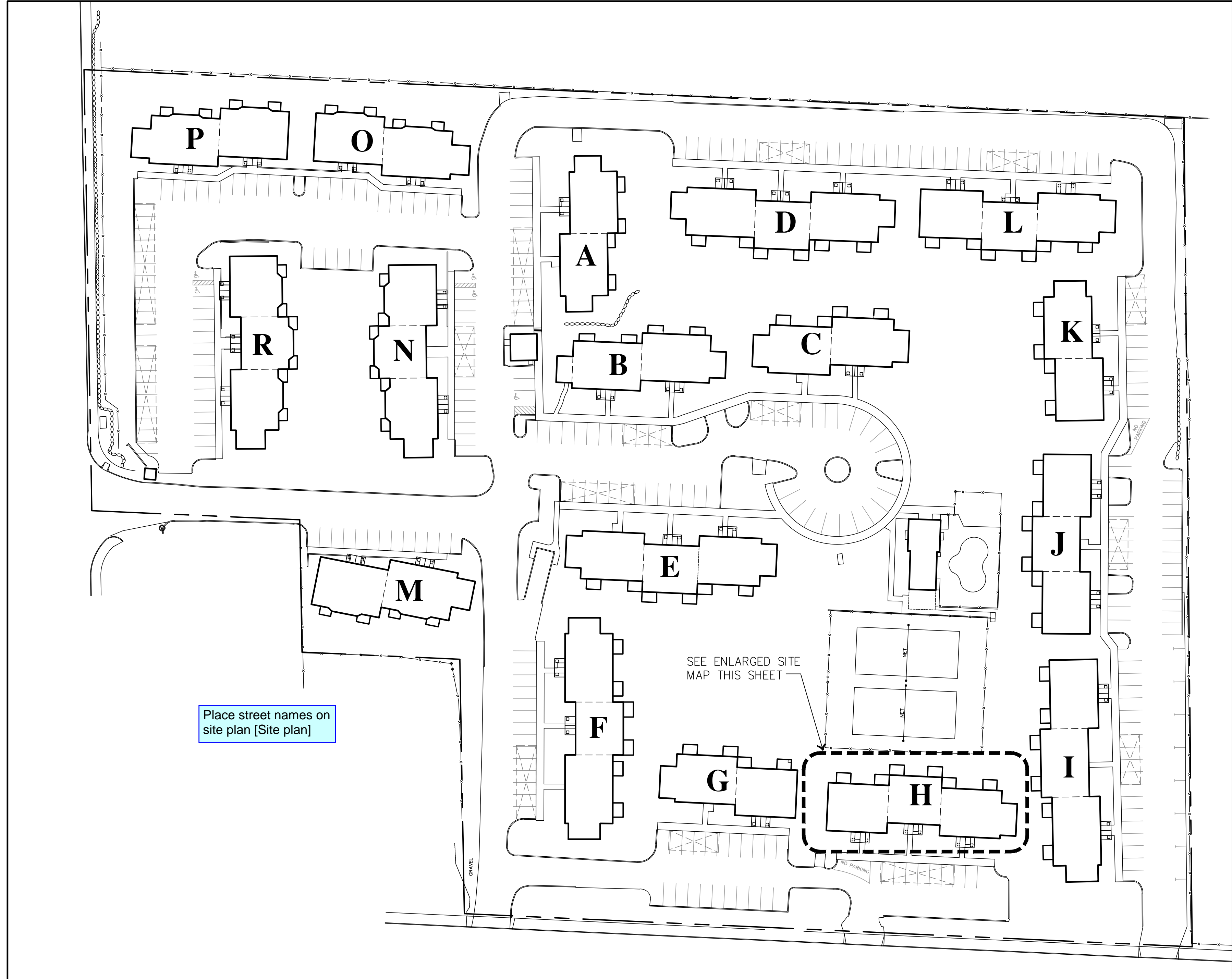

**Site Map**  
SCALE 1" = 50'

**Enlarged Site Map**

**City of Puyallup**  
Planning Division  
**APPROVED**

See permit conditions.

JHulseLew  
12/30/2024  
9:50:18 AM

Revise the site plan to depict the new or existing public utility connections (i.e. water, sewer, stormwater) from the public right-of-way to the building(s). The sanitary side sewer connection should include the location of any sewer clean outs, the water connection should include the location of the meter boxes and backflow prevention devices, and the stormwater connection should include the location of any clean outs and onsite stormwater systems.

**Meridian Firs Apartments - Deck Repair**  
**Puyallup, Washington**  
**PRDK20241953**

PROJECT NO. : 24-013  
 DRAWN BY : DLD  
 ISSUE DATE : 12-18-2024  
 LATEST REV. :  
 THIS SET : 4

P.O. Box 456 Puyallup, Washington 98371 (253) 584-5207