



Occupancy Calculations

1271 sq. ft. ÷ 75 sq. ft./person = Total Occupancy Load 17 persons

PRCTI20250067

6 ft.

5.5 ft.

City of Puyallup
**Building
REVIEWED
FOR
COMPLIANCE**

SKinnear
01/17/2025
12:02:14 PM



13.5 ft.

10.5 ft.

9.5 ft

10.3 ft.

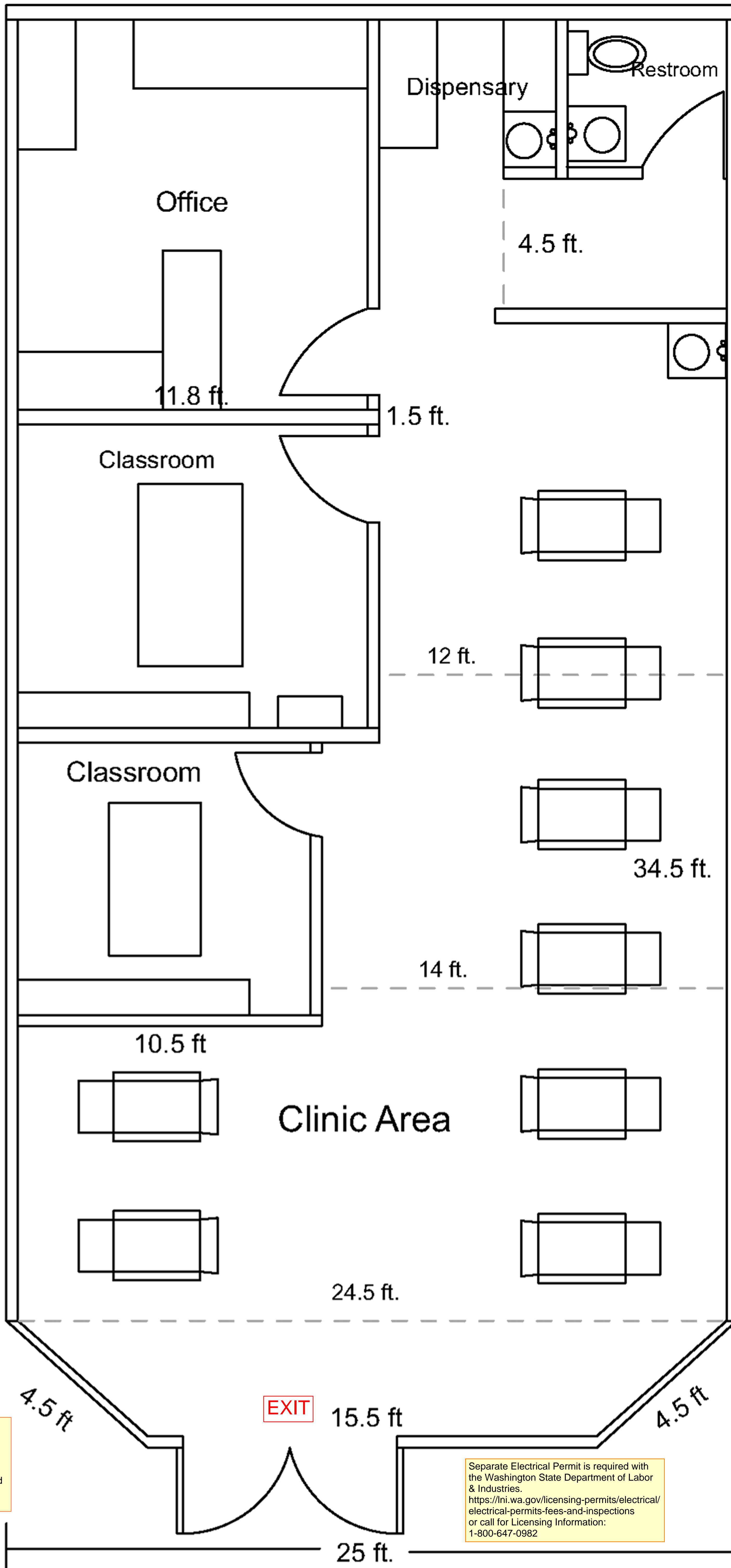

The approved construction plans, documents, and all engineering must be posted on the job at all inspections in a visible and readily accessible location.

Full sized legible color plans are required to be provided by the permittee on site for inspection.

Separate Electrical Permit is required with the Washington State Department of Labor & Industries.
<https://lni.wa.gov/licensing-permits/electrical/electrical-permits-fees-and-inspections>
or call for Licensing Information:
1-800-647-0982

Approval of submitted plans is not an approval of omissions or oversights by this office or non compliance with any applicable regulations of local government. The contractor is responsible for making sure that the building complies with all applicable codes and regulations of the local government.