

Job #: 887039285
 Date: 1/16/25
 Jurisdiction: Puyallup
 ROW Permit: Yes
 Est. Start Date:
 Est. Duration:

Service Address: SE 23RD ST & SHAW RD E VALVE 2
 City: Puyallup Zip: 98372
 Customer: PSE Phone:
 Customer Email:
 PM / Inspector: Gayle / Gary Inglin Phone:
 Site Contact Email: Phone:

Job Description

PROVIDE TRAFFIC CONTROL PLAN
 TO ALLOW PSE TO OPERATE VALVE @ 42'WCL SHAW RD & 21'NCL 23 AVE SE
 POLICE FLAGGER PLUS ONE FLAGGER No excavation

| |
|--------------------------|
| New Construction: |
| Construction Method |
| Building Foundation Type |
| Septic System |

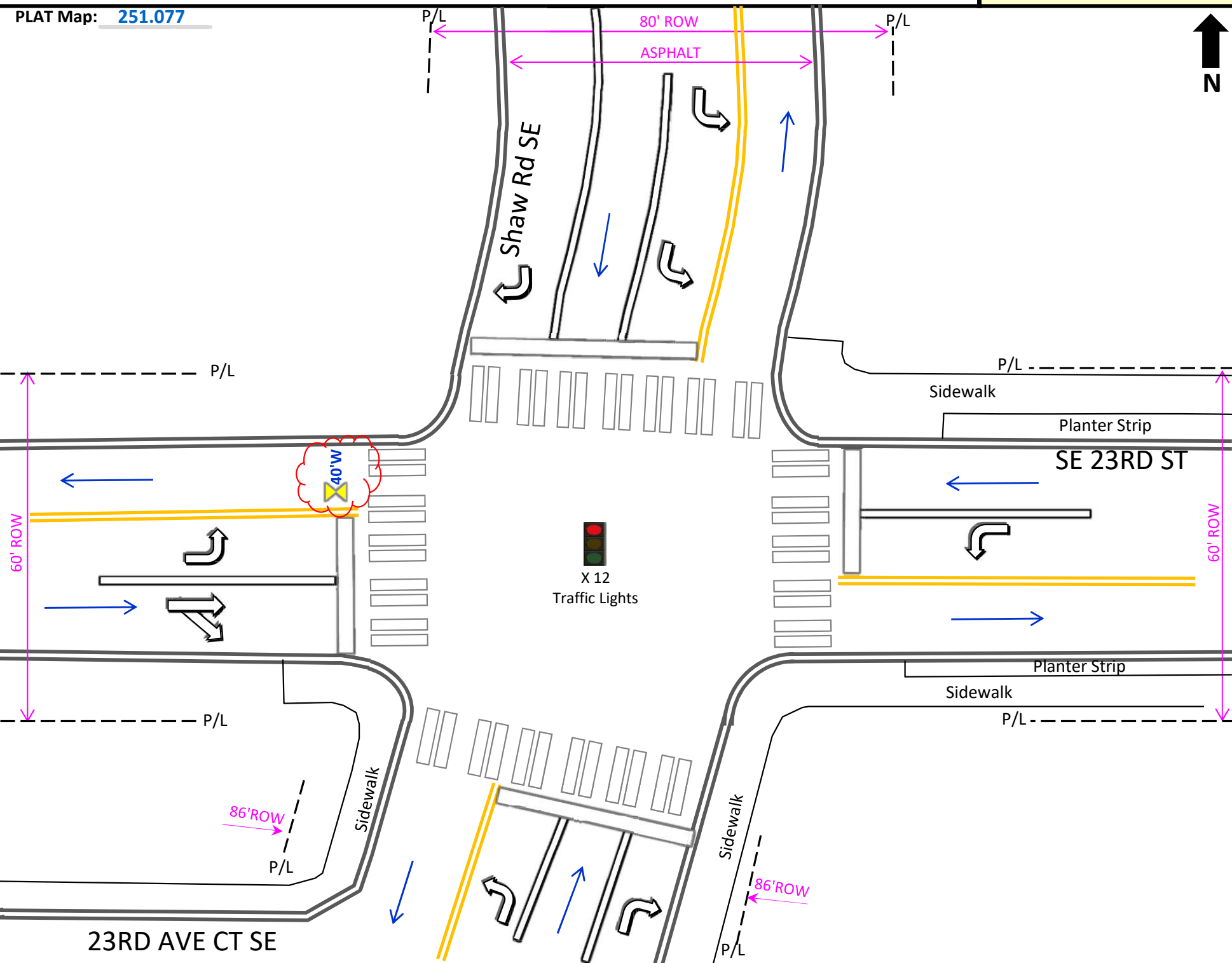

| Work Location | | | | | | | Size of Cut | Surface Type | |
|---------------------|--------|-------|-------------|--------------------|-----|---------|----------------|--------------|--|
| 12' | N | of CL | 23RD AVE SE | & | 42' | W of CL | SHAW RD | | |
| | | of CL | | & | | of CL | | | |
| | | of CL | | & | | of CL | | | |
| Service Information | | | | Street Information | | | | Job Type | |
| Diameter: | 0 | | | Flaggers #: | 0 | | Arterial: | No | |
| EFV: | 0 | | | Police #: | 0 | | TCP: | No | |
| Meter: | | | | Speed Limit: | 0 | | No Parks #: | 0 | |
| Meter Loc: | 0 | | | Trolley Lines: | No | | Mtr Hoods #: | 0 | |
| Del Press: | | | | Traffic Signal: | | | Bus Stop: | No | |
| Bollards: | 2.5" # | | 4" # | ADA Ramps #: | 0 | | Route #'s: | | |
| | | | | | | | LAK - Lakewood | | |