

The applicant/contractor shall contact Meghan Genge, Puyallup Police Department Support Specialist, at 253-841-5436 or mgenge@puyallupwa.gov to coordinate traffic support with a Puyallup uniformed police officer at least 24 hours of job start.

TEMPORARY TRAFFIC CONTROL PLAN

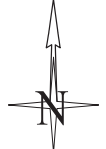

NIGHT WORK REQUIRED. ROAD WORK ALLOWED:
 Sunday - Thursday
 9PM - 5AM
 Call communications center at 253-287-4456 on night of work. Request a job start inspection through the CityView portal and leave a message for the inspectors by calling 253-435-3650 at least 48 hours in advance of job start.

The applicant shall notify all residents and businesses within 300 feet of the work area 48 hours in advance of start date by distributing informational door hangers, displaying work on message boards, or on signs posted visibly along the right-of-way. The City-issued permit packet shall be posted at the job site and available to inspectors at all times.

When shifting traffic into a turn lane, use of double cones is required. Traffic device spacing shall be half distance for opposing traffic devices.

City of Puyallup Development & Permitting Services ISSUED PERMIT

Building	Planning
Engineering	Public Works
Fire	Traffic

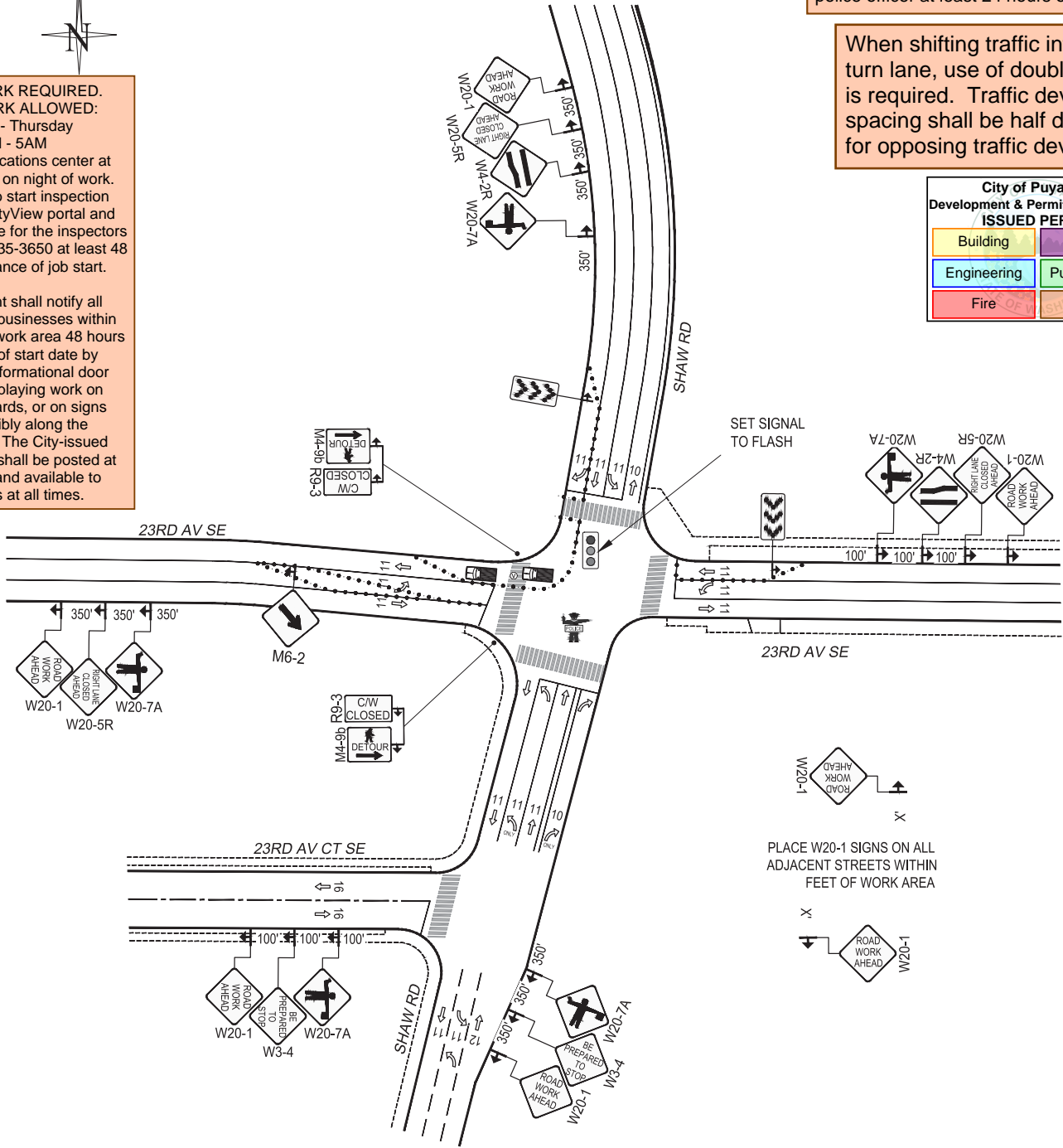

Notes:

- All signs and spacing to conform to the MUTCD and City of Puyallup standards.
- All sidewalks, driveways, exits and egresses shall be completely clear unless otherwise indicated.
- Channelizing devices are 28" traffic cones. Use traffic drums (barrels) with steady burning Type C lights on all State State Routes and Hwys.
- Sign size can be a minimum of 36" x 36" and shall not obstruct pedestrian access.
- Crew is required to leave a minimum of 11' for traveling lane width.
- Alert affected residents and businesses.
- ~~Work to take place between 9 a.m. and 4 p.m. unless otherwise specified. All work for arterials and major roadways will be from 9 a.m. to 3 p.m.~~
- Work area will be approx. 12' NCL of 23rd Av SE & 42' WCL of Shaw Av E.

$$L = \frac{W \cdot S^2}{60}$$

MPH	"X"
60/65	1000'
45/55	500'
35/40	350'
25/30	100'

CHANNELIZATION DEVICE SPACING
DISTANCE BETWEEN CONES EQUALS SPEED LIMIT IN UNITS OF FEET

LEGEND

- 28" TRAFFIC CONE
- VALVE LOCATION
- TRAFFIC FLOW
- UNIFORMED POLICE OFFICER
- FLAGGER
- WORK VEHICLE/ FLASHING LIGHTS
- SIGN LOCATION
- RIGHT OF WAY
- CHEVRON ARROW BOARD

PSE PUGET SOUND ENERGY
 Designer: Stephen R Gadke
 425-424-6431
 stephen.gadke@pse.com
 Project Address: 23rd Av SE & Shaw Av E Puyallup, WA

Puget Sound Energy
 Traffic Control Supervisor:
 Stephen R Gadke
 Card No. 012522
 Exp. 7/31/2025
 stephen.gadke@pse.com
 (425) 424-6431
Stephen R Gadke

1/16/25	REV 0
Job # 887039285	
Page	1 OF 1